

TUB FILLER WITH DIVERTER AND HAND SHOWER

Cat. No.
4023



W: 9"
H: 12"
D: 9 1/2"
Riser Height: 60"

Features:

- ▶ Code Gooseneck Spout
- ▶ 1/4 turn ceramic disc cartridges
- ▶ 3 3/8" Centers
- ▶ Flow rate for faucet is 3.68 GPM
- ▶ Flow rate for handshower is 2.5 GPM
- ▶ Hand-held Shower and Cradle
- ▶ Check Valve in Handshower
- ▶ Includes 59" hose
- ▶ Includes 6" Wall Support
- ▶ For Cast Iron Tub Use Only (Part# 4024 for Acrylic Tub)

Finishes:

CP Polished Chrome
BN Brushed Nickel

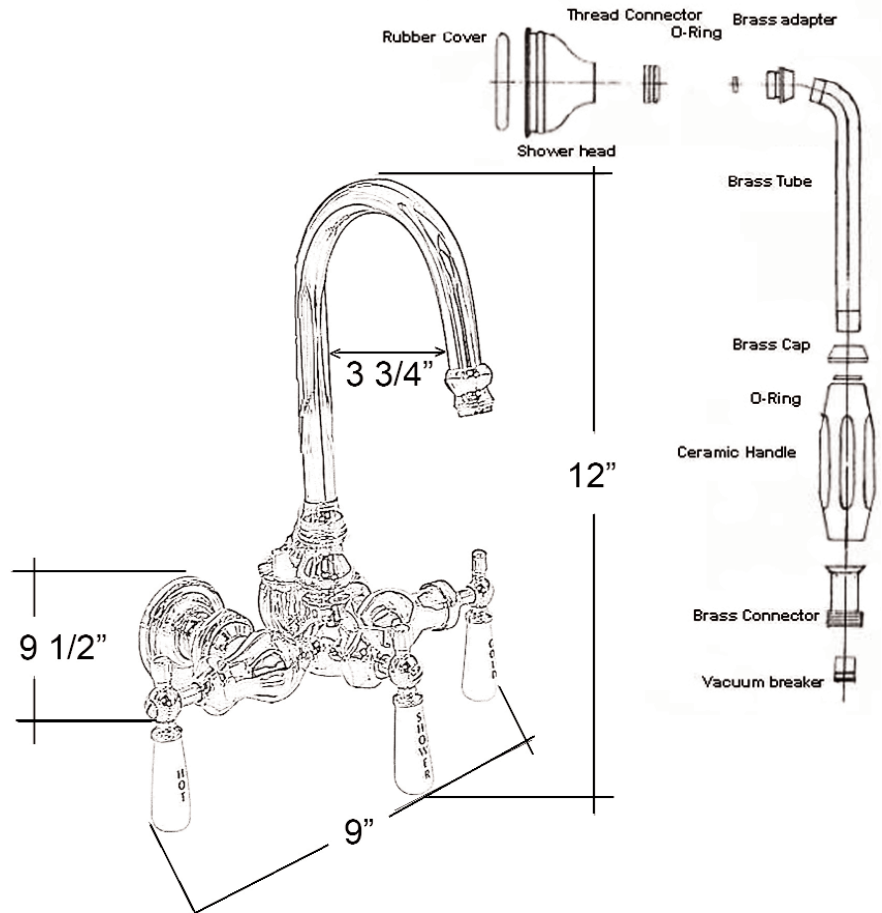

Dimensions of fixture are nominal and may vary. Dimensions and specifications subject to change without notice.