

COOPER LIGHTING - METALUX®

DESCRIPTION

The WS Series is a specification wraparound luminaire featuring energy efficient performance. The luminaire's characteristic clean, low profile design is both appealing and practically functional. The WS Series utilizes a clear, low brightness, extruded acrylic refractor with injection molded end caps for high performance and good looks.

The efficient and stylish WS Series is the perfect wraparound for commercial spaces, schools, dormitories, offices and retail areas.

SPECIFICATION FEATURES

Construction

Housing die formed code gauge prime cold rolled steel. Six full length ribs for strength. Ballast cover easily removed without tools. Steel end plates with 7/8" KO and light-seal embossment. Couplers for continuous row mounting.

Electrical*

Ballasts are CBM/ETL Class "P" and are positively secured by mounting bolts. Pressure lock lampholders. UL/CUL listed. Suitable for damp locations.

Finish

Multistage, iron phosphate pretreatment ensures maximum bonding and rust inhibitor. Lighting grade, baked white enamel finish.

Frame/Shielding

100% clear full thickness virgin acrylic prismatic refractor/lens. Permanent luminous injection molded end caps. Sides have inside linear prisms and bottom has pyramidal prisms for low brightness control. Lens can be hinged from either side in a lift and shift manner.

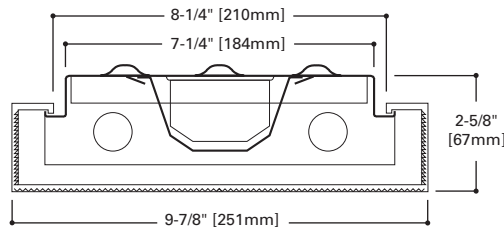

MOUNTING DATA

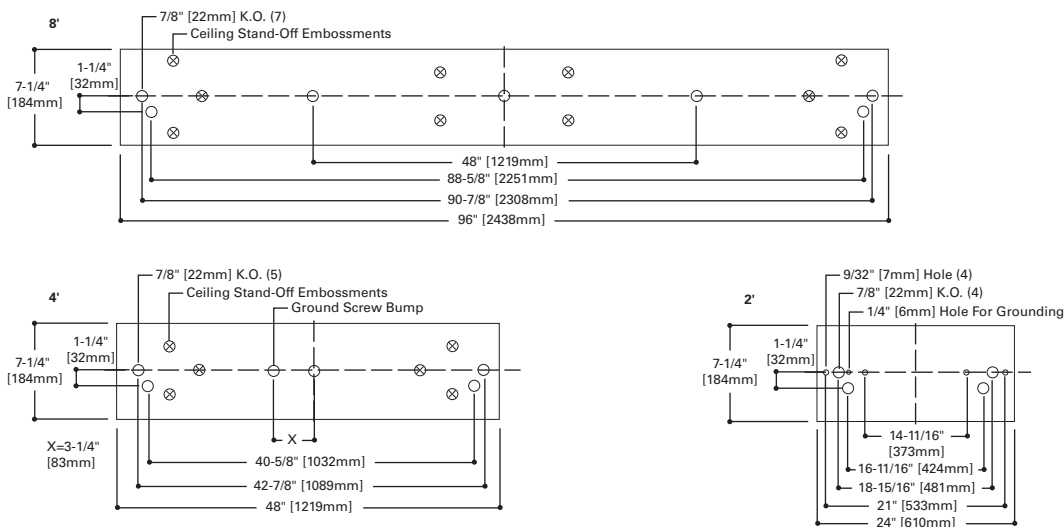

LAMP CONFIGURATIONS

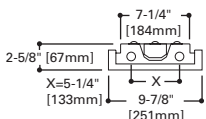

LIFT & SHIFT REFRACTOR

Easily Removed. Hinges Either Side (Not Recommended For Sloped Ceiling Applications.)

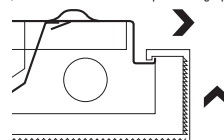

Catalog #		Type
Project		
Comments		Date
Prepared by		



WS
220
217
240
232

2', 4' OR 8' SURFACE
2 LAMPS

Specification Wrap

ENERGY DATA

Input Watts:
EB Ballast & STD Lamps
217 (36)
417 (72)

ES Ballast & STD Lamps
220 (58)
217 (45)
420 (116)
417 (90)

Luminaire Efficacy Rating
LER = FW-72
Catalog Number: WS-232A
Yearly Cost of 1000 lumens,
3000 hrs at .08 KWH = \$3.33

*Reference the lamp/ballast data in the Technical Section for specific lamp/ballast requirements.

LAMPS CONTAIN MERCURY. DISPOSE ACCORDING TO LOCAL, STATE OR FEDERAL LAWS

LINEAR DISCONNECT
Safe and convenient means of disconnecting power.

PHOTOMETRICS

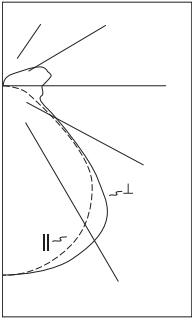

WS-232A
 Energy Saving Ballast
 F32T8/35L Lamps
 2850 Lumens
 Spacing criterion: (ll) 1.3 x mounting height, (⊥) 1.4 x mounting height
 Efficiency 80.5%
 Test Report: WS232A.IES
 LER = FW-72
 Yearly Cost of 1000 lumens, 3000 hrs at .08 KWH = \$3.33

Coefficients of Utilization

rc	Effective floor cavity reflectance						20%											
	80%			70%			50%		30%		10%		0%					
	rw	70	50	30	10	70	50	30	10	50	30	10	50	30	10	0		
RCR																		
0	92	92	92	92	88	88	88	88	81	81	81	75	75	75	69	69	69	66
1	84	81	78	75	81	78	75	72	71	69	67	66	64	62	61	59	58	55
2	77	71	66	62	74	69	64	60	63	60	57	59	56	53	54	52	50	47
3	71	63	57	53	68	61	56	51	57	52	49	53	49	46	49	46	43	41
4	66	57	50	45	63	55	49	44	51	46	42	47	43	40	44	41	38	36
5	60	50	44	39	57	49	43	38	45	40	36	42	38	34	39	36	33	31
6	55	45	39	34	53	44	38	33	41	36	32	38	34	30	36	32	29	27
7	51	41	34	29	49	39	33	29	37	32	28	35	30	26	32	28	25	24
8	47	37	30	26	45	35	29	25	33	28	24	31	26	23	29	25	22	20
9	43	33	26	22	42	32	26	22	30	25	21	28	23	20	26	22	19	18
10	40	30	24	19	39	29	23	19	27	22	18	25	21	18	24	20	17	15

Zonal Lumen Summary

Zone	Lumens	%Lamp	%Fixture
0-30	1080	18.9	23.5
0-40	1810	31.8	39.4
0-60	3031	53.2	66.0
0-90	3748	65.7	81.7
90-180	842	14.8	18.3
0-180	4589	80.5	100.0

Typical VCP Percentages

Room Size (Ft.)	Height Along		Height Across	
	8.5'	10.0'	8.5'	10.0'
20 x 20	68	73	67	73
30 x 30	62	66	58	64
30 x 60	53	56	44	50
60 x 30	63	66	61	66
60 x 60	53	56	46	51

Candela

Angle	Along ll	45°	Across ⊥
0	1337	1337	1337
10	1317	1326	1333
20	1250	1292	1324
30	1140	1230	1281
40	983	1107	1149
50	717	769	725
60	339	423	414
70	207	264	281
80	113	174	285
90	14	108	278
100	18	185	346
110	26	229	331
120	32	176	260
130	36	110	151
140	35	91	101
150	30	60	90
160	26	48	59
170	24	30	33
180	22	22	22

ORDERING INFORMATION

SAMPLE NUMBER: WS-232A-120V-EB81-U

<p>Tandem Blank=4' Length 8T=8' Length</p>	<p>Ballast Start Type LTS=Low Trigger Start (20 Watt only) (120V only) HTS=High Trigger Start (20 Watt only)</p>	<p>Ballast Type (4) Blank=Standard Magnetic T12 Ballast LE3=T12 Magnetic Energy Saving EB8 = T8 Electronic Instant Start. Total Harmonic Distortion < 20% No. of Ballast 1 or 2 EB8_/PLUS= T8 Electronic Instant Start. High Ballast Factor >1.13. Total Harmonic Distortion < 20% No. of Ballast 1 or 2 ER8 = T8 Electronic Program Rapid Start. Total Harmonic Distortion < 10% No. of Ballast 1 or 2 EB2 = T12 Electronic Rapid Start. No. of Ballast 1 or 2</p>	<p>Options RIF1=Radio Interference Suppressor RLS=Rotor-Lock Socket (T8 Lamps Only) (See options & accessories)</p>	<p>Packaging U=Unit Pack</p>
<p>Series (1) WS=Specification Surface Wrap</p>	<p>Voltage (4) 120V=120 Volt 277V=277 Volt 347V=347 Volt UNV=Universal Voltage 120-277 (5)</p>			
<p>Width Blank=Standard A=Wide Body for 2 Lamps</p>	<p>Options GL=Single Element Fuse GM=Double Element Fuse EL=Emergency Installed (6)</p>			
<p>Number of Lamps (2), (3) 2=2 Lamps (Not Included)</p>				
<p>Wattage 20=20W T12 (24") 17=17W T8 (24") 32=32W T8 (48") 40=40W T12 (48")</p>				
<p>Lens A=Acrylic Refractor Lens</p>				

NOTES: (1)Steel endplates with 7/8" KO standard for continuous row mounting. (2)Stem mounting not available on 3-lamp fixtures. (3)2 point suspension recommended for 2 and 4-lamp fixtures. (4)Products also available in non-US voltages and frequencies for international markets. (5)Not available when specifying emergencies, voltage must be specific. (6)Non available for 2' version.

For complete product data, reference the Fluorescent Specification binder. Specifications & dimensions subject to change without notice. Consult your Cooper Lighting Representative for availability and ordering information.

LAMP SPACING (8")

(2 Lamp Housing with 8" lamp spacing also available).

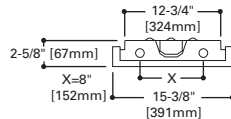

Catalog Number
WS-A-232A (120V or 277V)

ACCESSORIES

(Order Separately)
 SCF=Fixed Stem Set (Specify Length)
 SCS=Swivel Stem Set (Specify Length)
 SCA=Adjustable 48" Stem Set
 A1B/Spacer-U=Spacer 1-1/2" to 2-1/2" from ceiling (Use 2 per fixture)
 Lengths Available: 6, 8, 12, 18, 24, 36, 48
 (Additional Accessories Available. See Options and Accessories Section.)

SHIPPING DATA

Catalog No.	Wt.
WS-217A	8 lbs.
WS-232A	17 lbs.
8TWS-232A	33 lbs.