

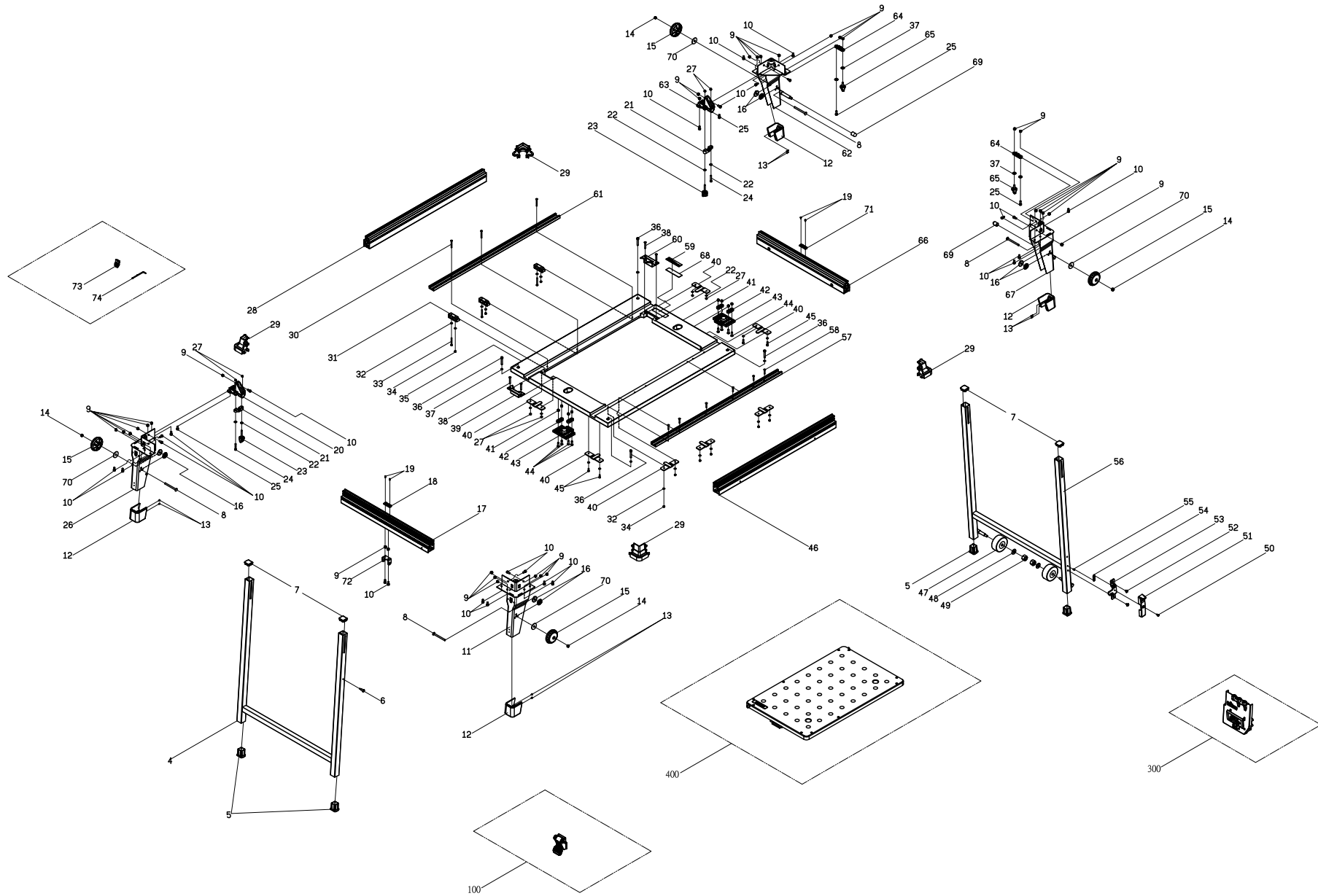

# TWX7 - Triton Workcentre





## TWX7 - Triton Workcentre

<b>NO.</b>	<b>Description</b>	<b>Qty</b>
4	Leg (Front)	1
5	Foot	4
6	Long Shoulder Cap Screw	1
7	Leg cap	4
8	Carriage Bolt(Zinc)	4
9	Nylon Nut	30
10	Hexagon Socket Head Cap Screw	24
11	Leg Bracket, RH, Front	1
12	Knee Bumper	4
13	Flat head screw cross(Zinc)	8
14	Hex Nut	4
15	Knob	1
16	Leg Packer/Disc	8
17	Short extrusion (INFEED)	1
18	Scale pointer, Front	1
19	Truss Head Phillips Tapping Screws	4
20	Side Support Bracket, Front	1
21	Press Plate, Side Support Bracket	2
22	Flat washer	12
23	Triton small knob + Screw(Zinc)	1
24	Hexagon Socket Head Cap Screw	2
25	Hexagon Socket Head Cap Screw	1
26	Leg Bracket, LH, Front	2
27	Nylon Nut	2
28	Short extrusion (LH, LONG)	4
29	Table Corner	1
30	Flat head screw cross(Zinc) pulley	8
31	levelling block	1
32	Flat washer	4
33	Round Head Phillips Screw	3
34	Nylon Nut	3
35	WorkCentre Top	12
36	Hexagon Socket Head Cap Screw	3
37	Flat washer	9
38	Flat head screw cross(Zinc)	1
		4
		8
		4



## TWX7 - Triton Workcentre

<b>NO.</b>	<b>Description</b>	<b>Qty</b>
39	table insert slot, front	1
40	Press Levellers	7
41	Compression Spring	8
42	Slide Plate for Latch	4
43	Latch	2
44	Truss Head Hex Socket Shoulder Bolt	8
45	Hexagon Socket Head Cap Screw	4
46	Short extrusion (RH LONG)	1
47	Reposition Wheel	2
48	Flat washer	2
49	Nylon Nut	2
50	Round Head Phillips Screw	1
51	Leg lock lever knob	1
52	Truss Head Phillips Shoulder Screw	2
53	Sprung Leg Latch	1
54	Extension Spring	1
55	Screw for Extension Spring	1
56	Leg (Rear)	1
57	T-track, RH	1
58	Flat head screw cross(Zinc)	6
60	table insert slot, rear	1
61	T-track Extrusion, LH	1
62	Leg Bracket, LH, Rear	1
63	Outfeed Support Bracket	1
64	Press Plate, Outfeed Support Bracket	2
65	Triton small knob	2
66	Short extrusion (OUTFEED)	1
67	Right Bracket, LH, Rear	1
68	Name label	1
69	Axel Cap, Rugged Wheel	2
70	Flat washer	4
71	Scale pointer, Rear	1
72	Rugged Handle Bracket	1
73	Hangers	20
74	Allen Key with Ball Head	1
100	Fence Clamp	4
300	Switchbox Assy	1
400	Clamping Module	1