



CulnatTM
Specialty plumbing products

120 E. Bell Ave.
Rockdale, TX 76567
info@culnat.com | culwellflange.com
855.285.9355

MADE IN USA



Culwell® Flange
No leaks, no repairs...no kidding!

**3 in. COMPRESSION
O-RING MODELS**



U.S. Pat. 8,955,172

TECHNICAL SPECIFICATIONS:

Culwell® Flange 3-in Compression O-Ring models are for tile applications with impermeable floor-covering membranes from 30 to 100 mils thick or without a membrane when the flange is recessed below the finished floor. For replacement or remodeling. These flanges attach to the sanitary piping system using conventional means that are standard in the industry and are designed to:

- Allow the flange to seal to the floor with its flat flush surface design and seal to a water barrier membrane to prevent water leakage into the subfloor thereby protecting the property from damage.
- Fits inside 3 inch Cast Iron, Schedule 30 or Schedule 40 DWV pipe.

Additional features include:

- Compression O-Ring joint- Two (2) diameters to accommodate different inside pipe sizes.
- Eight countersunk holes for secure attachment of the flange to the floor (Screws are NOT included)
- One-of-a-kind **nylon clamping ring** for superior strength and durability to prevent the need for repair or replacement in the future, backed by Culnat's exclusive **LIMITED LIFETIME WARRANTY**.
- Two (2) elastomeric sealing gaskets; only 1 used for sealing with membrane/ 2 used without membrane
- Uniquely engineered flat sealing surface for maximum contact between the flange and floor.
- Clamping ring that compresses an elastomeric sealing gasket against the floor-covering membrane liner to ensure a water-tight seal, while also engaging with the gasket to keep the closet bolts in place for ease of toilet installation.
- 5/16-in Closet bolts are included

Ideal for:
Wet rooms
Small spaces
Multi-floor
Concrete
Bariatric/
Disability
Commercial/
Residential

ALL DIMENSIONS ARE IN INCHES		Model Nos.	
		AC3	PC3
A	Overall Diameter	7.56	7.56
B	Max. Overall Height*	3.73	3.73
B1	Flange Height Above Subfloor or Slab* (w/ 1 Sealing Gasket)	0.58	0.58
	Flange Height Above Subfloor or Slab* (w/ 2 Sealing Gaskets)	0.59	0.59
B2	Flange Depth Below Floor	3.14	3.14
C	Screw Centers	6.76	6.76

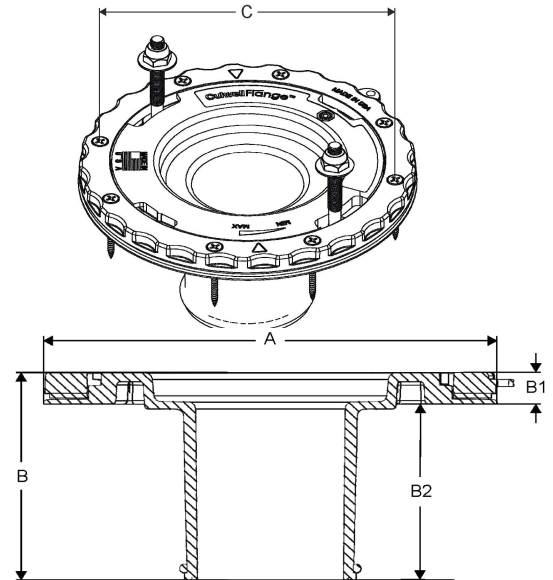

*Max. Overall Height and Flange Height Above Subfloor or Slab dimensions do not include additional height attributed to the thickness of the selected floor-covering membrane. Flange height in relation to the finished floor will vary depending on the thickness of the membrane and tile used during installation.

NOTE: Dimensional data is subject to customary manufacturing tolerances.

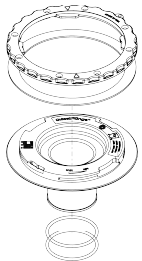

Model No.	Item No.	Description	UPC / GTIN	Ct	Wt (lbs)
AC3		Culwell® Flange 3-in Compression O-Ring - Black ABS Plastic	861225000264	1	0.90
			10861225000261	4	5.817
PC3		Culwell® Flange 3-in Compression O-Ring - White PVC Plastic	861225000271	1	1.05
			10861225000278	4	6.405

MATERIALS AND STANDARDS INFORMATION:

- ABS and PVC flange bodies are made from NSF/ANSI 14 listed materials.
- Clamping rings are made of nylon that has a flexural modulus of at least 2,000 MPa (290,076 psi), as specified in the Basic Property Table (Table PA) of ASTM D4066.