

Features

- Fits minimum 24-inch apron sink base cabinet.
- Single bowl.
- 9-inch depth.
- No faucet holes.
- Center drain.

Material

- KOHLER® enameled cast iron.

Installation

- Self-Trimming® apron overlaps the cabinet face for easy installation and beautiful results.
- Under-mount

Recommended Accessories

K-9000 P-Trap

Optional Accessories

K-8395 Bottom Basin Rack

K-8801 Sink Strainer

Components

Additional included component/s: Cutout templates.



Codes/Standards















ASME A112.19.1/CSA B45.2

KOHLER® Enameled Cast Iron Kitchen Sink - Lifetime Limited Warranty

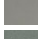
See website for detailed warranty information.

Available Color/Finishes

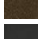
Color tiles intended for reference only.

Color	Code	Description
	0	White
	FF	Sea Salt™
	96	Biscuit
	47	Almond
	FD	Cane Sugar™
	NY	Dune
	95	Ice™ Grey
	G9	Sandbar
	33	Mexican Sand™
	K4	Cashmere
	FT	Basalt
	58	Thunder™ Grey
	20	Suede
	KA	Black 'n Tan
	FP	Caviar
	7	Black Black™

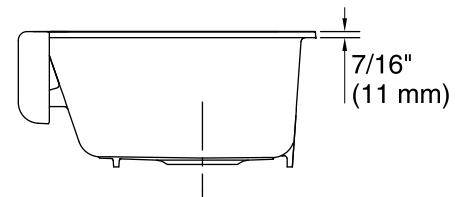
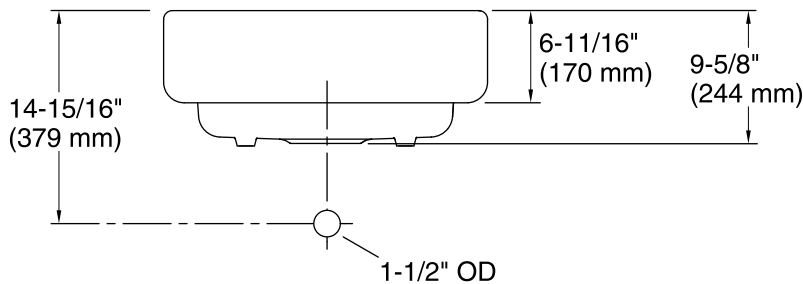
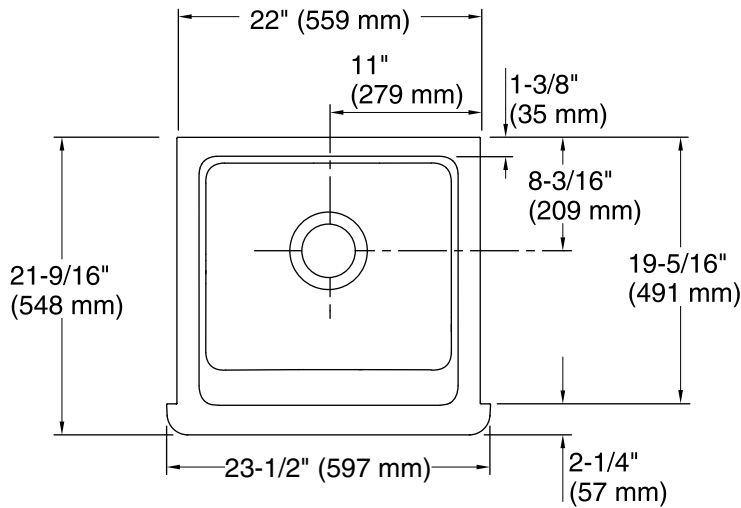

Technical Information

All product dimensions are nominal.

Bowl configuration:	Single
Installation:	Under-mount
Min. base cabinet width:	24" (610 mm)
Bowl area (Only)	Length: 18-13/16" (477 mm) Width: 18-1/16" (459 mm) Bowl depth: 9" (229 mm) Water depth: 9" (229 mm)
Drain hole:	3-5/8" (92 mm)
Template:	1247776-7, required, included 1239229-7, required, included

Notes

Install this product according to the installation instructions.