

Operator's manual

115iL



Please read the operator's manual carefully and make sure you understand the instructions before using the machine.

English

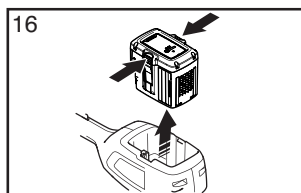
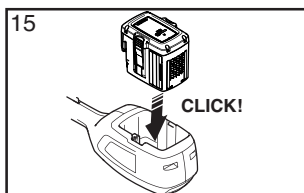
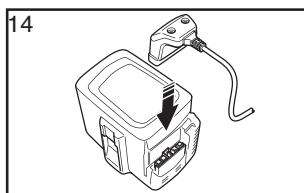
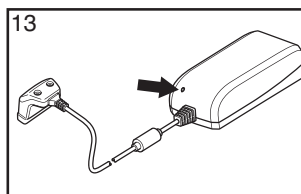
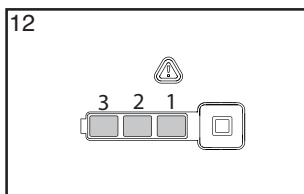
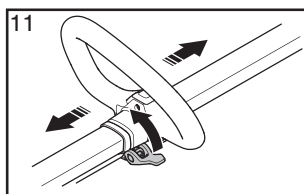
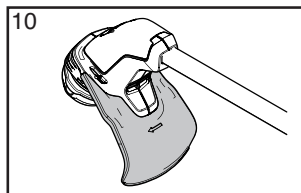
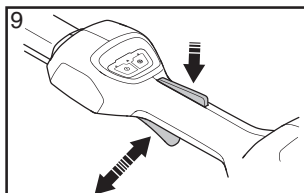
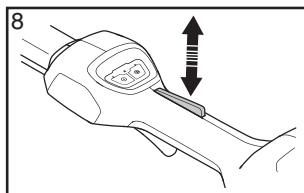
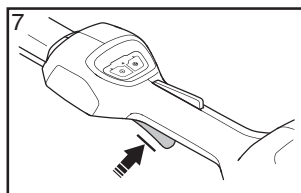
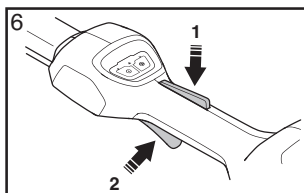
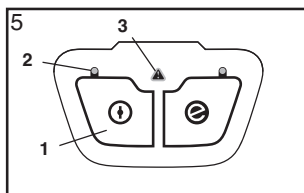
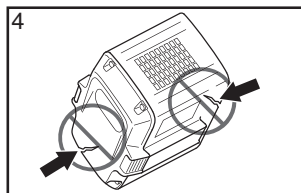
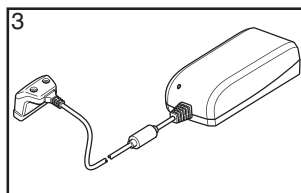
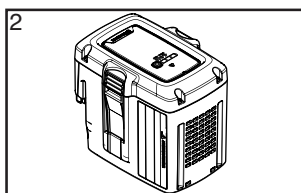
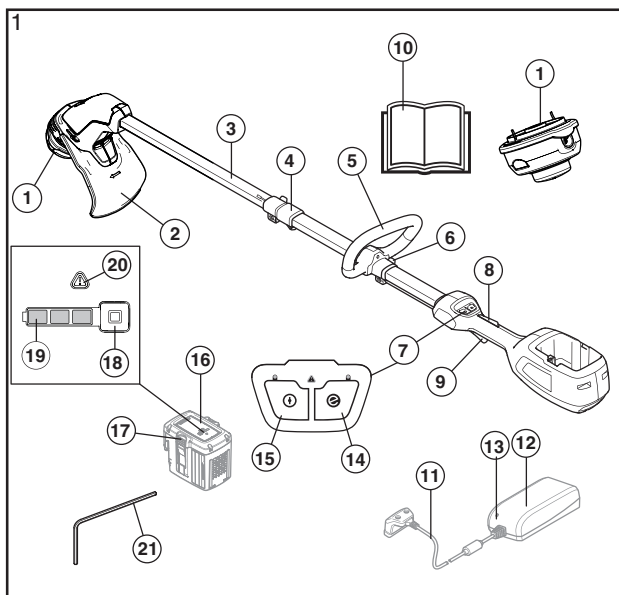

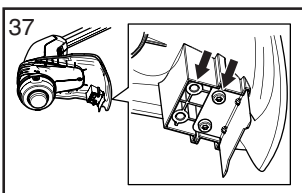
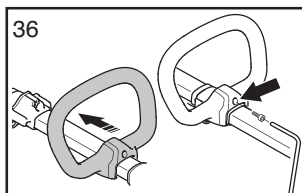
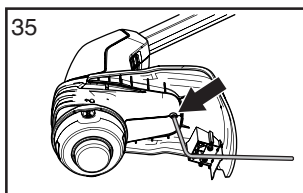
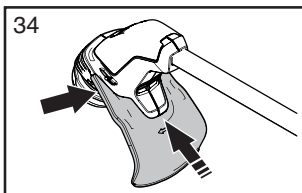
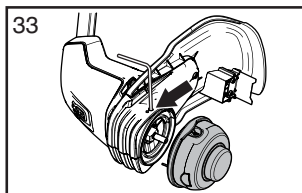
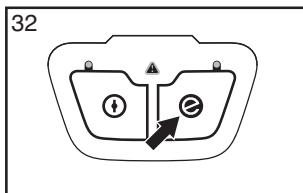
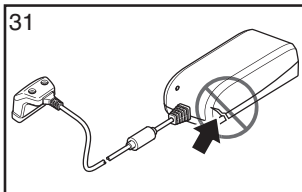
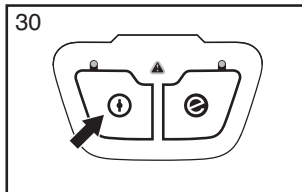
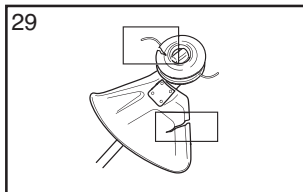
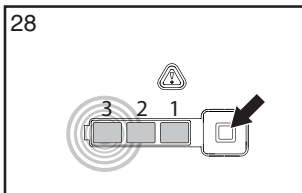
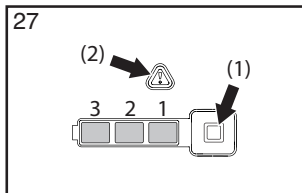
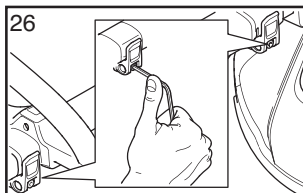
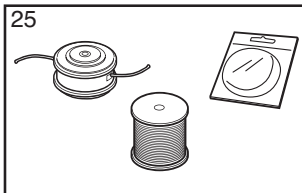
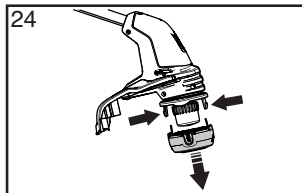
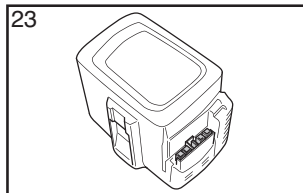
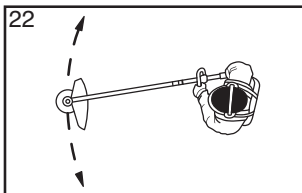
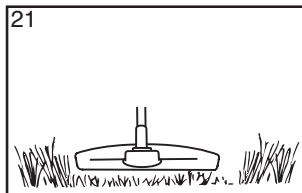
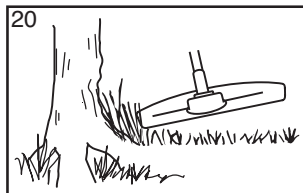
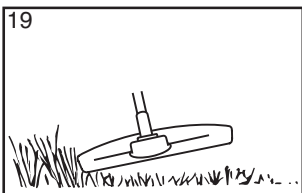

KEY TO SYMBOLS

Symbols on the machine:

Translation of the original Swedish operating instruction.

WARNING! Trimmers can be dangerous! Careless or incorrect use can result in serious or fatal injury to the operator or others. It is extremely important that you read and understand the contents of the operator's manual. Please read the operator's manual carefully and make sure you understand the instructions before using the machine.

Always wear:

- Approved hearing protection
- Approved eye protection

Max. speed of output shaft, rpm



max
5500 rpm

Keep bystanders away.



Always wear approved protective gloves.



Wear sturdy, non-slip boots.



Symbols on the product or its packaging indicate that this product cannot be handled as domestic waste. This product must be deposited at an appropriate recycling facility. (Applies to Europe only)



Watch out for thrown objects and ricochets.



Only use non-metallic, flexible cutting attachments, i.e. trimmer heads with trimmer cord.



Do not expose to rain.



Direct current.



The rating plate showing serial number. **yyyy** is the production year, **ww** is the production week.

yyyywwxxxxx

Symbols on the battery and/or on the battery charger:

This product must be deposited at an appropriate recycling facility. (Applies to Europe only)



Fail-safe transformer



Use and store battery charger only indoors.



Double insulation



Other symbols/decals on the machine refer to special certification requirements for certain markets.



WARNING

This product contains or emits a chemical known to the State of California to cause cancer or birth defects or other reproductive harm.

CONTENTS

Contents

KEY TO SYMBOLS

Symbols on the machine: 4

Symbols on the battery and/or on the battery charger: 4

CONTENTS

Contents 5

Note the following before starting: 5

INTRODUCTION

Dear customer! 6

What is what? 6

GENERAL SAFETY PRECAUTIONS

General power tool safety warnings 7

Personal protective equipment 9

Machine's safety equipment 10

Cutting equipment 10

ASSEMBLY

Trimmer guard 12

Fitting the trimmer head 12

Fitting the loop handle 12

Adjust the length of the trimmer cord 12

BATTERY HANDLING

Battery 13

Battery charger 13

Transport and storage 13

Disposal of the battery, battery charger and machine 13

STARTING AND STOPPING

Check before starting 14

Connect battery to the machine 14

Starting and stopping 14

WORKING TECHNIQUES

General working instructions 15

MAINTENANCE

Inspection and maintenance 17

Troubleshooting schedule 18

Maintenance schedule 19

TECHNICAL DATA

Technical data 20

Note the following before starting:

Please read the operator's manual carefully.

Maintenance, replacement, or repair of the emission control devices and system may be performed by any nonroad engine repair establishment or individual.



WARNING! Long-term exposure to noise can result in permanent hearing impairment. Always use hearing protection.



WARNING! Under no circumstances may the design of the machine be modified without the permission of the manufacturer. Always use genuine accessories. Non-authorized modifications and/or accessories can result in serious personal injury or the death of the operator or others.

Your warranty may not cover damage or liability caused by the use of non-authorized accessories or replacement parts.



WARNING! A lawn trimmer can be dangerous if used incorrectly or carelessly, and can cause serious or fatal injury to the operator or others. It is extremely important that you read and understand the contents of this operator's manual.

For customer assistance call: 1-800-487-5951 or visit www.usa.husqvarna.com.

INTRODUCTION

Dear customer!

Congratulations on your choice to buy a Husqvarna product! Husqvarna is based on a tradition that dates back to 1689, when the Swedish King Karl XI ordered the construction of a factory on the banks of the Huskvarna River, for production of muskets. The location was logical, since water power was harnessed from the Huskvarna River to create the water-powered plant. During over 300 years of continuous operation, the Husqvarna factory has produced a lot of different products, from wood stoves to modern kitchen appliances, sewing machines, bicycles, motorcycles etc. In 1956, the first motor driven lawn mowers appeared, followed by chain saws in 1959, and it is within this area Husqvarna is working today.

Today Husqvarna is one of the leading manufacturers in the world of forest and garden products, with quality as our highest priority. We develop, manufacture and market high quality motor driven products for forestry and gardening as well as for building and construction industry.

Your purchase gives you access to professional help with repairs and service whenever this may be necessary. If the retailer who sells your machine is not one of our authorized dealers, ask for the address of your nearest servicing dealer.

It is our wish that you will be satisfied with your product and that it will be your companion for a long time. Think of this operator's manual as a valuable document. By following its' content (using, service, maintenance etc) the life span and the second-hand value of the machine can be extended. If you ever lend or sell this machine, make sure that the borrower or buyer gets the operator's manual, so they will also know how to properly maintain and use it.

Thank you for using a Husqvarna product.

Husqvarna AB has a policy of continuous product development and therefore reserves the right to modify the design and appearance of products without prior notice.

What is what?

(Figure 1)

- 1 Trimmer head
- 2 Cutting attachment guard
- 3 Shaft
- 4 Shaft adjustment (telescope)
- 5 Loop handle
- 6 Handle adjustment
- 7 Keypad
- 8 Power trigger lockout
- 9 Power trigger
- 10 Operator's manual
- 11 Cord
- 12 Battery charger
- 13 Power on and warning indicator
- 14 SavE button
- 15 Activate and deactivate button
- 16 Battery
- 17 Battery release buttons
- 18 Battery indicator button
- 19 Battery status
- 20 Warning indicator
- 21 Allen key

GENERAL SAFETY PRECAUTIONS

General power tool safety warnings

READ ALL INSTRUCTIONS

WARNING! When using electric gardening appliances, basic safety precautions should always be followed to reduce the risk of electric shock, fire and/or serious injury including the following:

Please read the operator's manual carefully and make sure you understand the instructions before using the machine.

(Figure 1) - (Figure 37) refer to figures on pages 2-3.

- The machine is only design for trimming. Never fit metal cutting elements. Do not use the lawn trimmer for any job except that for which it is intended. The term "power tool" in the warnings refers to your mains-operated (corded) power tool or battery-operated (cordless) power tool.

Check before starting

- Always remove the battery to prevent the machine being started by accident. Always disconnect the battery before any maintenance on the machine.
- Before using the machine and after any impact, check for signs of wear or damage and repair as necessary.
- Inspect the working area. Remove all loose objects, such as stones, broken glass, nails, steel wire, string, etc. that could be thrown out or become wrapped around the cutter or cutter guard.
- Fully charge the battery before using it the first time. See instructions under the heading Charging the battery.
- The machine operator must ensure that no people or animals come closer than 15 metres while working. When several operators are working in the same area the safety distance should be at least 15 metres.
- Do an overall inspection of the machine before use, see maintenance schedule.

Work area safety

- **Keep work area clean and well lit.** Cluttered or dark areas invite accidents.
- **Do not operate power tools in explosive atmospheres, such as in the presence of flammable liquids, gases or dust.** Power tools create sparks which may ignite the dust or fumes.
- Do not use in rain.
- **Keep children and bystanders away while operating a power tool.** Distractions can cause you to lose control.

Electrical safety

- **Power tool plugs must match the outlet. Never modify the plug in any way. Do not use any adapter plugs with earthed (grounded) power**

tools. Unmodified plugs and matching outlets will reduce the risk of electric shock.

- **Avoid body contact with earthed or grounded surfaces, such as pipes, radiators, ranges and refrigerators.** There is an increased risk of electric shock if your body is earthed or grounded.
- **Do not expose power tools to rain or wet conditions.** Water entering a power tool will increase the risk of electric shock.

Avoid dangerous environment. Do not use appliances in a damp or wet locations. Use right appliance, do not use appliance for any job except that for which it is intended.

- **Do not abuse the cord. Never use the cord for carrying, pulling or unplugging the power tool. Keep cord away from heat, oil, sharp edges or moving parts.** Damaged or entangled cords increase the risk of electric shock.
- **When operating a power tool outdoors, use an extension cord suitable for outdoor use.** Use of a cord suitable for outdoor use reduces the risk of electric shock.
- **If operating a power tool in a damp location is unavoidable, use a ground fault circuit interrupter (GFCI) protected supply.** Use of an GFCI reduces the risk of electric shock.

Personal safety

- **Stay alert, watch what you are doing and use common sense when operating a power tool. Do not use a power tool while you are tired or under the influence of drugs, alcohol or medication.** A moment of inattention while operating power tools may result in serious personal injury.
- **Use personal protective equipment. Always wear eye protection.** Protective equipment such as dust mask, non-skid safety shoes, hard hat, or hearing protection used for appropriate conditions will reduce personal injuries.
- **Prevent unintentional starting. Ensure the switch is in the OFF-position before connecting to power source and/or battery pack, picking up or carrying the tool.** Carrying power tools with your finger on the switch or energising power tools that have the switch on invites accidents.
- **Remove any adjusting key or wrench before turning the power tool on.** A wrench or a key left attached to a rotating part of the power tool may result in personal injury.
- **Do not overreach. Keep proper footing and balance at all times.** This enables better control of the power tool in unexpected situations.
- **Dress properly. Do not wear loose clothing or jewellery. Keep your hair, clothing and gloves away from moving parts.** Loose clothes, jewellery or long hair can be caught in moving parts.
- **If devices are provided for the connection of dust extraction and collection facilities, ensure that**

GENERAL SAFETY PRECAUTIONS

these are connected and properly used. Use of dust collection can reduce dust-related hazards.

- The vibration emission during actual use of the power tool can differ from the declared total value depending on the ways in which the tool is used. Operators should identify safety measures to protect themselves that are based on an estimation of exposure in the actual conditions of use (taking account of all parts of the operating cycle such as the times when the tool is switched off and when it is running idle in addition to the trigger).

Power tool use and care

- **Do not force the power tool. Use the correct power tool for your application.** The correct power tool will do the job better and safer at the rate for which it was designed.
- **Do not use the power tool if the switch does not turn it on and off.** Any power tool that cannot be controlled with the switch is dangerous and must be repaired.
- **Disconnect the plug from the power source and/or the battery pack from the power tool before making any adjustments, changing accessories, or storing power tools.** Such preventive safety measures reduce the risk of starting the power tool accidentally.
- **Store idle power tools out of the reach of children and do not allow persons unfamiliar with the power tool or these instructions to operate the power tool.** Power tools are dangerous in the hands of untrained users.
- **Maintain power tools. Check for misalignment or binding of moving parts, breakage of parts and any other condition that may affect the power tool's operation. If damaged, have the power tool repaired before use.** Many accidents are caused by poorly maintained power tools.
- **Keep cutting tools sharp and clean.** Properly maintained cutting tools with sharp cutting edges are less likely to bind and are easier to control.
- **Use the power tool, accessories and tool bits etc. in accordance with these instructions, taking into account the working conditions and the work to be performed.** Use of the power tool for operations different from those intended could result in hazardous situations.

Battery tool use and care

- **Recharge only with the charger specified by the manufacturer.** A charger that is suitable for one type of battery pack may create a risk of fire when used with another battery pack.
- **Use power tools only with specifically designated battery packs.** Use of any other battery packs may create a risk of injury and fire.
- **When battery pack is not in use, keep it away from other metal objects, like paper clips, coins, keys, nails, screws or other small metal objects, that**

can make a connection from one terminal to another. Shorting the battery terminals together may cause burns or a fire.

- **Under abusive conditions, liquid may be ejected from the battery; avoid contact. If contact accidentally occurs, flush with water. If liquid contacts eyes, additionally seek medical help.** Liquid ejected from the battery may cause irritations or burns.

Service

- **Have your power tool serviced by a qualified repair person using only identical replacement parts.** This will ensure that the safety of the power tool is maintained.

Always remove battery pack before:

- Whenever the machine is left by user.
- Before clearing a blockage.
- Always disconnect the battery before any maintenance on the machine.
- If any foreign object is hit or if vibrations occur stop the machine immediately. Remove the battery from the machine and check that the machine is not damaged. If the machine starts to vibrate abnormally, immediately check.

GENERAL SAFETY PRECAUTIONS

IMPORTANT!

The cutting tool does not stop immediately after the machine is turned off.

This appliance is not intended for use by person (including children) with reduced physical, sensory or mental capabilities, or lack of experience and knowledge, unless they have been given supervision or instruction concerning use of the appliance by a person responsible for their safety. Children should be supervised to ensure that they do not play with the appliance.

Never allow children or other persons not trained in the use of the machine and/or the battery to use or service it. Local laws may regulate the age of the user.

Store the equipment in a lockable area so that it is out of reach of children and unauthorized persons.

Keep hands and feet away from the cutting area at all times and especially when switching on the motor.

Make sure all safety guards are in place and in good condition.

Never use the machine if you are tired, if you have drunk alcohol, or if you are taking medication that could affect your vision, your judgement or your co-ordination.

Wear personal protective equipment. See instructions under the heading "Personal protective equipment".

Turn off the machine when it has to be moved. Always remove the battery when passing the machine to another person.

The only accessories you can operate with this product are the cutting attachment we recommend in the technical data chapter.

Never use a machine that has been modified in any way from its original specification. Never use the machine near explosive or flammable materials.

Never use a machine that is faulty. Carry out the safety checks, maintenance and service instructions described in this manual. Some maintenance and service measures must be carried out by trained and qualified specialists. See instructions under the heading Maintenance. Only use original spare parts.

Always ensure that ventilation openings are kept clear of debris.

All covers, guards and handles must be fitted before starting. Only use the machine in daylight or in other well-lit conditions.

Never use the machine in bad weather, for instance in fog, in rain, damp or in wet locations, strong winds, intense cold, risk of lightning, etc. Extremely hot weather may cause overheating of the machine.

Always use common sense

It is not possible to cover every conceivable situation you can face. Always exercise care and use your common sense. Avoid all situations which you consider to be

beyond your capability. If you still feel uncertain about operating procedures after reading these instructions, you should consult an expert before continuing.

Important



WARNING! This machine produces an electromagnetic field during operation. This field may under some circumstances interfere with active or passive medical implants. To reduce the risk of serious or fatal injury, we recommend persons with medical implants consult their physician and the medical implant manufacturer before operating this machine.



WARNING! Never allow children to use or be in the vicinity of the machine. Since the machine is easy to start, children may be able to start it if they are not kept under full surveillance. This can mean a risk of serious personal injury. Therefore disconnect the battery when the machine is not under close supervision.

Personal protective equipment

IMPORTANT!

A lawn trimmer can be dangerous if used incorrectly or carelessly, and can cause serious or fatal injury to the operator or others. It is extremely important that you read and understand the content of this operator's manual.

You must use approved personal protective equipment whenever you use the machine. Personal protective equipment cannot eliminate the risk of injury but it will reduce the degree of injury if an accident does happen. Ask your dealer for help in choosing the right equipment.



WARNING! Listen out for warning signals or shouts when you are wearing hearing protection. Always remove your hearing protection as soon as the motor stops.



WARNING! There is a risk of burns as the gear housing can become very hot. Use gloves when working with the trimmer head.

Always wear:

- Hearing protection
- Protective goggles or a visor
- Gloves should be worn when necessary, e.g., when fitting cutting attachments.
- Wear sturdy, non-slip boots.

GENERAL SAFETY PRECAUTIONS

- Wear clothes made of a strong fabric and avoid loose clothing that can catch on twigs and branches. Always wear heavy, long pants. Do not wear jewellery, shorts sandals or go barefoot. Secure hair so it is above shoulder level.
- Always have a first aid kit nearby.

Machine's safety equipment

This section describes the machine's safety equipment, its purpose, and how checks and maintenance should be carried out to ensure that it operates correctly. See the "What is what?" section to locate where this equipment is positioned on your machine.

The life span or the runtime of the machine can be reduced and the risk of accidents can increase if machine maintenance is not carried out correctly and if service and/or repairs are not carried out professionally. If you need further information please contact your nearest service workshop.

IMPORTANT!

All servicing and repair work on the machine requires special training. This is especially true of the machine's safety equipment. If your machine fails any of the checks described below you must contact your service agent. When you buy any of our products we guarantee the availability of professional repairs and service. If the retailer who sells your machine is not a servicing dealer, ask him for the address of your nearest service agent.



WARNING! Never use a machine with faulty safety equipment. The machine's safety equipment must be checked and maintained as described in this section. If your machine fails any of these checks contact your service agent to get it repaired.

Keypad

Make sure the machine is switched on or off when the activate/deactivate button (1) is pressed and held (>1 sec.). The green LED (2) is lit or turned off.

Flashing warning indicator (3) and green LED (2) is lit could indicate that: (Figure 5)

- it is not possible to apply full power and, at the same time, activate the machine. Release the power trigger and the machine is active.
- the machine is blocked. Deactivate the machine. Disconnect the battery. Remove the grass or other material that is wrapped around the trimmer head.
- the machine is overloaded due to heavy trimming. Release the power trigger and the machine is active.

If the warning symbol (3) flashes, it indicates that the machine is too hot and the machine deactivates. When the machine is restored to normal temperature it is again ready to run.

Solid light indicates service.

Power trigger lockout

The power trigger lockout is designed to prevent accidental operation of the power trigger. When you press the lock (1) (i.e. when you grasp the handle) it releases the power trigger (2). When you release the handle the power trigger and the power trigger lockout both move back to their original positions. This movement is controlled by two independent return springs. (Figure 6)

Make sure the power trigger is locked when the power trigger lock is in its original position. (Figure 7)

Press the power trigger and make sure it returns to its original position when you release it. (Figure 8)

Check that the power trigger and the power trigger lockout move freely and that the return spring works properly. (Figure 9) See instructions under the heading Start. Start the machine and apply full power. Release the power trigger and check that the cutting attachment stops and remain at a standstill.

Cutting attachment guard

This guard is intended to prevent loose objects from being thrown towards the operator. The guard also protects the operator from accidental contact with the cutting attachment. (Figure 10)

Check that the guard is undamaged and not cracked. Replace the guard if it has been exposed to impact or is cracked.

Always use the recommended guard for the cutting attachment you are using. See chapter on Technical data.



WARNING! Never use a cutting attachment without an approved guard. See the chapter on Technical data. If an incorrect or faulty guard is fitted this can cause serious personal injury.



WARNING! This machine is renowned for its low vibration load. Overexposure to vibration can lead to circulatory damage or nerve damage in people who have impaired circulation. Contact your doctor if you experience symptoms of overexposure to vibration. These symptoms include numbness, loss of feeling, tingling, pricking, pain, loss of strength, changes in skin colour or condition. These symptoms normally appear in the fingers, hands or wrists.

Cutting equipment

This section describes how to choose and maintain your cutting equipment in order to:

- Obtain maximum cutting performance.
- Extend the life of cutting equipment.

GENERAL SAFETY PRECAUTIONS

IMPORTANT!

Only use cutting attachments with the guards we recommend! See the chapter on Technical data.

Refer to the instructions for the cutting attachment to check the correct way to load the line and the correct line diameter.

Always remove the battery before you work on any part of the cutting equipment. It continues to rotate even after the throttle control has been released. Check that the cutting equipment has stopped completely and remove the battery before you start any work on it.

Trimmer head



WARNING! Always use recommended trimmer line. See technical data. Failure to follow this instruction may cause personal injury.

IMPORTANT!

Always ensure the trimmer line is wound tightly and evenly around the drum, otherwise the machine will generate harmful vibration.

- Only use the recommended trimmer heads and trimmer lines. These have been tested by the manufacturer to suit a particular motor size. This is especially important when a fully automatic trimmer head is used. Only use the recommended cutting attachment. See the chapter on Technical data. (Figure 25)
- Smaller machines generally require small trimmer heads and vice versa. This is because when clearing using a cord the engine must throw out the cord radially from the trimmer head and overcome the resistance of the grass being cleared.
- The length of the cord is also important. A longer cord requires greater engine power than a shorter cord of the same diameter.
- Make sure that the cutter on the trimmer guard is intact. This is used to cut the cord to the correct length.
- To increase the life of the cord it can be soaked in water for a couple of days before use. This will make the cord tougher so that it lasts longer. Different line lengths can result in unnecessary vibrations. Tap the trimmer head to get correct lengths on the line.
- To increase the life of the line it can be soaked in water for a couple of days. This will make the line tougher so that it lasts longer.

SAVE THESE INSTRUCTIONS

Trimmer guard

- Slide the trimmer guard into the trimmer head.
(**Figure 34**)
- Fasten the trimmer guard onto the housing to the trimmerhead. (**Figure 35**)

Fitting the trimmer head

- Turn the output shaft until one of the holes in the drive disc aligns with the corresponding hole in the gear housing.
- Insert the locking pin into the hole to lock the axle.
- Screw on the trimmer head in the opposite direction to the direction of rotation.
- To dismantle, follow the instructions in the reverse order. (**Figure 33**)

Fitting the loop handle

- Fit the screw into the loop handle.
- Slide the loop handle into the fitting on the shaft.
- Tighten the screw that secures the loop handle.
(**Figure 36**)
- Now adjust the trimmer to give a comfortable working position. (**Figure 11**)

Adjust the length of the trimmer cord

- Make sure that the cutter on the trimmer guard is intact. This is used to cut the cord to the correct length.
- When using trimmer head, make sure the trimmer line have correct length and is cut by the guard knife.
- Adjust the length of the trimmer cord by moving the cutter on the trimmer guard. The cutter has two different adjustment positions on the trimmer guard.
(**Figure 37**)

BATTERY HANDLING

Battery

The display shows the battery capacity and if there are any problems with the battery. The battery capacity is displayed for 5 seconds after the machine is switched off or the battery indicator button (1) is pressed. The warning symbol on the battery is lit when an error has occurred (2). See fault codes. (Figure 27)

LED lights	Battery status
All LEDs are lit	Fully charged (67%–100%).
LED 1, LED 2 are lit.	The battery is 34%-66% charged.
LED 1 is lit.	The battery is 1%-33% charged.
LED 1 flashes.	The battery is empty. Charge the battery.

Battery charger



WARNING! Risk of electric shock and short circuiting. Use approved and intact wall sockets. Make sure that the cable is not damaged. Replace cable if it appears to be damaged in any way. Carry the hedge trimmer by the handle with the cutter blade stopped.

Connect the battery charger

- Connect the battery charger to the voltage and frequency specified on the rating plate.
- The battery will not be charged if the battery temperature is over 50 °C (122 °F).

Connect the battery to the battery charger.

Regularly check that the battery charger and the battery are intact. See instructions under the heading Maintenance.

The battery must be charged before using it the first time. The battery is only 30% charged when delivered.

- Connect the battery to the battery charger. (Figure 14)
- The green charging light on the charger is lit when the battery is connected to the battery charger. The charging process is ongoing. (Figure 13)
- When all the LEDs are lit on the battery, it is fully charged. (Figure 12)
- Pull out the plug. Never jerk the power supply cable to disconnect it from the wall socket.
- Disconnect the charger from the battery.

Charging status

Lithium-ion batteries can be charged at whatever charging level. The charging process can be cancelled or

started whatever the battery's charge level is. A fully charged battery will not lose its charge even when the battery is left in the charger. (Figure 28)

Transport and storage

- The contained lithium-ion batteries are subject to the Dangerous Goods Legislation requirements.
- For commercial transports e.g. by third parties, forwarding agents, special requirement on packing and labeling must be observed.
- For preparation of the item being shipped, consulting an expert for hazardous material is required. Please also observe possibly more detailed national regulations.
- Tape or mask off open contacts and pack up the battery in such a manner that it cannot move around in the packing.
- Always remove the battery for storage or transport.
- Store the battery and the battery charger in a dry, moisture-free and frost-free space.
- Do not store the battery in places where static electricity can occur. Never store the battery in a metal box.
- Store the battery where the temperature is between 5 °C (41 °F) and 25 °C (77 °F) and never in direct sunlight.
- Store the battery charger where the temperature is between 40 °F and 113 °F and never in direct sunlight.
- Store the battery charger only in an enclosed and dry space.
- Be sure to store the battery separate from the battery charger. Store the equipment in a lockable area so that it is out of reach of children and unauthorized persons.
- Ensure the machine is cleaned and that a complete service is carried out before long-term storage.
- Secure the machine during transport.

Disposal of the battery, battery charger and machine

Symbols on the product or its packaging indicate that this product cannot be handled as domestic waste. It must instead be submitted to an appropriate recycling station for the recovery of electrical and electronic equipment.

By ensuring that this product is taken care of correctly, you can help to counteract the potential negative impact on the environment and people that can otherwise result through the incorrect waste management of this product. For more detailed information about recycling this product, contact your municipality, your domestic waste service or the shop from where you purchased the product.

STARTING AND STOPPING

Check before starting

- Check the product for dirt and cracks. Clean off grass and leaves from the motor housing using a brush. Gloves should be worn when necessary.
- Check that the trimmer head is completely attached to the trimmer.
- Check that the machine is in perfect working order. Check that all nuts and screws are tight.
- Check that the trimmer head and trimmer guard are not damaged or cracked. Replace the trimmer head or trimmer guard if they have been exposed to impact or are cracked. (Figure 29)
- Never use the machine without a guard nor with a defective guard.
- All covers must be correctly fitted and undamaged before you start the machine.
- Only use the machine for the purpose it was intended for.

Connect battery to the machine

Make sure to use fully charged batteries. Use only a Husqvarna original battery in your machine. See technical data.

- Insert the battery in the machine. The battery should slide easily into the battery holder on the machine. If the battery does not slide in easily, it is not being inserted correctly. The battery will lock itself into place when you hear a click. Make sure the battery is fitted correctly to the machine. (Figure 15)

Starting and stopping



WARNING! Make sure no unauthorised persons are in the working area, otherwise there is a risk of serious personal injury. The safety distance is 15 meters (50 ft.).

Starting

Turn on the machine. Press and hold the start button (>1 sec.) until the green LED is lit. (Figure 30)

Press power trigger lockout and then press power trigger and the cutting equipment will start rotate.

Stopping

Stop the machine by releasing the power trigger and deactivate the machine.

Remove the battery from the machine by pressing the two release buttons and pulling out the battery. (Figure 16)

IMPORTANT! Always remove the battery to prevent the machine being started by accident.

WORKING TECHNIQUES

General working instructions

IMPORTANT!

This section takes up the basic safety precautions for working with a lawn trimmer.

If you encounter a situation where you are uncertain how to proceed you should ask an expert. Contact your dealer or your service workshop.

Avoid all usage which you consider to be beyond your capability.



WARNING! The machine can cause serious personal injury. Read the safety instructions carefully. Learn how to use the machine.



WARNING! Always disconnect the battery before any maintenance on the machine.

Basic safety rules

Wear personal protective equipment. See instructions under the heading "Personal protective equipment".

- 1 Look around you:
 - To ensure that people, animals or other things cannot affect your control of the machine.
 - To ensure that people, animals, etc., do not come into contact with the cutting attachment or loose objects that are thrown out by the cutting attachment.
 - CAUTION! Do not use the machine unless you are able to call for help in the event of an accident. Ensure that no-one comes closer than 15 m while you are working.
- 2 Inspect the working area. Remove all loose objects, such as stones, broken glass, nails, steel wire, string, etc. that could be thrown out or become wrapped around the cutting attachment.
- 3 Never use the machine in bad weather, for instance in fog, in rain, strong winds, intense cold, etc. Working in bad weather is tiring and can lead to dangerous conditions, e.g. slippery surfaces.

Safety instructions while working

- Make sure you can move and stand safely. Check the area around you for possible obstacles (roots, rocks, branches, ditches, etc.) in case you have to move suddenly. Take great care when working on sloping ground. (Figure 17)
- Do not overreach. Keep proper footing and balance at all times.
- Always be sure of the footing on slopes and to walk, never run.
- Always hold the machine with both hands. Hold the machine on the right side of your body. (Figure 18) Don't force the machine. It will do the job better and

with less likelihood of a risk of injury at the rate for which it was designed.

- Keep all parts of your body away from the rotating cutting attachment. Keep the cutting attachment below waist level.
- Turn off the machine when it has to be moved. Always remove the battery when passing the machine to another person.
- Never put the machine down without turning it off first and always remove the battery.
- If any foreign object is hit or if vibrations occur stop the machine immediately. Remove the battery from the machine and check that the machine is not damaged.
- If any unwanted vibrations occur, tap out new line to give the line the correct length and the vibrations should stop.
- Release the power trigger after each working operation to save battery power.
- Make sure that ventilation openings on the trimmer housing are kept clear of grass and debris.



WARNING! Neither the operator of the machine nor anyone else may attempt to remove the cut material while the motor is running or the cutting attachment is rotating, as this can result in serious injury.

Turn off the machine and remove the battery before removing materials that are wound around the trimmer head as otherwise there is risk of injury. The bevel gear can get hot during use and may remain so for a while afterwards. You could get burnt if you touch it.



WARNING! Watch out for thrown objects. Always wear approved eye protection. Never lean over the cutting attachment guard. Stones, rubbish, etc. can be thrown up into the eyes causing blindness or serious injury.

Keep unauthorized persons at a distance. Children, animals, onlookers and helpers should be kept outside the safety zone of 15 m. (50 ft.) Stop the machine immediately if anyone approaches. Never swing the machine around without first checking behind you to make sure no-one is within the safety zone.

Loop handle and shaft adjustment (telescop shaft)

- Loosen the locking handle and adjust the handle to the correct position. (Figure 11)

WORKING TECHNIQUES

- Loosen the lock on the shaft and set the desired length on the shaft and lock.

Safety instructions after completing work

- Make sure the cutting attachment has stopped before cleaning, carrying out repairs or an inspection. Disconnect the battery.

SavE mode

The machine is equipped with a battery saving function (SavE). Activate the function by pressing the SavE button. A green LED will light to indicate that the function is on.

In most cases SavE mode is the most optimum when trimming and gives longest runtime. Release the power trigger after each working operation to save battery power. (Figure 32)

Automatic switch off functionality

The machine is equipped with a shutdown feature that deactivates the machine if not used. The green LED will be extinguished and the machine turned off after 45 seconds.

Grass trimming with a trimmer head



WARNING! Sometimes branches or grass get caught between the guard and cutting attachment. Always remove the battery before cleaning.

Trimming

- Hold the trimmer head just above the ground at an angle. It is the end of the cord that does the work. Let the cord work at its own pace. Never press the cord into the area to be cut. (Figure 19)
- The cord can easily remove grass and weeds up against walls, fences, trees and borders, however it can also damage sensitive bark on trees and bushes, and damage fence posts.
- Reduce the risk of damaging plants by shortening the cord to 10-12 cm and reducing the engine speed.

Clearing

- The clearing technique removes all unwanted vegetation. Keep the trimmer head just above the ground and tilt it. Let the end of the cord strike the ground around trees, posts, statues and the like. CAUTION! This technique increases the wear on the cord. (Figure 20)
- The cord wears quicker and must be fed forward more often when working against stones, brick, concrete, metal fences, etc., than when coming into contact with trees and wooden fences.
- When trimming and clearing you should use less than full throttle (80%) so that the cord lasts longer and to reduce the wear on the trimmer head.

Cutting

- The trimmer is ideal for cutting grass that is difficult to reach using a normal lawn mower. Keep the cord parallel to the ground when cutting. Avoid pressing the trimmer head against the ground as this can ruin the lawn and damage the tool. (Figure 21)
- Do not allow the trimmer head to constantly come into contact with the ground during normal cutting. Constant contact of this type can cause damage and wear to the trimmer head.

Sweeping

- The fan effect of the rotating cord can be used for quick and easy clearing up. Hold the cord parallel to and above the area to be swept and move the tool side to side. (Figure 22)
- When cutting and sweeping you should use full throttle to obtain the best results.

MAINTENANCE

Inspection and maintenance



WARNING! Always disconnect the battery before any maintenance on the machine. Carry the hedge trimmer by the handle with the cutter blade stopped.

IMPORTANT! Never clean the battery or the battery charger with water. Strong cleaning agents can damage the plastic.

All servicing and repair work on the machine requires special training. This is especially true of the machine's safety equipment. If your machine fails any of the checks described below you must contact your service agent. When you buy any of our products we guarantee the availability of professional repairs and service. If the retailer who sells your machine is not a servicing dealer, ask him for the address of your nearest service agent. Only use original spare parts. **(Figure 31)**

Regularly check that the battery charger and the battery are intact. **(Figure 4)**

Cleaning

Clean the machine after use.

To avoid unbalance and vibrations in handles trimmer head need to be cleaned regularly. In addition, check other part of the head and the shaft if needed to be cleaned.

Make sure the battery and battery charger are clean and that the terminals on the battery and the battery charger are always clean and dry before the battery is placed in the battery charger. Keep the battery guide tracks clean.

Clean plastic parts with a clean and dry cloth. **(Figure 34) (Figure 23)**

Shaft adjustment (telescope)

The lever on the shaft for locking the shaft can be adjusted.

- Use the Allen key to tighten the screw that holds the shaft adjustment. **(Figure 26)**

Trimmer line

Only use the recommended trimmer heads and trimmer lines. These have been tested by the manufacturer to suit a particular motor size. This is especially important when a fully automatic trimmer head is used. Only use the recommended cutting attachment. See the chapter on Technical data.

Trimmer head

Check that the trimmer head is undamaged and not cracked. Replace the trimmer head if necessary. **(Figure 24)**

- Pull out the line chute assembly.
- Replace the trimmer head.
- Fit the trimmer head.

Replace the trimmer head.

- Insert the locking pin (C) in the hole to lock the shaft. **(Figure 33)**
- Screw the trimmer head counterclockwise.
- Fit the trimmer head.

MAINTENANCE

Troubleshooting schedule

Troubleshooting takes place from the keypad.

Keypad

Keypad	Possible faults	Possible action
Warning indicator flashing. No. 3 in figure (5).	Overload.	The trimmerhead is jammed.
		Remove the battery from the machine. Release the trimmer head from grass.
	Temperature deviation.	Allow the machine to cool down.
The machine does not start	Dirt in battery connectors.	Clean with compressed air or a soft brush.
	The power trigger and the activate button are pressed at the same time.	Release the power trigger and the machine is active.
Warning indicator lit. No. 3 in figure (5).	Service	Contact your service agent.

Troubleshooting the battery and/or the battery charger during charging.

Battery

LED display	Possible faults	Possible action
Warning indicator flashing. No. 3 in figure (27).	Temperature deviation.	Use the battery in surroundings where temperatures are between -10 °C (14 °F) and 40 °C (104 °F).
	Over voltage.	Check that the mains voltage corresponds with that stated on the rating plate on the machine.
		Remove the battery from the battery charger.
	Under voltage	Charge the battery.
Warning indicator lit. No. 3 in figure (27).	Cell difference too much (1V).	Contact your service agent.

Battery charger

LED display	Possible faults	Possible action
Error LED flashing	Temperature deviation.	Use the battery charger only when the surrounding temperature is between 5 °C (41 °F) and 40 °C (104 °F).
Red LED on	Cell difference too much (1V).	Contact your service agent.

MAINTENANCE

Maintenance schedule



WARNING! Always disconnect the battery before any maintenance on the machine. Carry the hedge trimmer by the handle with the cutter blade stopped.

The following is a list of the maintenance that must be performed on the machine. Most of the items are described in the Maintenance section.

Maintenance	Daily Maintenance	Weekly maintenance	Monthly maintenance
Clean the outside of the machine with a clean and dry cloth. Never use water.	X		
Keep handles dry, clean and free from oil and grease.	X		
Make sure that the activate and deactivate button works correctly and is not damaged.	X		
Make sure that the power trigger lock and the power trigger function works correctly from a safety point of view.	X		
Check that all controls are undamaged and in working order.	X		
Check that the guard is undamaged and not cracked. Replace the guard if it has been exposed to impact or is cracked.	X		
Check that the trimmer head is undamaged and not cracked. Replace the trimmer head if necessary.	X		
Check that nuts and screws are tight.	X		
Check that the battery is intact.	X		
Check the battery's charge.	X		
Check that the battery charger is intact and functional.	X		
Check the connections between the battery and the machine and also check the connection between battery and the battery charger.			X

TECHNICAL DATA

Technical data

	115iL	
Platform	T100UL	
Motor		
Motor type	BLDC	
Speed of output shaft, rpm	5500	
Cutting width, inch/mm	13/330	14/355
Weight		
Weight without battery, Lbs/kg	7,39/3,35	
Weight with battery, Lbs/kg	10,1/4,6	
Battery runtime		
Battery runtime, min, (free run) with SavE activated	97	

Approved batteries for 115iL.		
Battery	BLi20	
Type	Lithium-ion	
Battery capacity, Ah	4.2 (VTC4)	4 (HD2)
Voltage, V	36	36.5
Weight, lb/kg	2.6/1.2	2.6/1.2

Approved chargers for the specified batteries, BLi.	
Battery charger	QC80
Input Voltage, V	100-240
Frequency, Hz	50-60
Power, W	100
Output Voltage, V d.c. / Amps, A	36/2

Accessories	Type	Cutting attachment guard, Art. no.
115iL Trimmer head	(2,0 mm cord)	582 51 25-01

115iL Trimmer head

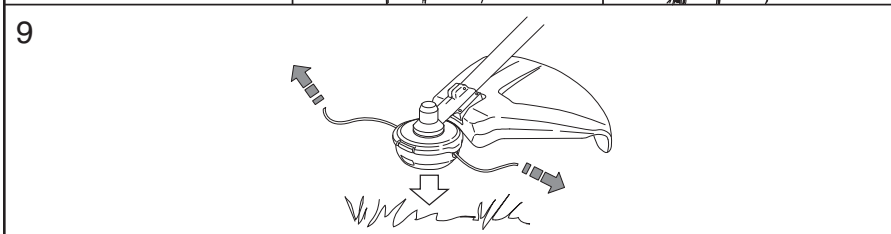
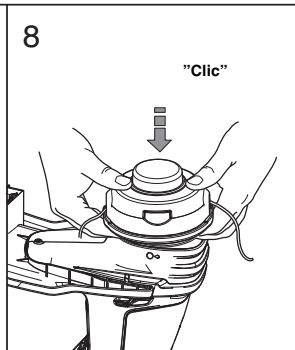
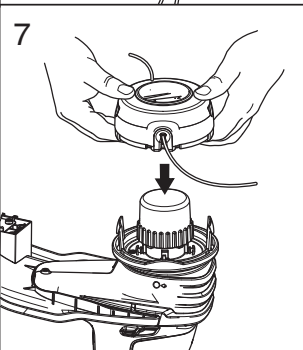
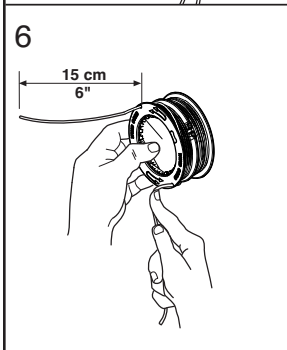
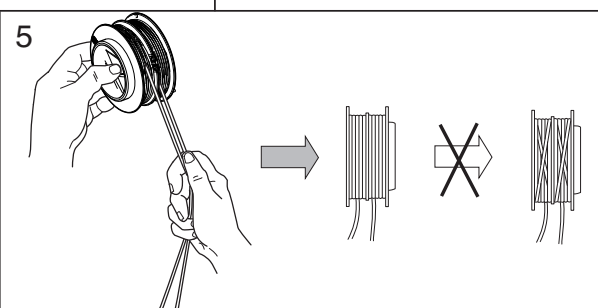
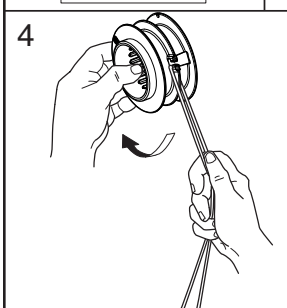
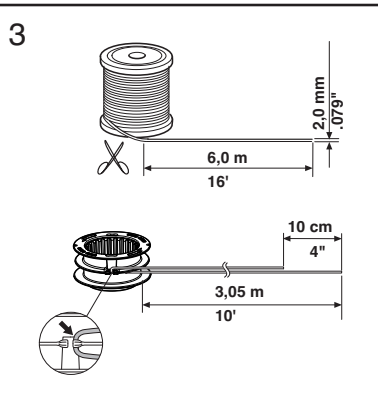
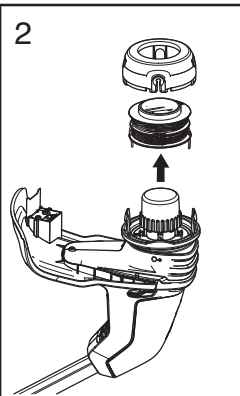
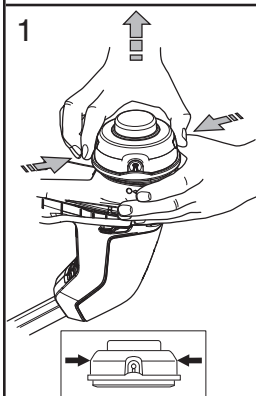

Husqvarna AB
SE-561 82 Huskvarna
Visiting address: Drottninggatan 2

1158312-95



2016-12-20