

Examine all packaging material for small parts that may have come loose during shipment. Periodic checks are recommended to insure that all components are in proper position, tight and free from damage. Keep this assembly instruction for future reference. Adult assembly is required. Customer Service Phone Number: 502-562-0000

**HARDWARE LIST**

- A (6) Allen Bolts  $\frac{3}{16}$ " x  $\frac{3}{8}$ "
- C (6) Allen Bolts  $\frac{1}{4}$ " x  $\frac{1}{2}$ "
- D (6) Counter Bolts  $\frac{1}{4}$ " x 1"
- E (5) Allen Bolts  $\frac{3}{16}$ " x  $1\frac{1}{2}$ "
- F (2) Counter Bolts  $\frac{1}{4}$ " x  $1\frac{1}{2}$ "
- G (11) Spring Washers  $\frac{1}{4}$ "
- H (11) Flat Washers  $\frac{1}{4}$ "
- J (1) Allen Wrench  $\frac{1}{4}$ "

**PARTS LIST**

- K (1) Top Rear Panel
- L (2) Side Arms
- M (2) Top Shelves
- N (1) Slate Top
- P (1) Top Support
- R (1) Lower Rear Panel
- S (2) Front Legs
- T (1) Bottom Shelf

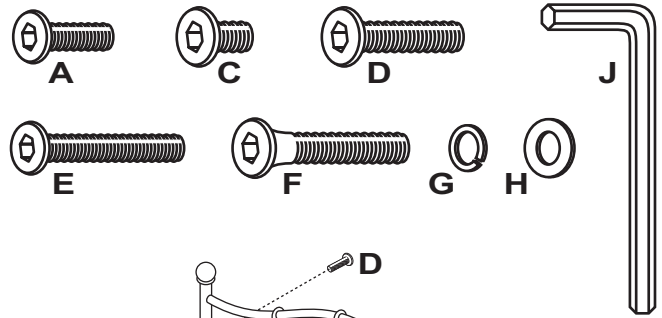

**STEP 1**

Begin assembly by attaching each Side Arm (L) to the Top Rear Panel (K) by aligning with the hole at the top and securing from the back with 1 Allen Bolt (D) to hold in place. Do not fully tighten bolts for this step.

**STEP 2**

Next attach each Top Shelf (M) to the Top Rear Panel (K) by aligning holes and securing from the back also using the Allen Bolts (D) to hold in place. Do not fully tighten bolts.

**STEP 3**

Secure the front side of the Top Shelves to the inside of each Side Arm (L) using the Allen Bolts (A) from the bottom to secure in place. Fully tighten all bolts from Steps 1 through 3 using the Allen Wrench (J) that has been provided.

**STEP 4**

Attach each Front Leg (S) to the bottom of the Top Support (P) with 2 Allen Bolts (C), 2 Spring Washers (G) & 2 Flat Washers (H) per each side. Do not fully tighten bolts.

**STEP 5**

Next attach the Top Support (P) to the top of the Lower Rear Panel (R) by setting in place and securing one hole with 1 Allen Bolt (C), 1 Spring Washer (G) & 1 Flat Washer (H) to secure in place. Do not fully tighten bolts.

**STEP 6**

Attach the Bottom Shelf (T) to the Lower Rear Panel (R) with 1 Counter Bolt (F) from the back per each side, and attach also to the Front Legs (S) by aligning holes and securing with 1 Allen Bolt (A) from the inside per each side. Tighten all bolts from Steps 4 through 6.

**STEP 7**

Carefully center the Slate Top (N) on top of the Top Support Frame (P) making sure all holes are properly aligned for final assembly.

**STEP 8**

Once in place, attach the assembled top section to the assembled lower section by guiding the inserts in place on the Slate Top (N) and securing from the bottom of the Top Support (P) & Lower Rear Panel (R) using 3 Allen Bolts (E), 3 Spring Washers (G) & 3 Flat Washers (H); also secure each Side Arm (L) with 1 Allen Bolt (E), 1 Spring Washer (G) & 1 Flat Washer (H) from the bottom of the Top Support (P) to secure in place. Tighten all bolts. The assembly is now complete.

