

88 5516 653

Barnside Pantry

IMPORTANT NOTE

Carefully remove all the parts from the carton and put them individually on a soft cloth to prevent scratches or other damage occurring to the parts.

We have taken great care in the design of this product and request that you carefully and strictly follow our assembly instructions to ensure a completed product as it was designed.

Home
Styles

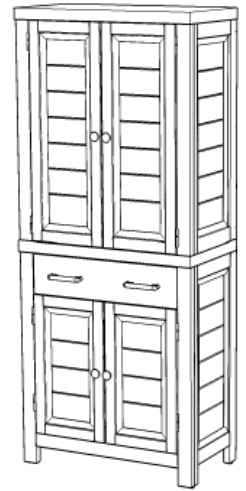

Part List

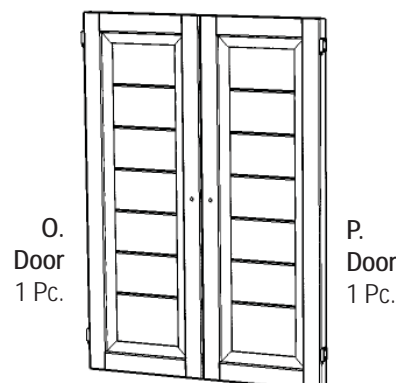
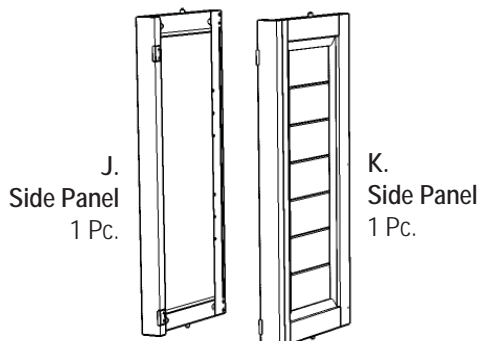
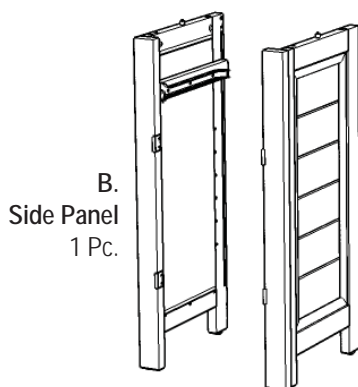

Hardware List

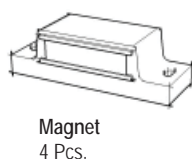
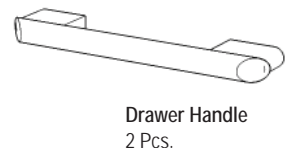
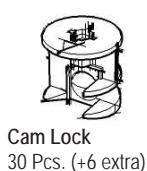

For assembly see instructions in carton 88 5516 654

Tools required for assembly : Phillips screwdriver

Home Styles Consumer Assistance: www.homestyles-furniture.com,
servicedesk@homestyles-furniture.com, 888-680-7460, 877-831-0319

88 5516 654

Barnside Pantry

IMPORTANT NOTE

Carefully remove all the parts from the carton and put them individually on a soft cloth to prevent scratches or other damage occurring to the parts.

We have taken great care in the design of this product and request that you carefully and strictly follow our assembly instructions to ensure a completed product as it was designed.

Home
Styles

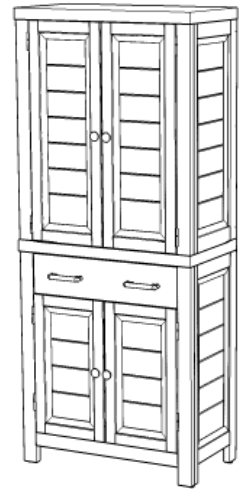

Part List



A.
Top
1 Pc.



D.
Base
1 Pc.

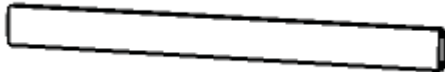

E.
Back Stretcher
2 Pcs.

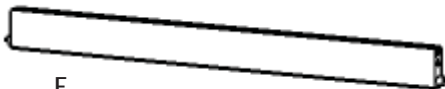

F.
Back Stretcher
3 Pcs.

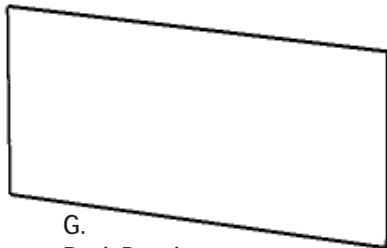

G.
Back Panel
2 Pcs.



H.
Front Rail
1 Pc.

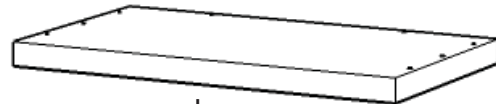

I.
Middle Panel
1 Pc.

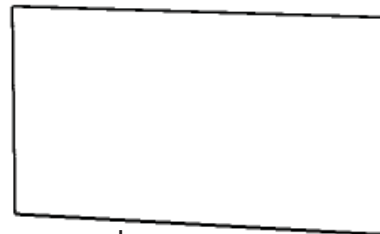

L.
Back Panel
2 Pcs.

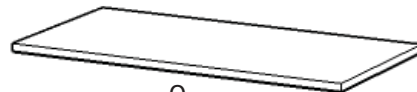

Q.
Shelf
4 Pcs.

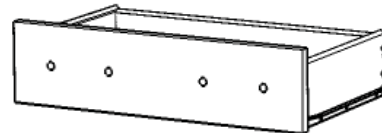

R.
Drawer
1 Pc.

(Please refer to the last page of instructions for steps to complete drawer assembly)

Also need the part(s) and hardware from carton 88 5516 653

Tools required for assembly : Phillips screwdriver

Tools recommended for assembly : Level

Home Styles Consumer Assistance: www.homestyles-furniture.com,
servicedesk@homestyles-furniture.com, 888-680-7460, 877-831-0319

IMPORTANT

- * Please keep Hex Wrench in a safe place as you may need to tighten up the Head Cap Bolts in the future.
- * Do not tighten up all the bolts until each part is properly assembled.
- * Use a soft cloth between these parts and the floor.
- * After assembly item must be level to work properly. Use the included adjustable levelers to level.

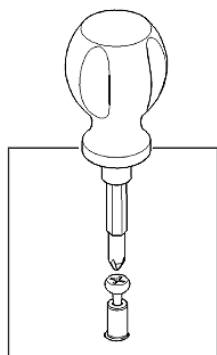
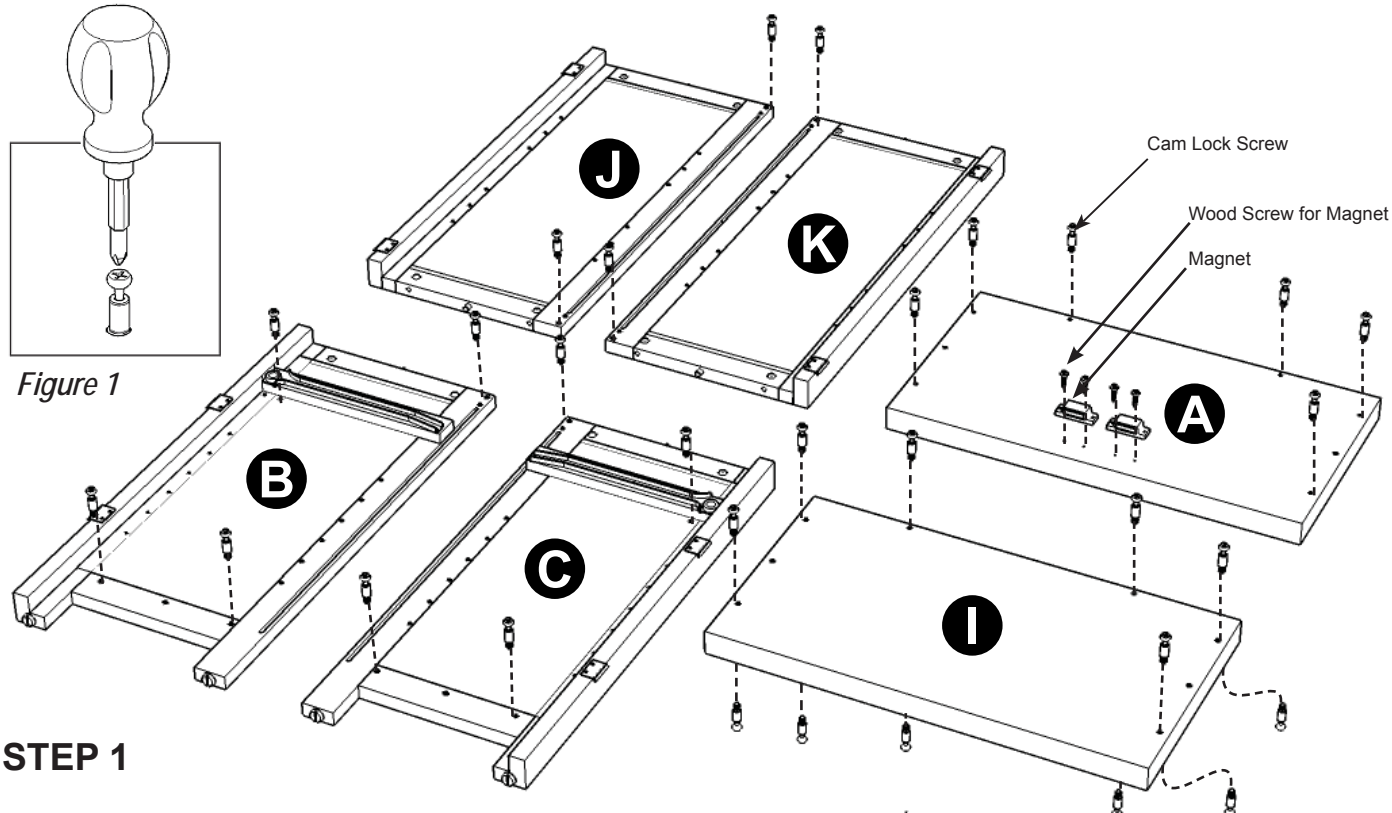

Figure 1



STEP 1

Insert Cam Lock Screws into pre-drilled holes of Top (A), Side Panels (B), (C), (J), (K) and Middle Panel (I). (See Figure 1)

Attach Magnets to Top (A) with Wood Screws for Magnet at the pre-drilled holes in Top (A). (See Figure 2)

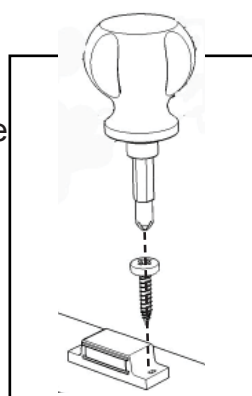

Figure 2

STEP 2

Attach Magnets to Front Rail (H) with Wood Screws for Magnet.

Attach Base (D), Back Stretcher (F) and Front Rail (H) to Side Panel (B) with Cam Locks.

Attach Back Stretcher (E) to unit then slide Back Panels (G) into place.

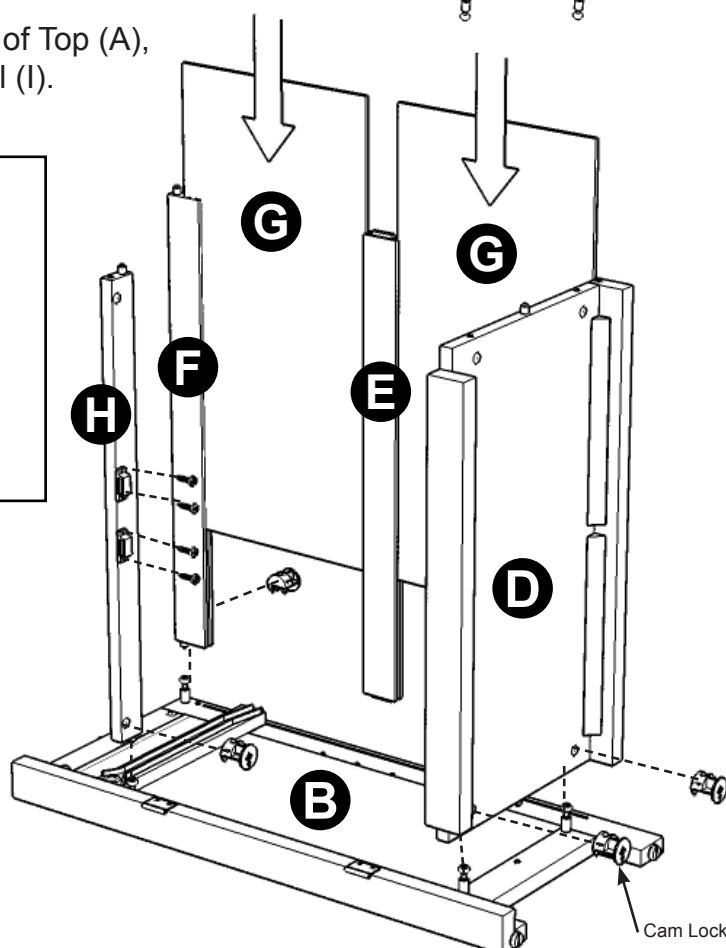

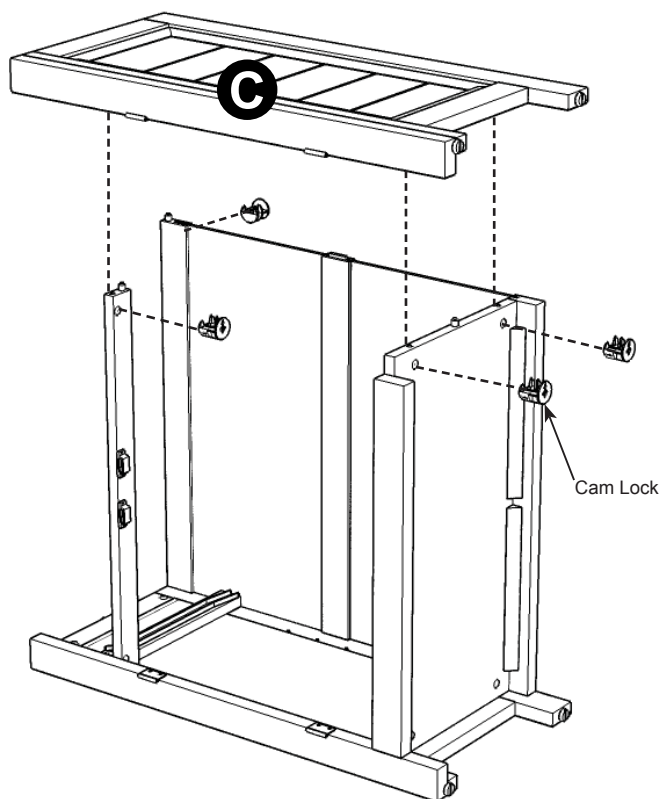

STEP 3

Attach Side Panel (C) to unit with Cam Locks.

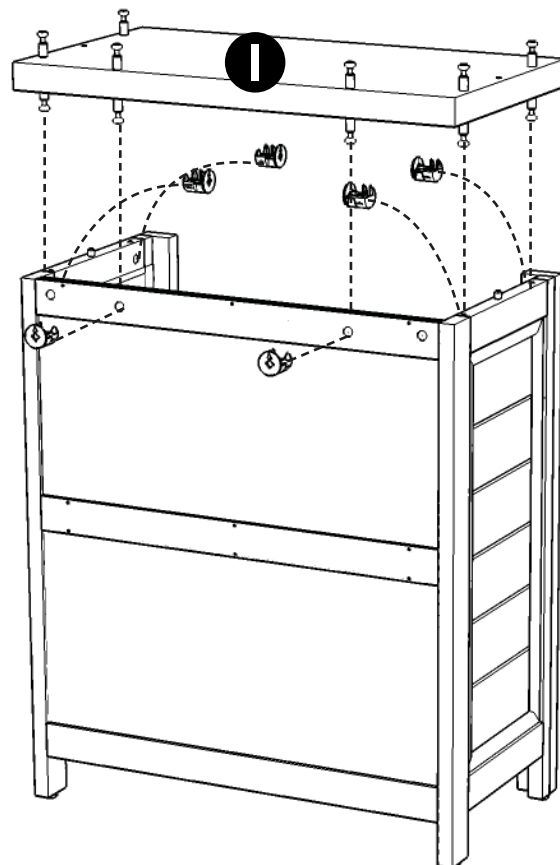

STEP 4

Attach Middle Panel (I) to unit with Cam Locks.

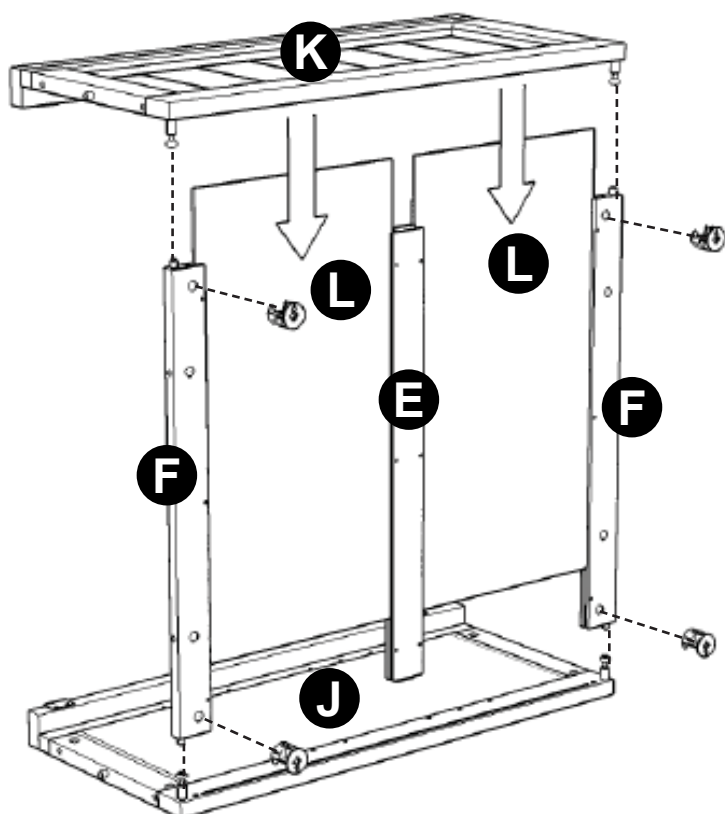

STEP 5

Attach Back Stretchers (F) to Side Panel (J) with Cam Locks.

Attach Stretcher (E) to Side Panel (J) then slide Side Panels (L) into position.

Attach Side Panel (K) to unit with Cam Locks.

STEP 6

Attach Top (A) to unit with Cam Lock.

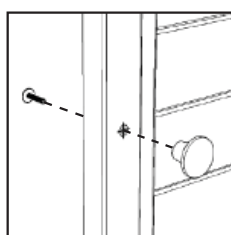
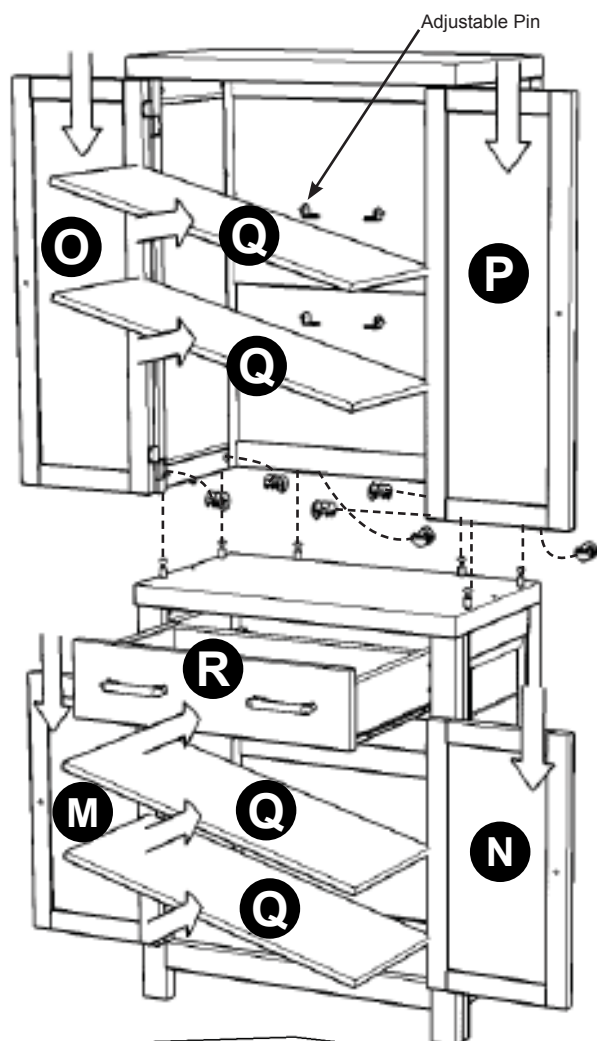

Figure 3

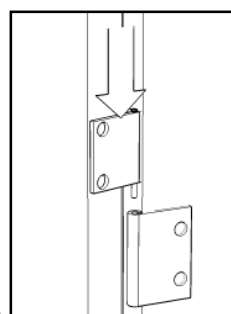
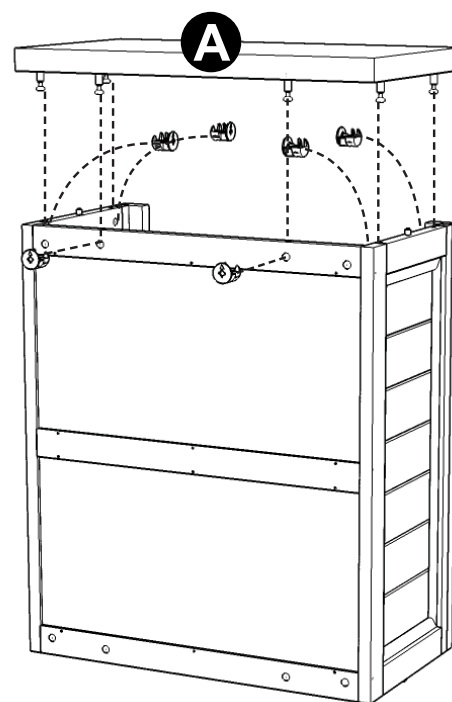

Figure 4



STEP 7

Attach unit from Step 6 to unit from Step 4 with Cam Locks.

Attach Door Handles to Doors (M), (N), (O) and (P) with Machine Screws. (See Figure 3)

Attach Doors (M), (N), (O) and (P) to unit by sliding the door lift hinges into the side panel lift hinges. (See Figure 4)

Insert Adjustable Pins into the middle panels at the desired level.

Slide Shelves (Q) and Drawer (R) into position.

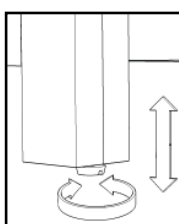
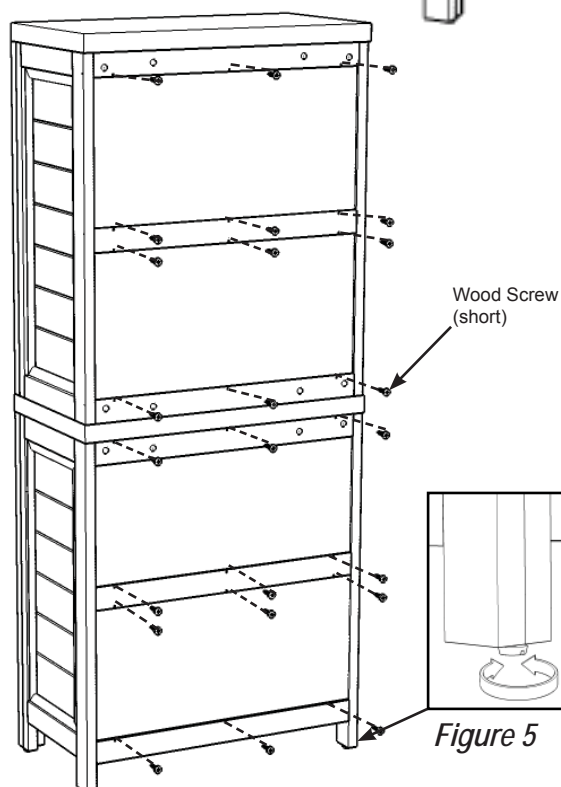

Figure 5

STEP 8

To level the unit, adjust the adjustable levelers on the bottom of the legs. (See Figure 5)

Insert 24X Wood Screws (short) from the back of the unit and tighten.

Note: Please make sure unit is level before tightening these screws.

Drawer R

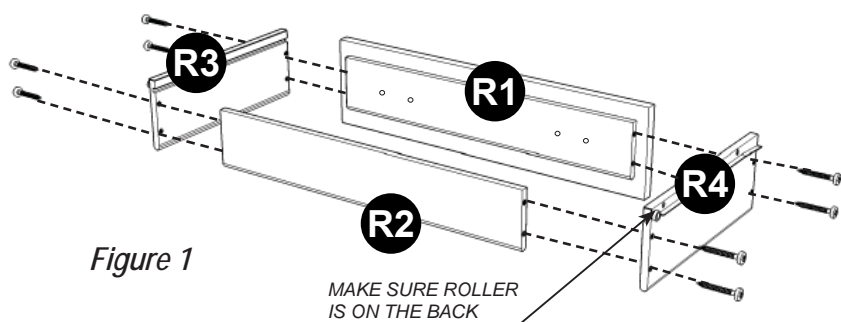

STEP 1

Attach R1, R2 and R3 using a Phillips screwdriver and long wood screws (4X), tighten halfway.

Attach R1, R2 and R4 using long wood screws (4X), tighten halfway. (See Figure 1)

STEP 2

Slide R5 into grooves in R3 and R4. Be sure to push R5 all the way forward so it meet R1. (See Figure 2)

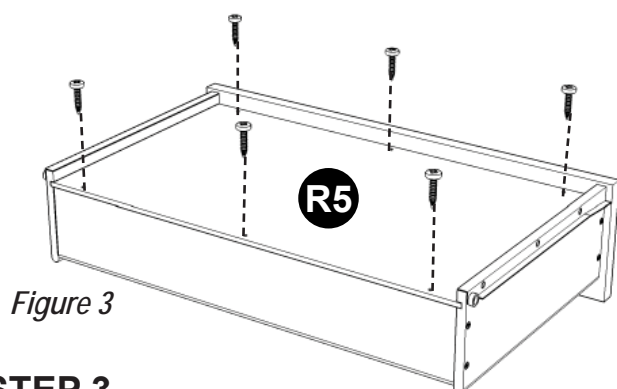
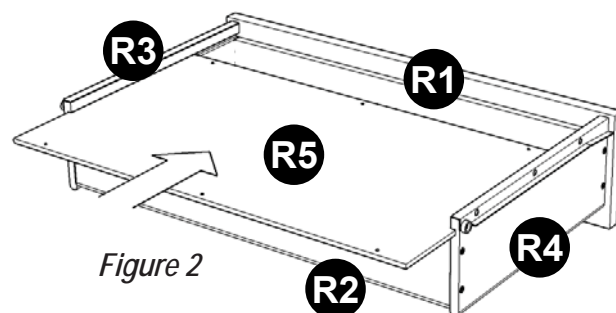

STEP 3

Insert short wood screws (6X) into the pre-drilled holes in R5, tighten screws. (See Figure 3)

Tighten all screws used in drawer assembly.

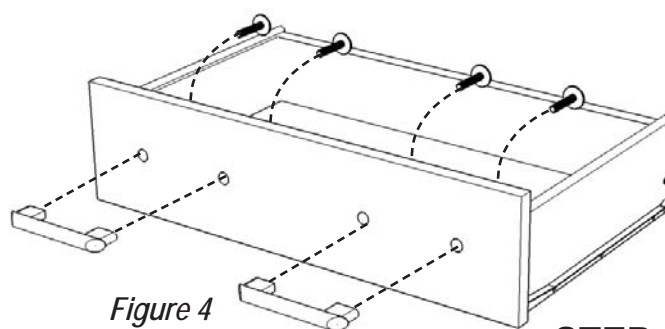

STEP 4

Attach Drawer Handles with Machine Screws. (See Figure 4)

Part List

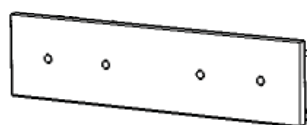

R1.
Front Part
1 Pc.



R2.
Back Part
1 Pc.

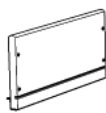

R3.
Side Part
1 Pc.

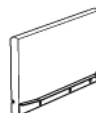

R4.
Side Part
1 Pc.



R5.
Base Part
1 Pc.