

88 5530 101

# Naples

## Entertainment Credenza (White Finish)

### IMPORTANT NOTE

Carefully remove all the parts from the carton and put them individually on a soft cloth to prevent scratches or other damages occurring to the wood parts.

We have taken great care in the design of this product and request that you carefully and strictly follow our assembly instructions to ensure a completed product as it was designed.



Casual Attire For Today's Home

## Part List

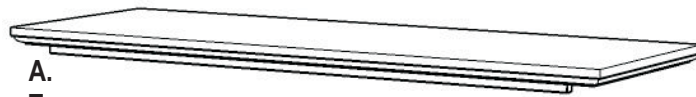

**A.**  
**Top**  
1 pc.



**H.**  
**Plinth**  
1 pc.



**I.**  
**Base**  
1 pc.

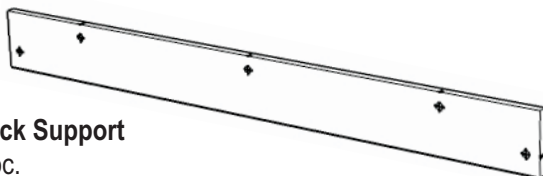

**R.**  
**Back Support**  
1 pc.

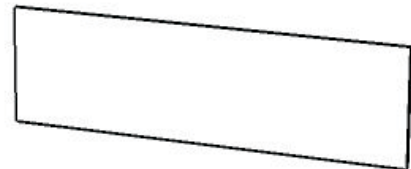

**J.**  
**Back Panel**  
1 pc.



**K.**  
**Back Panel**  
2 pcs.

## Hardware List



**Cam Lock Screw**  
28 pcs.(+1 extra)



**Magnet**  
4 pcs.



**Adjustable Pin**  
20 pcs.(+1 extra)



**Pull Handle**  
4 pcs.



**Cam Lock**  
28 pcs.(+1 extra)



**Wood Screw  
for Magnet**  
8 pcs.(+1 extra)



**Wood Screw  
for Back Panel**  
12 pcs.(+1 extra)



**Machine Screw**  
4 pcs.

**For assembly see instructions in carton 88 5530 102**

Tools required for assembly : Phillips screwdriver

**Home Styles Consumer Assistance Line 888-680-7460 and 877-831-0319**  
**[servicedesk@homestyles-furniture.com](mailto:servicedesk@homestyles-furniture.com)**

88 5530 102

# Naples

## Entertainment Credenza (White Finish)

### IMPORTANT NOTE

Carefully remove all the parts from the carton and put them individually on a soft cloth to prevent scratches or other damages occurring to the wood parts.

We have taken great care in the design of this product and request that you carefully and strictly follow our assembly instructions to ensure a completed product as it was designed.

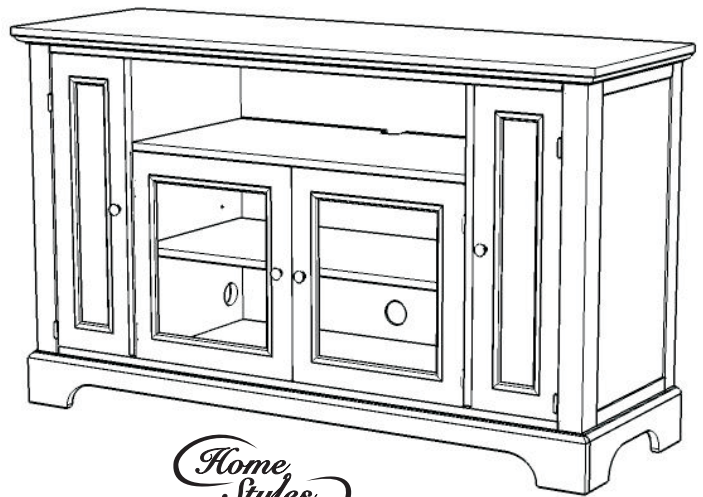

*Home Styles*

Casual Attire For Today's Home

### Part List (in this carton)

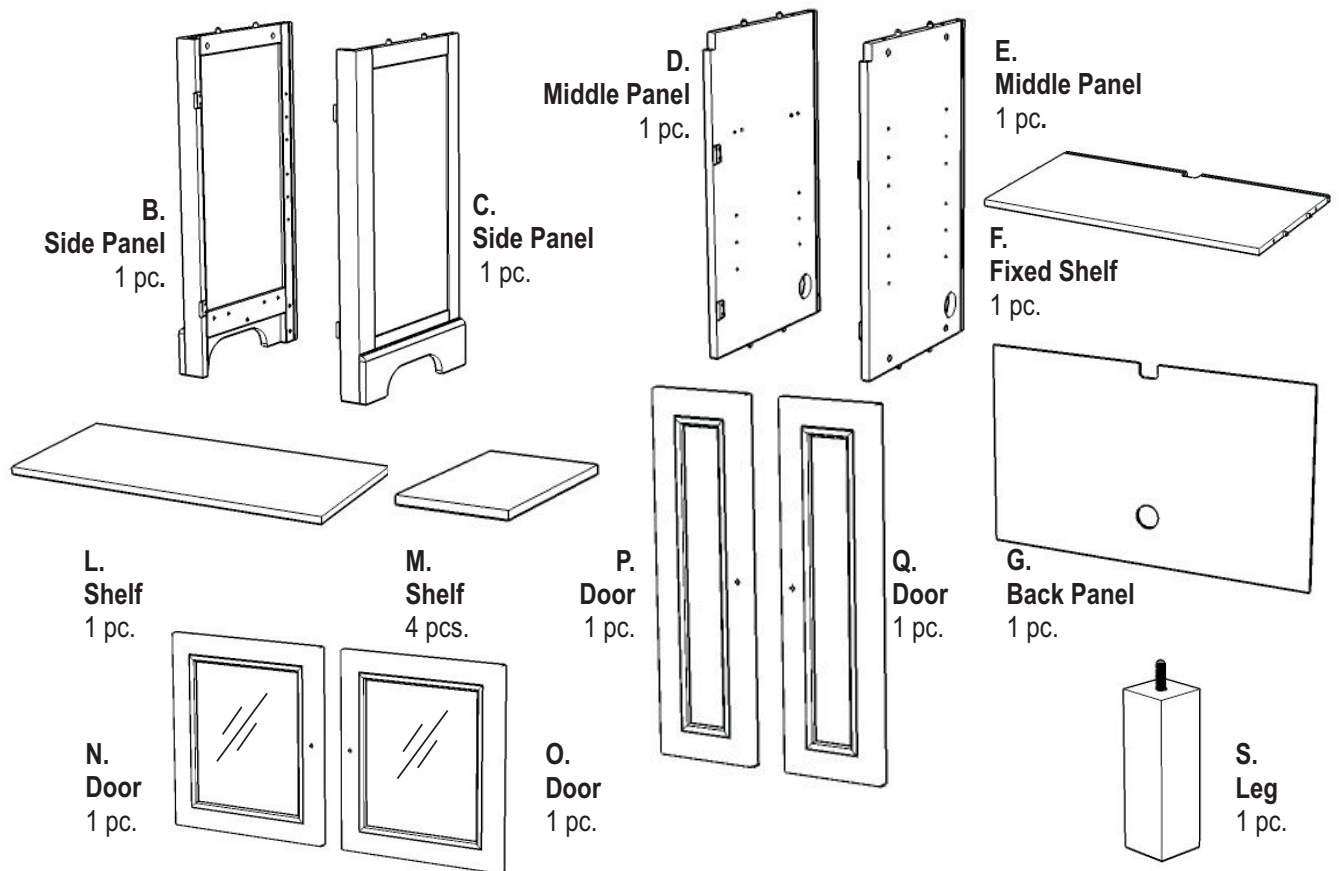

### Also need the following from carton 88 5530 101 :

#### Part List in carton 88 5530 101

Top (A)	1 pc.
Plinth (H)	1 pc.
Base (I)	1 pc.
Back Panel (J)	1 pc.
Back Panel (K)	2 pcs.
Back Support (R)	1 pc.

#### Hardware List in carton 88 5530 101

Cam Lock Screw	29 pcs.
Cam Lock	29 pcs.
Magnet	4 pcs.
Wood Screw for Magnet	9 pcs.
Wood Screw for Back Panels	13 pcs.
Adjustable Pin	21 pcs.
Pull Handle	4 pcs.
Machine Screw	4 pcs.

Tools required for assembly : **Phillips** screwdriver

**Home Styles Consumer Assistance Line 888-680-7460 and 877-831-0319**  
**[servicedesk@homestyles-furniture.com](mailto:servicedesk@homestyles-furniture.com)**

## STEP 1

Attach 2X Magnets to Top (A) by using Wood Screws in the pre-drilled holes (See figure 1).

Insert Cam Lock Screws into the pre-drilled holes of Top (A).

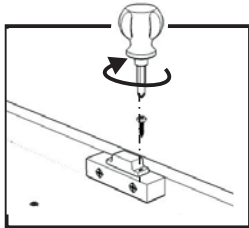

(Figure 1)

## STEP 2

Insert Cam Lock Screws into the pre-drilled holes of Side Panel (B) and (C), Middle Panel (D) and (E), Plinth (H) and Base (I).

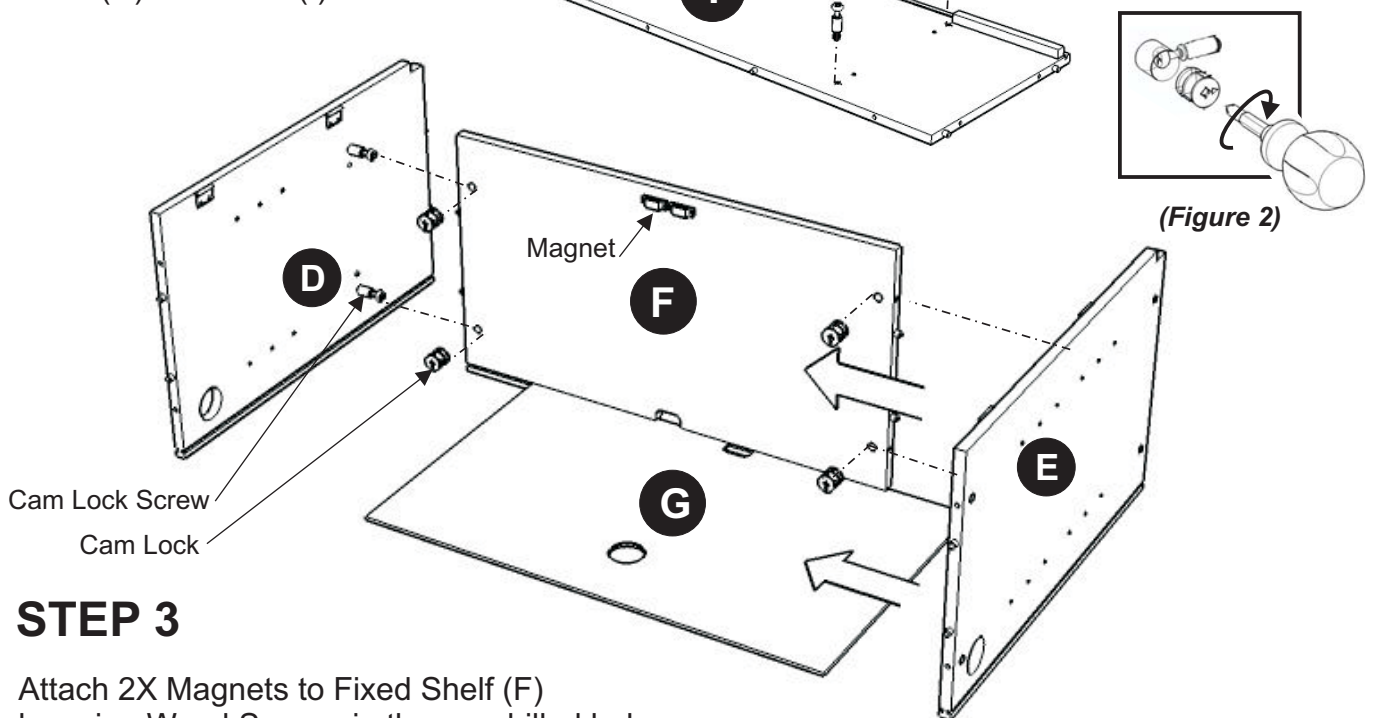

(Figure 2)

## STEP 3

Attach 2X Magnets to Fixed Shelf (F) by using Wood Screws in the pre-drilled holes.

Attach Fixed Shelf (F) to Middle Panel (D) with Cam Locks (See figure 2), then slide Back Panel (G) into position.

Attach Middle Panel (E) to the unit with Cam Locks.



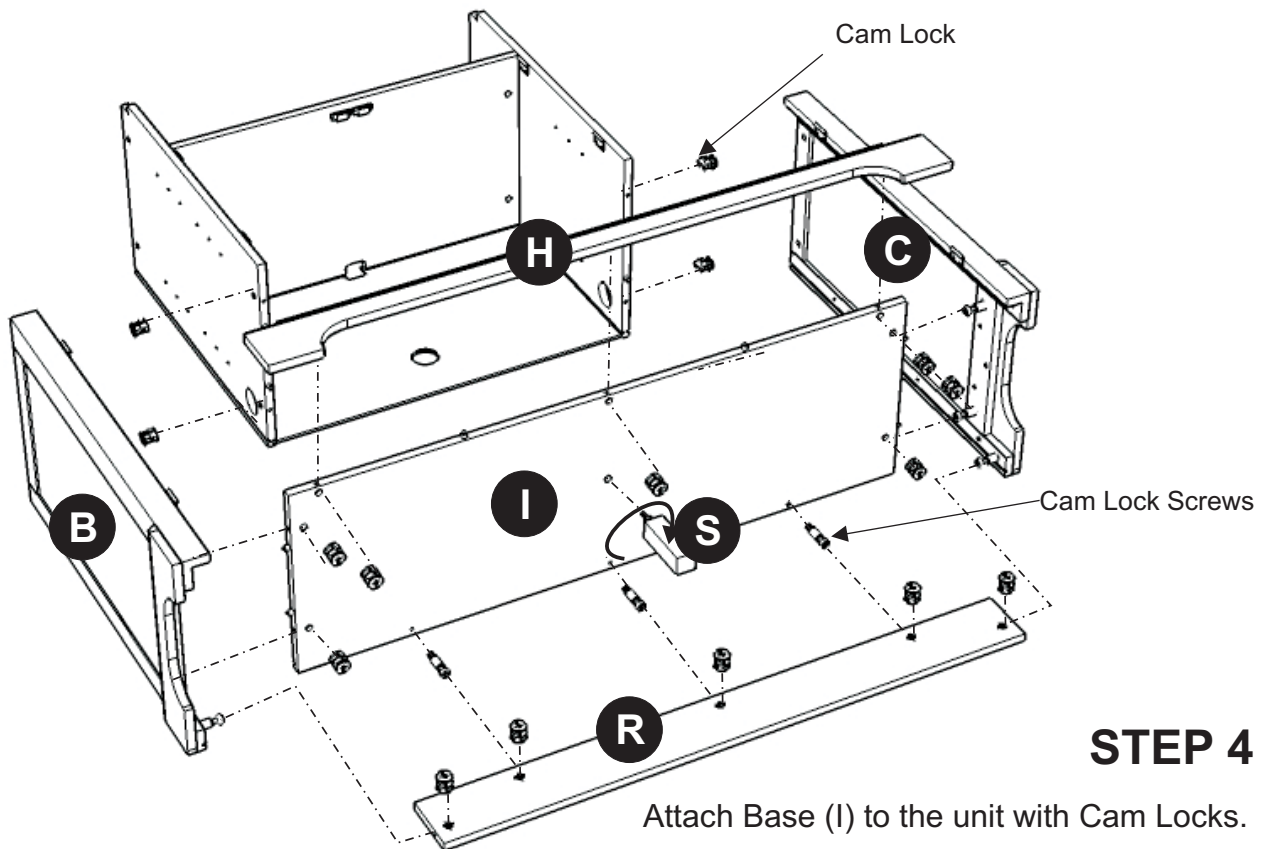

Put 3X Cam Lock Screws into the pre-dilled holes of Base (I) as shown, then attach Back Support (R) to Base (I) with Cam Locks and attach Side Panel (B) and (C), Plinth (H) to the unit with Cam Locks.

Tighten up Leg (S) in the pre-dilled hole of unit as shown.

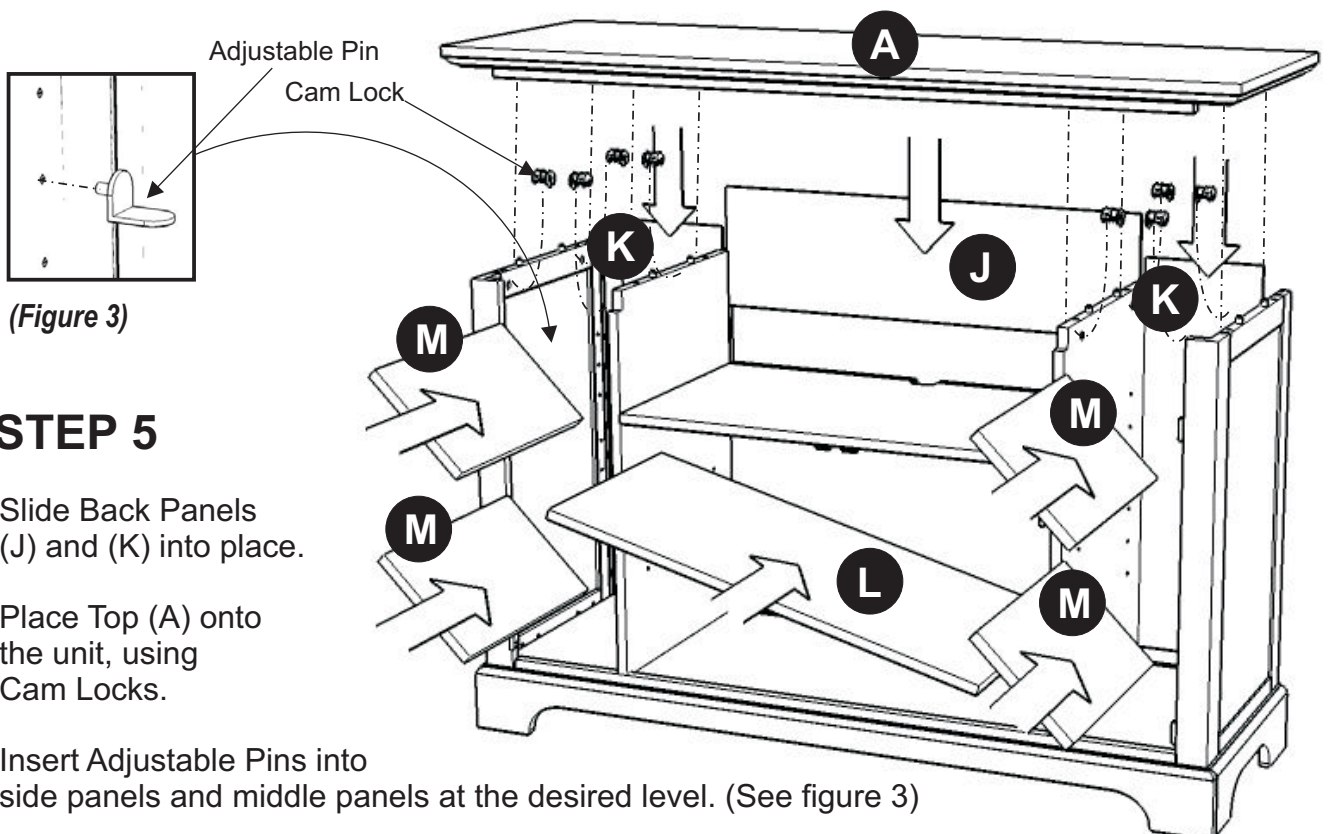

(Figure 3)

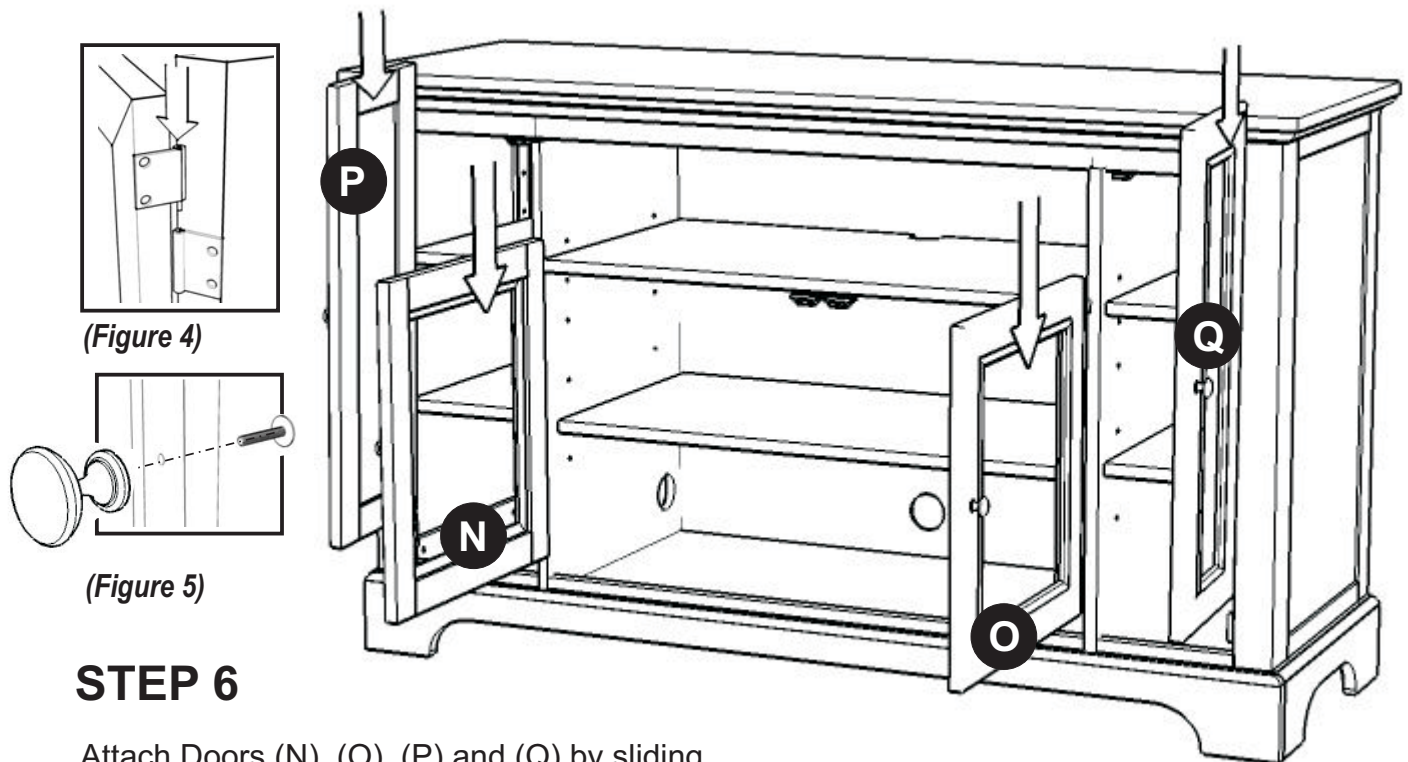

## STEP 6

Attach Doors (N), (O), (P) and (Q) by sliding the door lift hinges into the side panels lift hinges. (See figure 4)

Assemble Pull Handles to Doors with Machine Screws. (See figure 5)

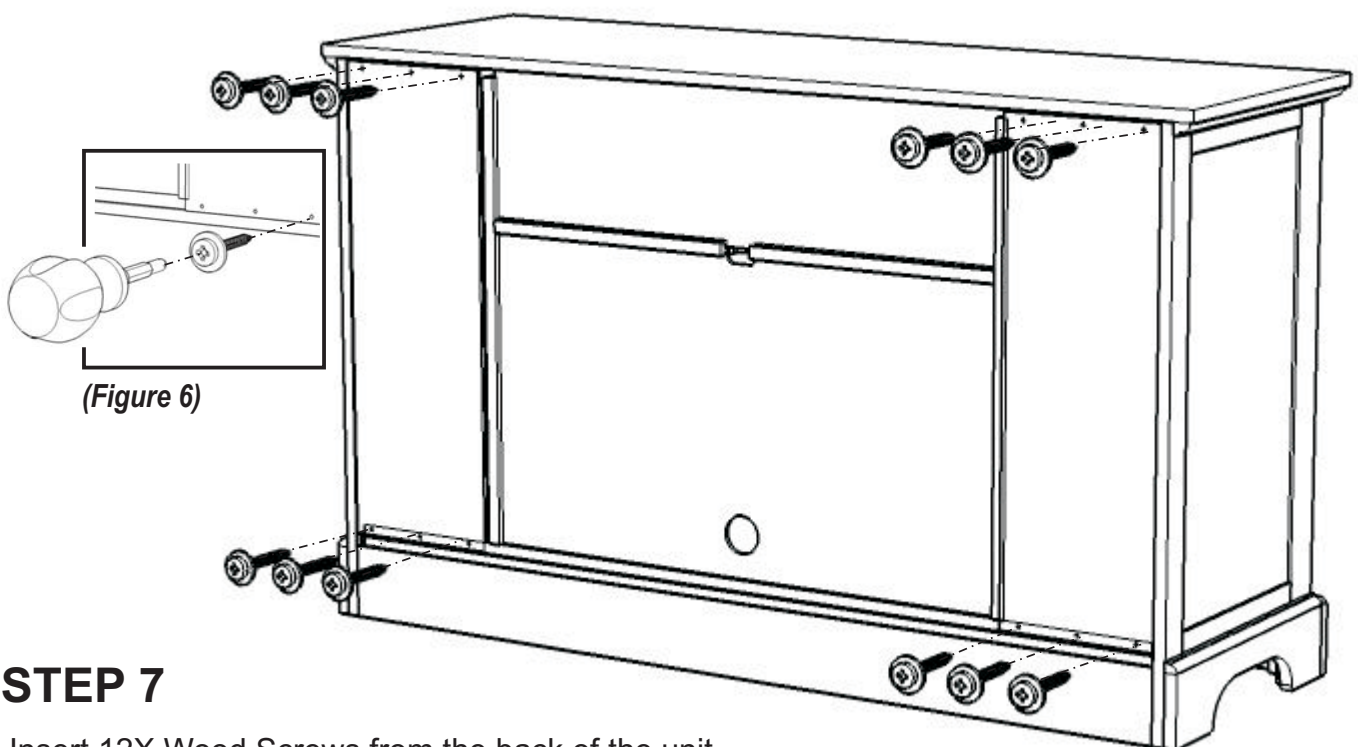

## STEP 7

Insert 12X Wood Screws from the back of the unit, tighten up all the Wood Screws. (See figure 6)

**Note:** Please make sure unit is level before tightening these screws.