

**A**

**Right drain installation**

**B**

**Left drain installation**

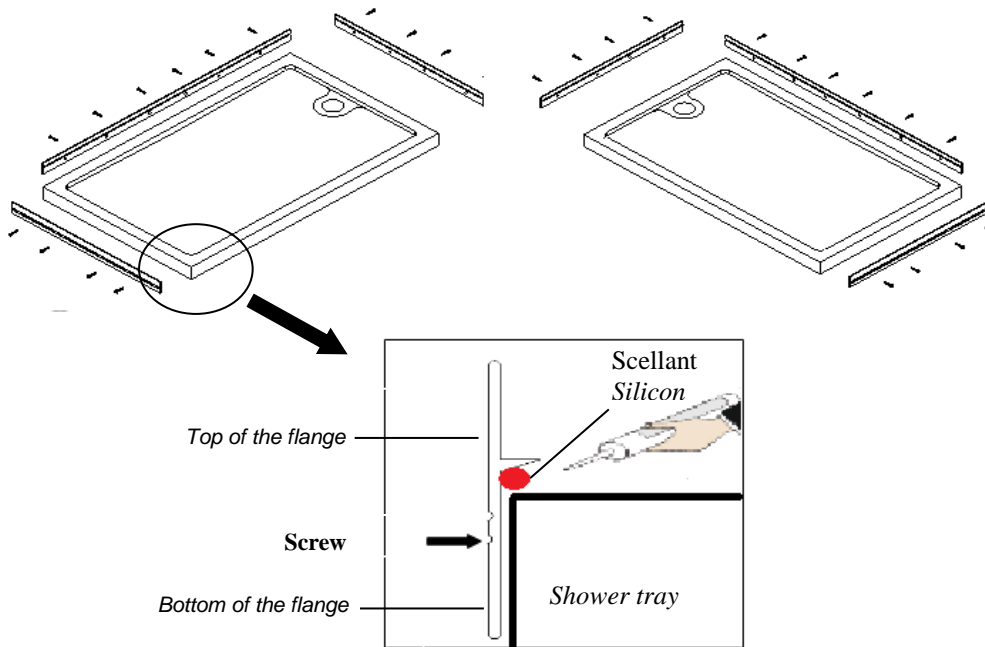

1A. According to the location of the drain, assemble the flanges on the base following the above illustration.

1B. Determine the 60 1/4 inches (1528 mm) side of the shower base that will install next to the back wall. This is the side where you will install the long tiling flange.

1C. Start with the long tiling flange. The side with groove should be the bottom of flange. Apply silicon on the location as shown on the above illustration.

1D. Use screws to install the tiling flange to the side of the base.

1E. Repeat the same instructions to assemble the tiling flange on the left and right sides of the shower base.



**Make sure to have a distance (D) from the left side tile to the right side tile:**

**D Min: 58 1/4 in (1480 mm)**

**D Max: 58 3/4 in (1492 mm)**

Needed wall studs as support for tracks

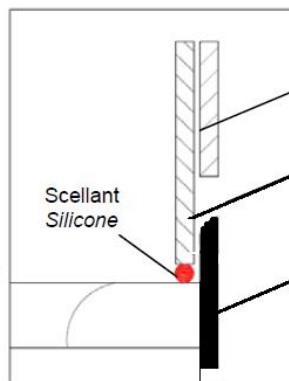
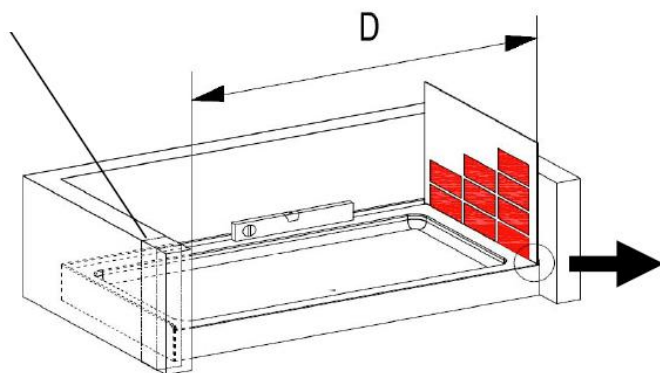

Gyproc is above the base flange

Tiles are in front of the base flange

Base flange

1F. Ensure that all raw plumbing has been prepared prior to installation of shower.

1G. Once in place, the inner surface of the top of the flange will be almost flush with the gyproc.

**Notes:**

- Measure the thickness of your tiles on either side before installing the metal tracks. A thicker tile will limit your space to install the shower panels.
- Make sure to have a distance tile to tile between 58 1/4 inches (1480 mm) Min and 58 3/4 inches (1492 mm) Max (see image).

**Before continuing the installation:**

- Ensure proper installation of the drain and test for leaks prior to installing the remaining pieces of shower unit.
- Verify all pipe connections to ensure no leakage occurs.
- Allow enough time for the cemented tiles to fully dry before installing the shower doors