



Vinyl Fence Gates

Assembly and Installation Instructions

PLEASE READ OWNER'S MANUAL COMPLETELY
BEFORE ASSEMBLING YOUR FENCE.

ALL STATED SIZES ARE NOMINAL DIMENSIONS.

34106493BOM V2 11/12

Models

73013273
73013276
73013300
73013299
73013786
73013793
73014059
73014060

Owner's Manual

Version

2.0

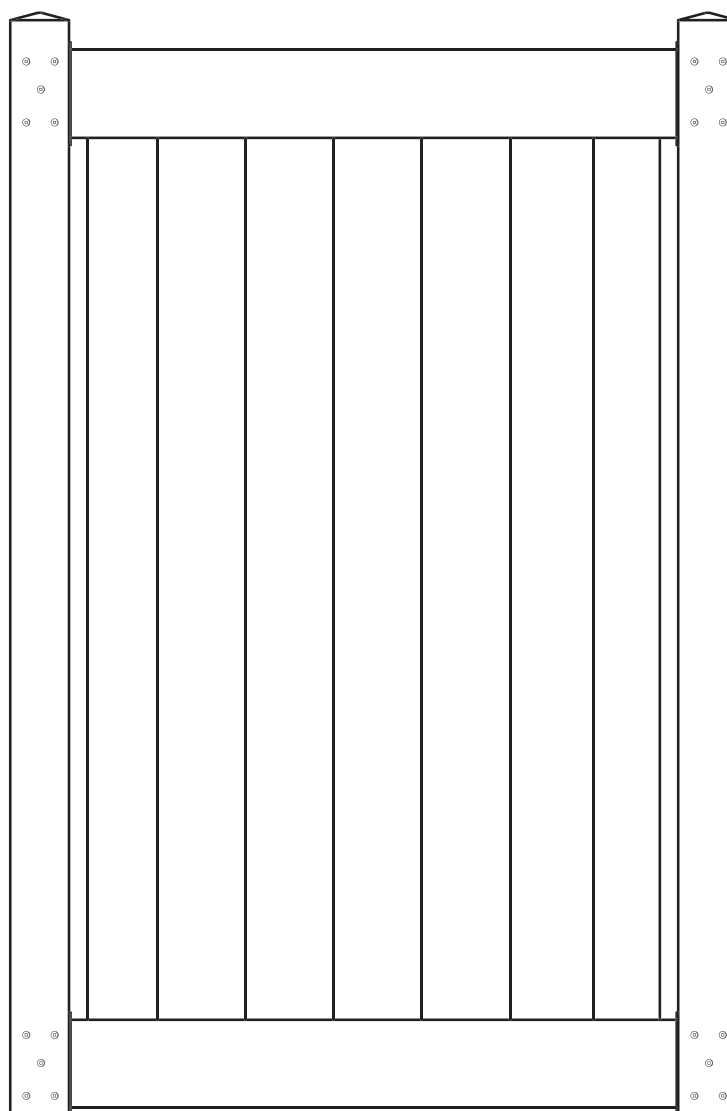

Thank you for choosing the Barrette Outdoor Living Fence Gate. Please read the instructions completely before assembling your gate. Retain manual and your dated sales slip for future reference and warranty claims.

Before You Begin...

Check your local zoning laws.

- Local zoning laws and Home Owners Associations may regulate the location, style and height of your fence or even require a permit signoff beforehand.

Contact your local utilities companies.

- You must have the utility companies clearly mark your property for electrical, gas or water lines to avoid puncturing any unseen underground utilities.

Pay to mark your property line.

- Being proactive will save you time and money from any disputes from neighbors.

Gate posts require an internal support system for weight-bearing purposes and therefore wooden inserts or a post stiffener is required.

Post Spacing will be determined by gate width and hardware.

© 2012 Barrette Outdoor Living
7830 Freeway Circle
Middleburg Heights, Ohio 44130

Material Checklist:

- | | |
|--|---|
| <input type="checkbox"/> Phillips Head Screwdriver | <input type="checkbox"/> Tape Measure |
| <input type="checkbox"/> Safety Glasses | <input type="checkbox"/> Drill |
| <input type="checkbox"/> Vinyl Cement | <input type="checkbox"/> 5/8" Drill Bit |
| <input type="checkbox"/> Line Level | <input type="checkbox"/> Gate Hardware (Hinges/Latch) |

ATTENTION: Before you assemble the gate:

PLEASE TAKE A COMPLETE INVENTORY OF ALL PARTS USING THE KIT CONTENTS.

DO NOT ATTEMPT TO ASSEMBLE THE GATE IF PARTS ARE MISSING OR DAMAGED.

Please do not return the product to the store, for assistance or replacement parts call:

1-800-336-2383

Purchased Metal Stiffener

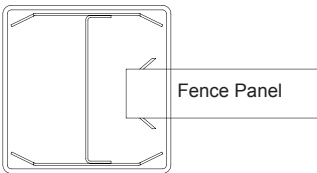

Screw/Nail Together As Shown

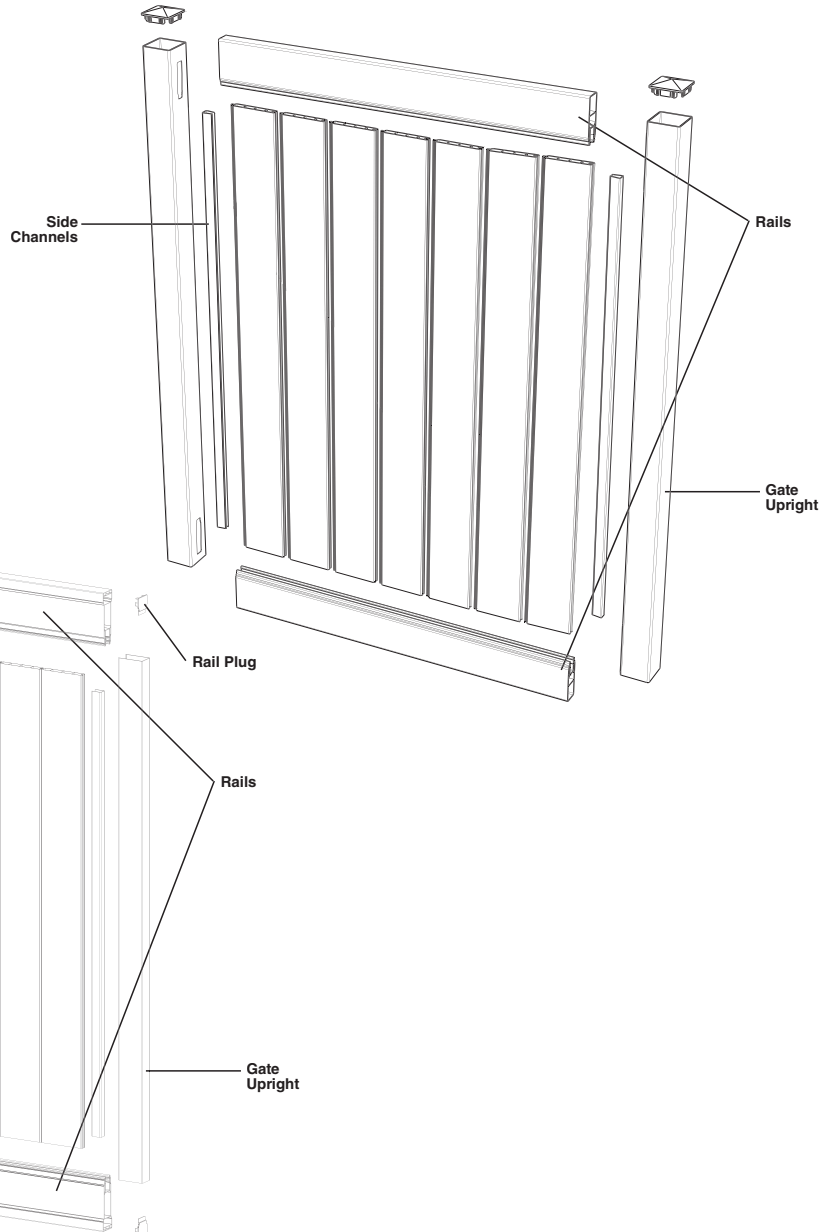
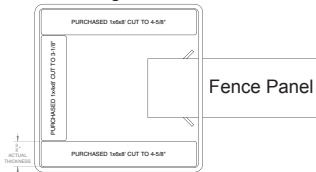

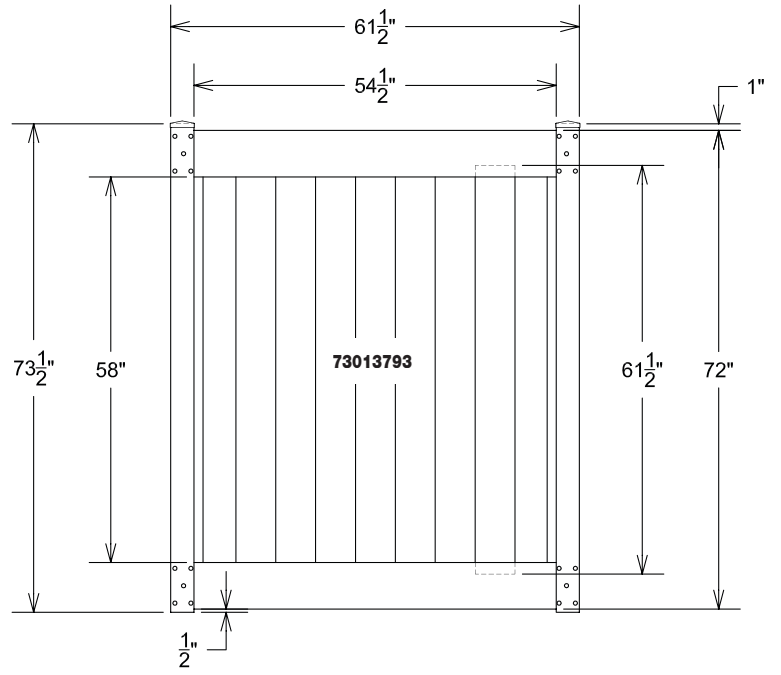
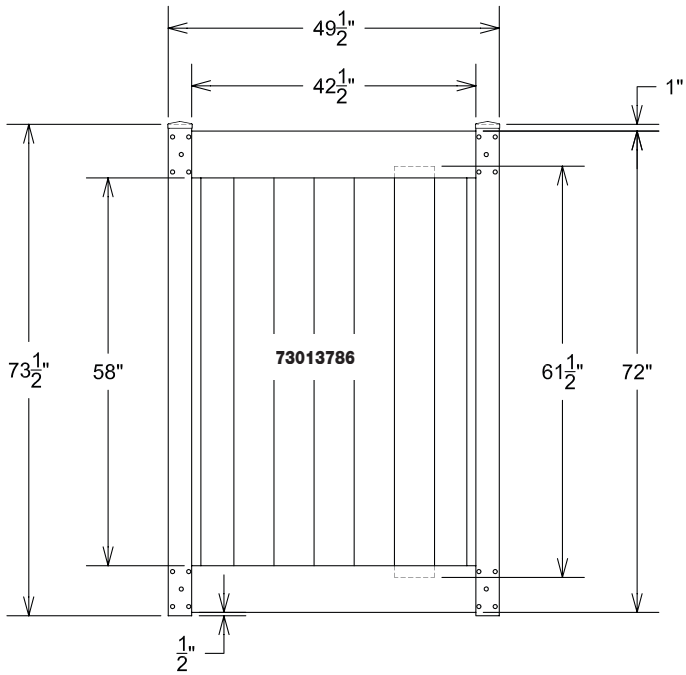
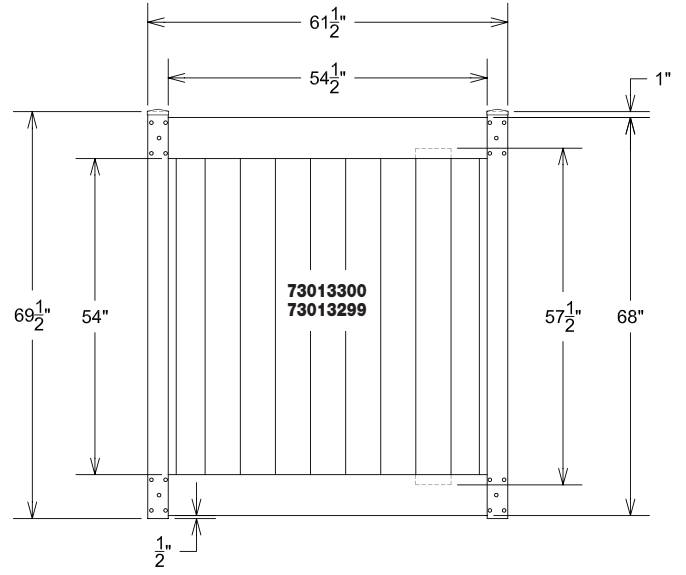
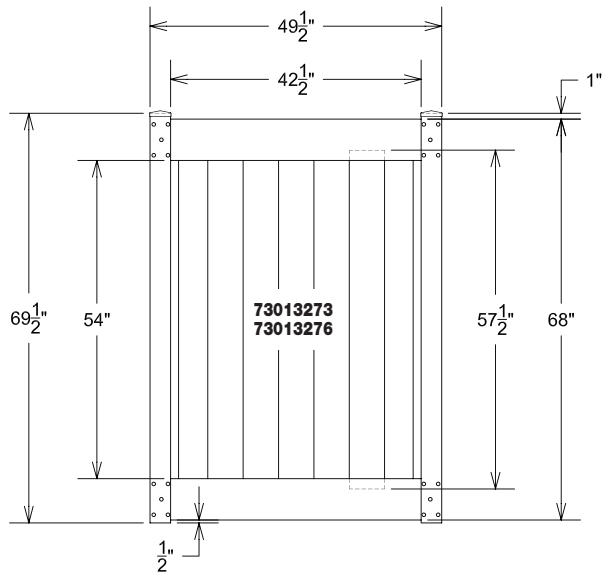

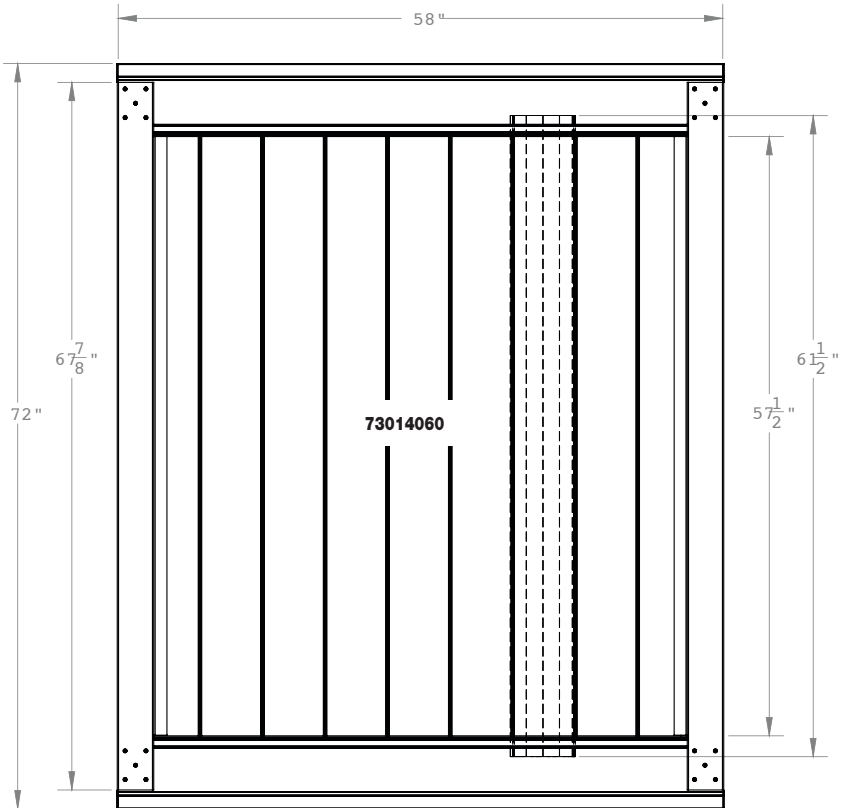
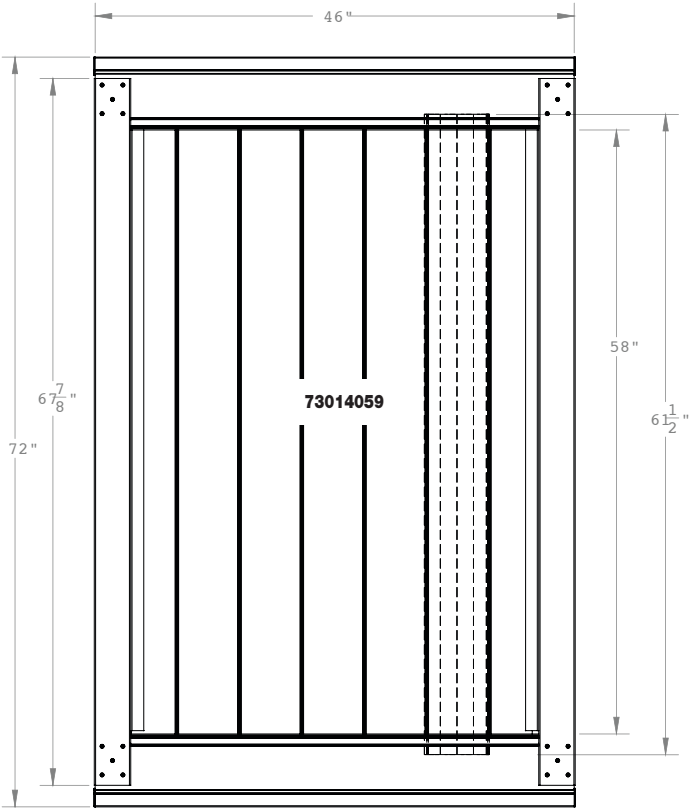

Product Overview:

NOTE: For plain flat rails use an internal post top. For decorative rails use a rail plug.

- 1.) Assemble the center portion by inseting the vertical boards into the bottom of the horizontal rail. For decorative top rail gates, there are two 4-1/2 in. boards (One missing a tongue and one missing a groove) which should be placed on the outer edges of the gate. Add left and right U-channels on either side. Snap the top rail horizontal rail on the vertical uprights.
- 2.) Install the center portion into the gate uprights. Snip off excess material on the upright for decorative rail installation (*Figure 1*). For flat rails the space should be at the top of the upright.
- 3.) Next, adhere the internal post top or decorative rail plug with glue. (*Figure 2*)
- 4.) Make sure the gate is square (*Figure 3*) and mark screw position in each of four corners. Make sure the screw placement allows for connection of the rail to the upright. (*Figure 4*)
- 5.) Secure the rails to the uprights using #2 square drive bit with supplied screws (20) for the flat rails or #10 x 3/4 in. screws (40) for the decorative rail. Repeat in each of the four corners on the front side of the gate and for the decorative rail on the opposite side of the gate (eight corners).
- 6.) Mount the gate according to the instructions on the hinge.

For gates with decorative top rails

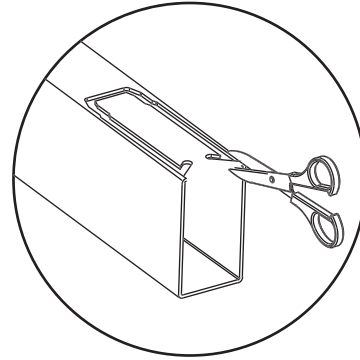

Figure 1

For gates with plain flat top rails

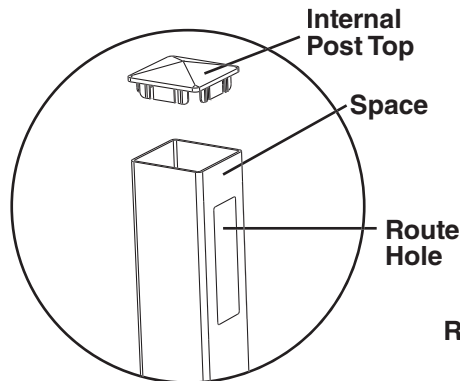

Figure 2a

For gates with decorative top rails

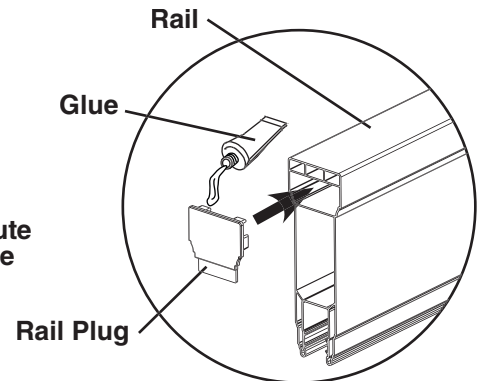

Figure 2b

NOTE: Not All fences, gates, or gate hardware are pool code approved.

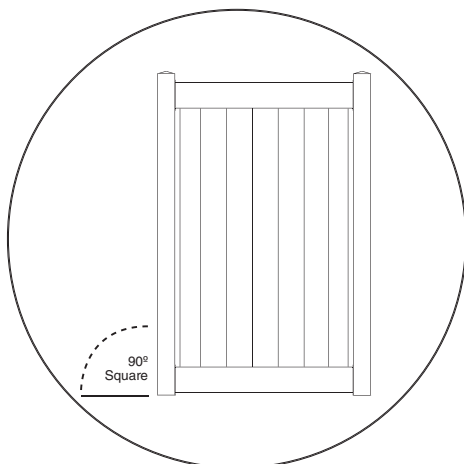

Figure 3

For gates with plain flat top rails

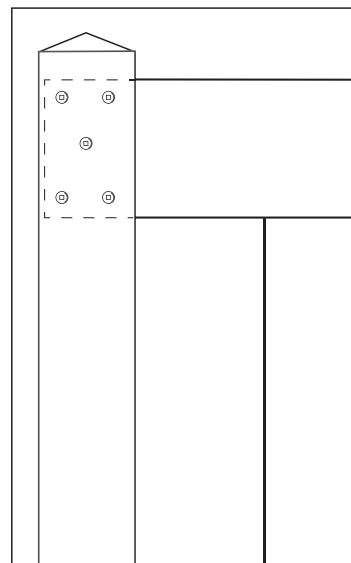

Figure 4a

For gates with decorative top rails

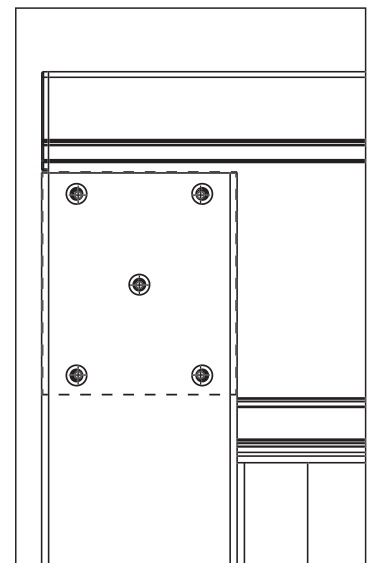

Figure 4b



Transferable Limited Lifetime Warranty

What is covered: Barrette Outdoor Living warrants vinyl and aluminum products to include; vinyl and aluminum fence, vinyl and aluminum railing and plastic lattice against defects or workmanship for as long as you own your home. Barrette Outdoor Living will at its option replace the product in question with new product of the same or equivalent value at no charge. Barrette Outdoor Living warrants these products against peeling, flaking, splintering, corrosion, rusting or abnormal discoloration under normal use and service per ASTM D 2244. This warranty extends to the original purchaser or transferee as specified herein on the products noted above. Separate and distinct warranties for hardware and other products are not covered under this warranty.

What this warranty does not cover: This limited warranty does not cover damage resulting from accident, unreasonable use, neglect, alteration, improper service, improper installation, acts of God or any other causes not arising out of defects in materials or workmanship. Additionally, this warranty does not cover costs of installation, removal, reinstallation or surface mold and mildew created by excessive environmental conditions. Any service or repair provided outside the scope of this limited warranty shall be at Barrette Outdoor Living's rate and terms then in effect.

What do we do to correct the problems? Should your Barrette Outdoor Living product prove defective under warranty, reference the website or call the phone number listed below. Your problem will be assigned a tracking number and an authorized Barrette Outdoor Living representative will contact you to arrange a convenient time to schedule an onsite inspection, or request pictures, if need be. If after inspection product is deemed to be manufacturer defect we will make arrangements to rectify the issue. You must have proof of your purchase in order for the problem to be corrected.

Transferee Coverage: Warranty coverage will be extended to one transferee on the above listed products with the following limitations. Transferee must obtain an original or copy of the initial sales receipt (with proof of date) from the previous owner(s). Additionally, if fence is purchased from a builder or installer, documentation must be supplied that names the product installed on property and date of transfer.

THIS WARRANTY IS IN LIEU OF ALL CONDITIONS OR WARRANTIES, EXPRESS, OR IMPLIED INCLUDING BUT NOT LIMITED TO ANY IMPLIED CONDITIONS OR WARRANTIES OR MERCHANTABILITY OR FITNESS FOR A PARTICULAR PURPOSE ON THE PART OF Barrette OR ITS LICENSORS, SOME STATES DO NOT ALLOW THE EXCLUSIONS OF IMPLIED WARRANTIES OR LIMITATIONS OF HOW LONG AN IMPLIED WARRANTY LASTS, SO THE ABOVE LIMITATIONS MAY NOT APPLY TO YOU. IF THE PRODUCT IS DEFECTIVE PER THE ABOVE COVERAGES, YOUR SOLE AND EXCLUSIVE REMEDY SHALL BE REPAIR OR REPLACEMENT AS PROVIDED ABOVE. BARRETTE AND ITS LICENSORS SHALL NOT BE LIABLE FOR ANY DAMAGES, LOSS OF USE, LOSS OF PROFITS OR INTERRUPTION OF BUSINESS WHETHER SUCH ALLEGED DAMAGES ARE BASED IN WARRANTY, TORT, CONTRACT, OR INDEMNITY. SOME STATES DO NOT ALLOW THE EXCLUSION OF LIMITATIONS OF INCIDENTAL OR CONSEQUENTIAL DAMAGES, SO THE ABOVE LIMITATIONS MAY NOT APPLY TO YOU. This warranty is valid only in the United States and Canada.

