

Recommended Tools

Drill, One-Way tool (provided),
3/16" Drill Bit, Tape Measure,
Pencil, 3/8" Socket Driver

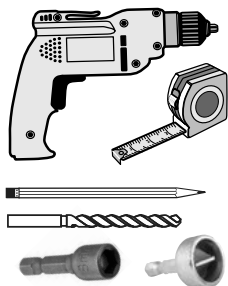

DESCRIPTION	QTY
1/4x4" one-way screw	8
1/4x1" one-way screw	8
1/4x1" self-drilling hex-head screw	8
Large End Cap	4
Mounting Bracket	8
Small End Cap	2

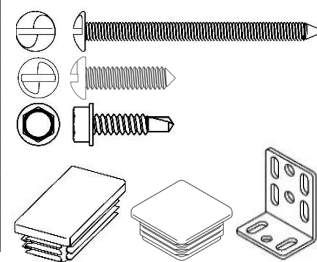

PREP STEPS

- Verify opening size with size shown on the box
- Make sure door trim is securely fastened and square

BEFORE YOU START

- Read the complete installation instructions before proceeding with installation
- Installation may require two people when lifting and installing the door
- Use appropriate protective equipment
- Do not allow children to play with the door
- Failure to install door properly could result in an injury
- Gatehouse is not responsible for accidents or injury resulting from the use or installation of this product

1 Determine if the Door will be Right or Left Operating

The door can be installed to operate from either the left or the right as viewed from the outside. Right operating door shown in these instructions.

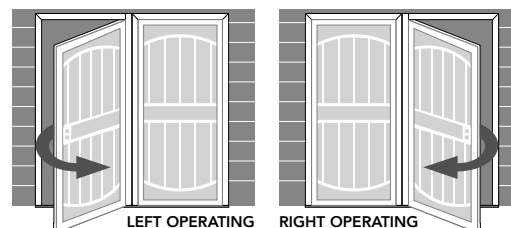

2 Install the Handle and Deadbolt using the Manufacturer's Instructions

3 Check for Obstructions and Select Mounting Method

Open the door and hold it up to the opening as shown. The door should be centered vertically over the opening for all mounting methods. Operate the door and inspect for possible interference that might affect the placement of the mounting brackets or operation of the door. Select appropriate mounting method.

To support the weight of the door, installation screws must hit a solid surface.

Important: Top and bottom brackets are required on all mounting methods

STANDOFF MOUNT

Projects the door up to 2" off the surface to avoid obstructions.

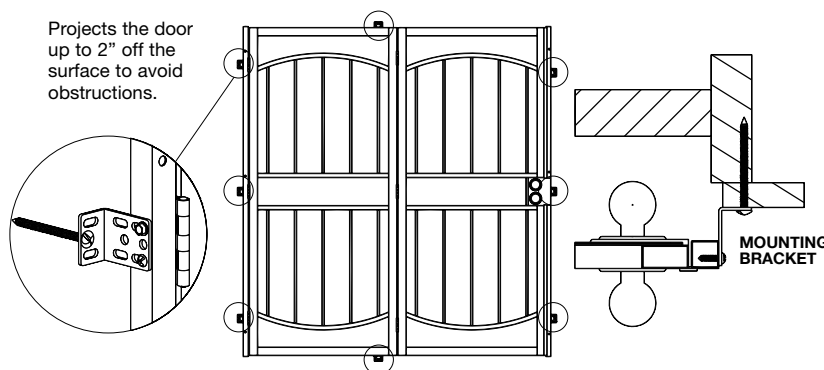

STANDARD MOUNT

Hinge and latch rails are attached directly to the mounting surface.

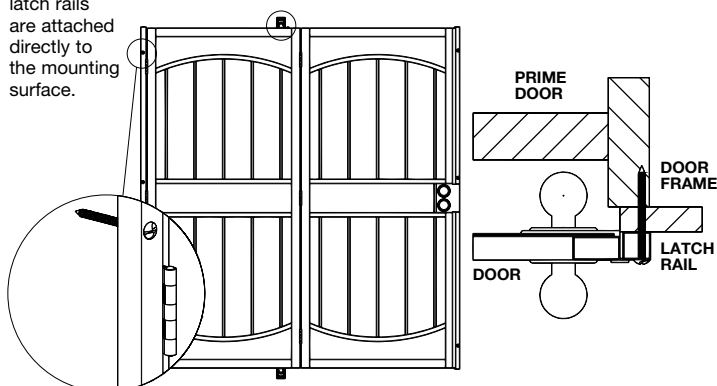

EXTENDED MOUNT

The door remains flush with the surface but extends the mounting range to fit larger openings. If the extended mount plus a 2" offset is required, it may be necessary to build out your mounting surface.

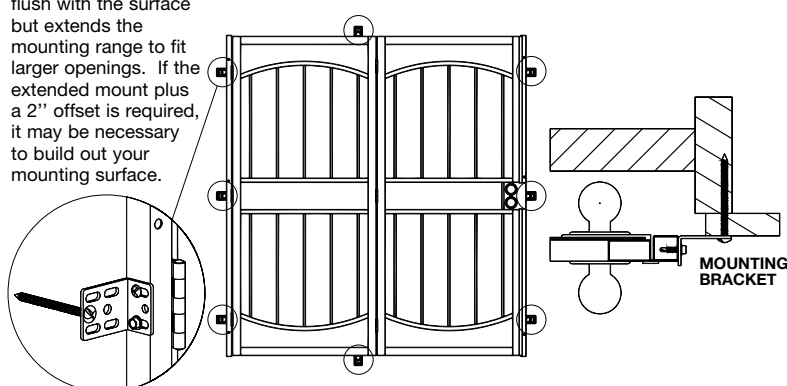

4 Install End Caps

Lay the door on a solid, flat surface. Push the 4 larger end caps into the holes in the top of the door. Push the two smaller end caps into the holes at the top of the latch rail and hinge rail

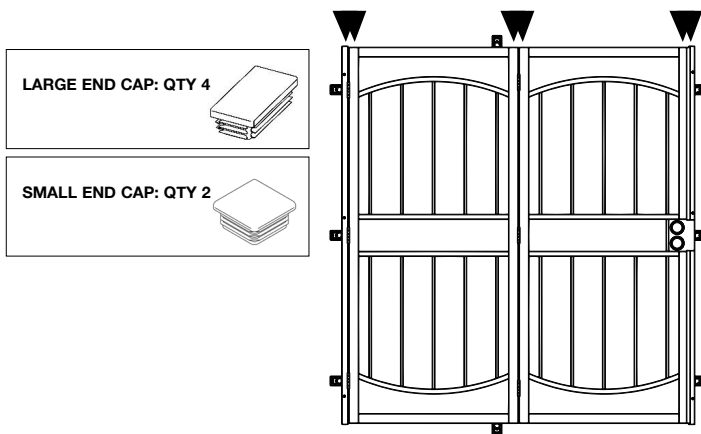

5 Position the Mounting Brackets

With a pencil, mark the position of all brackets on both the door and latch rail according to the mounting method chosen. Ensure the top and bottom brackets are on the stationary side of the door. If Standard Mount was chosen, only the top and bottom brackets are used.

Once the mounting brackets are screwed in place, they cannot be easily removed. Ensure the fit and appearance is satisfactory before brackets are attached.

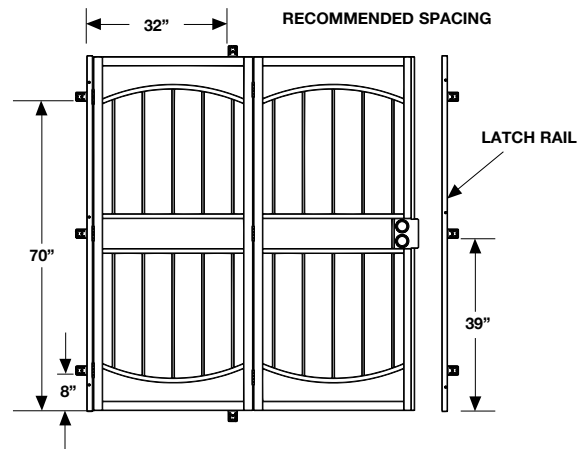

6 Attach Mounting Brackets with Self-Drilling Screw

Using a drill and a 3/8" socket driver, fasten mounting brackets to the door and latch rail using **one 1/4x1" hex-head screw per bracket**.

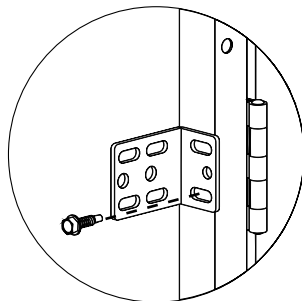

7 Install Shorter One-Way Screw

With a 3/16" drill bit, use each bracket as a template to drill a hole into the door. Do not drill all the way through the door. Secure each bracket to the door with one 1/4x1" one-way screw.

Important: Once installed, these screws cannot be easily removed.

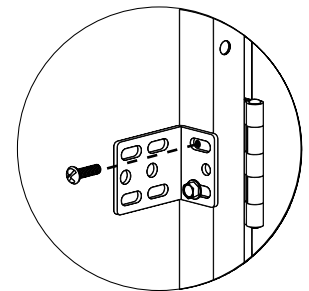
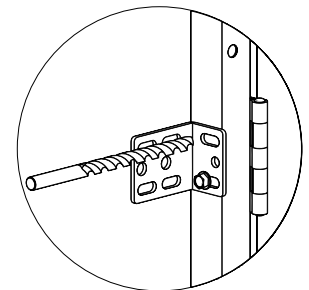
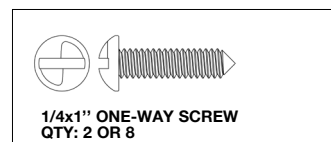

8 Attach Door to the Door Frame

Hold the door to the door frame as shown in the Step 3 and re-verify the door fits and operates properly. With a 3/16" drill bit, use each bracket as a template to drill one 4" deep hole into the door frame. Mount the door to the door frame with one 1/4x4" one-way screw per bracket. Start with the top middle bracket.

Important: Do not drill or mount the latch rail yet.



EXTENDED MOUNT

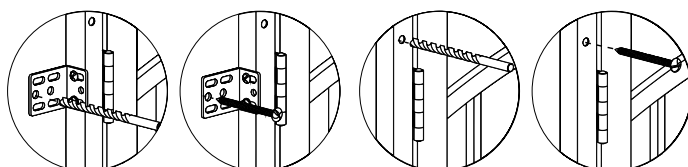

STANDARD MOUNT

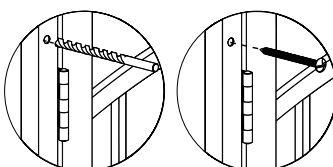

9 Position and Mount Latch Rail

With the door closed, align the latch rail next to the door ensuring there is a 1/8" gap between the latch rail and the door. Confirm the door opens and closes smoothly, and the handle and deadbolt operate. Repeat Step 8 to mount the latch rail using three 1/4x4" one-way screws.

