

## Preparation

### UNEVEN FLOORS AND WALLS

Because floors and walls have uneven spots which will affect the installation, it will be necessary to locate these uneven areas. Wall and floor unevenness can cause cabinets to be misaligned resulting in “racking” or misalignment of the doors and drawer fronts. Uneven spots can be found with a straight edge or a 4 ft. level. Simply run the straight edge along the floor and wall to identify any uneven areas. Where these uneven spots interfere, high spots can be removed by scraping or sanding the excess plaster. Low spots can be shimmed.

### LOCATE STUDS

Locate the wall studs with a stud finder or tap on the wall to locate a “solid sound”. This generally will tell you where the wall studs are located. You can verify this location by driving a small finishing nail into the wall. Make sure this is an area that will be covered by the base cabinets. Mark a chalk line at the center of the wall studs at the top and bottom of the cabinet position. Normally the wall studs are located 16 in. apart, center to center.

### CABINET HEIGHT

To establish the height of your base cabinets, measure up and mark the wall at 33½ in. from the highest spot on the floor. Use this mark as a starting point and draw the lines around the bathroom. Mark the outlines of all cabinets on the wall to check actual cabinet dimensions against your layout (Figure 1).

### HARDWARE

Decorative and installation hardware such as nails, screws, glue, wire, tape, etc., are not included.

### INSTALLATION TIP

Whenever drilling into a cabinet frame, crown, back panel, wall cleat, etc., it is recommended to pre-drill a pilot hole first to help prevent splitting. Also, using a little wax on the screws will help seat them into the wood.

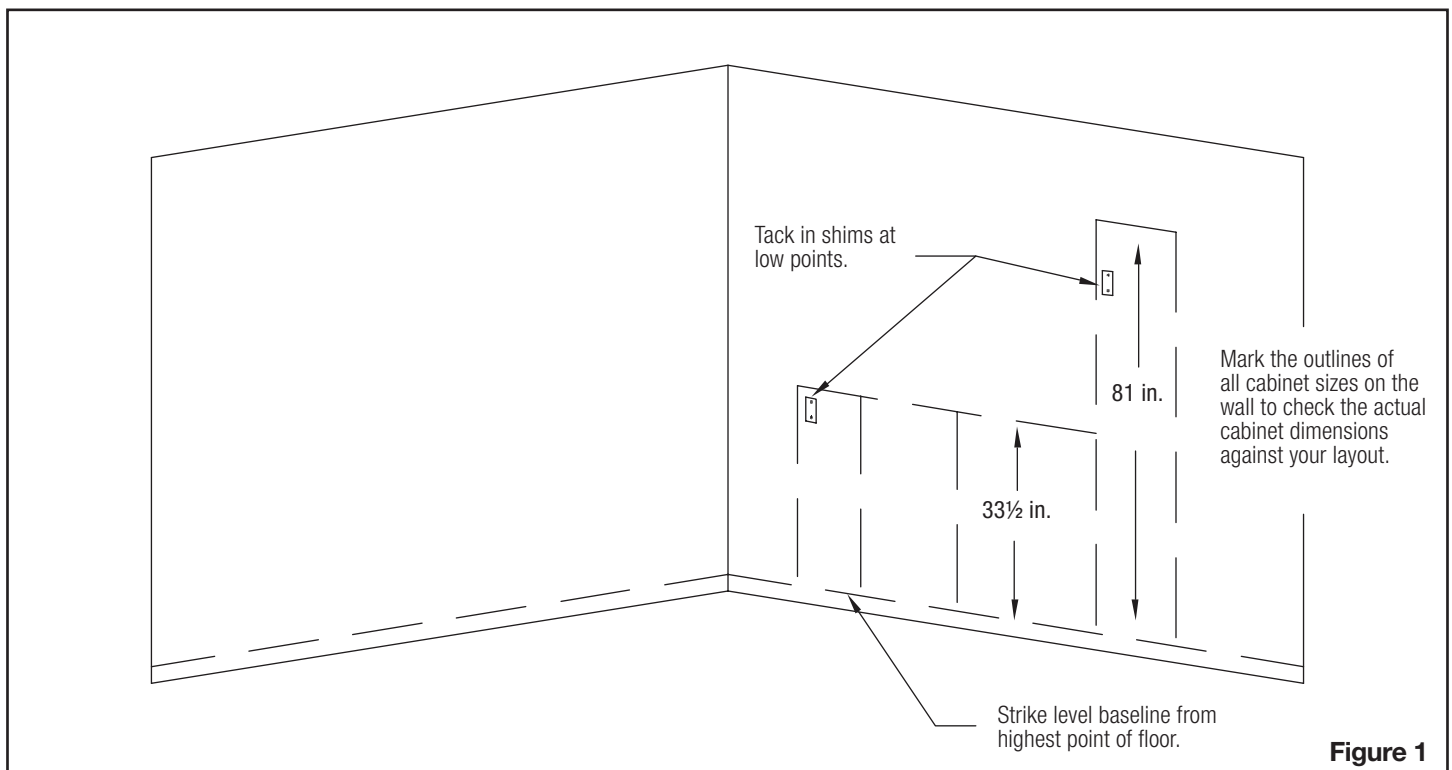

Figure 1

## INSTALL BASE CABINETS

Before beginning the cabinet installation, you will need to apply the finished flush-fit end panel(s) to the side(s) of the cabinet(s) that will be exposed to the room. Refer to the instructions provided with the flush fit end panels.

When starting the installation process, it is very important to start your installation from a corner wall and work out. If the wall is not straight, you may need to use a filler and scribe it to the wall's shape (Figure 2). Fillers may also be used to accommodate wall to wall installations where the cabinets do not fit exactly.

Once you have identified the starting point, take the first cabinet and shim it to the previously established level line. Drill pilot holes at the stud location, through the back rail and into the studs. Then securely fasten the cabinet to the wall, using #8 x 2½ in. screws and appropriate anchors (Do Not Nail). Make sure the cabinet remains square and level after wall attachment.

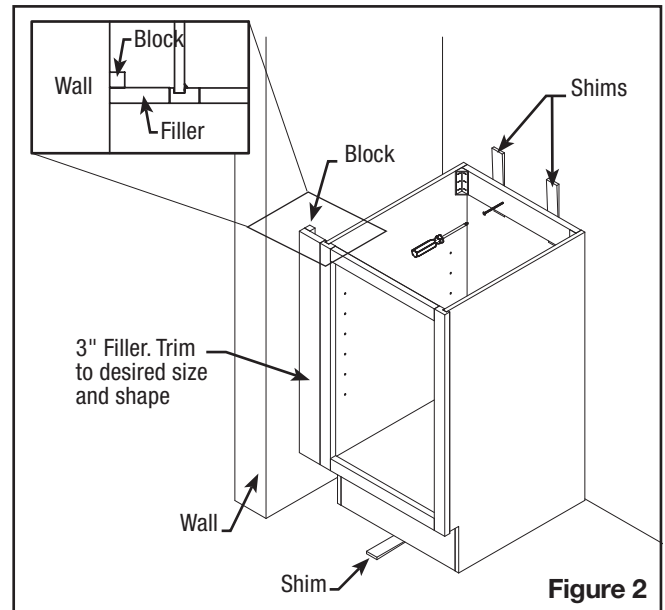

## ATTACH CABINETS TOGETHER

Once you have securely fastened the starting cabinet to the wall, line up the front of the cabinets and use "C" clamps to simply join the next cabinet to it. Place the "C" clamps on the adjoining stiles and carefully clamp the two together. Carefully line up the top and shim the bottom of the cabinets. Now drill a pilot hole using a 1/8 in. drill bit, through the adjoining stiles. Once done, draw the two together, use two #8 x 2 in. wood screws (Figure 3).

Continue installing the remaining base cabinets in the same manner. After joining all of your base cabinets together, verify all cabinets are level and secure each cabinet to the wall.

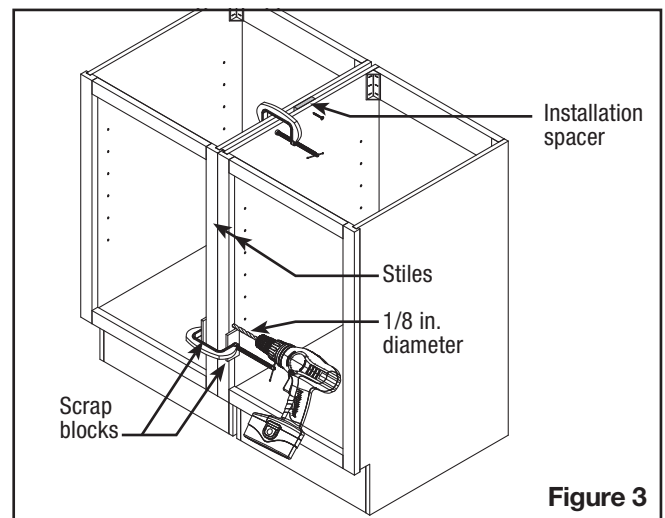

## Changing the Door Swing

Because some installations require a cabinet door to open in the opposite direction, it may be necessary to switch the hinges from one side of the cabinet to the other. You must first remove the door by unscrewing the hinges from the face frame. Then using a 3/32 in. diameter drill bit, drill holes 3/4 in. deep on the other side of the face frame. Rotate the door 180 degrees and screw the hinge onto the opposite side of the face frame (Figures 4 and 5).

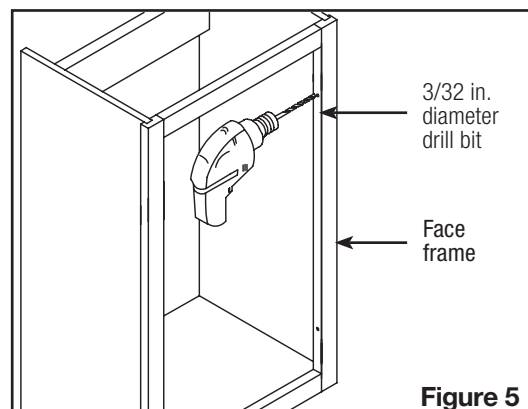
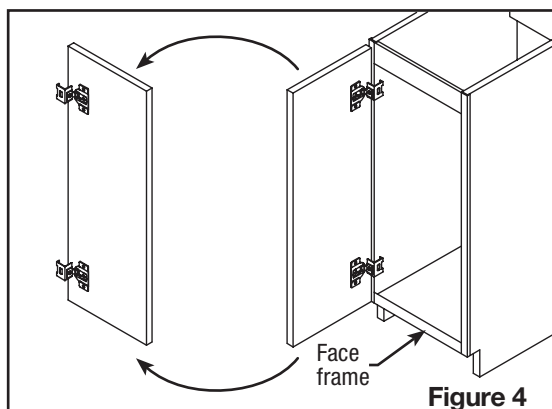

## Hinge Adjustment

It usually is necessary to adjust your hinges once you have finished the installation of your cabinets (Figure 6). You must do this before installing any decorative hardware.

## Drawer Adjustment

### DRAWER GLIDES

To remove the drawer from the cabinet, extend the drawer to the outer most location. Then reach underneath the drawer to the attaching clips located at the front of the drawer box. Then squeeze the clips pulling toward the sides which will release the glides from the drawer box (Figure 7). The drawer will now be ready to be removed. Lift the drawer away. To reinstall the drawer, make sure glides are pushed in all the way into the cabinet. Set the drawer back in the glide tracks and push the drawer all the way into the cabinet. When the clips attach to the glide you will hear a click. The glides will align automatically when the drawer is pushed back in.

### DRAWER FRONT ALIGNMENT

If there is a need to adjust the drawer front, locate the drawer clips attached to the underside of the drawer box, where it is connected to the drawer glides. Slide the noted tab on the clip to raise or lower as needed (Figure 7). Typically, only one side needs to be adjusted and can be done by touch without removing the drawer from the glides.

## Standard Fillers/Decorative Fillers

**Decorative Fillers:** In contrast to standard fillers, which are trimmed for a proper fit to complete a cabinet run, decorative fillers require a 3 in. spacing between cabinets.

### STANDARD CABINET INSTALLATION

- Remove doors and drawers.
- Using 3/16 in. drill bit, pre-drill holes through face frame, minimum of 2 holes per side.
  - If you like, you can remove hinge plate(s) and drill holes so that they will be covered by the hinge plate.
- Clamp filler in place. To prevent possible wood splitting, drill pilot hole with 1/8 in. drill bit into filler
- Secure filler in place with #8 x 2½ in. countersunk screws (Figure 8).
  - Reinstall the hinge plate to cover the countersunk screws.

## Toe Kick Installation

**Note:** Flush-fit end panel(s) should be installed before attaching the toe kick.

The toe kick should be attached once all of your cabinets have been installed and secured to the wall. Cut the toe kick to your exact dimensions. Use small finishing nails to attach the toe kick to your cabinets. It is recommended that a bead of high quality caulking material be used to seal the toe kick to the floor (Figure 9).

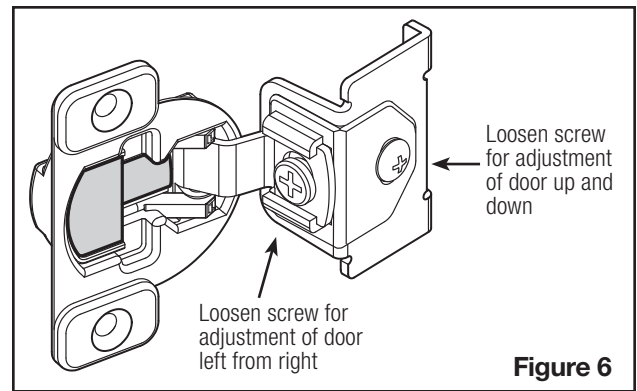

Figure 6

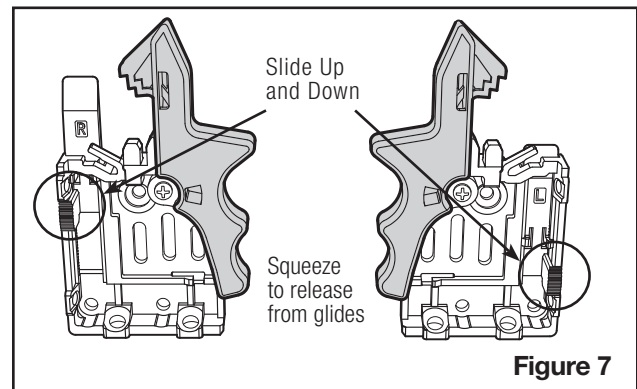

Figure 7

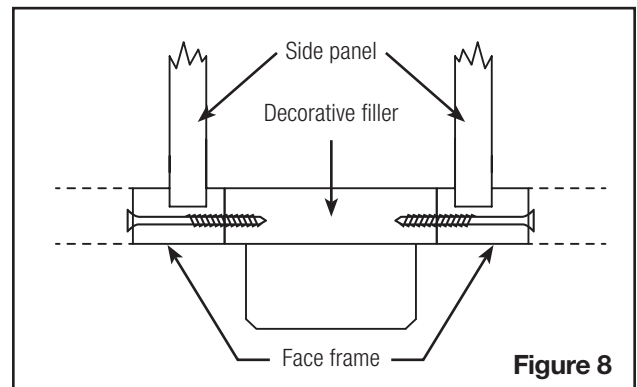

Figure 8

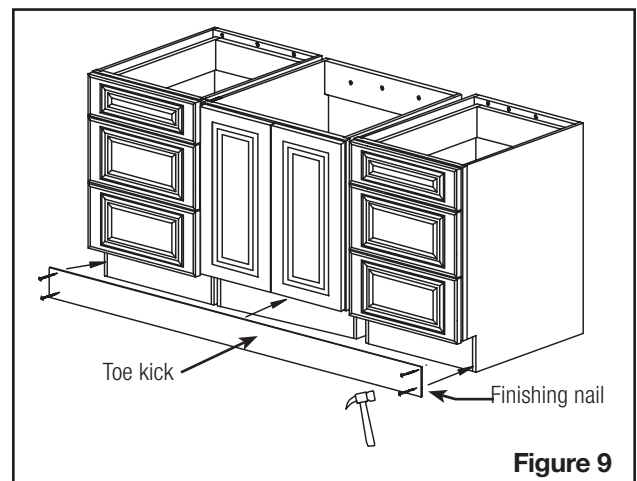

Figure 9

## Decorative Foot Installation

Before installing decorative foot, you will need to install the standard  $\frac{1}{8}$  in. finished toe kick (see Toe Kick Installation).

When installing the decorative foot it will be necessary to remove the doors or drawers from the base cabinets or drawer banks.

- When installing a foot under a filler, apply double-sided tape and adhesive to the back side of foot to secure in place.
- When installing a foot under a base, in addition to the back side adhesion noted above, use a  $\frac{1}{8}$  in. drill bit to pre-drill a hole just behind the face frame.
- Using #8 x 2 in. wood screw, secure the foot into place (Figure 10).

Note: If the floor is uneven and the foot doesn't fit under the vanity, stabilize the foot on its top and using a sanding block and 100 grit sand paper, grind down the bottom as needed to fit. Or use a miter saw to cut as needed.

## Toe Valance Installation

Before installing toe valance, you will need to install the standard  $\frac{1}{8}$  in. finished toe kick (see Toe Kick Installation).

Once the doors and/or drawers are removed, place the clear vinyl spacers (included), under the vanity between the face frame and toe kick. These spacers will help prevent the toe valance from rocking when clamped into position (Figure 11).

If installing valance with feet, it is best to start at one end of the cabinet and work your way across (Figure 12).

- Clamp into position.
- Using  $\frac{1}{8}$  in. drill bit, pre-drill hole just behind the face frame into the toe valance.
- Using #8 x  $1\frac{1}{4}$  in. wood screw, secure the toe valance into place.
- Continue installing the remaining feet and toe valances in the same manner.
- Reinstall the doors and drawers.

## Hardware Installation

Once all the doors and drawers are adjusted, pre-mark the fronts where hardware is desired.

Drill through your marks from the outside of the door to the inside. A  $\frac{1}{8}$  in. drill bit is recommended to allow for final adjustments to exact alignment.

Note: To help prevent "blowout" (rupture of the surface when drilling), clamp a piece of scrap wood to the back of the drawer or door prior to drilling (Figure 13).

## Scribe Moulding

Use scribe moulding to put the finishing touch on cabinets that are installed against uneven walls. Using finishing nail, install scribe moulding to cover gaps between the cabinets and uneven floors or walls.

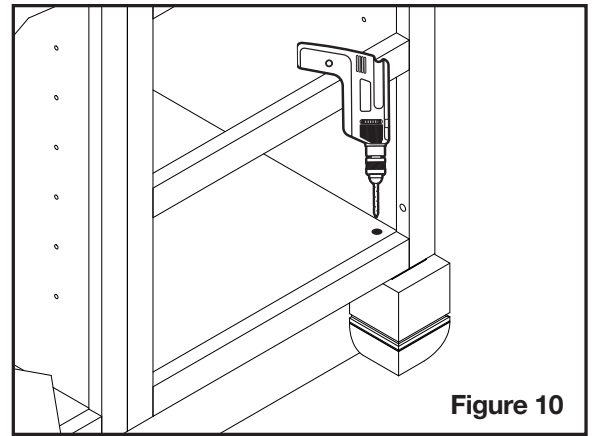

Figure 10

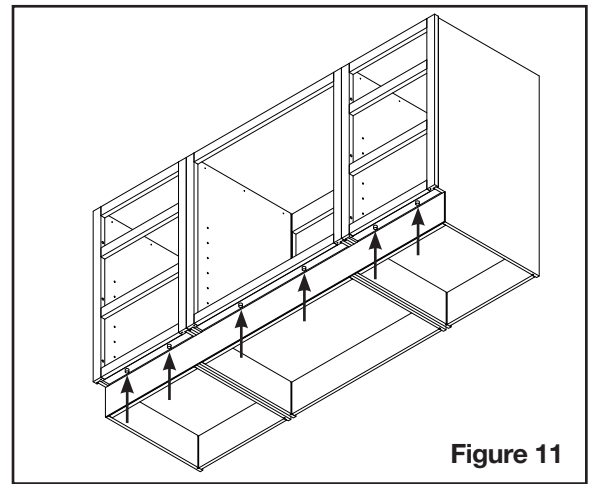

Figure 11

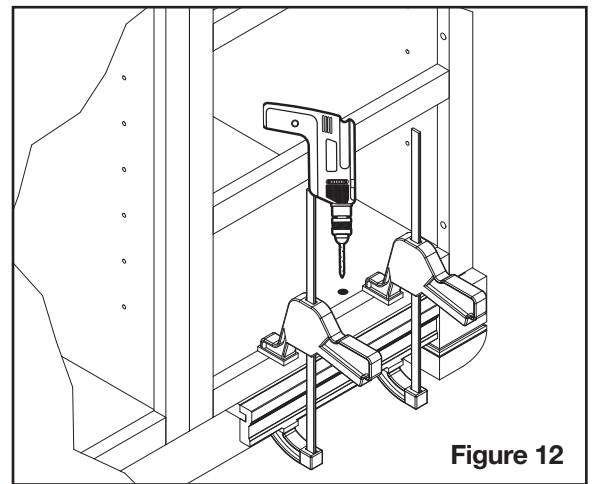

Figure 12

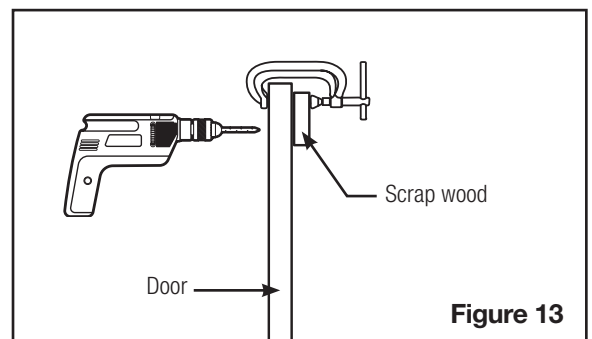

Figure 13

# Floor Hutch

The floor hutch is assembled with the finished flush-fit end panels unattached. You will need to apply the flush-fit end panels to the side(s) of the cabinet that will be exposed to the room. Just follow the simple steps below.

## Flush-Fit End Panel

### MATERIALS

Finished flush-fit end panel and a roll of double-sided tape (suggested 1 roll per flush-fit end panel) or construction adhesive or white glue (neither are provided).

### TOE NOTCH INSTRUCTIONS

Note: If flush-fit end panel is on the left side of cabinet, the toe notch will be on the right edge of the flush-fit end panel. If the flush-fit end panel is for the right side of the cabinet, the toe notch will be on the left edge of the flush-fit end panel.

#### To cut the toe notch out of the flush-fit end panel:

- Lay the panel up against the cabinet side to be covered and align all four edges with the cabinet.
- Using a pencil, draw a line to mark the location of the toe notch
- Using a power saw, cut along the line.

Apply double-sided tape or adhesive to the backside of the flush-fit end panel. (Figure 14).

#### If using tape:

- Cut the roll of double sided tape into strips. Cut tape strips to the lengths and quantities listed on the tape template. You will need approximately one roll of tape for each flush-fit end panel.
- Apply the tape to the flush-fit end panel following the tape template diagram. Tape strips applied along the edges of the flush-fit end panel should be 1/4 in. from the edge.
- As you apply each tape strip, run your finger along the strip, applying pressure to make sure the tape makes complete contact with the flush-fit end panel.

#### Apply flush-fit end panel to cabinet side panel

- Remove the backer from each tape strip.
- Holding the flush-fit end panel at an angle from the cabinet side panel, align the front edge of the flush-fit end panel to the face frame. Make sure the entire edge of the flush-fit end panel is seated inside the face frame groove.
- Align the top of the flush-fit end panel with the top of the cabinet side panel and press the flush-fit end panel against the side panel.
- Working from front to back, apply pressure along the entire surface of the flush-fit end panel to make sure each tape/ adhesive strip makes complete contact with the cabinet side panel.
- Allow the tape/adhesive to cure at least 1 hour before proceeding with the cabinet installation. Clamps or weights can be added to secure panel until adhesive dries. Check adhesive manufacturer's instructions for cure time.

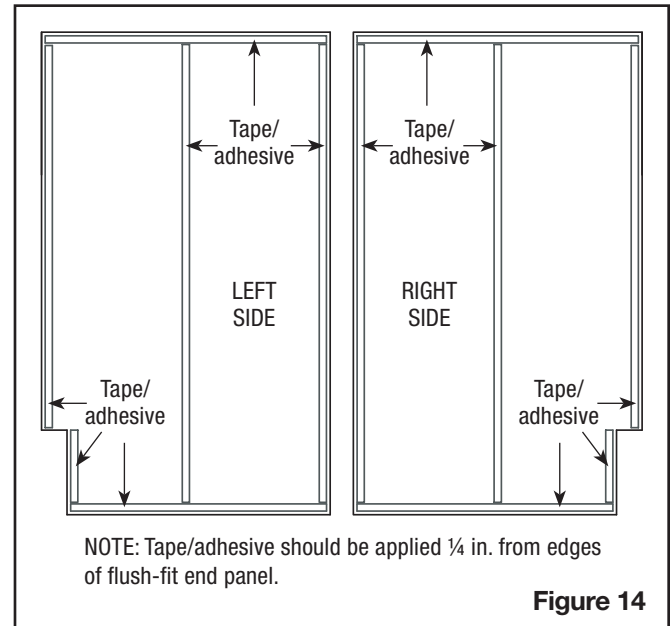

### COUNTER TOP

The floor hutch is assembled with the color matched countertop unattached to allow flexibility of installation of an alternate top. Attach the counter top after you attached the flush-fit end panel. Apply adhesive (not included) to the top of the cabinet and position the counter top in place. Follow adhesive manufacturer's instructions for cure time before moving the cabinet. Clamps or weights can be added to secure the top until the adhesive dries.



## Care and Cleaning

---

### EXTERIOR CARE AND CLEANING

For normal spills, a damp cloth is sufficient. Remember to dry the surface immediately. Lemon oil is recommended for cleaning wood doors. Most furniture care products, not containing wax, petroleum solvents or silicone can be used for polishing. Do not use caustic agents and/or abrasive scrubbers. Nicks and dings can be repaired using the color sticks. Fill in the scratch or nick using the color stick. A Clear Coat spray may be applied if desired.

### INTERIOR CARE AND CLEANING

Cabinets can be cleaned with a damp sponge or cloth using soapy water. Do not use any type of abrasive scrubbers. Do not let liquids stay on the surfaces for a long period of time. The surface is water resistant, not waterproof.

### MIRRORS

Use a water-dampened cloth to clean the mirror frame. For the mirror, use ammonia-free cleaning products. Avoid using abrasive cleaners.

---

## RSI HOME PRODUCTS, INC. LIMITED WARRANTY

**What This Warranty Covers:** RSI Home Products, Inc. ("RSI") warrants its parts and products to be free of substantial defects in materials and workmanship from the original date of purchase under normal home use. This warranty is offered only to the original consumer purchaser and may not be transferred.

**How Long The Warranty Lasts:** Coverage for all vanity cabinets, fixed vanities, drawer banks, bath storage cabinets, linen cabinets, wall hutches, fillers, and toe kicks last for the life of the product. Coverage for medicine cabinets, mirrors, and accessories lasts for 5 years from the original date of purchase.

**What RSI Home Products Will Do Under The Warranty:** During the warranty period, RSI, at its option, will repair or replace any part or product that proves to have substantial defects in materials or workmanship, or RSI will provide an equivalent replacement product. In keeping with our policy of continuous product improvement, RSI reserves the right to change specifications in design and materials without notice and with no obligation to retrofit products we previously manufactured.

**How State Law Applies:** This warranty gives you specific legal rights, and you may also have other rights that vary from state to state.

**IMPLIED WARRANTIES:** RSI DISCLAIMS ANY IMPLIED WARRANTY OF MERCHANTABILITY, AND THERE ARE NO WARRANTIES THAT EXTEND BEYOND THE DESCRIPTIONS ON THE FACE HEREOF. TO THE EXTENT THAT SUCH DISCLAIMER IS NOT VALID UNDER APPLICABLE LAW, ANY IMPLIED WARRANTY SHALL BE COEXTENSIVE IN DURATION WITH THIS WARRANTY.

**Wood, Aging and Printing Limitations:** Because of the varying natural characteristics of wood and the effects of aging, product shown in displays and/or printed materials will not be an exact match to new cabinetry you will receive. Depending on the wood characteristics, the age of the sample and the environment of the showroom, samples will show some degree of variation from new product. In addition, you should not expect all doors, drawer fronts, trim or moulding to match exactly in either finish or grain. Variation in wood is normal and unavoidable. In addition, it is not possible to exactly match our colors in printed materials. Therefore, you should view the actual samples when making your color selection.

**What This Warranty Does Not Cover:** This warranty does not cover any problems or damage which result from improper transportation, improper installation, mishandling, misuse, abuse, neglect, abnormal use, commercial use, improper maintenance, non-RSI repairs, accidents, or acts of God, such as hurricanes, fire, earthquakes or floods. This warranty and any applicable implied warranties do not cover incidental or consequential damages arising from any defects in the product, such as labor charges for installation or removal of the product or any associated products. This warranty does not cover defects or damages caused by normal wear & tear, alterations, environmental conditions, humidity absorption, or mold. In addition, variations in wood grain, finish color, aging or other natural wood and stain characteristics are not considered defects and are not covered by this warranty. Some states do not allow the exclusion or limitation of incidental or consequential damages, so the above limitation or exclusion may not apply to you.

**How To Obtain Warranty Services:** If you need replacement parts or would like to make warranty claim, please contact our Customer Service Representative by mail, e-mail, fax, or telephone at the address or phone numbers listed on this page. All warranty claims must include the model number of the product, copy of the original receipt and the nature of the problem. In addition, RSI may at its discretion require inspection of the installation site or authorize the prepaid return of the claimed defective part. Merchandise not pre-approved for return will not be accepted and the associated claim not accepted.

If upon inspection you find our product has a damaged or missing part, it may not be necessary to return the unit to the store of purchase. Please contact RSI Customer Service to obtain a replacement part.

Customer Service and Parts Department  
Voice: (800) 221-3051 • Fax: (714) 449-2208  
Email: [villabathcs@rsihomeproducts.com](mailto:villabathcs@rsihomeproducts.com)