

QUOIZEL

6 CORPORATE PARKWAY
GOOSE CREEK, SC. 29445
www. quoizel. com

Quoizel, Inc.
6 Corporate Parkway
Goose Creek, SC 29445

Customer Service
Phone 631.273.2700
Fax 631.231.7102
www. quoizel. com

Assembly Instruction Sheet #IS-VVWH9348IB For Style VVWH9348IB

Tools Required: Flathead screwdriver, Phillips screwdriver.

Bulb Recommended: LED 5W

Estimated Assembly Time: 15-20 minutes

Preparation: Identify and inspect all parts before beginning installation. Check package content list and diagrams below to be sure all parts are present. If any parts are missing or damaged, do not attempt to assemble, install, or operate the fixture. Contact customer service for replacement parts.

⚠ Warnings and Cautions

Turn off electricity at circuit breaker or main fuse box before installation. Consult a licensed electrician if in doubt.

These instructions are provided for your safety. It is very important you read them completely before installing the fixture. We strongly recommend that a licensed, professional electrician perform the installation.

Disconnect fixture from power source before replacing bulbs. Make sure bulbs are given sufficient time to cool before removal. Do not subject glass parts to any shock while in operation or shattering may result.

Package Contents

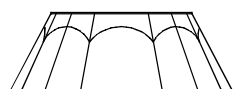

A Shade
x 1

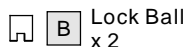

B Lock Ball
x 2

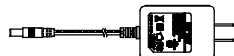

C Plug
x 1

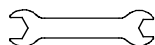

D Wrench
x 1

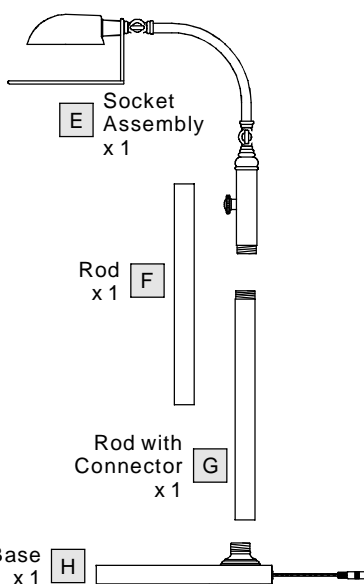

STEP 1 - Install Rods, Socket Assembly to Base

- Thread the Socket Assembly (E) and the Rods (F/G) to the Base (H) together as shown. Hand tighten until snug. Note: If the shade holder and the base are not lined up after assembly, unscrew the hex nut on the bottom of the base with the wrench (D), adjust the rods until the shade holder and the base are lined up. And then secure the rods to the base. Hand tighten until snug with the Wrench (D).
- Attach the Shade (A) onto the Shade Holder and secure with the Lock Balls (B). Hand tighten until snug with screwdrivers.
- Adjust the Support Arm and the Shade Holder to proper location by

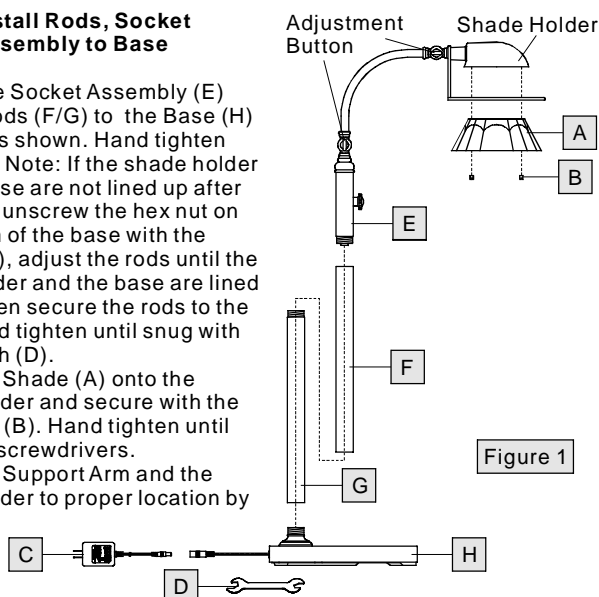

adjust the Adjustment Buttons.

D. Insert the Plug (C) into the cord from the Base (H) as shown.

Your fixture is now assembled and ready to use. Enjoy!

Replace LED Lamp

- Remove the shade from the fixture by unscrewing the lock balls.
- Unscrew the lock screws from the shade and remove the diffuser from the shade.
- Unscrew the screws on the LED Lamps and remove the LED lamp. Pull out the connectors from the fixture and separate the connectors on the wires.
- Connect the female connector of the replacement LED lamp to the male connector from fixture. Attach the LED lamp into the shade holder and secure with the removed lock screws.
- Place the diffuser back onto the shade and secure with the removed screws. Hand tighten until snug. Attach the shade back onto the shade holder and secure with the lock balls. Hand tighten until snug.

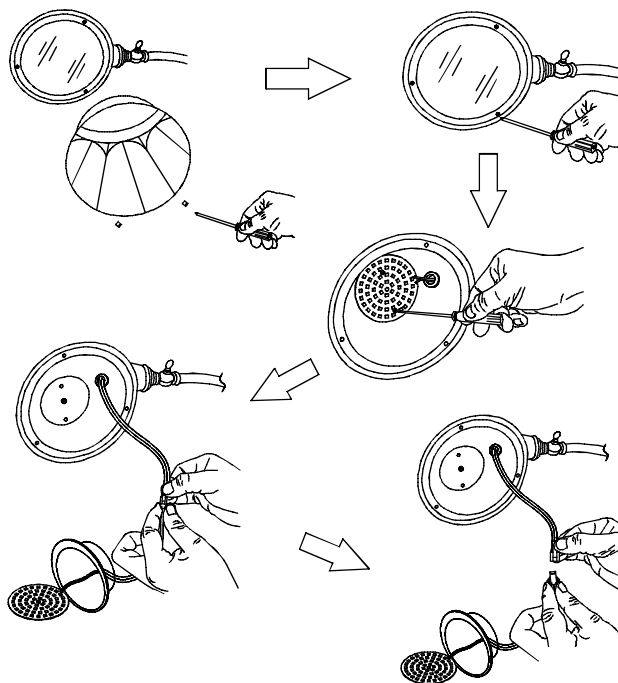

Thank you for purchasing a Quoizel product.
Need assistance with parts or assembly? Call Quoizel customer service at 1-631-273-2700
or visit us on-line at www. quoizel. com

VVWH9348IB

FINISH:IMPERIAL BRONZE

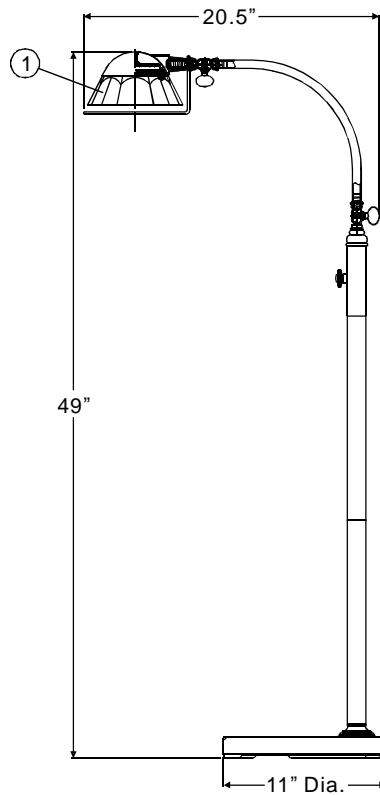

NOTE: ALL DIMENSIONS ARE ROUNDED UP TO THE NEAREST 1/2"

NO.	PART NUMBER	REPLACEMENT PART DESCRIPTION	REQ.
1	S1615MC	SHADE MICA	1

Thank you for purchasing a Quoizel product.
Need assistance with parts or assembly? Call Quoizel customer service at 1-631-273-2700
or visit us on-line at www.quoizel.com