

ASSEMBLY INSTRUCTIONS

Corner Wall Cabinet

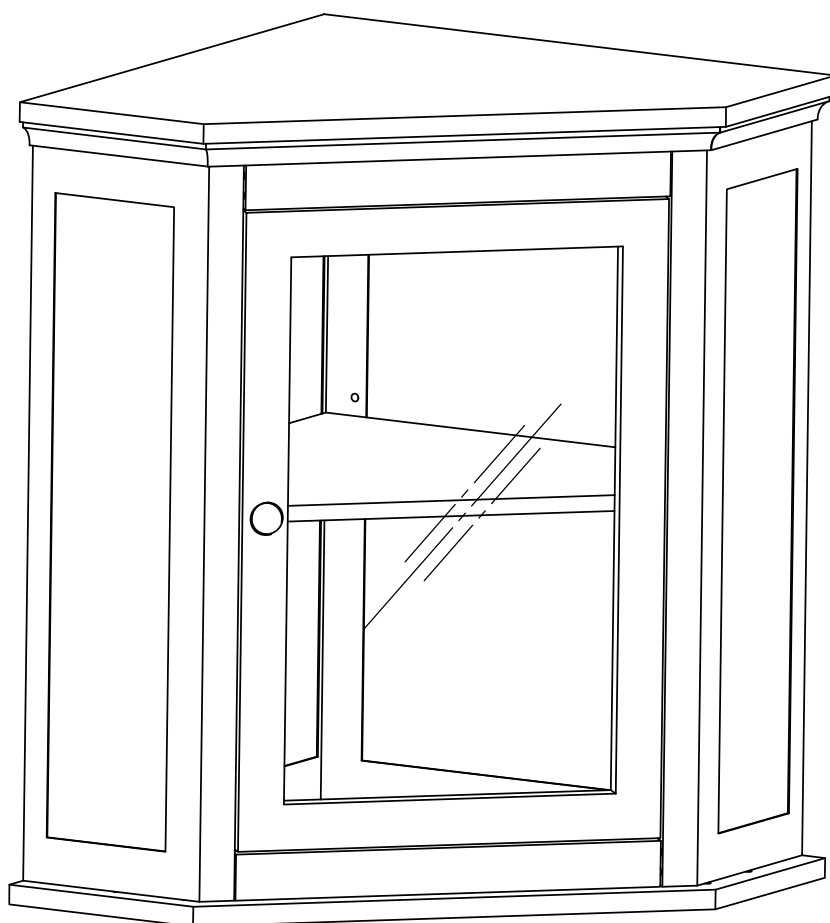

ASSEMBLY INSTRUCTIONS-IMPORTANT

Carefully unpack & identify each component before attempting to assemble. Refer to parts list. Please take care when assembling the unit and always set the parts on a clean, soft surface. If you require any assistance with assembly, parts, please call 866-931-4207.

INSTRUCCIONES PARA ARMAR-IMPORANT:

Desempaque cuidadosamente e identifique cada componente antes de tartar de empezar su ensambladura. Verifique la lista de partes. Por favor tenga cuidado cuando arme la unidad y siempre coloque las piezas sobre una superficie plana, suave y limpia. Si necesita ayuda con el armado, por favor llamada 866-931-4207

DIRECTIVES DE MONTAGE-IMPORTANT:

Avant de commencer l' assemblage, déballez délicatement toutes les pièces et repérez-les sur la liste des pièces. Procédez avec soins durant l' assemblage et posez toujours les pièces sur une surface proper, douce et lisse. Si vous avez besoin d' aide cocernant l' assemblage Svp appel 866-931-4207.

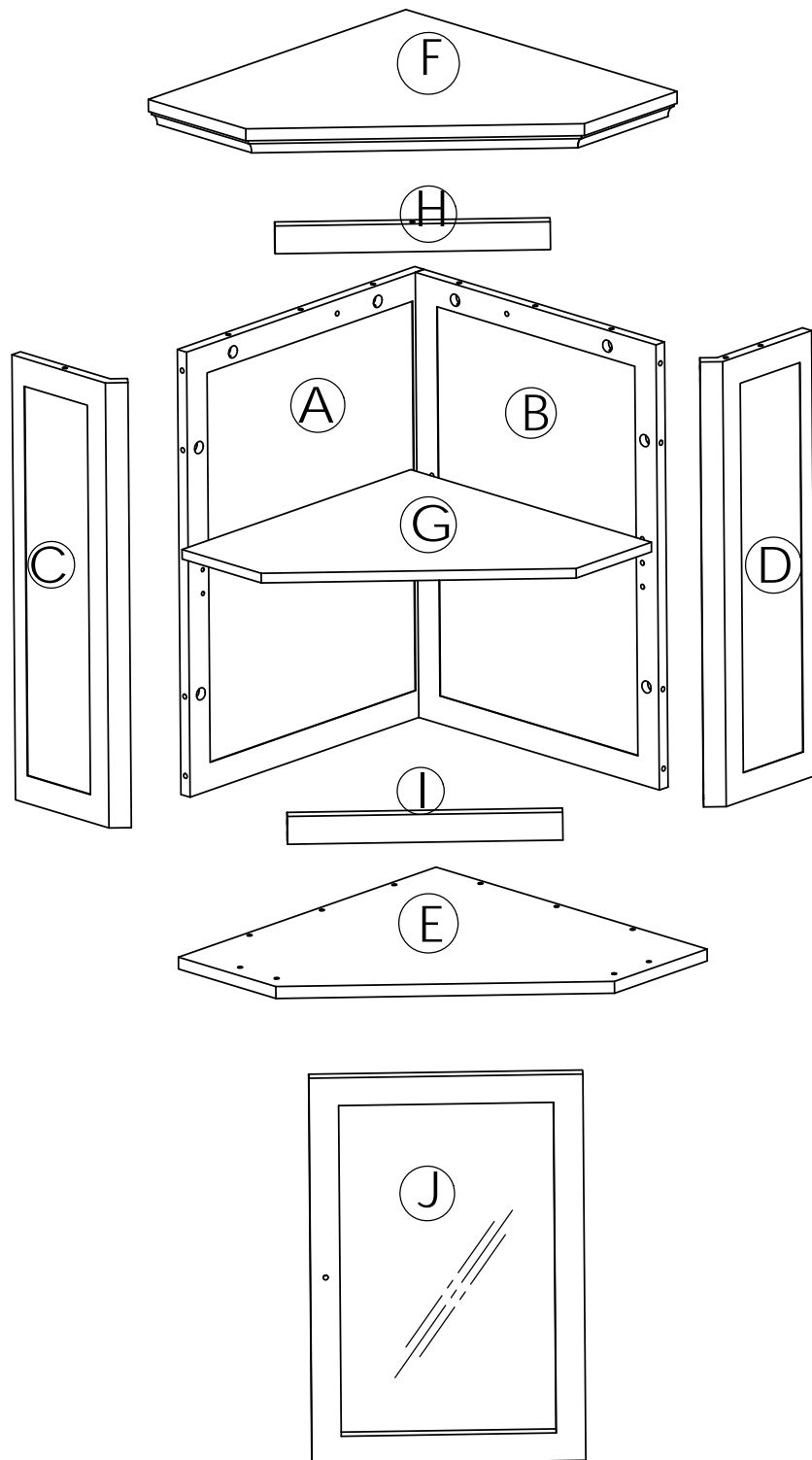

1

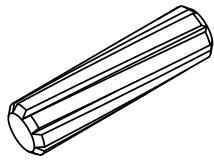

∅ 6X30 20pcs

2

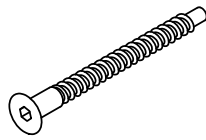

M5X40 3pcs

3

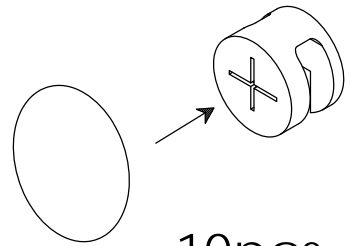

10pcs

4

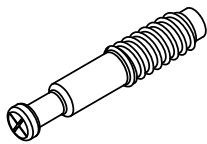

10pcs

5



M3X12 8pcs

6

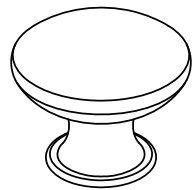

1PC

7

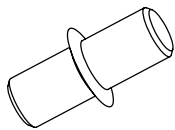

5pcs

8



M4X20 1PC

9

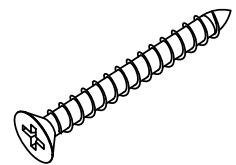

M4X35 2PCS

10

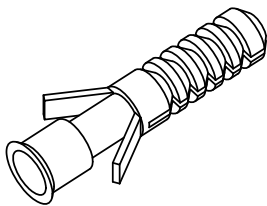

2pcs

11

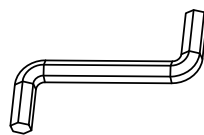

1PC

12



M4x30mm 7pcs

STEP 1

ÉTAPE 1

PASO 1

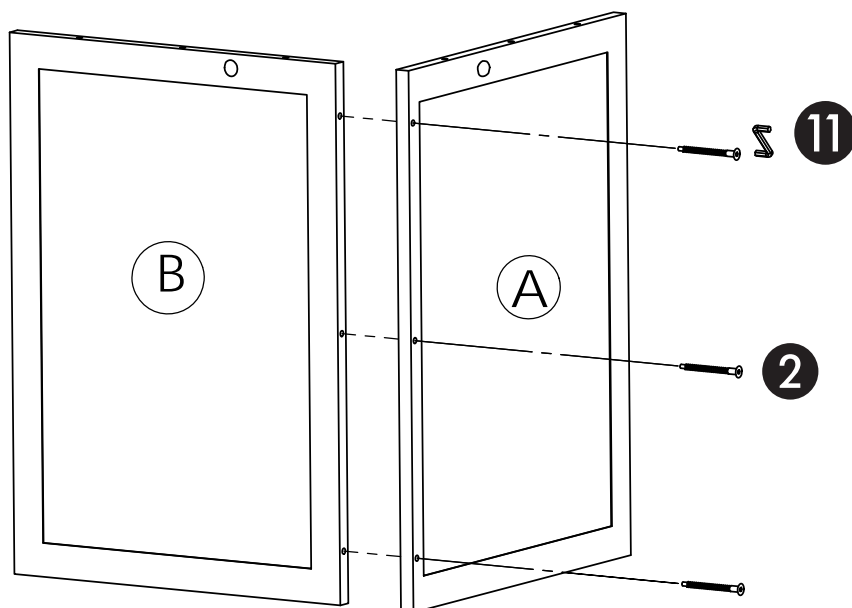

STEP 2

ÉTAPE 2

PASO 2

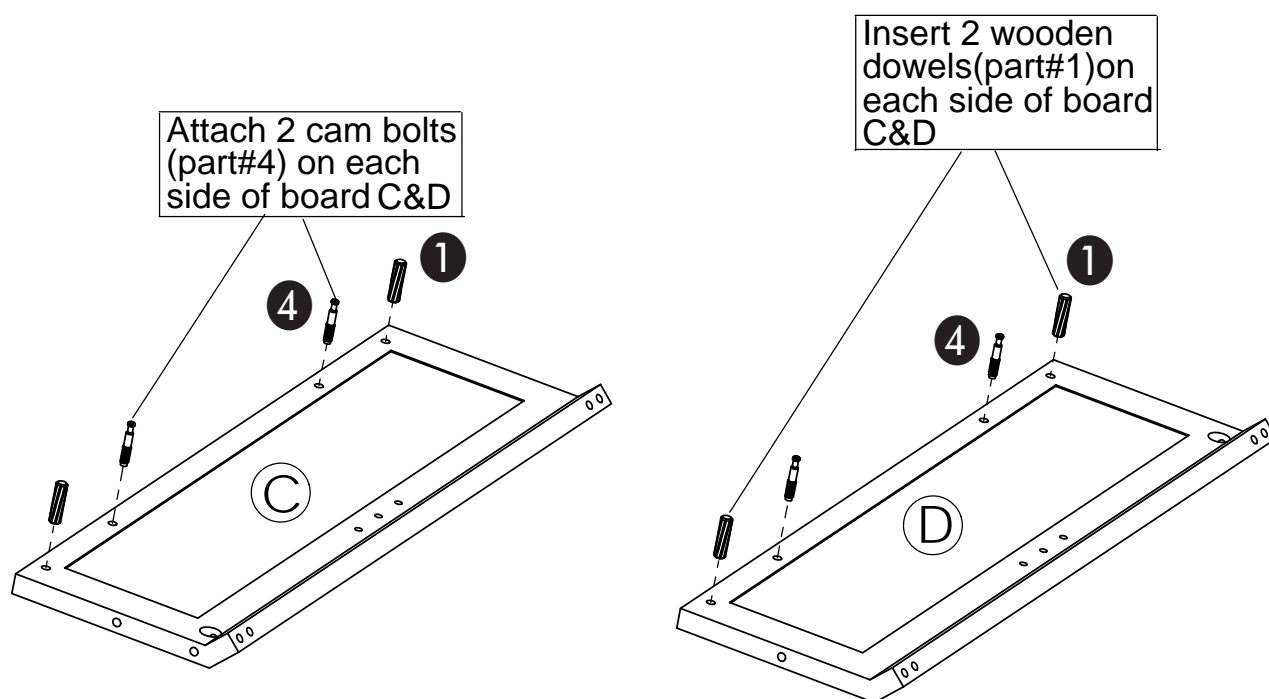

STEP 3

ÉTAPE 3

PASO 3

Make sure the magnet is on the bottom and face front

Insert 2 cam locks (part#3) on each side of panel A&B
Turn cam locks clockwise to secure.

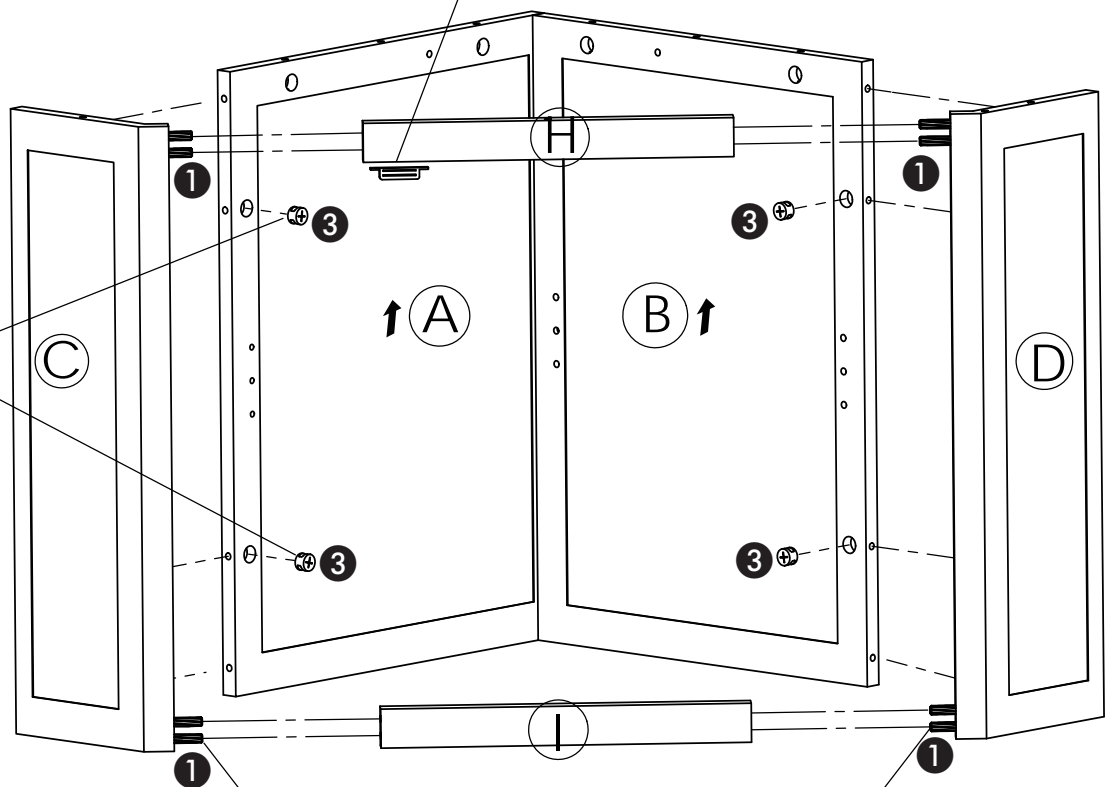

Insert 4 wooden dowels (part#1) on each side of panel C&D.

STEP 4

ÉTAPE 4

PASO 4

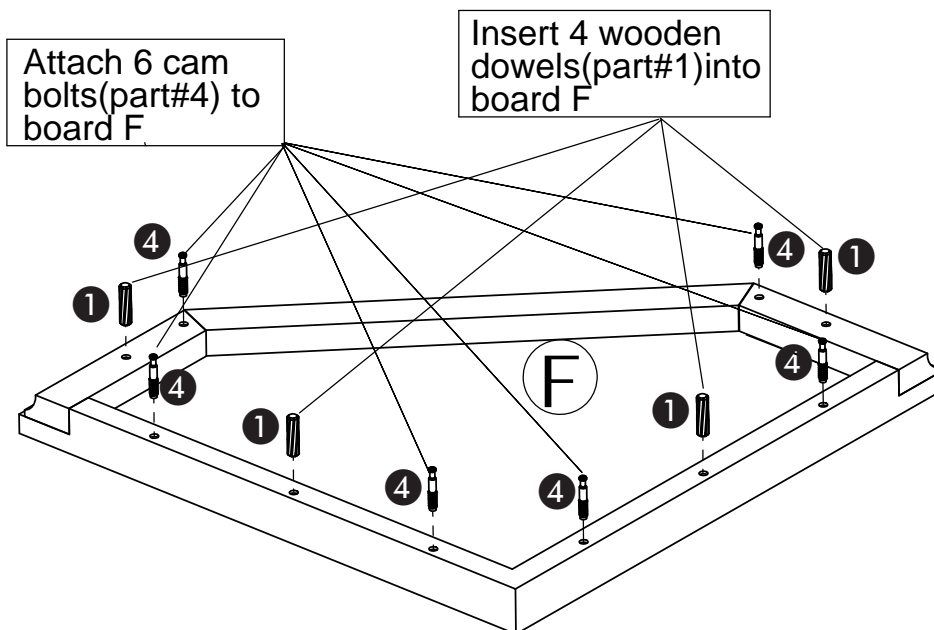

Insert 6 cam locks (part#3)into panel A&B&C&D. Turn them clockwise to secure.

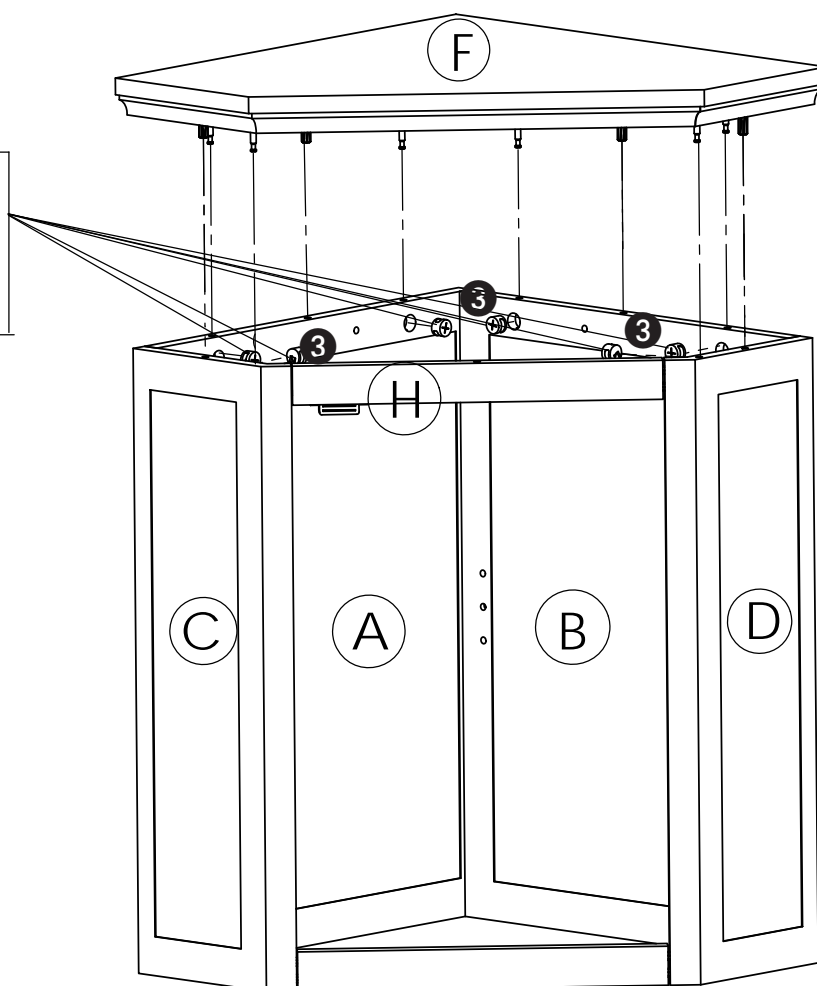

STEP 5

ÉTAPE 5

PASO 5

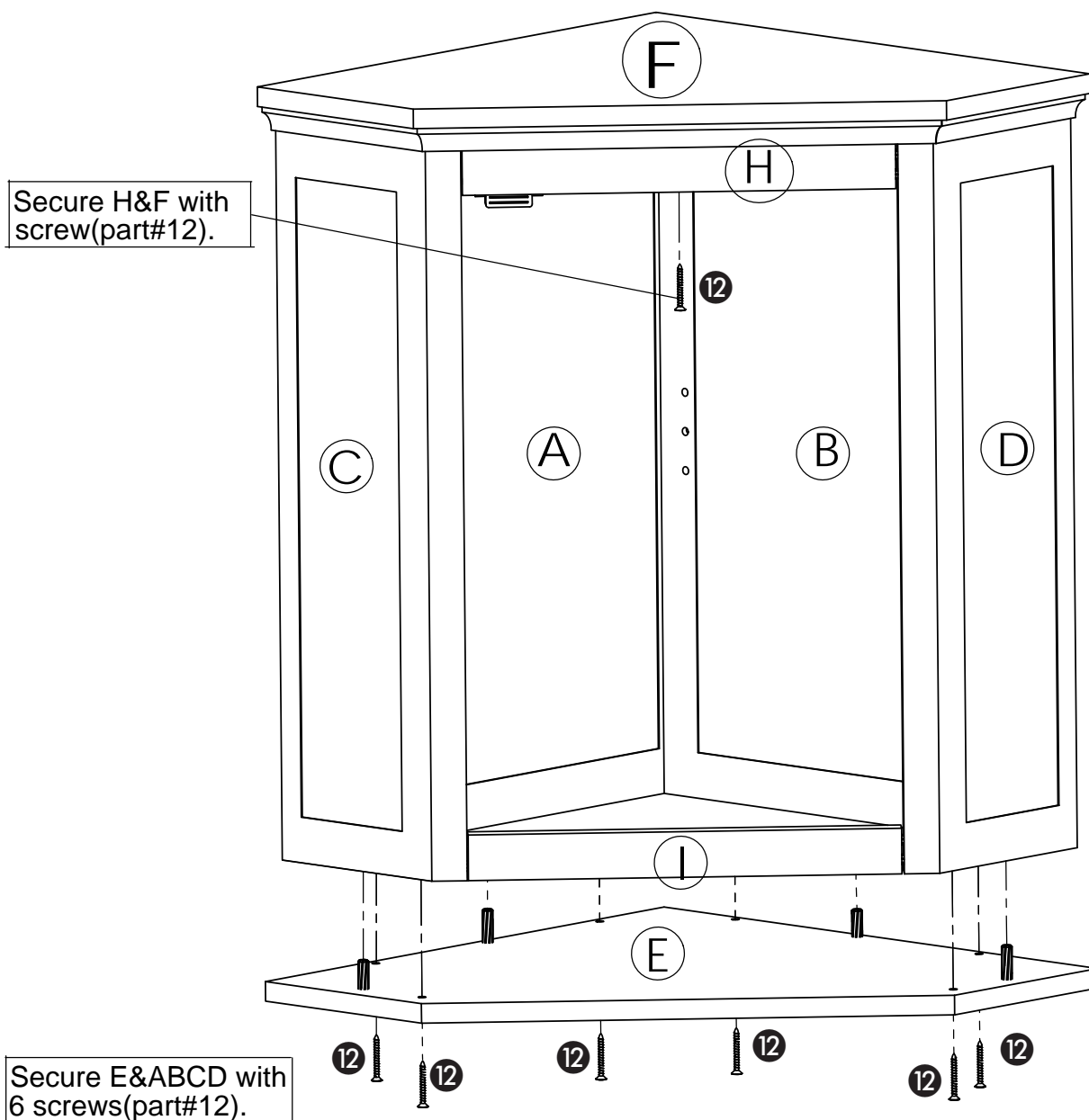
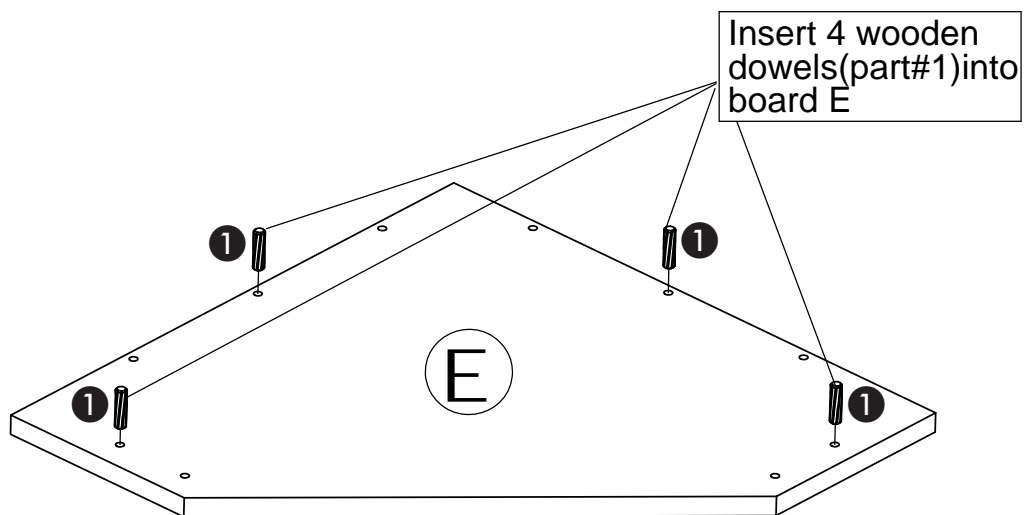

STEP 6

ÉTAPE 6

PASO 6

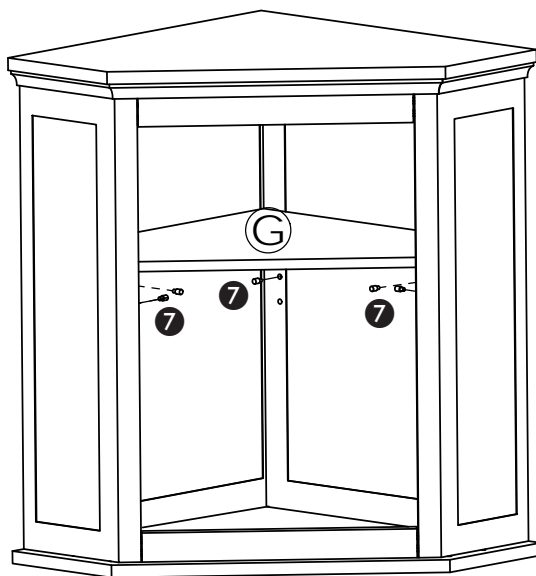

STEP 7

ÉTAPE 7

PASO 7

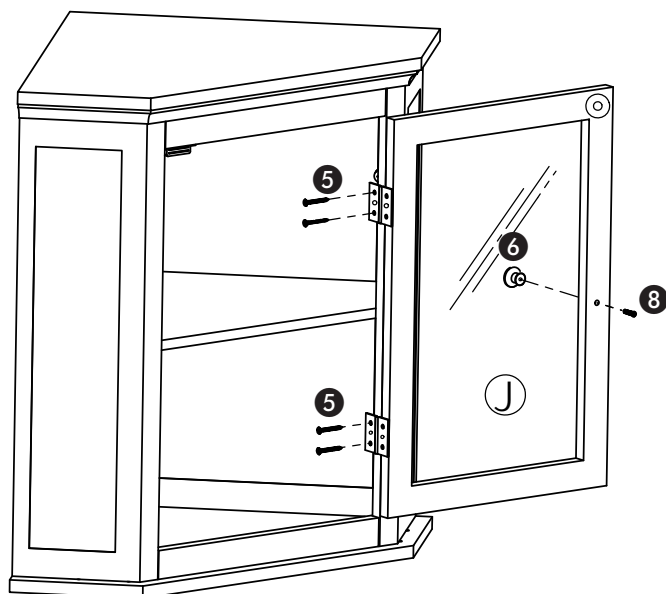

Door Aligning Instructions

Attach the hinges with screws(part#5).Adjust the position of the hinges so the door lines up with the opening prior to tightening the screws.

Finish by securing the hinges to the cabinet.

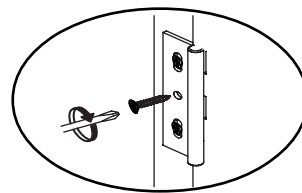

Loosen the screws attaching the hinges to the door itself and adjust their positioning if required,then tighten the screws again.

Finish by securing the hinges to the door.

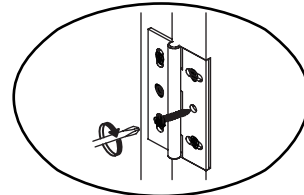

STEP 8

ÉTAPE 8

PASO 8

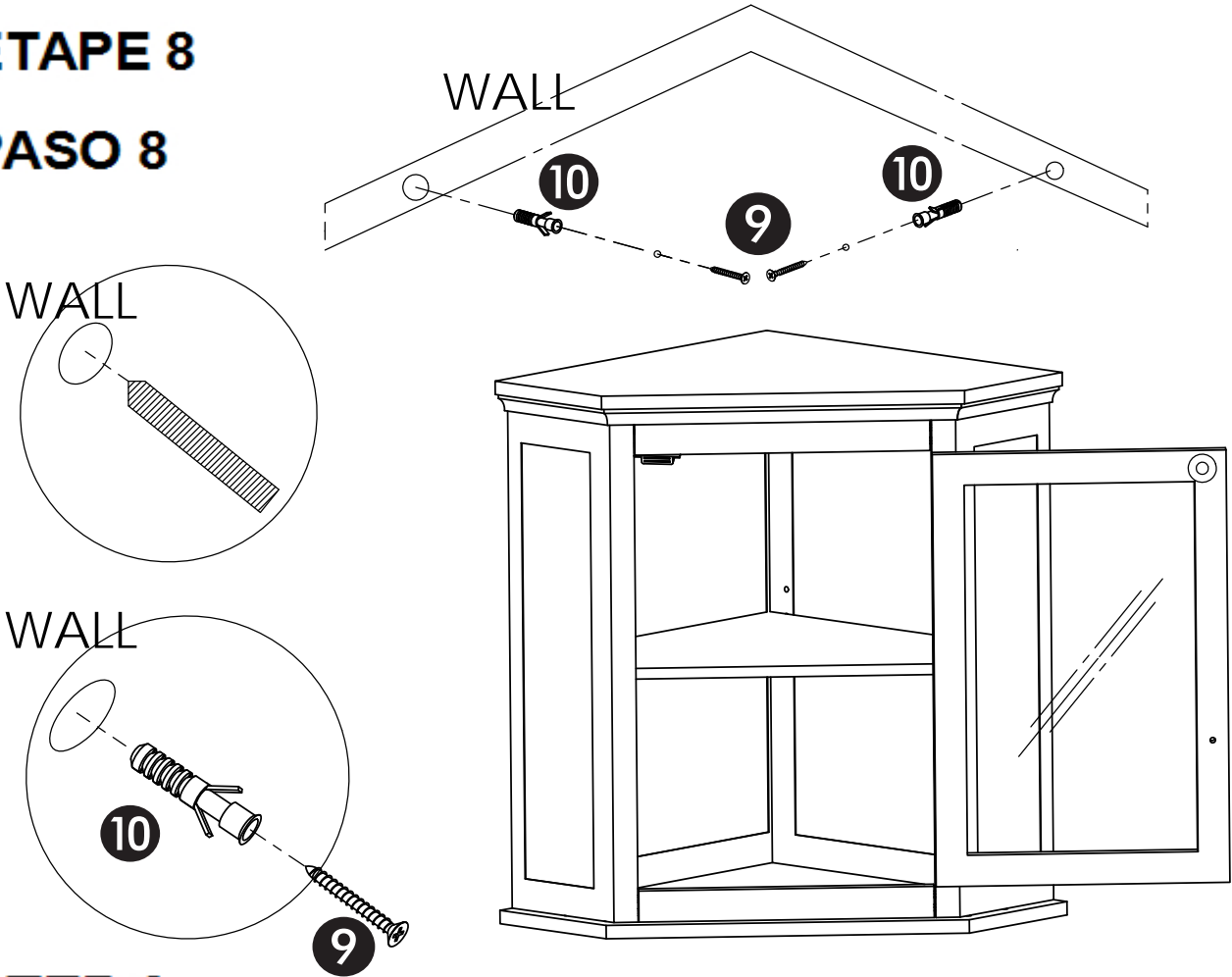

STEP 9

ÉTAPE 9

PASO 9

