



'Life Tastes Good' Global Company

Kuvings®



Instruction Manual

Kuvings Silent Juicer



IMPORTANT SAFEGUARDS

When using electrical appliances, basic safety precautions should always be followed including the following:

1. Read all instructions.
2. To protect against risk of electrical shock do not put motor or base of unit in water or other liquid.
3. Close supervision is necessary when any appliance is used by or near children.
4. Unplug from outlet when not in use, before putting on or taking off parts, and before cleaning.
5. Avoid contacting moving parts.
6. Do not operate any appliance with a damaged cord or plug or after the appliance malfunctions, or is dropped or damaged in any manner. Return appliance to the nearest authorized service facility for examination, repair or electrical or mechanical adjustment.
7. The use of attachments not recommended or sold by the manufacturer may cause fire, electric shock or injury.
8. Do not use outdoors (this may be omitted if it is specially designed for outdoor use).
9. Do not let cord hang over edge of table or counter.
10. Do not let cord contact hot surface, including the stove.
11. Always make sure juicer cover is clamped securely in place before motor is turned on.
Do not unfasten clamps while juicer is in operation.
12. Be sure to turn switch to OFF position after each use of your juicer. Make sure the motor stops completely before disassembling.
13. Do not put your fingers or other objects into the juicer opening while it is in operation.
If food becomes lodged in opening, use food pusher or another piece of fruit or vegetable to push it down. When this method is not possible turn the motor off and disassemble juicer to remove the remaining food.
14. Do not use the appliance if the rotating sieve is damaged.
15. When a separable pulp container is provided, Do not operate without the pulp container in place.

SAVE THESE INSTRUCTIONS

SAFETY PRECAUTIONS

The following information is intended so as to prevent damage to the unit or injury. Please read the following pages and use the appliance properly.

 **This sign warns risk of death or severe injuries**

 **This sign warns risk of injuries or product damage**

 Prohibited

 Must follow instructions

 Must unplug electric cord

 Do not disassemble

 Must take action

 Prevention of electric shock

Safety warning

Do not plug multiple cords into a single outlet or a fire may result.

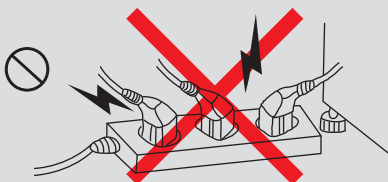

Please unplug the cord when not in use.

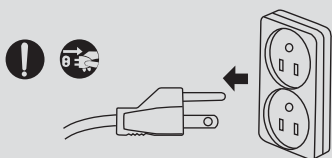

Do not drop the appliance or subject the appliance to any impact.

· Note: Otherwise the appliance may malfunction.



Do not plug in the cord with wet hands or you could receive an electrical shock. Make sure your hands are completely dry prior to use.



Do not spray water or flammable sprays on or near the appliance.

· Note: Otherwise, it may cause an explosion or electrical shock.

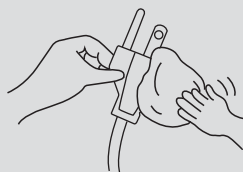

Please do not pull the cord to unplug the outlet. · Otherwise the cord can break and may cause electrical shock or fire.

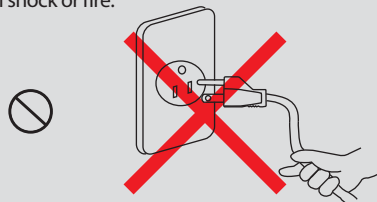

Please do not insert any silverware, other metals or fingers into the appliance while the cord is plugged in.

· Note: Otherwise an electrical shock will occur.



Safety precaution

Do not put the parts in a dishwasher nor very hot water.

· Note: Otherwise, parts will wear faster.



Do not repair, disassemble the base, or customize the appliance.

· Note: Otherwise, you may cause a fire or harm to yourself.



Do not use the appliance on an uneven surface.

· Note: Otherwise the appliance can fall or cause a malfunction.



Do not keep or operate the appliance near infants or small children.

· Note: Otherwise, it may injure them.



Do not use the appliance near any heat source

· Note: Otherwise the appliance can change color.

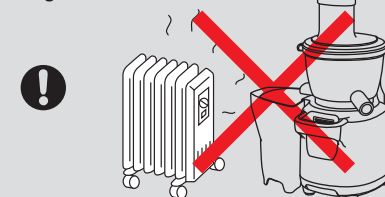

Do not use any cleaning chemicals to clean the appliance.

· Note: Otherwise it may change the color of the appliance or could result in a fire.



Do not curve or twist the cord or put pressure on the cord.

· Note: Otherwise, you may cause a fire or harm to yourself.

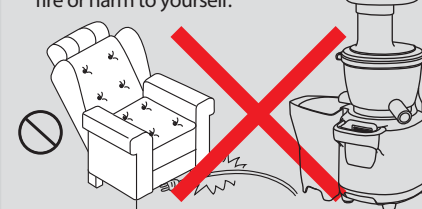

Do not spray water or flammable sprays on or near the appliance.

· Note: Otherwise, it may cause an explosion or electrical shock.

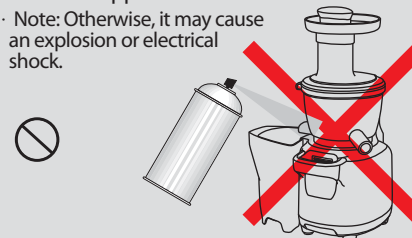

Features

Low speed extraction method

The juicer extracts juice instead of grinding, to retain all the nutrients and enzymes for a healthier, natural juice every time.

Multi-purpose for food preparation and cooking

Extract vegetable juice, soy juice, fruit juice, homemade tofu and more for convenience and speed.

Easy to clean

The juicing bowl and the base come apart easily for cleaning and assembly.

Two-step safety start system

All parts must be assembled properly and the lid must lock securely into place to start the juicer. This assures a safe operation.

Handgrip for ease of use

Handgrip feature makes it easier to use and move.

Powerful motor, no heat build-up

The high powered, low speed motor is able to process very high fibrous fruits and vegetables completely. The unit stays cool due to the slower processing speed.

Quiet operation

The motor is quiet and extracts juice fast.

Convenient auto purifying

Simply pour water into the appliance after each use for self-cleaning. The juice will taste fresher each time you make it.

Parts

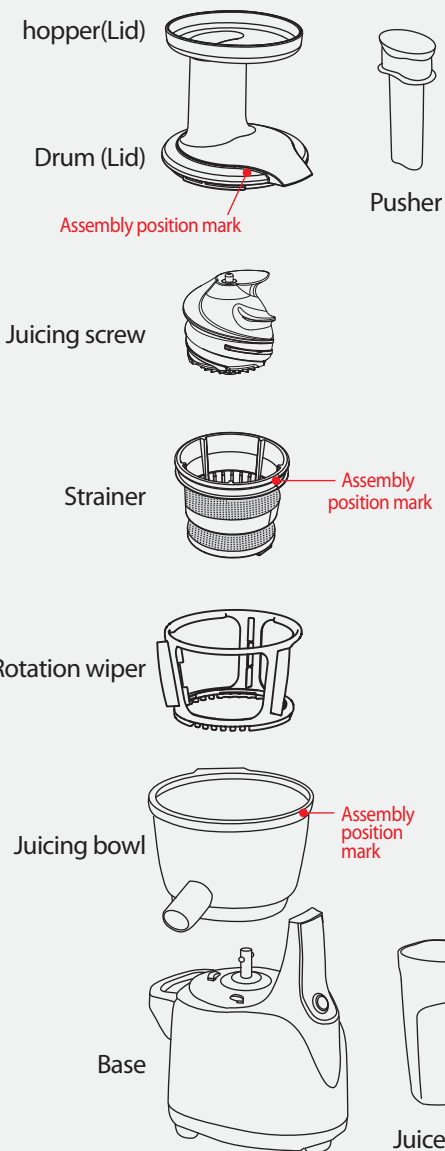

<Two step safety device>

The base and basket must be assembled properly, then turn the switch on.

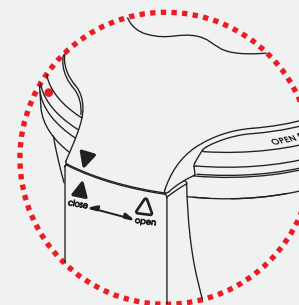

<Power Switch>



How to assemble the parts to a base unit

Disassembly is the reverse steps of assembly steps.

- ❗ Before attaching Juicing bowl to the base unit, check if the pulp extraction silicon is adjusted properly. If pulp extraction silicon is not adjusted properly, juice can leak outside of the juicing bowl and the amount of juice would be less.

1 Underneath the Bowl

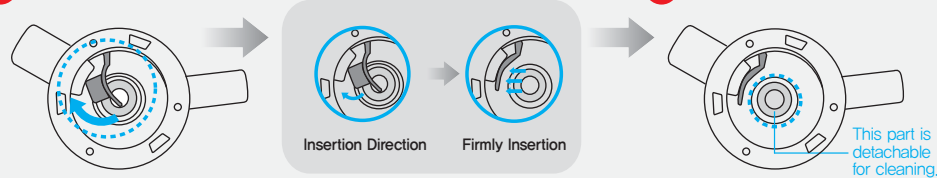

The pulp extraction silicon has to be attached to the pulp outlet. Always insert the rubber gasket properly before use.

1 Place the strainer into a rotation wiper.

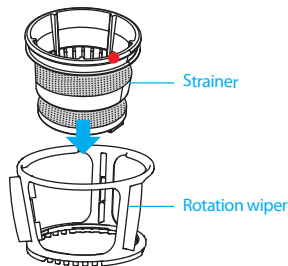

2 Make sure the red dot on the strainer and the red dot on the bowl is aligned.

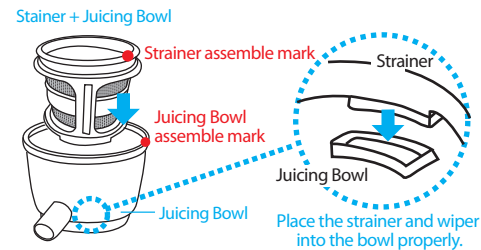

3 Insert the Juicing screw into center of strainer.

※ Spin and push the juicing screw while inserting into the strainer.

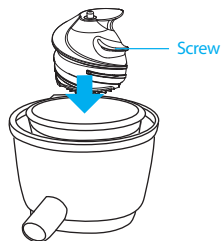

4 Connect the lid and the bowl through the red spot assemble mark and assemble it by turning it the clock-wise.

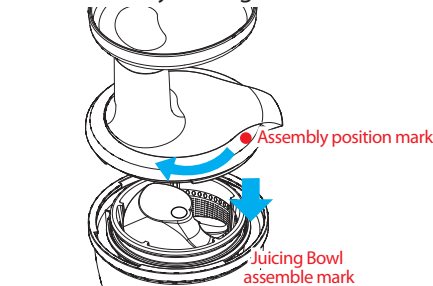

※ Make sure the red spot on the lid and the red spot on the bowl is aligned.

5 Turn the Lid clock-wise until || mark on the lid is alignment with | mark on the juicing bowl unit.

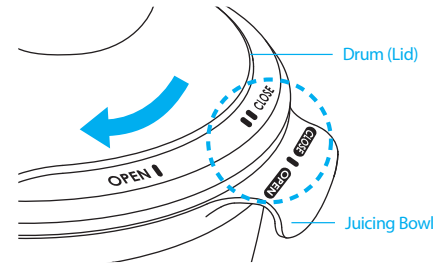

6 Assemble the entire top set onto the base. - Align the ▼ mark on the top set unit into ▲ on the base unit. Turn the top set unit clockwise to match ▼ mark and ▲ mark of the base unit.

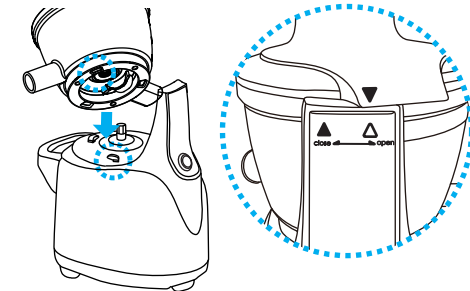

7 Turn the lid towards 'close' mark.

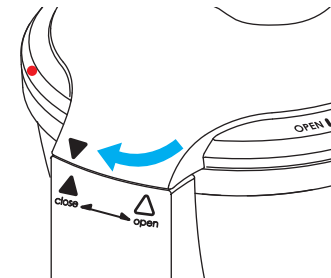

8 Place the pulp container under the base hook.

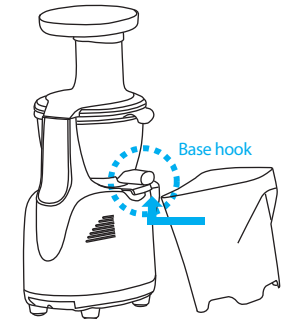

9 Place the juice cup properly.

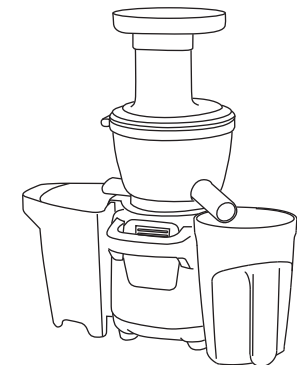

How to use the Silent Juicer

- 1** Please check the power switch is on off then plug the cord into the outlet to turn it on.

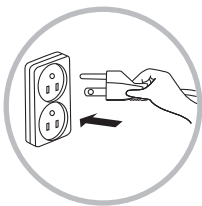

- Do not turn on power switch without anything to extract. (It may cause a malfunction)
- Check if Juice cub and pulp container are set up properly to prevent leaking juice or pulp.
- While in use, the appliance will be making a beep noise. The noise is the screw cleaning up the juicing bowl and it will disappear right after inserting fruits or vegetables.

- 2** Clean the fruits or vegetables and cut it in right amount and then insert into the appliance.
- (length 10~15cm, width 2~3cm)

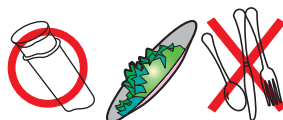

- !** Do not insert spoon, chopstick, fingers or any silverware into the appliance. Please use the pusher to push down the fruits or vegetables.



Notice



- Please insert the fruits or vegetables one by one, when inserting different fruits or vegetables, wait until appliance extracts the other items.
- Please cut high fiber materials into right amount to get the best result. (length 10~20cm)
- When extracting carrot, extract with different vegetable with high fiber to get more juice from the carrot since the carrot has low fiber. Please cut carrot into quarters before inserting it in to get the best result (Different fruits or vegetables have different amount of juice to extract)
- If the fruits or vegetables to be juiced is not fresh, the amount of juice will be less. To get more juice, dip it in the clean water until the fruits or vegetables gets wet. Then the fruits or vegetables will have more juice to be extract.
- Some fruits or vegetables do not have juice that can be extracted (Arrow root, or strong fiber fruits or vegetables)

- 3** If the appliance stops in the middle of operating, then please press the 'OFF' switch and press the 'REVERSE' switch to push back the fruits or vegetables that have been stuck between the screw and the juicing bowl. Then please press the 'FORWARD' switch. (Repeat the procedures 3 times)

- If the appliance still does not work, then Please disassemble the parts and clean the fruits or vegetables to use it again. ('REVERSE' button only works while holding the switch)



- !** While operating 'FORWARD' switch, please press 'OFF' switch and wait until the appliance stops completely to use the 'REVERSE' switch. (If 'reverse' switch is press without being stopped, it may cause the appliance to malfunction.)

- while operating 'REVERSE' the hopper(lid) may would disassemble, so please hold on the hopper with one hand when operating reverse switch.

FORWARD

Pushes down the fruits or vegetables to extract

REVERSE

pushes up the fruits or vegetables

- 4** Be sure to stop the appliance after the pulps and the juices are out of the appliance. (If all the pulps are not removed out of the appliance, It may be difficult to the appliance to open.)

How to disassemble

1

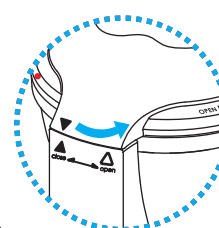

When Silent Juicer stops from operating, please turn the top set towards to 'open' sign.

2



Please detach the top set from the base unit by pulling it up in order to disassemble it.
· The disassembly for the top set is the reverse order of assembly for the top set.

Recipe for juice



After juicing, you might observe the layer separation depends on ingredient's concentration.

Tomato Juice

A Tomato is a typical vegetable juice which itself is a very refreshing juice. Lycopene is a red pigment which is an antioxidant that causes the inhibition of cell aging and also the sour taste will boost up the citric acid which is best for morning juice. Cherry tomatoes have a strong sweet taste which is great to make a variety juices with different fruit.

1. For organic tomato, just rinse them with running water.
If it is not organic, please use degradable natural detergent to clean tomato.

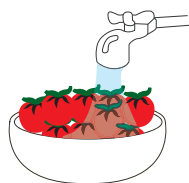

2. Insert the tomatoes into the appliance when they are prepared.

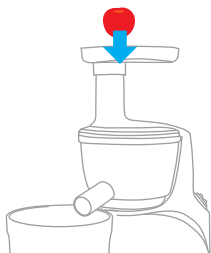

well being prescription

The juice is enriched with vitamin A and C which effectively prevents Cancer, stroke, and heart disease. The tomato acid is great for recovering fatigue and also for relieving queasiness.

(Cherry tomatoes has a higher nutrition and higher density with higher calories which people use often for ingredients of juice)

Carrot Juice

Carrot is one of the best vegetables for high nutrition and has a great taste which is a favorable juice to many people. Carrots have a specially sweet taste which can cover the bitter taste of different vegetable when they are mixed. Carrots contain high pro-vitamin A and carotene, however, consuming 2 carrots has enough of 4 times of RDA for Vitamin A.

1. Non chemically treated carrots are good enough for cleaning with water and chemical treated carrots must be cleaned with soup.



2. Please cut the carrot into the right amounts to insert.



3. Insert the prepared carrots into the appliance and reinsert the extracted carrot juice into the appliance to make it decrease the amount of residue in the appliance, it also makes the juice clear and fresher.



well being prescription

Carrot juice has a high vitamin-A content which prevents skin aging and also makes eyesight better as well as immunity. Carrot juice contains high dietary fiber which is great for diet. One carrot juice per day can normalize the body as well as decrease the chance of getting lung cancer. Carrot juice is one the best drinks for a woman skin.

Maximum rating is based on Model NS-998 under normal load of cutting soaked carrot, other Models may draw significantly less power.

How to clean and store

- 1 Turn the switch to 'OFF' and then unplug the cord.

Remove all the fibers in the juicing bowl before stopping the appliance.

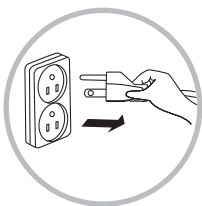

- 3 Disassemble the parts reverse way of assemble.

After use, if the appliance does not get clean, then it is much difficult to clean as well as the reason of the performance resistance.

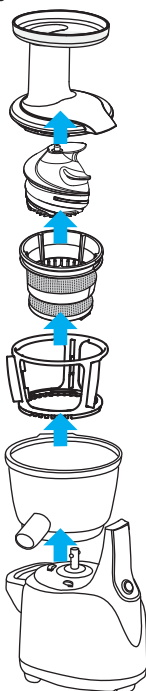

- 2 After using the appliance, hold on to the juicing outlet and turn the juicing bowl to 'open' mark to disassemble the base unit.

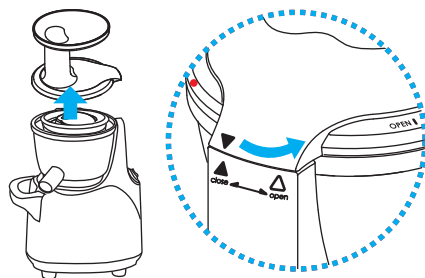

- 4 Strainer, juicing bowl and juicing screw has to be clean with the supplied brush and medium strong detergent. Then keep it dry.



- 5 Clean the base unit wet soft towel.

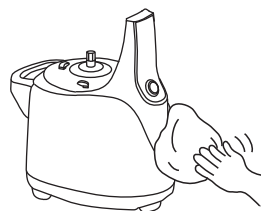

When malfunction occur while using

Hearing unusual noises

- Turn the switch to 'OFF' then check if the parts are assembled properly.
- Check if fruits or vegetables are cut it in right portion.

When Motor does not work.

- Check if the cord is plugged properly.
- Check if all the parts are assembled properly.
- Turn the switch to 'OFF' and let appliance rest for an hour in order to work again.

When appliance stops in middle of operating or re operating, the reason could be either fruits or vegetables are too big to be extract or motor is overheated.

When appliance stops in middle of operating.

- When appliance stops in middle of operating then turn the switch to 'OFF' and press 'REVERSE' switch to unclogged the fruits or vegetables in the juicing screw. Then press the 'FORWARD' switch to push the fruits or vegetables down the screw. (repeat the steps 3times)

If the appliance still does not work, then disassemble the juicing bowl and clean all the fruits or vegetables that has been clogged.

Q&A

Status	Checklist
When motor stops in middle of using.	<ul style="list-style-type: none"> - Check if the cord is plugged properly. - Check if any fruits or vegetables are clogged and when motor works then nothing is wrong with the motor. - Check if "reverse" switch operates.
Seems like juicing screw is grinding.	<ul style="list-style-type: none"> - Juicing Screw and strainer are stuck together, so do not operate for long time when there is nothing to be extract.
Amount of juice is little.	<ul style="list-style-type: none"> - Each fruits or vegetables to be juiced may produce a different amount of juice. - Even same fruits or vegetables can have different amount of juice due to the freshness of the fruits or vegetables. - To extract more juice out of the refrigerated fruits or vegetables, put it in the clean water and wait until the fruits or vegetables are moist enough to be extract. - Carrot has a low fiber which it is hard to extract it, to get a best result extract carrot with different high fiber fruits or vegetables. Such as, kale, leafy green vegetable. Please cut the carrot into quarterly to get a best result. - Check if the pressure silicon is assembled properly.
After juicing, the amount of pulp in the juice is great.	<ul style="list-style-type: none"> - Check if the pressure silicon is assembled properly.
Juice is leaking from the juicing bowl.	<ul style="list-style-type: none"> - If the pressure silicon is not assembled properly, it may leaked the juice out of the juicing bowl.
Stops middle of operating.	<ul style="list-style-type: none"> - Too much fruits or vegetables in the screw or over heated motor may stop the appliance in middle of using. Please wait until the appliance is cool down to use it again. - Please place the motor around cool temperature area. - When using the fruits or vegetables with the hard seed in it, please remove all the seeds in the fruits or vegetables to use. It may break down the juicing screw.
Juicing bowl is shaking in middle of operating.	<ul style="list-style-type: none"> - It is completely normal that juicing bowl is shaking little bit while operating.
The Lid is not opening	<ul style="list-style-type: none"> - Turn the hopper unit to counter clockwise to open the Lid.

Specification

Product	Juicer
Model No.	NS-995UL, NS-996UL, NS-997UL, NS-998UL
Voltage	AC120V / 60Hz
Power Consumption	330W
Maximum Use	Less than 30 Min
Weight	7kg
Dimensions(W x D x H)	245 x 165 x 435 (mm)
Manufacturer	NUC Electronics Co., Ltd.
Compress type	Low speed compression

Memo

Memo