

installation instructions:

PVC SHUTTERS

SAFETY INSTRUCTIONS

Make sure to use the correct tools recommended.

Wear safety goggles.

Follow fixture, power tools, and paint manufacturers' instructions and users manuals.

Use common sense and follow good construction practices.

Decorative use only.

TOOL & MATERIAL CHECKLIST

- electric drill
- 1/8" drill bit
- caulk gun
- exterior grade screws
- putty knife
- acrylic caulk

IMPORTANT INFO

- 1/8" carbide drill bit is required for stucco, hardboard, fiber cement, brick or masonry.
- For shutters up to 55", use four screws per shutter.
- For shutters over 55", use six screws per shutter.
- Pre-finish shutters with 100% acrylic paint prior to installation.

INSTALL INSTRUCTIONS:

General Installation

1. Determine the position for the shutter by matching up the top and bottom of the shutter with the window and mark its position.
2. Mark the shutter where you will fasten it to your installation surface by drilling through the shutter to mark the facade at the top, middle and bottom of the shutter.
3. Remove the shutter and pre-drill pilot holes through the facade. Caulk each pre-drilled hole with a clear water proof and paintable sealant.
4. Using a level, set the shutter in place and fasten using non-corrosive exterior grade screws. Be sure not to over-tighten the screws.
5. After shutters are securely fastened, cover the fastener with a compatible acrylic filler or caulk, and touch up with your selected paint.

Finishing Tips:

1. Paint with premium grade exterior 100% acrylic paint.
2. Seal with exterior-grade clear acrylic top coat.

EXAMPLE DIAGRAM:

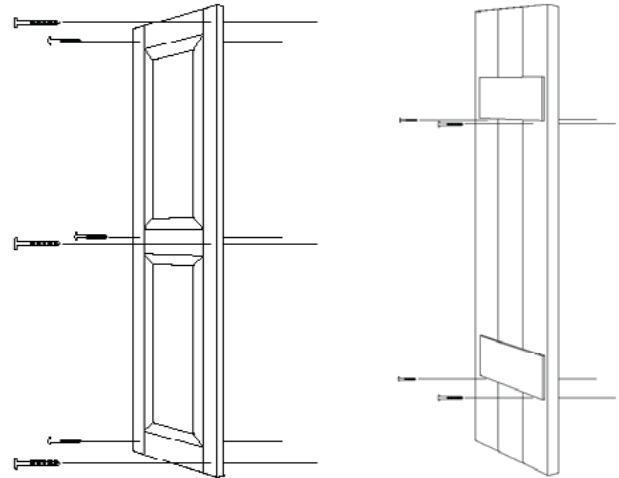

We Can Help. Call (866) 607-0453



Industry leading manufacturer of urethane, PVC, wood, rustic, and metal millwork

www.ekenamillwork.com

FUNCTIONAL PVC SHUTTERS

SAFETY INSTRUCTIONS

Make sure to use the correct tools recommended.

Wear safety goggles.

Follow fixture, power tools, and paint manufacturers' instructions and users manuals.

Use common sense and follow good construction practices.

TOOL & MATERIAL CHECKLIST

- electric drill
- 1/8" & 1/4" drill bit
- shutter hardware
- proper screws for installation surface
- screw driver
- level
- pencil, marker, or chalk

IMPORTANT INFO

- Determine the position of the Pintel on the Window casement. Measure the depth of the surface that the Pintel will be mounted on and the adjacent wall surface. This will determine the Pintel height and Hinge combination that best fits the application.
- Shims are available to adjust the pinter projection.

INSTALL INSTRUCTIONS:

Functional Hardware

1. Hold shutters in place in the window opening.
2. Using shims center the shutter in the opening to create a 1/4" gap around all four sides of the shutter, and 3/8" gap between the center of the two shutters.
3. Determine where the hinges will be installed on the shutter and mark the holes with a sharpie remove hinges and drill pilot holes. Fasten the hinges using the pilot holes.
4. Slide the pintels into place with rod facing upward mark the holes, remove the pintels, and drill pilot holes. Fasten the pintels into place using the pilot holes. Diagram (B)
5. Note: It is recommend that functional shutters are installed so that they lay flush against the window when in the closed position. See Diagram (A)

Decorative Hardware

1. Determine the position for the mounting brackets by matching up the top and bottom of the shutter with the window and mark its position.
2. Using a level set the bottom bracket in place and fasten using the correct screws for your installation surface. (Note: At this point it is recommended you place the shutter in place and double check your marking for the top bracket.)
3. Using a level set the top bracket in place and fasten using the correct screws for your installation surface.
4. If installing shutters larger than 55" fasten the center "L" brackets in place.
5. Set the shutter in place, mark the position of the holes on the shutter. Remove the shutter and drill pilot holes using a 1/8" bit.
6. Place the shutters back in place and fasten the shutter in place using screws being sure not to over-tighten the screws. Diagram (C)

EXAMPLE DIAGRAM:

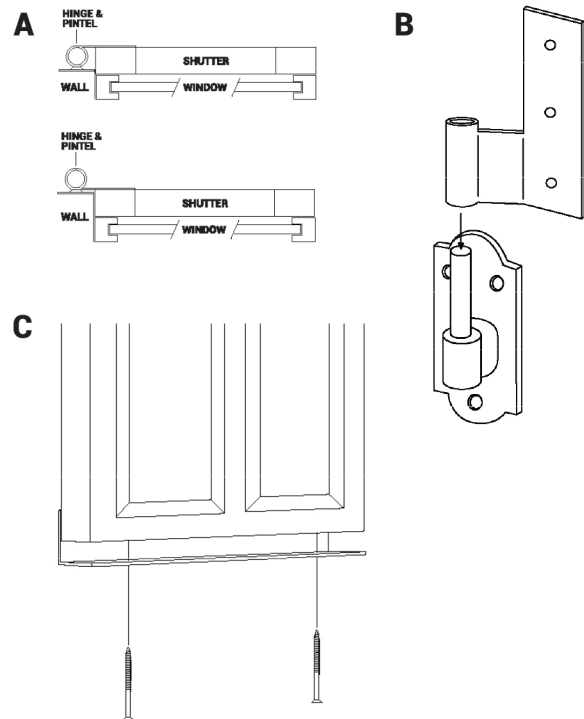

We Can Help. Call (866) 607-0453



Industry leading manufacturer of urethane, PVC, wood, rustic, and metal millwork

www.ekenamillwork.com