

ASSEMBLY AND INSTALLATION INSTRUCTIONS

F0012 / F0013

WARNING: BE SURE TO SHUT OFF POWER AT THE MAIN FUSE OR CIRCUIT BREAKER BOX BEFORE INSTALLING OR SERVICING THIS FIXTURE.

NOTE: 1. Before installing, consult local electrical codes for wiring and grounding requirements.
2. The combined weight of your ceiling fan and light kit cannot exceed 35 pounds unless additional support is provided for the fan.

WARNING:

As per EPACT 2005 requirements, this fan light has a built-in current limiting device to conserve energy. The fan light will not operate if the combined wattage of the installed bulbs exceeds 190 Watts. If the fan light shuts off shortly after being switched on, it may be due to excessive current demand. You should replace the light bulbs with lower wattage bulbs.

----This FAN LIGHT can be installed in one of three ways.
----This fan light is not compatible with ceiling fans containing an integrated light kit.

Installing the fan light on fans with Non-Removable switch box:

1. Unscrew the three screws from the switch box, remove the switch box cover and disconnect the wire nuts. (See Fig. 1)
2. Push the center plug from inside the switch box cover to remove the center plug. (See Fig. 1)
Note: Save the center plug should you choose to remove the light fixture in the future.
3. Feed the two wires from the fan light kit through the center hole in the switch box cover, and thread the wires through the washer and hex nut, then secure switch box cover onto the fan light kit with a hex nut and washer. (See Fig. 2)
4. Remove the wire nuts from the two wires in the switch box labeled "FOR LIGHT KIT CONNECTION".
5. Connect wires by using the wire nuts: (See Fig. 2)
 - The black (hot) wire from fan light kit to the blue (hot) wire from the fan.
 - The white (neutral) wire from fan light kit to the white (neutral) wire from the fan.
 - Carefully put wires back into the switch box.
6. Restore the switch box cover back to the switch box by using the three screws. (See Fig. 2)
7. Install bulbs (included). See relamping label at socket area or packaging for maximum allowed wattage. (See Fig. 2)
8. Slip the glass shade up through the pull chain and the short nipple, secure them with the metal pad and hex nut. (See Fig. 2)
9. Slip the cover up through the pull chain and the short nipple, hand tighten until snug.
10. Turn on the electric circuit.

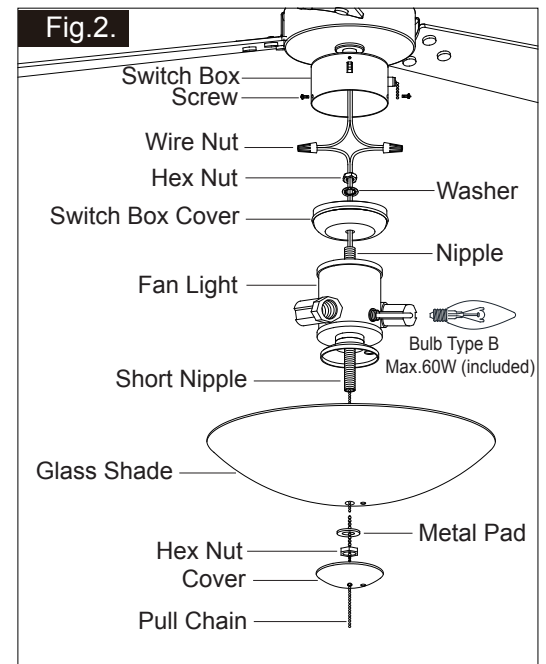
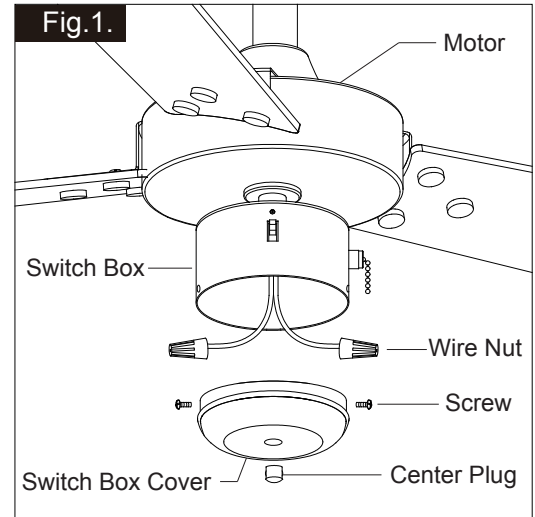

aireRyder
FAN CO

Installing the fan light kit on a removable switch box:

1. Unscrew the three screws from the fan, remove the switch box and disconnect the terminals. (See Fig. 3)
2. Push the center plug from inside the switch box to remove the center plug. (See Fig. 3)
Save the center plug should you choose to remove the light fixture in the future.
3. Thread the two wires from the fan light kit through the center hole in the switch box, then thread the wires through the washer and hex nut, then secure switch box onto the fan light kit with a hex nut and washer. (See Fig. 4)
4. Remove the wire nuts from the two wires in the switch box labeled "FOR LIGHT KIT CONNECTION". (See Fig. 5)
5. Connect wires by using the wire nuts: (See Fig. 5)
 - The black (hot) wire from fan light kit to the blue (hot) wire from the switch box.
 - The white (neutral) wire from fan light kit to the white (neutral) wire from the switch box.
 - Carefully put wires back into the switch box.
6. Connect the two terminals respectively from the fan and switch box. (See Fig. 6)
7. Restore the switch box back to the fan by using the three screws. (See Fig. 6)
8. Install bulbs (included). See relamping label at socket area or packaging for maximum allowed wattage. (See Fig. 6)
9. Slip the glass shade up through the pull chain and the short nipple, secure them with a metal pad and hex nut. (See Fig. 6)
10. Slip the cover up through the pull chain and the short nipple, hand tighten until snug. (See Fig. 6)
11. Turn on the electric circuit.

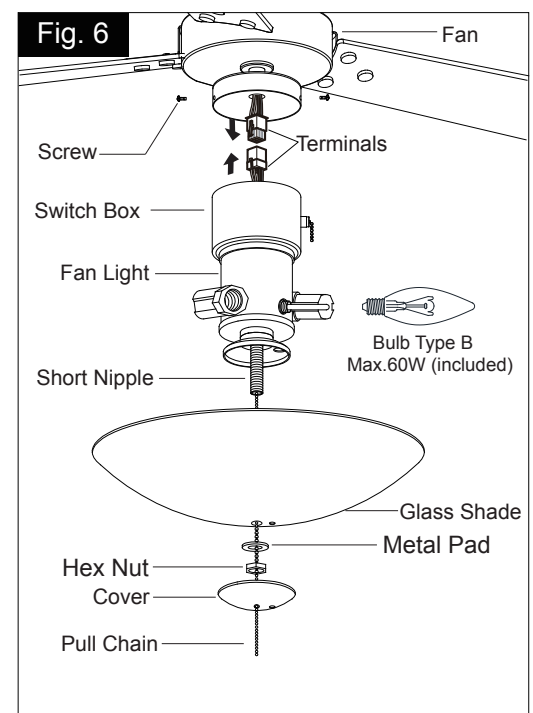
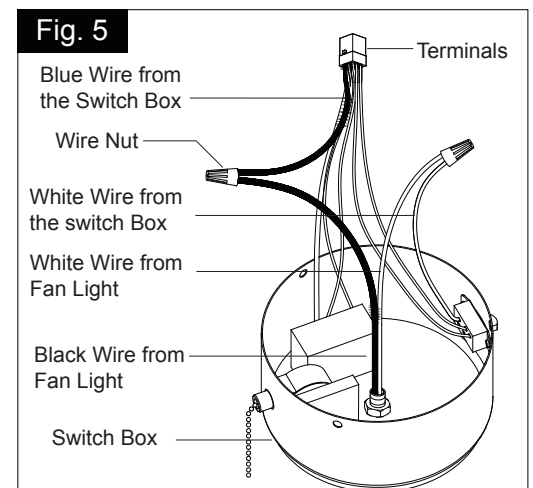
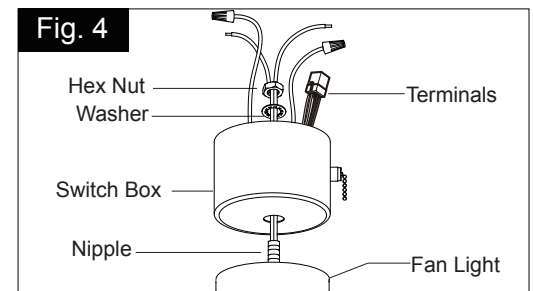
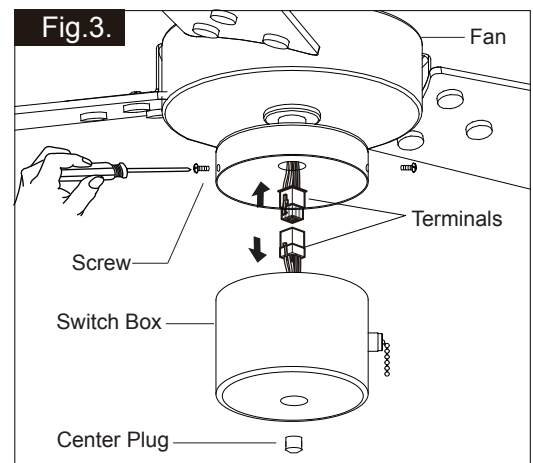

Installing the fan light on the ceiling:

1. Take out the parts from the hardware package For Semi-Flush. (See Fig. 7)
2. Attach two screws to the mounting strap, and secure it with two lock nuts. Adjust the length of the screws if necessary. (See Fig. 7)
3. Attach the mounting strap to the outlet box by using two mounting screws. (See Fig. 7)
4. Thread the fixture wires through the cap, coupling, hex nut, long nipple, big tube, cap, canopy, metal pad, washer, grounding pad and another hex nut. (See Fig. 7)
5. Secure the coupling onto the nipple on the top of the light kit. Then secure the long nipple into the coupling, and secure it with a hex nut. (See Fig. 7)
6. Slip the big tube, cap with the open side facing downward and the canopy down through the long nipple, secure them together with a metal pad, washer, grounding pad and hex nut. (See Fig. 7)
7. Cut the redundant wires if necessary. Pull out the outlet wires and the house grounding wire from the outlet box.

Connections wires: (See Fig. 7)

- Connect the black (hot) wire from fixture to the black (hot) wire from power source.
- Connect the white (neutral) wire from fixture to the white (neutral) wire from power source.
- Attach the fixture grounding wire to the mounting strap with the green grounding screw. Then connect it to the house grounding wire with the wire nut.

Carefully put wires back into the outlet box.

8. Attach the canopy to the mounting strap by inserting the screws, and secure it with the ball nuts. (See Fig. 7)
9. Install bulbs (included). See relamping label at socket area or packaging for maximum allowed wattage. (See Fig. 7)
10. Slip the glass shade up through the pull chain and the short nipple, secure them with a metal pad and hex nut. (See Fig. 7)
11. Slip the cover up through the pull chain and the short nipple, hand tighten until snug. (See Fig. 7)
12. Turn on the electric circuit.

