

ASSEMBLY AND INSTALLATION INSTRUCTIONS

T0062

WARNING: BE SURE TO SHUT OFF POWER AT THE MAIN FUSE OR CIRCUIT BREAKER BOX BEFORE INSTALLING OR SERVICING THIS FIXTURE.

**NOTE: 1. Before installing, consult local electrical codes for wiring and grounding requirements.
2. READ AND SAVE THESE INSTRUCTIONS.**

Parts:

Parts Number (4752MM)



Mounting Plate (A)



Green Grounding Screw (C)



Wire Nut (E)



Ball Nut (G)



Mounting Screw (B)



Headless Screw (D)



Lock Nut (F)



Rubber Pad (H)

Parts Number (7047PC)

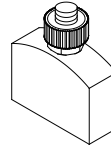

Photocell (I) (X1)

Parts Number (9454CS)



Glass Panel (J) (X3)

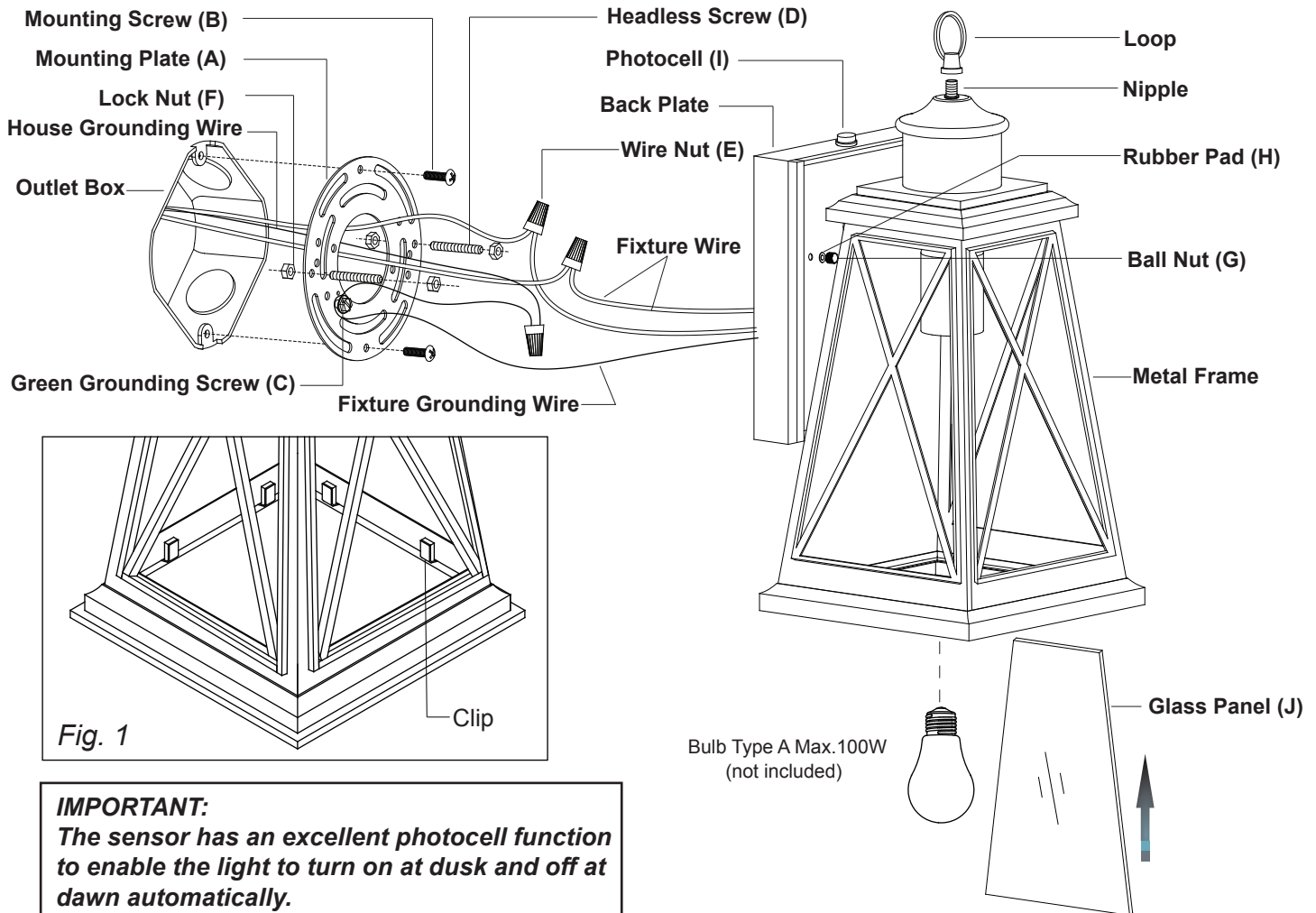

1. Thread two headless screws through the mounting plate, then secure them with four lock nuts (two on each side of the mounting plate). Adjust the length of the headless screws if necessary.
Note: Make sure that the headless screws are lined up horizontally, to ensure that the fixture will be level.
2. Attach the mounting plate to the outlet box by using two mounting screws.

3. Take a glass panel and gently slide the narrow side of the glass panel down into the metal frame in place, secure it by pressing the clips from both top and bottom sides. (See Fig.1) Repeat with other panels.
4. Secure the loop to the nipple of the fixture.
5. Pull out the outlet wires and the house grounding wire from the outlet box. Make wire connections using the wire nuts:
 - Connect the black (hot) wire from the fixture to the black (hot) wire from the power source.
 - Connect the white (neutral) wire from the fixture to the white (neutral) wire from the power source.
 - Attach the fixture grounding wire to the mounting plate with the green grounding screw. Then connect it to the house grounding wire with a wire nut.
 Carefully put the wires back into the outlet box.
6. Attach fixture to the wall by aligning fixture mounting screws on mounting plate with holes on back plate. Slide fixture mounting screws through holes, secure them with two rubber pad and ball nuts.
7. With silicone caulking compound, caulk completely around where the back plate meets with the wall surface.

CAUTION: Be sure to caulk completely where the back plate meets the wall surface to prevent water from seeping into the outlet box.
8. Install a bulb (not included). See relamping label at socket area or packaging for maximum allowed wattage.
9. Turn on the power at the main fuse or circuit breaker box.

Operation the Unit Without Photocell

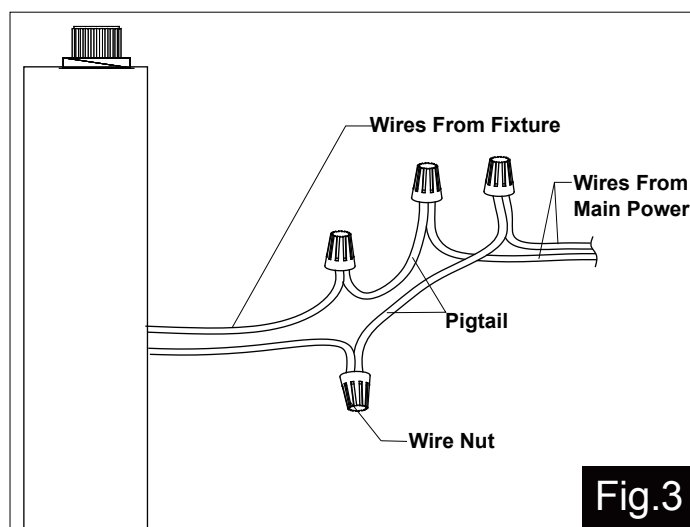
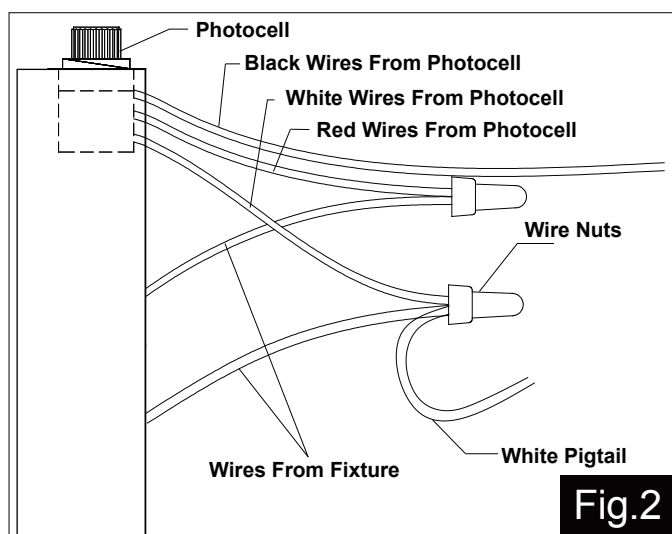

1. Turn off the power at the main fuse or circuit breaker box before starting installation.
2. Loosen the wire nuts connected with the wires from photocell. (See Fig.2)

Note: Do not move the photocell to prevent water from seeping into the outlet box.
3. Take a white pigtail and black pigtail and make wire connections using wire nuts: (See Fig.3)
 - a. The black wire from the fixture to one end of the black pigtail.
 - b. The white wire from the fixture to one end of the white pigtail.
 - c. The other end of the black pigtail to the black wire from the power source.
 - d. The other end of the white pigtail to the white wire from the power source.
 Put all wires back into the back plate of the fixture.

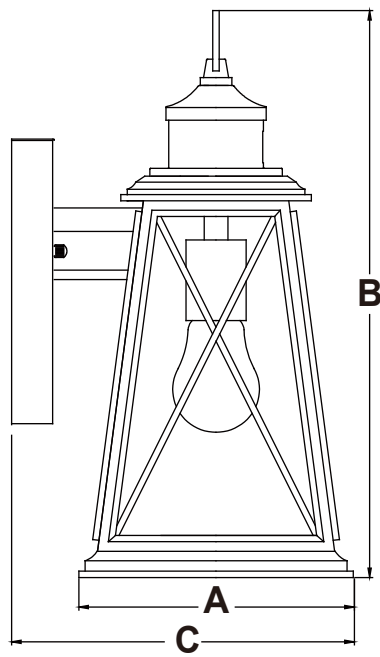

A: 9"
B: 18"
C: 11"