

REV.	DESCRIPTION	DATE	DRAWN	APPROVED
1				

Instructions for Models:

SI-A111
SI-A111-BN



Need Help?
For additional assistance or service call:

SPEAKMAN Company
400 Anchor Mill Road
New Castle, DE 19720

PHONE: 800-537-2107
EMAIL: customerservice@speakmancompany.com
WEB: www.speakmancompany.com

92-SI-A111-R1

Maintenance:

Your new Soap Dispenser is designed for years of trouble-free performance. Keep it looking new by cleaning it periodically with a soft cloth. Avoid abrasive cleaners, steel wool, and harsh chemicals as these will dull the finish and void your warranty.

Notes:

To fill, lift the head and pump assembly out of the bottle and pour out more than 10 oz. and less than 17 oz. into bottle. It is not necessary to remove the bottle to refill.

NOTE:

- ① Please reference exploded view for part numbering.
Remove Nut (4). Insert Body Assembly (2) through selected hole in sink.

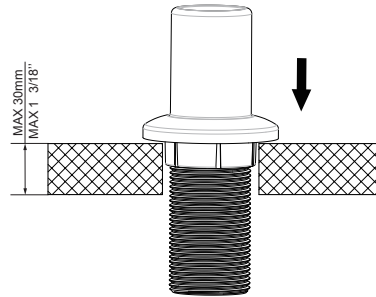

- ② Secure Body Assembly (2) to sink with Nut (4).

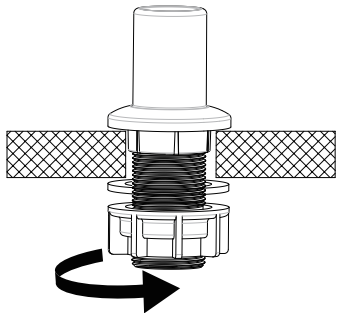

- ③ From under the sink screw the Bottle (5) into the Body Assembly (2) shank.

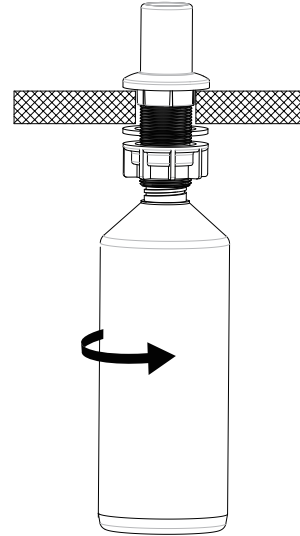

- ④ Insert Head & Pump (1) down into the Body Assembly (2). Attach the Head assembly into the pump if it has become detached during installation.

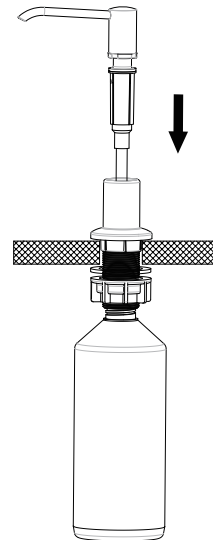

- ① Head & Pump
② Body Assembly
③ Washer
④ Nut
⑤ Bottle

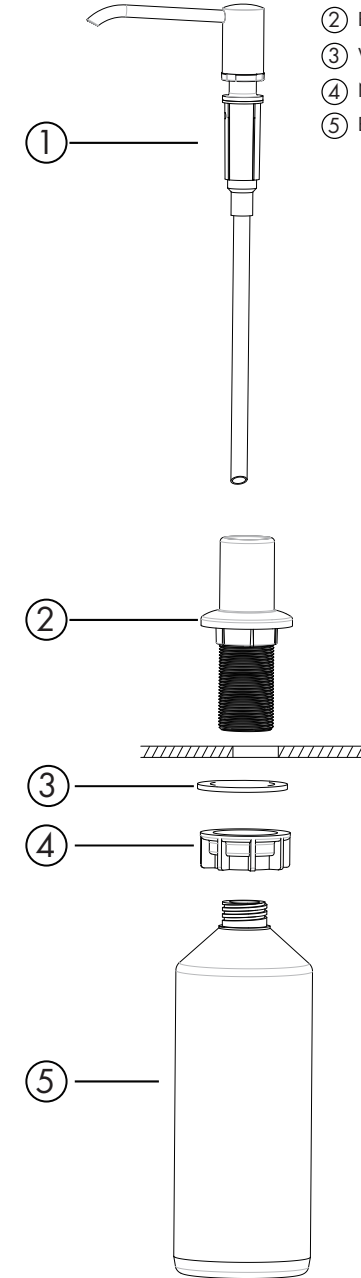

UNLESS OTHERWISE SPECIFIED:		NAME	DATE	SPEAKMAN COMPANY
DIMENSIONS ARE IN INCHES	TOLERANCES:	DRAWN		NEW CASTLE, DE
FRACTIONAL	CHECKED	XXX	XXXXXXXXXX	TITLE
DECIMAL	ENG APPR.	XXX	XXXXXXXXXX	BRASS SOAP DISPENSER
THREE PLACE DECIMAL	MFG APPR.			IOM
MATERIALS (SEE SPEC)	DRAWN			SCALE: 1:1
FINISHES (SEE SPEC)	DATE			WEIGHT:
PROPRIETARY AND CONFIDENTIAL	ISSUED			SHEET 1 OF 1
THIS DRAWING IS THE PROPERTY OF SPEAKMAN COMPANY. IT IS TO BE USED ONLY FOR THE PROJECT AND FOR THE ORIGINAL CONTRACTOR. REPRODUCTION OR TRANSMISSION OF THIS DRAWING TO ANY OTHER PARTY WITHOUT THE WRITTEN PERMISSION OF SPEAKMAN COMPANY IS PROHIBITED.	APPROVED			