



Where Luxury Is Affordable / Où le Luxe est abordable

Owner's Manual / Guide de l'utilisateur

B-090 B-091 Alpine
B-100 Nest
B-110 B-112 Silver Cloud
B-120 Oasis
B-121 B-141 Castello

B-130 B-150 Camaro / Super Camaro
B-131 B-151 Luxury Exotic
B-132 B-152 Birkin
B-140 Elegance



DO NOT RETURN MERCHANDISE DIRECTLY TO YOUR ORIGINAL SELLING STORE.
CALL MSPA AFTER SALES SERVICE CENTER FOR ANY PRODUCT QUESTIONS.
CONTACT US AT info@the-mspa.com



NE PAS RETOURNER LA MARCHANDISE DIRECTEMENT AU MAGASIN DE VENTE INITIAL.
APPELER LE SERVICE APRÈS VENTE MSPA POUR TOUTE QUESTION SUR LE PRODUIT.
NOUS CONTACTER AU info@the-mspa.com

www.the-mspa.com



WARNING

For your own safety and that of your equipment, make sure to take the following precautions. Failure to follow warning notices and instructions may result in property damage, serious injury or death. Improper installation or operation will void the warranty

When install or use this equipment, basic safety precautions must be followed, including the following:

IMPORTANT SAFETY INSTRUCTIONS

READ AND FOLLOW ALL INSTRUCTIONS

WARNING: RISK OF ELECTRIC SHOCK. Insert the plug only to a properly grounded socket.

WARNING: The spa must be supplied by an isolating transformer or supplied through a ground-fault circuit interrupter (GFCI) having a rated residual operating current not exceeding 30mA.

WARNING: GFCI must be tested before each use.

WARNING: If the supply cord is damaged, it must be replaced immediately by the manufacturer, its service agent or similarly qualified person in order to avoid a hazard.

WARNING: To reduce the risk of electric shock, do not use extension cord to connect unit to electric supply; provide a properly located receptacle.

WARNING: No part of the appliance is to be located above the bath during use.

WARNING: Parts containing live parts, except parts supplied with safety extra-low voltage not exceeding 12V, must be inaccessible to a person in spa pool; Earthed appliance must be connected to the fixed receptacle which is permanently connected to fixed wiring. Parts incorporating electrical components, except remote control devices, must be located or fixed so that they cannot fall into the spa pool.

WARNING: The plug of spa shall be more than 3.5m away from the pool.

WARNING: Spray head must not be used.

WARNING: The outlet of Spa must not be connected to any tap or fitting other than those specified.

WARNING: Electric installations should fulfill the requirements of local standards.

WARNING: TO AVOID THE ELECTRIC SHOCK, DO NOT USE THE SPA WHEN IT IS RAINING.

WARNING: To reduce the risk of injury, do not permit children to use this product unless they are closely supervised at all times.

A wire connector is provided on this unit to connect a minimum **6 AWG** solid copper conductor between this unit and any metal equipment, metal enclosures of electrical equipment, metal water pipe, or conduit within 5 feet (1.5 m) of the unit.

WARNING: Water attracts children. Always have the Spa locked with its cover after each use.

WARNING: Do not bury cord. Locate cord to minimize abuse from lawn mowers, hedge trimmers, and other equipment.

WARNING: Do not overexert press down or uplift the control panel device. Do not put any heavy on control panel device after installation.

WARNING: Pets should be kept away from spa to avoid damage.

WARNING: When the bubble function is going to be in function, make sure the cover of Spa must be opened first.

WARNING: Do not switch on if there is any possibility that the water in the spa is frozen.

WARNING: Use only approved accessories. Use of non-approved accessories could void the warranty.

DANGER: Risk of accidental drowning. Extreme caution must be exercised to prevent unauthorized access by children. To avoid accidents, ensure that children can not use this spa unless they are supervised at all times.

WARNING: RISK OF ELECTRIC SHOCK. Install at least 1.5m from all metal surfaces.

WARNING: RISK OF ELECTRIC SHOCK. Never operate any electrical appliance when in your spa or when your body is wet. Never place any electric appliance, such as a light, telephone, radio, or television, within 1.5m of spa.

WARNING: During pregnancy, soaking in hot water may cause damage to the fetus. Limit use to 10 minutes at a time.

WARNING: Do not expose spa under direct sunshine.

WARNING – This product is provided with a ground-fault circuit-interrupter in the plug. The GFCI must be tested before each use. With the product operating, open the service door. When the product stops operating, this merely indicates that the door is equipped with an electrical interlock. Next, push the test button on the GFCI and close the service door. The product should not operate. Now open the service door, push the reset button on the GFCI and close the service door. The product should now operate normally. When the product fails to operate in this manner, there is a ground current flowing indicating the possibility of an electric shock. Disconnect the power until the fault has been identified and corrected.

DANGER – Risk of injury.

- a) Replace damaged cord immediately.
- b) Do not bury cord.
- c) Connect to a grounded, grounding type receptacle only.

DANGER – Risk of Accidental Drowning. Extreme caution must be exercised to prevent unauthorized access by children. To avoid accidents, ensure that children cannot use this spa unless they are supervised at all times.

DANGER – Risk of Injury. The suction fittings in this spa are sized to match the specific water flow created by the pump. Should the need arise to replace the suction fittings or the pump, be sure that the flow rates are compatible. Never operate spa if the suction fittings are broken or missing. Never replace a suction fitting with one rated less than the flow rate marked on the original suction fitting.

DANGER – Risk of Electric Shock. Install at least 5 feet (1.5 m) from all metal surfaces. As an alternative, a spa may be installed within 5 feet of metal surfaces if each metal surface is permanently connected by a minimum 6 AWG solid copper conductor to the wire connector on the terminal box that is provided for this purpose.

DANGER – Risk of Electric Shock. Do not permit any electric appliance, such as a light, telephone, radio, or television, within 5 feet (1.5 m) of a spa.

WARNING: TO REDUCE THE RISK OF INJURY:

- A. The water in a spa should never exceed 40°C(104°F). Water temperature between 38°C(100°F) and 40°C(104°F) are considered safe for a healthy adult. Lower water temperature is recommended for young children and when spa use exceeds 10 minutes.
- B. Since excessive water temperatures have a high potential for causing fetal damage during the early months of pregnancy, pregnant or possibly pregnant women should limit spa water temperature to 38°C(100°F).
- C. Before entering a spa, the user should measure the water temperature with an accurate thermometer since the tolerance of water temperature regulating devices varies.
- D. The use of alcohol, drugs, or medication before or during spa use may lead to unconsciousness with the possibility of drowning.
- E. Obese person and person with a history of heart disease, low or high blood pressure, circulatory system problems, or diabetes should consult a physician before use a spa...
- F. Person using medication should consult a physician before using a spa since some medication may induce drowsiness while other medication may affect heart rate, blood pressure, and circulation.

A green coloured terminal or a terminal marked G, GR, Ground, Grounding, or the  symbol* is located inside the supply terminal box or compartment. To reduce the risk of electric shock, this terminal must be connected to the grounding means provided in the electric supply service panel with a continuous copper wire equivalent in size to the circuit conductors supplying this equipment.

* IEC Publication 417, Symbol 5019.

At least two lugs marked "BONDING LUGS" are provided on the external surface or on the inside of the supply terminal box or compartment. To reduce the risk of electric shock, connect the local common bonding grid in the area of the hot tub or spa to these terminals with an insulated or bare copper conductor not smaller than No. 6 AWG.

All field—installed metal components such as rails, ladders, drains or other similar hardware within 3 m of the spa or hot tub shall be bonded to the equipment grounding bus with copper conductors not smaller than No. 6 AWG.

SAVE THIS INSTRUCTIONS

WARNING: CHILDREN SHOULD NOT USE SPAS OR HOT TUBS WITHOUT ADULT SUPERVISION

WARNING: DO NOT USE SPAS OR HOT TUBS UNLESS ALL SUCTION GUARDS ARE INSTALLED TO PREVENT BODY AND HAIR ENTRAPMENT

WARNING: PEOPLE USING MEDICATIONS AND/OR HAVING AN ADVERSE MEDICAL HISTORY SHOULD CONSULT A PHYSICIAN BEFORE USING A SPA OR HOT TUB

WARNING: PEOPLE WITH INFECTIOUS DISEASES SHOULD NOT USE A SPA OR HOT TUB

WARNING: TO AVOID INJURY EXERCISE CARE WHEN ENTERING OR EXITING THE SPA OR HOT TUB

WARNING: DO NOT USE DRUGS OR ALCOHOL BEFORE OR DURING THE USE OF A SPA OR HOT TUB TO AVOID UNCONSCIOUSNESS AND POSSIBLE DROWNING

WARNING: PREGNANT OR POSSIBLY PREGNANT WOMEN SHOULD CONSULT A PHYSICIAN BEFORE USING A SPA OR HOT TUB

WARNING: WATER TEMPERATURE IN EXCESS OF 38°C MAY BE INJURIOUS TO YOUR HEALTH

WARNING: BEFORE ENTERING THE SPA OR HOT TUB MEASURE THE WATER TEMPERATURE WITH AN ACCURATE THERMOMETER

WARNING: DO NOT USE A SPA OR HOT TUB IMMEDIATELY FOLLOWING STRENUOUS EXERCISE

WARNING: PROLONGED IMMERSION IN A SPA OR HOT TUB MAY BE INJURIOUS TO YOUR HEALTH

WARNING: DO NOT PERMIT ELECTRIC APPLIANCES (SUCH AS A LIGHT, TELEPHONE, RADIO, OR TELEVISION) WITHIN 1.5 M OF THIS SPA OR HOT TUB

CAUTION: MAINTAIN WATER CHEMISTRY IN ACCORDANCE WITH MANUFACTURER' S INSTRUCTION

Hyperthermia occurs when the internal temperature of the body reaches a level several degrees above the normal body temperature of 37°C(98°F). The symptoms of hyperthermia include drowsiness, lethargy, and an increase in the internal temperature of the body.

The effects of hyperthermia include

- (a) unawareness of impending hazard;**
- (b) failure to perceive heat;**
- (c) failure to recognize the need to exit spa;**
- (d) physical inability to exit spa;**
- (e) fetal damage in pregnant women; and**
- (f) unconsciousness and danger of drowning.**

WARNING: THE USE OF ALCOHOL OR DRUGS CAN GREATLY INCREASE THE RISK OF FATAL HYPERTHERMIA IN HOT TUBS AND SPAS

WARNING: *TO REDUCE THE RISK OF INJURY:* Never pour water which higher than 40°C(104°F) into the spa pool directly.

WARNING: The use of alcohol, drugs, or medication can greatly increase the risk of fatal hyperthermia.

Hyperthermia occurs when the internal temperature of the body reaches a level several degrees above the normal body temperature of 37°C(98.6°F). The symptoms of hyperthermia include an increase in the internal temperature of the body, dizziness, lethargy, drowsiness, and fainting, The effects of hyperthermia include failure to perceive heat; failure to recognize the need to exit spa; unawareness of impending hazard; fetal damage in pregnant women; physical inability to exit the spa; and unconsciousness resulting in the danger of drowning.

CONSULT YOUR PHYSICIAN FOR RECOMMENDATIONS.

CAUTION: The spa should not be setup or left out in temperature lower than 4°C (40°F):

CAUTION: Do not use the spa alone.

CAUTION: People with infectious diseases should not use a spa.

CAUTION: Do not use the spa immediately following strenuous exercise.

CAUTION: Always enter and exit the spa slowly and cautiously. Wet surfaces are slippery.

CAUTION: To avoid damage to the pump, the spa must never be operated unless the spa is filled with water.







CAUTION: Immediately leave spa if uncomfortable or sleepy.

CAUTION: Never add water to chemicals. Always add chemicals to water to avoid strong fumes or violent reactions that may result in hazardous chemical spray.

CAUTION: Place only on surface that can withstand the floor loading requirement of your Spa.

NOTE: Please examine equipment before use. Notify after service center listed on this manual for any damaged or missing parts at the time of purchase. Verify that the equipment components represent the models that you had intended to purchase.

SPECIFICATIONS

Style No.	Bubble Spa							
	B-090	B-091	B-100	B-110 B-120 B-121	B-130 B-131 B-132	B-140	B-112 B-141 B-150	B-151 B-152
Seating capacity	2  + 2 	4  + 2 	2 	4 	4-6 			
Shape	Square	Square	Oval	Round	Round			
Water Capacity (Approx.)	650 L/171 gallon	930 L/245 gallon	550 L/145 gallon	700 L/184 gallon	930 L/245 gallon			
Outside Dimensions	1.58 m/62"	1.85 m/73"	1.86x1.25 m/73.5"x49.5"	1.80 m/71"	2.04 m/80"			
Inside Dimensions	1.28 m/50.5"	1.45 m/57"	1.46x0.85 m/57.5"x33.5"	1.40 m/55"	1.60 m/63"			
Height	0.68 m/27"	0.68 m/27"	0.68 m/27"	0.70 m/28"	0.70 m/28"			
Power rated	110~120V, 60Hz	110~120V, 60Hz	110~120V, 60Hz	110~120V, 60Hz	110~120V, 60Hz			
Heater	675W x 2	675W x 2	675W x 2	675W x 2	675W x 2			
Massage air blower	500W	500W	500W	500W	500W			
Filter pump	AC 24 V/50 W	AC 24 V/50 W	AC 24 V/50 W	AC 24 V/50 W	AC 24 V/50 W			
Power Cable Length	3.1 m/10 feet	3.1 m/10 feet	3.1 m/10 feet	3.1 m/10 feet	3.1 m/10 feet			
Top lid	polyester laminated PVC with foil and inflatable bladder	polyester laminated PVC with foil and inflatable bladder	Synthetic leather with foil and inflatable bladder	B-110/B-120 polyester laminated PVC with foil and inflatable bladder B-121/B-130/B-131/B-132/B-140 Synthetic leather with foil and inflatable bladder	B-112 polyester laminated PVC with foil and inflatable bladder B-141/B-150/B-151/B-152 Synthetic leather with foil and inflatable bladder			

INSTALLATION INSTRUCTIONS

NOTE: Ensure to check all parts are present.

A: Synthetic leather with foil and zipper

B: Control panel

C: Spa pool

D: Temp barrier mat

E: Digital lock

F: Filter cartridge

G: Drainage hose

H: Repair kit

I: Inflatable bladder

J: Manometer + Inflation Hose

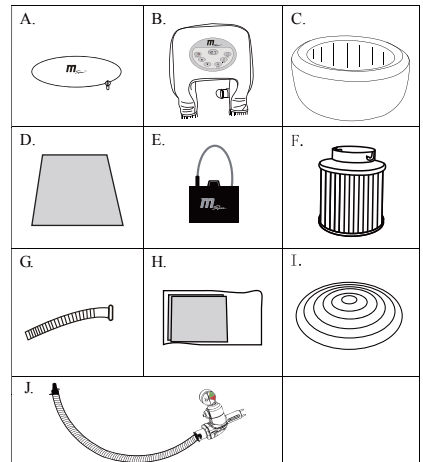

NOTE: Drawings for illustration purpose only in this manual. Actual product may vary. Not to scale.

A. Site Requirements

WARNING: The floor has to be capable of supporting the expected load.

WARNING: An adequate drainage system has to be provided to deal with overflow water.

IMPORTANT: Because of the combined weight of the spa, water and users, it is extremely important that the base where the spa is installed is smooth, flat, level and capable of uniformly supporting the weight for the entire time the spa is installed. If the spa is placed on a surface which does not meet these requirements, any damage caused by improper support will void the warranty. It is the responsibility of the spa owner to ensure the integrity of the site at all times.

Be aware of special requirements if you install the spa indoors.

1. The floor must be able to withstand the capacity of the spa.
2. The floor should be a non-slip, level surface.
3. Proper drainage is essential for indoor spa installation.
4. When building a new room for the spa it is recommended that a floor drain be installed.
5. Humidity is naturally present with the spa installation, determine the effects of airborne moisture on exposed wood, paper, etc. in the proposed location.
6. To minimize these effects it is best to provide plenty of ventilation to the selected area. An architect can help determine if more ventilation is needed.

NOTE: Do not install the spa on carpet or other material that can be damaged by moisture.

B. GFCI Test

WARNING: RISK OF ELECTRIC SHOCK. The GFCI plug must be tested before each use.

WARNING: Insert the GFCI plug into a residual current device (GFCI) protected power receptacle only.

WARNING: Before inserting the plug into a power receptacle, make sure the current rate of the power receptacle and the fixed wiring are suitable for the spa. Contact a qualified electrician, if you cannot distinguish.

1. Insert the plug into the power receptacle. (1)
2. The indicator light should turn red.
3. Then press the "TEST" button. The indicator light should disappear. (2)

WARNING: Do not use if above test fails.

4. Press the "RESET" button again, the indicator light should turn red. The spa is now ready for use. (3)

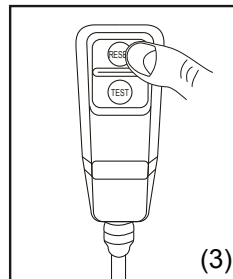
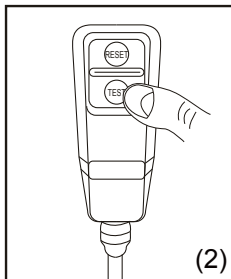
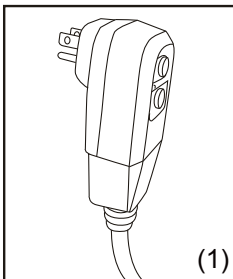

C. Assembly

a) Unfold the Spa pool from the packaging. Spread the Spa, cover and temp barrier mat. Make sure Spa and cover are right side up. Put temp barrier mat under Spa(optional).

Note: B-100 includes a side bar, which needs to be placed before filling water to the tub. The side bar helps keeping the spa pool in its proper shape after filling.

Temp barrier mat(optional) is helpful to avoid heat loss from bottom and provide better heat preservation together with inflatable bladder(optional) being used.

It's only possible to setup and leave the spa at outside temperature less than 4°C(40°F) as long as the spa has a constant water temperature guaranteed more than 4°C(40°F). The spa can be used under low environment temperature down to maximum -10°C(14°F) if it is properly set up to make sure no frozen water inside control box, pipes and spa pool. It's helpful to put temp barrier mat between spa and ground, or similar mat which is made of foam material or some material with temp barrier function.

Don't install Mspa onto the lawn as grass may cause air pump damped and rusted which could result the air pump works improperly and will void your warranty.

b) Screw the control panel onto the spa, fasten the ring to the pipe adaptor.

Precautions:

1. When using the spa tub outside, air pipe can not be taken off. Do not use the spa tub in rains as air pump will not working properly.
2. The two O-ring part on the air pipe is important to get the spa tub working properly. Lost of the O-rings could cause air pump rusted or not working properly. Missing of the O-rings also affects bubbling function.

For models coming with outer pool cover, put the side leather cover on the spa tub.

Attention: make sure the 2 holes on the leather fit the right positions of spa tub.

c) Connect the pin plugs. Make sure that plugs are properly matched together, then screw a cap, and then you'll see code shown on control panel, no bent or wet for the pin inside male connector which will cause failure connection.

d) Open the air valve under the control panel. Screw one end of inflation hose onto it.

e) Unscrew the top part of air valve on the Spa. Screw the other end of inflation hose onto Manometer, and then put into the air valve.

f) As previously outlined, test spa's GFCI plug. Then inflate the spa pool by pressing the "bubble" button.

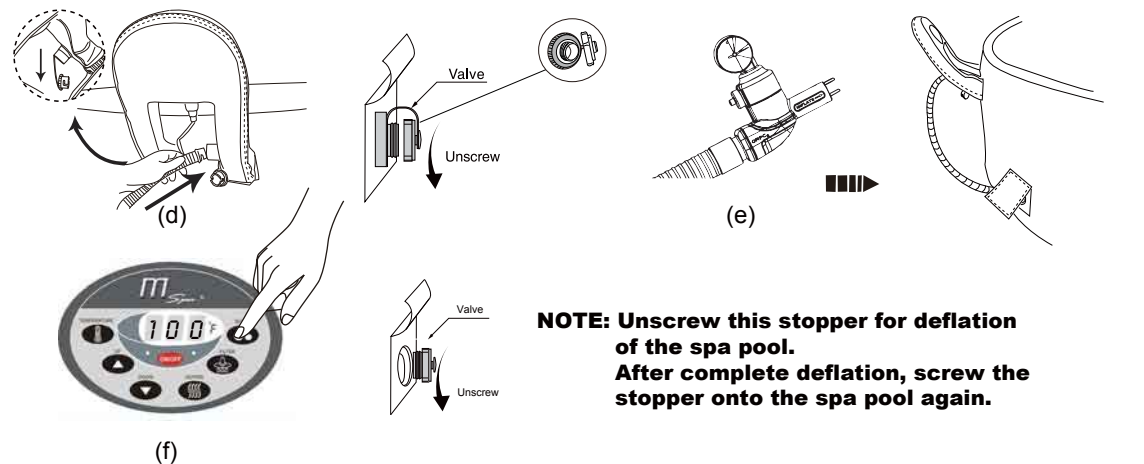
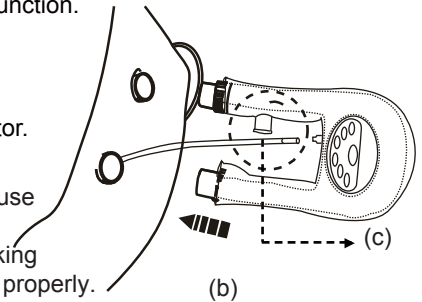

h) Please check and test the air pressure status inside the spa pool in the following way:



Please read the dial plate of manometer.



Yellow

If it points to yellow sector, the spa is well inflated. You may fill in water now.

TO AVOID OVER INFLATION CAUSED BY WARM WEATHER OR SUNSHINE WHEN LEAVING MSPA FOR WEEKS INFLATED AND FILLED WITH WATER IN TEMPERATURE HIGHER THAN 20°C, PLEASE REDUCE THE AIR PRESSURE TO THE YELLOW SECTOR OF MANOMETER.



Green

After filling in water, please check air pressure again and make sure the pin reads in green sector.

When needs to inflate more air during use, please make sure it reads in green sector in any term.

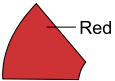

Red

If it points to red sector, the spa is over inflated. Please unscrew the valve and release some air.

Recheck the air pressure and make sure it reads within the green sector.



Please press the black button on the manometer, and air will be let out from the position where the button locates. Keep pressing the button till the pin points to the green area.

DO NOT OVER INFLATE. OVER INFLATION MAY CAUSE SPA POOL LEAKAGE AND VOID THE MANUFACTURER WARRANTY.

- i) Press the “bubble” button again to stop inflating. Remove the inflation hose from the air valve on the spa pool. Screw the cover to the valve once the air pressure inside the pool is tested to be suitable.
- j) Connect the inflation hose to the air valve of inflatable bladder(optional) and then press the “bubble” button on the control panel to inflate it. When it's going to be full without wrinkles on surface, please press the “bubble” button again to shut off and stop inflating.

k) Fill the Spa

Using a garden hose to fill the Spa at least to the water level printed on the Spa wall.

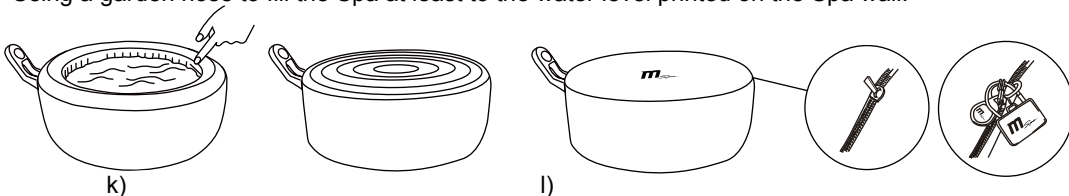

WARNING: make sure the power pack is not plugged in before filling water into the SPA.

1. PLEASE AVOID WATER SPILLAGE WHICH WILL CAUSE DAMAGE TO THE ELECTRIC PARTS.

2. After filling in water, please check air pressure again and make sure the pin reads in green sector. When needs to inflate more air during use, please make sure it reads in green sector in any term.

3. Please reduce the air pressure to the yellow sector of manometer, to avoid over inflation due to warm weather or sunshine etc. after leaving Mspa for weeks inflated.

Warning: to avoid function failure and damage to the control system, please do not operate until spa is filled with water to the low water mark.

l) Place the zipper cover onto the spa and then put the inflatable bladder onto the spa pool, Fasten the zipper and lock the cover to the spa by using the digital lock in the accessory pack.

Note:

Please remember to test and adjust the air pressure inside of spa pool before each time of use.

Please cover zipper with wax once a week so as to make it smooth for operation and avoid split.

How to change the combination of digital lock:

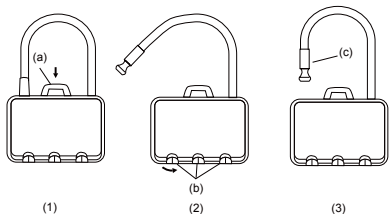

Original combination is set as 000

1) Push release button(a) in the direction of the arrow shown and the lock will be released.

2) Set your desired combination by move the number wheel(b). Please do not forget your new combination.

3) Insert back the steel cable(c) to its end in the direction of the arrow. The new combination is ready for use.

WARNING: Do not move the number wheels while the digital lock is open. Or you will change the combination you just set. This will unable the digital lock. WARNING: The cover is not a substitute for adult supervision; Children must be supervised at all times around the Spa.

WARNING: Water attracts children; Always attach a spa cover and lock it after each use.

POWER PACK OPERATION

Warning: to avoid function failure and damage, please do not operate until spa is filled with water to the low water mark.

It is the responsibility of the spa owner to make sure the above installation conditions are met as well as to follow the Safety and Warning Instructions. Any failure and damage, which may result from dry-run, water spillage, excessive humidity, or structural loading will void the warranty.

Control panel:



1. "ON/OFF" Button: To activate power pack.



2. "BUBBLE" Button: To activate Bubbling system, which has a 20-minute auto shut off for 10 minutes feature. The light of bubble Button displays green when being activated.

NOTE: If it works more than 15 minutes and stop manually, please wait more than 10 mintues to activate manually again.



3. "FILTER" Button: To activate Filtration system. The light of "FILTER" button displays green when the filtration system is activated.



4. "HEATER" Button: To activate Heating and Filtration system at the same time. (Filtration system cannot be turned off when heating)



5. "TEMPERATURE" Button: To set and display water temperature



6. "UP" Button: Increase temperature



7. "DOWN" Button: Lower temperatrure



LED Display: Once powered-up, the LED displays the current water temperature automatically.

NOTE: The setting temperature defaults to 38°C (100°F) when first plugged in.

NOTE: Temperature adjustment ranges from 20°C (68°F) to 40°C (104°F).

Set your desired temperature by pressing “TEMPERATURE” Button.

Note: In case when leaving spa under unattended working condition, you can press up “▲” & down “▼” buttons at the same time to lock the control panel to avoid any misoperation by children. To press both buttons at the same time again and after hearing sound of “DI”, it will be unlocked.

The light of the “HEATER” button displays red when the heating system is activated.

Note: It's normal that filtration system cannot be turned off individually when heating system is working. And filtration system can only be turned off by pressing “HEATER” button but not “FILTER” button

The heater does not stop heating the Spa until the current water temperature reaches the setting temperature. Then the “FILTER” button will be off and the light of “HEATER” button displays green. After the current water temperature drops 2°C(4°F) below the set point temperature, the heating system will restart and light turns into red. The “FILTER” button will be activated automatically at the same time. The heat increase rate is maximumly 1.2 to 1.7°C(1-3°F) per hour.

Please note that the following conditions will lead to slow and even heating without heating phenomenon:

1. Environmental temperature lower than 10°C(50°F)
2. Outdoor wind force above Gentle breeze/F 3
3. Environmental temperature lower than 10°C(50°F) and wind power above Gentle breeze/F 3
4. Activate bubbling system when heating
5. Spa lid is not covered or improperly covered when heating
6. In order to conform to the safety regulations, MSpa control system uses double heating elements technology. When bubble+filter+heater functions are all on, only one heating element is working, which is of 675W only

So you are recommended to fill spa with warm water for quick heating and energy saving.

For B-150, when heating, please always remember to use inflatable bladder & heat mat, for quicker and better heating performance.

Maintaining Spa Water

Poor water quality can be extremely hazardous to your health.

We recommend you do following things:

A: Please use filter cartridge.

Screw the filter onto the water inlet (lower fitting) on the spa wall by turning it clockwise.

Note: Two filter cartridge, one is for use, one is spare.

Note: Do not use filter cartridge when only to heat water and to ensure good heating performance. To avoid that the filter cartridge get damaged, you take it off when there are children in the pool or more than two persons.

After finish bathing replace the filter cartridge.

B: Clean your filter cartridge at least once a time after it worked continuously for 72~120 hours. The filter cartridge should be replaced at least once a week depending on use.

Please make sure to unplug the power pack from the electrical receptacle before the following actions.

1. Unscrew the filter cartridge by turning it counterclockwise.
2. The Filter Cartridge can be rinsed off with a garden hose and reused. However, if the Filter Cartridge remains soiled and discolored the Filter Cartridge should be replaced .

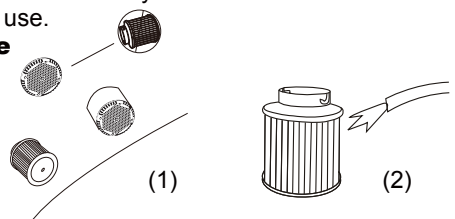
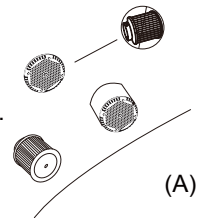

C: Change water every few days or use appropriate pool chemicals. All spas require the use of pool chemicals. Please consult your local pool supply retailer for more information about chemical maintenance. Pay close attention to the chemical manufacturer's instructions. Spa damage resulting from misuse of chemicals and mismanagement of spa water is not covered by the warranty.

a. Water Balance: we recommend maintain your water pH between 7.2 and 7.8, total alkalinity between 80 and 120ppm and free chlorine between 3 to 5ppm. Use test strip to test your water chemistry before each use of the spa, no less than once per week. Low pH will damage to the spa and pump. Damaged resulting from chemical imbalance is not covered by the warranty.

b. Water Sanitation: Water Sanitation is the responsibility of the spa owner, achieved through the regular and periodic (daily, if necessary) addition of an approved sanitizer. The sanitizer will chemically control the bacteria and viruses present in the fill water or introduced during use of the spa.

Note:

1. You must not use chemicals you have in your house or any leftovers from an outdoor inflated pool or a swimming pool.

2. Do not use chlorine tablets but use chlorine powder and dissolve first in a bottle.

3. Do not mix the water with bath oil or something like that, otherwise the pool can be damaged.

4. Do only use clean freshwater and not salt water that will damage the pump.

Special Notice on Water Treatment

Please read about water quality and filter in user manual. Always shower before you enter your MSpa!

Please use test strip to test your water chemistry before each use of the spa, no less than once per week. The pH level must be between 7.2 and 7.8, total alkalinity between 80 and 120ppm and free chlorine between 3 to 5ppm. Too low of a pH level will result in excessive wrinkles and damage to the spa pool as well as corrosion in the motor unit. Too high of a pH level(hard water) will result in scale incrustation, e.g. sheets of white coagulations inside the filter pump, which will lead to block and non-working of the filter pump.

If you have any questions regarding chemicals, please contact local spa and pool water treatment specialist stores.

It is the responsibility of the owner to properly maintain the chemical balance and sanitation of the water. Mspa is not responsible for any damages that result from improperly maintained water. Improper water maintenance may result in voiding the warranty.

Cleaning the spa

Detergent residues and dissolved solids from bathing suits and chemicals will gradually accumulate in the Spa's water. If there is a lot of dirt in the water, try and get it out or change water and clean the pool. Use a mild soap and water solution to wash the vinyl then rinse with freshwater and drain this out before you fill up your MSpa with new fresh water.

NOTE: Do not use hard brushes or abrasive cleaners.

Drainage

1. Turn off all the buttons on the control panel.
2. Unscrew the valve on outside of the spa pool till it is detached from the drainage structure.
3. Connect the black drainage hose on to the drainage structure.
Make sure it is well connected and the other end of the drainage hose is connected to a ground drain.
4. Pull and open the cover of the drainage structure inside of the spa pool, water will flow out from the drainage hose.
5. Tilt the spa until no water flow out to empty the spa completely.

If you are going away for some weeks and nobody can follow up the water treatment program in your MSpa, please drain out the water before leaving and take out some air pressure.

Spa Pool Repair

If the Spa is torn or punctured use the provided Repair Patch. Dry the area to be repaired. apply the glue for PVC to PVC to the repair patch and then attach it onto the damaged area. Smooth the surface to remove any air bubbles. A secure unnoticeable repair can usually be made.

Spa Storage

After the spa is drained, unscrew the complete part of the air valve on the spa pool and the spa will be deflated.
Make sure all water is drained from the Spa and control box. This is essential to extend the life of the spa. We recommend the use of a wet/dry vacuum to blow out or suck up water from the Spa pipes and Pump lines. Remove the Filter Cartridge. It is recommended you store the spa in its original package in a warm dry place.

NOTE: Make sure all components are completely dry and clean before re-packing.

Store safely in dry condition and out of sunlight.

Plastic becomes brittle and susceptible to breakage when exposed to subzero temperatures.

Freezing can severely damage the Spa. Improper winterization of your Spa may void your warranty.

Spa checklist before unpack the unit and re-use for the new season:

In order to have your MSpa runs smoothly and easily for another new season, make sure you do the follow:

1. Check if there is water in the air pipe. If any water is found, dry the air pipe before operating the spa tub.
2. Connect control panel correctly, turn on the spa tub, check if LED displays correctly and if the signal cable is connected properly.
3. Press ON / OFF button on the control panel, open bubble function, check if it operates properly.
4. After doing the above steps, your MSpa should be ready for use. Enjoy it!

Any damage caused by improper storage or failure to do the checklist of reuse will void your warranty.

DISPOSAL

1. The marking  indicates that this product shall not be disposed with the general household waste. Please contact your local community about collection points or ask your dealer.

2. This product contains valuable materials that can be recycled and contribute to a sustainable environment.

3. For recovery, recycling and dismantling information for this product, please visit us at www.the-mspa.com

TROUBLESHOOTING

Mspa® strives to provide the most trouble-free spas on the market. If you experience any product related problems, do not hesitate to contact us or your local after sales service center.

Here are some helpful tips to help you to diagnose and rectify some common sources of trouble.

*For any spare parts you need for replacement, please refer to the warranty policy for replacing details.

*For any other unknown failures out of the list, please contact your national or regional MSpa service center.

Problems	Probable Causes	Solutions
Control panel/display panel attends black without any power at all	Power failure, GFCI plug isn't turned on.	Check that your GFCI plug is ok, you must be able to see the indicator light is in red. Sometimes it can be a little bit tricky, so please then try to push the RESET button several times rather quick, to see if this helps.
	Pin plug connection failure	Control the pin plug connection between the control box and the control panel. Please also check the ends of the plug if there is some failure of one of the pins etc..
	If it still doesn't work, please contact your country MSpa service center to get a new control panel and replace.	
The GFCI plug does not work	Power supply	Please check that the power supply is ok.
	GFCI plug failure	Is there any red indication in the GFCI plug when you push the RESET button? Have the plug being wet or any severe humidity? Please dry your GFCI plug.
	If it still doesn't work please contact your country MSpa service center to get a new one and replace.	
The water does not get warm or water is too hot!	Power failure	First find out that your MSpa is connected to a 16A power supply. If you have to use one extension cord/connector cable, please be sure this is for 16A purpose and for outdoor use. The cable must have minimum the same thickness as the cable from the GFCI plug into the MSpa pump.
	GFCI failure	Please check that your GFCI plug is not wet. To avoid wet conditions, please wrap it into some plastic to avoid humidity and component failure.
	Pin plug connection failure	Control the pin plug that all thin pin plugs are standing correctly.
	Water level too low and filter cartridge dirty	Please check water level that it must reach the water line to make sure filter pump work efficiency. Please control the filter cartridge and water quality. If the filter cartridge is dirty or old the result can be that the filter pump doesn't get enough water thru the filter to operate as it is made for. Please cut the power supply to your MSpa, remove the filter cartridge and then restart without the filter.
The spa pool has got a strange shape	Extra air pressure by strong sunshine	Please check the air pressure. The bath tub can get a unormal shape if the pressure is too high due to strong hot sunshine. Normally this happens only if the air pressure have been too high due to direct sunshine. Smart investment is to buy a spa cover at your MSpa dealer or their webshop. This will protect your pool from UV and pollution.
The spa pool looses air pressure	Air valve looses	Please drain out all the water from your pool if necessary and possible. Try and use some Vaseline or similar to grease the rubber gaskets in the air valve and in the part to open to fit the black tube into the panel. Fill up the inflated tub with air.
	Hole or split on spa pool	Use a spray bottle with a mild detergent to be able to see the air leak when it's coming some small soap bubbles. Try to find the air leak on both sides of the inflated tub part and pvc glue. hole or split within size of 10cm and not in welding seam part can be repaired by material swatches provided in repair kit.
Spa leakage	Inlet and outlet loose	If there are water leakage like tear drops, it's ok for use, and you only need to screw them tight.
	Drainage valve	Please check the o-ring and replace if necessary, and make screws tight if they loose.
Error code "F1" "F2" "F3" "F4" in the display	/	Filter system failure. Do not use the spa. Please contact your country MSpa service center.
Error code "SPL" & "SPH" in the display	Pin plug connection failure	Please check there is no humidity inside the pin plug connection. Control the pin plug that all 12 thin pin plugs are standing correctly.
	SPL, temperature lower than 32 °F	Please check if there is any water frozen inside the spa and control box, use warm water to melt and get water temperature higher than 32°F
	SPH, abnormal high temperature	Do not use the spa. Please contact your country MSpa service center.



MSpa® products are designed with reliability and simplicity in mind. In addition, our internal Quality Assurance Team carefully inspects each unit thoroughly before it leaves our facility. Oriental Recreational Products (Shanghai) Co., Ltd. (ORPC) is pleased to extend this limited warranty coverage to the original purchaser of an MSpa® Product. This warranty is not transferable. The warranty period commences on the original purchase date through 6-12 months accordingly.

The Limited Warranty

This warranty is subject to the obligations, limitations and exclusion listed below:

1. Spa pool – **six (6) months** from original date of purchase.
 2. Electric Parts (Control Box) – **twelve (12) months** from original date of purchase.
- *Report damage after this time will be subject to rejection.

Repair/replacement parts purchased by the consumer from ORPC after the original coverage has expired on the unit will carry a 90 day warranty, valid with a receipt only. Any item shown to be defective will be repaired at our discretion. No labor coverage is included within these parts.

Shipping Policy: Consumers are responsible for the shipping/freight when return the defect parts to MSpa authorized service center or ORPC. All subsidized labour costs of removal and reinstallation of parts might be subject to dealer service charges

Conditions:

This warranty applies to the original purchaser and terminates upon any transfer of ownership. ORPC's obligation under this warranty is only limited to replacing or repairing at ORPC's option once any part or parts of this unit which in our judgment show evidence of such defect.

All repairs for which warranty claims are made must be pre-authorized by ORPC through an accredited distributor or agent provided that the defective part be returned to the distributor or agent Transportation Prepaid, if requested.

All The authorized selling dealer is responsible for all in-field service work carried out on your MSpa® product. ORPC will not be liable for results or cost of workmanship from unauthorized service persons or dealers.

Warranty Registration is required. Warranty Registration Card can be only filled out by mail. All claims must be submitted to ORPC by authorized selling dealers. It is essential that all submitted claims provide all of the necessary information including customer name, purchase date, serial #, product model, problem, and part or parts requested, without this information the warranty will be invalid.

Warranty Cards must be completed and mailed to ORPC by authorized dealer within thirty (30) days from the original purchase date.

Limitations on Warranties

This warranty is a limited warranty. It does not extend to any product or damage to a product caused by or attributable to freight damage, abuse, misuse, or abnormal usage, or repairs not provided by ORPC authorized service personnel, to products used for commercial or rental purpose, or to products used as store display models.

Damages caused by or attributable to the following incidents are specially excluded:

- a. Any damage caused by the operation of the spa with water temperatures outside the range of 0°C-42°C/32°F-107.6°F (Europe/Australia) or 0°C-40°C/32°F-104°F (USA)
- b. Any damage caused by clogged, dirty or calcified filters
- c. Any damage that are purely aesthetic and do not hinder the function of the MSpa
- d. Any damage to the exterior resulting from improper maintenance or any damage to the exterior attributable to freight mishandling
- e. Overfilling
- f. Damage resulting from improper winterization
- g. Damage to the spa liner resulting from improper chemical treatment, damage to the spa resulting from exposure to extreme temperatures.
- h. Damage to the spa resulting from exposure to direct sunlight and ultraviolet rays while the spa is empty
- i. Damage to the pump, motor, plumbing and components due to improper maintenance, chemical treatment, or exposure
- j. Damage resulting from failure to properly follow user's manual installation, operating, or maintenance instructions.

Also exclude are spa accessories (optional), including but not restricted to the following:

- * Comfort set (headrests, cup holder)
- * Filter cartridge
- * Heat preservation mat
- * Seat cushion
- * Test trip
- * Bubble spa overall cover
- * Ice box
- * Foot bath
- * Led light
- * Plastic wood step

Any alterations to the spa will void this warranty. Alterations include but are not limited to: any component or plumbing change, electrical conversion, or addition of alternate sanitation or heating systems.

ORPC authorizes no other warranty beyond that specifically set forth above. ORPC is not responsible or liable for indirect, special or consequential damages arising out or in connection with the use or performance of the product or damages with respect to any economic loss, loss of or damage to property including water damage, loss of revenue, loss of enjoyment or use, costs of removal, installation or other consequential damages of whatsoever nature.

No agent, dealer, distributor or Service Company or other party is authorized to change or modify or extend the terms of this warranty.

Legal Rights

This warranty gives you specific legal rights and you may have other rights, which vary from country to country.

For warranty service contact, see the MSpa **After Service Center Contact List** in the User Manual.

Manufactured By:

**Oriental Recreational Products (Shanghai) Co., Ltd.
1699 Daye Road, Wuqiao, Fengxian
Shanghai, China**



MSpa® Warranty Registration Card

Congratulations on purchasing a quality MSpa® product! To get the most value from your investment, please fill in the Warranty Registration Card below. By submitting this form, your warranty will be registered.

**Note: Incomplete form will not be accepted and honored by MSpa.*

Please fill out the required file with correct info:

*Last Name: _____

*First Name: _____

*Mailing Address 1: _____

Address 2: _____

*City: _____ *State/Province: _____

*Zip/Postal Code: _____ *Country: _____

*Phone Number: _____

*Email Address: _____

*Purchase Date: ___ ___ (mm) ___ ___ (dd) ___ ___ (yyyy) *Product Model: _____

*Serial Number _____ Find the SN# underneath the control panel and on the spa pool cover. e.g. (2GNBUB#####SC##)

*Dealer Where Purchased: _____

*Dealer Store Address: _____

* Purchase Invoice with purchase date and product model cycled attached:

Defect Problem Description:

Spa Pool Cracking () Control Box () Other Problems, state details in the below ()

IMPORTANT:

- For Spa pool (body) problem – Picture of defect part need to be attached along with the mail-in warranty card and is **MANDATORY** to claim the warranty
-
- For electric part(s) or control box problem – Send the control box to your local MSpa Service Center. See the Service Center Contact List in the manual.

