

INSTALLATION



Caution: All installation types need to allow room for faucet installation. Ensure adequate clearance behind the basin for your faucet and backsplash, as well as the full range of motion for faucet handles and spouts. All basins, especially under mount and apron front installations, should be installed by professional installers.



The Sinkology **Dual-Flex rim** is designed with a Flat Standard under-mount rim, also has a slight curve at the end to allow for decorative and flexible drop-in installation.

BATH - DROP-IN INSTALLATION

Step 1. Flip sink upside down and trace outside edge onto craft paper or cardboard. Add second line that is 1/2" inside that line. Cut out the center of the traced template using the second line.

Step 2. Position the template flat on the countertop to align with cabinet and plumbing connections. Mark opening on countertop. Drill a 1/2" hole on the inside of the scribed line to start cutout, then use a jigsaw to cut the countertop.

Step 3. Position the sink in the hole and check for gaps around the rim. Eliminate gaps by gently tapping the rim with a rubber mallet.

Step 4. Attach drain assembly to sink.

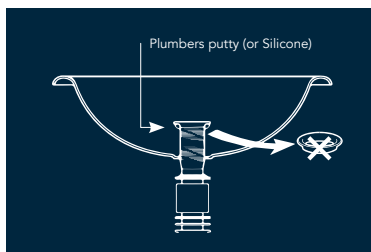

Step 5. Apply silicone to the bottom rim of the sink. Position the sink in the cutout, and use weight in the basin to hold the sink in place.

Step 6. Clean excess silicone. Apply polyurethane to seal the gap between the sink and countertop. Mount faucet.

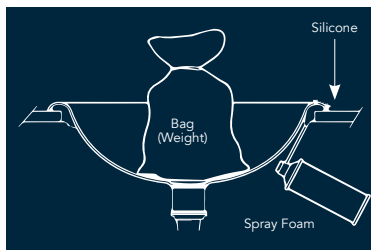

Step 7. Treat copper sinks with Sinkology Copper Armor for maximum protection (apply based on directions on bottle).

BATH - UNDER-MOUNT INSTALLATION

Step 1. Flip sink upside down and trace outside edge, noting where the rim is located, on craft paper or cardboard. Add second line that is inside that line at the desired offset. Cut out the center of the traced template using the second line.

Step 2. Place the template on to the countertop, trace the edge with a pencil, and cut the hole into the countertop.

Step 3. Assemble waste fitting to basin, and use silicone to seal between waste fitting and the inside of the basin.

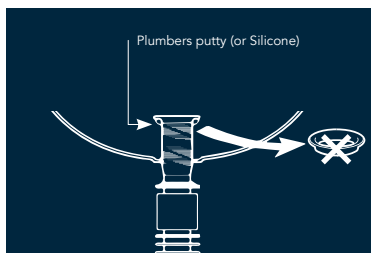

Step 4. Mount sink to countertop.

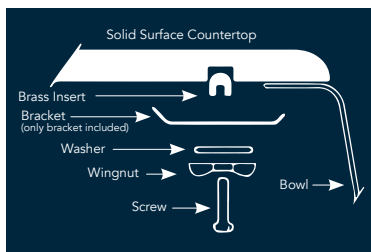

Step 5. Clean excess silicone and mount faucet.

Step 6. Treat copper sinks with Sinkology Copper Armor for maximum protection (apply based on directions on bottle).

BATH - VESSEL INSTALLATION

Step 1. Flip sink upside down and trace outside edge onto craft paper or cardboard. Outline faucet to ensure necessary clearance. Cut out template and place on the countertop.

Step 2. Find and mark the center of the sink based on the template. Remove template from countertop. Drill a 2 3/4" diameter hole in the center and chamfer the top edge of the hole by 1/8".

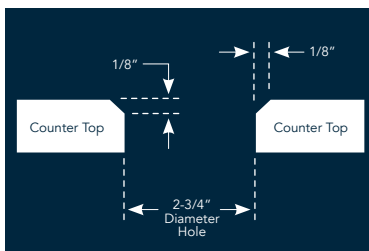

Step 3. Apply silicone to chamfer and mount sink to countertop using waste fitting and supplied Washer.

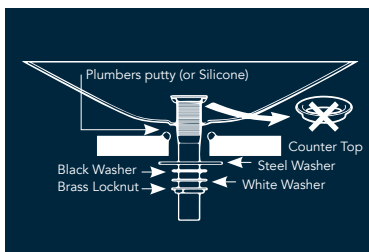

Step 4. Clean excess silicone and mount faucet.

Step 5. Treat copper sinks with Sinkology Copper Armor for maximum protection (apply based on directions on bottle).



KITCHEN - DROP-IN INSTALLATION

- Step 1.** Flip sink upside down and trace the inside edge onto craft paper or cardboard by placing arm through the drain hole. Add second line that is 3/8" outside that line. Cut out the center of the traced template using the second line.
- Step 2.** Position the template flat on the countertop to align with cabinet and plumbing connections. Mark opening on countertop. Drill a 1/2" hole on the inside of the scribed line to start cutout, then use a jigsaw to cut the countertop.
- Step 3.** Use the sink as a template for the faucet holes. Center the sink in the cutout. Use a pencil to mark the faucet holes. Remove the sink and use a 1 1/2" hole saw to cut out the necessary faucet holes.
- Step 4.** Install clamps. Place notched end of bolt into the keyhole slot. Lower the sink carefully into the countertop so the bolts enter without interference. (Illustration 4A) Turn the claws out 90° so they grasp the underside of the countertop. (Illustration 5A). Tighten the clamps gradually (Illustration 5B), in a sequence similar to that shown. (Illustration 5C). Please note that some kitchen sinks are designed to mount either as an undermount or drop-in. These sinks will not have install clamps and need to be installed using 100% silicone.

Illustration 4A

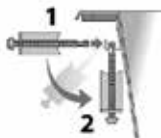

Illustration 5A

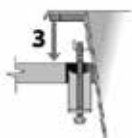

Illustration 5B



Illustration 5C



- Step 5.** Treat copper sinks with Sinkology Copper Armor for maximum protection (apply based on directions on bottle).



KITCHEN - UNDER-MOUNT INSTALLATION

- Step 1.** Flip sink basin upside down on countertop and mark countertop by tracing the edge of the basin. Measure the distance between the edge of the basin and the inside edge of the lip. Add a second line inside the first according to this measurement.
- Step 2.** Cut countertop based on the inside, second line.
- Step 3.** Apply silicone around hole in the underside of the countertop and position the basin.
- Step 4.** Use a level to make sure that the basin is sitting flush in all directions, while pressing down to seal.
- Step 5.** Clean excess silicone and mount faucet.
- Step 6.** Treat copper sinks with Sinkology Copper Armor for maximum protection (apply based on directions on bottle).



KITCHEN - APRON FRONT INSTALLATION

Step 1. Flip sink upside down and mark the countertop by tracing the inside edge of the basin by placing your arm through the drain hole.

Note: We recommend a ¼" reveal on 3 sides when using the under-mount style. For flush or built-up mount, cut countertop along the outside line of basin profile. Apron fronts are designed to be installed ¾" extended out beyond the front of the countertop.

Step 2. Cut the countertop based on the installation type.

Step 3. Place the basin and apply silicone as a gasket between the sink and the cabinet.

Step 4. Install countertop.

Step 5. Apply silicone around the top edge of the basin. Place the countertop around the basin. Ensure it is centered and remove any excess silicone.

Step 6. Install the drain mount.

Step 7. Treat copper sinks with Sinkology Copper Armor for maximum protection (apply based on directions on bottle).