



**PRIMO® FREESTANDING
BATH SERIES**

INSTALLATION AND OPERATION INSTRUCTIONS

Jacuzzi Luxury Bath
13925 City Center Drive, Suite 200
Chino Hills, CA 91709
www.jacuzzi.com

Contents

Contents 2

Product Information 2

Safety Instructions 3

Inspection and Testing 5

Sub Floor 5

Installation Procedure 5

Maintenance 9

Primo® 5390 Freestanding Bathtub Specifications 10

Primo® 6634 Freestanding Bathtub Specifications 11

Primo® 6836 Freestanding Bathtub Specifications 12

Authorized Service 13

Warranty 14

Notes 16

Warranty Registration Card 17

Product Information

NOTE

Save these instructions for future use. Use the form below to record your model and serial number for future reference.

Date Purchased: _____

Purchased From: _____

Installed By: _____

Serial Number: _____

Model: _____

Installer: Leave the manual for the homeowner.
Homeowner: Read this manual and keep for future reference.

Dealer/Installer
Information

Dealer/Installer
Information

Safety Instructions

INSTRUCTIONS PERTAINING TO A RISK OF FIRE, ELECTRIC SHOCK, OR INJURY TO PERSONS.

This is a professional grade product. A knowledge of construction techniques, plumbing and electrical installation according to codes are required for proper installation and user satisfaction. We recommend that a licensed contractor perform the installation of all Jacuzzi Luxury Bath products. Our warranty does not cover improper installation related problems.



CAUTION: When using this unit, basic precautions should always be performed, including the following:

READ AND FOLLOW ALL INSTRUCTIONS. SAVE THESE INSTRUCTIONS.

- Use this unit only for its intended use as described in this manual. Do not use attachments not recommended by the manufacturer.
- Never drop or insert any object into any opening.



WARNING: RISK OF ACCIDENTAL INJURY OR DROWNING!

Do not permit children to use this unit unless they are closely supervised at all times. Do not use hydromassage bathtub unless all suction guards are installed to prevent body and hair entrapment. Never operate the hydromassage bathtub if the suction cover is broken, damaged or missing.



DANGER: RISK OF SEVERE INJURY FROM ELECTRIC SHOCK OR DEATH FROM ELECTROCUTION!

This unit must be connected only to a supply circuit that is protected by a 15 amp ground fault circuit interrupter (GFCI). Such a GFCI should be provided by the installer and should be tested on a routine basis. To test the GFCI, push the test button. The GFCI should interrupt power. Push the reset button. Power should be restored. If the GFCI fails to operate in this manner, the GFCI is defective. If the GFCI interrupts power to the bathtub without the test button being pushed, a ground current is flowing, indicating a possibility of an electric shock. Do not use this hydromassage bathtub. Disconnect the hydromassage bathtub and have the problem corrected by a qualified service representative before using.



WARNING: RISK OF ELECTRIC SHOCK!

Connect only to a circuit protected by a ground fault circuit interrupter (GFCI). (For permanently connected units) A green-colored terminal (or a wire connector) marked "G," "GR," "GROUND," or "GROUNDING" is provided within the terminal compartment. To reduce the risk of electric shock, connect the terminal or connector to the grounding terminal of your electric service or supply panel with a conductor equivalent in size to the circuit conductors supplying the equipment.



CAUTION: This equipment is intended for indoor use only. Install the equipment in accordance with these instructions. Use supply wires that are suitable for 167°F (75°C), including the temperature rating of the supply conductors to be used. This unit should be electrically grounded and installed by a licensed contractor, electrician, and plumber. Building materials and wiring should be routed away from the motor/pump or blower or other heat producing components of this unit. A pressure wire connector is provided on the exterior of the motor/pump and heater to permit connection of an No. 8 AWG solid copper bonding conductor between this unit and all other electric equipment and exposed metal in the vicinity, as needed to comply with local requirements.

Important CSA Safety Instructions (Canadian models only)



When using this electrical equipment, basic safety precautions should always be followed, including the following:

1. WARNING: RISK OF ACCIDENTAL INJURY OR DROWNING! CHILDREN SHOULD NOT USE HYDROMASSAGE BATHTUB WITHOUT ADULT SUPERVISION.
2. WARNING: RISK OF ACCIDENTAL INJURY OR DROWNING! DO NOT USE HYDROMASSAGE BATHTUB UNLESS ALL SUCTION GUARDS ARE INSTALLED TO PREVENT BODY AND HAIR ENTRAPMENT.
3. WARNING: TO AVOID INJURY, EXERCISE CARE WHEN ENTERING OR EXITING THE HYDROMASSAGE BATHTUB.
4. WARNING: RISK OF ACCIDENTAL INJURY OR DROWNING! DO NOT USE DRUGS OR ALCOHOL BEFORE OR DURING THE USE OF A HYDROMASSAGE BATHTUB EQUIPPED WITH A HEATER TO AVOID UNCONSCIOUSNESS AND POSSIBLE DROWNING.
5. WARNING: RISK OF FETAL INJURY! PREGNANT OR POSSIBLY PREGNANT WOMEN SHOULD CONSULT A PHYSICIAN BEFORE USING A HYDROMASSAGE BATHTUB EQUIPPED WITH A HEATER.
6. WARNING: RISK OF HYPERTHERMIA AND POSSIBLE DROWNING: DO NOT USE A HYDROMASSAGE BATHTUB EQUIPPED WITH A HEATER IMMEDIATELY FOLLOWING STRENUOUS EXERCISE.
7. SAVE THESE INSTRUCTIONS.

Safety Instructions (Continued)



WARNING: RISK OF HYPERTHERMIA AND POSSIBLE DROWNING!

Do not use a hydromassage bathtub equipped with a heater immediately following strenuous exercise.



WARNING: RISK OF ELECTRICAL SHOCK!

- Do not permit electrical appliances (such as a hair dryer, lamp, telephone, radio or television) within 60" (1524 mm) of this hydromassage bathtub.
- Do not operate hydromassage system unless the bathtub is filled with water to at least 1-2" (25-51 mm) above the highest air hole.
- Do not immerse the control panel by overfilling the bathtub.
- When cleaning your bathtub, do not use abrasive substances which will damage the bathtub's surface.
- To prevent discoloration of the acrylic finish, do not fill the bathtub with water in excess of 140°F (60°C).



WARNING: PROLONGED IMMERSION IN HOT WATER MAY INDUCE HYPERTHERMIA!

Hyperthermia occurs when the internal temperature of the body reaches a level several degrees above the normal body temperature of 98.6°F (37°C). The symptoms of hyperthermia include an increase in the internal temperature of the body, dizziness, lethargy, drowsiness and fainting. The effects of hyperthermia include:

- A. Failure to perceive heat.
- B. Failure to recognize the need to exit the bathtub.
- C. Unawareness of impending hazard.
- D. Fetal damage in pregnant women.
- E. Physical inability to exit the bathtub.
- F. Unconsciousness resulting in danger of drowning.



WARNING: RISK OF FETAL INJURY!

Pregnant or possibly pregnant women should consult a physician before using a hydromassage bathtub equipped with a heater.



WARNING: The use of alcohol, drugs or medication can greatly increase the risk of fatal hyperthermia.

People using medications or having an adverse medical history should consult a physician before using a hydromassage bathtub equipped with a heater.



WARNING: The use of alcohol, drugs or medication can greatly increase the risk of fatal hyperthermia.

People using medications or having an adverse medical history should consult a physician before using a hydromassage bathtub equipped with a heater.



WARNING: Do not tamper with user-operated controls or such devices.



WARNING: Use this unit only for its intended use as described in this manual. Do not use attachments not recommended by the manufacturers.



WARNING: To avoid injury, exercise caution when entering or exiting the hydromassage bathtub.



WARNING: Do not use hydromassage bathtub unless all suction guards are installed to prevent body and hair entrapment. Never operate the hydromassage bathtub if the suction cover is broken, damaged or missing.



WARNING: Water temperature in excess of 104°F (40°C) may be injurious to your health. Check and adjust water temperature before use.



CAUTION: Test the ground fault circuit interrupter protecting this appliance periodically in accordance with manufacturer's instructions



IMPORTANT: Read the complete instructions provided in this manual before beginning installation.

The Company has obtained applicable code (standards) listings generally available on a national basis for products of this type. It is the responsibility of the installer/owner to determine specific local code compliance prior to installation of the product. The Company makes no representation or warranty regarding, and will not be responsible for any code compliance. Product specifications are subject to change without notice.

Inspection and Testing

Visual Inspection

- 1 Remove the bathtub from the shipping carton. Be careful not to scratch the surface of the bathtub on exposed staples. Remove the staples or fold them into the carton. Retain the carton until satisfactory inspection of the product has been made. Do not lift the bathtub by the plumbing at any time; handle by the shell only.
- 2 Inspect the shell and bathtub components. Should inspection reveal any damage or defect in the finish or visible damage to any components, do not install the bathtub. Damage or defect to the finish claimed after the bathtub is installed is excluded from the warranty. Jacuzzi Luxury Bath's responsibility for shipping damage ceases upon delivery of the products in good order to the carrier.
- 3 Refer any claims for damage to the carrier. For definitions of warranty coverage and limitations, refer to the published warranty information packed with the product or in the back of this manual.

Bathtub Water and Operational Test

All bathtub units are factory tested for proper operation and watertight connections prior to shipping. However, the unit must be retested by the installer prior to installation. Jacuzzi Luxury Bath is not responsible for any defect that could have been discovered, repaired, or avoided by following this inspection and testing procedure:

- 1 Place the bathtub on a level surface, near appropriate water supply, and water drainage. A driveway is a suitable choice.
- 2 Seal the drain and overflow hole with tape or a stopper and fill the bathtub to the bottom of the overflow hole.
- 3 Allow bathtub to stand for 5 minutes.
- 4 Visually inspect all joints for leaks. Do not install the bathtub if leaks are detected.
- 5 Return bathtub to box or otherwise protect from damage until time of installation.

Sub Floor

Prepare the sub floor for the drain and ensure that the area is level.

- 1 The drain/overflow of the bathtub extends below the bottom of the bathtub. Identify the drawing in the Technical Specifications section that corresponds with your bathtub (page 10-12).
 - 2 Determine the location of the basin. The floor must be flat and level.
 - 3 Make appropriate cuts to the Sub floor to accommodate the drain.
-  Please refer to the drawing(s) in the Technical Specifications section that correspond to your bathtub.

Installation Procedures

Before you begin your installation, please read the following:

- Observe all local land building codes.
- Determine which tools will be used during the installation.
- Additional bathtub drain ports and plumbing are commercially available at plumbing and hardware stores.
- Drain/Overflow rough-in information is included in your bathtub in the Technical Specifications section.

Preparation Before Installation

The floor structure must be able to support the total weight of the bathtub, bath water and bather, and the bath must be horizontally level and continuous to provide proper drainage. Also, make sure any water connections or electrical supplies are within the designated areas and that there will be no interference with the skirt or bath installation. Follow the installation instructions carefully to ensure stability and possible future service of the unit, should service be required.

Installation Procedures (Continued)

Primo® 5930 Installation

English

- 1 Install the metal drain/waste fitting (supplied with the tub) into the drain hole as illustrated (Figure 1). Ensure that the drain opening on the waste fitting is situated in the integral overflow channel (Figure 1).

- 2 Use clear silicone to adhere the bottom gasket to the underside of the integral overflow channel (Figure 1).

- 3 Secure the waste fitting with the supplied waste fitting nut. Apply thread sealant to the threads prior to inserting the nut. Overtightening the nut may cause shell damage. Ensure the drain opening on the waste fitting is not exposed after tightening of the nut.

- 4 Install a PVC thread adaptor (not supplied) to the metal waste fitting. This is to provide a PVC to PVC connection to the stub up in the floor. Water test fitting for leaks before installation.
NOTE: Use PVC Cement per ASTM D 2564 on all PVC joints.

- 5 Carefully lift the tub and apply a bead of clear silicone or construction adhesive to the bottom edge of the tub (Figure 1).

CAUTION! Before applying construction adhesive, please make sure that the permanent location of the bathtub has been determined.

- 6 Carefully lower tub over the drain stub up in the floor. Thread the metal toe-tap drain cover (supplied) into the waste fitting. Wipe off excess silicone or construction adhesive with a clean cloth.

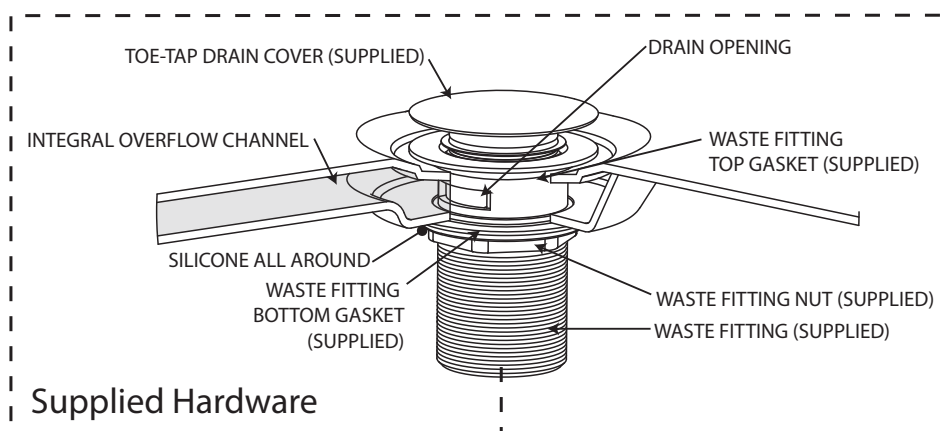

Supplied Hardware

Fig. 1

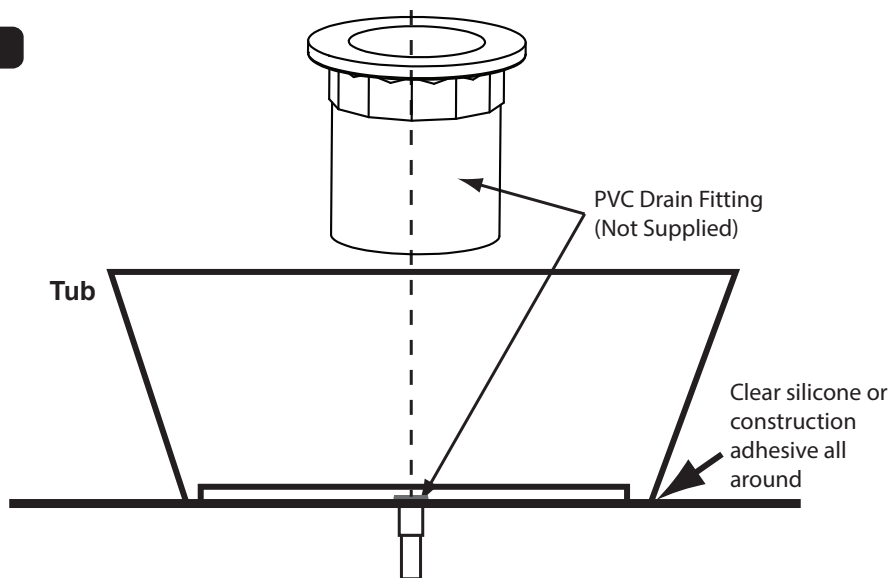

Installation Procedures (Continued)

Primo® 6634 Installation

- 1 Set the 2-piece tub in place and position it precisely with respect to the drain-overflow location. Verify where the indentation for the drain is in relation to the drain-overflow. Use a marker to outline the perimeter of the entire tub directly on the floor (Fig. 2).

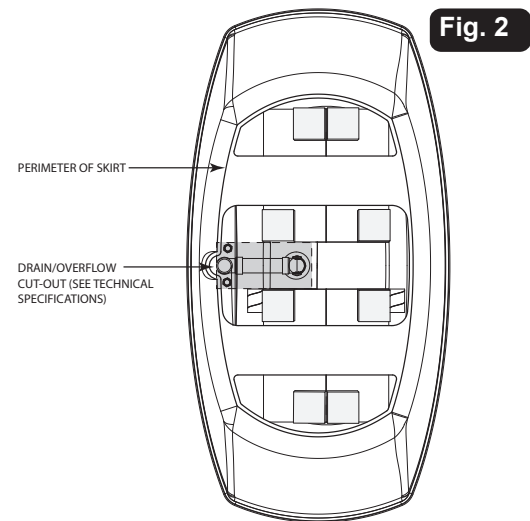

- 2 Mark trough for the overflow drain location. The drain-overflow extends below the bottom of the bath. The drain-overflow requires a cutout of the floor for providing space to accommodate the extension. Do not exceed the dimensions of the tub perimeter (Fig. 3).

- 3 When the above locations have been marked on the floor, remove the tub base (skirt), set it aside and continue with the installation process.

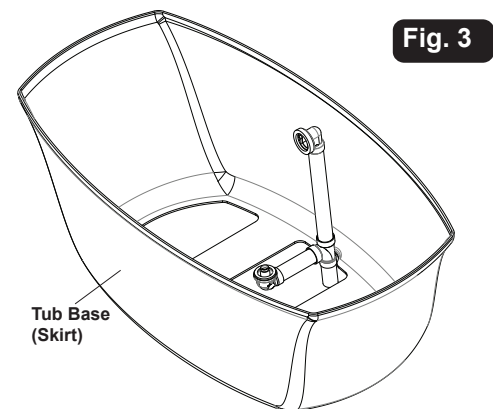

- 4 Faucetry is not supplied with the freestanding bath. To use deck-mounted faucetry, flexible connections lines that are 72" in length must be used. These lines need to be installed prior to installing the bath into the skirt.

- 5 When installing the faucet on the same side as the overflow, make sure there is no interference between the two before drilling.

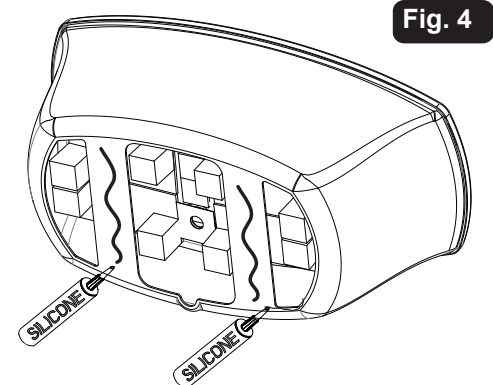

- 6 Use structural adhesive or silicone to attach tub skirt to Sub floor. Make sure the tub is properly oriented according to the drain-overflow end. (Fig. 4)

- 7 Place the tub skirt on the floor in relation to the drain/overflow. Place the tub skirt on the floor an line up with the markings previously made on the floor (Fig. 5). Allow the constuction adhesive to dry for 24-hours before entering and/or using the tub.

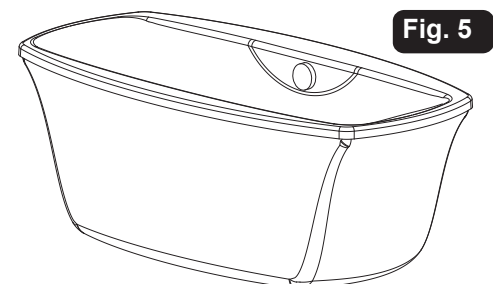

Installation Procedures (Continued)

Primo® 6836 Installation

Fig. 6

- 1 Set the tub in its place and position precisely with respect to the drain-overflow location. Verify where the indentation for the drain is in relation to the drain-overflow. Use a marker to outline the perimeter of the entire tub directly on the floor (Fig. 6).
- 2 Mark trough for the overflow drain location. The drain/overflow extends below the bottom of the bath. The drain/overflow requires a cutout of the floor for providing space to accommodate the extension. Do not exceed the dimensions of the tub perimeter. When the above locations have been marked on the floor, remove the tub, set it aside and continue with the installation process.

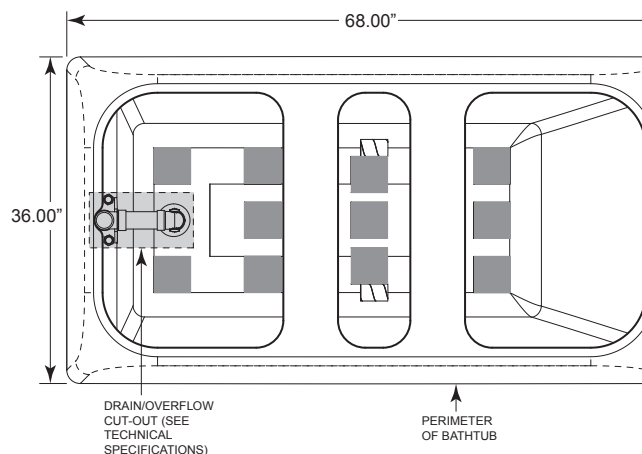

- 3 Prepare the drain/overflow trough according to the dimensions shown in the Technical Specifications section. The depth of the trough depends on the vertical extension of the drain elbow at the bottom of the plumbing below the floor level. Install drain/overflow according to the manufacturer's instructions. Refer also to the Technical Specifications section.



Watertight installation of the drain is the installer's responsibility. Drain leakage is excluded from the Jacuzzi Luxury Bath warranty of this product.

4

Before the tub may be secured to the floor, the following steps must be completed:

Place the tub on the floor in relation to the drain/overflow. Place the tub on the floor and line up with the markings previously made on the floor (Fig. 7).



Floor-mounted or wall-mounted faucetry can be used exterior to the bath, this can be installed after the bath is installed into the floor.

6

Clean up debris left over from the construction steps taken thus far. Also, remove the perimeter outline of the template on the floor.

7

Use structural adhesive or silicone to attach tub to the sub floor. Make sure the tub is properly oriented according to the drain/overflow end (Fig. 8).



If you are using adhesive to secure the tub to the floor, a bead of adhesive sealant should be applied around the bottom of the tub. Carefully place the tub on the floor in the correct position and press to the floor. Place weights around the perimeter and allow the adhesive to cure before proceeding.

Fig. 7

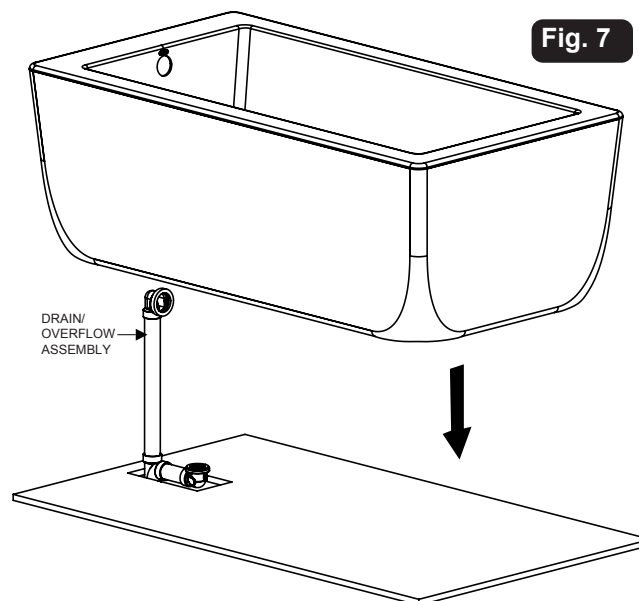
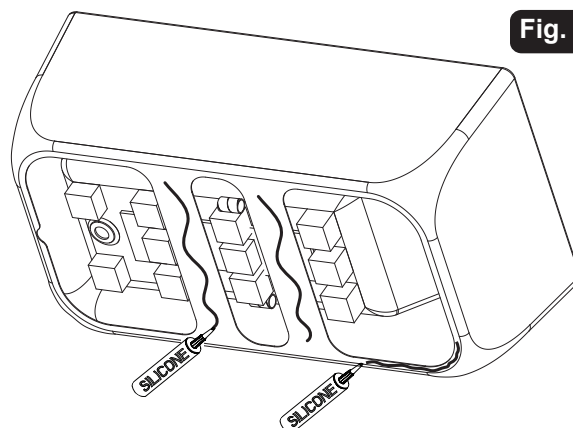

Fig. 8



Maintenance

Cleaning the Bathtub

To clean the bathtub, use a mild Meguiar's nonabrasive liquid detergent solution. You can protect and restore the luster to a dulled acrylic surface by applying Meguiar's #10 Mirror Glaze, a product specifically designed for use on acrylic finishes.



Never use abrasive household cleaners of any kind on any Jacuzzi Luxury Bath product.

Surface Repair

Minor scratches which do not penetrate the color finish can be removed by lightly sanding with #600-grit wet and dry sandpaper. Restore the gloss using Meguiar's Mirror Glaze. Major scratches and gouges which penetrate the acrylic surface will require refinishing. Call Jacuzzi Luxury Bath to find a service agent in your area.

Primo® 5930 Freestanding Bathtub Specifications

English

Letter	Description	Soaking
-	Drain Location	Center Drain
-	Pump Location	N/A
-	Cutout Template	N/A
-	Total Weight	845 lb (383 kg)
-	Floor Loading	69 lb/ft ² (337 kg/m ²)
-	Operating Gallons (Max)	60 Gal (227L)
-	Product Weight - Empty	97 lb (44 kg)
-	Soaking Depth	16.1" (409 mm)
L	Outer Length	59.00" (1499 mm)
W	Outer Width	30.00" (762 mm)
H	Overall Height	23.00" (584 mm)
J	Interior Dimensions: J(L) x J(W) Bottom of Bath	18.3" x 37.2" (465 mm x 945 mm)
K	Interior Dimensions: K(L) x K(W) Top of Bath	25.3" x 57.3" (643 mm x 1455 mm)
L	Interior Depth - Drain End (D)	18.5" (470 mm)
A	Overflow Height	16.3" (414 mm)
B	Long Edge to Drain Center	14.8" (376 mm)
C	Short Edge to Drain Center	29.5" (749 mm)
D	Drain Shoe Length	N/A
E	Flange Height	N/A
F	Deck Width*	2.1" (53 mm)
G	Service Access Dimensions	No Service Access
I	Floor Cutout for Drain	4.0" x 4.0" (102 mm x 102 mm)
M	Backrest Angle	30°

NOTE

The overall dimensions are nominal with a tolerance of +0 and -.25" (6mm). v

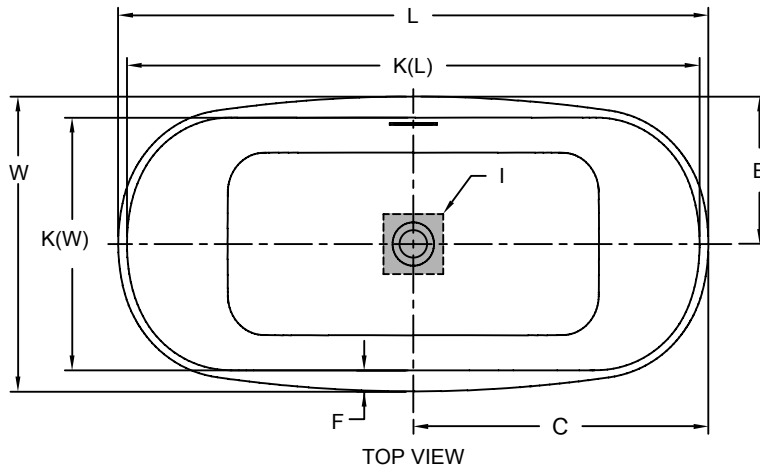

NOTE: Drawings not to scale.

*Deck width reflects only area indicated on detail.

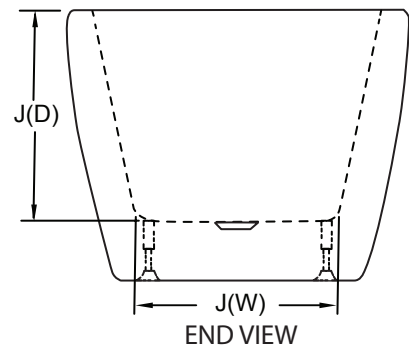
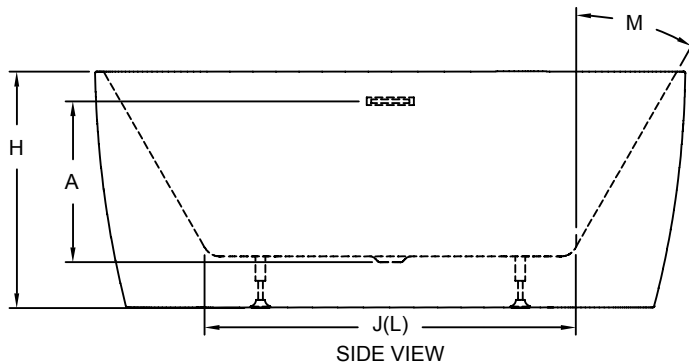

©2016 Jacuzzi Luxury Bath • For additional information call Customer Service 800-288-4002 • www.jacuzzi.com/baths/
Refer to installation instructions included with fixture before beginning installation. Please confirm product availability and specifications before commencing with any installation work.
PRODUCT SPECIFICATIONS AND AVAILABILITY ARE SUBJECT TO CHANGE WITHOUT NOTICE.

Primo® 6634 Freestanding Bathtub Specifications

Letter	Description	Soaking
-	Drain Location	Center
-	Cutout	N/A
-	Total Weight	922 lb (418 kg)
-	Floor Loading	55.8lb/ft ² (272.4 kg/m ²)
-	Operating Gallons (Max)	60 Gal (227 L)
-	Product Weight - Empty	122 lb (55 kg)
L	Outer Length	66.00" (1676 mm)
W	Outer Width	34.00" (864 mm)
H	Overall Height	24.00" (610 mm)
A	Overflow Height	18.50" (610 mm)
B	Long Edge to Drain Center	14.25" (362 mm)
C	Short Edge to Drain Center	33.00" (838 mm)
D	Drain Shoe Length	9.63" (245 mm)
E	Deck Height	1.50" (38 mm)
F	Deck Width	4.13" (105 mm)
I	Floor Cutout for Drain	12.00" x 4.00" (305 mm x 102 mm)
J	Interior Dimensions J(L) x J(W) Bottom of Bath	45.25" x 20.43" (1149 mm x 519 mm)

NOTE

The overall dimensions are nominal with a tolerance of +0 and -.25" (6mm). v

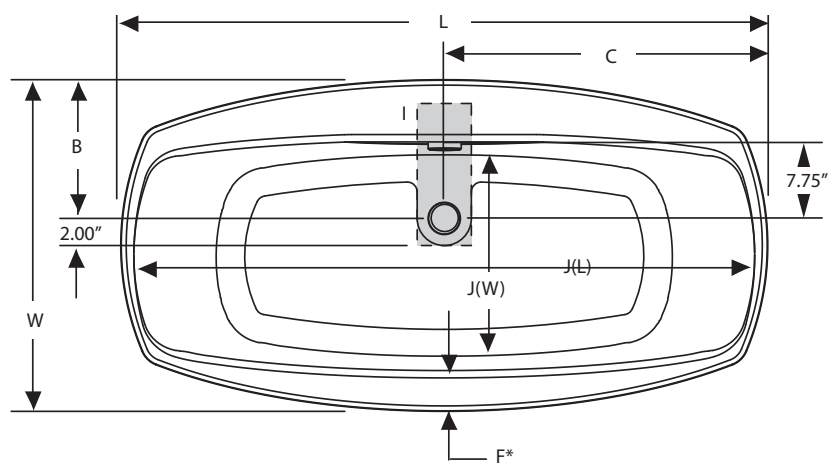

TOP VIEW

NOTE: Drawings not to scale.

*Deck width reflects only area indicated on detail.

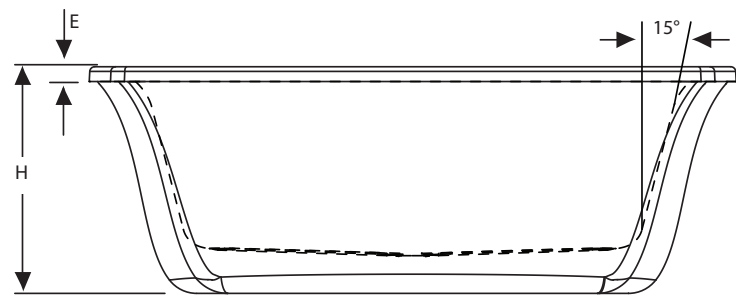

SIDE VIEW

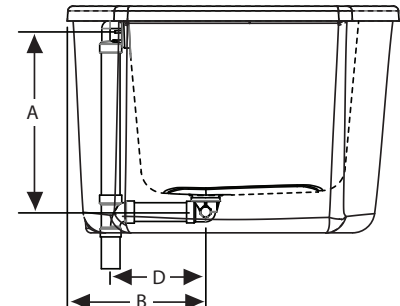

DRAIN/OVERFLOW

©2016 Jacuzzi Luxury Bath • For additional information call Customer Service 800-288-4002 • www.jacuzzi.com/baths/
 Refer to installation instructions included with fixture before beginning installation. Please confirm product availability and specifications before commencing with any installation work.
 PRODUCT SPECIFICATIONS AND AVAILABILITY ARE SUBJECT TO CHANGE WITHOUT NOTICE.

Primo® 6836 Freestanding Bathtub Specifications

Letter	Description	Soaking
-	Drain Location	Universal End Drain
-	Pump Location	N/A
-	Cutout Template	N/A
-	Total Weight	1136 lb (515 kg)
-	Floor Loading	68.9 lb/ft ² (336 kg/m ²)
-	Operating Gallons (Min/Max)	89 Gal (337L)
-	Product Weight - Empty	145 lb (66 kg)
-	Soaking Depth	18.50" (470 mm)
L	Outer Length	68.00" (1727 mm)
W	Outer Width	36.00" (914mm)
H	Overall Height	24.00" (610 mm)
J	Interior Dimensions J(L) x J(W) Bottom of Bath	20.90" x 44.70" (531 mm x 1135 mm)
K	Interior Dimensions K(L) x K(W) Top of Bath	28.15" x 58.13" (715 mm x 1477 mm)
L	Interior Depth - Drain End (D)	21.88" (556mm)
A	Overflow Height	21.00" (533 mm)
B	Long Edge to Drain Center	11.83" (300 mm)
C	Short Edge to Drain Center	18.00" (457 mm)
D	Drain Shoe Length	7.68" (195 mm)
E	Flange Height	N/A
F	Deck Width*	4.00" (102 mm)
G	Service Access Dimensions	No Service Access
I	Floor Cutout for Drain	12.00" x 6.00" (305 mm x 152 mm)
M	Backrest Angle	32°

NOTE

The overall dimensions are nominal with a tolerance of +0 and -.25" (6mm).

Drain Kit:
 Must purchase:
 LH33826 - Deep Soak DWO Kit BN
 LH33827 - Deep Soak DWO Kit CHR
 LH33845 - Deep Soak DWO Kit ORB

NOTE: Drawings not to scale.

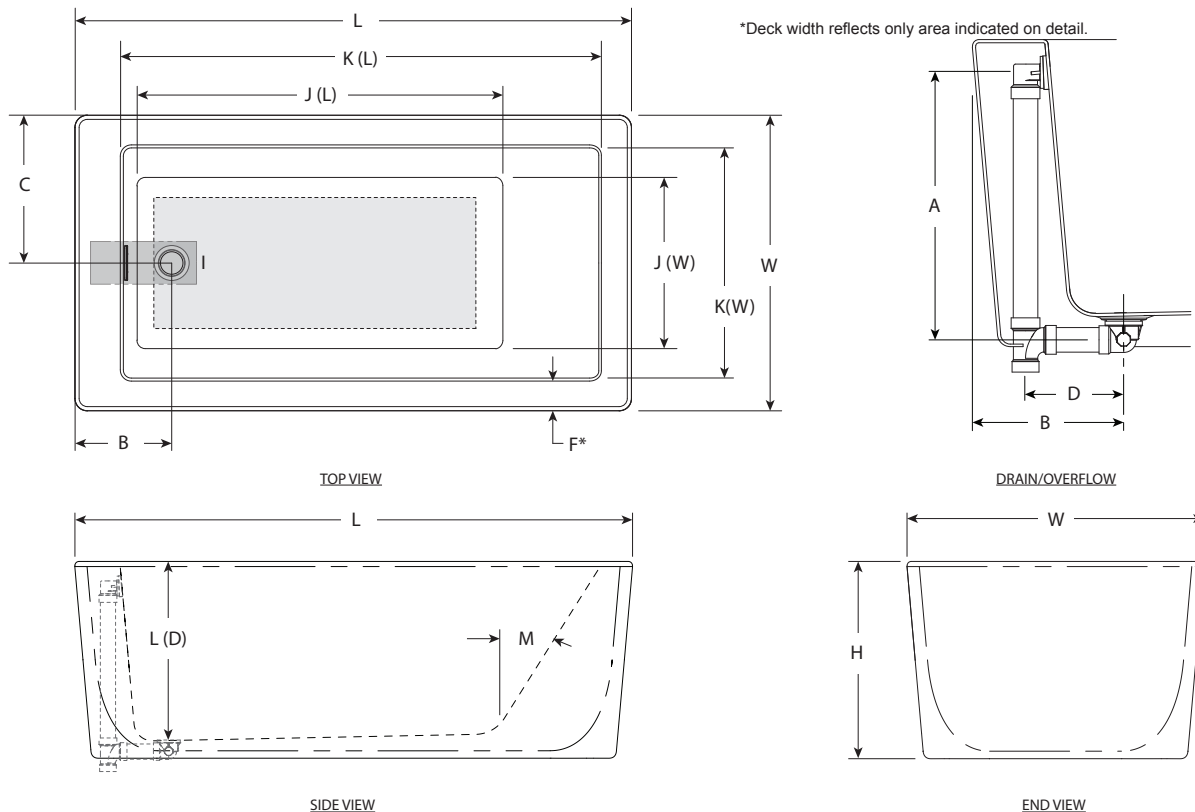

©2016 Jacuzzi Luxury Bath • For additional information call Customer Service 800-288-4002 • www.jacuzzi.com/baths/
 Refer to installation instructions included with fixture before beginning installation. Please confirm product availability and specifications before commencing with any installation work.
 PRODUCT SPECIFICATIONS AND AVAILABILITY ARE SUBJECT TO CHANGE WITHOUT NOTICE.

Authorized Service

If you need a referral for a service company near you, or need assistance with operation or maintenance-related questions, please call our Service Support Department at 1-800-288-4002. Visit our website at <http://www.jacuzzi.com/> for products, services, and an online copy of these Installation and Operation Instructions.

When requesting service or technical assistance please have available both the model and serial number of your unit. This information can be obtained from the product registration card provided with your unit. If the card has been misplaced, this information can be obtained from the specification/serial number label on the unit itself.

SPECIFICATION/SERIAL NUMBER LABEL

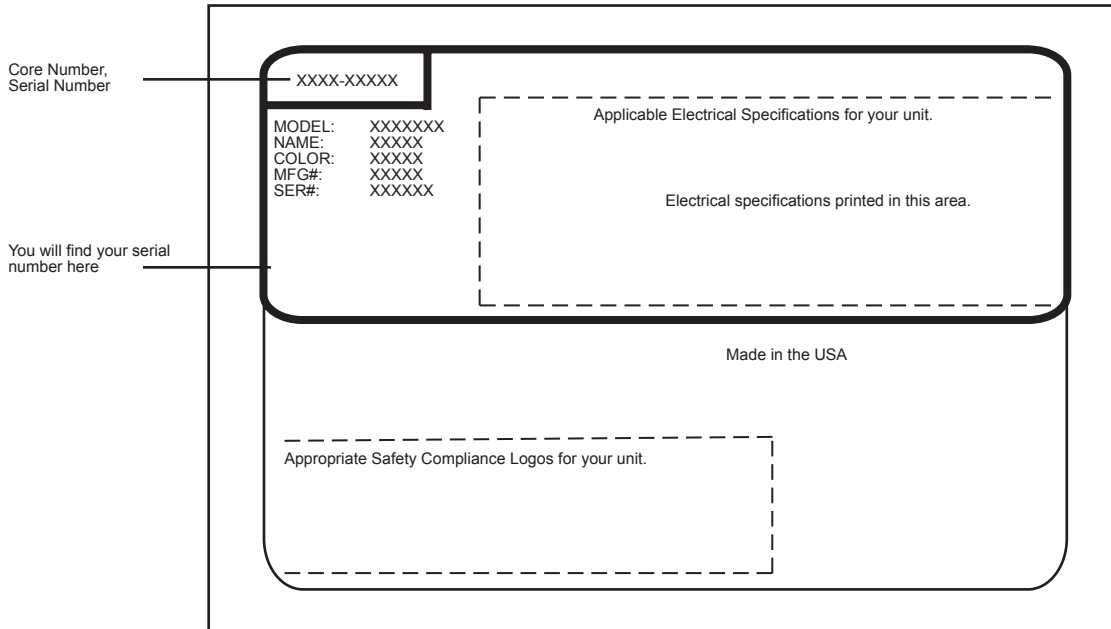

PRODUCT SPECIFICATIONS ARE SUBJECT TO CHANGE WITHOUT NOTICE.
 USE TECHNICAL SPECIFICATIONS MANUAL SUPPLIED WITH PRODUCT.

Jacuzzi Luxury Bath has obtained applicable code (standards) listings generally available on a national basis for products of this type. It is the responsibility of the installer/owner to determine specific local code compliance prior to installation of the product. Jacuzzi Luxury Bath makes no representation or warranty regarding, and will not be responsible for any code compliance.

Jacuzzi Luxury Bath
 13925 City Center Drive, Suite 200
 Chino Hills, CA 91709
 1-800-288-4002
www.jacuzzi.com

Limited Lifetime Warranty on Jacuzzi Branded Baths for the Primo® Collection

WARRANTY COVERAGE

Jacuzzi® Luxury Bath (the "Company") offers the following expressed limited lifetime warranty to the original purchaser of any Jacuzzi® Luxury Bath products provided in the Company's Primo® collection who purchases the Bath for personal or single family residential use ("user"): The Company will repair or replace, at its sole option, the Bath or its equipment in accordance with the following terms and conditions.

LIFETIME WARRANTY ON BATHS

The Company extends to the user of the Bath a non-transferable limited lifetime warranty that the shell will maintain its structural integrity and configuration and be free of water loss due to a defect in the tub shell. This warranty covers only the tub shell and the manufacturer installed pump, jets, controls, and blower against defects in material or workmanship. This warranty does not apply to any display models or to any options or accessories which are covered under our limited ninety (90) day warranty set forth below. Warranty coverage begins on the date the unit was originally purchased by the user and upon receipt by the Company of a completely filled out Warranty Registration Card as described below.

1 YEAR LABOR WARRANTY FOR ALL FACTORY INSTALLED COMPONENTS:

Our limited labor warranty is for a period of One (1) Year from the date the unit was originally purchased by the user, but not more than Two (2) Years from date of manufacture. All factory installed components (e.g., pump, motor, blower, and plumbing) are covered under our labor warranty against failure due to defects in materials and workmanship.

1 YEAR (PARTS ONLY) LIMITED WARRANTY ON OPTIONAL HEATER

Our limited warranty on our optional Heater is for One (1) Year for parts only and excludes labor. Warranty coverage begins on the date the heater was purchased as an option for use on Primo® baths only.

90 DAY (PARTS ONLY) LIMITED WARRANTY ON OTHER OPTIONS AND ACCESSORIES

Our warranty covers options and accessories manufactured for the company but not installed by the factory (e.g., fill spout kits, trim kits, skirts, pillows, etc.) against defects in material or workmanship. Warranty coverage begins on the date the option or accessory was originally purchased by the user. These items may be covered by a manufacturer's warranty which may have a longer duration than this limited warranty. Please confirm with the manufacturer the duration of the appropriate warranty for Options and Accessories.

WARRANTY LIMITATIONS

Our limited warranty does not cover defects, damage, or failure caused by the common carrier, installer, user, or other persons, pets, or rodents, or resulting from, without limitation, any of the following: careless handling (lifting unit by plumbing, abrading finish, etc.) including its own negligence; modification of any type for any reason (including modification to meet local codes); improper installation (including installation not in accordance with instructions and specifications provided with the unit); connections supplied by the installer of the equipment; improper voltage supply or unauthorized electrical modification; misuse; incorrect operation, or lack of proper routine maintenance; operation of the unit without specified minimum amount of water or at inappropriate water temperature; use of abrasive or improper cleaners; or acts of God, such as lightning, floods, earthquakes, etc. In addition, THE COMPANY WILL NOT BE RESPONSIBLE FOR INCIDENTAL OR CONSEQUENTIAL DAMAGES or losses arising from any cause (e.g., water damage to carpet, ceiling, tiles, marble, loss of use, etc.) including its own negligence; damages to, respecting, or resulting from: plated parts when pool and/or spa chemicals are used in the unit or hard water conditions; optional bath equipment not manufactured by the Company but supplied by Dealer, installer or the Company; the unit's prior usage as an operational display; or defects that should have been discovered before installation. This limited warranty does not include: labor, transportation, or other costs incurred in the removal and/or reinstallation of the original unit and/or installation of a replacement unit; any costs relating to obtaining access for repair; or loss of use damage, including loss of sales, profit or business advantage of any kind under any circumstances. Bath units are excluded from any warranty coverage if any addition, deletion, or modification of any kind whatsoever has been made to the unit (or to any component). Warranty coverage is provided in the United States of America, Canada and Mexico only.

EXCLUSION OF IMPLIED WARRANTIES

IMPLIED WARRANTIES OF MERCHANTABILITY AND FITNESS FOR A PARTICULAR PURPOSE ARE DISCLAIMED TOGETHER OR TO THE FULLEST EXTENT ALLOWED BY LAW.

NOTICE: This warranty gives you specific legal rights, and you may also have other rights which vary from state to state. There are no warranties applicable to Jacuzzi Luxury Bath products except as expressly stated herein or as implied by applicable state and federal laws. The Company will not be responsible for any statements or representations made in any form that go beyond, are broader than or are inconsistent with any authorized literature or specifications furnished by the Company. Some states do not allow limitations on how long an implied warranty lasts, or the exclusion or limitation of incidental or consequential damages, so the above limitations and exclusions may not apply to you.

RETURN OF WARRANTY CARD

The attached Warranty Registration Card MUST be filled out by the purchaser within thirty (30) days from purchase and received by Jacuzzi Luxury Bath in order for this warranty to become effective.

RETURN OF WARRANTY REGISTRATION

To register your product, please go to our web-site Jacuzzi.com. You will then be prompted to enter your product Serial Number followed by your warranty registration information. Or you may also register by completing the registration below and mailing it to Jacuzzi at the address provided below. The attached Warranty Registration MUST be filled out by the purchaser within thirty (30) days from purchase and received by Jacuzzi Luxury Bath in order for this warranty to become effective.

RESPONSIBILITIES OF OTHERS

Inspecting the unit prior to installation is the responsibility of the installer or building contractor who acts on behalf of the User. They are responsible for ensuring the unit is free of defect or damage. Notices are placed on and in the unit and on the shipping carton advising the installer of this responsibility. In the event of a problem, the unit must not be installed. The Company is not responsible for failures or damage that could have been discovered, repaired, or avoided by proper inspection and testing (including proper water testing) prior to installation. Damage occurring in transit is the responsibility of the carrier. The User or installer MUST open the crate and inspect the unit for damage when it is delivered. If damage is discovered, it must be reported immediately to the seller and the carrier in writing, and an inspection requested. Failure of the carrier to respond should be reported to the seller and the carrier. Your freight claims should be filed promptly thereafter. Damage occurring to the unit during installation is the responsibility of the installer and/or building contractor and damage occurring thereafter is the responsibility of the user. Failure of any optional equipment is the sole responsibility of the equipment manufacturer except as provided above and shall not extend to or apply to any replacement parts for the Options and Accessories. Any replacement parts shall be covered by the original equipment manufacturer. The Distributor or Dealer is responsible for knowing local code requirements and notifying the installing contractor and/or User of these requirements at the time of purchase. The Company is not responsible for costs to modify any product to obtain any code approval, such as city, county, or state building codes in U.S.A. or municipal or provincial codes in Canada and Mexico.

WARRANTY SERVICE

For the customer's benefit, the Company maintains a list of independent service personnel to perform required warranty service repairs. Such firms are not agents or representatives of the Company and cannot bind the Company by words or conduct. The Company will provide the warranty service described above when the following conditions have been met: the failure is of the nature or type covered by the warranty; the User has informed an Authorized Jacuzzi Luxury Bath Service Agent or Warranty Service Department Representative of the nature of the problem during the warranty period; conclusive evidence (e.g., proof of purchase or installation) is provided to the foregoing by the user proving that the failure occurred or was discovered within the warranty period; an authorized independent service person or Company representative has been permitted to inspect the unit during regular business hours within a reasonable time after the problem was reported by the User. In order to obtain warranty service, contact Jacuzzi Luxury Bath at:

jacuzzi.com

or

Warranty Service Department
14525 Monte Vista Avenue
Chino, California 91710
Call: 1-(800) 288-4002

To obtain warranty replacement for factory-installed components for Company supplied options and accessories manufactured and supplied by the Company, call or write the above. Provide a description of the problem and proof of purchase. You will be instructed how to obtain replacements and where to return, at your expense, the failed component(s), option(s), or accessory(ies).

All replacement parts, equipment, and repairs shall assume the remaining warranty period of the part(s) replaced.

The Company's warranty obligation shall be discharged upon tender of replacement or repair. The customer's refusal to accept the tender terminates the Company's warranty obligation.

Ninety-Day
Parts Only
Limited Warranty
On
Accessory(ies)

Jacuzzi® Luxury Bath
TP48000B



Notes:



Jacuzzi Luxury Bath
14525 Monte Vista Avenue
Chino, California 91710



WARRANTY REGISTRATION CARD

To complete your registration, visit our website at www.jacuzzi.com or fill out and mail this card to the address printed on the other side within thirty (30) days from date of purchase in order for this warranty to be come effective.



Purchaser's Name _____
Purchaser's Address _____
City _____ State __ Zip _____
Home Phone: _____ Cell Phone: _____
Email: _____
Date of Purchase _____
Model Name _____
Serial Number _____
Dealer's Name _____
Dealer's Address _____

- 1. How did you first hear about this Jacuzzi product?
2. Who first gave you specific information about this product (specifications, prices, etc.)?
3. What was the main reason for purchase?
4. Who finally decided which product you would buy?
5. Who installed?
6. What is the current market value of this property?
7. What is the age of the head of the household? Years
8. What other manufacturers did you consider?
9. How long did you shop before purchasing unit?
10. Approximately how long have you lived in this home?
11. Please indicate, approximately, the total annual income of your household.
12. Was your purchase process?
13. How technically aware were you of the patented Jacuzzi jet system prior to your purchase?

Ninety-Day
Parts Only
Limited Warranty
On
Accessory(ies)