

STANDARD MAINTENANCE AND TROUBLESHOOTING

REPLACING THE CARTRIDGE

1. Shut off the water supply to the faucet.
2. Turn on the faucet briefly to relieve any pressure inside the faucet.
3. Move the faucet handle to the "OFF" position.
4. Disconnect flexible supply hoses from the water supply.
5. Remove indicator cap C from the lever handle.
6. Remove the screw B using an allen key.
7. Pull the lever handle A from the faucet body .
8. Unscrew the cap D.
9. Unscrew the cartridge lock nut E.
10. Lift ceramic disk cartridge F from the body and repalce it with a new one. Ensure the two lugs on bottom of the cartridge sit properly in the allocated holes at the base of the body.
11. Re-assemble faucet in reverse order.
12. Test for leakage.

GENERAL MAINTENANCE

Clean aerator periodically for any buildup .
Do not use harsh detergents, solvents, chemical agents, metallic sponges, etc. that could harm the surface and damage the finish.
Clean only with a soft sponge and soapy water.

SPARE / REPLACEMENT LIST

A+B+C+G.	Handle assembly	F2901CH	F2901SN
D.	Cap	F2902CH	F2902SN
E.	Lock nut	F2903	
F.	Cartridge	F2904	
H.	Spout	F2905CH	F2905SN
L.	Spray head assembly	F2906CH	F2906SN
11.	Aerator wrench	F2907	
	CH chrome		SN satin nickel

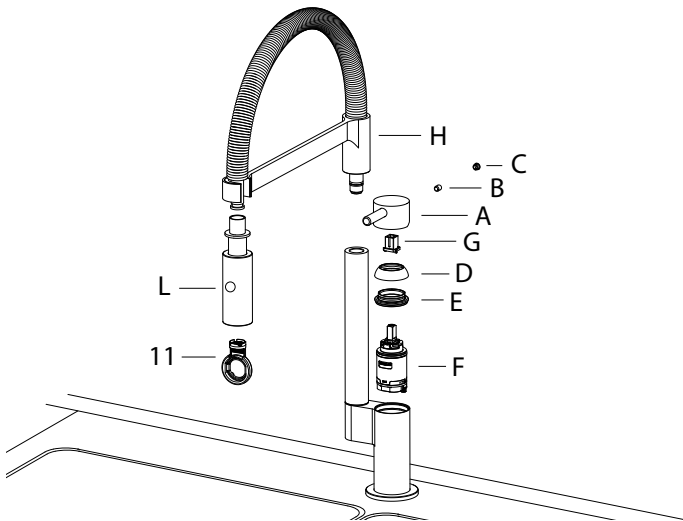

LIMITED LIFETIME WARRANTY

Franke Consumer Products, Inc., Kitchen Systems Division extends the following warranty to the original purchaser of its faucets effective January 1, 2003.

All faucets installed in a private residence will carry a limited lifetime warranty on all mechanical parts to be free of manufacturing defects in material and workmanship under normal usage. All chrome finishes carry a limited lifetime warranty; all other finishes are warranted for five (5) years from the original date of purchase.

Marine and Outdoor Installation: Franke Consumer Products, Inc. faucets are NOT warranted for Marine and Outdoor installations.

This warranty applies only to the original owner, providing the product has been installed in accordance with our installation instructions, used as recommended and in a normal residential application. In the event of a warranty claim, the owner will be required to provide proof of purchase - save sales receipt. This warranty covers all components which make the product operational. Franke, at its option, may repair or replace the product or components necessary to restore the product to good working condition. Franke reserves the right to inspect the installation prior to the actual replacement of the product or component part. This warranty does not cover misuse or abuse, accidental damages, scuffs or scratches, improper installation, abnormal usage, negligence or damage caused by improper maintenance or cleaning. Normal wear of parts is excluded from the warranty. Damage caused by impurities or acts beyond our control are not covered. Any product or part which has been repaired or altered in any manner outside of Franke's factory, unless previously authorized in writing by Franke, will void warranty. **Any replacement excludes transportation and any labor re-installation costs.** This warranty does not allow recovery of incidental or consequential damages such as loss of use, delay, property damage or other consequential damage, and Franke accepts no liability for such damages.

The Franke warranty is limited to the above conditions and to the warranty period specified herein and is exclusive. Franke DISCLAIMS all other warranties, expressed or implied, including IMPLIED WARRANTIES OF MERCHANTABILITY AND/OR FITNESS FOR AS PARTICULAR PURPOSE. This warranty gives you specific legal rights that may vary from state to state.

Further information

For any further information about our products, about the installation of them or about the guarantee, please dial the number of the customer service:

Phone number +1-215-822-6590

Or: 1-800-626-5771

Fax number + 1-215-822-5873

Franke Consumer Products Inc. - Kitchen Systems Division
3050 Campus Drive, Suite 500 Hatfield, PA 19440

INSTALLATION MANUAL

FF2900 - FF2980



KITCHEN
SYSTEMS

FRANKE

TECHNICAL DATA

Standard Water Flow 2 GPM at 22,5 PSI
 Maximum Water Flow 2.2 GPM at 150 PSI
 Recommended Pressure Range 22,5 PSI
 Complies with NSF61, AB1953, and ASME A112.18.1-2005/CSA B 125.1-2005 Requirements

NOTE:

Call us immediatly if you see inconsistencies.
 (1- 800-626-5771)
 or visit
www.frankeksd.com
info.fks@franke.com

CONTENTS IN BOX

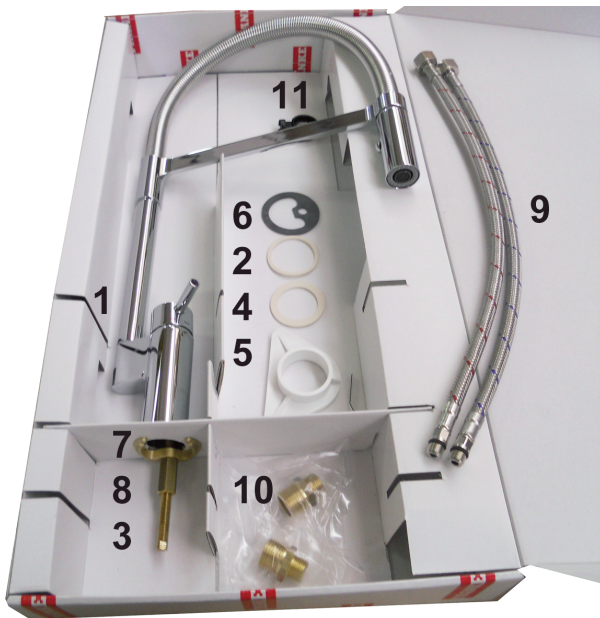

- 1 Faucet assembly
- 2 Rubber washer
- 3 Mounting Shank
- 4 Rubber washer
- 5 Plastic flange
- 6 Shaped washer
- 7 Fixing plate
- 8 Fixing nut
- 9 Flexible supply hoses
- 10 Nipples (not included in US models)
- 11 Key for aerator

INSTALLATION INSTRUCTIONS

1. Remove all contents from the package and check for completeness.
2. Flush pipe work to ensure it is free from debris.
3. Turn off water supply.
4. Remove faucet and hardware from its protective packaging.
Faucet comes assembled.
5. Connect the 2 flexible supply hoses (9) - red hot water, blue cold water - to the body of the faucet (1).

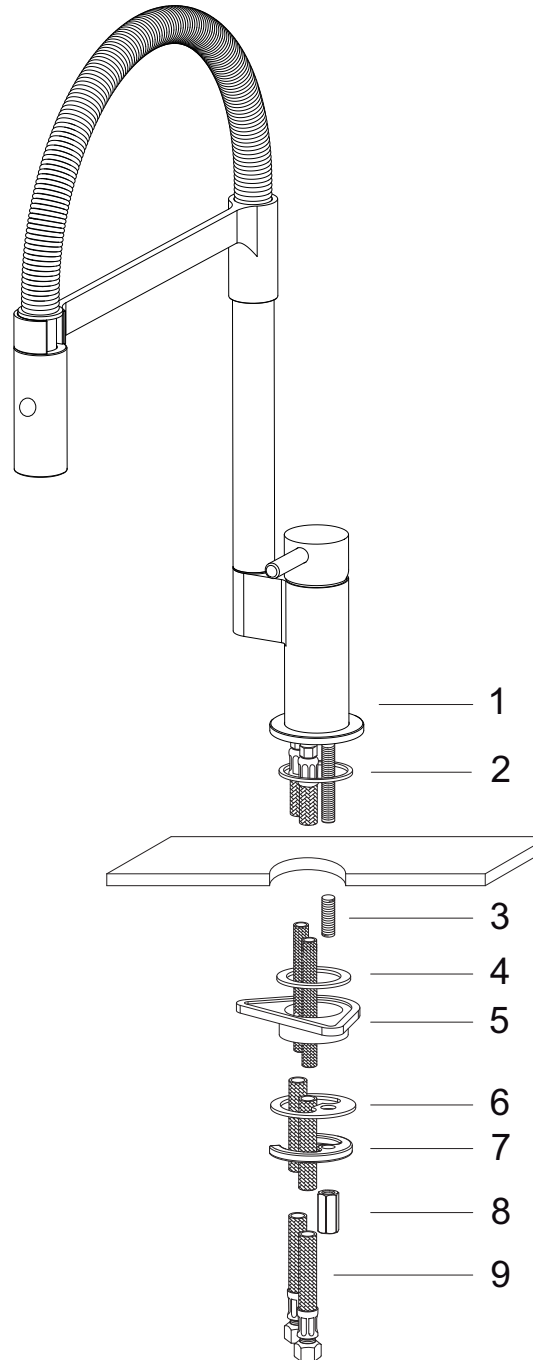

6. Cut a mounting hole 1 3/8 diameter (35mm) in the desired position in counter top or sink (if one isn't available).
7. Place the rubber washer (2) over the hole.
ATTENTION: The washer should be sitting between the countertop and faucet base.
DO NOT use putty or other sealant at this location.

NOTES:

Solid surface installation: The countertop mounting surface needs to be flat and free of debris otherwise the faucet may not sit properly. For tile installations, avoid installing faucet near or on top of grout lines. This may cause a weak joint between the faucet and the counter and could cause leaks.

8. Install the mounting hardware to the base of the faucet body in the following order - rubber washer (4); plastic flange (5) shaped washer (6) and the fixing plate (7) as illustrated.

9. Tighten the body down installing Fixing Nut (8) to the Mounting Shank (3).

10. Connect the flexible supply hoses to the water supply in the house and turn on the faucet. Ensure everything is functioning properly and check/ test for leak.