



ITEM #0160126

3 PC NESTING TABLE SET

MODEL #1005PT

Français p.6

Español p.11

allen + roth® is a registered trademark of LF, LLC. All Rights Reserved.

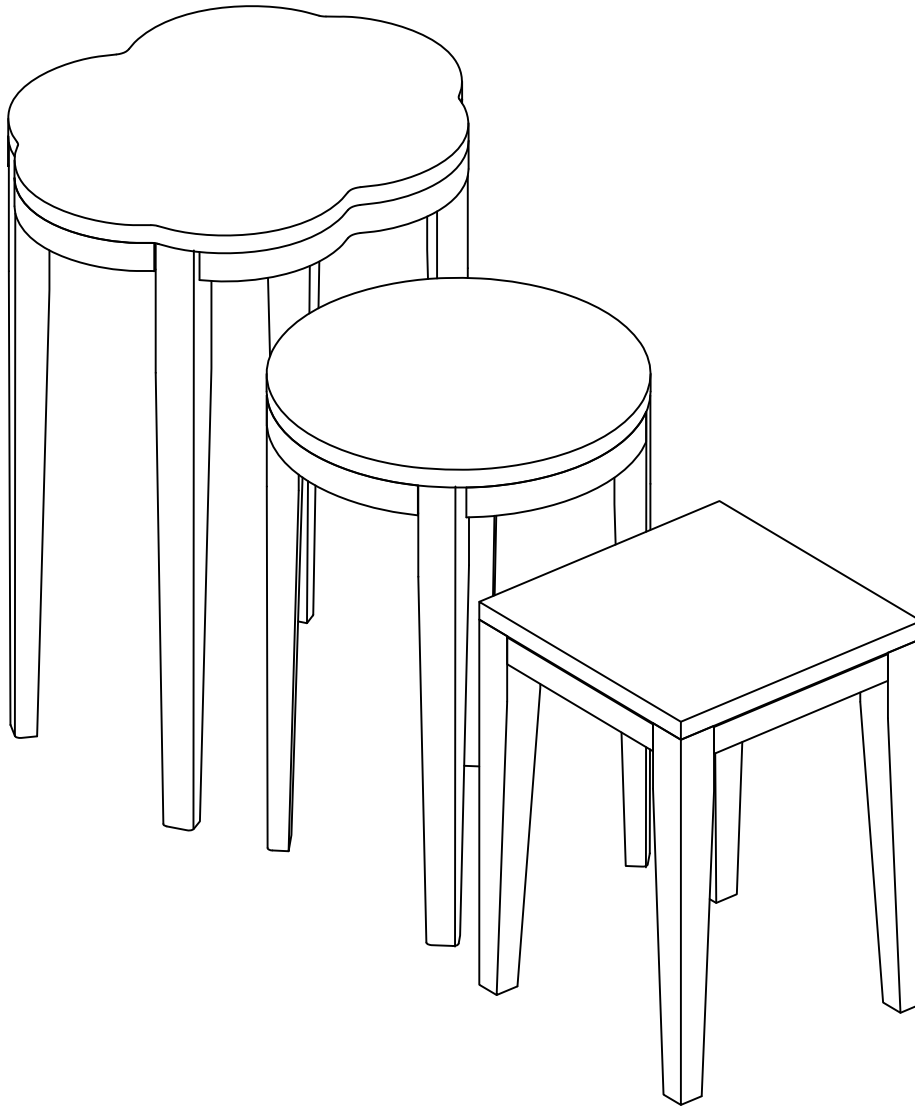

ATTACH YOUR RECEIPT HERE

Serial Number _____ Purchase Date _____



Questions, problems, missing parts? Before returning to your retailer, call our customer service department at 1-866-439-9800, 8 a.m. - 8 p.m., EST, Monday - Friday.

XXXXXX

Lowes.com/allenandroth allen + roth

PACKAGE CONTENTS

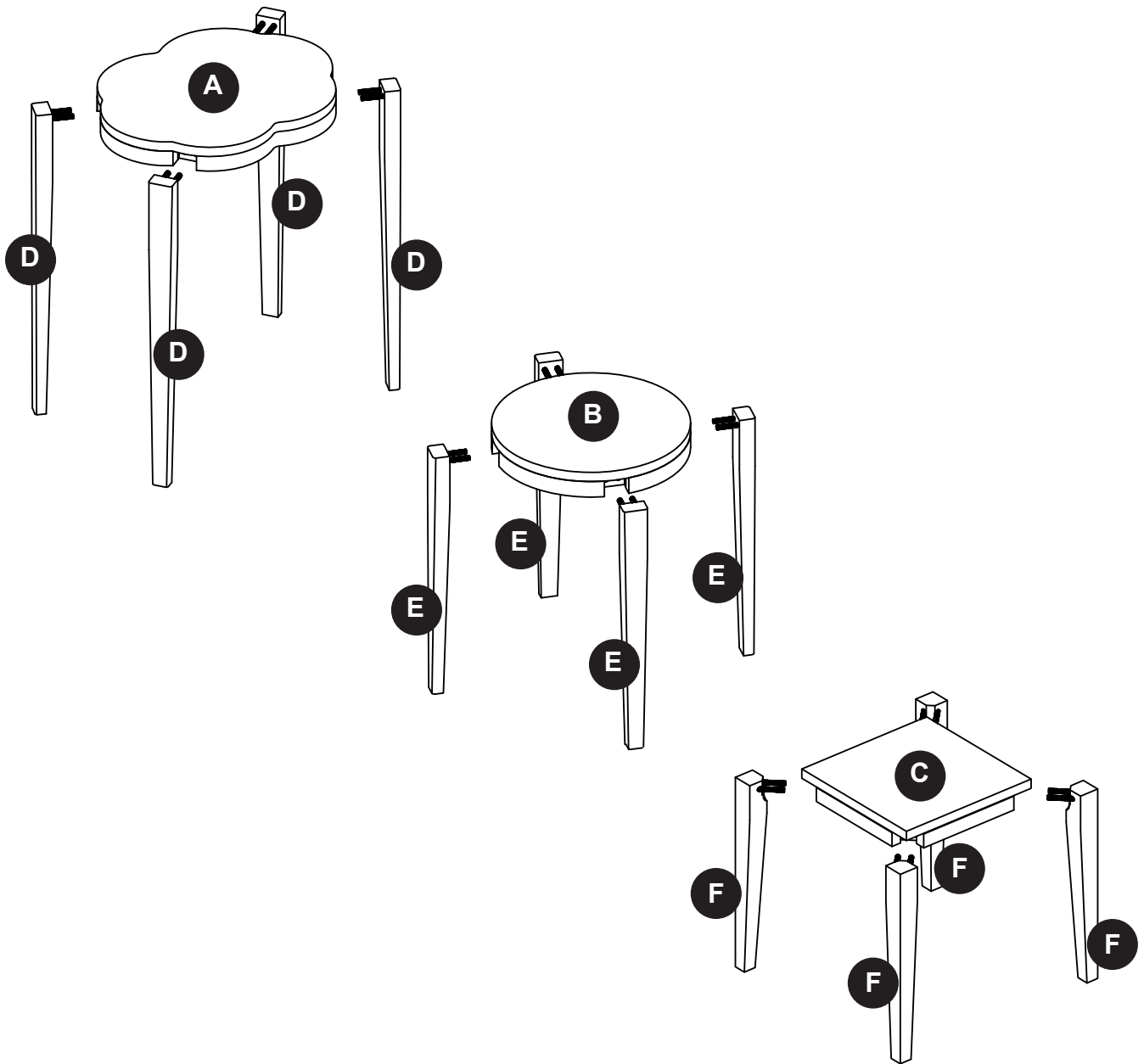

PART	DESCRIPTION	QUANTITY
A	Scalloped Table Top	1
B	Round Table Top	1
C	Square Table Top	1

PART	DESCRIPTION	QUANTITY
D	Large Leg	4
E	Medium Leg	4
F	Small Leg	4

HARDWARE CONTENTS (shown actual size)

AA

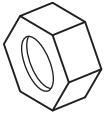

Nut

Qty. 24

BB

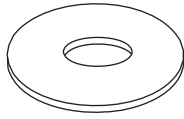

Flat
Washer

Qty. 24

CC



Lock
Washer

Qty. 24

DD

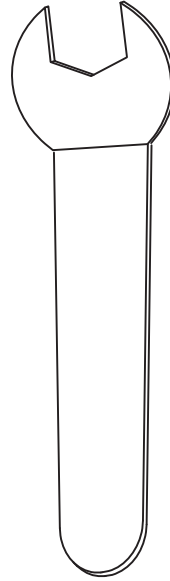

Hex
Wrench

Qty. 1



SAFETY INFORMATION

Please read and understand this entire manual before attempting to assemble, operate or install the product.

- Assemble the parts on a soft, non-abrasive surface, such as carpeting, to avoid scratching the finish.



WARNING

- Do not allow children to climb on this product.

PREPARATION

Before beginning assembly of product, make sure all parts are present. Compare parts with package contents list and hardware contents list. If any part is missing or damaged, do not attempt to assemble the product.



Estimated Assembly Time: 45 minutes

Tools Required for Assembly (included): Hex Wrench

ASSEMBLY INSTRUCTIONS

1. Attach large legs (D) to scallop table top (A) using two nuts (AA), two flat washers (BB) and two lock washers (CC). Tighten with hex wrench (DD). Do not overtighten to avoid cracking the wood.



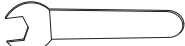

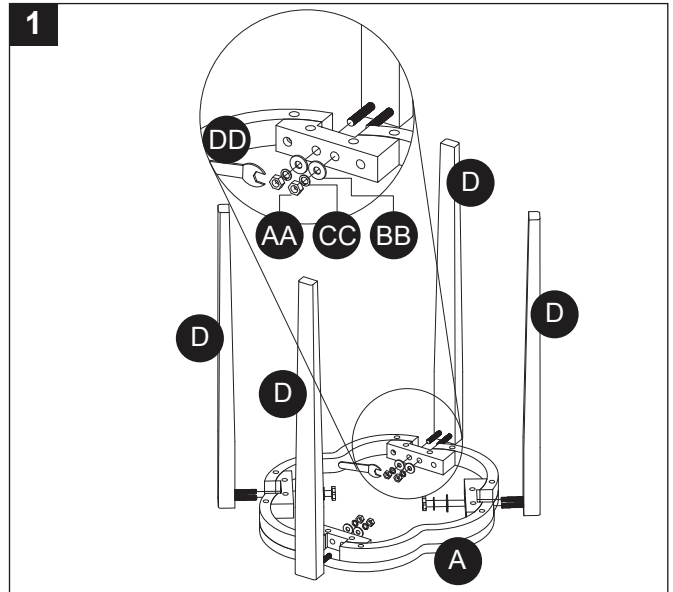
Hardware Used

AA	Nut		x 8
BB	Flat Washer		x 8
CC	Lock Washer		x 8
DD	Hex Wrench		x 1



2. Attach medium legs (E) to round table top (B) using two nuts (AA), two flat washers (BB) and two lock washers (CC). Tighten with hex wrench (DD). Do not overtighten to avoid cracking the wood.

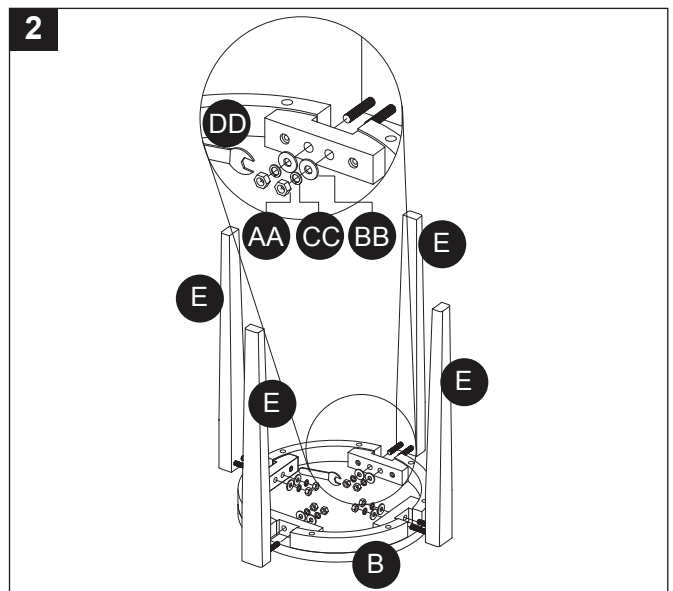

Hardware Used

AA	Nut		x 8
BB	Flat Washer		x 8
CC	Lock Washer		x 8
DD	Hex Wrench		x 1



3. Attach small legs (F) to square table top (C) using two nuts (AA), two flat washers (BB) and two lock washers (CC). Tighten with hex wrench (DD). Do not overtighten to avoid cracking the wood.

Hardware Used

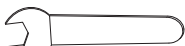
AA	Nut		x 8
BB	Flat Washer		x 8
CC	Lock Washer		x 8
DD	Hex Wrench		x 1

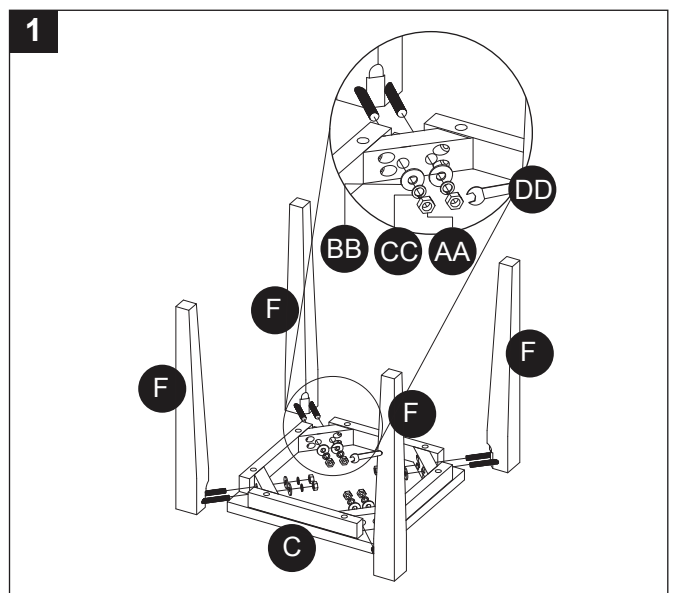

CARE AND MAINTENANCE

- Periodically check to make certain all components are properly positioned, free from damage and firmly connected.
- Wipe clean using a damp cloth and a mild cleaner. Wipe dry with a clean cloth.

REPLACEMENT PARTS LIST

For replacement parts, call our customer service department at 1-866-439-9800, 8 a.m. - 8 p.m., EST, Monday - Friday.

PART	DESCRIPTION	PART #
A	Scallop Table Top	160126-A
B	Round Table Top	160126-B
C	Square Table Top	160126-C
D	Large Leg	160126-D
E	Meduim Leg	160126-E
F	Small Leg	160126-F
AA	Nut	160126-AA
BB	Flat Washer	160126-BB
CC	Lock Washer	160126-CC
DD	Hex Wrench	160126-DD

