

# WALLdesign

## Installing your WallDesign Panels

The following are illustrations of all the tools and accessories needed to successfully install your WallDesign panels.

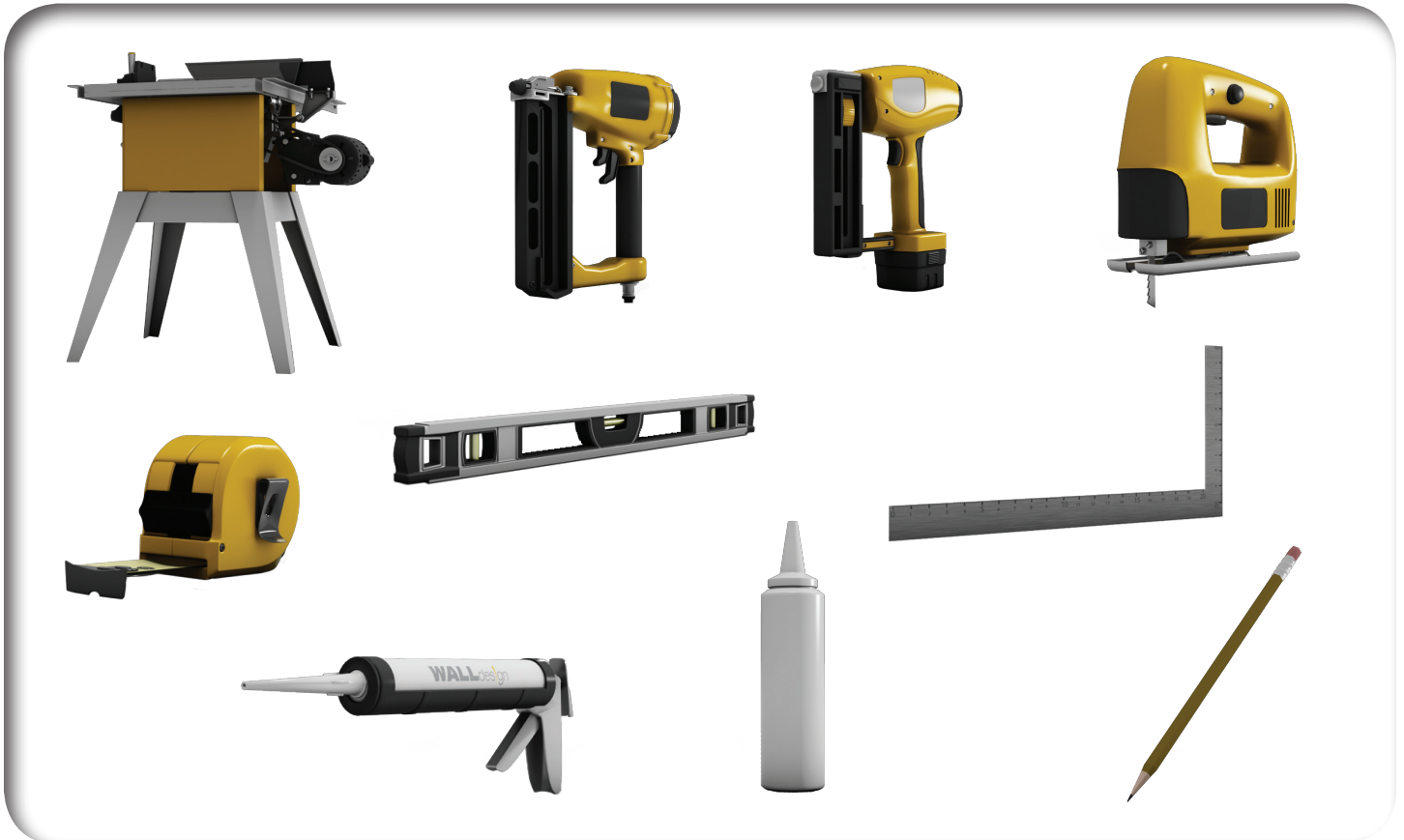

### Installation Technique

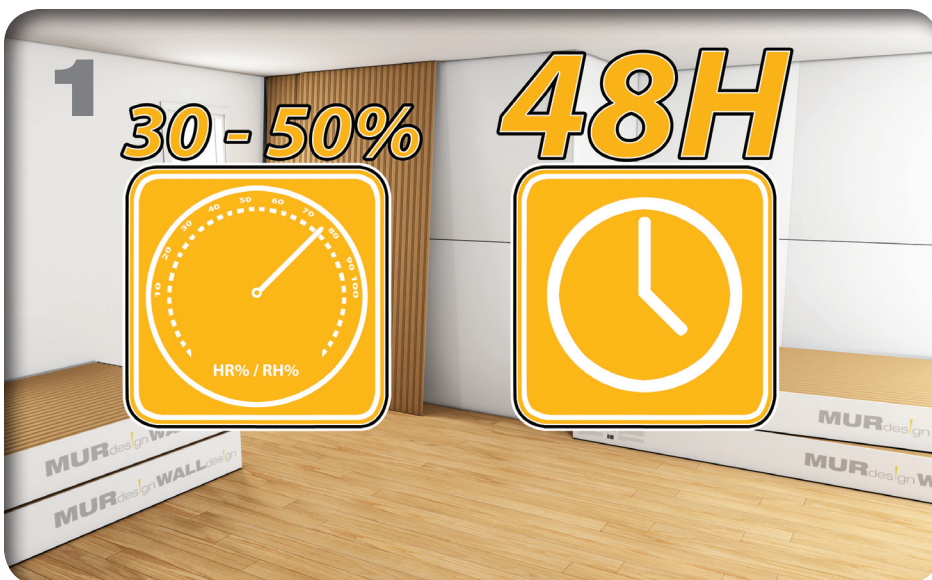

**A simple precaution will guarantee the problem-free installation of your long-lasting panels.**

Take into account the humidity level of the room where you will be installing your panels.

Above all, store your WallDesign panels for a period of 48 to 72 hours in the room where you plan to install them. It is essential that they become acclimatized to the room temperature and humidity.

For wood-based products, the humidity level has an impact on the wood's expansion and contraction. The relative humidity of the room must not be less than 30% or more than 50%.

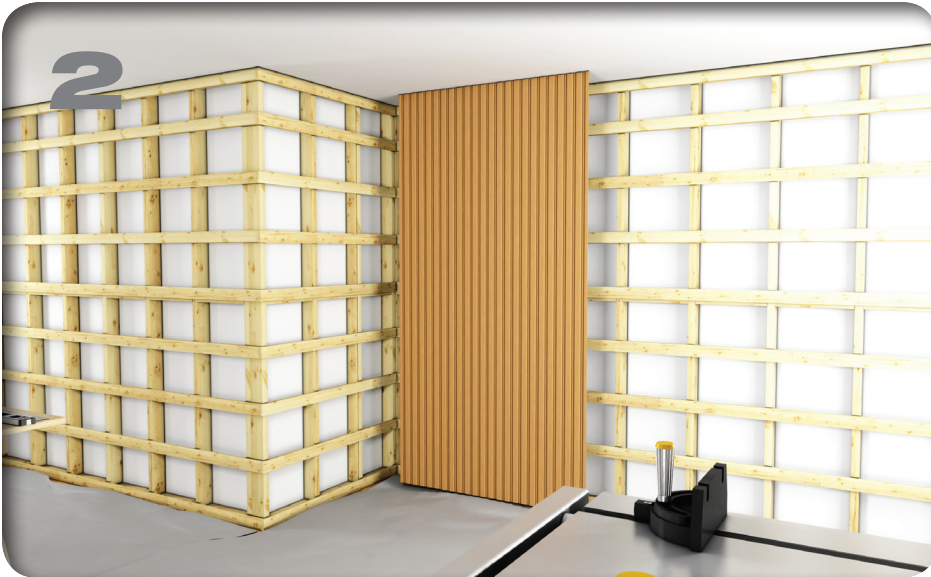

**Even the simplest installations require some preparation.**

Your walls must be as level as possible.

For impeccable results... The panels can be directly installed on studs but we strongly recommend adding furring strips, which will enhance the quality of the joints and provide increased solidity.

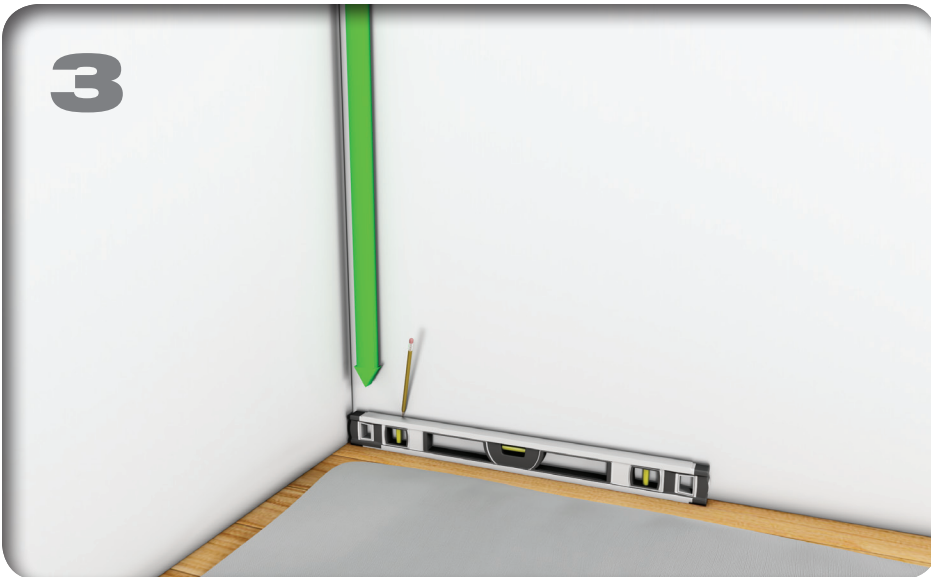

**A sound take-off will guarantee successful results!**

Always work with a level.

At the base of the wall, draw a reference line with your level. This will allow you to make sure that your panels are straight, even if your walls are not square.

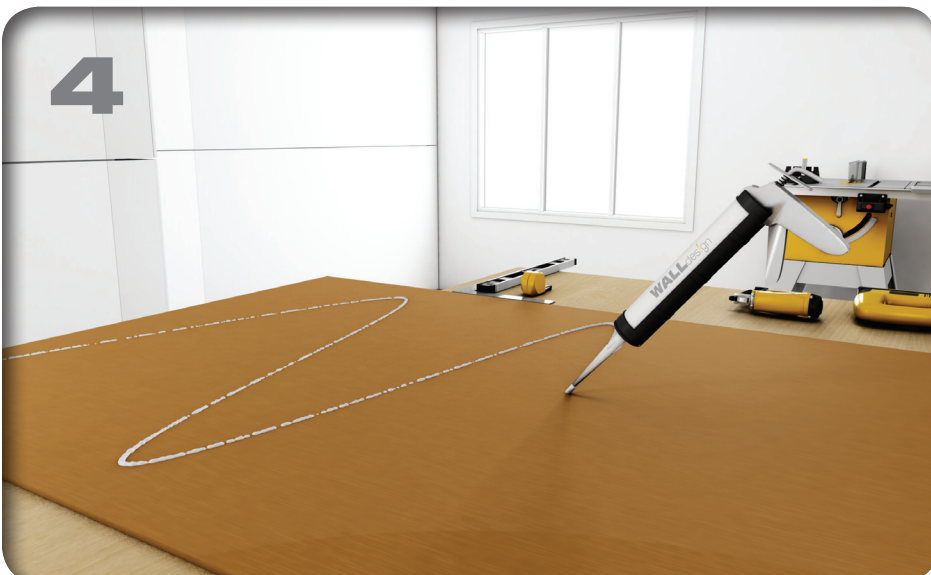

**The panels must be securely fastened.**

Use construction adhesive.

Apply construction adhesive to the back of the panels.



**The first panel can now be installed.**  
Your level line is your point of reference.

Position the first panel aligning it with the line drawn on the wall. Then start nailing making sure to do so in the grooves so that the nails are less visible and to ensure a smoother finish.



**In construction, joints are always somewhat touchy areas.**

Reinforce each joint with this helpful hint.

Apply adhesive to the joints to prevent them from separating. Then, simply remove the excess adhesive.

**You're off to a good start.**

Continue installing your panels.

Different finishing options are available. The panels can be installed on a full wall or you can leave a space for mouldings. The inner and outer corners can be simply glued one over the other or you can choose to install them at a 45 degree angle, which provides a more refined cachet to your final results.

For panels at the base of your walls, you can easily coordinate them with your wall panels and install a chair rail to create a dramatic effect to your decor.

**Now, sit back and admire your work... and, especially, enjoy !  
WallDesign is a plus, not only for your walls, but for your quality of life !**

**walldesign.ca**