

DO NOT OPERATE APPLIANCE IF THE LINE CORD SHOWS ANY DAMAGE OR IF APPLIANCE WORKS INTERMITTENTLY OR STOPS WORKING ENTIRELY.

IMPORTANT: During the first few minutes of initial use, you may notice a slight odor. This is normal and will quickly disappear.

PREPARATION

Before beginning assembly of product, make sure all parts are present. Compare parts with package contents list. If any part is missing or damaged, do not attempt to assemble the product.

Estimated Assembly Time: 5-10 minutes

No Tools Required for Assembly.

ASSEMBLY INSTRUCTIONS

1. Align the two portions of circular base and insert the four connectors of the rear base (B) into the four slots of the front base (A). Please ensure four buckles are connected closely and the two parts are tightly secured. There should be a “click” sound when the buckles are properly connected (Fig. 1).

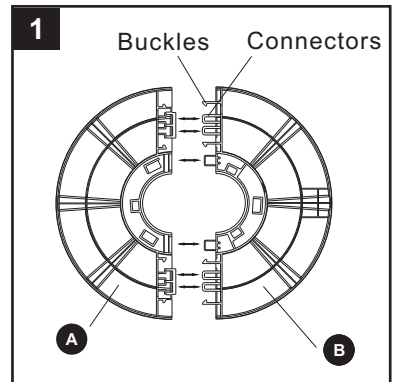

2. Feed the power cord (C) through the center of the base assembly.

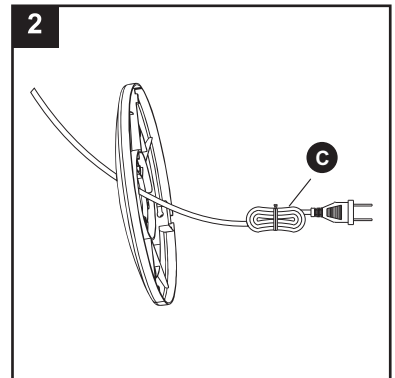

3. Align the groove and arrow at the bottom of the fan housing (D) to the arrow on the base assembly (which is near the central hole edge of the base assembly) (Fig. 3). Push the base assembly into the fan body until a “click” is heard. Please make sure the three buckles at the bottom of the fan body connected closely to the base and all connections between the fan body and the base are tight and secure (Fig. 4).

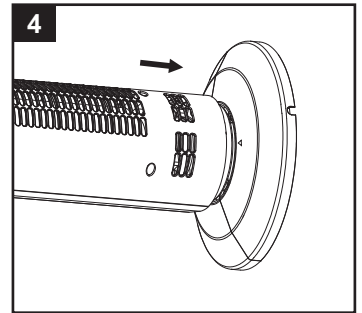
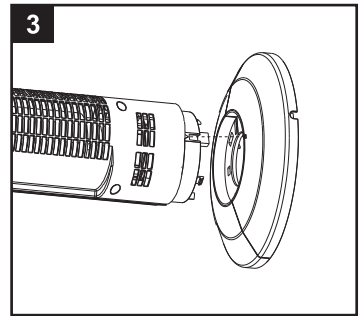

4. Locate the power cord holding bracket at the bottom of the base assembly . Gently pull any slack out of the power cord ,place the power cord securely in the holding bracket and secure the power cord bracket over the power cord .Then thread the power cord through the “U” locating notch on the edge of the base assembly (Fig. 5). Stand the fan in an upright position.

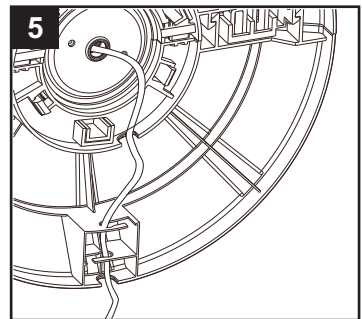

Note: Do not operate the tower fan unless it is in its proper, upright position.

OPERATING INSTRUCTIONS

Controlling the Fan Speed

Once fan is fully assembled (see Assembly Instructions section), place fan on a dry, level surface. Plug it into a 120V AC electrical outlet. To operate, turn the rotary knob switch to the appropriate speed control option. There are four available settings: 0=Off, 3=High, 2=Medium, 1=Low.