



# Illumifalls Kit

MODEL/MODELO #AISB12K

**REMINDER**  
 CALL 1-888-755-4497  
 BEFORE RETURNING TO STORE.



**Questions, problems, missing parts?** Before returning to your retailer, call our customer service department at 1-888-755-4497, 8 a.m.-6 p.m., EST, Monday-Friday, or email us at [customer@smart-pond.com](mailto:customer@smart-pond.com).

## PACKAGE CONTENTS

Part	Description	Quantity
A	Pump	1
B	Prefilter	1
C	1" ID tubing (10 feet)	1
D	Tub	1
E	Illumifalls spillway	1
F	Hose clamp	1

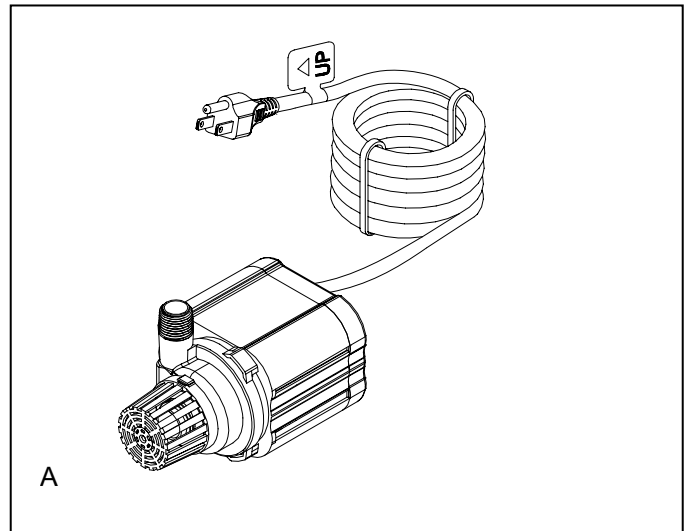
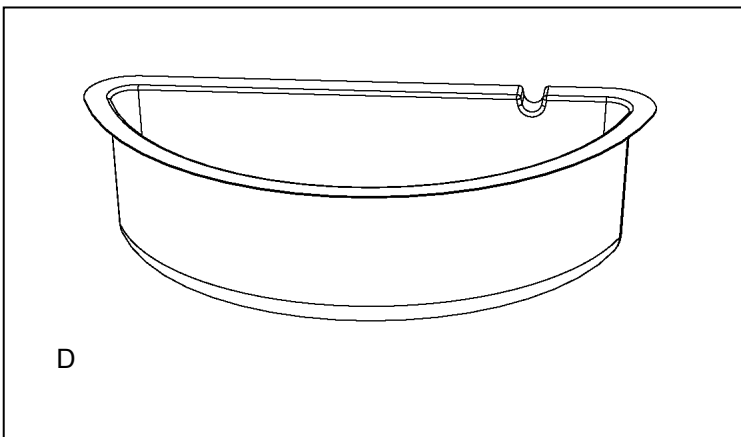
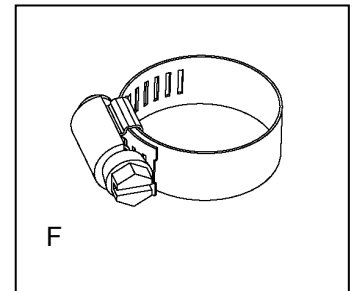
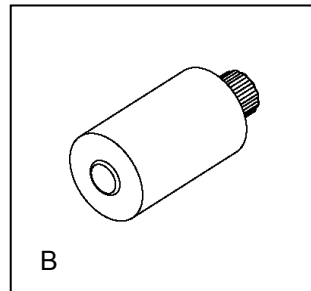
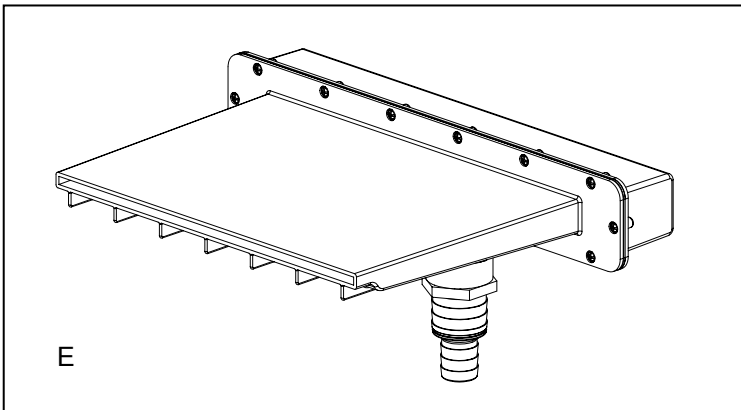
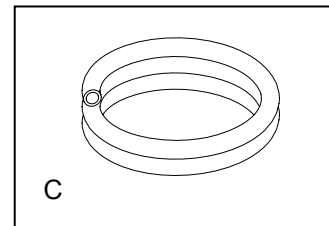



## **WARNINGS AND CAUTIONS – PUMP**

---

### **WARNING**

- Risk of electrical shock. This pump is supplied with a grounding conductor and grounding-type attachment plug. To reduce the risk of electric shock, be certain that it is connected only to a properly grounded, grounding-type receptacle (GFCI).
- Do not exceed the voltage shown on the pump.
- Always disconnect pump from the power source before beginning any maintenance or work on the pump.
- Inspect cord for damage before installation and/or maintenance. Replace the entire pump assembly if damage is found.
- Do not remove the grounding pin from the power cord plug.
- Risk of electrical shock: This pump has not been investigated for use in swimming pools or marine areas.

### **CAUTION**

- This pump has been evaluated for use with fresh water only.
- Use a proper power source as indicated on the pump label.
- Keep the cord away from high temperatures or other heat sources.
- Avoid using the pump when water temperatures fall below 41° F.
- Avoid using the pump in water exceeding 86°F.
- Do not pump heated liquids.
- Do not let the pump run dry. Pump must be completely submerged for proper operation and cooling.
- Operate in fresh water only. Avoid heavily chlorinated water and water with high pH levels.
- Do not lift the pump by its power cord.



## **WARNINGS AND CAUTIONS – ILLUMIFALLS SPILLWAY**

---

### **WARNING**

- To reduce the risk of electrical shock, connect only to a properly grounded, grounding type receptacle (GFCI).
- Do not exceed the input voltage shown on the transformer.
- Do not submerge the transformer.
- To reduce the risk of fire or injury, keep lamp away from materials that may burn.
- Always disconnect light from the power source before beginning any maintenance or work on the light.
- Inspect cord for damage before installation and/or maintenance. Replace the entire light/transformer assembly if damage is found.

### **CAUTION**

- Use a proper power source as indicated on the transformer label.
- Keep the cord away from high temperatures or other heat sources.
- Do not lift the light or the transformer by its power cord.
- This light assembly is not intended for use in swimming pools or hot tubs.

## **PREPARATION**

---

Before beginning assembly or operation of product, make sure all parts are present. Compare parts with package contents list and diagram above. If any part is missing or damaged, do not attempt to assemble, install or operate the product. Contact customer service for replacement parts.

- Estimated Assembly Time: 1.5 hours
- Tools required for assembly: hammer, chisel, flathead screwdriver.

## OPERATION INSTRUCTIONS

1. Select a level location to build the Illumifalls kit. Begin building the kit by placing the tub on the ground and building the stones around it. It is very important that the stones are level, so be sure to check that the structure is level from front to back as well as left to right. Fig. 1

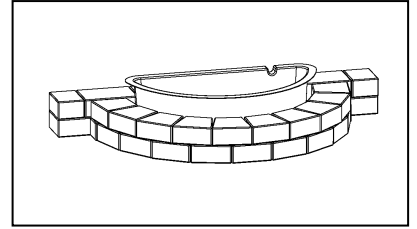

**Fig. 1**

2. The two stones in the picture need to be cut in order to fit the half round tub. The pump power cord and tubing will fit through this hole. Fig. 2

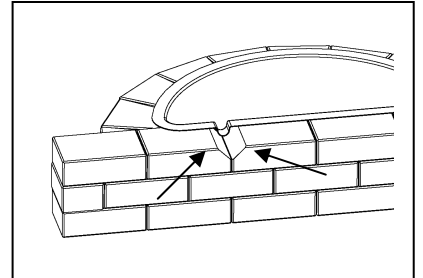

**Fig. 2**

3. HINT: To assist with keeping the wall plumb, place a layer of roofing shingles along the back wall on this layer. This will keep the wall from leaning back due to the lip of the tub. Fig. 3

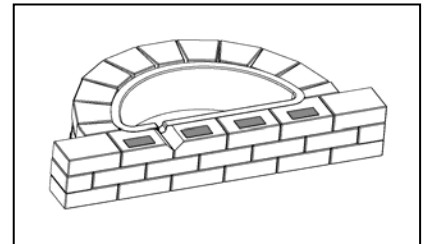

**Fig. 3**

4. For maximum water flow, cut the adapter as shown using a hacksaw. Fig. 4

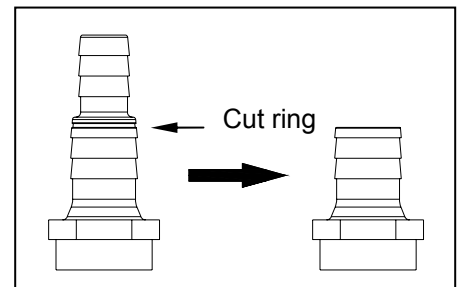

**Fig. 4**

5. Connect the tubing to the inlet of the spillway using the adapter. Slip the hose clamp on to the tubing but do not tighten it. Fig. 5

NOTE: The spillway has two ports to install the inlet. For installing with this kit, using connection (a) is preferred. For other installs use (b).

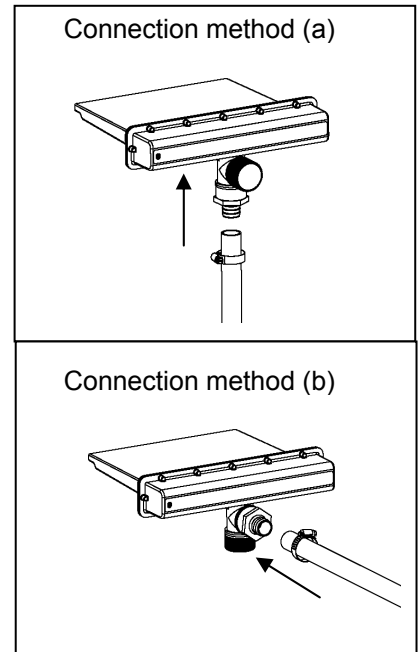

**Fig. 5**

6. Tighten the hose clamp using a flathead screwdriver. Fig. 6

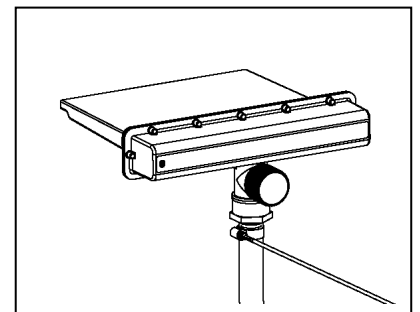

**Fig. 6**

7. Place the Illumifalls spillway onto the wall. Then continue building the rest of the wall. Fig. 7

NOTE: You will need to cut the stone that goes on the top of the spillway before building the next layer of stones.

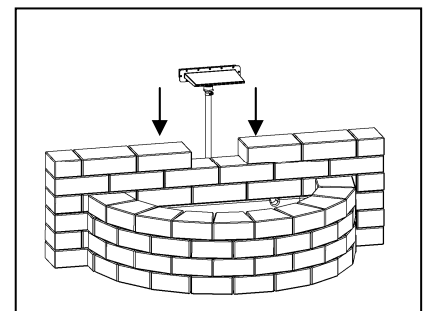

**Fig. 7**

- Cut the stone that goes on the top of the spillway before building the next layer of stones. Or use a retaining wall block cap in place of the cut and add an inch of roofing shingles under the spillway. Fig. 8

NOTE: The thickness of the weir is approximately 1". You can cut several pieces of stone to make this fit.

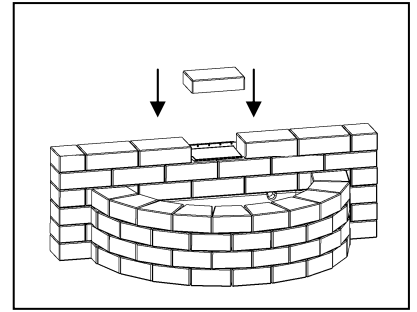

**Fig. 8**

- Route the power cord of the pump through the hole in the tub and then route the tubing through the same hole. Fig. 9

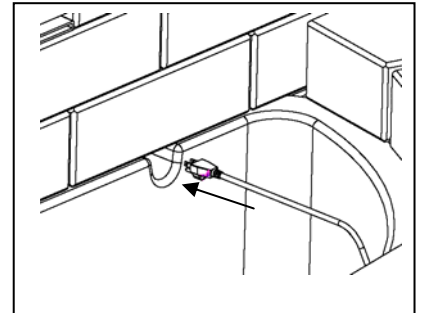

**Fig. 9**

- Remove the front screen from the pump and connect the prefilter to the front of the pump. Fig. 10

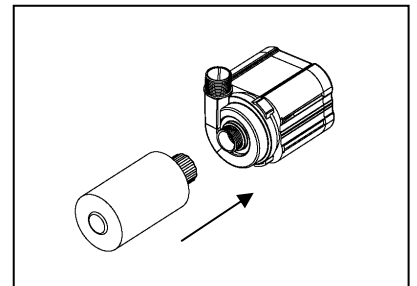

**Fig. 10**

- Connect the tubing to the pump and place it in the tub. Fig. 11

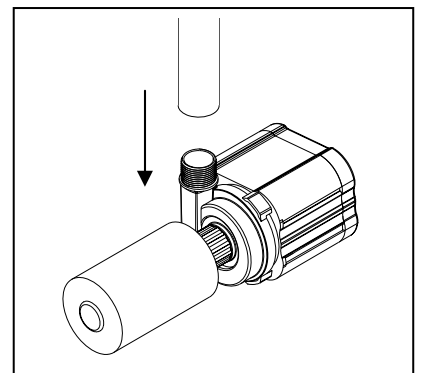

**Fig. 11**

12. Fill the tub with water. Fig. 12

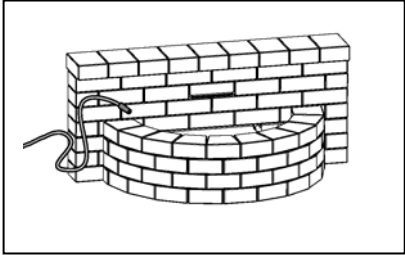

Fig. 12

13. Connect the Illumifalls to the transformer by pushing the plug into the transformer socket until it is firmly seated. Hand tighten the nut from the plug to the socket. Fig. 13

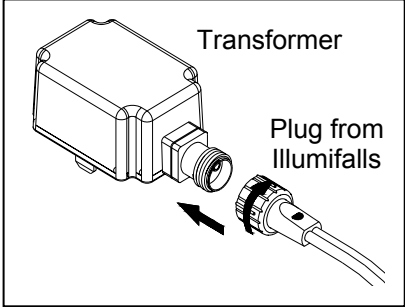

Fig. 13

14. Plug the transformer into a properly grounded electrical outlet. Fig. 14

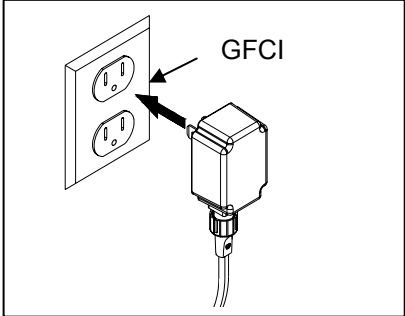

Fig. 14

15. Connect the pump to a proper power source. Fig. 15

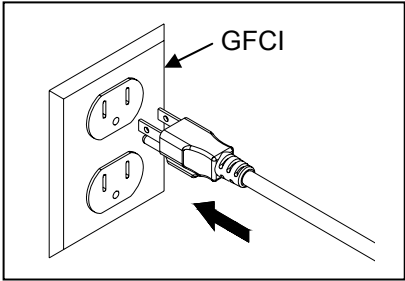

Fig. 14

## **CARE AND MAINTENANCE – PUMP**

---

- Clean the pump with filter regularly depending upon the environment in which it is operated. Clean the pump when it is visibly soiled or when a drop in performance is detected.
- Before cleaning, always disconnect the pump from the power source.
- Remove all parts from the pump and clean in warm, soapy water.
- Disassemble the pump cover and remove the impeller cover to expose the impeller assembly. Use a soft cloth or brush to clean the impeller assembly and the inside of the impeller housing. Refer to the diagram in the replacement parts list.

## **CARE AND MAINTENANCE – ILLUMIFALLS SPILLWAY**

---

- Clean the spillway regularly depending upon the environment in which it is operated. Clean the spillway when it is visibly soiled or when a drop in performance is detected.
- Before cleaning, always disconnect the transformer from the power source.
- Use a dryer brush to clean the inside of the spillway. We recommend using a 10” long brush, approximately 1” thick or any brush that will fit inside the front of the spillway opening.

## **TROUBLESHOOTING**

---

If the light fails to illuminate:

- Check that it is getting power by testing another appliance in the same power outlet.

If the pump fails to operate:

- Check to make sure the power cord is plugged in and the pump is getting power.
- Check the pump outlet and any tubing, for kinks or obstructions.
- Remove the inlet screen and/or pump cover, and impeller cover to expose the impeller. Turn the impeller to ensure that it is not broken or jammed. Also check to make sure that the ceramic shaft or bearings are not broken.

If the performance of the pump is not satisfactory or the pump does not flow evenly:

- Check to make sure the pump is completely submerged in water.
- Check to make sure the impeller and the housing are clean.

## REPLACEMENT PARTS LIST

For replacement parts, call our customer service department at 1-888-755-4497, 8 a.m.-6 p.m., EST, Monday-Friday.

Part	Description
F	Hose clamp
G	Inlet screen
H	Impeller housing
I	Impeller assembly
J	O-ring
K	Waterfall gasket
L	Adapter gasket
M	Adapter
N	Cap
O	Filter pad
P	Filter holder
Q	Coupler

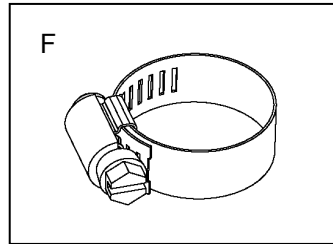
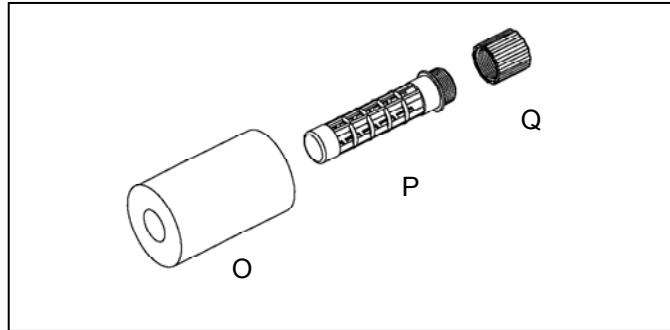
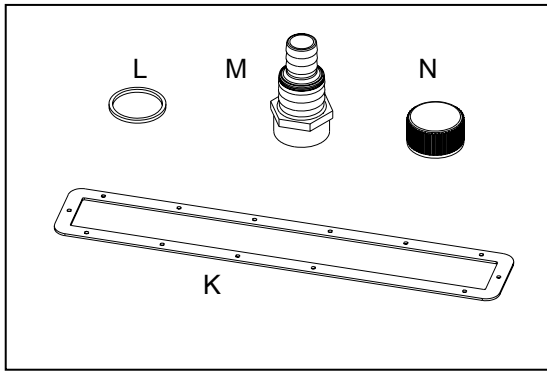
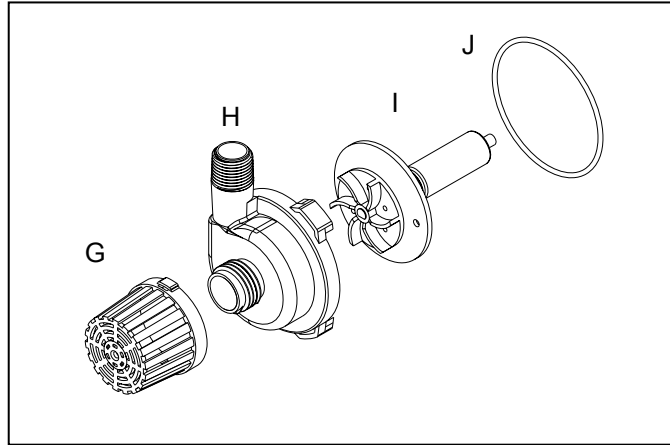



## LIMITED WARRANTY

All pumps and electrical products are warranted to the user against defective material and workmanship, under normal working conditions. This warranty period begins on the date of purchase by the original purchaser.

Item	Limited Warranty
FP45, FP80, FP155, FP500, FP170AS, FP300ASL	1 year
DP210, DP330, DP560	1 year
WPR2000, WPR3600, WPR5100	1 year
LDS10W, LDS10W3, LVSL, FTNFG	1 year
PCUV9 (excludes UV bulb)	1 year
PL0710, PL1013, PL1320	lifetime
ACFK and MFBX500P (pump only)	1 year
PBF1200UV (UV filter only)	1 year
WGK200 (pump only)	1 year
DP700UV, WP1300UV	1 year
DPKIS (pump only)	1 year
EPDM1520, EPDM1525, EPDM2020	20 years
APH	1 year
UVFS, AISB12K	1 year

### Application

Warranty covers only properly installed and maintained units. Pump warranty is limited to applications pumping fresh water at temperatures between 41°F — 86°F, with a pH range of 5 — 9. Other liquid applications or extreme temperature uses must be approved in writing by the manufacturer. Receipt and product date code are required for warranty claims.

### Warranty Claim

**Warranty claims must be made by calling customer service (at 1-888-755-4497).** If the item is determined to be defective, you will be given authorization to return the defective part(s), freight pre-paid, along with proof of purchase to:

GeoGlobal Partners  
1727 Old Okeechobee Road  
West Palm Beach, FL 33409  
Attn: Customer Service

### Disposition

The manufacturer will make a good faith effort for prompt disposition regarding all warranty claims. Returned product will be inspected to determine cause of failure before warranty is applied. Warranty does not cover any costs associated with the shipping, handling, installation or removal of products or parts subject to this warranty. For products damaged in transit, a claim should be filed with the carrier.

### Disclaimer

Any oral statements made about the product by the seller, the manufacturer, the representatives, or any other parties do not constitute warranties, should not be relied upon by the user, and are not part of the contract for sale. The seller's and manufacturer's only obligation, and buyer's only remedy shall be for the manufacturer to either replace and/or repair at the manufacturer's sole discretion, the product as described above. Neither seller nor the manufacturer shall be liable for injury, loss or damages for lost profits, lost sales, injury to person or property, or any other incidental or consequential loss arising from any cause whatsoever, no matter whether based upon warranty, contract, negligence or other misuse, and the buyer and user agree that no other remedy shall be available to them. Before using, the buyer and user shall determine the suitability of the product for the intended use, and assume all risk and liability whatsoever in connection therewith. The warranty and remedy described in this limited warranty is an exclusive warranty and remedy in lieu of any other warranty or remedy expressed or implied. All other warranties and remedies are hereby expressly excluded, including but not limited to any implied warranty of merchantability of fitness for any particular purpose. This warranty gives the buyer and user specific legal rights, and buyer and user may also have other rights which vary from state to state. Some states do not allow exclusions or limitations of incidental or consequential damages, so the above limitations or exclusions may not apply to you.

**REMINDER**  
**CALL 1-888-755-4497**  
**BEFORE RETURNING TO STORE.**