



Floating Pump and Filter with UV

MODEL/MODELO #UVFS

REMINDER
CALL 1-888-755-4497
BEFORE RETURNING TO STORE.



Questions, problems, missing parts? Before returning to your retailer, call our customer service department at 1-888-755-4497, 8 a.m.-6 p.m., EST, Monday-Friday, or email us at customer@smart-pond.com

PACKAGE CONTENTS

Part	Description	Quantity
A	Floating pump and filter with UV	1
B	Waterspray nozzle	1
C	Waterbell nozzle insert	1
D	Trumpet nozzle insert	1
E	Lower fountain head nozzle	1

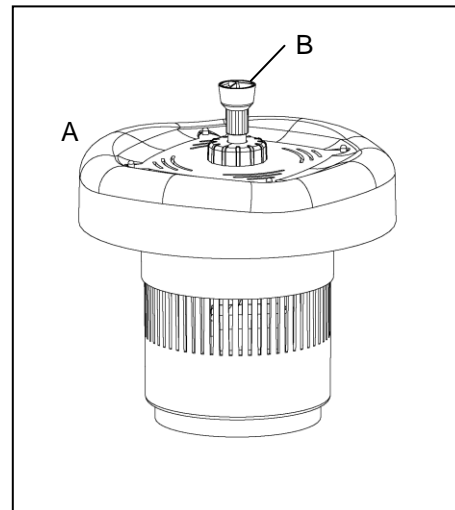
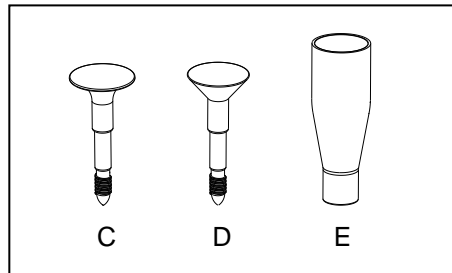

WARNINGS AND CAUTIONS

WARNING

- Risk of electrical shock. This unit is supplied with a grounding conductor and grounding-type attachment plug. To reduce the risk of electric shock, be certain that it is connected only to a properly grounded, grounding-type receptacle (GFCI).
- Do not exceed 120 volts.
- Always disconnect unit from the power source before beginning any maintenance or work on the unit.
- Inspect cord for damage before installation and/or maintenance. Replace the entire pump assembly if damage is found.
- Do not remove the grounding pin from the power cord plug.
- Risk of electrical shock: This unit has not been investigated for use in swimming pools or marine areas.

CAUTION

- This unit has been evaluated for use with fresh water only.
- Use a proper power source as indicated on the unit label.
- Keep the cord away from high temperatures or other heat sources.
- Avoid using the unit when water temperatures fall below 41° F.
- Avoid using the unit in water exceeding 86° F.
- Do not pump heated liquids.
- Do not let the unit run dry. Unit must be completely submerged up to the flotation ring for proper operation and cooling.
- Operate in fresh water only. Avoid heavily chlorinated water and water with high pH levels.
- Do not lift the unit by its power cord.

CAUTION

- UV light may cause irritation to the skin and/or eyes. Avoid exposure.
- DANGER – ULTRAVIOLET RADIATION – disconnect power before replacing lamp.
- Prolonged or repeated exposure to UV light may have adverse physical effects including, severe damage to your skin and eyes. Seek immediate medical attention for overexposure to UV radiation.
- This light assembly has not been investigated for use in swimming pools or hot tubs.

PREPARATION

Before beginning assembly or operation of product, make sure all parts are present. Compare parts with package contents list and diagram above. If any part is missing or damaged, do not attempt to assemble, install or operate the product. Contact customer service for replacement parts.

- Estimated Assembly Time: 5 minutes
- Tools Required for Assembly: Philipshead screwdriver, string, rock.

OPERATION INSTRUCTIONS

1. Choose a fountain head for the desired water effect, and assemble your choice as shown in Fig. 1.

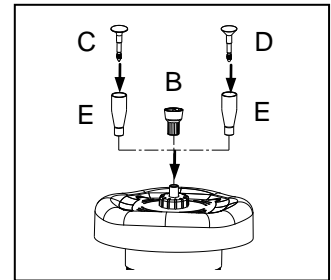

Fig. 1

2. If desired, anchor the fountain in the pond using a heavy object (such as a rock) and some string. Cut a length of string slightly longer than the depth of the pond. Tie one end of the string to the anchor and the other end to the ring at the bottom of the float. Fig. 2

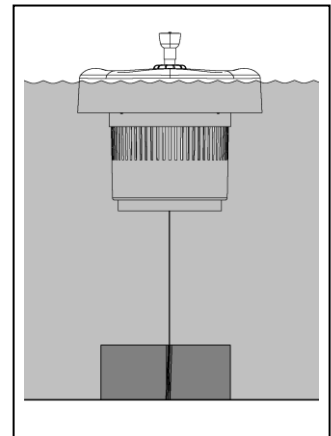

Fig. 2

3. Place the unit into the water and connect to a proper power source. Fig. 3

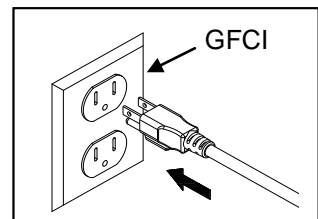

Fig. 3

DISASSEMBLY PROCEDURE

In order to insure optimal operation of the Floating Pump and Filter with UV, the following procedures should be performed periodically. When the performance of the water flow through the fountain head is reduced – it is an indication that cleaning of the unit is needed.

1. Unplug the power cord, and then carefully remove the Floating Pump and Filter assembly from the pond. Fig. 4

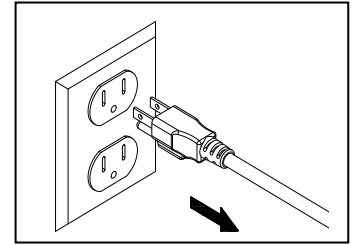

Fig. 4

1. Turn the Floating Pump and Filter assembly upside down. Remove the locking screw. Fig. 5

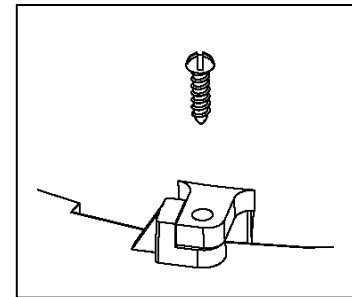

Fig. 5

2. Remove the fountain head and the top locking nut. Then remove the top cover. Fig. 6

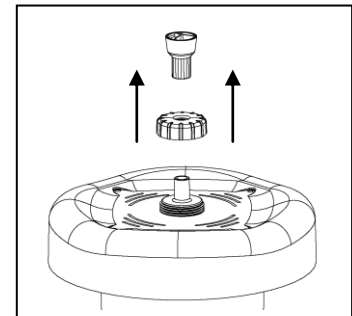

Fig. 6

3. Twist the top section counterclockwise. Then pull the top section from the lower. Unscrew the wire connector that connects the top section to the rest of the unit. Fig. 7

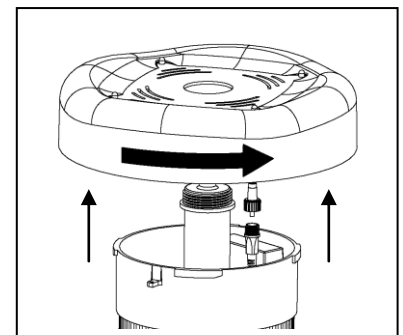

Fig. 7

4. Lift the pump and filter assembly up from the fountain. NOTE: In order to extract the filter assembly from the flotation basket, the main power cord must be fed up through the bottom of the flotation basket. Fig. 8

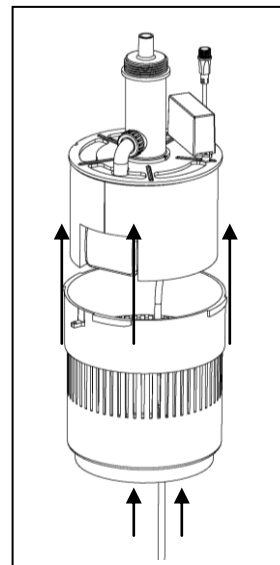

Fig. 8

5. Remove the filter pad and rinse until it is clean. Then reassemble the pump and filter assembly. Fig. 9

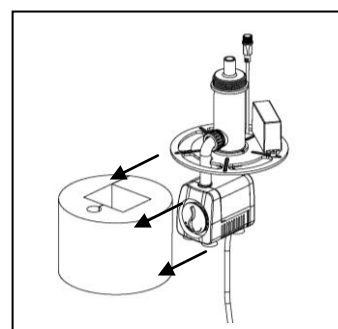

Fig. 9

CARE AND MAINTENANCE

- General
 - A visible drop in waterflow or increased algae in the pond is your indication that filter pad, pump, and/or UV clarifier portion of the unit require cleaning.
 - Before attempting to disassemble the unit or clean the pump, UV clarifier or any portion of the unit, always disconnect the unit from the power source.
 - Disassemble the unit in accordance with the Disassembly Procedure section of this instruction sheet.
- Cleaning the Pump
 - Insure the pump is disconnected from all other components comprising the unit.
 - Inspect the pump by removing the front screen and impeller assembly and clean parts of the pump and clean in warm, soapy water.
 - Reassemble the pump and reposition and connect the low voltage power cables

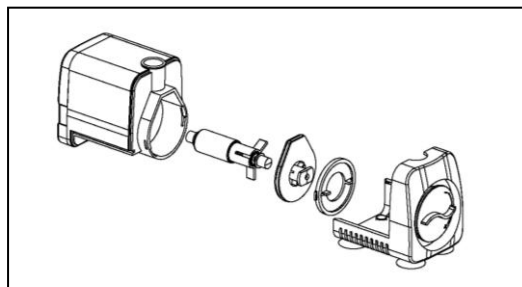

Fig. 10

To maximize the performance of the UV clarifier portion of the unit, periodically disassemble the unit to clean dirt and debris from the exterior of the glass tube and reflector located in the lamp housing.

IMPORTANT NOTE:

Be sure that the entire unit is completely dry and gaskets are properly seated when reassembling the UV clarifier.

Failure to do so will result in water leakage, which can cause damage to the light unit.

1. Disconnect the UV light from the outlet. Be sure to allow sufficient time for the light to cool before disassembling the light.
2. Unscrew the locking ring, and pull out the light unit.
3. Carefully pull out the glass tube holder by twisting and then pull out.
4. Use warm, soapy water to clean the glass tube. Be sure to use biodegradable soap.
5. Reassemble the UV clarifier, and be sure that all gaskets and o-rings are seated properly.

TROUBLESHOOTING

If the LED lights fail to operate:

- Check to make sure the power cord is plugged in and the light is getting power and the unit is getting power.

If the UV Clarifier fails to operate:

- Check bulb to make sure that it has not burned out. Replace the bulb as necessary or after every season. Bulbs are available by calling the customer service department.

If the pump fails to operate:

- Check to make sure the power cord is plugged in, the pump is getting power and the pump is fully submerged.
- Remove the inlet screen and/or pump cover, and impeller cover to expose the impeller. Turn the impeller to ensure that it is not broken or jammed.

If the performance of the pump is not satisfactory or the pump does not flow evenly:

- Check to make sure the pump is completely submerged in water.
- Check to make sure the impeller, filter pad and the housing are clean clear of debris.
- Check the pump outlet and any tubing, fountains, spitters etc. for kinks or obstructions.
- Adjust flow control.

REPLACEMENT PARTS LIST

For replacement parts, call our customer service department at 1-888-755-4497, 8 a.m.-6 p.m., EST, Monday-Friday.

Part	Description
B	Waterspray nozzle
C	Waterbell nozzle insert
D	Trumpet nozzle insert
E	Lower fountain head nozzle
F	Flow control knob
G	Front cover
H	Locking ring
I	Impeller cover
J	Shaft support
K	Washer
L	Shaft
M	Impeller assembly
N	Float (upper)
O	Float (lower)
P	Screw
Q	Brace
R	Plug seal
S	Filter pad
T	Lamp housing
U	Locking nut
V	Lamp holder
W	Small locking nut
X	Inlet
Y	Foil reflector
Z	Glass tube
A1	UV bulb

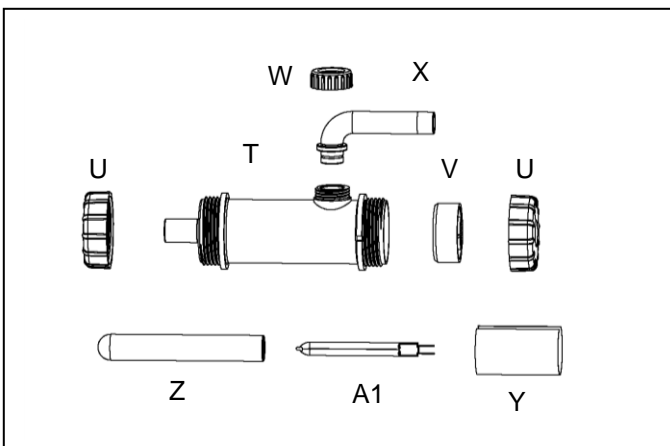
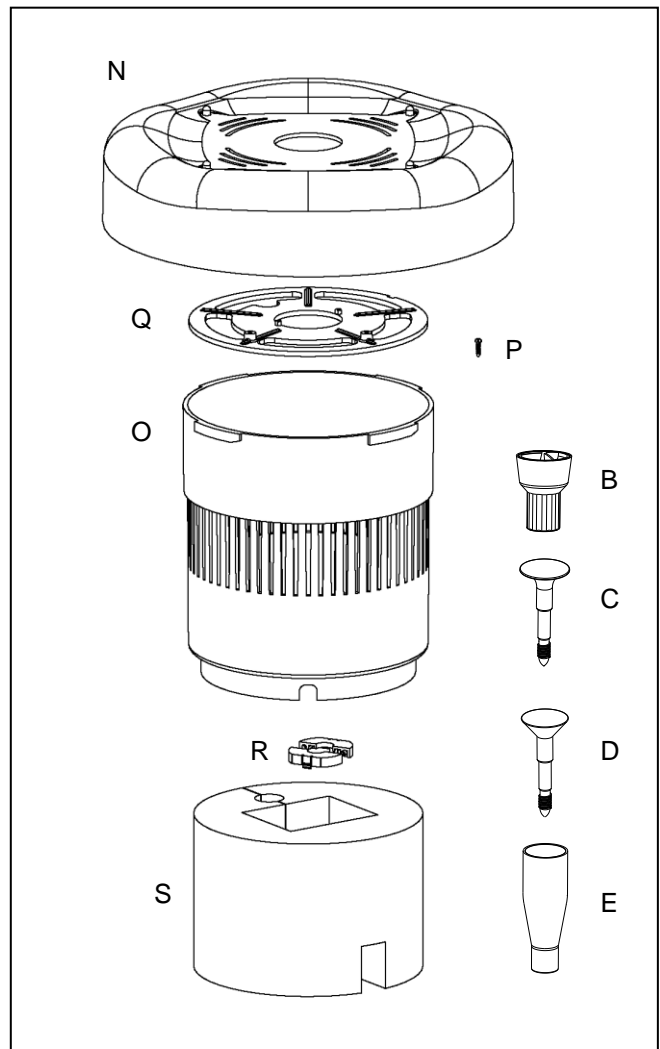
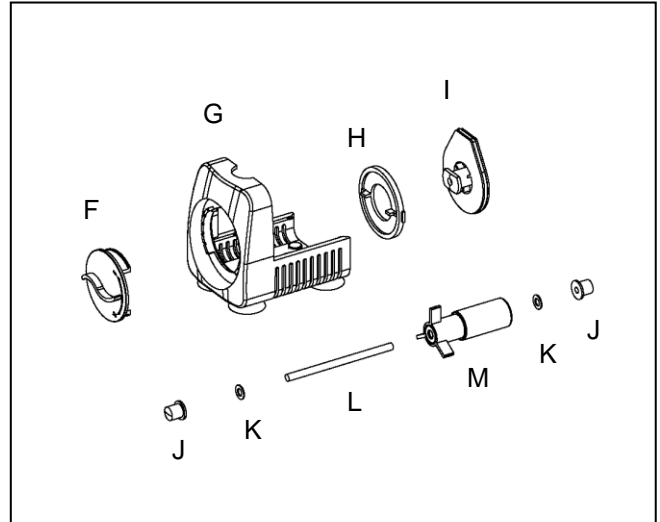

Printed in China