

PORTER CABLE®

9 IN. (228 MM) BAND SAW
SCIE À RUBAN 228 MM (9 PO)
SIERRA DE CINTA PARA
BRANCO DE 228 MM (9 PULG.)

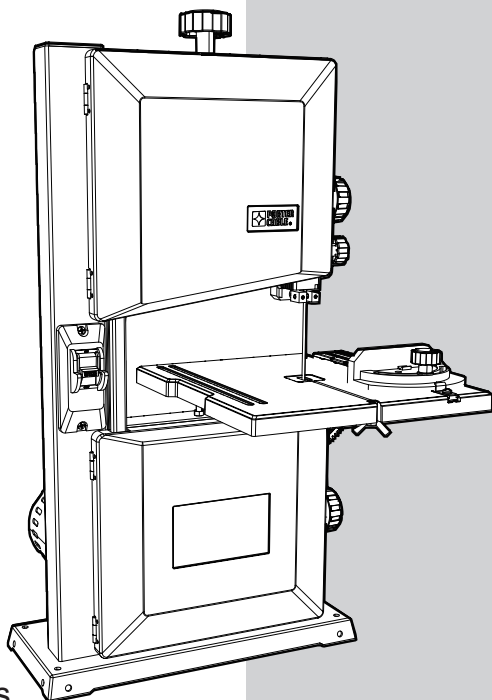

Instruction Manual
Manuel d'instructions
Manual de instrucciones

www.portercable.com

INSTRUCTIVO DE OPERACIÓN,
CENTROS DE SERVICIO Y PÓLIZA
DE GARANTÍA.

⚠ ADVERTENCIA: LÉASE ESTE
INSTRUCTIVO ANTES DE USAR EL
PRODUCTO.

CATALOG NUMBER
PCXB310BS

TABLE OF CONTENTS

SECTION	PAGE
PRODUCT SPECIFICATIONS	2
SAFETY GUIDELINES - DEFINITIONS	3
PROPOSITION 65 WARNING.....	3
POWER TOOL SAFETY	4
BAND SAW SAFETY	6
ELECTRICAL REQUIREMENTS AND SAFETY	7
TOOLS NEEDED FOR ASSEMBLY	9
CARTON CONTENTS	9
KNOW YOUR BAND SAW	11
GLOSSARY OF TERMS	12
ASSEMBLY AND ADJUSTMENTS	13
OPERATION	19
MAINTENANCE	21
TROUBLESHOOTING GUIDE	22
ACCESSORIES AND ATTACHMENTS	24
PARTS LIST	25
WARRANTY	28

PRODUCT SPECIFICATIONS

MOTOR

Amps	2.5 A
Voltage	120 V
Hz	60
Speed	1720 RPM (No load)
Type	Induction

TABLE SIZE	12-5/16 x 11-7/8 in. (313 x 302 mm)
-------------------	--

BLADE

Width	1/8, 1/4, 3/8 in. (3.2, 6.4, 9.5 mm)
Length	59-1/2 in. (1511 mm)

CUTTING CAPACITY

Throat	9 in. (228 mm)
Height	3-1/2 in. (89 mm)

SAWDUST PORT	2-1/2 in. O.D. (64 mm)
---------------------	------------------------

WARNING

To avoid electrical hazards, fire hazards or damage to the tool, use proper circuit protection. Use a separate electrical circuit for your tools. This band saw is wired at the factory for 120 Volt operation. It must be connected to a 120 Volt / 10 Ampere time delay fuse or circuit breaker. To avoid shock or fire, replace power cord immediately if it is worn, cut or damaged in any way.

SAVE THESE INSTRUCTIONS

SAFETY GUIDELINES - DEFINITIONS

WARNING ICONS

Your power tool and its Instruction Manual may contain “WARNING ICONS” (a picture symbol intended to alert you to and/or instruct you how to avoid a potentially hazardous condition). Understanding and heeding these symbols will help you operate your tool better and safer. Shown below are some of the symbols you may see.



SAFETY ALERT: Precautions that involve your safety.



PROHIBITION



WEAR EYE PROTECTION: Always wear safety goggles or safety glasses with side shields.



WEAR RESPIRATORY AND HEARING PROTECTION: Always wear respiratory and hearing protection.



READ AND UNDERSTAND INSTRUCTION MANUAL: To reduce the risk of injury, user and all bystanders must read and understand instruction manual before using this product.



KEEP HANDS AWAY FROM THE MOVING PART AND CUTTING SURFACE: Failure to keep your hands away from the moving part and cutting surface will result in serious personal injury.



SUPPORT AND CLAMP WORK



DANGER

DANGER: Indicates an imminently hazardous situation which, if not avoided, will result in death or serious injury.



WARNING

WARNING: Indicates a potentially hazardous situation which, if not avoided, could result in death or serious injury.



CAUTION

CAUTION: Indicates a potentially hazardous situation which, if not avoided, may result in minor or moderate injury.

NOTICE

NOTICE: Used without the safety alert symbol indicates potentially hazardous situation which, if not avoided, may result in property damage.

PROPOSITION 65 WARNING



WARNING

Drilling, sawing, sanding or machining wood products can expose you to wood dust, a substance known to the State of California to cause cancer. Avoid inhaling wood dust or use a dust mask or other safeguards for personal protection. For more information go to: www.P65Warnings.ca.gov/wood.

Some examples of these chemicals are:

- Lead from lead-based paints,
- Crystalline silica from bricks and cement and other masonry products, and
- Arsenic and chromium from chemically-treated lumber.

Your risk from these exposures varies depending on how often you do this type of work. To reduce your exposure to these chemicals: work in a well ventilated area and work with approved safety equipment, such as dust masks that are specially designed to filter out microscopic particles.





Handling the power cord on this product may expose you to chemicals known to the state of California to cause cancer and birth defects or other reproductive harm. Wash hands after handling. For more information go to: www.P65Warnings.ca.gov.



POWER TOOL SAFETY

GENERAL SAFETY INSTRUCTIONS BEFORE USING THIS POWER TOOL

Safety is a combination of common sense, staying alert and knowing how to use your power tool.

WARNING

- To avoid mistakes that could cause serious injury, do not plug the tool in until you have read and understood the following.
 - Read all instructions before operating product. Failure to follow all instructions listed below may result in electric shock, fire and/or serious injury.
1.  **READ** and become familiar with the entire Instruction Manual. **LEARN** the tool's application, limitations and possible hazards.
 2. **KEEP GUARDS IN PLACE** and in working order.
 3. **REMOVE ADJUSTING KEYS AND WRENCHES.** Form the habit of checking to see that keys and adjusting wrenches are removed from the tool before turning ON.
 4. **KEEP WORK AREA CLEAN.** Cluttered areas and benches invite accidents.
 5. **DO NOT USE IN DANGEROUS ENVIRONMENTS.** Do not use power tools in damp locations, or expose them to rain or snow. Keep work area well lit.
 6. **KEEP CHILDREN AWAY.** All visitors and bystanders should be kept a safe distance from work area.
 7. **MAKE WORKSHOP CHILD PROOF** with padlocks, master switches or by removing starter keys.
 8. **DO NOT FORCE THE TOOL.** It will do the job better and safer at the rate for which it was designed.
 9. **USE THE RIGHT TOOL.** Do not force the tool or an attachment to do a job for which it was not designed.
 10. **USE PROPER EXTENSION CORDS.** Make sure your extension cord is in good condition. When using an extension cord, be sure to use one heavy enough to carry the current your product will draw. An undersized cord will result in a drop in line voltage and in loss of power which will cause the tool to overheat. The table on page 9 shows the correct size to use depending on cord length and nameplate ampere rating. If in doubt, use the next heavier gauge. The smaller the gauge number, the heavier the cord.
 11. **WEAR PROPER APPAREL.** Do not wear loose clothing, gloves, neckties, rings, bracelets or other jewelry which may get caught in moving parts. Nonslip footwear is recommended. Wear protective hair covering to contain long hair.
 12.  **ALWAYS WEAR EYE PROTECTION.** Any power tool can throw foreign objects into the eyes and could cause permanent eye damage. **ALWAYS** wear Safety Goggles (not glasses) that comply with ANSI Safety standard Z87.1. Everyday eyeglasses have only impact-resistant lenses. They **ARE NOT** safety glasses. **NOTE:** Glasses or goggles not in compliance with ANSI Z87.1 could seriously injure you when they break.
 13.  **WEAR A FACE MASK OR DUST MASK.** Sawing operation produces dust.
 14.  **SECURE WORK.** Use clamps or a vise to hold work when practical. It is safer than using your hand and it frees both hands to operate the tool.
 15. **DISCONNECT TOOLS FROM POWER SOURCE** before servicing, and when changing accessories such as blades, bits and cutters.

16. **REDUCE THE RISK OF UNINTENTIONAL STARTING.** Make sure switch is in the OFF position before plugging the tool in.
17. **USE RECOMMENDED ACCESSORIES.** Consult this Instruction Manual for recommended accessories. The use of improper accessories may cause risk of injury to yourself or others.
18. **NEVER STAND ON THE TOOL.** Serious injury could occur if the tool is tipped or if the cutting tool is unintentionally contacted.
19. **CHECK FOR DAMAGED PARTS.** Before further use of the tool, a guard or other part that is damaged should be carefully checked to determine that it will operate properly and perform its intended function – check for alignment of moving parts, binding of moving parts, breakage of parts, mounting and any other conditions that may affect its operation. A guard or other part that is damaged should be properly repaired or replaced.
20. **NEVER LEAVE THE TOOL RUNNING UNATTENDED. TURN THE POWER “OFF”.** Do not walk away from a running tool until the blade comes to a complete stop and the tool is unplugged from the power source.
21. **DO NOT OVERREACH.** Keep proper footing and balance at all times.
22. **MAINTAIN TOOLS WITH CARE.** Keep tools sharp and clean for best and safest performance. Follow instructions for lubricating and changing accessories.
23. **DO NOT use power tool in presence of flammable liquids or gases.**
24. **DO NOT** operate the tool if you are under the influence of any drugs, alcohol or medication that could affect your ability to use the tool properly.
25. Dust generated from certain materials can be hazardous to your health. Always operate saw in well-ventilated area and provide for proper dust removal.
26.  **WARNING**
People with electronic devices, such as pacemakers, should consult their physician(s) before using this product. Operation of electrical equipment in close proximity to a heart pacemaker could cause interference or failure of the pacemaker.
27.  **WEAR HEARING PROTECTION to reduce the risk of induced hearing loss.**

BAND SAW SAFETY

- 1. TO AVOID INJURY** from unexpected movement, make sure the saw is on a firm, level surface and properly secured to prevent rocking. Make sure there is adequate space for operating. Bolt the saw to a support surface to prevent slipping, walking or sliding during operation.
- 2. UNPLUG AND TURN** the saw off before moving it.
- 3. USE THE CORRECT** size and style of blade.
- 4. USE** blades rated at 2500 FPM or greater.
- 5. MAKE SURE** the blade teeth point down and towards the table when installed on unit.
- 6. BLADE GUIDES, SUPPORT BEARINGS AND BLADE TENSION** must be properly adjusted to avoid accidental blade contact and to minimize blade breakage. To maximize blade support, always adjust the upper blade guide and blade guard so that it is 1/8 inch (3.2 mm) above the workpiece.
- 7. TABLE LOCK HANDLE** should be tight.
- 8. USE EXTRA CAUTION** with large, very small or awkward workpieces.
- 9. USE EXTRA SUPPORTS** to prevent workpieces from sliding off the table top. Never use another person to support the workpiece.
- 10. WORKPIECES** must be secured so they do not twist, rock or slip while being cut.
- 11. PLAN** intricate and small work carefully to avoid pinching the blade. Avoid awkward operation and hand positions to prevent accidental contact with the blade.
- 12. SMALL PIECES** should be secured with jigs or fixtures. Do not hold pieces that are so small your fingers are under the blade guard.
- 13. SUPPORT** round work properly (with a V-block or clamped to the miter gauge) to prevent it from rolling and the blade from biting.
- 14. CUT** only one workpiece at a time. Make sure the table is clear of everything except the workpiece and guides before turning the saw on.
- 15. ALWAYS WATCH** the saw run before each use. If there is excessive vibration or unusual noise, stop immediately. Turn the saw off. Unplug immediately. Do not start the saw again until the problem has been located and corrected.
- 16. TO FREE** any jammed material, turn the switch off. Remove the switch key and unplug the saw. Wait for all moving parts to stop before removing jammed material.
- 17. DO NOT LEAVE** the work area until all moving parts are stopped. To childproof the workshop, shut off power to master switches and remove the switch key from the band saw. Store it in a safe place, away from children.

WARNING

For your own safety, read the entire Instruction Manual before using the band saw.

1. Wear eye protection.
2. Do not wear gloves, neckties or loose clothing.
3. Make sure the saw is on a firm level surface and properly secured.
4. Use only the recommended accessories.
5. Use extra caution with very large, very small or awkward workpieces.
6. Keep hands away from the blade at all times to prevent accidental injury.
7. Do not remove jammed or cutoff pieces until the blade has stopped.
8. Maintain proper adjustment of blade tension, blade guides and thrust bearings.
9. Hold the workpiece firmly against the table.
10. Adjust the upper guide to clear the workpiece.

ELECTRICAL REQUIREMENT AND SAFETY

POWER SUPPLY AND MOTOR SPECIFICATIONS

⚠ WARNING

To avoid electrical hazards, fire hazards, or damage to the tool, use proper circuit protection. Use a separate electrical circuit for your tool. Your saw is wired at the factory for 120 V operation. Connect to a 120 V, 10 Amp circuit and use a 10 Amp time delay fuse or circuit breaker. To avoid shock or fire, if power cord is worn, cut, or damaged in any way, have it replaced immediately.

GROUNDING INSTRUCTIONS

⚠ WARNING

This tool must be grounded while in use to protect the operator from electrical shock.

IN THE EVENT OF A MALFUNCTION OR BREAKDOWN, grounding provides a path of least resistance for electric currents and reduces the risk of electric shock. This tool is equipped with an electrical cord that has an equipment-grounding conductor and a grounding plug. The plug must be plugged into a matching receptacle that is properly installed and grounded in accordance with all local codes and ordinances.

DO NOT MODIFY THE PLUG PROVIDED.

If it will not fit the receptacle, have the proper receptacle installed by a qualified electrician.

IMPROPER CONNECTION of the equipment grounding conductor can result in risk of electric shock. The conductor with the green insulation (with or without yellow stripes) is the equipment grounding conductor. If repair or replacement of the electrical cord or plug is necessary, do not connect the equipment grounding conductor to a live terminal.

CHECK with a qualified electrician or service person if you do not completely understand the grounding instructions, or if you are not certain the tool is properly grounded.

USE only 3-wire extension cords that have three-pronged grounding plugs with three-pole receptacles that accept the tool's plug. Repair or replace damaged or worn cords immediately.

Use a separate electrical circuit for your tool. This circuit must not be less than #16 wire and should be protected with a 10 Amp time lag fuse. Before connecting the motor to the power line, make sure the switch is in the off position and the electric current is rated the same as the current stamped on the motor nameplate. Running at a lower voltage will damage the motor.

GUIDELINES FOR EXTENSION CORDS

USE THE PROPER EXTENSION CORD.

Make sure your extension cord is in good condition. Use an extension cord heavy enough to carry the current your product will draw. An undersized cord will cause a drop in line voltage resulting in loss of power, overheating and burning out of the motor. The table below shows the correct size to use depending on cord length and nameplate ampere rating. If in doubt, use the next heavier gauge. The smaller the gauge number, the heavier the cord.

Make sure your extension cord is properly wired and in good condition. Always replace a damaged extension cord or have it repaired by a qualified technician before using it. Protect your extension cords from sharp objects, excessive heat and damp or wet areas.

MINIMUM GAUGE FOR EXTENSION CORDS (AWG)						
Ampere Rating		Total Length of Cord				
More Than	Not More Than	120 V	25	50	100	150 ft.
		(7.62	15.24	30.48	45.72 m)	
More Than	Not More Than	240 V	50	100	200	300 ft.
		(15.24	30.48	60.96	91.44 m)	
AWG - American Wire Gauge						
0	6	18	16	16	14	
6	10	18	16	14	12	
10	12	16	16	14	12	
12	16	14	12	Not Recommended		

⚠ WARNING

This tool is for indoor use only. Do not expose to rain or use in damp locations.

This tool is intended for use on a circuit that has a receptacle like the one illustrated in Fig. 1. Fig. 1 shows a three-pronged electrical plug and receptacle that has a grounding conductor. If a properly grounded receptacle is not available, an adapter (Fig. 2) can be used to temporarily connect this plug to a two-contact grounded receptacle. The adapter (Fig. 2) has a rigid lug extending from it that MUST be connected to a permanent earth ground, such as a properly grounded receptacle box.

⚠ CAUTION

In all cases, make certain the receptacle is properly grounded. If you are not sure, have a qualified electrician check the receptacle.

Fig. 1

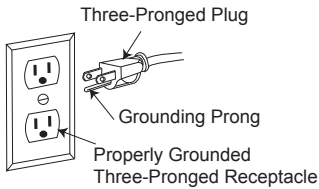
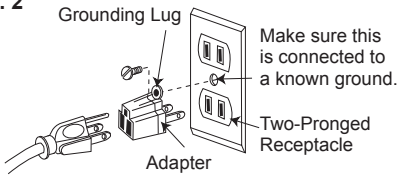

Fig. 2



TOOLS NEEDED FOR ASSEMBLY

Supplied



2 mm hex wrench



4 mm hex wrench



Open end wrench

Not Supplied



Phillips screwdriver



Adjustable wrench

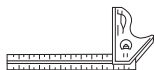

Combination square

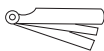

Feeler gauge
(size 0.02 in.)

CARTON CONTENTS

UNPACKING AND CHECKING CONTENTS

Carefully unpack the band saw and all its parts, and compare against the list below and the illustration on the next page. With the help of an assistant place the saw on a secure surface and examine it carefully.

⚠ WARNING

- To avoid injury from unexpected starting or electrical shock, do not plug the power cord into a source of power during unpacking and assembly. This cord must remain unplugged whenever you are adjusting/assembling the saw.
- The saw is heavy and should be lifted with care. If needed, get the assistance of someone to lift and move the saw.
- If any part is missing or damaged, do not attempt to assemble the band saw, or plug in the power cord until the missing or damaged part is correctly replaced.

TABLE OF LOOSE PARTS

ITEM DESCRIPTION	QUANTITY
A. Band saw	1
B. Miter gauge	1
C. Table locking knob and washer	1 each
D. Band saw table assembly	1
E. Open end wrench	1
2 mm hex wrench	1
4 mm hex wrench	1

UNPACKING YOUR BAND SAW

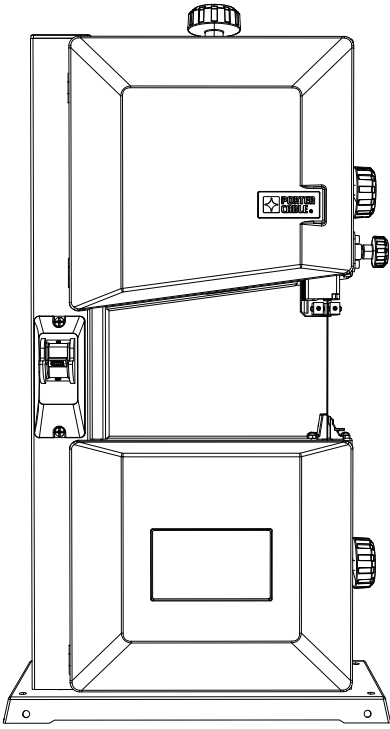

A

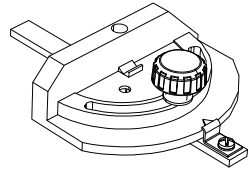

B

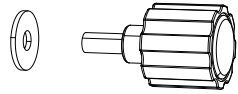

C

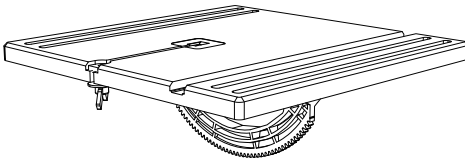

D

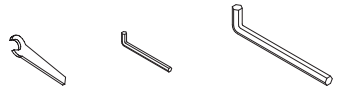

E

KNOW YOUR BAND SAW

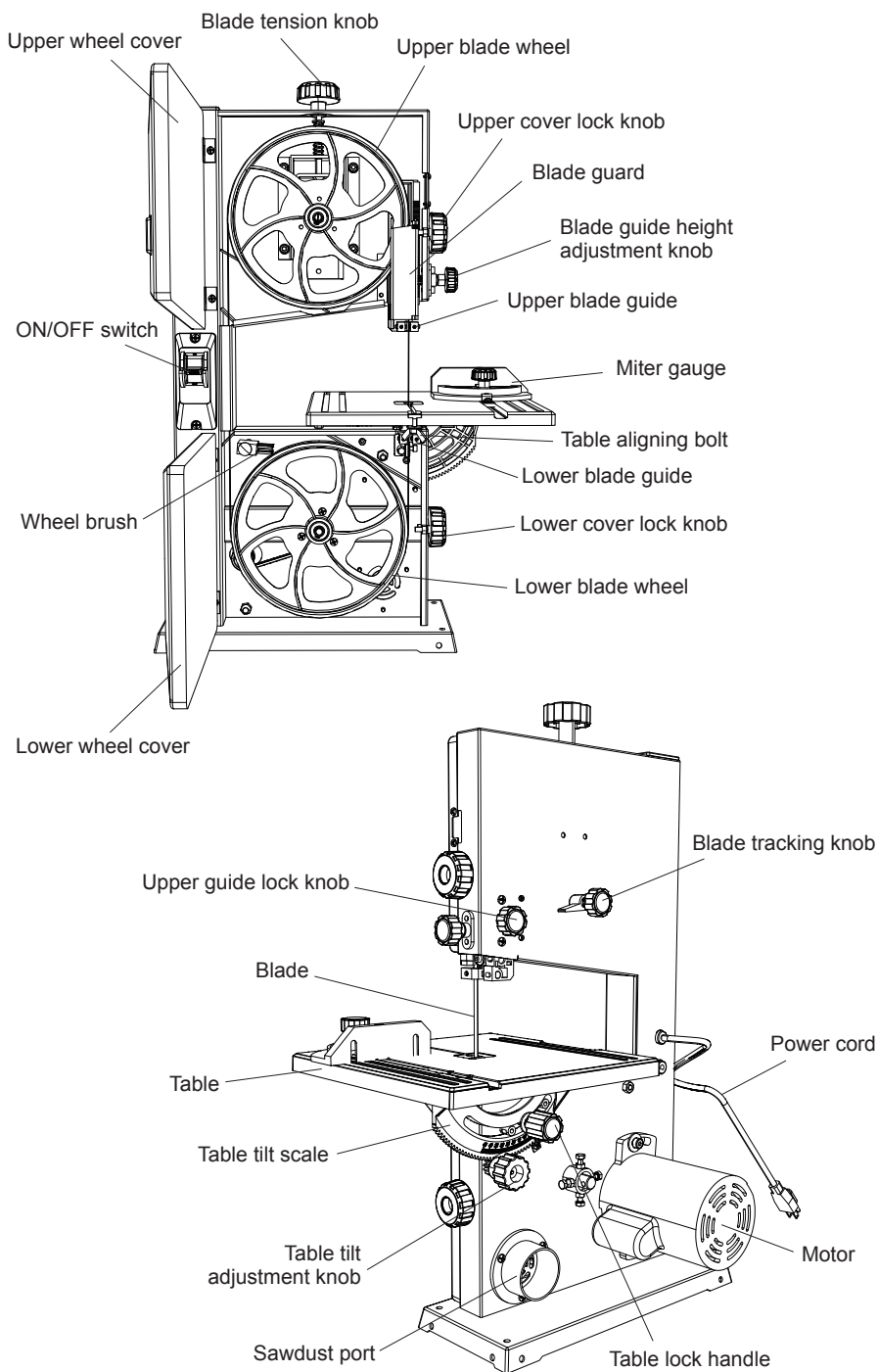

GLOSSARY OF TERMS

BAND SAW TERMS

BLADE GUIDES — Support the blade and keep it from twisting during operation. Blade guides must be adjusted when blade is changed or replaced.

UPPER GUIDE LOCK KNOB — locks the upper slide. Use it after adjusting the upper guide assembly to make sure upper blade guide just clears workpiece before cutting. Upper guide lock knob must be tightened before the band saw is turned on.

TABLE LOCK KNOB — locks the table in place.

TILT (BEVEL) SCALE — shows the degree the table is tilted for bevel cutting.

BLADE TENSION KNOB — controls the amount of blade tension when changing blades.

BLADE TRACKING KNOB — adjusts blade position so blade always runs in the center of the wheel.

SAWDUST PORT — helps keep the machine free from sawdust. The sawdust port makes an excellent hook-up for a wet/dry vacuum.

ON/OFF SWITCH — has a built-in child safety lock. To lock the switch in the OFF position, remove the switch key from the switch.

WOODWORKING TERMS

BEVEL CUT — An angle cut made through the face of a workpiece.

COMPOUND CUT — A simultaneous bevel and miter cut.

CROSSCUT — A cut made across the width of the workpiece.

F.P.M. — Feet per minute. Used in reference to the surface speed of the saw blade.

FREE HAND — Performing a cut without using a fence (guide), hold-down or other proper device to prevent the workpiece from twisting during the cutting operation.

GUM — A sticky sap-based residue from wood products.

HEEL — Misalignment of the blade.

KERF — The material removed by the blade in a through cut, or the slot produced by the blade in a non-through or partial cut.

LEADING EDGE — The front edge of the workpiece pushed into the cutting tool first.

MITER CUT — An angle cut made across the width of a workpiece.

RESAW — A cutting operation to reduce the thickness of the workpiece to make thinner workpiece.

RESIN — A sticky sap that has hardened.

RIPPING CUT — A cutting operation along the length of the workpiece.

R.P.M. — Revolutions per minute. The number of turns completed by a spinning object in one minute.

SAW BLADE PATH — The area of the workpiece or table top directly in line with the travel of the blade or the part of the workpiece that will be cut.

SET — The distance between two saw blade teeth tips, that are bent outward in opposite directions to each other. The further apart the tips are, the greater the set.

TRAILING EDGE — The workpiece edge last cut by the blade.

WORKPIECE — The item being cut. The surfaces of a workpiece are commonly referred to as faces, ends and edges.

WORKTABLE — The surface on which the workpiece rests while performing a cutting or sanding operation.

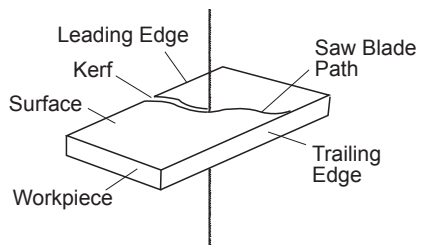

ASSEMBLY AND ADJUSTMENTS

Estimated Assembly Time: 50 - 60 minutes.

⚠ WARNING

For your safety, never connect plug to power source receptacle until all assembly and adjustment steps are complete, and you have read and understood the safety instructions.

INSTALLING THE BAND SAW TABLE

(FIG. A, B, C)

1. **Bag "D"** - Loosen the table aligning bolt (1) and remove the table aligning nut (2) from the table.
2. Guide the table slot (3) over the saw blade (4).

Fig. A

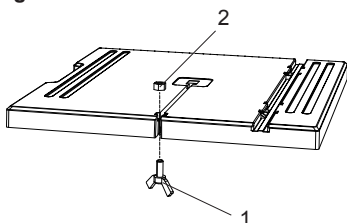
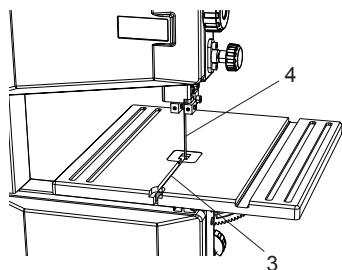

Fig. B



3. Place the table by aligning the slot (5) of table tilt scale (6) with two pins (7) and the teeth of the scale (6) engage with the teeth of the table tilt adjustment knob (8) as shown on Fig. C.
4. **Bag "C"** - Insert the table lock knob (9) through the washer (10) and into the hole (11).
5. Adjust the table by aligning the zero scale mark to the scale pointer (12) and tighten the table lock knob (9).

6. Replace the table aligning nut (2) back into the place and tighten with the table aligning bolt (1).

Fig. C

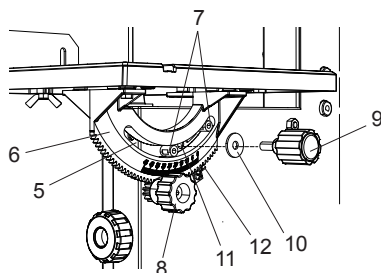

INSTALLING AND REMOVING BLADE

(FIG. D, E)

⚠ WARNING

To avoid injury from accidental starting, always turn the switch OFF and remove the plug from the power source before moving, replacing, or adjusting the blade.

Removing

1. Loosen the blade tension by turning the blade tension knob (1) counterclockwise.
2. Open the upper and lower wheel cover doors (2) by rotating the two wheel cover lock knobs (3).
3. Remove the table aligning pad from the table.

Fig. D

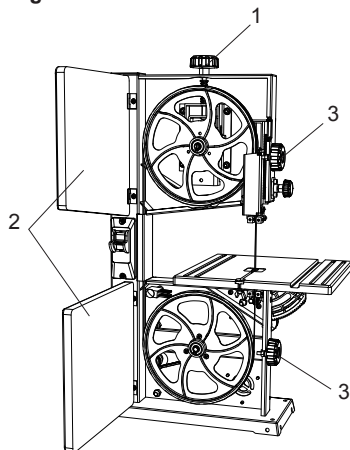

4. Loosen the upper blade guide lock knob (4) on the rear side of the band saw by turning it counterclockwise.
5. Lower the upper blade guide (5) to its lowest position by turning the blade guide height adjustment knob (6).
6. Pull and open the blade guard (7) as shown in Fig. E.
7. Remove the blade (8) from the upper and lower blade guides (5, 9).
8. Carefully pull the blade (8) from the table slot (10) and from the wheels (11).
9. Hold the blade (8), slide it out from the left side blade guard slot (12).

Fig. E

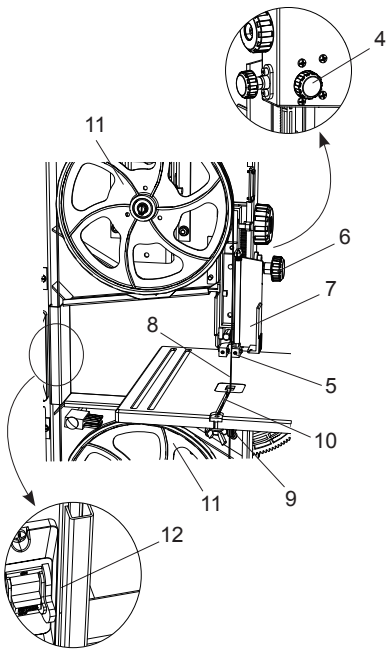

Installing

1. Make sure the blade tension knob (1) is turned counterclockwise enough to get blade over pulleys.
2. Remove old blade as explained in "Removing" section.
3. Guide the new blade (8) through the slot (12) of the left side blade guard. Make sure the blade teeth are pointing forward and down.

NOTE: To avoid lifting the workpiece, the blade teeth must point downward toward the table.
4. Place the blade (8) on the upper and lower wheels (11).
5. Place the blade carefully between the upper and lower blade guides (5, 9).
6. Slide the blade into the table slot (10), and make sure the blade is positioned at the middle of the wheels.
7. Turning the blade tension knob (1) clockwise, tighten the tension until the blade is tight on the wheels.
8. Close the upper blade guard (7), and rise the upper blade guard to the desired height by turning the blade guide height adjustment knob (6).
9. Tighten the upper blade guide lock knob (4).
10. Replace the table aligning pin (3).
11. Adjust the blade tracking and tension properly (See ADJUSTMENT INSTRUCTIONS section) before operating the band saw.

⚠ WARNING

To avoid injury, the blade tension, tracking, upper and lower guides and bearings must be properly adjusted before operating the band saw. (See ADJUSTMENT INSTRUCTIONS section)

⚠ WARNING

Before operation always make sure the blade is in center of table insert slot.

INSTALLING A NEW BELT (FIG. F)

1. Open the lower wheel cover.
 2. Loosen the blade tension by turning the blade tension knob.
 3. Remove the blade from the lower wheel assembly.
 4. Using a snap ring pliers, remove snap ring (1) that secures lower wheel (2) to shaft (3) and flange (4) on the lower blade wheel.
 5. Loosen the belt tension by loosen the hex screw on the motor with a 6 mm hex wrench. See "DRIVE BELT TENSION" on page 18.
 6. Slide lower wheel assembly off the shaft (3) which will dislodge the belt. Remove the old belt.
 7. Place the new belt on the saw pulley and the motor pulley.
 8. When the pulley belt is positioned properly, tighten the hex screw on the motor.
- NOTE:** The pulley belt is properly tensioned when there is a 1/2 in. (12.7 mm) deflection if pressed in the center of the pulleys.
9. Replace the lower wheel (2). Push the wheel in firmly until it is touching the shaft step. Replace and tighten the flange (4) and snap ring (1).
 10. Reinstall the blade. See "INSTALLING AND REMOVING BLADE - Installing" section on page 14.
 11. Adjust the blade tension, tracking, the upper and lower blade guides and bearings before operating the band saw.

⚠ WARNING

To avoid injury, the blade tension, tracking, and upper and lower guides and bearings must be properly adjusted before operating the band saw. (See "ADJUSTMENT INSTRUCTIONS" section)

Fig. F

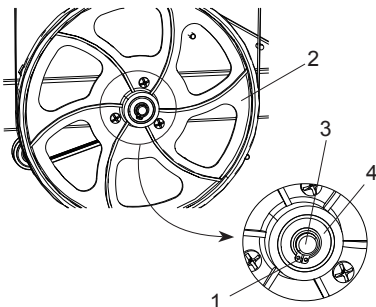

ADJUSTMENT INSTRUCTIONS

⚠ WARNING

To avoid injury, turn the switch OFF and unplug the band saw from the power source before making any adjustments.

TABLE ADJUSTMENTS (FIG. G)

Tilting the table (Fig. G)

The band saw table can be tilted from 0° to 45° right.

1. Loosen the table lock knob (1) on the rear side of the band saw.
2. Tilt the table to the desired angle on the table tilt scale (2).
3. Tighten the table lock knob (1).

Fig. G

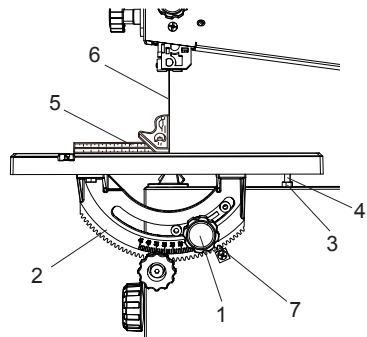

Adjusting the 90° table stop (Fig. G)

1. Loosen the table lock knob (1) and tilt the table to the right.
2. Loosen the nut (3) on the table stop bolt (4) and lower the table stop bolt (4) as far as possible.
3. Place a combination square (5) on the table with the heel of the square against the saw blade (6).
4. Rise or lower the table stop bolt (4) to adjust the table until it is 90° to the blade. Make sure there is no space between the square and the blade. Tighten the nut (3).
5. Check the square again to make sure the table is 90° to the blade. If not, re-adjust the stop bolt (4).
6. Lock table lock knob (1).
7. When the adjustment is accurate at 90°, align the pointer (7) to 0° on the scale (2).

BLADE TENSION (FIG. H)

⚠ WARNING

- To avoid injury, turn the switch OFF and disconnect the saw from the power source before making any adjustments. NEVER make tension adjustments with the machine running.
 - Blade tension was set at the factory. When adjustment is needed please follow the procedure below.
1. Turn the blade tension knob (1) clockwise to tighten the blade, counterclockwise to loosen.
 2. As you become familiar with the saw, you may try to change the tension settings.

NOTE: Changes in blade width and type of material being cut will have an effect on the blade tension. Too much or too little tension could break the blade.

Fig. H

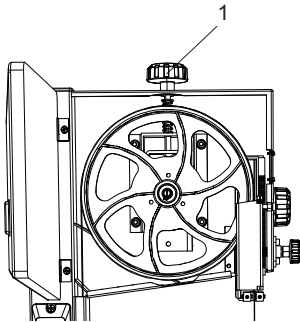

BLADE TRACKING (FIG. I)

⚠ WARNING

To avoid injury, turn the switch OFF and disconnect the saw from the power source before making any adjustments. NEVER make tracking adjustments with the machine running.

Blade tracking was set at the factory. When adjustment is needed please follow the procedure below.

Tracking refers to how the blade is situated upon the wheels while in motion. The blade should track in the center of both wheels.

The blade must be slightly tensioned before adjusting blade tracking. Make sure blade guides and bearings do not interfere with blade.

1. Open upper and lower doors. Hand rotate upper wheel slowly and observe the position of blade on the wheel. Blade should be in the center of the wheel.
2. If adjustment is necessary, loosen the lock handle (1) on the rear of the band saw and make adjustment with tracking knob (2).
3. If the blade moves toward the front of the wheel, turn the tracking knob (2) clockwise. This tilts the top of the wheel and moves the blade toward the center.
4. If the blade moves toward the back edge, turn the tracking knob (2) counterclockwise, moving the blade toward the center.
5. After blade is tracking in the center of the wheel, tighten the lock handle (1).

Fig. I

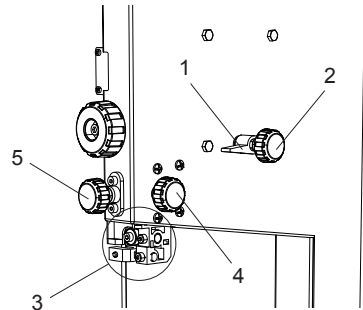

UPPER BLADE GUIDE POSITIONING (FIG. I)

⚠ WARNING

To avoid injury, turn the switch OFF and disconnect the saw from the power source before making any adjustments. NEVER make adjustments with the machine running.

The upper blade guide assembly (3) should be adjusted to just above the material being cut. To adjust:

1. Loosen the lock knob (4) and raise or lower upper blade guide assembly (3) by turning height adjustment knob (5).

UPPER BLADE GUIDES AND BLADE SUPPORT BEARING (FIG. J, K)

⚠ WARNING

The blade guard has been removed for clarity of illustration. To avoid injury, never operate the band saw without all guards in place and in working order.

⚠ WARNING

To avoid injury, turn the switch OFF and disconnect the saw from the power source before making any adjustments. NEVER make adjustments with the machine running. **NOTE:** Make sure the blade is tensioned and tracking properly. Adjust the blade guides and support bearing after each blade tension and tracking adjustment. When the upper blade guides and support bearings are adjusted, the lower guides and bearings should also be adjusted.

Blade guides (Fig. J, K)

Blade guides have been set at the factory but should be checked.

1. Make sure the blade is tensioned and tracking properly.
2. Loosen the two front hex socket screws (1) with a 2 mm hex wrench.
3. Move the two guide pins (2) as close to the blade (3) as possible without pinching it.
4. Using a feeler gauge, make sure the space between guide pins and the blade measured is 0.002 in. (0.05 mm, the thickness of a dollar bill).
5. Tighten the front hex screws (1).

Fig. J

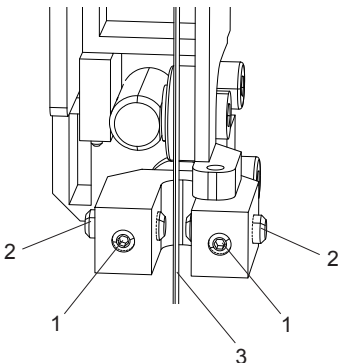

6. Loosen the side hex screw (4) by turning counterclockwise with a 4 mm hex wrench supplied.
7. Move the upper blade guide brackets (5) in or out until the guide pins (2) are just behind the blade teeth.
8. Tighten the side hex screw (4).

Fig. K

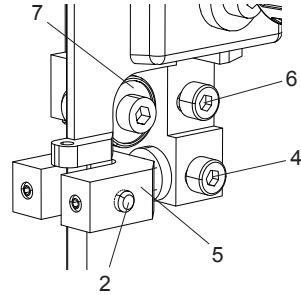

Support bearing (Fig. K)

Support bearing has been set at the factory but should be checked.

9. Loosen the hex screw (6), adjust the support bearing (7) in or out until the bearing is 1/64 in. (0.4 mm) behind the blade. **NOTE:** This blade support bearing prevents the blade from moving back too far and damaging the saw teeth setting.
10. Check the position of blade, it should be positioned within the face of the support bearing (7).
11. Tighten the hex screw (6).

LOWER BLADE GUIDES AND SUPPORT BEARING (FIG. L, M, N)

⚠ WARNING

To avoid injury, turn the switch OFF and disconnect the saw from the power source before making any adjustments. NEVER make adjustments with the machine running. **NOTE:** Make sure the blade is tensioned and tracking properly. The lower blade guides and support bearings should always be adjusted after the blade is tensioned, the tracking is adjusted, and the upper blade guides and upper support bearings are properly adjusted.

Blade guides

1. Loosen two front hex socket screws (1) with a hex wrench.
2. Move the guide pins (2) as close to the sides of the blade (3) as possible without pinching it.
3. Using the feeler gauge, measure the spaces between the guide pins and the blade. Adjust to 0.002 in. (0.05 mm).
4. Tighten two front hex socket screws (1).

Fig. L

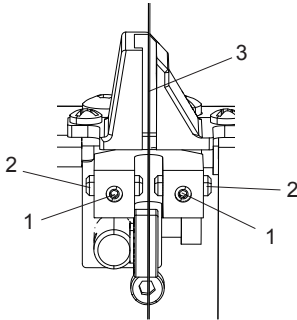

5. Loosen two lock screws (4), move the lower blade guide bracket (5) in or out until the guide pins (2-Fig. K) are just behind the saw teeth. Tighten two lock screws (4).

Fig. M

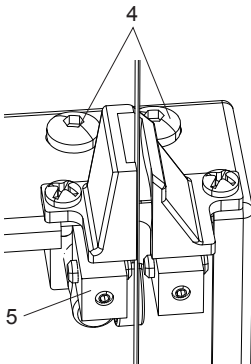

Support bearing

6. Loosen the support bearing hex screw (6) on the right side of the band saw with the hex wrench.
7. Move the support bearing shaft (7) in or out until the support bearing (8) is 1/64 in. (0.4 mm) behind the saw blade.

8. Tighten the support bearing hex screw (6).
9. The back edge of the blade (3) should be positioned 1/16 in. (1.6 mm) to 1/8 in. (3.2 mm) from the surface of the support bearing (8).

Fig. N

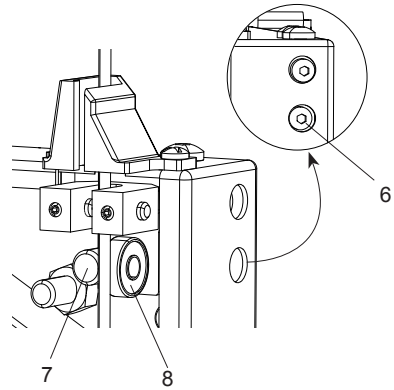

DRIVE BELT TENSION

1. Disconnect the machine from the power source.
2. Loosen the hex screw (1) on the motor with a 6 mm wrench. Do not remove the hex screw (1).
3. Push the motor down to add tension to belt. Move the motor up to loose tension to belt.
4. The belt is properly tensioned when moderate finger pressure on the belt between the two pulleys causes a 1/2 in. deflection.
5. Tighten the hex screw (1) that secures motor.

Fig. O

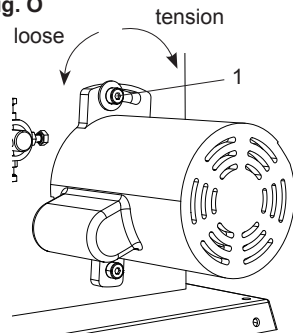

OPERATION

BASIC SAW OPERATIONS

“ON/OFF” SWITCH (FIG. P)

The switch with safety key is intended to prevent unauthorized use of the band saw.

1. To turn the band saw ON, insert the yellow safety key (1) into the key slot in the center of the switch (2).
2. Push the key firmly into the slot, then push switch (2) to the ON position to start the band saw.
3. To turn the band saw OFF, push the switch (2) to the OFF position.
4. Remove the yellow safety key (1) by pulling it outward when the saw is complete stop.

⚠ WARNING

Remove the yellow safety key (1) whenever the saw is not in use. Place it in a safe place and out of reach of children.

Fig. P

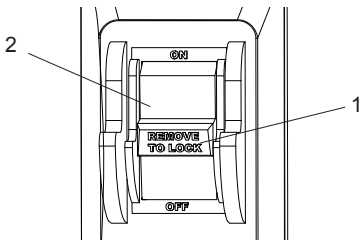

GENERAL CUTTING

⚠ WARNING

For your safety, read and understand all SAFETY INSTRUCTIONS on pages 4-8 before using the band saw.

Operating band saws involves a certain amount of hazard. Before attempting regular work, use scrap lumber to check the settings, and to get the feel of operating the band saw. Read instructions and plan your work before cutting a workpiece.

Do not turn the power ON until after you have made all adjustments, checked that the guard is in place, and turned the wheel by hand to make sure all parts work properly. Always keep the guide assembly 1/8 in. (3.2 mm) above the workpiece.

Do not force the workpiece against the blade. Light contact permits easier cutting and prevents unwanted friction and heating of the blade.

Sharp saw blades need little pressure for cutting. Steadily move the workpiece against the blade without forcing it.

To avoid twisting the blade do not turn sharp corners; saw around corners.

A band saw is basically a “curve-cutting” saw. It is not capable of doing intricate inside cutting as can be done with a scroll saw.

It is also used for straight line operations such as crosscutting, ripping, mitering, beveling, compound cutting, and resawing.

⚠ WARNING

To avoid blade breakage, fire or other damage or injury, NEVER use this band saw to cut metals.

CUTTING CURVES

When cutting curves, carefully turn the workpiece so the blade may follow without twisting. If the curve is so sharp that you repeatedly back up and cut new kerf, use a narrower blade, or a blade with more set (teeth further apart). When a blade has more set, the workpiece turns easier but the cut is rougher.

When changing a cut, do not withdraw the workpiece from the blade. The blade may get drawn off the wheels. To change a cut, turn the workpiece and saw out through the scrap material area.

When cutting long curves, make relief cuts as you go along.

CIRCLE CUTTING (FIG. Q)

1. Adjust the guide assembly to 1/8 in. (3.2 mm) above the workpiece.
2. Use both hands while feeding the work into the blade. Hold the workpiece firmly against the table. Do not force the work and operate with gentle pressure.
3. The smallest diameter circle that can be cut is determined by the width of the blade. For example, a 1/4 in. (6.4 mm) wide blade will cut a minimum diameter of approximately 1-1/2 in. (38.1 mm).

Fig. Q

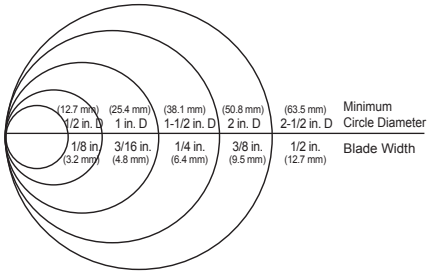

BLADE SELECTION (FIG. R)

CAUTION

Blade teeth are sharp. Use care when handling a saw blade.

CAUTION

For longest wear and best cutting results, use the correct blade thickness, width, and temper for the type of material you will cut.

When sawing small curves and delicate work, use narrow blades. Otherwise, use the widest blade as possible. (Please refer Fig. Q)

For cutting wood and similar materials with this band saw, purchase blades in width up to 1/2 in. (12.7 mm), and a length of 59-1/2 in. (1,511.3 mm).

Do not cut metals with this band saw.

Fig. R

Operation	Recommended Blade Width (Inches)
Cross Cutting	1/8, 1/4, 3/8 in. (3.2, 6.4, 9.5 mm)
Mitering	1/8, 1/4, 3/8 in. (3.2, 6.4, 9.5 mm)
Beveling	1/8, 1/4, 3/8 in. (3.2, 6.4, 9.5 mm)
Compound Cutting	1/8, 1/4, 3/8 in. (3.2, 6.4, 9.5 mm)
Circle Cutting	See chart on Fig. P
Curve Cutting	1/8, 1/4 in. (3.2, 6.4 mm)

FREE WARNING LABEL REPLACEMENT:

If your warning labels become illegible or are missing, call 1-888-609-9779 for a free replacement.

PCXB310BS
 120V AC~ 60Hz 2.5A 1720RPM (No Load)
 BLADE SPEED: 2500FPM
 SERIAL NO. / N° DE SÉRIE / SERIAL N°:
 MFG. DATE / DATE DE FAB. / FECHA FAB.:

POWER TOOL SPECIALISTS, INC. ROCK HILL, SC 29730 U.S.A. 1-888-609-9779
 PORTER-CABLE and the PORTER-CABLE logo are registered trademarks of PORTER-CABLE and are used under license. All rights reserved.
 PORTER-CABLE et le logo PORTER-CABLE sont des marques déposées de PORTER-CABLE utilisées sous licence. Tous droits réservés.
 PORTER-CABLE y el logo PORTER-CABLE son marcas comerciales registradas de PORTER-CABLE y se utilizan bajo licencia. Todos los derechos reservados.

MADE IN CHINA / FABRIQUÉ EN CHINE / HECHO EN CHINA

⚠ DANGER
 CUT HAZARD.
 KEEP HANDS AWAY FROM BLADE.

⚠ PELIGRO
 RIESGO DE CORTE.
 MANTENGA MANOS LEJOS DE LA HOJA.

⚠ DANGER
 RISQUE DE COUPURE.
 ÉLOIGNER LES MAINS DE LA LAME.

BLADE DIRECTION
 ↓

⚠ WARNING	⚠ AVERTISSEMENT	⚠ ADVERTENCIA
<p>1. READ THE INSTRUCTIONS.</p> <p>2. DO NOT OPERATE UNLESS YOU HAVE READ THE INSTRUCTIONS CAREFULLY.</p> <p>3. ALWAYS WEAR PROTECTIVE EYEWEAR AND MAKE CERTAIN THE BLADE IS FULLY STOPPED BEFORE YOU TOUCH IT.</p> <p>4. NEVER ATTEMPT TO ADJUST OR REPAIR THE BAND SAW WHILE IT IS RUNNING. MAKE SURE THE BAND SAW IS COMPLETELY STOPPED.</p> <p>5. ALWAYS WEAR YOUR SAFETY GLASSES AND HEARING PROTECTION.</p> <p>6. KEEP HANDS AWAY FROM THE BLADE AND ALWAYS WEAR PROTECTIVE EYEWEAR AND HEARING PROTECTION.</p> <p>7. NEVER ATTEMPT TO ADJUST OR REPAIR THE BAND SAW WHILE IT IS RUNNING. MAKE SURE THE BAND SAW IS COMPLETELY STOPPED.</p> <p>8. NEVER ATTEMPT TO ADJUST OR REPAIR THE BAND SAW WHILE IT IS RUNNING. MAKE SURE THE BAND SAW IS COMPLETELY STOPPED.</p> <p>9. NEVER ATTEMPT TO ADJUST OR REPAIR THE BAND SAW WHILE IT IS RUNNING. MAKE SURE THE BAND SAW IS COMPLETELY STOPPED.</p> <p>10. NEVER ATTEMPT TO ADJUST OR REPAIR THE BAND SAW WHILE IT IS RUNNING. MAKE SURE THE BAND SAW IS COMPLETELY STOPPED.</p> <p>11. NEVER ATTEMPT TO ADJUST OR REPAIR THE BAND SAW WHILE IT IS RUNNING. MAKE SURE THE BAND SAW IS COMPLETELY STOPPED.</p> <p>12. NEVER ATTEMPT TO ADJUST OR REPAIR THE BAND SAW WHILE IT IS RUNNING. MAKE SURE THE BAND SAW IS COMPLETELY STOPPED.</p> <p>13. NEVER ATTEMPT TO ADJUST OR REPAIR THE BAND SAW WHILE IT IS RUNNING. MAKE SURE THE BAND SAW IS COMPLETELY STOPPED.</p> <p>14. NEVER ATTEMPT TO ADJUST OR REPAIR THE BAND SAW WHILE IT IS RUNNING. MAKE SURE THE BAND SAW IS COMPLETELY STOPPED.</p> <p>15. NEVER ATTEMPT TO ADJUST OR REPAIR THE BAND SAW WHILE IT IS RUNNING. MAKE SURE THE BAND SAW IS COMPLETELY STOPPED.</p> <p>16. NEVER ATTEMPT TO ADJUST OR REPAIR THE BAND SAW WHILE IT IS RUNNING. MAKE SURE THE BAND SAW IS COMPLETELY STOPPED.</p> <p>17. NEVER ATTEMPT TO ADJUST OR REPAIR THE BAND SAW WHILE IT IS RUNNING. MAKE SURE THE BAND SAW IS COMPLETELY STOPPED.</p> <p>18. NEVER ATTEMPT TO ADJUST OR REPAIR THE BAND SAW WHILE IT IS RUNNING. MAKE SURE THE BAND SAW IS COMPLETELY STOPPED.</p> <p>19. NEVER ATTEMPT TO ADJUST OR REPAIR THE BAND SAW WHILE IT IS RUNNING. MAKE SURE THE BAND SAW IS COMPLETELY STOPPED.</p> <p>20. NEVER ATTEMPT TO ADJUST OR REPAIR THE BAND SAW WHILE IT IS RUNNING. MAKE SURE THE BAND SAW IS COMPLETELY STOPPED.</p>	<p>1. LIREZ LES INSTRUCTIONS.</p> <p>2. NE PAS OPERER SAUF SI VOUS AVEZ LUEU LES INSTRUCTIONS ATTENTIVEMENT.</p> <p>3. TOUJOURS PORTER DES LUNETTES DE PROTECTION ET S'ASSURER QUE LA LAME EST COMPLETEMENT ARRÊTÉE AVANT DE LA TOUCHER.</p> <p>4. NE PAS TENTER D'AJUSTER NI RÉPARER LA SCIE PENDANT QU'ELLE EST EN MARCHÉ. S'ASSURER QUE LA SCIE EST COMPLETEMENT ARRÊTÉE AVANT DE LA TOUCHER.</p> <p>5. TOUJOURS PORTER SES LUNETTES DE PROTECTION ET SES PROTECTEURS D'AUDITION.</p> <p>6. GARDER LES MAINS LOIN DE LA LAME ET TOUJOURS PORTER SES LUNETTES DE PROTECTION ET SES PROTECTEURS D'AUDITION.</p> <p>7. NE PAS TENTER D'AJUSTER NI RÉPARER LA SCIE PENDANT QU'ELLE EST EN MARCHÉ. S'ASSURER QUE LA SCIE EST COMPLETEMENT ARRÊTÉE AVANT DE LA TOUCHER.</p> <p>8. NE PAS TENTER D'AJUSTER NI RÉPARER LA SCIE PENDANT QU'ELLE EST EN MARCHÉ. S'ASSURER QUE LA SCIE EST COMPLETEMENT ARRÊTÉE AVANT DE LA TOUCHER.</p> <p>9. NE PAS TENTER D'AJUSTER NI RÉPARER LA SCIE PENDANT QU'ELLE EST EN MARCHÉ. S'ASSURER QUE LA SCIE EST COMPLETEMENT ARRÊTÉE AVANT DE LA TOUCHER.</p> <p>10. NE PAS TENTER D'AJUSTER NI RÉPARER LA SCIE PENDANT QU'ELLE EST EN MARCHÉ. S'ASSURER QUE LA SCIE EST COMPLETEMENT ARRÊTÉE AVANT DE LA TOUCHER.</p> <p>11. NE PAS TENTER D'AJUSTER NI RÉPARER LA SCIE PENDANT QU'ELLE EST EN MARCHÉ. S'ASSURER QUE LA SCIE EST COMPLETEMENT ARRÊTÉE AVANT DE LA TOUCHER.</p> <p>12. NE PAS TENTER D'AJUSTER NI RÉPARER LA SCIE PENDANT QU'ELLE EST EN MARCHÉ. S'ASSURER QUE LA SCIE EST COMPLETEMENT ARRÊTÉE AVANT DE LA TOUCHER.</p> <p>13. NE PAS TENTER D'AJUSTER NI RÉPARER LA SCIE PENDANT QU'ELLE EST EN MARCHÉ. S'ASSURER QUE LA SCIE EST COMPLETEMENT ARRÊTÉE AVANT DE LA TOUCHER.</p> <p>14. NE PAS TENTER D'AJUSTER NI RÉPARER LA SCIE PENDANT QU'ELLE EST EN MARCHÉ. S'ASSURER QUE LA SCIE EST COMPLETEMENT ARRÊTÉE AVANT DE LA TOUCHER.</p> <p>15. NE PAS TENTER D'AJUSTER NI RÉPARER LA SCIE PENDANT QU'ELLE EST EN MARCHÉ. S'ASSURER QUE LA SCIE EST COMPLETEMENT ARRÊTÉE AVANT DE LA TOUCHER.</p> <p>16. NE PAS TENTER D'AJUSTER NI RÉPARER LA SCIE PENDANT QU'ELLE EST EN MARCHÉ. S'ASSURER QUE LA SCIE EST COMPLETEMENT ARRÊTÉE AVANT DE LA TOUCHER.</p> <p>17. NE PAS TENTER D'AJUSTER NI RÉPARER LA SCIE PENDANT QU'ELLE EST EN MARCHÉ. S'ASSURER QUE LA SCIE EST COMPLETEMENT ARRÊTÉE AVANT DE LA TOUCHER.</p> <p>18. NE PAS TENTER D'AJUSTER NI RÉPARER LA SCIE PENDANT QU'ELLE EST EN MARCHÉ. S'ASSURER QUE LA SCIE EST COMPLETEMENT ARRÊTÉE AVANT DE LA TOUCHER.</p> <p>19. NE PAS TENTER D'AJUSTER NI RÉPARER LA SCIE PENDANT QU'ELLE EST EN MARCHÉ. S'ASSURER QUE LA SCIE EST COMPLETEMENT ARRÊTÉE AVANT DE LA TOUCHER.</p> <p>20. NE PAS TENTER D'AJUSTER NI RÉPARER LA SCIE PENDANT QU'ELLE EST EN MARCHÉ. S'ASSURER QUE LA SCIE EST COMPLETEMENT ARRÊTÉE AVANT DE LA TOUCHER.</p>	<p>1. LEER LAS INSTRUCCIONES.</p> <p>2. NO OPERAR SI NO HA LEÍDO LAS INSTRUCCIONES CUIDADOSAMENTE.</p> <p>3. SIEMPRE USAR OJOS PROTECTORES Y ASEGURARSE DE QUE LA LAMA EST COMPLETAMENTE DETENIDA ANTES DE TOCARLA.</p> <p>4. NUNCA INTENTAR AJUSTAR NI REPARAR LA SIERRA MIENTRAS ESTE EN USO. ASEGURARSE DE QUE LA SIERRA ESTE COMPLETAMENTE DETENIDA ANTES DE TOCARLA.</p> <p>5. SIEMPRE USAR SUS GAFAS DE PROTECCIÓN Y PROTECTORES DE OÍDOS.</p> <p>6. MANTENER LAS MANOS FUERA DE LA LAMA Y SIEMPRE USAR OJOS PROTECTORES Y PROTECTORES DE OÍDOS.</p> <p>7. NUNCA INTENTAR AJUSTAR NI REPARAR LA SIERRA MIENTRAS ESTE EN USO. ASEGURARSE DE QUE LA SIERRA ESTE COMPLETAMENTE DETENIDA ANTES DE TOCARLA.</p> <p>8. NUNCA INTENTAR AJUSTAR NI REPARAR LA SIERRA MIENTRAS ESTE EN USO. ASEGURARSE DE QUE LA SIERRA ESTE COMPLETAMENTE DETENIDA ANTES DE TOCARLA.</p> <p>9. NUNCA INTENTAR AJUSTAR NI REPARAR LA SIERRA MIENTRAS ESTE EN USO. ASEGURARSE DE QUE LA SIERRA ESTE COMPLETAMENTE DETENIDA ANTES DE TOCARLA.</p> <p>10. NUNCA INTENTAR AJUSTAR NI REPARAR LA SIERRA MIENTRAS ESTE EN USO. ASEGURARSE DE QUE LA SIERRA ESTE COMPLETAMENTE DETENIDA ANTES DE TOCARLA.</p> <p>11. NUNCA INTENTAR AJUSTAR NI REPARAR LA SIERRA MIENTRAS ESTE EN USO. ASEGURARSE DE QUE LA SIERRA ESTE COMPLETAMENTE DETENIDA ANTES DE TOCARLA.</p> <p>12. NUNCA INTENTAR AJUSTAR NI REPARAR LA SIERRA MIENTRAS ESTE EN USO. ASEGURARSE DE QUE LA SIERRA ESTE COMPLETAMENTE DETENIDA ANTES DE TOCARLA.</p> <p>13. NUNCA INTENTAR AJUSTAR NI REPARAR LA SIERRA MIENTRAS ESTE EN USO. ASEGURARSE DE QUE LA SIERRA ESTE COMPLETAMENTE DETENIDA ANTES DE TOCARLA.</p> <p>14. NUNCA INTENTAR AJUSTAR NI REPARAR LA SIERRA MIENTRAS ESTE EN USO. ASEGURARSE DE QUE LA SIERRA ESTE COMPLETAMENTE DETENIDA ANTES DE TOCARLA.</p> <p>15. NUNCA INTENTAR AJUSTAR NI REPARAR LA SIERRA MIENTRAS ESTE EN USO. ASEGURARSE DE QUE LA SIERRA ESTE COMPLETAMENTE DETENIDA ANTES DE TOCARLA.</p> <p>16. NUNCA INTENTAR AJUSTAR NI REPARAR LA SIERRA MIENTRAS ESTE EN USO. ASEGURARSE DE QUE LA SIERRA ESTE COMPLETAMENTE DETENIDA ANTES DE TOCARLA.</p> <p>17. NUNCA INTENTAR AJUSTAR NI REPARAR LA SIERRA MIENTRAS ESTE EN USO. ASEGURARSE DE QUE LA SIERRA ESTE COMPLETAMENTE DETENIDA ANTES DE TOCARLA.</p> <p>18. NUNCA INTENTAR AJUSTAR NI REPARAR LA SIERRA MIENTRAS ESTE EN USO. ASEGURARSE DE QUE LA SIERRA ESTE COMPLETAMENTE DETENIDA ANTES DE TOCARLA.</p> <p>19. NUNCA INTENTAR AJUSTAR NI REPARAR LA SIERRA MIENTRAS ESTE EN USO. ASEGURARSE DE QUE LA SIERRA ESTE COMPLETAMENTE DETENIDA ANTES DE TOCARLA.</p> <p>20. NUNCA INTENTAR AJUSTAR NI REPARAR LA SIERRA MIENTRAS ESTE EN USO. ASEGURARSE DE QUE LA SIERRA ESTE COMPLETAMENTE DETENIDA ANTES DE TOCARLA.</p>

MAINTENANCE

GENERAL MAINTENANCE

⚠ WARNING

For your own safety, turn the switch OFF and remove the plug from power source before maintaining, cleaning, adjusting or lubricating your band saw.

⚠ WARNING

To avoid fire or toxic reaction, never use gasoline, naphtha, acetone, lacquer thinner or similar highly volatile solvents to clean the band saw.

⚠ WARNING

To avoid eye injury from blowing debris, wear safety goggles when blowing out sawdust.

MAINTENANCE

Use only mild soap and damp cloth to clean the tool. Never let any liquid get inside the tool; never immerse any part of the tool into a liquid.

BAND SAW

Sawdust will accumulate under the table and base. This could cause difficulty in the movement of the table when setting up a band saw cut. Frequently blow out or vacuum up the sawdust. Keep your band saw clean. Remove the sawdust from the inside. Vacuum or blow out frequently.

Do not allow debris to build up on the table, the guides or the support bearings. Clean them with gum and pitch remover.

NOTE: Do not immerse the support bearings in the gum and pitch remover.

Apply a thin coat of paste wax on the table so that the wood slides easily while cutting.

BLADE WHEEL TIRES

Pitch and sawdust that build up on the tires should be removed with a stiff brush or scraped off with a piece of wood.

NOTE: To avoid damaging the tires do not use a sharp knife or any kind of solvent.

When the tires are worn, they should be replaced. When replacing the tires, stretch them around the wheels but do not glue them on.

MOTOR

Frequently blow or vacuum out any sawdust from the motor. Follow lubrication instruction on the motor label.

⚠ WARNING

To avoid electrocution or fire, immediately replace a worn, cut or damaged power cord.

ADJUSTING THE UPPER BLADE GUIDE TRAVEL (FIG. S)

If the upper blade guide assembly is not move up and down easily or falls when the lock knob is loosened, the following adjustment should be performed.

1. Loosen the upper blade guide lock knob (1) by turning it counterclockwise.
2. Using a Phillips screwdriver, tighten or loosen the two screws (2) located beside the lock knob (1) to adjust the blade guide travel.
3. Move the blade guide assembly (3) up and down to check for smooth movement and ability to hold in position.
4. Make further adjustments to the two screws if required. When blade guide is properly adjusted, it should move smoothly and able to hold in position when released.
5. Tighten the upper blade guide lock knob (1) by turning clockwise.

Fig. S

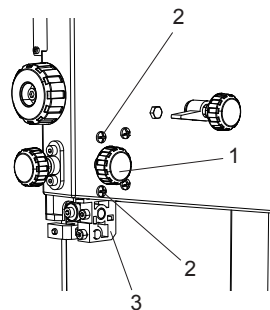

LUBRICATION

All of the bearings are packed with grease at the factory. They require no further lubrication.

⚠ CAUTION

Never put lubricant on the blade while it is spinning.

TROUBLESHOOTING GUIDE

WARNING

To avoid injury from an accidental start, turn the switch OFF and always remove the plug from the power source before making any adjustments.

REPLACEMENT PARTS

Use only identical replacement parts. For a parts list or to order parts, visit our service website at www.portercable.com. You can also order parts from your nearest Porter-Cable Factory Service Center or Porter-Cable Authorized Warranty Service Center. Or, you can call our Customer Care Center at (888) 609-9779.

SERVICE AND REPAIRS

All quality tools will eventually require servicing and/or replacement of parts. For information about Porter-Cable, its factory service centers or authorized warranty service centers, visit our website at www.portercable.com or call our Customer Care Center at (888) 609-9779. All repairs made by our service centers are fully guaranteed against defective material and workmanship. We cannot guarantee repairs made or attempted by others.

You can also write to us for information at Power Tool Specialists, Inc. 684 Huey Road, Rock Hill, SC 29730, (888) 609-9779 - Attention: Product Service. Be sure to include all of the information shown on the nameplate of your tool (model number, type, serial number, etc.).

PLEASE READ THE FOLLOWING: The manufacturer and/or distributor is providing the buyer with a parts list and assembly diagram in this manual as a reference tool only. Neither the manufacturer nor distributor make any representation or warranty of any kind to the buyer regarding the accuracy of the list or diagram or that buyer is qualified and able to make any repairs or replace any parts of the product. The manufacturer and/or distributor expressly recommend: that all repairs and/or part replacements only be undertaken by a certified and licensed technician, and not by the buyer. The buyer assumes all risk and liability, including injuries to persons and damage to property, associated with and arising out of any attempt of the buyer at repairs or replacement of parts to the product.

GENERAL

PROBLEM	PROBLEM CAUSE	SUGGESTED CORRECTIVE ACTION
Blade does not run in the center of upper wheel.	<ol style="list-style-type: none"> 1. Not tracking properly. 2. Defective blade. 	<ol style="list-style-type: none"> 1. Adjust tracking. See ASSEMBLY AND ADJUSTMENTS section - "BLADE TRACKING." 2. Replace blade.
Band saw slows down when cutting.	<ol style="list-style-type: none"> 1. Belt too loose. 2. Cutting too small a radius. 3. Dull blade. 4. Overloading motor. 	<ol style="list-style-type: none"> 1. Adjust belt tension. See ASSEMBLY AND ADJUSTMENTS section - "BLADE TENSION." 2. Stop feeding, back up the material slightly, until band saw speeds up. 3. Replace blade. 4. Slow down, trying to cut too fast. See "MOTOR TROUBLESHOOTING GUIDE."
Blades breaking.	<ol style="list-style-type: none"> 1. Too much tension on the blade. 2. Kink in the blade caused by cutting too small a radius or turning the material too fast when cutting. 	<ol style="list-style-type: none"> 1. Adjust belt tension. See ASSEMBLY AND ADJUSTMENTS section - "BLADE TENSION." 2. Use correct cutting technique. See OPERATION section section "GENERAL CUTTING."
Blade dulls too quickly.	<ol style="list-style-type: none"> 1. Blade guides set too close to the teeth. 2. Cutting incorrect material. 	<ol style="list-style-type: none"> 1. Adjust upper and lower blade guides. 2. See OPERATION section - "BLADE SECTION."
Band saw vibrates.	<ol style="list-style-type: none"> 1. Too much tension on motor belt. 	<ol style="list-style-type: none"> 1. Adjust tracking. See ASSEMBLY AND ADJUSTMENTS section - "DRIVE BELT TENSION."

MOTOR

PROBLEM	PROBLEM CAUSE	SUGGESTED CORRECTIVE ACTION
Noisy operation.	<ol style="list-style-type: none"> 1. Incorrect belt tension. 2. Loose motor pulley. 3. Loose pulley cover. 	<ol style="list-style-type: none"> 1. Adjust tension. See ASSEMBLY AND ADJUSTMENTS section - "DRIVE BELT TENSION." 2. Readjust and tighten motor pulley set screw. 3. Readjust and tighten pulley cover mounting screws.
Motor will not start.	<ol style="list-style-type: none"> 1. Not plugged into power outlet. 2. Switch and key not in ON position. 3. Motor cord cut or abraded. 4. Plug on cord is faulty. 5. Fuse on circuit breaks open. 6. Faulty motor. 	<ol style="list-style-type: none"> 1. Plug it into the power outlet. 2. Insert key and turn the switch ON. 3. Re-set; may be too many machines on line. 4. Contact Porter-Cable Service Center or Authorized Service Station for repair or replacement.
Motor will not start and fuse or circuit breaker opens.	<ol style="list-style-type: none"> 1. Too many electrical machines. 2. Incorrect fuse. 3. Wheels do not rotate. 4. Undersized extension cord. 5. Short circuit. 	<ol style="list-style-type: none"> 1. Turn off other machines and try again. 2. Try time delay fuse, or go to circuit with higher rated fuse or circuit breaker. 3. Unplug and turn wheels by hand, move obstruction. 4. Use correct size extension cord, see page 7. 5. Cord, plug, or motor need repair. Contact Porter-Cable Service Center or Authorized Service Station for repair.
Motor fails to develop full power.	<ol style="list-style-type: none"> 1. Low line voltage. 2. Faulty motor or capacitor. 	<ol style="list-style-type: none"> 1. Check power line for proper voltage. 2. Contact Porter-Cable Service Center or Authorized Service Station for repair.
Motor overheats.	<ol style="list-style-type: none"> 1. Overload on motor. 2. Poor ventilation of motor. 3. Capacitor failure. 	<ol style="list-style-type: none"> 1. Reduce load to motor, feed work slower into blade. 2. Unplug and clean out around motor. Provide better air circulation. 3. Contact Porter-Cable Service Center or Authorized Service Station for repair.
Motor stalls or slows.	<ol style="list-style-type: none"> 1. Motor overload. 2. Low line voltage. 3. Loose wire connections. 4. Faulty motor. 	<ol style="list-style-type: none"> 1. Reduce load to motor, feed work slower into blade. 2. Check power line for proper voltage. 3. Contact Porter-Cable Service Center or Authorized Service Station for repair.
Frequent fuse or circuit breaker failure.	<ol style="list-style-type: none"> 1. Motor overload. 2. Overload of electrical circuit. 3. Incorrect fuse or circuit breaker. 	<ol style="list-style-type: none"> 1. Reduce load to motor, feed work slower into blade. 2. Too many electrical appliances on same circuit. 3. Have electrician upgrade service to outlet.

For assistance with your product, visit our website at www.portercable.com for a list of service centers, or call the Porter-Cable Customer Care Center at (888) 609-9779.

ACCESSORIES AND ATTACHMENTS

ACCESSORIES

WARNING

Since accessories, other than those offered by Porter-Cable, have not been tested with this product, use of such accessories with this tool could be hazardous. To reduce the risk of injury, only Porter-Cable recommended accessories should be used with this product.

A complete line of accessories is available from your Porter-Cable Factory Service Center or a Porter-Cable Authorized Warranty Service Center. Please visit our Web Site www.portercable.com for a catalog or for the name of your nearest supplier.

WARNING

Do not use any accessory unless you have completely read the Instruction Manual for that accessory.

PARTS LIST

9 IN. (228 MM) BAND SAW

PARTS LIST FOR BAND SAW

ID	Description	Size	Q'ty	ID	Description	Size	Q'ty
X7HW	Hex screw	M4*8	4	X7DC	Blade wheel adjusting knob		1
X7HV	Spring washer	5	3	X7DB	6P4 clip		2
X7HU	Philips screw	M5*16	3	X7DA	Power cord		1
X7HT	Spring washer	8	1	X7D9	Hex screw	M8*25	2
X7F7	Lower door		1	X7D8	Flat washer		2
X7F6	Hex screw	M6*10	2	X7D7	Motor		1
X7F5	Spring washer		3	X7D6	Locking knob		1
X7F4	Nut		4	X7D5	Eccentric locking knob		2
X7F3	Philips screw	M4*10	6	X7D4	Flat washer		2
X7F2	Blade tracking window		1	X7D3	Hex screw	M6*25	2
X7F1	Upper door		1	X7D2	Adjusting gear		1
X7F0	Blade		1	X7D1	Adjusting handle base		1
X7EZ	Circlip for shaft		2	X7D0	Adjusting handle		1
X7EY	Ball bearing		4	X7CZ	Dust port		1
X7EX	Internal circlip	φ26	4	X7CY	Hex bolt	M6*20	4
X7EV	Tire		2	X7CX	Hex nut		5
X7EU	Idler pulley		1	X7CW	Shaft		1
X7ET	Carriage bolt	M8*70	1	X7CV	Locking spring		2
X7ES	Brush		1	X7CU	Gear handle		1
X7EQ	Upper wheel shaft		1	X7CT	Scale pointer		1
X7EP	Upper wheel shaft base		1	X7CS	Hex bolt	M6*25	1
X7EN	Washer		2	X7CR	Table insert		1
X7EM	Connection shaft		1	X7CQ	Work table		1
X7EL	Blade wheel		2	X7CP	Table locking knob		1
X7EK	U type support		1	X7CN	Guide block		2
X7EJ	Carriage bolt	M8*85	1	X7CM	Angle support		1
X7EH	Hex nut		2	X7CL	Hex bolt	M6*12	4
X7EG	Switch		1	X7CK	Hex screw	M6*16	2
X7EF	Switch plate		1	X7CJ	Wing nut		1
X7EE	Locking pad		1	X7CH	Flat washer		2
X7ED	Guide base		1	X7CG	Slide bar		1
X7EC	Philips screw	M5*10	7	X7CF	Miter gauge knob		1
X7EB	Guide plate		1	X7CE	Miter gauge		1
X7EA	Plate spring		1	X7CD	Pan head screw with flat & spring washer	M5*8	1
X7E9	Philips screw	ST3.9*10	1	X7CC	Miter gauge pointer		1
X7E8	Slide board		1	X7CB	Lower support shaft		1
X7E7	Upper guide slide bar		1	X7CA	Lower blade guide support		1
X7E6	Hex screw	M4*4	1	X7C9	Spring washer		4
X7E5	Pin		4	X7C8	Capacitor		1
X7E4	Upper blade guide support		1	X7C7	Philips screw+flat washer	M4*6	2
X7E3	Upper support shaft		1	X7C6	Capacitor box		1
X7E2	Flat washer		4	X7C5	Wavy washer	φ6	1
X7E1	Ball bearing		2	X7C4	Lower blade guide support base		1
X7E0	Bearing fastening screw		2	X7C3	Hex bolt	M6*40	1
X7DZ	Hex screw	M5*10	5	X7C2	Open end wrench		1
X7DY	Hex screw	M5*15	2	X7C1	4 mm hex wrench		1
X7DX	Pan head screw with flat & spring washer	M4*8	6	X7C0	2 mm hex wrench		1
X7DW	Belt		1	X7BZ	Warning label		1
X7DV	Hex nut	M12*1.5	1	X7BY	Logo label		1
X7DU	Spring washer		1	X7BX	Motor label		1
X7DT	Lower wheel shaft		1	X7BW	Rotating label		1
X7DS	Hex screw	M5*10	1	X7BV	Instruction manual		1
X7DR	Flat washer		1	X7BS	Upper guide slide bar assembly		1
X7DQ	Driven pulley		1	X7BR	Upper blade guide support		1
X7DP	Guide plate		1	X7BQ	Upper bearing guide assembly		1
X7DN	Hex nut		1	X7BP	Upper door assembly		1
X7DM	Hex screw	M6*8	2	X7BN	Lower door assembly		1
X7DL	Blade lower guard		1	X7BM	Upper blade wheel assembly		1
X7DK	Saw body		1	X7BL	Lower blade wheel assembly		1
X7DJ	Block		1	X7BK	Miter gauge assembly		1
X7DH	Tension spring		1	X7BJ	Lower blade guide support		1
X7DG	Tension handle		1	X7BH	Lower bearing guide assembly		1
X7DF	Flat washer		3	X7BG	Work table assembly		1
X7DE	Hex nut		1	X7BF	Motor assembly		1
X7DD	Wing locking nut		1	X4CC	Miter gauge scale label		1

9 IN. (228 MM) BAND SAW
SCHEMATIC FOR BAND SAW

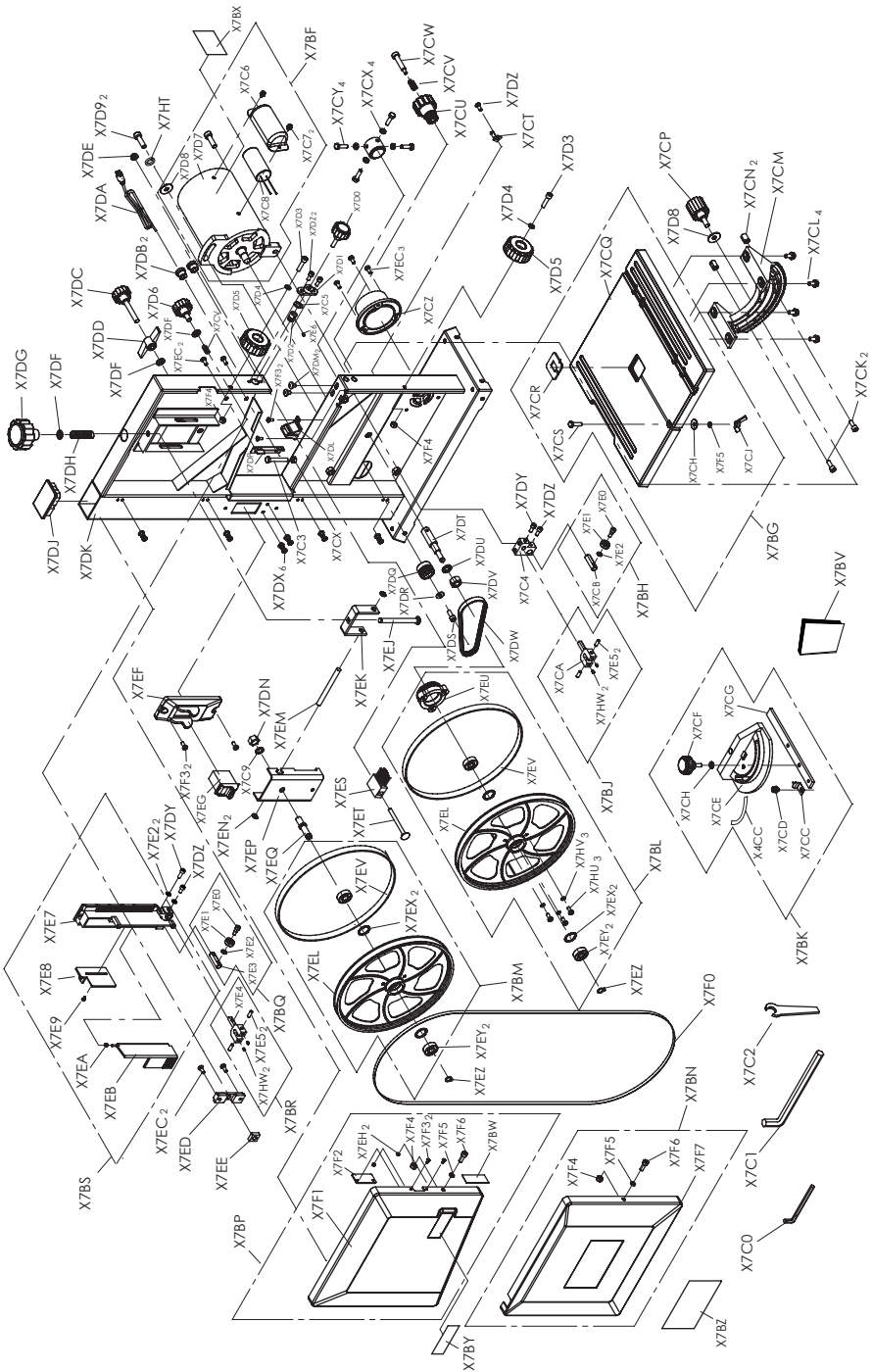

NOTES

WARRANTY

THREE YEAR LIMITED WARRANTY

PORTER-CABLE will repair, without charge, any defects due to faulty materials or workmanship for three years from the date of purchase. This warranty does not cover part failure due to normal wear or tool abuse. For further detail of warranty coverage and warranty repair information, visit www.portercable.com or call (888) 609-9779. This warranty does not apply to accessories or damage caused where repairs have been made or attempted by others. This warranty gives you specific legal rights and you may have other rights which vary in certain states or provinces.

In addition to the warranty, PORTER-CABLE tools are covered by our:

1 YEAR FREE SERVICE: PORTER-CABLE will maintain the tool and replace worn parts caused by normal use, for free, any time during the first year after purchase.

90 DAYS MONEY BACK GUARANTEE: If you are not completely satisfied with the performance of your PORTER-CABLE Power Tool for any reason, you can return it within 90 days from the date of purchase with a receipt for a full refund – no questions asked.

LATIN AMERICA: This warranty does not apply to products sold in Latin America. For products sold in Latin America, see country specific warranty information contained in the packaging, call the local company or see website for warranty information.

To register your tool for warranty service visit our website at www.portercable.com.

WARNING LABEL REPLACEMENT

If your warning labels become illegible or are missing, call (888) 609-9779 for a free replacement.

The following are PORTER-CABLE trademarks for one or more power tools and accessories: a gray and black color scheme; a "four point star" design; and three contrasting/outlined longitudinal stripes. The following are also trademarks for one or more Porter-Cable and Delta products: 2 BY 4[®], 890[™], Air America[®], AIRBOSS[™], Auto-Set[®], B.O.S.S.[®], Bammer[®], Biesemeyer[®], Builders Saw[®], Charge Air[®], Charge Air Pro[®], CONTRACTOR SUPERDUTY[®], Contractor's Saw[®], Delta[®], DELTA[®], Delta Industrial[®], DELTA MACHINERY & DESIGN[™], Delta Shopmaster and Design[®], Delta X5[®], Deltacraft[®], DELTAGRAM[®], Do It. Feel it.[®], DUAL LASERLOC AND DESIGN[®], EASY AIR[®], EASY AIR TO GO[™], ENDURADIAMOND[®], Ex-Cell[®], Front Bevel Lock[®], Get Yours While the Sun Shines[®], Grip to Fit[®], GRIPVAC[™], GTF[®], HICKORY WOODWORKING[®], Homecraft[®], HP FRAMER HIGH PRESSURE[®], IMPACT SERIES[™], Innovation That Works[®], Jet-Lock[®], Job Boss[®], Kickstand[®], LASERLOC[®], LONG-LASTING WORK LIFE[®], MAX FORCE[™], MAX LIFE[®], Micro-Set[®], Midi-Lathe[®], Monsoon[®], MONSTER-CARBIDE[™], Network[®], OLDHAM[®], Omnijig[®], PC EDGE[®], Performance Crew[™], Performance Gear[®], Pocket Cutter[®], Porta-Band[®], Porta-Plane[®], Porter-Cable[®], Porter-Cable Professional Power Tools[®], Powerback[®], POZI-STOP[™], Pressure Wave[®], PRO 4000[®], Proair[®], Quicksand and Design[®], Quickset II[®], QUIET DRIVE TECHNOLOGY[™], QUIET DRIVE TECHNOLOGY AND DESIGN[™], Quick-Change[®], QUIK-TILT[®], RAPID-RELEASE[™], RAZOR[®], Redefining Performance[®], Riptide[®], Safe Guard II[®], Sand Trap and Design[®], Sanding Center[®], Saw Boss[®], Shop Boss[®], Sidekick[®], Site Boss[®], Speed-Bloc[®], Speedmatic[®], Stair Ease[®], Steel Driver Series[®], SUPERDUTY[®], T4 & DESIGN[®], THE AMERICAN WOODSHOP[®], THE PROFESSIONAL EDGE[®], Thin-Line[®], Tiger Saw[®], TIGERCLAW[®], TIGERCLAW AND DESIGN[®], Torq-Buster[®], TRU-MATCH[®], T-Square[®], Twinlaser[®], Unifence[®], Uniguard[®], UNIRIP[®], UNISAW[®], UNITED STATES SAW[®], Veri-Set[®], Versa-Feeder[®], VIPER[®], VT[™], VT RAZOR[™], Water Driver[®], WATER VROOM[®], Waveform[®], Whisper Series[®], X5[®], YOUR ACHIEVEMENT. OUR TOOLS.[®], Trademarks noted with ® are registered in the United States Patent and Trademark Office and may also be registered in other countries. Other trademarks may apply.

PORTER-CABLE and the PORTER-CABLE logo are registered trademarks of PORTER-CABLE and are used under license. All rights reserved.

PORTER CABLE.

Power Tool Specialists, Inc.
684 Huey Road, Rock Hill, SC 29730
(888) 609-9779
www.portercable.com