

ULTRACOOL[®]



CP35 PORTABLE EVAPORATIVE COOLER USE & CARE GUIDE



Read and Save These Instructions

If you have any problems with this product, please call 1-800-643-8341 BEFORE returning it to your retailer.

NOTICE: This Product May Temporarily Produce An Odor When First Turned On. This is NORMAL and will dissipate after a few hours.

ABOUT EVAPORATIVE COOLING

Evaporative cooling is an economical way to cool and is highly effective in arid climates. Air is cooled while being drawn across wet evaporative media. The movement of this fresh cooled air over the skin is what makes it feel cool.

In order for evaporative coolers to be effective in an enclosed area, a fresh air source and adequate exhaust need to be present. These coolers will not work well without an outlet to exhaust the hot air. Humidity will build up in the enclosed space and the unit will not cool adequately.

THIS IS NOT AN AIR CONDITIONER

For evaporative coolers to work effectively, there must be an outside air inlet and at least one air outlet (window or door) in each room to be cooled.



DOOR OPEN APPROX. 6"

NOTE: These coolers WILL NOT work in a Closed Room

SAFETY RULES

1. Unit must be in the Off Position and Unplugged from power receptacle when performing any maintenance.
2. To reduce the risk of electric shock, plug unit into a properly grounded 120 Volt A.C., 60 Hz receptacle.
3. To reduce the risk of electric shock, install only on a circuit protected with a Ground Fault Circuit Interrupter (GFCI).
4. This appliance is not intended for use by persons (including children) with reduced physical, sensory or mental capabilities, or lack of experience and knowledge, unless they have been given supervision or instruction concerning use of the appliance by a person responsible for their safety. Children should be supervised to ensure that they do not play with the appliance.
5. Do Not operate any fan with a damaged cord or plug. Discard fan or return to an authorized service facility for examination and/or repair.
6. Do Not run cord under carpeting. Do Not cover cord with throw rugs, runners or similar coverings. Do Not route cord under furniture or appliances. Arrange cord away from traffic area and where it will not be tripped over.

WARNING: To reduce the risk of fire or electric shock, do not use this fan with any "solid-state fan speed control device."

ASSEMBLY

Remove unit from carton, and remove packing material.

Install Casters

This unit comes with 4 stem casters:
2 locking and 2 non-locking.

1. Insert casters into four holes on bottom of unit. The stem should fit snugly into hole.

NOTE Install both locking casters on the same side (front or back) to ensure equal and secure locking.

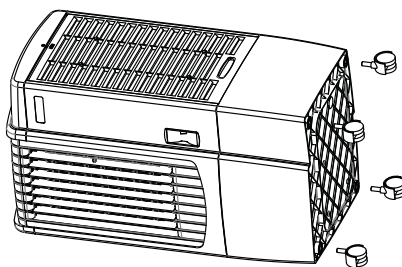

Fill with Water

The reservoir on this unit holds 3.8 gallons.

1. To fill the reservoir, open the water fill door at the back and fill with fresh, clean water using a fill hose or pitcher. **DO NOT OVERFILL.**

CAUTION: If moving the unit for filling, make sure the casters are unlocked for easy mobility. Do not tip unit.

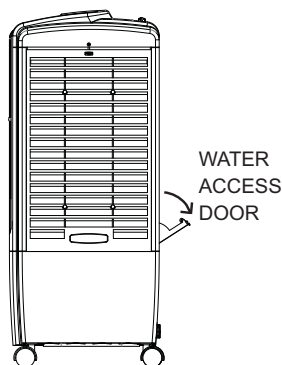

2. A gauge on the front of the unit shows the water level. When the reservoir is full, the window will show a full blue fill. When the reservoir is low, an indication of LOW WATER will appear in the window. Observe this gauge to monitor the water level.

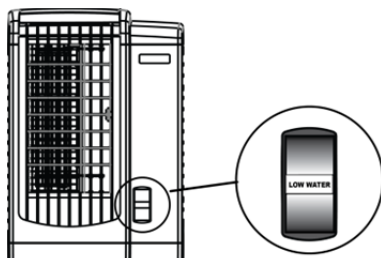

OPERATIONS

ALL ICONS SHOWN FOR REFERENCE

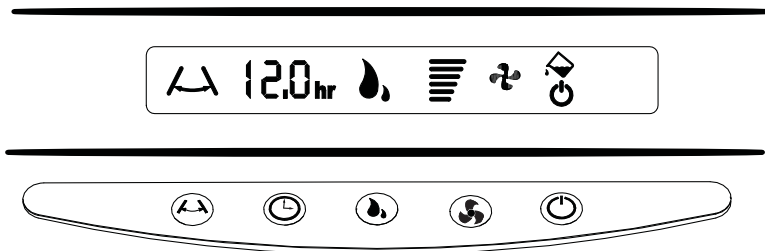

Operating Instructions

When first plugged in the control panel will momentarily light up and unit will beep. The unit is in Standby mode, and the Power button will stay illuminated in red.

With the unit filled and plugged in, press the Power button and it will change from Red to Blue.

NOTE: For best cooling, we recommend turning on the pump 2 or 3 minutes before turning on the fan. This allows the media to become saturated for faster cooling effect.

NOTE: This unit can be used as a fan only or an evaporative cooler. If no evaporative cooling is desired, simply do not engage the pump and use only the fan feature.

For Evaporative Cooling:

With the unit already filled and turned on:

1. Press the PUMP button. This will activate the pump to begin saturating the media. The two Droplet icons will alternately flash.
2. Press the SPEED button to engage the fan. The 3-speed fan starts in High and can be adjusted down by pressing the SPEED button again. The FAN display shows 6 bars for High, 4 bars for Medium and 2 bars for Low.

For Fan Only Operation:

With unit turned on:

1. Press the SPEED button. The fan proceeds from High speed to Medium to Low speed.
2. The FAN icon will be progress from 6 bars (high speed) to four bars (medium. speed) to 2 bars (low speed). It will cycle in this order when pressed.

Additional Features:

Oscillate Feature:

1. When the OSCILLATE button is pressed the vertical louvers on the front grill move left and right.
2. The OSCILLATE icon on the display will illuminate with activation of this feature.
3. This feature is available anytime the FAN function is turned on.

Timer Feature:

1. This unit has a timer feature that allows setting the duration of operation from half an hour to 12 hours, in 30 minute increments.
2. To set the timer, press TIMER and keep pressing until the desired amount is displayed in the TIMER section of the display.
3. Once the desired time is displayed, release the button. After 5 seconds the time is confirmed.
4. When the set time is on the last half hour, the time will count down in tenths until it reaches 0.0 and the unit will go into standby mode (all icons off, except the POWER button which illuminates red.)
5. Once the desired time is displayed, release the button. After 5 seconds the time is confirmed.
6. To cancel (after confirmation) press the TIMER button again.

NOTE: If continuous operation is desired Press TIMER and set at 0.0. The fan will run continuously. The pump will not operate if there is no water in the unit.

Low Water Indication:

1. When the water tank has been depleted to a certain level, a red LOW WATER icon will display on the Control Panel. The pump will stop operating and an audible beeping will sound for 60 seconds or until the PUMP button is pressed.
2. If unit is filled within 60 seconds of the beeping, the pump will start again automatically. Otherwise refill and press PUMP again.
3. Fill the water tank to reset the LOW WATER indications.

Remote Control:

The CP35 unit comes with a remote control that allows operation of the of the cooler from a distance.

1. Extract the remote control from the bag the manual came in and open the case. Unwrap the two AAA batteries included in the bag. Insert them into the remote.
2. Point the remote at the control panel. The controls on the remote will function the same as the control on the unit.
3. The remote is effective up to approximately 30 feet, but must be in line of vision. The sensor is located in the upper right hand corner of the control screen.

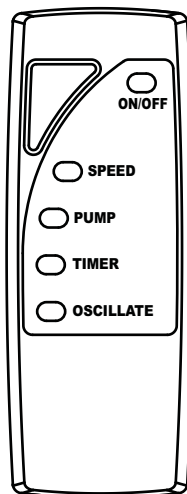

MAINTENANCE:

CAUTION: Turn off and unplug unit from power before any maintenance is performed.

GENERAL INFORMATION:

The cellulous media used in these portable evaporative coolers must be kept in good condition to maintain the stated cooling capabilities. We recommend draining the unit weekly and refilling to keep water fresh and reduce mineral build-up on media.

Weekly Draining

(Accomplish when water level is low or unit is out of water.)

1. Turn unit off. Unplug and move it to an area that will not be damaged by water.
2. Unscrew the drain cap from the bottom of the back of the unit. Allow any remaining water to drain out of unit.
3. When cleaning the media pad, try to preserve the integrity of the fluted surface.
4. Reinstall drain cap and refill with fresh water. Plug in and operate per instructions.

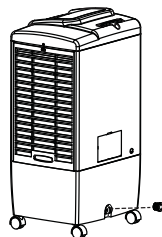

Regular Servicing:

(Accomplish at least twice a season, more often in areas with hard water.)

1. Remove media frame section by extracting one screw from center of upper grate.
2. Using a water hose, wash out back with fresh water. Clean media pad. DO NOT use chemicals or pressure washer on media.
3. Using a screw driver or other tool, pry off the four keeper discs, then push the stems back through the media and extract them through the back. Remove pad.
4. Rinse media with water. Light scrubbing may be necessary. Be careful not to damage the media.

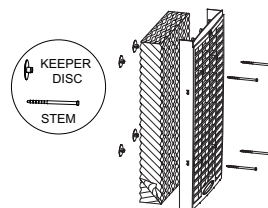
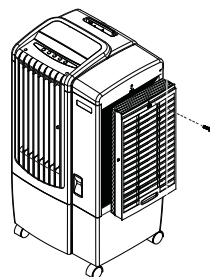

NOTE: Average life expectancy of the rigid media pad is 2 years, though water with high mineral content will deteriorate the integrity of the media sooner.

Pad Replacement

- 1. Remove media frame from unit side by extracting one screw.
- 2. Remove and dispose of used media.
- 3. Install new media pad per instructions noted here.

NOTE: Proper orientation of the media is critical to ensure cooling effectiveness.

- 4. Install the media pad so that the steeper angle of the flute slopes down toward the bottom of the media frame.
- 5. Insert the stems through the four screw holes in the media frame.
- 6. Push stems through the media and fasten media in place with the four keepers. Take care not to damage the media.
- 7. Reinstall media frame onto the body using one screw.

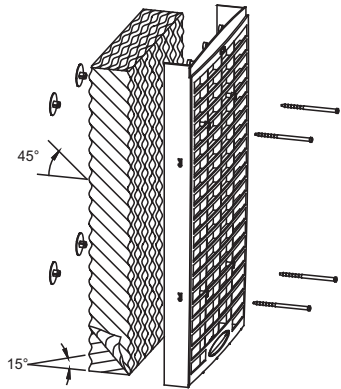

End of Season Servicing

- 1. Accomplish Regular Servicing procedures. Ensure unit is fully drained of water.
- 2. Carefully inspect media to verify media is not crushed, broken and clogged or heavily encrusted with minerals. If so, dispose and replace media pad.
- 3. Clean interior with clean water. Wipe down outside with clean damp cloth.
- 4. Store in safe, dry place. Do not store with water in reservoir.

TROUBLE SHOOTING :

PROBLEM	PROBABLE CAUSE	REMEDY
Pump is not working	Unit may be out of water	Fill reservoir with water and activate pump.
	Pump may be defective	Replace pump
Fan not operating	No power supplied.	Verify unit is plugged into a 120V power outlet and turned on. Check fuse or breaker. If connected to GFCI outlet, check if tripped and reset.
Unit is not cooling as well as previously	Insufficient air flow (input and exhaust.)	Ensure windows/doors are open for correct air flow.
	Clogged or dirty media	Check media pad and wash or replace as necessary.

CP35 Replacement Parts

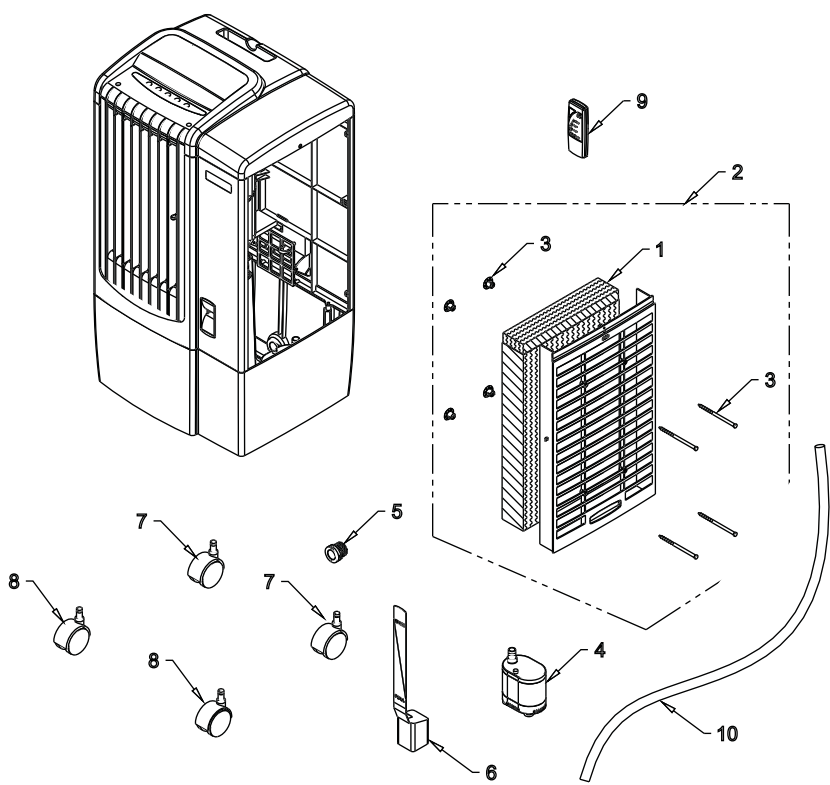

Item Number	Description	Part Number
1	Evaporative media	110132-1
2	Evaporative media frame assembly	110870-11
3	Keepers & Stems (set of 4)	110871
4	Pump	110439-4
5	Drain plug assembly	110698-2
6	Water indicator float	110872-2
7	Swivel casters- Non-locking	110822-8
8	Swivel casters - Locking	110822-9
9	Remote control	110101-2
12	Water distributor tubing	110734-1

To purchase parts call 1.800 643.8341, or visit XXXXXXXXXX.com

COOLER LIMITED WARRANTY POLICY

SALES RECEIPT REQUIRED AS PROOF OF PURCHASE FOR ALL WARRANTY CLAIMS.

This warranty is extended to the original purchaser of an evaporative cooler installed and used under normal conditions. It does not cover damages incurred through accident, neglect, or abuse by the owner. We do not authorize any person or representative to assume for us any other or different liability in connection with this product.

Terms and Conditions of the Warranty

For One Year from date of purchase, we will replace any original component provided by Champion Cooler which fails due to any defect in material or factory workmanship only.

Exclusions from the Warranty

We are not responsible for replacement of evaporative media. These are disposable components and should be replaced periodically. We are not responsible for any incidental or consequential damage resulting from any malfunction.

We are not responsible for any damage received from the use of water softeners, chemicals, de-scale material or plastic wrap.

We are not responsible for the cost of service calls to diagnose the cause of trouble, or labor charge to repair and/or replace parts.

How to Obtain Service Under this Warranty

Contact the Dealer where you purchased the evaporative cooler. If for any reason you are not satisfied with the response from the dealer, contact the Customer Service Department: Champion Cooler, 5800 Murray Street, Little Rock, Arkansas 72209. 1-800-643-8341 or at info@championcooler.com

Some states do not allow the exclusion or limitation of incidental or consequential damages, so the above may not apply to you.

This warranty gives you specific legal rights, and you may also have other rights which vary from state to state.

This limited warranty applies to the original purchaser only.

Register your cooler on line at: www.xxxx.xxxxx