



ITEM #0122692, 0159439, 0159490, 0159538, 0159556,
0159568, 0163013, 0166445, 0166614, 0175267,
0177174, 0181543, 0199981, 0210390, 0215039,
0228015, 0238868, 0250714, 0251221 - 0251248.

CORDLESS CELLULAR SHADE

MODEL #70355 - 70404

Français p. 5

Español p. 9

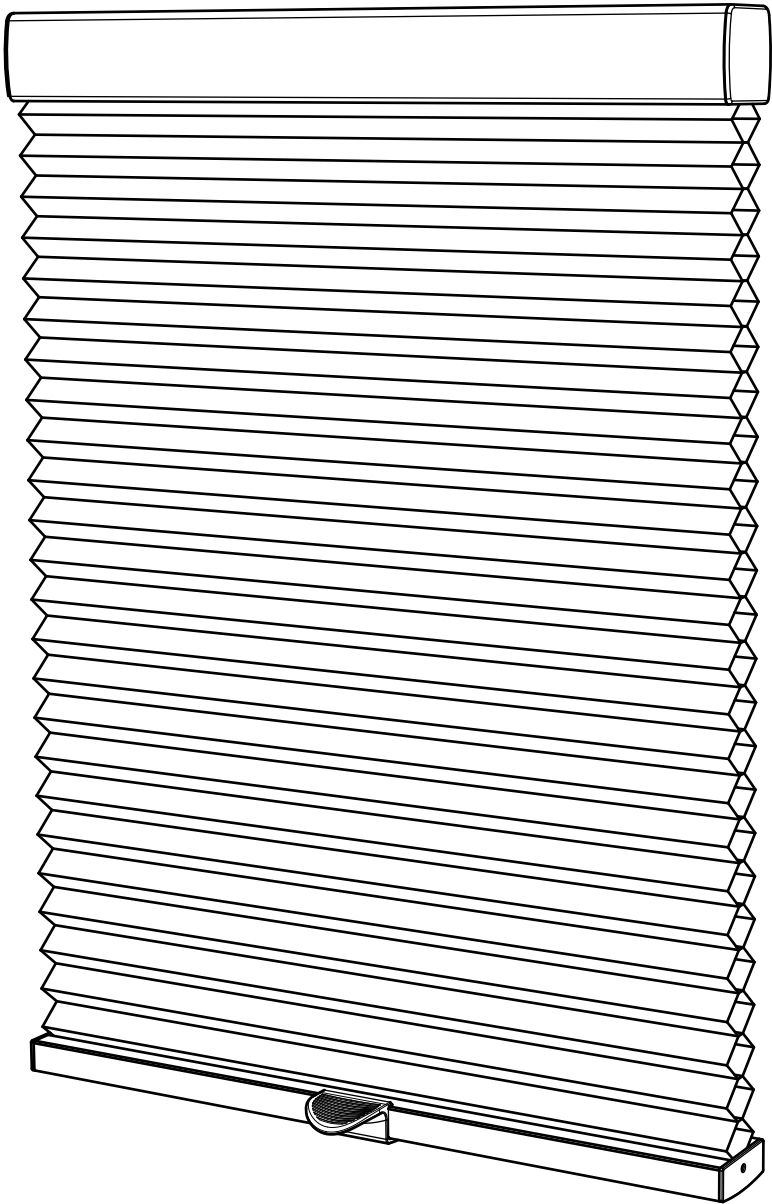

ATTACH YOUR RECEIPT HERE

Serial Number _____ Purchase Date _____



Questions, problems, missing parts? Before returning to your retailer, call our customer service department at 1-866-439-9800, 8 a.m. - 8 p.m., EST, Monday - Friday.

PACKAGE CONTENTS

| PART | DESCRIPTION | QUANTITY |
|------|-------------|----------|
| C | Shade | 1 |

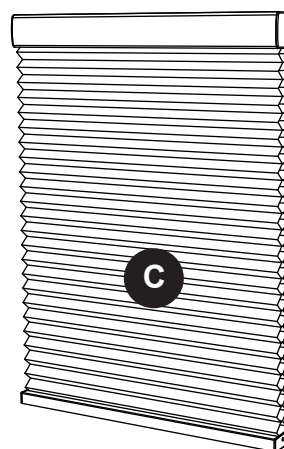

HARDWARE CONTENTS (shown actual size)

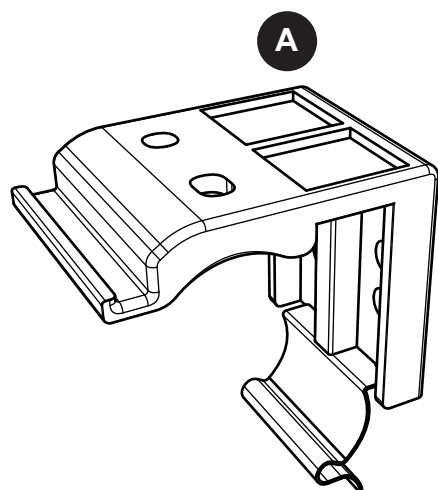

Mounting Bracket
Qty. (23 in. - 36 in.): 2
Qty. (37 in. - 47 in.): 3
Qty. (48 in. - 72 in.): 4

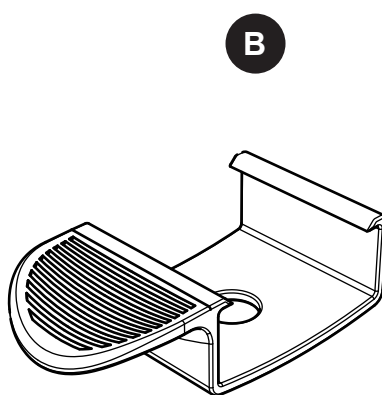

Handle
Qty. 1



Wood Screw
Qty. (23 in. - 36 in.): 4
Qty. (37 in. - 47 in.): 6
Qty. (48 in. - 72 in.): 8

PREPARATION

Before beginning assembly of product, make sure all parts are present. Compare parts with package contents list and hardware contents above. If any part is missing or damaged, do not attempt to assemble the product. Contact customer service for replacement parts.

Estimated Assembly Time: 30 minutes

Tools Required for Assembly (not included): Measuring tape, pencil, drill with 3/32 in. drill bit, Phillips screwdriver, safety glasses and step ladder.

Note: Use #6 plastic anchors (not included) for drywall or plaster mounting. Use 1/4 in. drill bit for these anchors.



Bracket Location and Installation:

The shade may be installed either inside or outside the window frame. A mounting bracket should be positioned on each end of the headrail. Wider shades that require 3 or more brackets should be spaced evenly between the two outermost brackets. Always position the brackets such that there is no interference with cords and mechanisms inside the headrail. The procedure outlined below will assure proper bracket placement.

ASSEMBLY INSTRUCTIONS

- 1a. For outside mounting, clip the mounting brackets (A) onto the headrail of shade. Hold shade (C) level at the height desired and center it over the window opening. Mark the exact location of each mounting bracket (A) with a pencil. Remove the mounting brackets (A) from the headrail of shade. Pre-drill the screw holes and then secure the mounting bracket (A) to the wall or window molding with wood screws (AA).

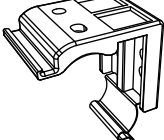

Hardware Used

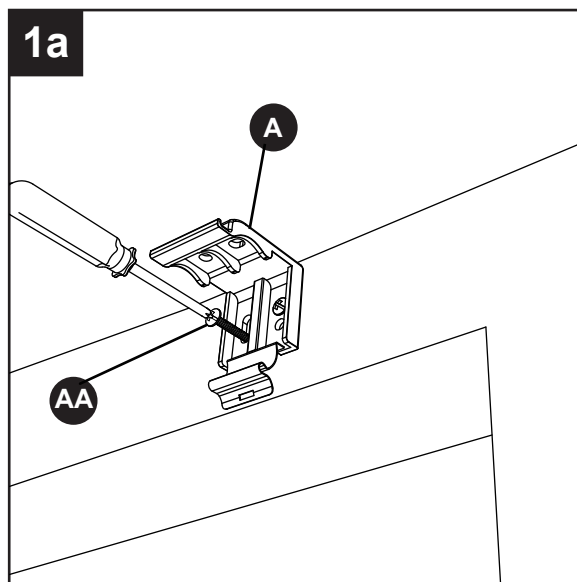
- | | | | |
|-----------|------------------|---|-----|
| A | Mounting Bracket |  | x 2 |
| AA | Wood Screw |  | x 4 |

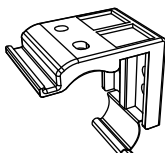

- 1b. For inside mounting, clip the mounting brackets (A) onto the headrail of shade. Hold shade (C) in place and make pencil mark at the rear of each mounting bracket (A). Remove the mounting brackets (A) from the headrail of shade. Pre-drill the screw holes and then secure the mounting bracket (A) to the wall or window molding with wood screws (AA).

Hardware Used

- | | | | |
|-----------|------------------|---|-----|
| A | Mounting Bracket |  | x 2 |
| AA | Wood Screw |  | x 4 |

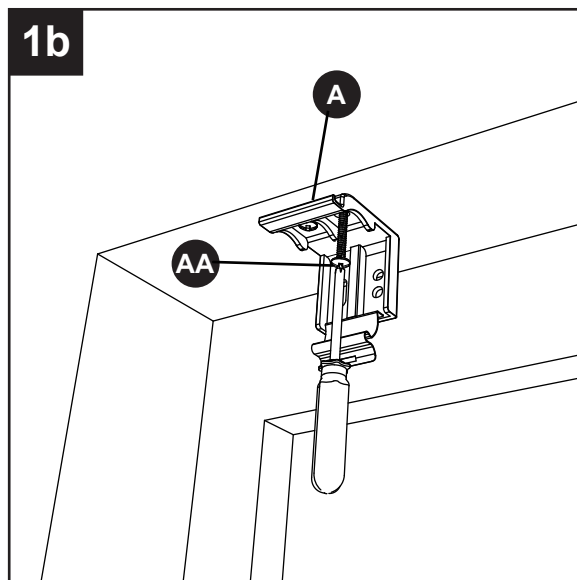

2. Lift the headrail of shade into position such that the inner front edge of the headrail of shade slides into the slot at the front of each mounting bracket (A). Push the headrail of shade upward until the flexible tab at the bottom of each mount bracket (A) snaps onto the back of the headrail of shade. Check carefully to assure that each mounting bracket (A) is properly snapped into place.

Hardware Used

- | | | | |
|----------|------------------|---|---------|
| A | Mounting Bracket |  | x 1 - 2 |
|----------|------------------|---|---------|

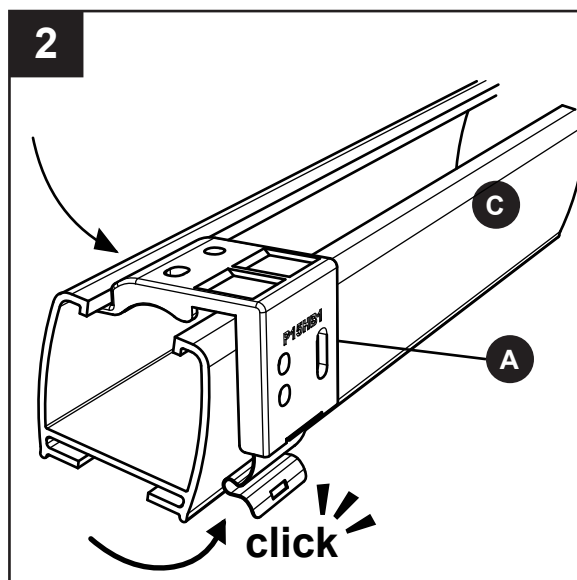

ASSEMBLY INSTRUCTIONS

3. Attach the handle (B) to the center of the bottom rail. Check carefully to assure that the handle (B) is properly snapped into place.

Hardware Used

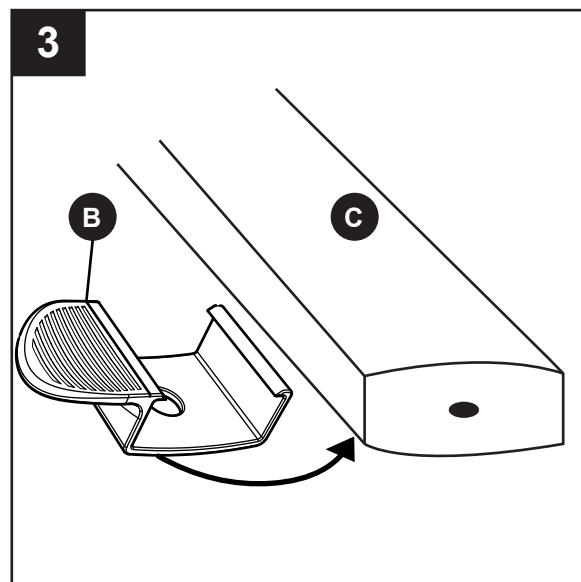
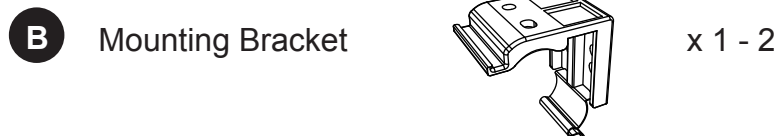

CARE AND MAINTENANCE

The vinyl headrail and bottom rail can be wiped clean with a damp sponge. To clean the shade fabric, use a feather duster or vacuum lightly using the soft brush attachment.

WARRANTY

ONE YEAR LIMITED WARRANTY

For a period of one (1) year from the date of purchase, the manufacturer will replace this window covering with one of equal or superior value, if this window covering is found to be defective in material or workmanship. To obtain warranty service contact our customer service department at 1-866-439-9800. This warranty does not cover damage of defects caused by or resulting from improper maintenance, negligent or improper use, abuse, misuse, neglect, accidents, act of God, alteration, commercial use, installation, removal or reinstallation.

This warranty is restricted to normal consumer use within the United States and Canada.

MANUFACTURER WILL NOT BE LIABLE FOR INCIDENTAL OR CONSEQUENTIAL DAMAGES, SOME STATES DO NOT ALLOW THE EXCLUSION OR LIMITATION OF INCIDENTAL OR CONSEQUENTIAL DAMAGES, SO THE ABOVE LIMITATION OR EXCLUSION MAY NOT APPLY TO YOU.

This warranty gives you specific legal rights, and you may also have other rights which vary from state to state.

REPLACEMENT PARTS LIST

For replacement parts, call our customer service department at 1-866-439-9800, 8 a.m.- 8 p.m., EST, Monday-Friday.

| PART | DESCRIPTION | PART # |
|------|--------------|----------------|
| JJ | Hardware Box | 0CELZ0 00 HW2L |

| PART | DESCRIPTION | QUANTITY |
|---|------------------|----------|
| Hardware Box includes all of the following: | | |
| A | Mounting Bracket | 3 |
| B | Handle | 1 |
| AA | Wood Screw | 6 |

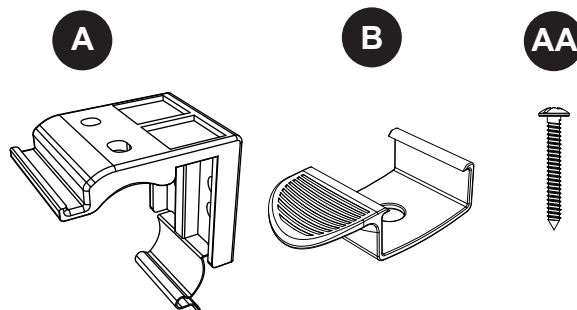

Printed in Tawain