

KITCHEN SINK K-6491

Features

- KOHLER cast iron
- Double (equal) compartment
- Self-rimming
- Acid-resistant enamel finish
- Available with 1-, 2-, or 3- hole
- 33" (83.8 cm) x 22" (55.9 cm)

Codes/Standards Applicable

Specified model meets or exceeds the following:

- ASME A112.19.1M
- IAPMO/UPC
- CSA B45
- CSA International

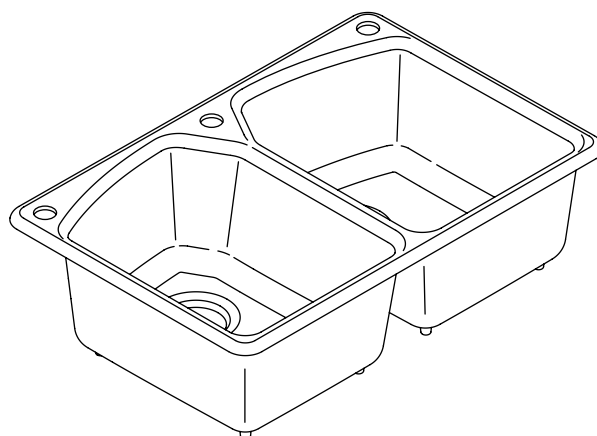

Colors/Finishes

- 0: White
- Other: Refer to Price Book for additional colors/finishes

Accessories:

- ST: Stainless Steel
- CP: Polished Chrome

Specified Model

Model	Description	Colors/Finishes	
K-6491-1	Single-hole self-rimming sink for single-hole faucet	<input type="checkbox"/> 0	<input type="checkbox"/> Other_____
K-6491-2R	2-hole self-rimming sink for single-hole faucet and right accessory	<input type="checkbox"/> 0	<input type="checkbox"/> Other_____
K-6491-2L	2-hole self-rimming sink for single-hole faucet and left accessory	<input type="checkbox"/> 0	<input type="checkbox"/> Other_____
K-6491-3	3-hole self-rimming sink for single-hole faucet and accessories	<input type="checkbox"/> 0	<input type="checkbox"/> Other_____

Recommended Accessories			
K-6146	Bottom basin rack (left)	<input type="checkbox"/> ST	
K-6147	Bottom basin rack (right)	<input type="checkbox"/> ST	
K-9000	P-Trap	<input type="checkbox"/> CP	

Product Specification

The self-rimming cast iron kitchen sink shall be 33" (83.8 cm) in length and 22" (55.9 cm) in width. Sink shall have acid-resistant enamel finish. Sink shall feature double (equal) compartment. Sink shall be single-hole (-1), 2-hole (-2), or 3-hole (-3). Sink shall be Kohler Model K-6491-_____-_____.

TANAGER™

Technical Information

Fixture*:	
Basin area	14-5/16" (36.4 cm) x 18-3/4" (47.6 cm)
Water depth	9" (22.9 cm)
Drain holes	3-7/8" (9.8 cm) D.
Faucet holes	1-3/8" (3.5 cm) D.
* Approximate measurements for comparison only.	
Included components:	
Cut-out template	1066422-7

Installation Notes

Install this product according to the installation guide.

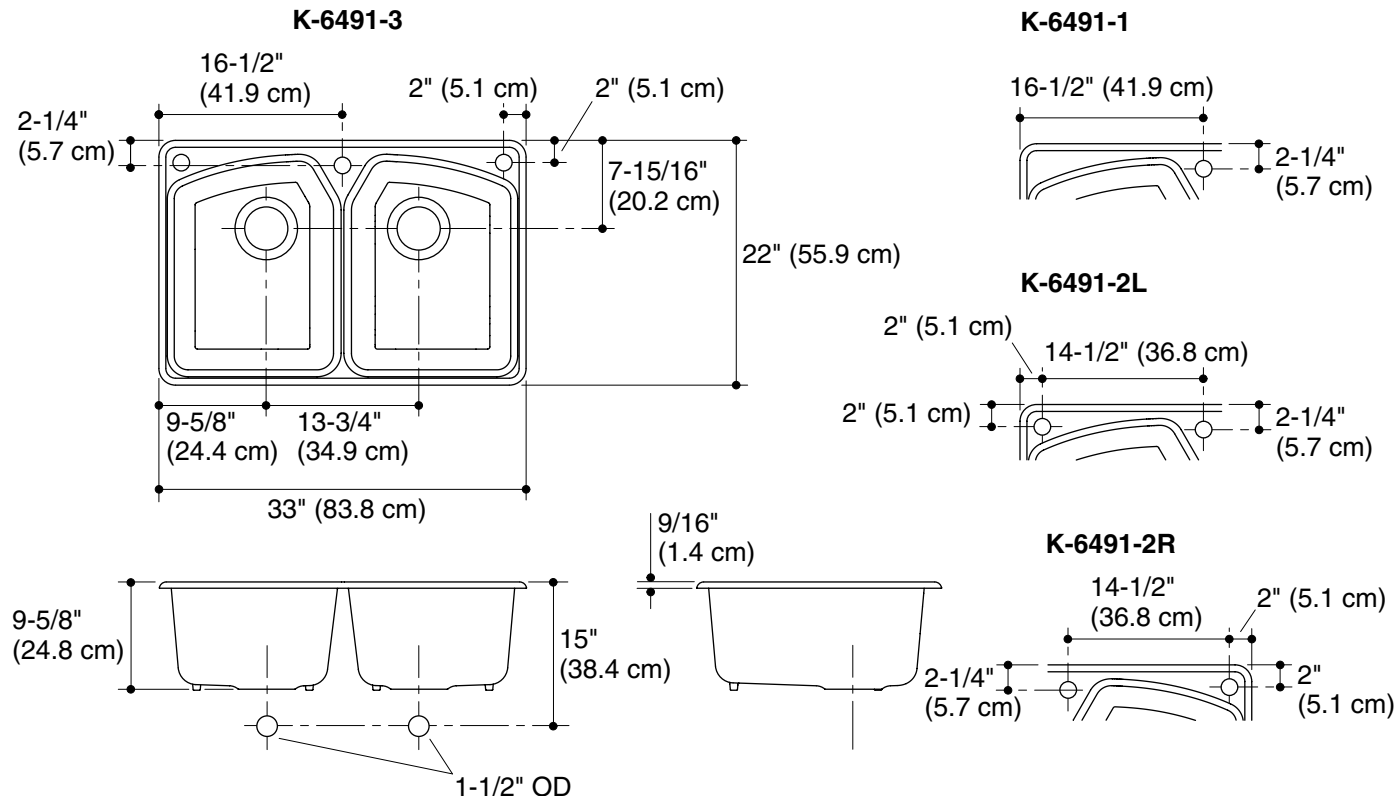

Product Diagram