



COMFORT FREESTANDING BATH SERIES

INSTALLATION AND OPERATION INSTRUCTIONS

Jacuzzi Luxury Bath
13925 City Center Drive, Suite 200
Chino Hills, CA 91709
www.jacuzzi.com



Contents

Contents.....	3
Product Information.....	3
Safety Instructions.....	4
Inspection and Testing.....	6
Sub Floor.....	6
Electrical Connections.....	6
Installation Procedures.....	7
Operation.....	12
Purging Air Channels.....	12
Maintenance.....	13
Troubleshooting Procedures.....	13
Technical Specifications (Gallery™ And Riva® Models).....	14
Technical Specifications (Bravo™ Models).....	15
Authorized Service.....	16
Warranty.....	17
Warranty Registration Card.....	19

Product Information

NOTE

Save these instructions for future use. Use the form below to record your model and serial number for future reference.

Date Purchased: _____

Purchased From: _____

Installed By: _____

Serial Number: _____

Model: _____

Installer: Leave the manual for the homeowner.

Homeowner: Read this manual and keep for future reference.

Dealer/Installer
Information

Dealer/Installer
Information

Safety Instructions

INSTRUCTIONS PERTAINING TO A RISK OF FIRE, ELECTRIC SHOCK, OR INJURY TO PERSONS.

This is a professional grade product. A knowledge of construction techniques, plumbing and electrical installation according to codes are required for proper installation and user satisfaction. We recommend that a licensed contractor perform the installation of all Jacuzzi Luxury Bath products. Our warranty does not cover improper installation related problems.



CAUTION: When using this unit, basic precautions should always be performed, including the following:

READ AND FOLLOW ALL INSTRUCTIONS. SAVE THESE INSTRUCTIONS.

- Use this unit only for its intended use as described in this manual. Do not use attachments not recommended by the manufacturer.
- Never drop or insert any object into any opening.



WARNING: RISK OF ACCIDENTAL INJURY OR DROWNING!

Do not permit children to use this unit unless they are closely supervised at all times. Do not use hydromassage bathtub unless all suction guards are installed to prevent body and hair entrapment. Never operate the hydromassage bathtub if the suction cover is broken, damaged or missing.



DANGER: RISK OF SEVERE INJURY FROM ELECTRIC SHOCK OR DEATH FROM ELECTROCUTION!

This unit must be connected only to a supply circuit that is protected by a 15 amp ground fault circuit interrupter (GFCI). Such a GFCI should be provided by the installer and should be tested on a routine basis. To test the GFCI, push the test button. The GFCI should interrupt power. Push the reset button. Power should be restored. If the GFCI fails to operate in this manner, the GFCI is defective. If the GFCI interrupts power to the bathtub without the test button being pushed, a ground current is flowing, indicating a possibility of an electric shock. Do not use this hydromassage bathtub. Disconnect the hydromassage bathtub and have the problem corrected by a qualified service representative before using.



WARNING: RISK OF ELECTRIC SHOCK!

Connect only to a circuit protected by a ground fault circuit interrupter (GFCI). (For permanently connected units) A green-colored terminal (or a wire connector) marked "G," "GR," "GROUND," or "GROUNDING") is provided within the terminal compartment. To reduce the risk of electric shock, connect the terminal or connector to the grounding terminal of your electric service or supply panel with a conductor equivalent in size to the circuit conductors supplying the equipment.



CAUTION: This equipment is intended for indoor use only. Install the equipment in accordance with these instructions. Use supply wires that are suitable for 167°F (75°C), including the temperature rating of the supply conductors to be used. This unit should be electrically grounded and installed by a licensed contractor, electrician, and plumber. Building materials and wiring should be routed away from the motor/pump or blower or other heat producing components of this unit. A pressure wire connector is provided on the exterior of the motor/pump and heater to permit connection of an No. 8 AWG solid copper bonding conductor between this unit and all other electric equipment and exposed metal in the vicinity, as needed to comply with local requirements.

Important CSA Safety Instructions (Canadian models only)



When using this electrical equipment, basic safety precautions should always be followed, including the following:

1. WARNING: RISK OF ACCIDENTAL INJURY OR DROWNING! CHILDREN SHOULD NOT USE HYDROMASSAGE BATHTUB WITHOUT ADULT SUPERVISION.
2. WARNING: RISK OF ACCIDENTAL INJURY OR DROWNING! DO NOT USE HYDROMASSAGE BATHTUB UNLESS ALL SUCTION GUARDS ARE INSTALLED TO PREVENT BODY AND HAIR ENTRAPMENT.
3. WARNING: TO AVOID INJURY, EXERCISE CARE WHEN ENTERING OR EXITING THE HYDROMASSAGE BATHTUB.
4. WARNING: RISK OF ACCIDENTAL INJURY OR DROWNING! DO NOT USE DRUGS OR ALCOHOL BEFORE OR DURING THE USE OF A HYDROMASSAGE BATHTUB EQUIPPED WITH A HEATER TO AVOID UNCONSCIOUSNESS AND POSSIBLE DROWNING.
5. WARNING: RISK OF FETAL INJURY! PREGNANT OR POSSIBLY PREGNANT WOMEN SHOULD CONSULT A PHYSICIAN BEFORE USING A HYDROMASSAGE BATHTUB EQUIPPED WITH A HEATER.
6. WARNING: RISK OF HYPERTHERMIA AND POSSIBLE DROWNING: DO NOT USE A HYDROMASSAGE BATHTUB EQUIPPED WITH A HEATER IMMEDIATELY FOLLOWING STRENUOUS EXERCISE.
7. SAVE THESE INSTRUCTIONS.

Safety Instructions (Continued)**WARNING: RISK OF HYPERTHERMIA AND POSSIBLE DROWNING!**

Do not use a hydromassage bathtub equipped with a heater immediately following strenuous exercise.

**WARNING: RISK OF ELECTRICAL SHOCK!**

- Do not permit electrical appliances (such as a hair dryer, lamp, telephone, radio or television) within 60" (1524 mm) of this hydromassage bathtub.
- Do not operate hydromassage system unless the bathtub is filled with water to at least 1-2" (25-51 mm) above the highest air hole.
- Do not immerse the control panel by overfilling the bathtub.
- When cleaning your bathtub, do not use abrasive substances which will damage the bathtub's surface.
- To prevent discoloration of the acrylic finish, do not fill the bathtub with water in excess of 140°F (60°C).

**WARNING: PROLONGED IMMERSION IN HOT WATER MAY INDUCE HYPERTHERMIA!**

Hyperthermia occurs when the internal temperature of the body reaches a level several degrees above the normal body temperature of 98.6°F (37°C). The symptoms of hyperthermia include an increase in the internal temperature of the body, dizziness, lethargy, drowsiness and fainting. The effects of hyperthermia include:

- A. Failure to perceive heat.
- B. Failure to recognize the need to exit the bathtub.
- C. Unawareness of impending hazard.
- D. Fetal damage in pregnant women.
- E. Physical inability to exit the bathtub.
- F. Unconsciousness resulting in danger of drowning.

**WARNING: RISK OF FETAL INJURY!**

Pregnant or possibly pregnant women should consult a physician before using a hydromassage bathtub equipped with a heater.

**WARNING:** The use of alcohol, drugs or medication can greatly increase the risk of fatal hyperthermia.

People using medications or having an adverse medical history should consult a physician before using a hydromassage bathtub equipped with a heater.

**WARNING:** The use of alcohol, drugs or medication can greatly increase the risk of fatal hyperthermia.

People using medications or having an adverse medical history should consult a physician before using a hydromassage bathtub equipped with a heater.

**WARNING:** Do not tamper with user-operated controls or such devices.**WARNING:** Use this unit only for its intended use as described in this manual. Do not use attachments not recommended by the manufacturers.**WARNING:** To avoid injury, exercise caution when entering or exiting the hydromassage bathtub.**WARNING:** Do not use hydromassage bathtub unless all suction guards are installed to prevent body and hair entrapment. Never operate the hydromassage bathtub if the suction cover is broken, damaged or missing.**WARNING:** Water temperature in excess of 104°F (40°C) may be injurious to your health. Check and adjust water temperature before use.**CAUTION:** Test the ground fault circuit interrupter protecting this appliance periodically in accordance with manufacturer's instructions**IMPORTANT:** Read the complete instructions provided in this manual before beginning installation.

The Company has obtained applicable code (standards) listings generally available on a national basis for products of this type. It is the responsibility of the installer/owner to determine specific local code compliance prior to installation of the product. The Company makes no representation or warranty regarding, and will not be responsible for any code compliance. Product specifications are subject to change without notice.

Inspection and Testing

Visual Inspection

- ❶ Remove the bathtub from the shipping carton. Be careful not to scratch the surface of the bathtub on exposed staples. Remove the staples or fold them into the carton. Retain the carton until satisfactory inspection of the product has been made. Do not lift the bathtub by the plumbing at any time; handle by the shell only.
- ❷ Inspect the shell and bathtub components. Should inspection reveal any damage or defect in the finish or visible damage to any components, do not install the bathtub. Damage or defect to the finish claimed after the bathtub is installed is excluded from the warranty. Jacuzzi Luxury Bath's responsibility for shipping damage ceases upon delivery of the products in good order to the carrier.
- ❸ Refer any claims for damage to the carrier. For definitions of warranty coverage and limitations, refer to the published warranty information packed with the product or in the back of this manual.

Bathtub Water and Operational Test

All bathtub units are factory tested for proper operation and watertight connections prior to shipping. However, the unit must be retested by the installer prior to installation. Jacuzzi Luxury Bath is not responsible for any defect that could have been discovered, repaired, or avoided by following this inspection and testing procedure:

- ❶ Place the bathtub on a level surface, near appropriate electrical supply, water supply, and water drainage. A driveway is a suitable choice.
- ❷ Seal the drain with tape or a stopper and fill the bathtub to 2" (50mm) above the highest air hole.
- ❸ Allow bathtub to stand for 5 minutes.
- ❹ If applicable, plug in the blower and turn the unit on. Confirm that all features function as described in the Operation section of this manual. Do not install the bathtub if bathtub fails to operate as described.
- ❺ Visually inspect all joints for leaks. Do not install the bathtub if leaks are detected.
- ❻ Return bathtub to box or otherwise protect from damage until time of installation.

Sub Floor

Prepare the sub floor for the drain and ensure that the area is level.

- ❶ The drain/overflow of the bathtub extends below the bottom of the bathtub. Identify the drawing in the Technical Specifications section that corresponds with your bathtub (page 14-15).
- ❷ Determine the location of the basin. The floor must be flat and level.
- ❸ Make appropriate cuts to the Sub floor to accommodate the drain.



Please refer to the drawing(s) in the Technical Specifications section that correspond to your bathtub.

Electrical Connections



Risk of electric shock. Connect only to a circuit protected by a GFCI.



When using electrical products, basic precautions should always be followed:

- Always follow local building and electrical codes.
- Grounding is required. The unit should be installed and grounded by a qualified electrician.

A separate GFCI protected circuit is required. Install a duplex outlet to the wall stud underneath the bathtub, at least 4" (101mm) above the floor. The duplex outlet is not supplied. A separate, 120VAC, 15 Amp GFCI circuit is required.

Test

Reset

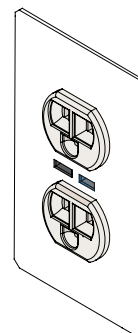

Installation Procedures

Before you begin your installation, please read the following:

- Observe all local land building codes.
- Determine which tools will be used during the installation.
- Additional bathtub drain ports and plumbing are commercially available at plumbing and hardware stores.
- Drain/Overflow rough-in information is included in your bathtub in the Technical Specifications section.

Bath Preparation Before Installation

The floor structure must be able to support the total weight of the bathtub, bath water and bather, and the bath must be horizontally level and continuous to provide proper drainage. Also, make sure any water connections or electrical supplies are within the designated areas and that there will be no interference with the skirt or bath installation. Follow the installation instructions carefully to ensure stability and possible future service of the unit, should service be required. See the Gain Service Access section for details.

- 1 Set the skirt in its place and position precisely with respect to the drain-overflow location. Verify where the indentation for the drain is in relation to the drain-overflow (Figures 1 & 2). Note: For Gallery™ and Riva™ models, the electrical area at the opposite end is within 15 inches of where the electrical floor outlet is to be located. Use a marker to outline the perimeter of the entire skirt directly on the floor.
- 2 Mark trough for the overflow drain location. The drain/overflow extends below the bottom of the bath. The drain/overflow requires a cutout of the floor for providing space to accommodate the extension. Do not exceed the dimensions of the skirt perimeter.
- 3 Mark area for electrical outlet from which you will measure the location of the electrical outlet to prevent interference during the bath installation.
- 4 Mark the six mounting hole areas on the floor. Six screws will be used to secure the skirt to the floor.
- 5 When the above locations have been marked on the floor, remove the skirt, set it aside and continue with the installation process.

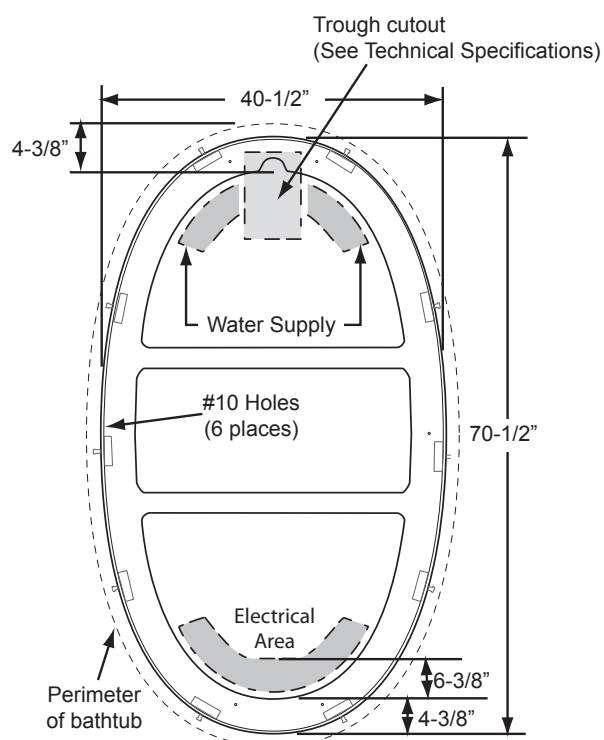

Figure 1. Template for Gallery™ 7242 & Riva™ 7242 Skirt

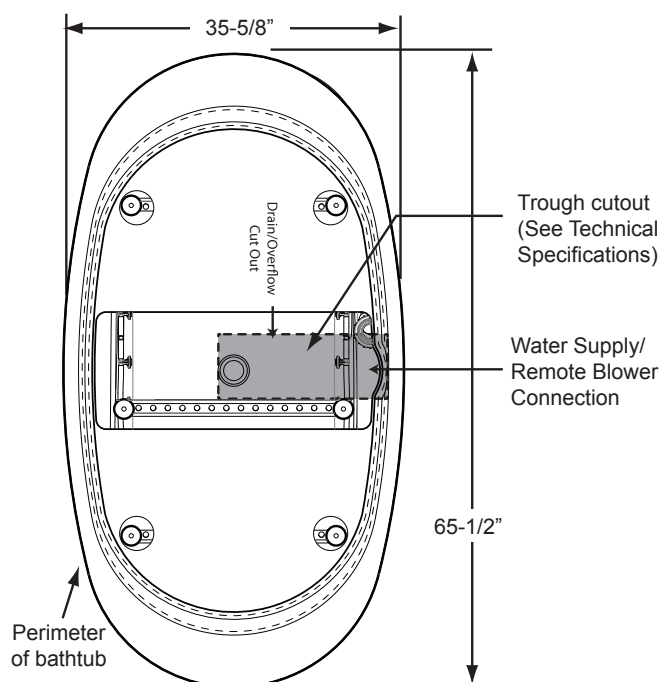

Figure 2. Template for Bravo™ 6636 Skirt

Installation Procedures (Continued)

Leveling (Bravo™ Models)

Once the unit is in position, ensure it is level in both directions for proper draining. Leveling must be done with the adjustable legs located beneath the unit. Make sure the legs and the contour of the skirt are at the same level to ensure stability of the unit (Figure 1). A level must be used to verify the bathtub is level. If the bathtub is not level, please perform the following steps:

- 1 Use a screwdriver and loosen the level adjustment bolts (Figure 2).
- 2 Adjust bolts until level. Tighten the level adjustment bolts after leveling is achieved.

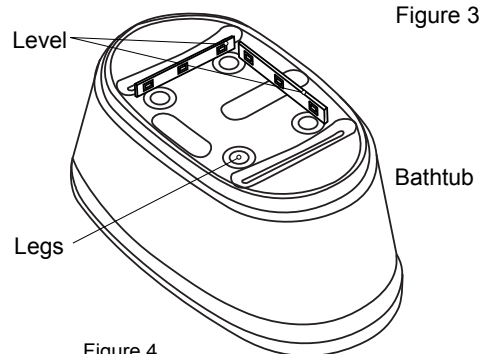

Figure 3

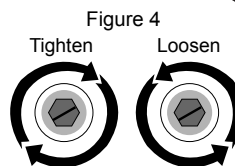

Figure 4

Prepare Drain-Overflow Trough

Prepare the drain/overflow trough according to the dimensions shown in the Technical Specifications section. The depth of the trough depends on the vertical extension of the drain elbow at the bottom of the plumbing below the floor level. Install drain/overflow according to the manufacturer's instructions. Refer also to the Technical Specifications section.



Watertight installation of the drain is the installer's responsibility. Drain leakage is excluded from the Jacuzzi Luxury Bath warranty of this product.

Construction Required Before Installation (Gallery™ & Riva® Models)

Before the skirt may be secured to the floor, the following steps must be completed:

- 1 Place the skirt on the floor in relation to the drain/overflow and the electrical area (and water supply - when applicable). Place the skirt on the floor and line up with the markings previously made on the floor.
- 2 Drill holes for attaching the skirt to the Sub floor. Drill six holes into the floor that will accommodate the six screws (provided) that will be used to secure the bath skirt to the floor. Use a 1/8" drill bit and drill 1" deep.
- 3 Faucetry is not supplied with the freestanding bath. To use deck-mounted faucetry, flexible connection lines that are 72" in length must be used. These lines need to be installed prior to installing the bath into the skirt. Refer to Figure 5 for possible locations of the faucetry in order to bring the water supply through the floor. If faucetry must be located outside of the recommended areas, you must be careful not to locate it where it will interfere with the location of the mounting brackets.

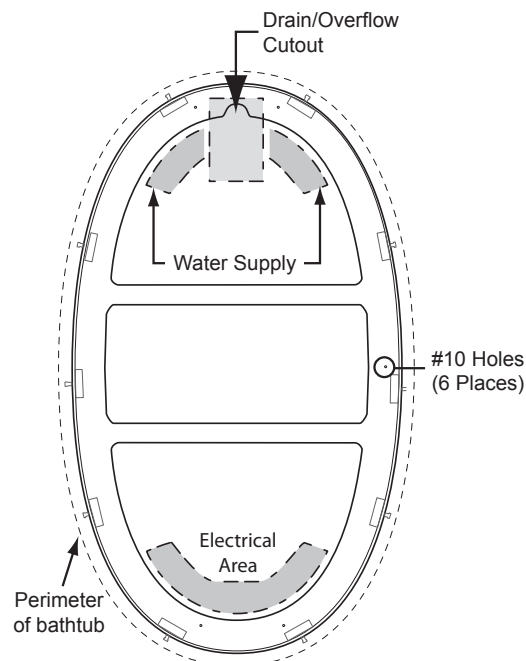

Figure 5. Gallery™ 7242 Faucet Installation



The water supply should be located in the area illustrated above. Under no circumstances should installation permit interference with any of the equipment. DO NOT modify the mounting brackets to facilitate mounting the faucet and faucet hardware.



DO NOT install faucetry near electrical outlets.



If floor-mounted or wall-mounted faucetry is to be used exterior to the bath, this can be installed after the bath is installed into the bath skirt.

- 4 Prepare the Electrical Outlet. A dedicated floor outlet must be provided in the areas designated as electrical areas in Figure 5.



This 115V outlet for a three-prong plug must be protected by a ground fault circuit interrupter (GFCI) circuit.

Installation Procedures (Continued)

Clean Area After Construction

Clean up debris left over from the construction steps taken thus far. Also, remove the perimeter outline of the template on the floor.

Secure Skirt To Floor (Gallery™ & Riva® Models)

Use the six #10 x 1.5" screws provided to attach the skirt to the Sub floor. Make sure the skirt is properly oriented according to the drain/overflow end and the electrical area. Tighten the screws snugly (do not overtighten).



If you are using adhesive to secure the skirt to the floor, a bead of adhesive sealant should be applied around the bottom of the skirt. Carefully place the skirt on the floor in the correct position and press to the floor. Place weights around the perimeter and allow the adhesive to cure before proceeding.

Install Faucet (Bravo™ Models)

Faucet elements must be installed in the recommended area (Figure 6). Before drilling, position faucet elements to make sure they line up with the pre drilled holes beneath.

Faucet elements must be attached to a 25" (636 mm) length of 1/2" hose so you can lift the bathtub when needed.

- 1 Mark the location of the faucets on the underside of the unit and drill 3/16" (5 mm) pilot holes. Make sure the holes line up with the plumbing. Drill directly on the finished side, following the provided faucet installation instructions (Figure 7).



CAUTION

If installing the faucet on the same side as the overflow, make sure there is no interference between the two before drilling.

Figure 6

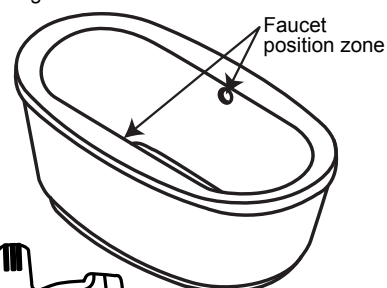
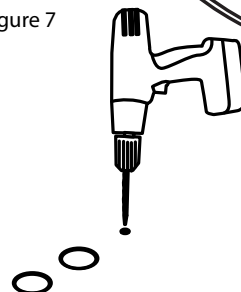

Figure 7



Prepare Bath For Installation Into Skirt (Gallery™ & Riva® Models)

- 1 Place the bath in the skirt momentarily without making any connection, then center the bath in the skirt. Make sure the drain and overflow piping will line up with the connection points on the bath, then remove the bath from the skirt and set it aside.
- 2 Place two, five foot long 2x4" supports across the top of the skirt. Spread the wooden supports evenly over the skirt as illustrated (Figure 8). They will support the bath during the connection of the water supply, drain/overflow, and during adjustment of the ten fasteners.
- 3 Place the bath onto the 2x4" supports in the position that it will be lowered into the skirt. The 2x4" supports need to be positioned under the foam block base. Orient the bath properly with respect to the electrical area and the drain. Also, make sure the drain and overflow areas line up.
- 4 Connect the water supply to the bath (if applicable). Connect the flexible water lines to the faucets if using deck mounted faucetry. Make certain the valves are in the closed position. Turn on the

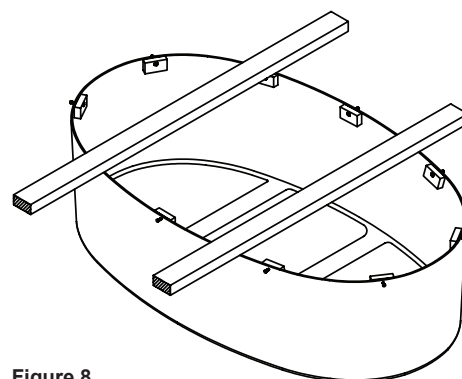

Figure 8

Gallery™ & Riva® Series Preparation for Bathtub Installation Note: Retain the two 2x4" supports in the event that future service is required.

Installation Procedures (Continued)

Prepare Bath For Installation Into Skirt (Gallery™ & Riva® Models - Continued)

water supply and check for leaks at any of the connections.

- 5 If applicable, connect the electrical plug to the dedicated GFCI-protected outlet.
- 6 Adjust the fasteners at the top edge of the skirt. Make sure the 10 hex-head screws around the top edge of the skirt extend about 1/4" beyond the outside surface of the skirt (Figure 9).



If you are installing optional decorative accessories you must install them now. Refer to Riva® 7242 / Gallery™ 7242 ring and leg installation instructions included with your accessories for detailed instructions. The decorative ring must be installed prior to placing the bath into the skirt.

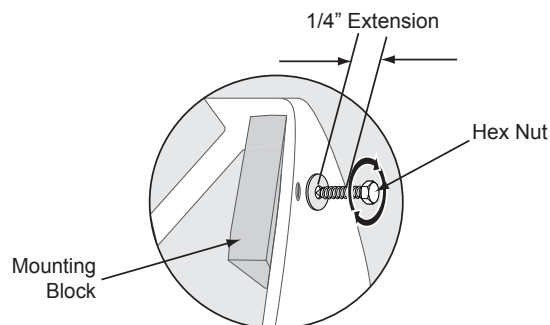

Figure 9
Hex-Head Screws (10)

Prepare Bath For Installation Into Skirt (Bravo™ Models)

- 1 Connect the water supply to the bath (if applicable). Connect the flexible water lines to the faucets if using deck mounted faucetry. Make certain the valves are in the closed position. Turn on the water supply and check for leaks at any of the connections.
- 2 If applicable, connect the electrical plug to the dedicated GFCI-protected outlet.

Position Bath Into Skirt (Gallery™ & Riva® Models)

- 1 Lower the bath into place. Three persons will be required to lower the bath into the skirt. One person at each end of the bath will lift the bath, and the third person will remove the two supports from the top of the bath skirt.



Take care not to damage the overflow pipe while lowering the bath into the skirt.

- 2 There are ten mounting brackets underneath the rim of the bath (Figure 10). Align the slots in the 10 brackets with the hex-head screws extending 1/4" from the skirt, then place the bath into position.



Hand-tighten the nuts snugly. DO NOT overtighten the nuts.

- 3 Make the final connection of the drain fitting and the overflow fitting, then seal the connection.
- 4 Turn on power to the dedicated GFCI-protected circuit and check system operation.
- 5 Tighten the 10 hex-head fasteners around the top of the skirt until the skirt is secured by the brackets.

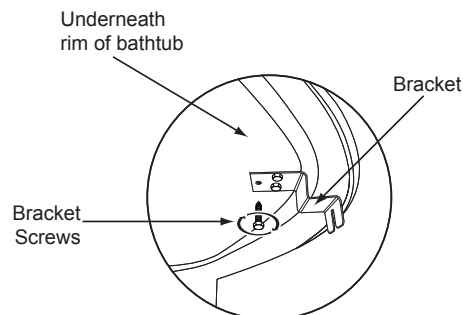

Figure 10
Skirt Mounting Bracket



The bracket must be attached to the underside of the unit using industrial adhesive (commercially available)

Installation Procedures (Continued)**Remote Blower Installation (Bravo™ Models)**

For ease of installation of remote blower and airline fittings, it is recommended there be access to the underside of the bathtub, either from above or below the sub floor.

- 1 Determine the locations for the blower and verify that access to blower and airline fittings will be possible after bathtub is installed. Blower location must be within 10 feet of the tub as illustrated (Figure 11).

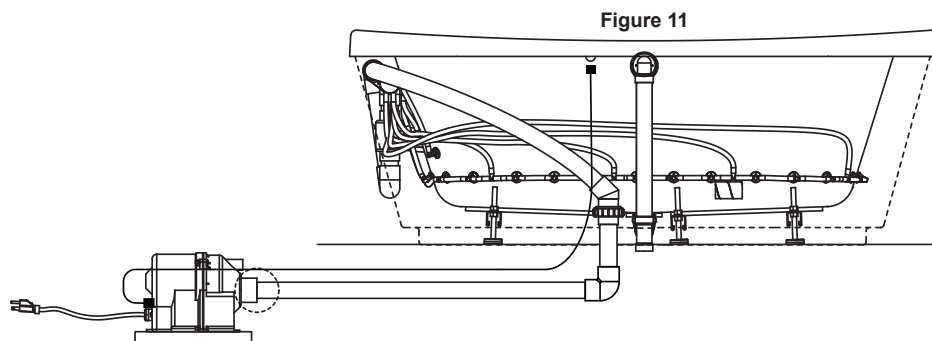

- 2 Use 1-1/2" schedule 40 PVC to connect the bathtub to the blower. Pipe connected directly to the blower should be secured with a stainless steel screw. Do not glue blower to the PVC.
- 3 The control cable provided with the tub is 25' long. Do not wrap the cable along the pipe from blower to bathtub.
- 4 Once airline fittings and control cable are connected to the blower, plug the blower into the outlet and test the operation before completing the installation.

Gain Service Access (Gallery™ & Riva® Models)

In the event service access is required to the plumbing or bathtub equipment, you will need two, five foot 2x4" supports. Place them in the vicinity of the bath, then perform the steps outlined below:

- 1 Shut off the water from the main valve(s). Remove power from the unit at the main electrical panel, then loosen the ten hex-head screws that secure the bath to the skirt (it is not necessary to remove the screws).
- 2 Disconnect the appropriate plumbing as required:
 - Remove the drain flange at the drain.
 - Remove the drain overflow fitting.
- 3 With a person at each end of the bath, raise it out of the skirt enough to position the two 2x4" wood supports over the skirt to support the raised bath. Place the supports evenly onto the skirt as illustrated (Figure 12). Set the bath onto the wood supports. *Note: The supports need to be positioned under the foam block base.*
- 4 After completing service, restore all connections and attachments. Restore the tub to the skirt and make sure it is secure. Finally, restore electrical power and the water supply from the main source.

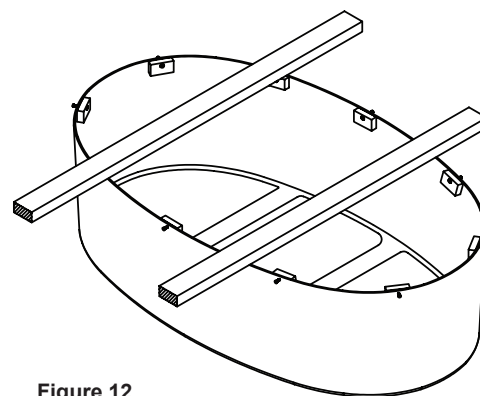
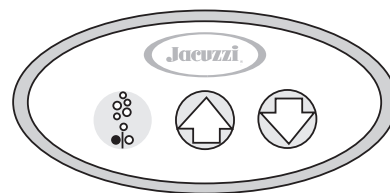

Figure 12

Operation

All bathtubs manufactured by Jacuzzi Luxury Bath are designed for “fill and drain,” which means the bathtub should be drained after each use and filled with fresh water by the next bather. This is a health precaution, as these bathtubs are not designed to hold water continuously like pools or spas.



Blower Operation

ON: Press the blower button once to turn blower ON. The indicator light(s) at left will illuminate brightly. The blower is on a timer and will operate for 20 minutes.

OFF: Press the blower button a second time to turn blower OFF.



The last blower setting used is remembered by the system and will automatically resume upon next use.



When the blower is turned off, operation does not immediately cease. There is a delay of 15-20 seconds to allow the blower to cool down. The unit is shutting down, as indicated by the blinking of indicator lights.

Increase Speed

Press the Up Arrow Button to increase blower speed.

There are five blower intensities. Each push and release of the button will increase blower intensity through five incremental steps.



Alternately, if the Up Arrow button is depressed and held, the blower intensity will increase through each of the 5 blower intensities, stopping when the button is released.

Decrease Speed

Press the Down Arrow button to decrease blower speed.

There are five blower intensities. Each push and release of the button will decrease blower intensity through five incremental steps.



Alternately, if the Down Arrow button is depressed and held, the blower intensity will decrease through each of the five blower intensities, stopping when the button is released.

Purging Air Channels

The purge cycle is automatic and will reduce excessive accumulation of residual water in the air channels. Twenty minutes after the motor has shut down, the blower will turn on for a one-minute drying cycle to blow out any water remaining in the air channel. If the bath is used without the motor operating, the one-minute drying cycle may be manually initiated by turning the blower on and immediately off. The drying cycle will then initiate after 20 minutes.

Daily Purge



The blower may be automatically activated for 1 minute daily at a set time.

Setting Daily Purge

With the blower off, hold the UP arrow button for 5-seconds, then release. The blower will come on for 1-second, turn off for 2-seconds, then come on for 1-second and finally turn off to indicate the feature has been activated. The blower will now start every day at the same time for 1-minute, then turn off.

Daily Purge (Continued)

Stopping The Daily Purge

With the blower off, hold the UP arrow button for 5-seconds, then release. The blower will come on for 1-second, then turn off to indicate the feature has been deactivated.

The default setting is no purge. The daily purge feature must be set upon installation.

Maintenance

Cleaning The Bathtub

To clean the bathtub, use a mild Meguiar's nonabrasive liquid detergent solution. You can protect and restore the luster to a dulled acrylic surface by applying Meguiar's #10 Mirror Glaze, a product specifically designed for use on acrylic finishes.



Never use abrasive household cleaners of any kind on any Jacuzzi Luxury Bath product.

Surface Repair

Minor scratches which do not penetrate the color finish can be removed by lightly sanding with #600-grit wet and dry sandpaper. Restore the gloss using Meguiar's Mirror Glaze. Major scratches and gouges which penetrate the acrylic surface will require refinishing. Call Jacuzzi Luxury Bath to find a service agent in your area.

Troubleshooting Procedures

Problem	Probable Cause	Remedy
Blower does not start.	No power to blower Blower not connected Blower is defective	Reset GFCI and/or breaker. Ensure plug is fully in outlet. Ensure control panel is connected to control box. Contact Jacuzzi Luxury Bath @ 800-288-4002.
Blower operates but NO air is exiting the holes.	Check to see if the plumbing is connected to the blower	Call Jacuzzi Luxury Bath @ 800-288-4002
Blower operates but air is not exiting all of the holes.	Blower intensity is insufficient Obstructed air holes	Increase the blower intensity. Note: The system is designed such that all air holes operate at the blower's highest setting. Remove debris with a toothpick or toothbrush.
Blower shuts off unexpectedly.	20-minute timer has elapsed GFCI tripped Inadequate supply wiring	Turn on blower. Reset GFCI. If it continues to trip, do not use the unit. Consult a licensed electrician to correct.



If the unit is within the warranty period, contact Jacuzzi Luxury Bath Service Support at 1-800-288-4002 with your bath's serial number before work is started. The serial number is located on the Specification/Serial Number Plate (the plate is located behind the equipment area).

Technical Specifications (Gallery™ And Riva® Models)

PureAir® Pictured

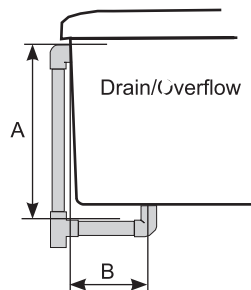
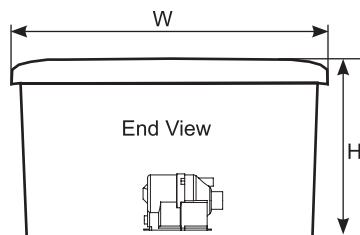
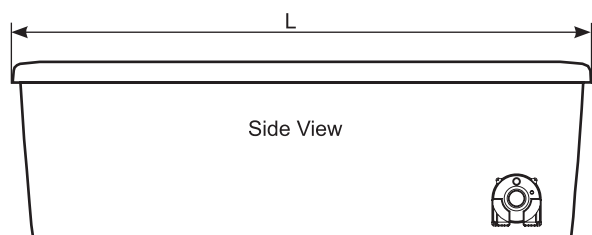

Model	Dimensions	Drain/Overflow	TOTAL WEIGHT FLOOR LOADING	OPERATING GALLONS	PRODUCT WEIGHT	SKIRT AND MOUNTING	HEATER
Gallery™ 7242 Freestanding Pure Air®	72" L (1829mm) 42" W (1067mm) 20½" H (521 mm)	16" A (406mm) 11½" (292mm)	1208lb, 57.5lb/sq. ft. (548kg, 281kg/m²)	89 US Gal Max. (337 Liters) 55 US Gal. Min (208 Liters)	167 lb (767 kg)	Included	Not Available
Gallery™ 7242 Freestanding Soaking Bath	72" L (1829mm) 42" W (1067mm) 20½" H (521 mm)	16" A (406mm) 11½" (292mm)	1115lb, 53.1lb/sq. ft. (506kg, 259kg/m²)	89 US Gal Max. (337 Liters)	124lb (56kg)	Included	Not Available
Riva® 7242 Freestanding Pure Air®	72" L (1829mm) 42" W (1067mm) 20½" H (521mm)	16" A (406mm) 11½" B (292mm)	1208lb, 57.5lb/sq. ft. (548kg, 28 kg/m²)	89 US Gal. Max (337 Liters) 55 US Gal. Min (208 Liters)	167 lb (767 kg)	Included	Not Available
Riva® 7242 Freestanding Soaking Bath	72" L (1829mm) 42" W (1067mm) 20½" H (521mm)	16" A (406mm) 11½" B (292mm)	1115lb, 53.1lb/sq. ft. (506kg, 259kg/m²)	89 US Gal. Max (337 Liters)	124lb (56kg)	Included	Not Available



The overall dimensions are nominal with a tolerance of +0 and -1/4" (6mm).
Blower; 115VAC, 15 Amp, 60Hz (Dedicated GFCI-Protected Circuit Required)

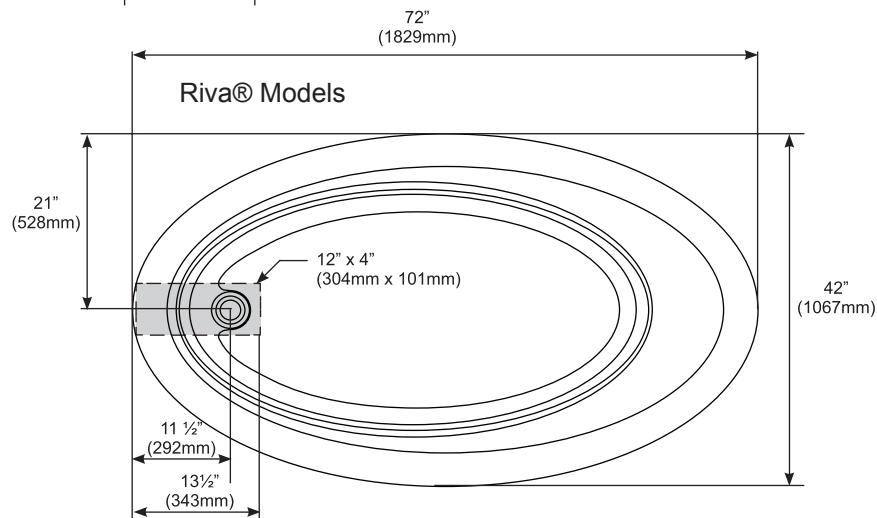
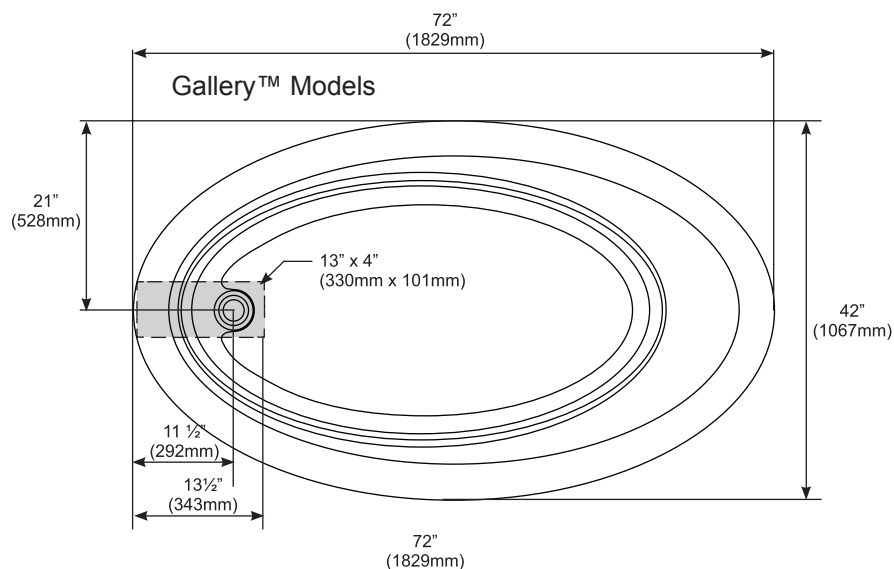

Technical Specifications (Bravo™ Models)

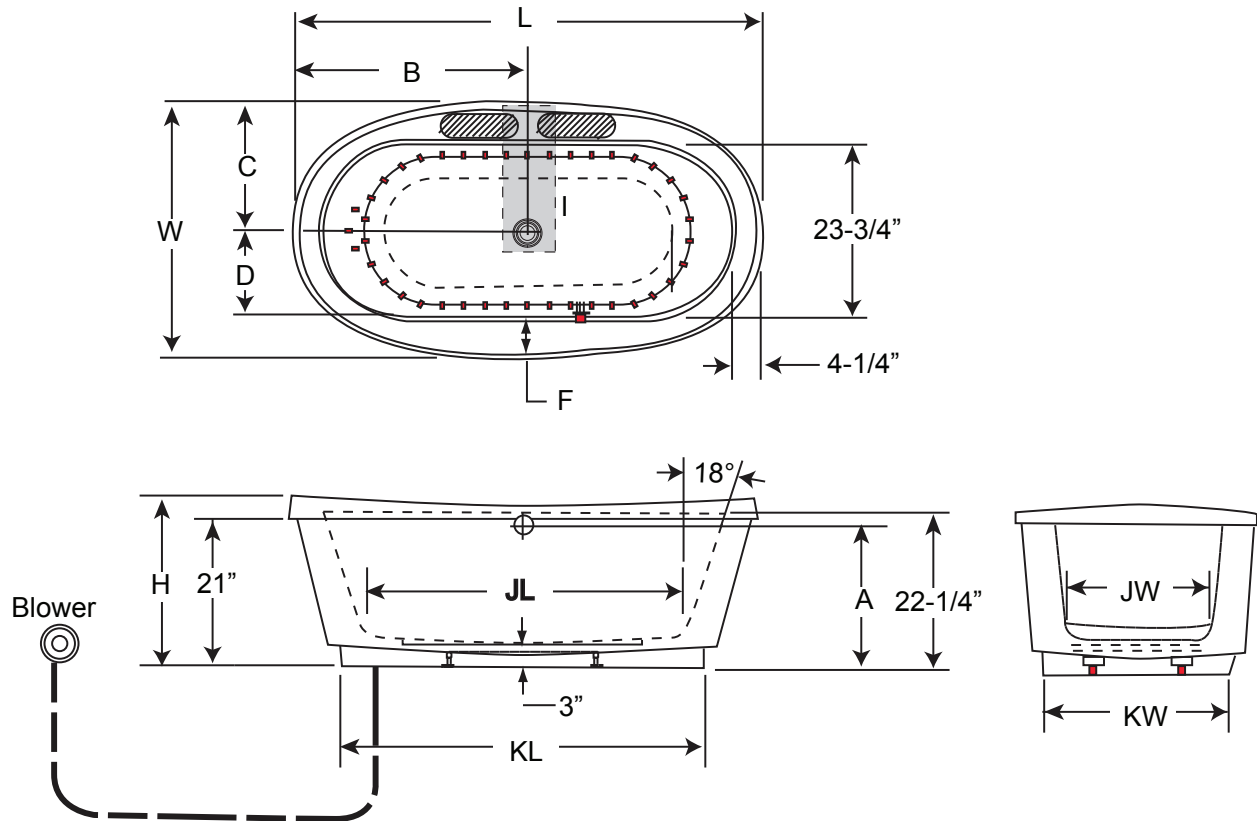

Soaking Bath Model

Letter	Description	English	Metric
-	Drain/Motor Location	Center Drain	
-	Cutout	N/A	
-	Total Weight	922 lb	418 kg
-	Floor Loading	55.8 lb/ft ²	272.4 kg/m ²
-	Operating Gallons (Min/Max)	48 Gal. Min. 60 Gal. Max.	182 L Min. 227 L Max.
-	Product Weight	122 lb.	55 kg
-	Soaking Depth	16"	406 mm
L	Outer Length	65-1/2"	1664 mm
W	Outer Width	35-5/8"	905 mm
H	Overall Height	24"	610 mm
A	Overflow Height	20"	508 mm
B	Long Edge to Drain Center	32-3/4"	832 mm
C	Short Edge to Drain Center	17-3/4"	451 mm
D	Dain Shoe Length	12-3/4"	324 mm
E	Flange Height	N/A	N/A
F	Deck Width	5"	127 mm
G	Service Access Dimensions	N/A	N/A
I	Floor Cutout for Drain	6" x 18"	150 x 457 mm
J	Interior Dimensions (W x L)	46" x 20-1/4"	1168 x 514 mm
K	Skirt Base Dimensions: K(L) x K(W)	50" x 30"	1270 x 762 mm

Pure Air™ Bath Model

Letter	Description	English	Metric
-	Drain/Motor Location	Center Drain	
-	Cutout	N/A	
-	Total Weight	931 lb	427 kg
-	Floor Loading	56.4 lb/ft ²	275.3 kg/m ²
-	Operating Gallons (Min/Max)	48 Gal. Min. 60 Gal. Max.	182 L Min. 227 L Max.
-	Product Weight	131 lb	59 kg
-	Soaking Depth	16"	406 mm
L	Outer Length	65-1/2"	1664 mm
W	Outer Width	35-5/8"	905 mm
H	Overall Height	24"	610 mm
A	Overflow Height	20"	508 mm
B	Long Edge to Drain Center	32-3/4"	832 mm
C	Short Edge to Drain Center	17-3/4"	451 mm
D	Drain Shoe Length	12-3/4"	324 mm
E	Flange Height	N/A	N/A
F	Deck Width	5"	127 mm
G	Service Access Dimensions	N/A	N/A
I	Floor Cutout for Drain	6" x 18"	150 x 457 mm
J	Interior Dimensions (W x L)	46" x 20-1/4"	1168 x 514 mm
K	Skirt Base Dimensions: K(L) x K(W)	50" x 30"	1270 x 762 mm

Authorized Service

If you need a referral for a service company near you, or need assistance with operation or maintenance-related questions, please call our Service Support Department at 1-800-288-4002. Visit our website at <http://www.jacuzzi.com/> for products, services, and an online copy of these Installation and Operation Instructions.

When requesting service or technical assistance please have available both the model and serial number of your unit. This information can be obtained from the product registration card provided with your unit. If the card has been misplaced, this information can be obtained from the specification/serial number label on the unit itself.

SPECIFICATION/SERIAL NUMBER LABEL

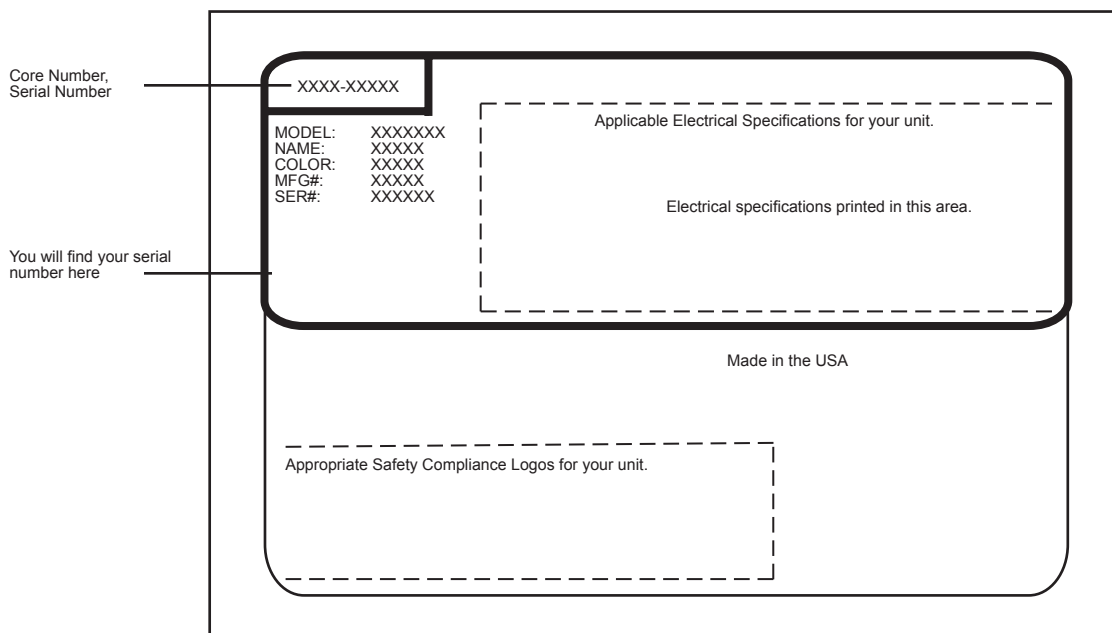

PRODUCT SPECIFICATIONS ARE SUBJECT TO CHANGE WITHOUT NOTICE.

USE TECHNICAL SPECIFICATIONS MANUAL SUPPLIED WITH PRODUCT.

Jacuzzi Luxury Bath has obtained applicable code (standards) listings generally available on a national basis for products of this type. It is the responsibility of the installer/owner to determine specific local code compliance prior to installation of the product.

Jacuzzi Luxury Bath makes no representation or warranty regarding, and will not be responsible for any code compliance.

Jacuzzi Luxury Bath
13925 City Center Drive, Suite 200
Chino Hills, CA 91709
1-800-288-4002
www.jacuzzi.com

Limited Lifetime Warranty on Jacuzzi Branded Bathtubs for the Comfort and Luxury Collections

Jacuzzi Luxury Bath (the "Company") offers the following expressed limited lifetime warranty to the original purchaser of any Jacuzzi Luxury Bath products provided in the Company's Comfort and Luxury collections ("Bath") who purchases the Bath for personal or single family residential use ("User"): The Company will repair or replace, at its sole option, the Bath or its equipment in accordance with the following terms and conditions. This warranty does not apply to non-branded Bath products manufactured by the Company.

LIFETIME WARRANTY ON BATHS

The Company extends to the User of the Bath a non-transferable limited lifetime warranty that the shell will maintain its structural integrity and configuration and be free of water loss due to a defect in the bathtub shell. This warranty covers only the bathtub shell and the manufacturer installed pump, jets, controls, and blower against defects in material or workmanship. This warranty does not apply to any display models or to any options or accessories which are covered under our limited ninety (90) day warranty set forth below. Warranty coverage begins on the date the unit was originally purchased by the User and upon receipt by the Company of a completely filled out Warranty Registration Card as described below.

2 YEAR LABOR WARRANTY FOR ALL FACTORY INSTALLED COMPONENTS

Our limited labor warranty is for a period of two (2) years from the date the unit was originally purchased by the User, but not more than Three (3) Years from date of manufacture. All factory installed components (e.g., pump, motor, blower, and plumbing) are covered under our labor warranty against failure due to defects in materials and workmanship.

NINETY DAY (PARTS ONLY) LIMITED WARRANTY ON OPTIONS AND ACCESSORIES

Our limited warranty on options and accessories is for ninety (90) days for parts only. Our warranty covers options and accessories manufactured (e.g., drains fill spout kits, trim kits, skirts, video monitors, LCD flat panel screens, CD and MP3 players and other music and video devices and optional heaters) against defects in material or workmanship. Warranty coverage begins on the date the option or accessory was originally purchased by the User. These items may be covered by a manufacturer's warranty which may have a longer duration than this limited warranty. Please confirm with the manufacturer the duration of the appropriate warranty for Options and Accessories.

WARRANTY LIMITATIONS

Our limited warranty does not cover defects, damage, or failure caused by the common carrier, installer, user, or other persons, pets, or rodents, or resulting from, without limitation, any of the following: careless handling (lifting unit by plumbing, abrading finish, etc.) including its own negligence; modification of any type for any reason (including modification to meet local codes); improper installation (including installation not in accordance with instructions and specifications provided with the unit); connections supplied by the installer of the equipment; improper voltage supply or unauthorized electrical modification; misuse; incorrect operation, or lack of proper routine maintenance; operation of the unit without specified minimum amount of water or at inappropriate water temperature; use of abrasive or improper cleaners; or acts of God, such as lightning, floods, earthquakes, etc.

In addition, THE COMPANY WILL NOT BE RESPONSIBLE FOR INCIDENTAL OR CONSEQUENTIAL DAMAGES or losses arising from any cause (e.g., water damage to carpet, ceiling, tiles, marble, loss of use, etc.) including its own negligence; damages to, respecting, or resulting from: plated parts when pool and/or spa chemicals are used in the unit or hard water conditions; optional bathtub equipment not manufactured by the Company but supplied by Dealer, installer or the Company; the unit's prior usage as an operational display; or defects that should have been discovered before installation. This limited warranty does not include: labor, transportation, or other costs incurred in the removal and/or reinstallation of the original unit and/or installation of a replacement unit; any costs relating to obtaining access for repair; or loss of use damage, including loss of sales, profit or business advantage of any kind under any circumstances. Bathtub units are excluded from any warranty coverage if any addition, deletion, or modification of any kind whatsoever has been made to the unit (or to any component). Warranty coverage is provided in the United States of America and Canada only.

EXCLUSION OF IMPLIED WARRANTIES

IMPLIED WARRANTIES OF MERCHANTABILITY AND FITNESS FOR A PARTICULAR PURPOSE ARE DISCLAIMED TOGETHER OR TO THE FULLEST EXTENT ALLOWED BY LAW.

NOTICE: This warranty gives you specific legal rights, and you may also have other rights which vary from state to state. There are no warranties applicable to Jacuzzi Luxury Bath products except as expressly stated herein or as implied by applicable state and federal laws. The Company will not be responsible for any statements or representations made in any form that go beyond, are broader than or are inconsistent with any authorized literature or specifications furnished by the Company. Some states do not allow limitations on how long an implied warranty lasts, or the exclusion or limitation of incidental or consequential damages, so the above limitations and exclusions may not apply to you.

RETURN OF WARRANTY REGISTRATION OR NO WARRANTY

To register your product, please go to our web-site Jacuzzi.com, click on Bath and Showers, then select ONLINE WARRANTY REGISTRATION from the top of the page. You will then be prompted to enter your product Serial Number followed by your warranty registration information. Or you may also register by completing the registration below and mailing it to jacuzzi at the address provided below.

THE ATTACHED WARRANTY REGISTRATION MUST BE FILLED OUT BY THE PURCHASER WITHIN THIRTY (30) DAYS FROM PURCHASE AND RECEIVED BY JACUZZI LUXURY BATH IN ORDER FOR THIS WARRANTY TO BECOME EFFECTIVE.

RESPONSIBILITIES OF OTHERS

Inspecting the unit prior to installation is the responsibility of the installer or building contractor who acts on behalf of the User. They are responsible for ensuring the unit is free of defect or damage. Notices are placed on and in the unit and on the shipping carton advising the installer of this responsibility. In the event of a problem, the unit must not be installed. THE COMPANY IS NOT RESPONSIBLE FOR FAILURES OR DAMAGE THAT COULD HAVE BEEN DISCOVERED, REPAIRED, OR AVOIDED BY PROPER INSPECTION AND TESTING (INCLUDING PROPER WATER TESTING) PRIOR TO INSTALLATION.

Damage occurring in transit is the responsibility of the carrier. The User or installer MUST open the crate and inspect the unit for damage when it is delivered. If damage is discovered, it must be reported immediately to the seller and the carrier in writing, and an inspection requested. Failure of the carrier to respond should be reported to the seller and the carrier. Your freight claims should be filed promptly thereafter.

Damage occurring to the unit during installation is the responsibility of the installer and/or building contractor and damage occurring thereafter is the responsibility of the User.

Failure of any optional equipment is the sole responsibility of the equipment manufacturer except as provided above and shall not extend to or apply to any replacement parts for the Options and Accessories. Any replacement parts shall be covered by the original equipment manufacturer.

The Distributor or Dealer is responsible for knowing local code requirements and notifying the installing contractor and/or User of these requirements at the time of purchase. The Company is not responsible for costs to modify any product to obtain any code approval, such as city, county, or state building codes in U.S.A. or municipal or provincial codes in Canada.

WARRANTY SERVICE

For the User's benefit, the Company maintains a list of independent service personnel to perform required warranty service repairs. Such firms are not agents or representatives of the Company and cannot bind the Company by words or conduct.

The Company will provide the warranty service described above when the following conditions have been met: the failure is of the nature or type covered by the warranty; the User has informed an Authorized Jacuzzi Luxury Bath Service Agent or Warranty Service Department Representative of the nature of the problem during the warranty period; conclusive evidence (e.g., proof of purchase or installation) is provided to the foregoing by the user proving that the failure occurred or was discovered within the warranty period; an authorized independent service person or Company representative has been permitted to inspect the unit during regular business hours within a reasonable time after the problem was reported by the User. In order to obtain warranty service, contact Jacuzzi Luxury Bath at:

www.jacuzzi.com
or
Jacuzzi Luxury Bath
Warranty Service Department
14525 Monte Vista Avenue
Chino, California 91710
Call: 1-(800) 288-4002

To obtain warranty replacement for factory-installed components for Company supplied options and accessories manufactured and supplied by the Company, call or write the above. Provide a description of the problem and proof of purchase. You will be instructed how to obtain replacements and where to return, at your expense, the failed component(s), option(s), or accessory(ies).

All replacement parts, equipment, and repairs shall assume the remaining warranty period of the part(s) replaced.

The Company's warranty obligation shall be discharged upon tender of replacement or repair. The customer's refusal to accept the tender terminates the Company's warranty obligation.

Ninety-Day Parts Only Limited Warranty On Accessory(ies)
--



Jacuzzi Luxury Bath
14525 Monte Vista Avenue
Chino, California 91710



WARRANTY REGISTRATION CARD

To complete your registration, visit our website at www.jacuzzi.com or fill out and mail this card to the address printed on the other side within thirty (30) days from date of purchase in order for this warranty to be come effective.

Purchaser's Name _____

Purchaser's Address _____

City _____ State ____ Zip _____

Home Phone: _____ Cell Phone: _____

Email: _____

Date of Purchase _____

Model Name _____

Serial Number _____

Dealer's Name _____

Dealer's Address _____

1. How did you first hear about this Jacuzzi product?

- ☐ Advertisement ☐ Article in Magazine/Newspaper
☐ Visited Dealer/Plumbing Supplier ☐ Yellow Pages
☐ Builder/Plumber/Remodeler ☐ Decorator/Architect
☐ Visited Retailer/Home Center Store
☐ Word of Mouth . . . Friend/Relative/Acquaintance
☐ Other (Please Describe) _____

2. Who first gave you specific information about this product (specifications, prices, etc.)?

- ☐ Dealer/Plumbing Supplier ☐ Builder ☐ Remodeler
☐ Plumbing Contractor ☐ Retailer/Home Center Store
☐ Decorator/Architect ☐ Already Installed

3. What was the main reason for purchase?

- ☐ Styling ☐ Warranty Service ☐ Product Features
☐ Brand Name ☐ Price ☐ Hydrotherapy
☐ Home Resale _____
☐ Other _____

4. Who finally decided which product you would buy?

- ☐ Self ☐ Spouse ☐ Self and Spouse Together
☐ Other Family Member ☐ Designer/Architect
☐ Builder/Plumber/Remodeler ☐ Already Installed

5. Who installed? ☐ Already installed/New Home

- ☐ Contractor/Plumber when remodeling
☐ Self/Spouse when remodeling
☐ Other _____

6. What is the current market value of this property?

Please estimate \$ _____

7. What is the age of the head of the household? Years

8. What other manufacturers did you consider?

- ☐ Eljer ☐ Lasco ☐ Price Pfister ☐ Aqua Glass
☐ Kohler ☐ American Standard ☐ Sterling
☐ Other (Specify) _____

9. How long did you shop before purchasing unit?

- ☐ 1 day ☐ 2 months- 6 months
☐ 2-7 days ☐ 6 months- 1 year
☐ 1 week- 2 weeks ☐ 1 year- 2 years
☐ 2 weeks- 4 weeks ☐ +2 years
☐ 1 month- 2 months

10. Approximately how long have you lived in this home _____?

11. Please indicate, approximately, the total annual income of your household.

- ☐ Up to \$24,999 ☐ \$50,000 to \$74,999
☐ \$25,000 to \$29,999 ☐ \$75,000 to \$99,999
☐ \$30,000 to \$39,999 ☐ \$100,000 to \$149,999
☐ \$40,000 to \$49,999 ☐ \$150,000 and Above

12. Was your purchase process?

- ☐ Very easy ☐ Easy ☐ Difficult ☐ Very Difficult

13. How technically aware were you of the patented Jacuzzi jet system prior to your purchase?

- ☐ Not aware ☐ Somewhat aware ☐ Very aware

Ninety-Day
Parts Only
Limited Warranty
On
Accessory(ies)