

ASSEMBLY INSTRUCTIONS to begin...

Model # P1002-71
Brushed Nickel Pot Rack Light

Note: Carefully unpack and identify all parts before beginning assembly. Max. 2 x R20 50W medium base bulbs (bulbs not included).

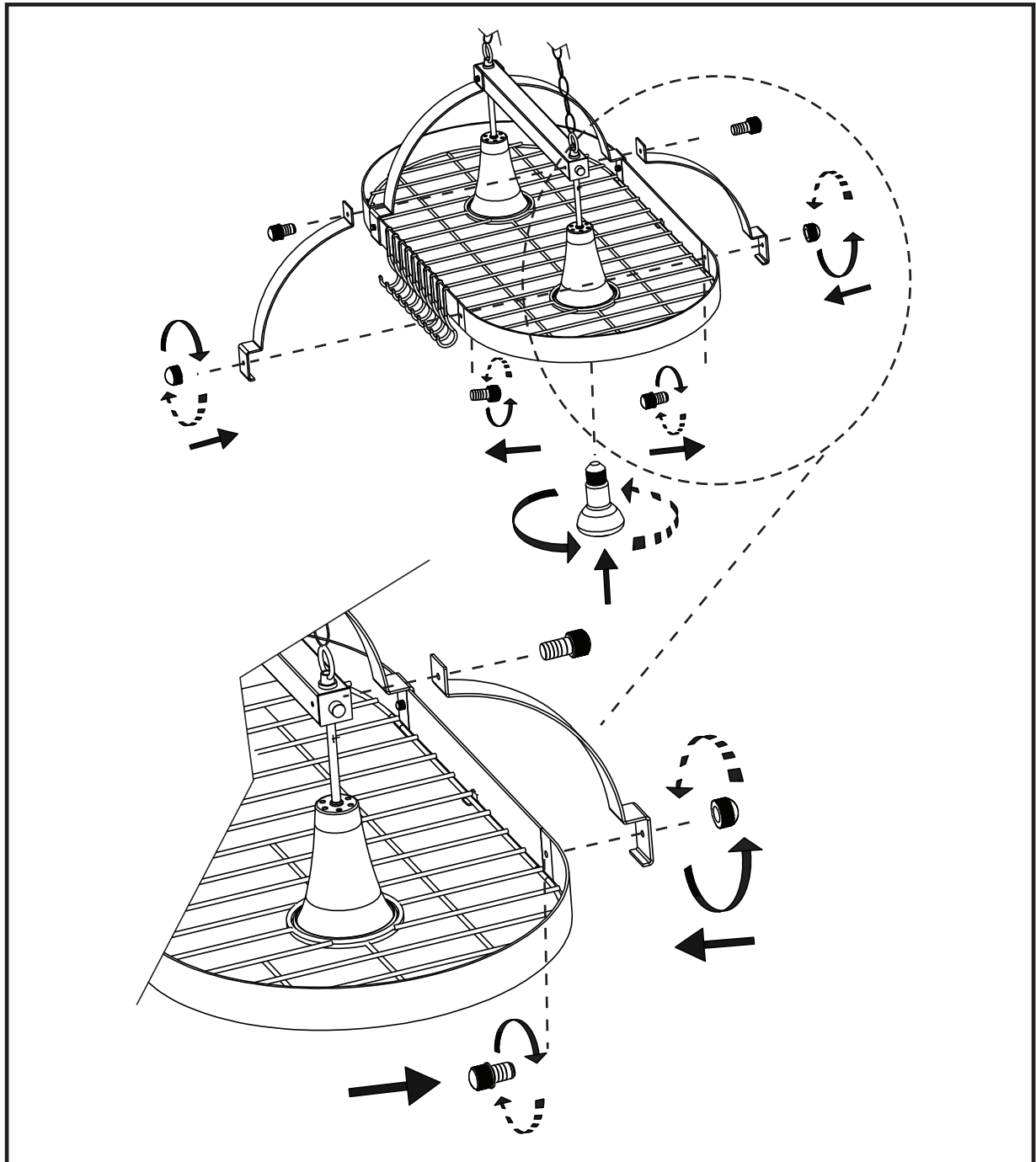

Supplied:



Decorative knob x 4



Decorative screw x 8



Questions? Call our customer service at 1800.265.9960

OVER 50lbs (22.68kg) .CHAIN SUSPENDED FIXTURE INSTALLATION INSTRUCTION

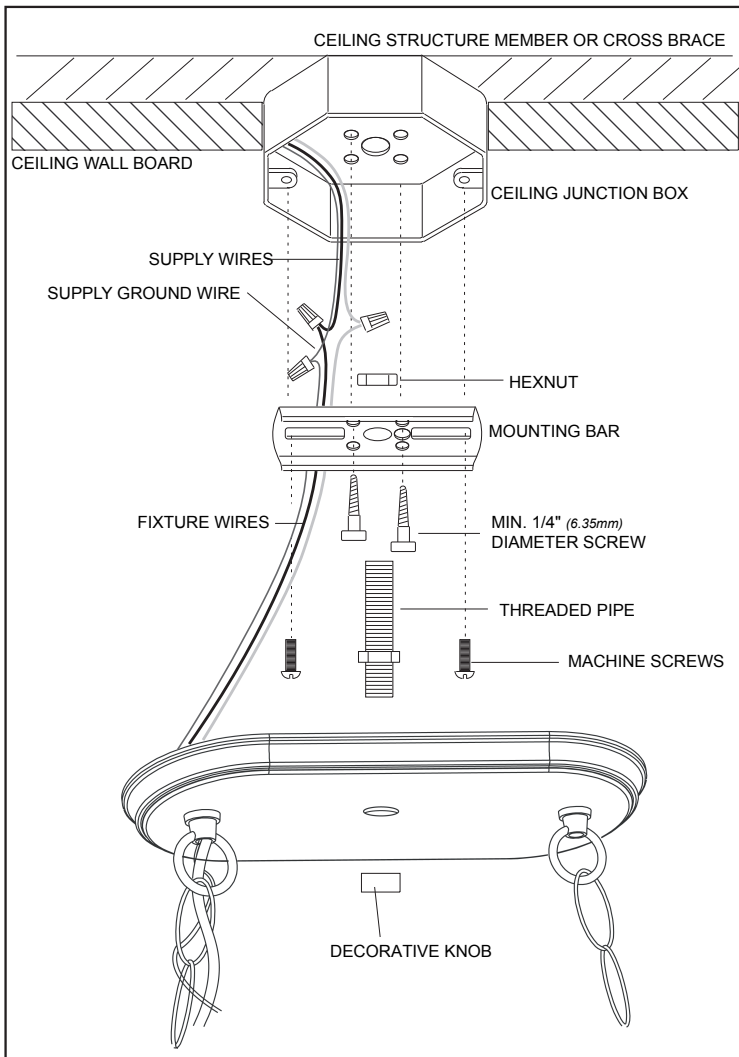

IMPORTANT:

-TURN POWER AT MAIN FUSE OR CIRCUIT BREAKER BOX BEFORE STARTING INSTALLATION.

-RECOMMEND THIS PRODUCT BE INSTALLED BY A QUALIFIED ELECTRICIAN TO REDUCE RISK OF FIRE AND ELECTRICAL SHOCK.

1. A. Screw about 1/2" (12.70 mm) of threaded pipe into center hole in mounting bar. Note: The protruding side lips of mounting bar must face threaded pipe. See diagram.
- B. Attach mounting bar to ceiling junction box with two machine screws (supplied with junction box) through slot at each end of mounting bar.
- C. At this point test install the canopy onto ceiling through this threaded pipe and make certain 5/16" (7.94 mm) of threaded pipe protrude below the canopy. If not, then adjust the threaded pipe location by screwing up or down accordingly.
- D. Once correct threaded pipe location has been adjusted, remove canopy and mounting bar from junction box.
- E. Lock threaded pipe into mounting bar by fastening a hex nut from above. Note: Do not spin threaded pipe during tightening.

2. To hang fixtures weighing over 50 lbs. (22.68 kg.) (over 25 lbs. (11.34 kg.) in Canada) the mounting bar must be supported independently of the ceiling junction box. Recommend minimum of two 1/4" (6.35 mm) diameter screws or bolts (rated for 200 lbs. (90.72 kg.) or greater) which must have sufficient length to be installed through the mounting bar, junction box, and securely into the ceiling structure member or cross brace. This installation must be able to support at least four times the weight of the fixture. Check this fact before starting assembly. If unsure please consult a qualified technician.

3. Fasten back two machine screws (supplied with junction box) through slot at each end of mounting bar and into junction box.

4. Fasten another hex nut onto bottom end of threaded pipe.

Min. 60 ° C (140 ° F) supply conductors

5. Fixture wire connections:

Connect clear smooth side fixture wire to black supply wire and clear ridged side fixture wire to white supply wire.

Note: Make certain no loose conductors protrude outside of wire connectors. And make certain all wires are securely held together by wire connectors.

6. Ground wire connection:

Connect fixture ground wire to supply ground wire with wire connector.

Important: Never connect ground wire to black or white supply wires.

7. Once all wires are connected tuck them carefully into junction box. Then raise canopy against the ceiling and lock into position by screwing decorative knob onto the threaded pipe.



Checkolite International Inc.
142 Charles Street
Jersey City, NJ 07307
www.checkolite.com
1.800.265.9960
Printed in China

