

Rear Stacking Kit

(For Stacking Dryers on Washers) Part# RSK 3070

(Enclosed: 1 Bracket)

Installation Instructions

1

Using a Philips Screwdriver remove the two screws that hold the top of the washer in place. The screws are located at the rear of the machine.

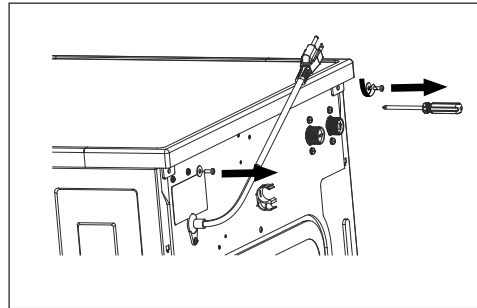

2

Stack the dryer on the washer. Pull the dryer out towards the back so the two rear feet are hanging out.

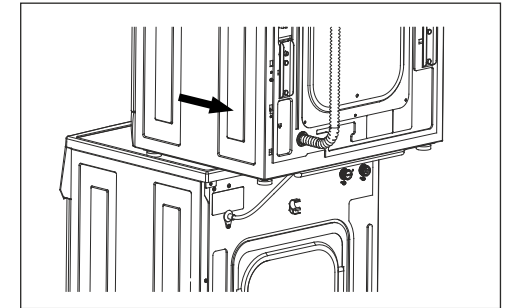

3

Unscrew the rear feet from the dryer

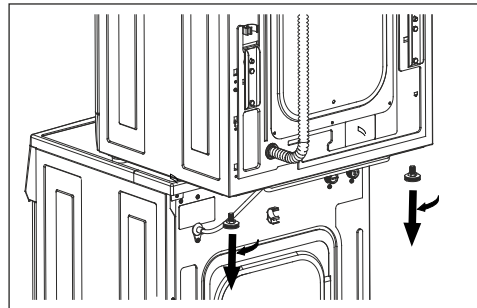

4

Align two holes on the top of the bracket with the holes for the feet of the dryer.

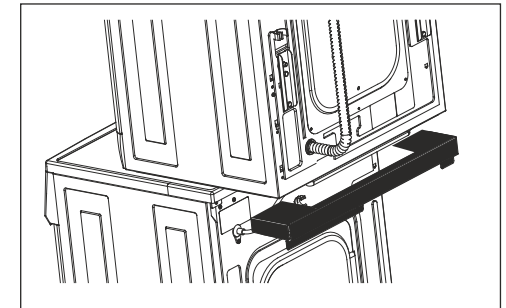

5

Screw the rear feet back into the machine with the bracket between the feet and the machine.

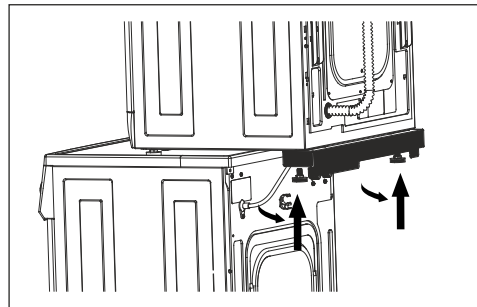

6

- Push the Dryer forward until the holes at the rear of the bracket are aligned with the holes at the back of top panel
- Insert the 2 screws that were removed in Point no. 1
- If the holes do not align properly you may need to level the feet at the back of the dryer.

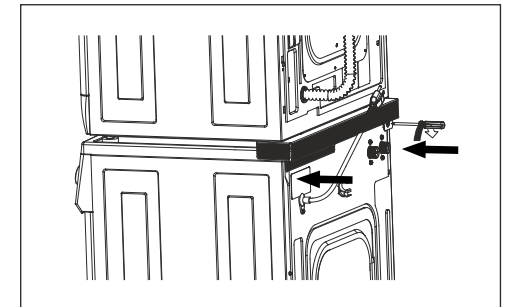

TOOLS NEEDED



Philips screwdriver



WARNING

Before working on any appliance, be sure that the power ON/OFF button is in the OFF position and that the electrical cord is unplugged.

Appliance Desk

10216 Georgibelle Drive, Suite 900D, Houston, TX 77043-5249

Tel: 800-490-8018 • www.ApplianceDesk.com • Parts@ApplianceDesk.com