

ASSEMBLY INSTRUCTIONS



CAUTION

◆ Inspect the wire insulation for any cuts, abrasions, or exposed copper that may have resulted during shipping. If there is a defect in the wire, do not attempt installation.

◆ Before starting installation of this fixture or removal of a previous fixture, disconnect the power by turning off the circuit breaker or by removing the fuse at the fuse box.



If you need further assistance, please contact us by Email: customersupport@superiordecorinc.com

TOOLS REQUIRED



Ladder



Safety glasses



Electrical tape



Phillips screwdriver



Flat blade screwdriver



Pliers

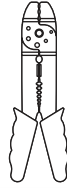

Wire strippers

HARDWARE INCLUDED

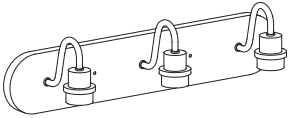

Fixture

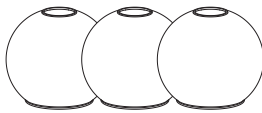

Glass shade



Ball Nuts

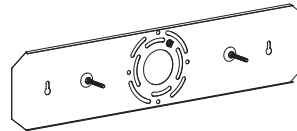

Mounting Unit

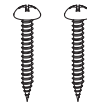

Wood Screws

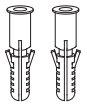

Wall Anchors



Mounting Screws



Wire Nuts

***PARTS SHOWN MAY DIFFER SLIGHTLY PER LIGHT FIXTURE**

EXPLODED PARTS

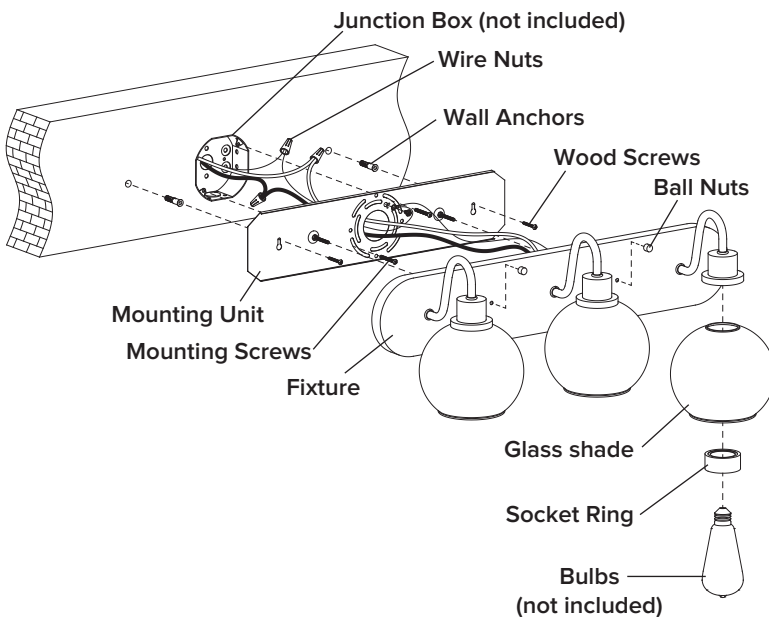

INSTALLATION

STEP 1

Unscrew the **ball nuts** and **green grounding screw** from the **mounting unit**.

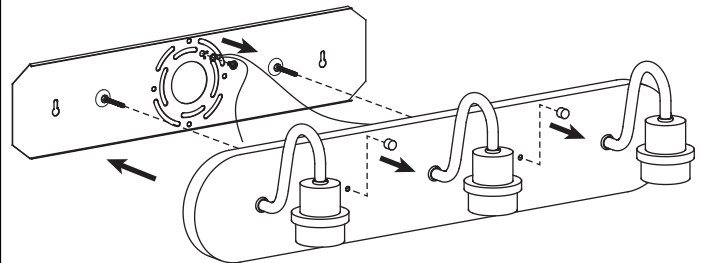

STEP 2

Attach the **mounting unit** to the junction box (not included) using the **mounting screws**. Secure **mounting unit** to ceiling with **wood screws** and **wall anchors**.

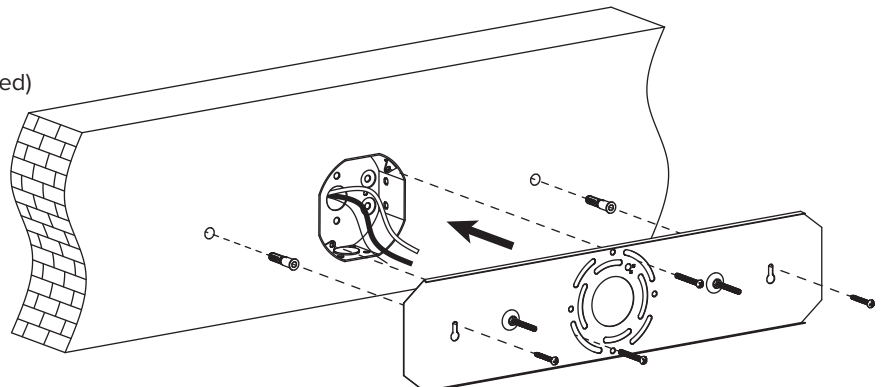

ASSEMBLY INSTRUCTIONS (INSTALLATION)

STEP 3

Make the electrical connection from the junction box (not included) to the **fixture**. Connect the ground wire to the **mounting unit** using the preinstalled green ground screw. Then, connect the positive, negative and ground wires with the supplied **wire nuts**. Secure with electrical tape.

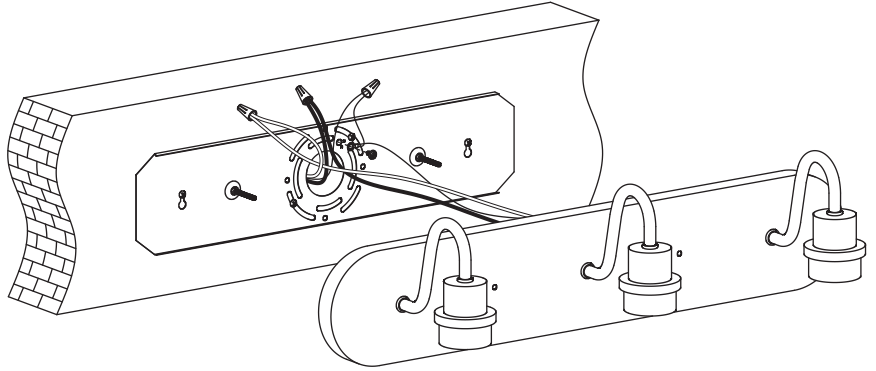
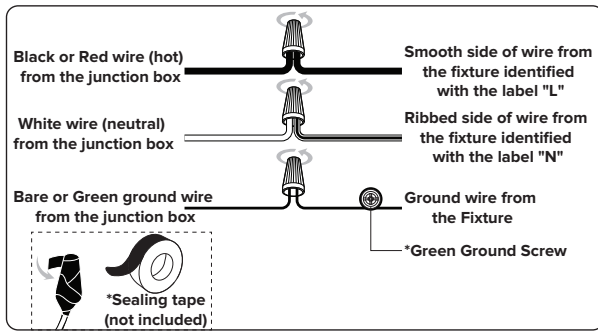

STEP 4

Secure the **fixture** to the **mounting unit** with the **ball nuts**.

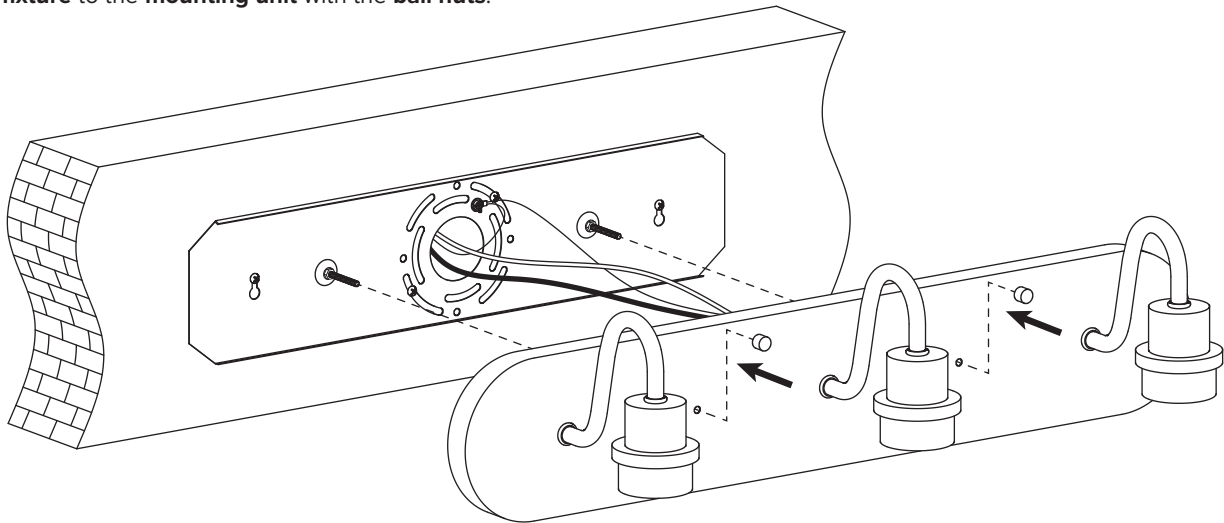

STEP 5

Remove the **socket rings** from the socket.
Attach the **glass shade** onto **fixture** using **socket rings**.

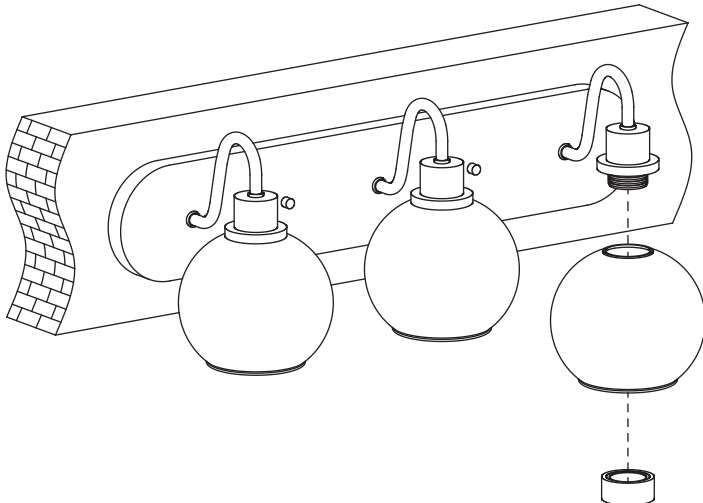

STEP 6

Install bulb (not included)

