

USER MANUAL

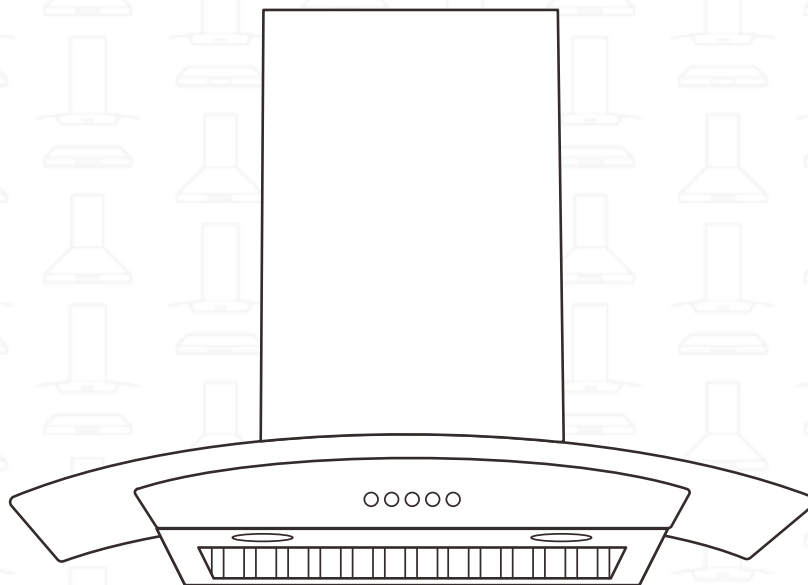

WM-630 Model Series

HAUSLANE

Table of Contents

Safety Information	2	Mounting the Hood.....	7
Warranty Information	3	Attach Duct to Outlet Adapter (for Ducted Mode Only) ..	8
Specifications	4	Assemble the Chimney Bottom	8
Package Contents	4	Assemble the Chimney Top	8
Parts Needed	4	Install Charcoal Filter (for Non-ducted Mode).....	9
Tools Needed	4	How to Use Your Range Hood	10
Preparation: What to Do Before Installation 5		Using the Front Control Panel.....	10
Read This Manual.....	5	Basic Maintenance Instructions	11
Remove Packaging	5	Maintaining the Stainless Steel Baffle Filters.....	11
Ensure There is Proper Height Clearance	5	Replacing the Non-Ducted Recirculation	
Check Your Power Supply and Ducts	5	Charcoal Filters.....	11
Complete Duct Work (for Ducted Mode).....	5	Replacing the LED Lamps.....	11
Figure Out Ducting Requirements & Install Adapter	6	Cleaning the Range Hood.....	11
Find a Helper	6	Cleaning the Oil Cup	11
How to Install Your Range Hood	7	Troubleshooting Tips	12
Test the Unit.....	7	Contact Hauslane	13
Drilling the Pilot Holes	7		

Safety Information

Before installing your range hood, read the entire instruction manual. Installers, leave this manual with the homeowner.

WARNING

SUITABLE FOR USE IN HOUSEHOLD COOKING AREA ONLY. TO REDUCE THE RISK OF FIRE, ELECTRICAL SHOCK, OR INJURY, OBSERVE THE FOLLOWING:

1. Use this range hood only in the manner intended by the manufacturer. If you have the questions, contact Hauslane at **1-800-929-0168** or email at **info@hauslane.com**.
2. Before servicing or cleaning, switch power off at service panel and lock service panel to prevent power from being switched on accidentally. When the service disconnecting means cannot be locked, securely fasten a prominent warning device, such as a tag, to the service panel.
3. Installation work and electrical wiring must be done by qualified personnel in accordance with all applicable codes and standards, including fire-rated construction codes and standards.
4. Sufficient air is needed for proper combustion and exhausting of gases through the flue (chimney) of fuel-burning equipment to prevent back drafting. Follow the heating equipment manufacturer's guidelines and safety standards such as those published by the National Fire Protection Association (NFPA), and the American Society for Heating, Refrigeration and Air Conditioning Engineers (ASHRAE), and the local code authorities.
5. When cutting or drilling into wall or ceiling, do not damage electrical wiring and other hidden utilities.
6. Ducted fans must always be vented to the outdoors.
7. Do not use this unit with any solid-state speed control device.
8. To reduce the risk of fire, use only steel ductwork.

9. This unit must be grounded.

TO REDUCE THE RISK OF A RANGE TOP GREASE FIRE:

1. Never leave surface units unattended at high settings. Boil overs cause smoking and greasy spillovers that may ignite. Heat oils slowly on low or medium settings.
2. Always turn hood ON when cooking at high heat or when cooking flaming foods.
3. Clean ventilating fans frequently. Grease should not be allowed to accumulate on fan or filter.
4. Use proper pan size. Always use cookware appropriate for the size of the surface element.

WARNING

TO REDUCE THE RISK OF INJURY TO PERSONS IN THE EVENT OF A RANGE TOP GREASE FIRE, OBSERVE THE FOLLOWING*:

1. SMOTHER FLAMES with a close-fitting lid, cookie sheet or metal tray, then turn off the burner. BE CAREFUL TO PREVENT BURNS. IF THE FLAMES DO NOT GO OUT IMMEDIATELY, EVACUATE AND CALL THE FIRE DEPARTMENT.
2. NEVER PICK UP A FLAMING PAN as you may be burned.
3. DO NOT USE WATER, including wet dishcloths or towels. This could cause a violent steam explosion.
4. Use an extinguisher ONLY if:
 - A. You own a Class ABC extinguisher and you know how to operate it.
 - B. The fire is small and contained.
 - C. The fire department has been called.
 - D. You can fight the fire with your back to an exit.

*Based on "Kitchen Fire Safety Tips" published by NFPA.

⚠ CAUTION

1. For general ventilating use only. Do not use to exhaust hazardous or explosive materials and vapors.
2. To avoid damage and noisy and/or unbalanced impellers, keep drywall/construction dust, etc. off power unit.
3. Mount your range hood so that the bottom of the hood is 24" to 30" above the cooking surface. The minimum hood distance above cooktop must not be less than 24"; any installation less than 24" may cause overheating and cause damage to the range hood. For gas ranges, the required distance is 30". Do not exceed the maximum height of 30" while in operation. HAUSLANE does not warrant this improper installation.

4. Two to three installers are recommended because of the larger size and weight of this hood.
5. To reduce the risk of fire and to properly exhaust air, be sure to duct air outside. Do not exhaust air into spaces within walls and ceiling or into attics, crawl space or garages.
6. Because of the high exhausting capacity of this hood, you should make sure enough air is entering the house to replace exhausted air by opening a window close to or in the kitchen.
7. Use with approved cord-connection kit only.
8. Please read product specification label on range hood for further information and requirements.

Warranty Information

This range hood is warranted to the original purchaser to be free of defects in material and workmanship for two (2) years from the date of purchase.

Our obligation shall be limited to the repair or replacement of a unit (at our discretion) that may prove, by our sole examination, to be defective under normal use and service during the warranty period. We may issue credit in the amount of the invoice value of the defective product (or a percentage of it according to use) in lieu of repair or replacement. Any failure of this product that is not traceable to a defect in material or workmanship is not covered by this warranty. These non-warrantable items include, but are not limited to:

- Any defects or damage to light bulbs
- Change in color or finish due to chemical usage
- Improper installation not in accordance with the instructions
- Dents, bumps, and scratches incurred during shipping, handling, or installation
- Damage caused by failure to follow care and cleaning guidelines, including damage caused by the use of abrasive cleaners
- Alterations made to the unit by the purchaser or installer
- Damage caused by accidental impact, fire, flood, freezing, and normal wear
- Bends and warping caused by forced connections, over-tightened fittings, and inadequate support during installation

A thorough inspection must be made before installation and any damage must be promptly reported. We will not be liable for failures or damage that could have been discovered or avoided by proper inspection and testing prior to installation. Incidental repairs that would involve a minimum of time and effort on behalf of the purchaser will not be considered warranty work and no compensation will be deemed forth coming.

This warranty is non-transferable and shall be voided if the unit is removed from its initial installation or if it is not installed following the instructions.

Under no circumstance shall we be held liable for personal

injury or property damage resulting from improper installation or use of this product. We will not be held liable for inconvenience caused by loss of use of this product, costs incurred for labor or materials, removal and installation of replacement units, or any other incidental or consequential damages. Costs relating to obtaining access for repair or replacement are the responsibility of the user.

This warranty does not extend to commercial and institutional installation or use.

Warranty Claim Procedure

If a claimable defect occurs, please contact our customer service team at **1.800.929.0168** (8 a.m.-5 p.m., PST, Monday-Friday). or email us at **info@hauslane.com**.

Before you make your claim call, please ensure that you have:

- Description of the range hood
- Proof of sale
- Details regarding the defect
- Name(s) and address(es) of the owner and installer

Claims must be filled out in writing and returned within six (6) months of the appearance of a defect. Failure to comply with this stipulation will make this warranty null and void. We reserve the right to a thirty-day (30) delay following the receipt of a claim in which to inspect the product. We assume no responsibility for labor costs, removing or replacing a previously installed product, transportation, or the return of a product.



CALIFORNIA RESIDENTS ONLY WARNING:

Cancer and Reproductive Harm
www.P65Warnings.ca.gov

Specifications

Dimensions	Volts	Hertz	Fan CFM	Speeds	Light Wattage	Stainless Steel Grade
30": 29 3/4" W x 18 7/8" D x 21" - 41.1" H 36": 35 5/8" W x 18 7/8" D x 21" - 41.1" H	120	60	Equivalent Airflow: 750 Laboratory Airflow: 340	3	3W x 2 LED (GU10 Base)	430

Package Contents

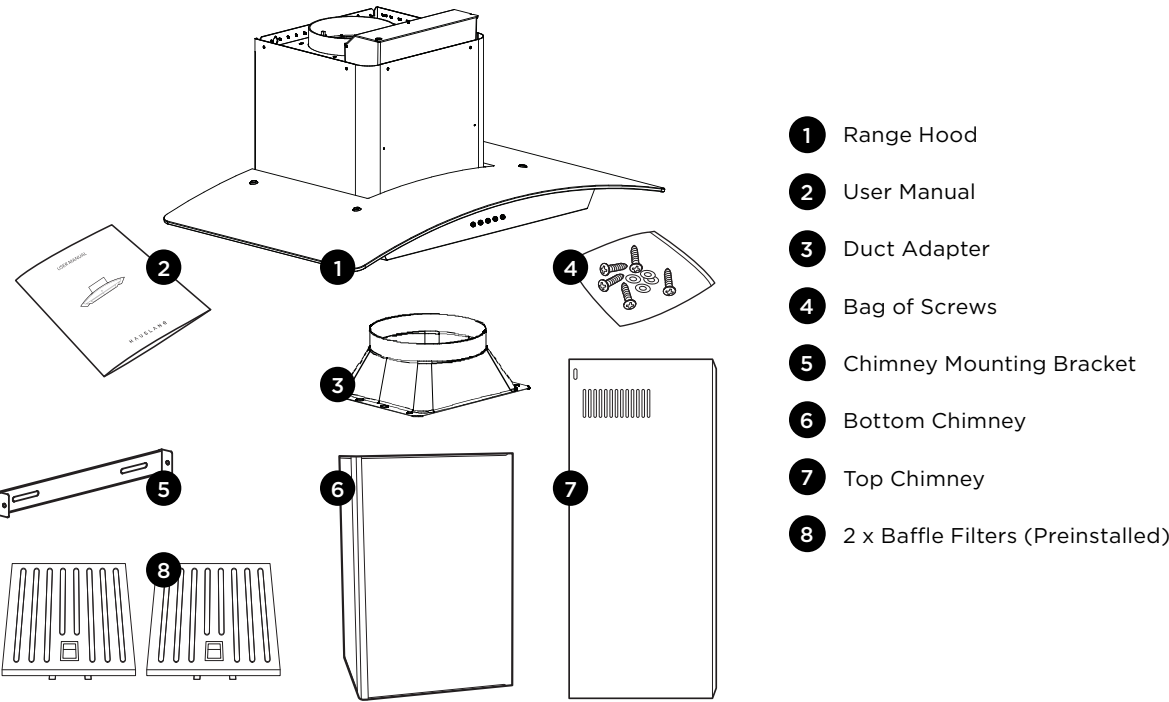

Parts Needed



Tools Needed

Before you begin the installation process, gather the following tools:

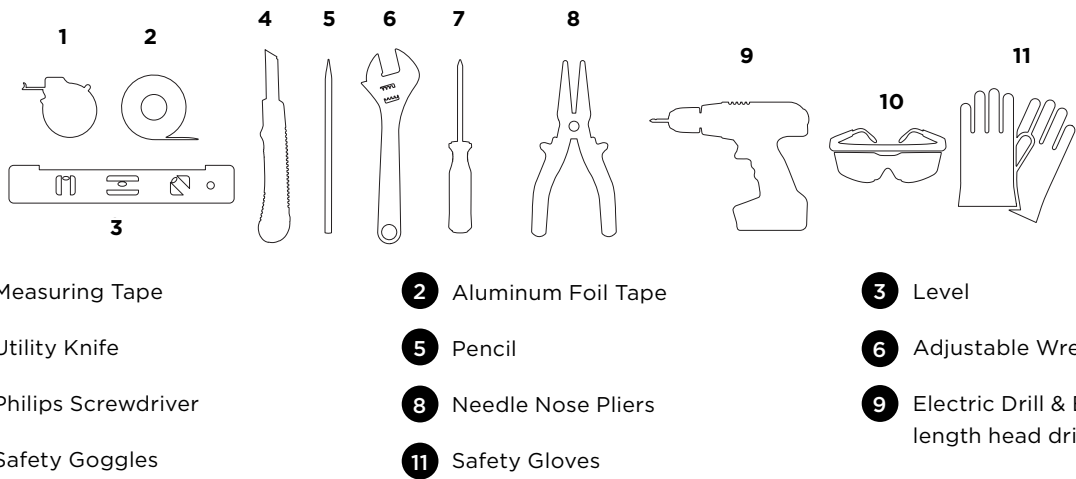

Preparation: What to Do Before Installation

Before installing your range hood, carefully follow these steps:

1. Read This Manual

Read through all the steps. If you fail to read the instructions carefully, we will not be responsible for damages incurred on your part. If you're not confident in your abilities to install the range hood properly, we recommend hiring a certified technician to complete the installation.

2. Remove Packaging

Open the box and carefully unbox the range hood. Remove any packaging, including the plastic wrap and protective plastic film, from the hood and the chimney covers. You can use stainless steel cleaner to wipe down the surface if desired. Keep all packaging materials until you are satisfied with our product.

3. Ensure There is Proper Height Clearance

To ensure the highest performance, the bottom of your range hood must be between 24" and 30" from the top of the cooking surface. For gas ranges, the required distance is 30". Do not exceed the maximum height of 30" while in operation.

This is very important! Installing at the incorrect height could lead to drastic reduction in the range's performance or even cause a fire.

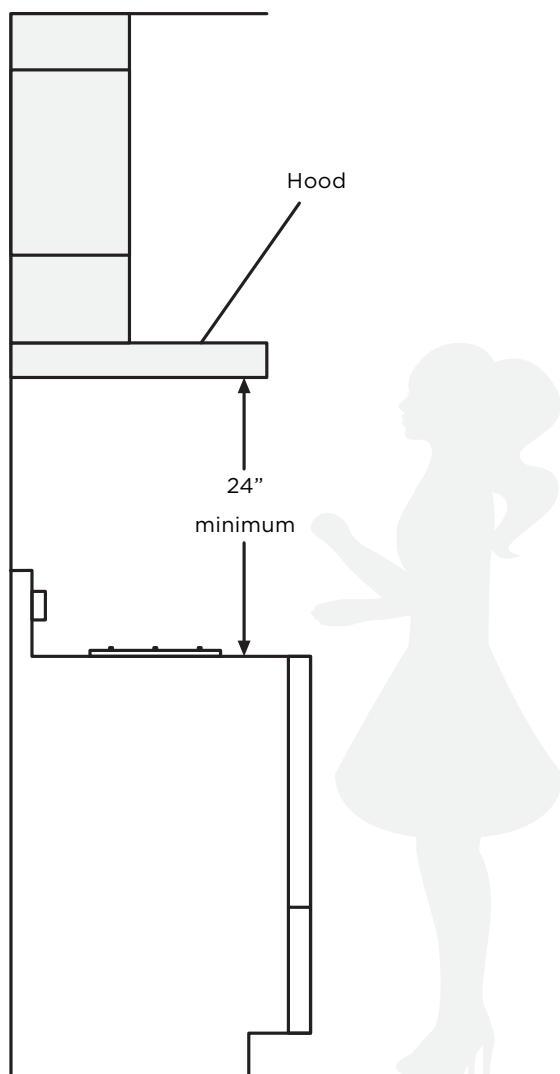

4. Check Your Power Supply and Ducts

Check to ensure your main voltage is in line with the required voltage outlined on the rating plate inside this hood. Also check the domestic power supply to guarantee adequate earthing before installation. When ducting to the outside, don't connect the range hood to exhaust ducts that carry any type of combustion fumes like fireplaces, boilers, or any similar items. The vents should have a short, straight run to the outside. Avoid any elbows if possible, and if an elbow is required, a minimum of a 12" straight run is imperative before the elbow.

5. Complete Duct Work (For Ducted Mode)

Decide where the ductwork (not included) will run between the hood and the outside. Please note that a straight, short duct will allow the hood to perform more efficiently. Install a roof/wall cap. Connect metal ductwork to cap and work back towards hood location. Check and properly tape all joints on ductwork to ensure proper connections.

Attach an adequate length of approximately 6 inches round duct to the air outlet adapter. The air must not be discharged into a flue that is used for exhausting fumes from appliances burning gas or other fuels. Be sure to fulfill all regulations concerning air discharge. Install a roof/wall cap. Connect round metal ductwork to cap and work back towards hood location. Use duct tape to seal the joints between ductwork sections. (The roof/wall cap should be sourced locally).

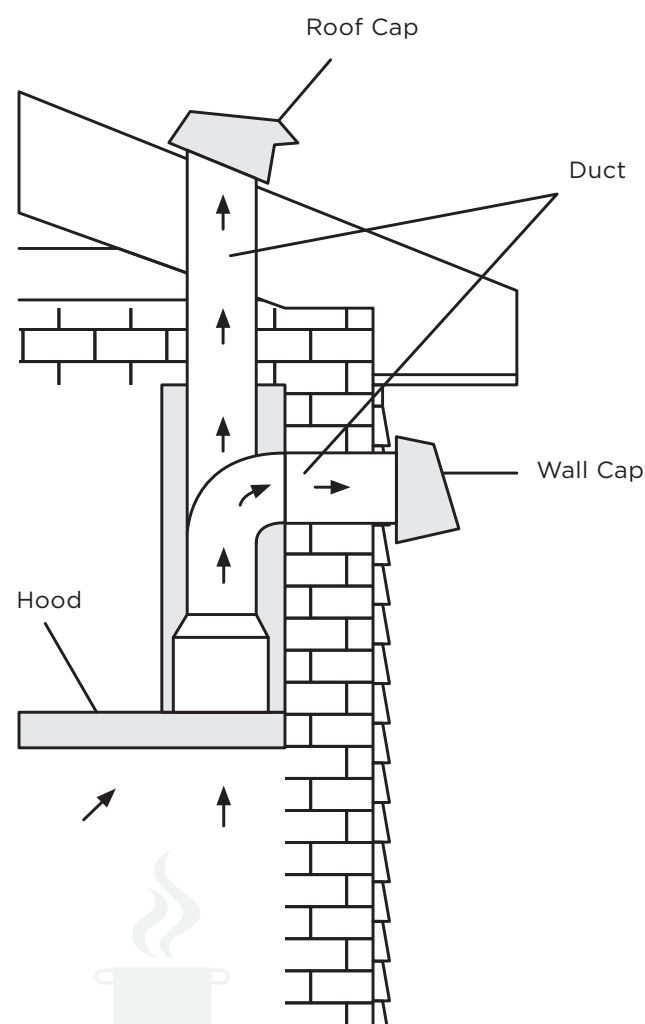

Preparation: What to Do Before Installation

6. Figure Out Ducting Requirements & Install Adapter

Install duct adapter by placing adapter on top of vent exit and securing the 4 screws (CC).

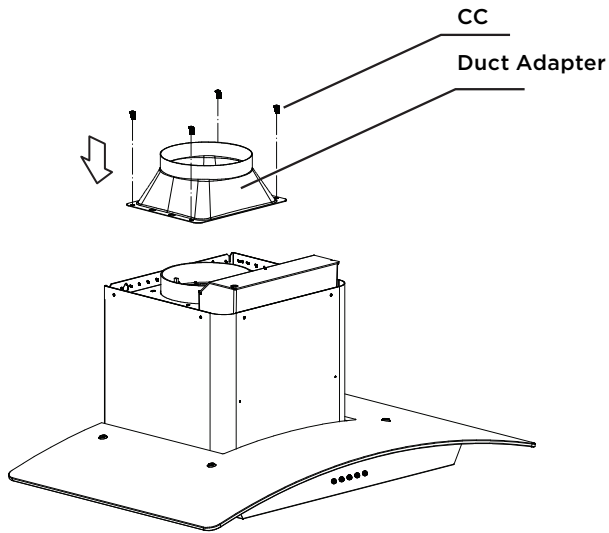

7. Find a Helper

This range hood is best installed by two or more people due to its size and weight. Again, it is recommended to hire a certified technician for installation to reduce the risk of damage or injury.

How to Install Your Range Hood

When you've completed all the preparation steps, you're ready to install your range hood.

1. Test the Unit

Check your range hood for damaged or missing parts. Plug it in to an outlet to ensure the fan and lights work. If anything is damaged or missing, contact the manufacturer to get the issues solved. Don't throw away packaging until you're sure you are fully satisfied with the product.

⚠ IMPORTANT: Power the range hood and test all functions before proceeding with the installation. If the range hood is not working properly, please contact us immediately (**1.800.929.0168 / info@hauslane.com**).

2. Drilling the Pilot Holes

- Mark a vertical center line (1) on the supporting wall up to the ceiling, or as high as practical, at the center of the area where the hood will be installed.
- Mark a horizontal line (2) above the range at the preferred distance between 24 to 36 inches (607-762 mm). Consult the user manual of your range if so required.
- Position chimney mounting bracket (C) on the wall as shown about 1 inch (25.4 mm) from the ceiling.

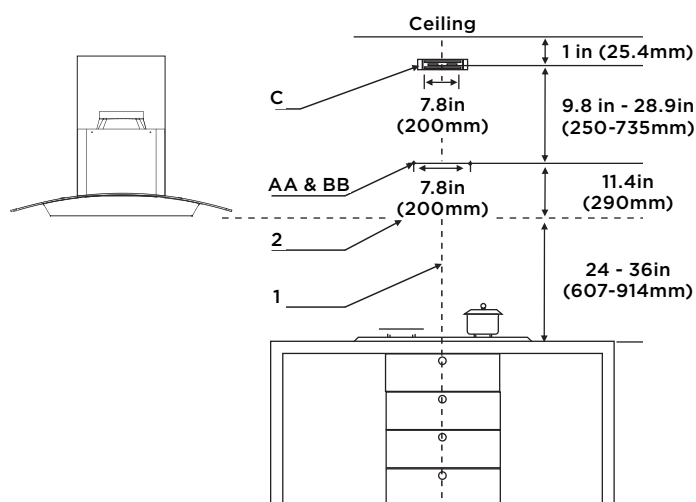

⚠ WARNING: For drywall or plaster walls, mounting screws must be secured to wooden wall studs or a support structure directly (without supplied anchors) or using fastening hardware appropriate for your wall type.

3. Mounting the Hood

Due to the size and weight of this range hood, the supports must be firmly attached to the wall. For drywall or plaster walls, range hood must be attached to a wooden wall stud. If this is not possible, a support structure must be built behind the plaster or drywall (preferred).

- Using a 3/8 in (9mm) drill bit, enlarge the pilot holes and insert the plastic wall anchors (BB) into the wall along the line that is 11.4 inch (290mm) above the horizontal line (2). Insert screws and leave a 0.25 inch (6.4mm) gap between the wall and the back of the screw head to slide the range hood into place.

Ensure the screws and anchors (AA and BB) are parallel with the horizontal line (2).

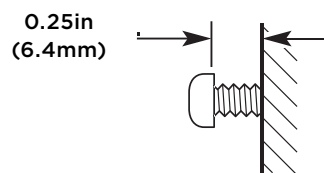

- Hook the hood body (A) onto the screws (AA and BB) mounted onto the wall and securely tighten the screws (AA and BB) to secure the hood body (A) on the wall.

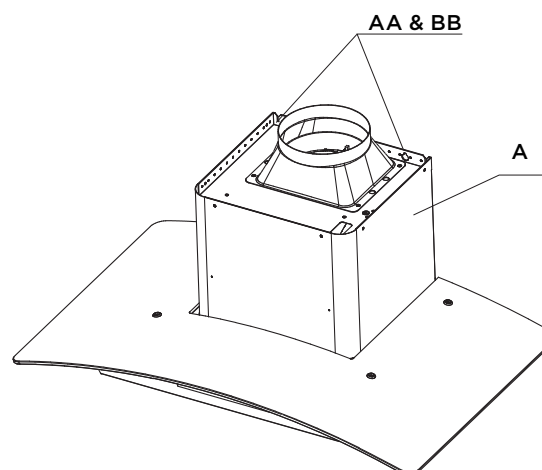

- Install two additional hood body mounting screws (AA) into the auxiliary mounting holes to secure the hood body (A) in place.

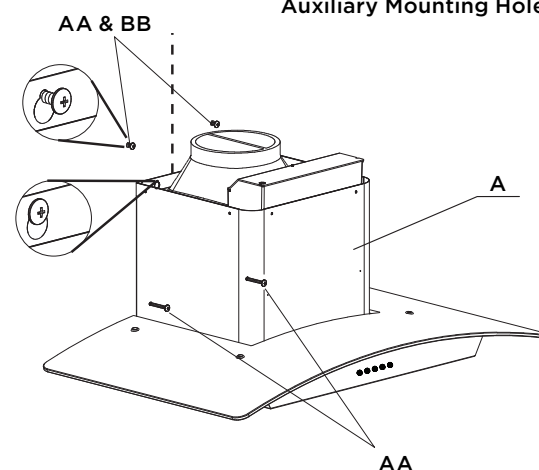
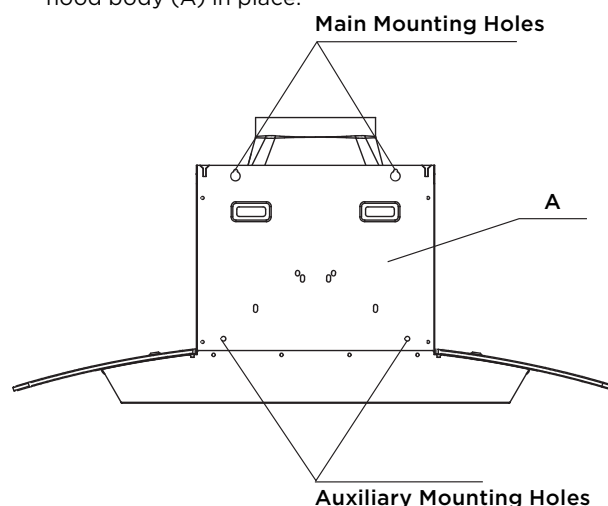

How to Install Your Range Hood

4. Attach Duct to Outlet Adapter (for Ducted Mode Only)

CAUTION: to reduce risk of fire, use metal ductwork only.

Now, attach an adequate length of 6-inch round duct (not included) to the top of the outlet adapter. Secure the duct, taping all joints to ensure proper connection. The max length of flexible duct is 59 inch.

Secure the duct. Check and properly tape all joints on the duct work to ensure proper connections.

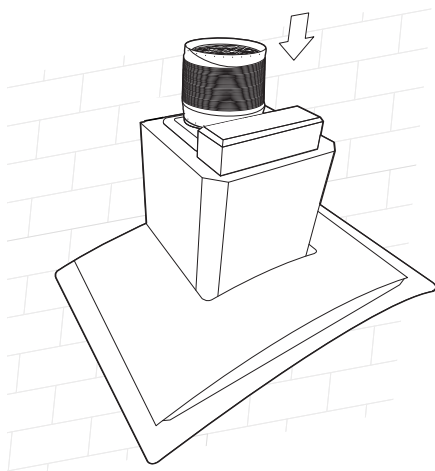

Chimney Top: Raise the top chimney (D) up inside the bottom chimney (C). Secure the top chimney (D) to the chimney mounting bracket (B) that is securely attached on the wall with the two chimney bracket screws (CC) supplied from two sides.

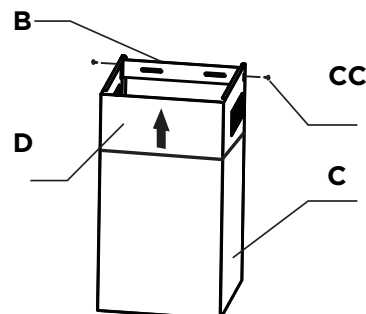

- Decide where the duct (Not included) will run between the hood and the outside.
- A straight, short duct run will allow the hood to perform most efficiently.
- Long duct runs, elbows, and transitions will reduce the performance of the hood. Use as few of them as possible. Larger ducting may be required for best performance with longer duct runs.
- Attach an adequate length of 6 inch flexible duct to the air outlet adapter.
- The air must not be discharged into a flue that is used for exhausting fumes from appliances burning gas or other fuels. Regulations concerning the discharge of air have to be fulfilled.
- Install a roof/wall cap. Connect round metal ductwork to cap and work back towards hood location. Use duct tape to seal the joints between ductwork sections. (The roof / wall cap should be sourced locally).

5. Telescopic Chimney Assembly

Chimney Bottom: Carefully slide the bottom chimney (C) down outside the top chimney (D), and then carefully place the bottom chimney (C) into the recessed area of the hood body top.

Optionally fix the bottom chimney (C) with the three chimney bottom screws (DD) supplied from inside of hood body.

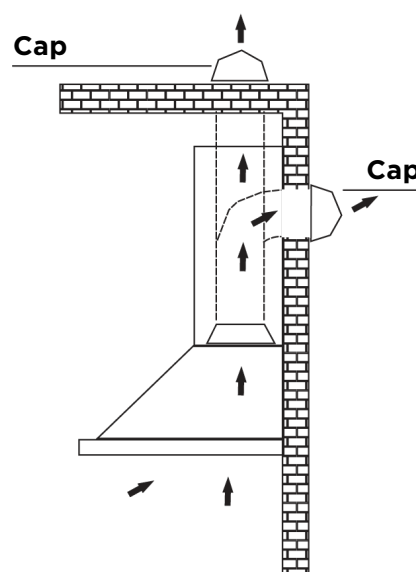
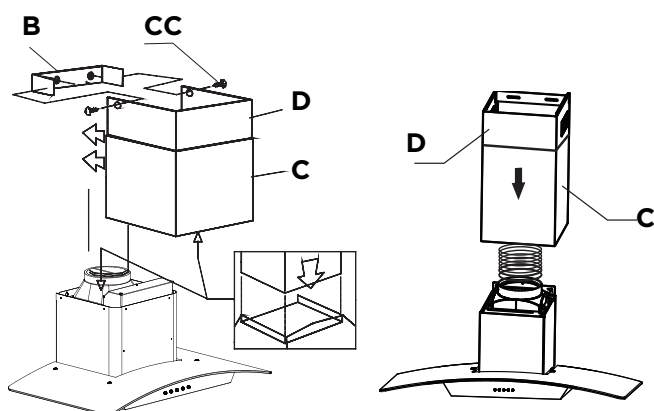

How to Install Your Range Hood

6. Install Charcoal Filter (Non-Ducted Only)

Easy to install. Just twist and lock into place on the blower.

Note: Charcoal filters are sold separately. Order part number **CFI011**. We recommend replacing the charcoal filter every 2 months or more frequently if in heavy used.

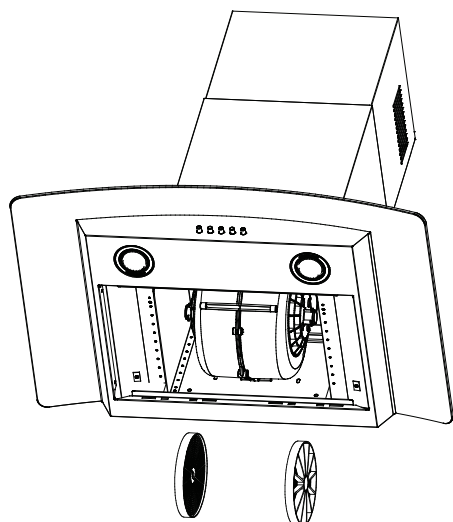

Please note that the air will flow out from the two grids on the two sides of the chimney top.

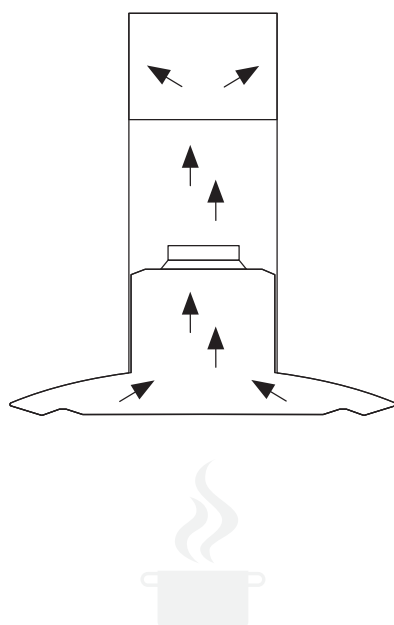

Be Careful with Electrical Connections.

⚠ WARNING: Electrical wiring must be done by a qualified person(s) in accordance with all applicable codes and standards. Turn off electrical power at service entrance before wiring.

⚠ WARNING: Do not use the plug and an extension cord other than the ones initially supplied with the hood.

⚠ WARNING: The ground connection of this hood is compulsory. Do not remove ground prong of the plug.

How to Use Your Range Hood

Now that your range hood is installed, it's time to learn how to use it. It is very simple to use and is operated entirely using the front control panel.

Using the Front Control Panel

Use the simple front control panel to turn the lights and fan on or off.

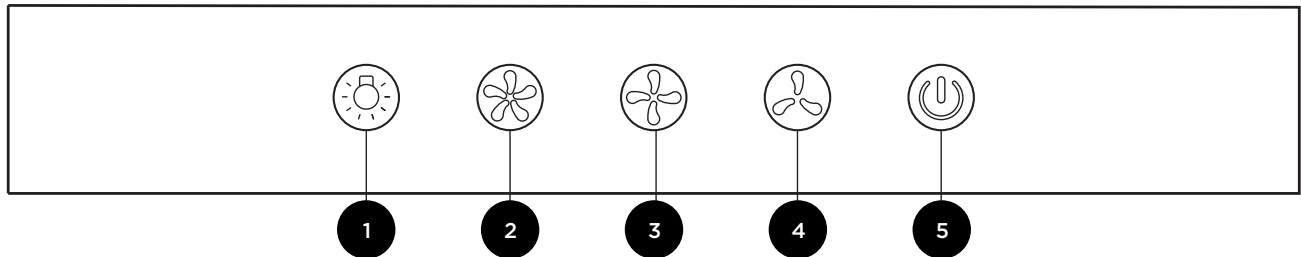

- 1 Light On / Off
- 2 High Fan Speed
- 3 Medium Fan Speed
- 4 Low Fan Speed
- 5 Power On / Off

Basic Maintenance Instructions

Your range hood requires some easy routine maintenance to keep it running efficiently.

Maintaining the Stainless Steel Baffle Filters

Clean the grease filters frequently—we suggest cleaning every 2 weeks, or more frequently for heavy use. For your convenience, the filters are dishwasher safe!

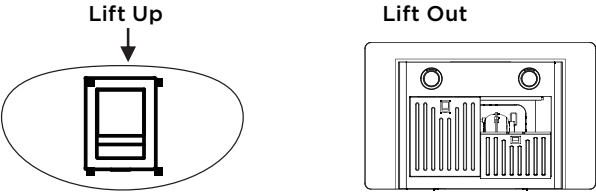

- 1. Remove the baffle filters by lifting up the latch. This will disengage the filters from the hood. Tilt the filter lift out and remove.
- 2. Wash the filters, taking care not to bend them. Allow them to be dry before replacing.
- 3. When replacing the filters, make sure that the latch is visible from the outside.

Replacing the Non-Ducted Recirculation Charcoal Filters

Charcoal filters are not included. Order part number **CFI011**. It is not washable and should be replaced approximately every 2 months, or more frequently for heavy use.

- 1. Install the charcoal filter by removing the grease filter and placing the charcoal filter on the side of the motor and turn to lock its position.
- 2. After placing the charcoal filter, re-install the grease filter.

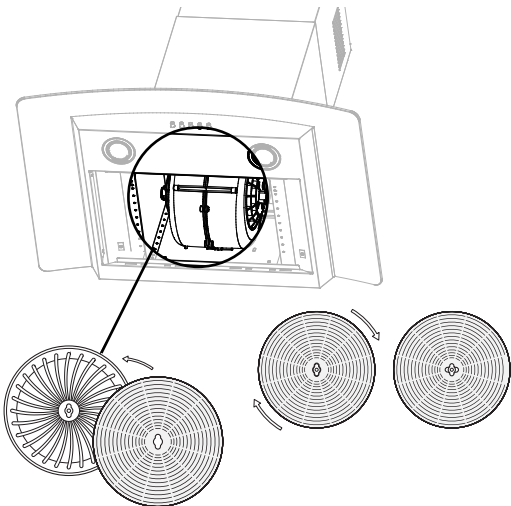

Maintaining the Lighting

CAUTION: Always switch off the electrical supply before replacing lamps.

This range hood uses two GU-10 LED 3W light bulbs.

- 1. Switch off power and wait for 5 minutes to ensure bulbs have cooled down.
- 2. Wearing protective gloves, rotate the light bulb counterclockwise to disengage the bulb.
- 3. Place the new light bulb into the socket and rotate clockwise until fixed.

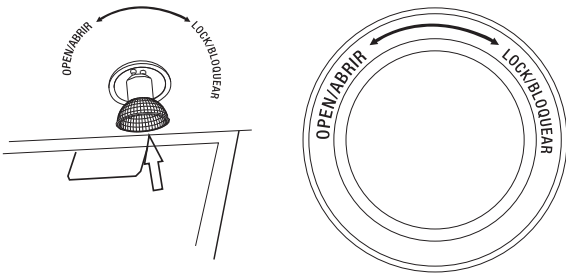

Cleaning the Range Hood

This range hood will look great and function correctly for a long time with proper care. Here are a few do's and don'ts when caring for your range hood.

WARNING: Failure to maintain basic standards of care and cleaning will increase the risk of fire.

Cleaning the Oil Cup

The oil cup is located in the motor blower and must be cleaned frequently. Do not let the oil cup get more than half full.

- 1. Remove the oil cup by sliding it out carefully.
- 2. To clean, simply use a warm detergent.
- 3. Allow the oil cup to dry before reinstalling.

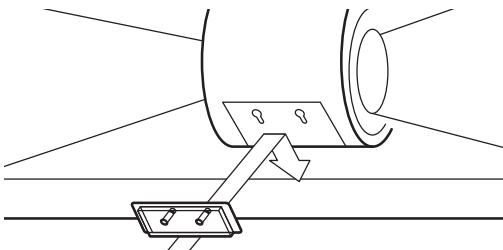

DO'S	DONT'S
Clean the range hood with warm, soapy cloth or a stainless-steel polish.	Don't use cleaners or cloths that are corrosive or abrasive. Don't use detergents with ingredients like chloride, iodide, or fluoride.
Clean the hood in line with the grain of the stainless steel.	Don't leave dirt or soap residue on the hood. This can damage the surface. Wash the hood's surface and rinse immediately with clean water.
After cleaning with soap, rinse with clean water and wipe with a clean, dry cloth.	Don't let particles, especially construction particles (from sanding, etc.) enter the hood. Cover the hood during room renovations.
Check the ducts and vents regularly to make sure they are not clogged.	Don't use flammable agents near the stove, as these can cause explosions.

Troubleshooting Tips

⚠ WARNING: Please turn off the power circuit or power breaker panel before troubleshooting this range hood. Failure to do so can cause death or serious injury.

PROBLEM	SOLUTION
My range hood won't work.	<ol style="list-style-type: none"> 1. Make sure the power supply and wiring are connected securely. 2. Double-check to see that the power breaker is on and the power supply is live. 3. Check to see that the control panel cables are connected correctly to the switchboards.
My range hood vibrates while the fan is operating.	<ol style="list-style-type: none"> 1. Check to ensure the hood is firmly secured to the cabinet/wall. Tighten or add screws if necessary. 2. Confirm that the motor is firmly in place and secured safely. If it is not, tighten it. 3. If those steps haven't resolved the issue, your fan may be damaged. If it is damaged, you may need to replace it.
The fan is operating weakly.	<ol style="list-style-type: none"> 1. Double-check to ensure the duct size is correct. 2. Clean ducts or filters if they're dirty. Also, check to make sure the mesh enclosure on the hood is receiving proper air ventilation. 3. If possible, check to see that the damper is functioning properly regarding the opening.
The fan is not working properly even though the lights are working.	<ol style="list-style-type: none"> 1. Double-check that the fan is not jammed /that it isn't scraping any of the surfaces of the hood. 2. If this doesn't work, you may need to replace the motor as it may be defective.
The vent hood is not working efficiently.	<ol style="list-style-type: none"> 1. The minimum distance between the cooking area and the appliance should be 24" or 30" maximum. Check to see if this is correct. 2. Make sure that the duct is not susceptible to easy wind opening. 3. Make sure the fan speed is at the appropriate rate. The heavier the cooking, the greater the speed of the hood should be set. 4. Closing the windows and doors in the room will allow the vent to work much better. 5. As noted during the installation process, all ductwork must be done correctly. You may need to reduce the length of ductwork or reduce elbows. 6. Make sure all joinery in ductwork is sealed and secured properly.
The light is not working.	<ol style="list-style-type: none"> 1. Check to see if lightbulb is loose and needs to be tightened. 2. If tightening doesn't fix the problem, replace bulb with a new one and see if that solves the issue. 3. If replacement and/or tightening does not solve, you may need to replace the lighting service system on the hood.
The touch panel is not responding.	<ol style="list-style-type: none"> 1. Perform a power cycle reset by unplug the power cord, wait 10 seconds, and plug the power cord back. 2. If Step 1 doesn't resolve the issue, please contact us immediately for a control panel replacement.

Still experiencing problems after following these steps?

Contact a technician to assist. Contact us at **1.800.929.0168** or **info@hauslane.com**.



Extended Warranties

If you are interested in an extended warranty, sign up on our website at **www.hauslane.com**



Parts and Accessories

If you need replacement parts or accessories, visit **www.hauslane.com**



Contact Us

We'd be happy to answer your questions or resolve any issues you may have.

Phone: **1.800.929.0168**

Email: **info@hauslane.com**



Find Us and Connect with Us

@HauslaneOfficial

