

Lighted Dust Solution for Miter Saws



Use caution when removing hood from the bag. It is spring loaded and will spring to shape when removed. Always follow safety recommendations and guidelines provided by the manufacturer of your tools. When in doubt refer to the applicable owner's manual or dealer.

Surround LED lighting improves visibility, enhances safety and accuracy
High Density Nylon 100%
Made in China
Hood Captures Dust And Directs Airflow To 4" Vacuum Port
Use With Shop Vass, Dust Collectors Or Installed Vacuum System
Foldable design, easy to store and transport
Suitable for all 10 inch miter saws.
Led light: 220/110Volts 6.6/1.1watt 0.03/0.01Amps
Item Dimensions: 2.40 x 24.00 x 20.00 in
Item Weight: 7.8 lbs
Package Dimensions: 4.50 x 22.20 x 19.50 in
Package Weight: 9.48 lbs

1. Assemble the stanchions

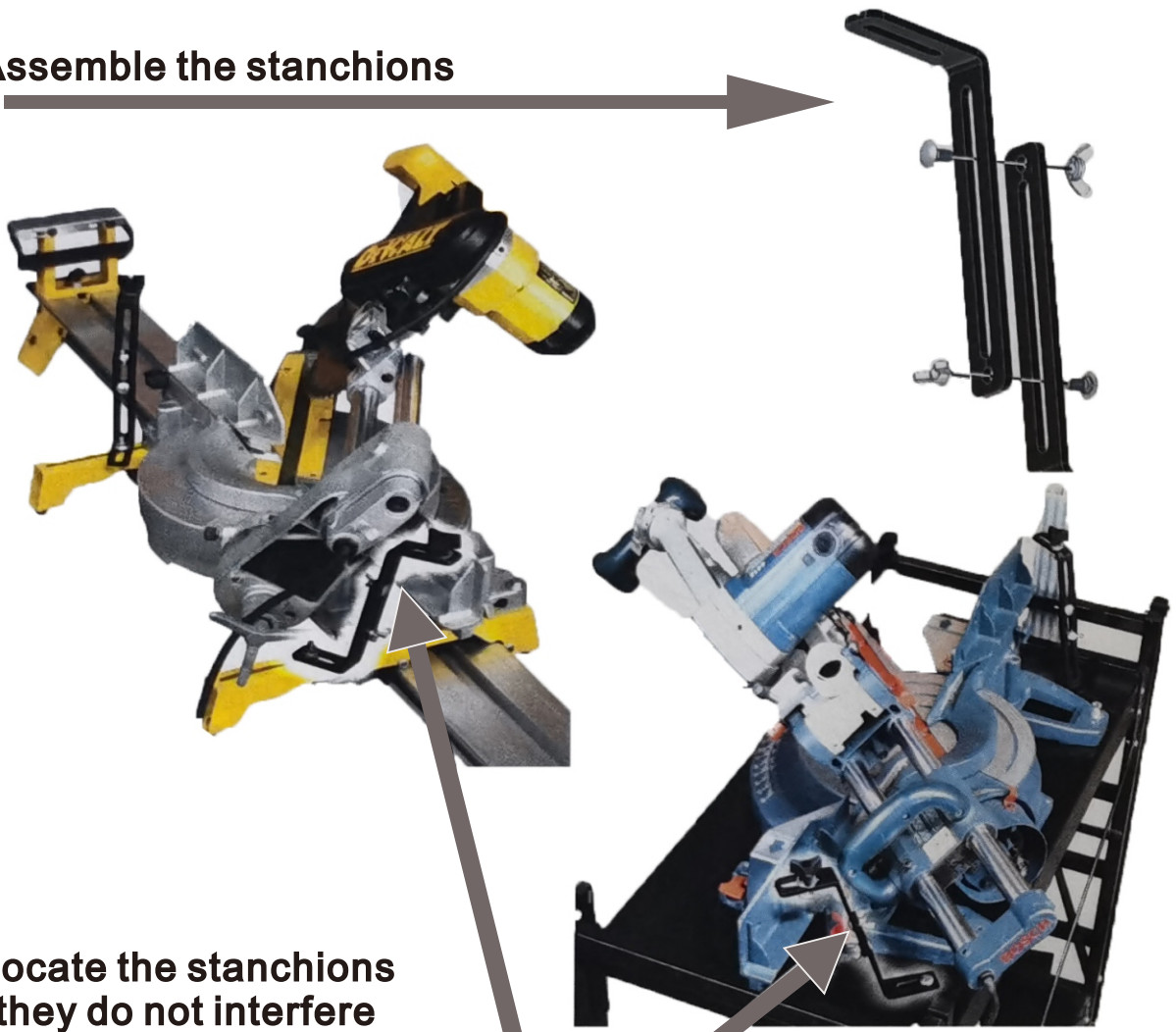

2. Locate the stanchions so they do not interfere with the saw at maximum bevel and angle.

3. Drill if necessary and bolt the stanchions to the tool platform with the 2" carriage bolts.



4. Use the 5 arm knob, flat washer and 1" carriage bolt to mount the hood on the stanchion.