

# ASSEMBLY INSTRUCTIONS



## CAUTION

◆ Inspect the wire insulation for any cuts, abrasions, or exposed copper that may have resulted during shipping. If there is a defect in the wire, do not attempt installation.

◆ Before starting installation of this fixture or removal of a previous fixture, disconnect the power by turning off the circuit breaker or by removing the fuse at the fuse box.

✉ If you need further assistance, please contact us by Email: [customersupport@superiordecorinc.com](mailto:customersupport@superiordecorinc.com)

## TOOLS REQUIRED



Ladder



Safety glasses



Electrical tape



Phillips screwdriver



Flat blade screwdriver



Pliers

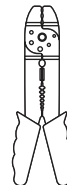

Wire strippers

## HARDWARE INCLUDED

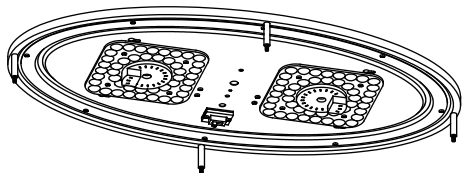

Fixture

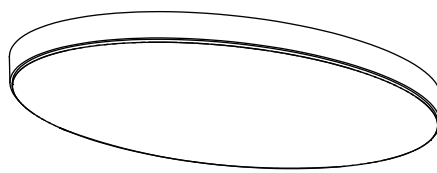

Shade

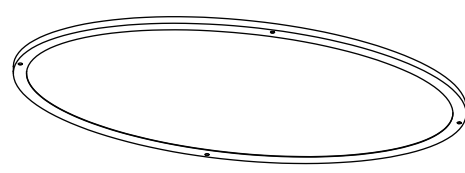

Decorative Circle

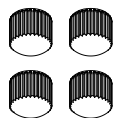

Ball Nuts A

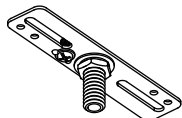

Mounting Unit

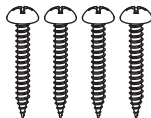

Wood Screws

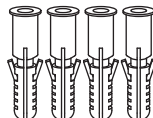

Plastic Anchors



Ball Nut B



Mounting Screws



Wire Nuts

\* PARTS SHOWN MAY DIFFER SLIGHTLY PER LIGHT FIXTURE

## EXPLODED PARTS

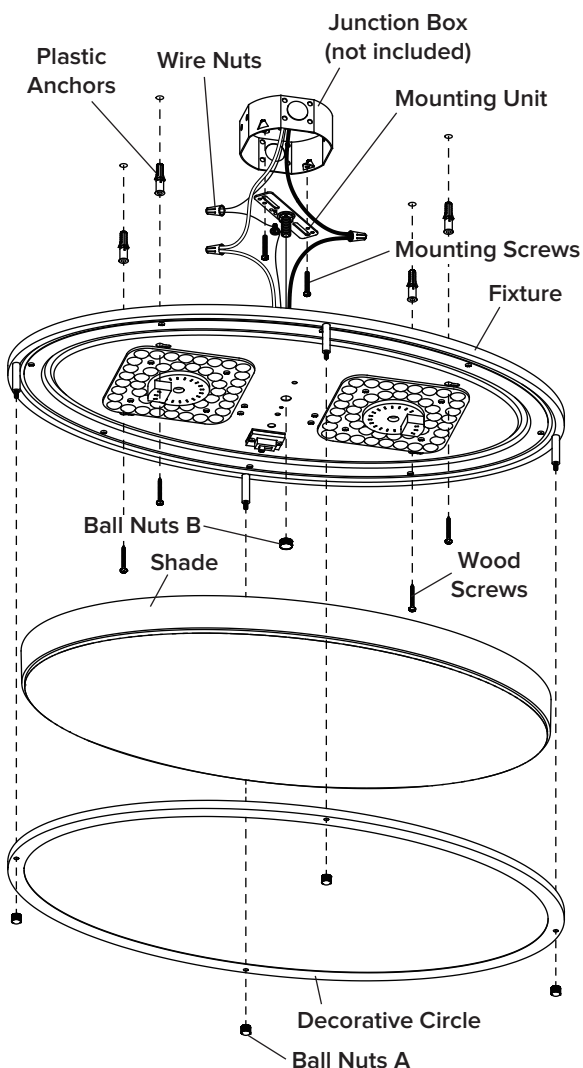

## INSTALLATION

### STEP 1

- Use the **mounting screws** to attach the **mounting unit** to the **junction box** (not included). Note: Please adjust the mounting unit so that the fixture will be installed in your desired position.
- Place the **fixture** in the desired position and install **fixture** using **ball nut b**.
- Mark the drilling position with a pencil. Next, disassemble the **fixture**.
- Using a 5/16" (8mm) drill bit (not included), drill holes in the marked areas.
- Insert the **plastic anchors** into the drilled holes.

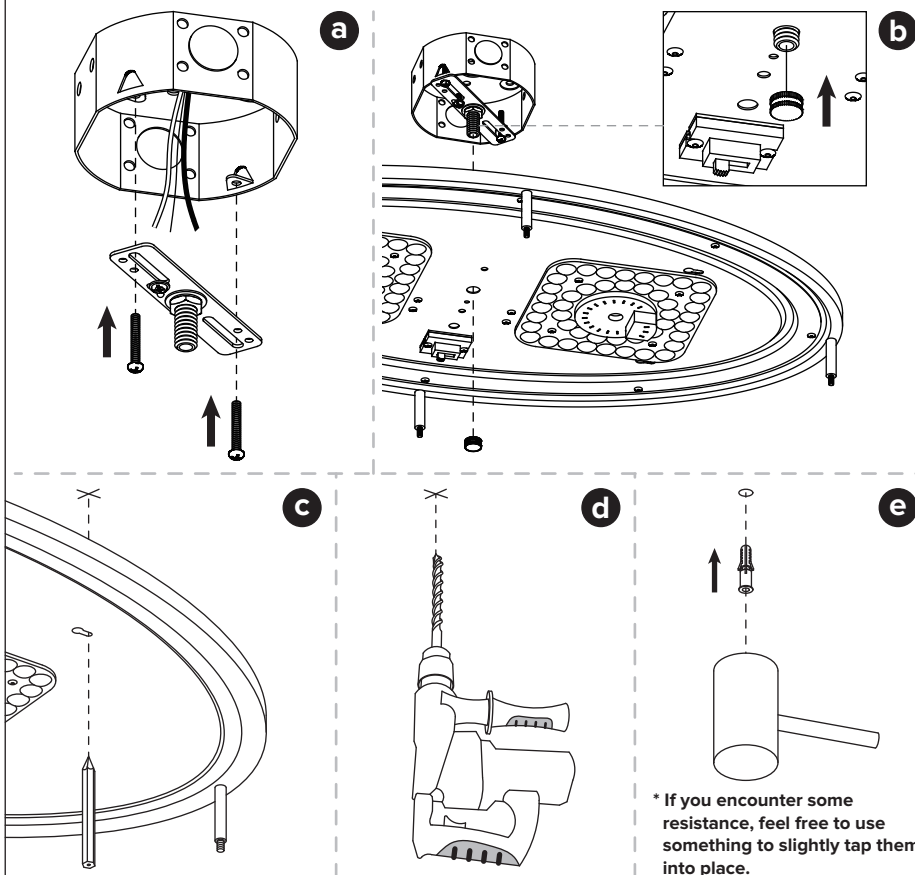

\* If you encounter some resistance, feel free to use something to slightly tap them into place.

## STEP 2

Make the electrical connection from the junction box (not included) to the **fixture**. Connect the ground wire to the **mounting unit** using the preinstalled green ground screw. Next, connect the live wire, neutral wire and ground wires with the supplied **wire nuts**. Secure with electrical tape.

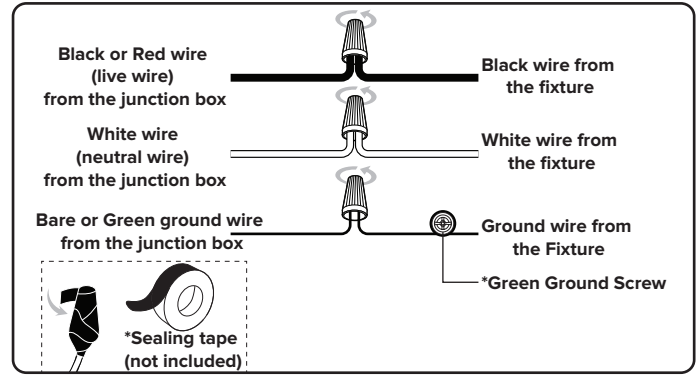
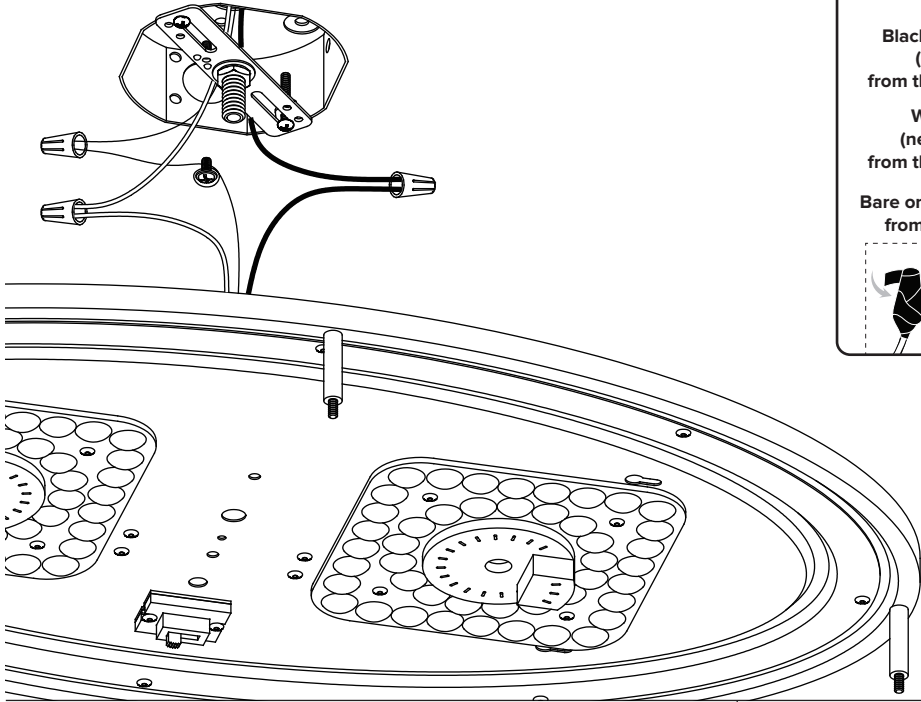

## STEP 3

Install **fixture** using **ball nut b** and **wood screws**.

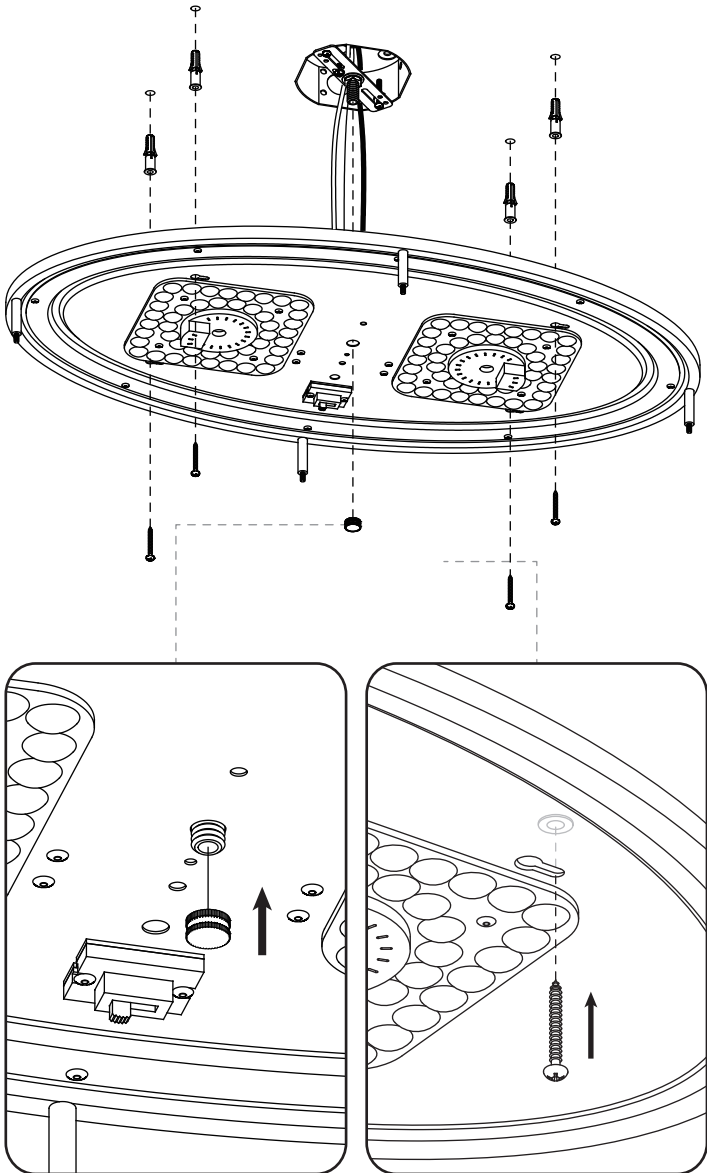

## STEP 4

1. Select the color temperature you need.
2. Use the **ball nuts a** to attach the **shade** and **decorative circle** to the **fixture**.

