

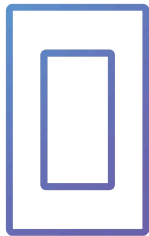

INSTALLATION GUIDE

ON-OFF KINETIC SWITCH KITS



Rocker Style Switch
(single or dual)

RW9-SSxx / RW9-DSxx



5A On/Off
Receiver

RW9-5C-B



**DON'T LIKE PAPER?
SCAN FOR DIGITAL GUIDE
& EXTRA TIPS/INFO**

Or Visit: runlesswire.com/install

RunLessWire On/Off Switch Kits are self-powered by kinetic energy - no batteries, no wiring, no Wi-Fi. The switch generates its own power every time you press it, sending a wireless signal up to 150 ft to the included receiver. Easily install the receiver, mount the switch wherever makes sense, and you're done. Works with standard wall plates, sticks to almost any surface, or works as a freestanding remote.

Perfect for retrofits, rentals, pull-chain fixtures, stairways, garages, and anywhere running a new wire just isn't worth it.

PACKAGE CONTENTS

- 5A Receiver
- Kinetic Rocker Switch
- Screwless Faceplate & Backplate
- Hardware Kit:

Command Strips, Mounting Screws & Wire Nuts

EQUIPMENT NEEDED

- Screw driver

CAUTION

- This product is intended for use indoors and dry locations only.
- Install and use in accordance with these instructions, electrical codes, and regulations.
- If you feel unsure or uncomfortable with any part of these instructions, consult an electrician.

SPECIFICATIONS

WIRELESS ROCKER SWITCH - PART# RW9-SSxx/ RW9-DSxx:

- WIRELESS RANGE:** 50-150ft (typical)
- FREQUENCY:** 902 MHz
- POWER SUPPLY:** Self-Generated when switch is pressed
- OUTPUTS:** Link to any number of receivers in range
- BUTTONS:** 2 Buttons - 1 Rocker(RW9-SSxx)
4 Buttons - 2 Rockers (RW9-DSxx)
- ADDRESSING:** Factory set unique ID (1 of 4 Billion)
- OPERATING TEMP:** -13° to +149°F (- 25° to + 65°C)
- DIMENSIONS:** 2.75(W) x 4.5(H) x 0.62(D) inches
- CERTIFICATIONS:** FCC (United States): SZV-PTM215U
I.C. (Canada): 5713A-PTM215U

5 AMP ON/OFF RECEIVER - PART# RW9-5C-B:

- WIRELESS RANGE:** 50-150ft (typical)
- FREQUENCY:** 902 MHz
- POWER SUPPLY INPUT RATING:** 100-240 VAC 50/60 Hz
- RELAY OUTPUT:** 1 Form A Relay 5A
- MAX LOADS/CONTACT RATINGS:** Resistive Load 5A, Tungsten 600W, Fluorescent 600W, LED Lamp 200W
- MEMORY:** Link up to 10 Switches / Sensors
- OPERATING TEMP:** -40°F to +140° F (-40°C - 60°C)
- DIMENSIONS:** 1.73 (W) x 2.61 (H) 1.09 (D) inches
- RADIO CERTIFICATIONS:** FCC ID: VJC-RW95CB, UL: pending

CHOOSE OPTIMAL RECEIVER INSTALL LOCATION

The long term reliability and wireless performance of the receiver is strongly influenced by the mounting location. Choose mounting location carefully.

FOR BEST PERFORMANCE:

- Create separation distance away from interfering electronics such as fluorescent tube ends, electronic transformers/power supplies, motors, etc.
- Obstructions of metal, concrete, and dense building materials will reduce the range. Mount higher and away from obstructions to maximize the range.
- Straighten antenna out and away from metal.
- A plastic junction box is recommended to maximize the range.
- Installation above a hot fixture may result in overheating or melting. Confirm operating environment does not exceed temperature specs.
- Site survey tools are available to help fine tune wireless communications.

RECEIVER INSTALLATION

(See digital guide for more details & wiring diagrams)

The receiver requires a neutral wire and can be installed at the original switch, fixture, or outlet locations. If neutral wires are not present at switch location, install receiver at fixture location.



WHEN DEALING WITH ELECTRICAL WIRES, ALWAYS POWER OFF CORRESPONDING CIRCUIT BREAKER

1. Access & identify circuit wires by removing original light switch, light fixture, or wall outlet.
 - TIPS:**
 - Neutral wires are normally white and if not connected to original switch, they are sometimes tucked back in the box.
 - Ground wires are green/copper and not needed for install. If present, leave alone or cap off with a wire nut.
 - The line wire brings power from the breaker
 - The load wire brings power from the fixture.
2. Connect receiver wires:
 - Black wire connects to Power In / Line wire
 - White wire connects to Neutral wire
 - Blue wire connect to Power Out / Load wire

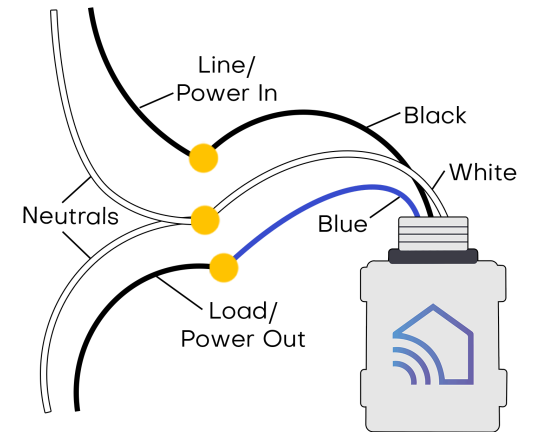

3. Turn breaker ON to test button switch, then back OFF prior to tucking wires and receiver back into junction box.
 - SWITCH LOCATION:** Cover with a blank faceplate or mount wireless switch (see option 2 on next page).
 - FIXTURE LOCATION:** Re-attach light fixture.
 - OUTLET LOCATION:** Re-attach outlet and cover.

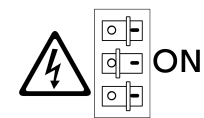

4. Turn the breaker back ON to use, and enjoy!

MOUNTING WIRELESS SWITCH

OPTION 1: MOUNT ON FLAT SURFACE / REMOTE

1. Use small screws to attach switch to backplate
2. Press faceplate onto switch, click into place
3. Use command strips to mount on any flat surface, or use as a remote

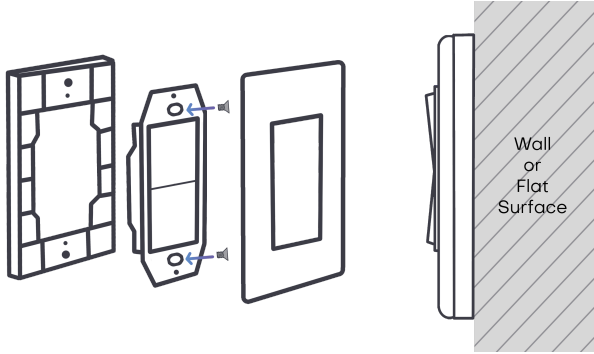

OPTION 2: MOUNT AT WALL SWITCH LOCATION

1. Use large screws to attach switch to junction box
2. Press faceplate onto switch, or use smaller screws to attach standard or multi-gang faceplate (BACKPLATE NOT NEEDED).

RunLessWire Screwless Faceplate:

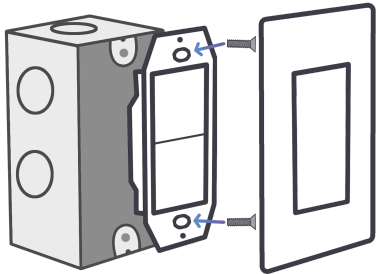

Standard or Multi-Gang Faceplate:

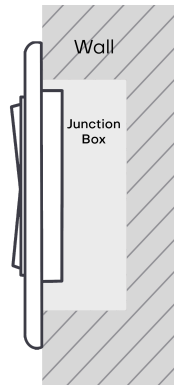
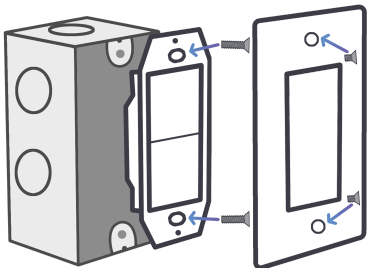

TROUBLESHOOTING

CONFIRM RECEIVER IS WIRED CORRECTLY:

Test the status light on the receiver by pressing the CTRL button. Green means the output should be ON, no light means the output should be OFF. If the status light is not working, that indicates the power is not ON, wiring is incorrect, or the receiver has been damaged. Try tapping the button a few times to get the light to turn on. If the status light turns ON, but the light doesn't turn ON, the wiring could be incorrect or it could be a bulb failure.

CONFIRM SWITCH IS FUNCTIONAL:

Press the top of the switch to turn the receiver ON and the bottom of the switch to turn it OFF. If the receiver doesn't respond, the switch may not be linked.

LINK/UNLINK SWITCH TO RECEIVER:

ALL KITS COME PRE-LINKED, ONLY DO THIS TO ADD OR REMOVE SWITCHES OR RECEIVERS

1. Press button on receiver for 3 seconds until receiver begins to toggle on/off.
2. Press TOP of switch 3 times quickly to link switch to receiver, or BOTTOM of switch 3 times to unlink.
3. The LED and output will pause ON for 3 seconds if linked, or OFF for 3 seconds if unlinked.
4. Wait for linking mode to time out (30 seconds).
5. Test switch to ensure it's linked properly.

FCC Warning: This device complies with part 15 of the FCC Rules. Operation is subject to the following two conditions: (1) This device may not cause harmful interference, and (2) this device must accept any interference received, including interference that may cause undesired operation.

Note: The Grantee is not responsible for any changes or modifications not expressly approved by the party responsible for compliance. Such modifications could void the user's authority to operate the equipment.

Note: This equipment has been tested and found to comply with the limits for a Class B digital device, pursuant to part 15 of the FCC Rules. These limits are designed to provide reasonable protection against harmful interference in a residential installation. This equipment generates, uses and can radiate radio frequency energy and, if not installed and used in accordance with the instructions, may cause harmful interference to radio communications. However, there is no guarantee that interference will not occur in a particular installation. If this equipment does cause harmful interference to radio or television reception, which can be determined by turning the equipment off and on, the user is encouraged to try to correct the interference by one or more of the following measures:

- Reorient or relocate the receiving antenna
- Increase the separation between the equipment and receiver
- Connect equipment on a different circuit to troubleshoot.
- Consult the dealer or an experienced electrician for help.

Questions? We're happy to help!

support@runlesswire.com

866.600.2111

 RunLessWire.com

DIMENSIONS

