



# Locking Engineered Hardwood Flooring on Wall

## Installation Instructions Horizontal Accent Wall

Although originally designed as a durable floor covering, many consumers have started using Pergo locking engineered hardwood flooring on walls to give their rooms more character and to create a feature or accent wall.

Locking engineered hardwood can be utilized as a decorative covering over an existing clean, dry, secure and vertical wall that meets local building code requirements. The wall substrate should be primed or painted drywall (gypsum board) only. Do not install directly over wallpaper or paneling. Locking engineered hardwood is not intended to be used on ceilings, countertops or as any type of structural material.

The installation wall should only run vertical to the floor. Sloping walls and surfaces that are parallel to the floor, such as ceilings or soffits, should not be selected. Limit installations to a maximum of 40 feet in length and a maximum of 10 feet in height.

Locking engineered hardwood is suitable for an accent wall when used in climate controlled (35-55% RH and 60-80° F) indoor installations only. Acclimate unopened product lying flat in the room where it is to be installed for at least 48 hours. Mix planks from different cartons as you install to maximize the natural appearance.

Check wall for moisture, visible water stains or leaking windows. Do not install locking engineered hardwood over a wall with known moisture damage. Do not install in areas near water sources such as a backsplash over a sink or bathtub. Acceptable job site conditions, including relative humidity and wall moisture conditions, must be maintained throughout the life of the locking engineered hardwood application.

Check wall for flatness within 3/16" over 10 feet. Correct any unevenness before installing to allow the locking engineered hardwood planks to lie flat without rocking.

The following requirements are not intended to supersede federal, state or local building codes, but as with many other interior finish products, may require modifying existing structural components for successful installation. Owner assumes responsibility for compliance with all building codes, including maintaining the required distance from heat sources such as fireplaces.

**WARNING:** For a safe and secure installation, this product **MUST** be installed in accordance with these installation instructions.

### Tools Required for Installation:

- Caulk gun
- Utility knife
- Stud finder (electronic)
- Carpenters level or laser level
- Chalk line
- 18 gauge brad nail gun (electric or air)
- Tape measure
- Pencil
- Screw gun or drill driver
- Safety glasses
- Dust mask
- Gloves

### Materials Required for Installation:

- 1-1/2" – 1-3/4" brad nails
- 100% silicone adhesive caulk (clear)
- 1-1/2" – 1-3/4" dry wall screws
- Painters tape

### Other Tools and Materials:

- Step ladder
- Hammer
- Uniclic® appropriate tapping block
- Pull bar
- Saw for cutting locking engineered hardwood planks
- Pry bar (for removing existing base or trim)
- Wall base and quarter round moldings (to frame out accent wall)

Measure the length and width of the wall area to determine the total square footage area. Order that amount of flooring plus an additional 10% for incorrect cuts.

Remove baseboards from the accent wall and locate the wall studs using the stud finder tool. Mark vertical lines over all studs. Use painters tape to extend stud location to ceiling if needed. (Figure 1)

Turn off power while working around wall outlets and light switches. Pay special attention to avoid contact with electrical wiring.

Inspect each plank for damage before installing. (Figure 1a)  
Do not install damaged planks.

Select planks of varying lengths for the first row. Choose plank lengths so that each plank will be nailed to at least one stud.

Lay the planks on the floor with the face side up and the groove side toward the wall. Assemble the short ends of the planks together and measure length to fit the first row (bottom).

Cut the last piece as needed leaving a 3/16" gap against any adjoining walls, if applicable. (Figure 2)

Flip the planks over (it is ok if they become disconnected from each other). Apply a bead of 100% silicone adhesive caulk to the back side of each locking locking engineered hardwood plank in the first row. (Figure 3)

**NOTE:** You may need to adjust placement of the first plank row to account for any floor unevenness so that the first row is perfectly straight and all end joints remain square and tight.

Starting on the right, press plank 1 of row 1 against the wall with the long side groove facing up towards the ceiling. Repeat this process for each plank in row 1, being sure to properly connect the short side joints to be tight and square. Continually check and adjust the level of row 1 as you progress from right to left. (Figure 3A)

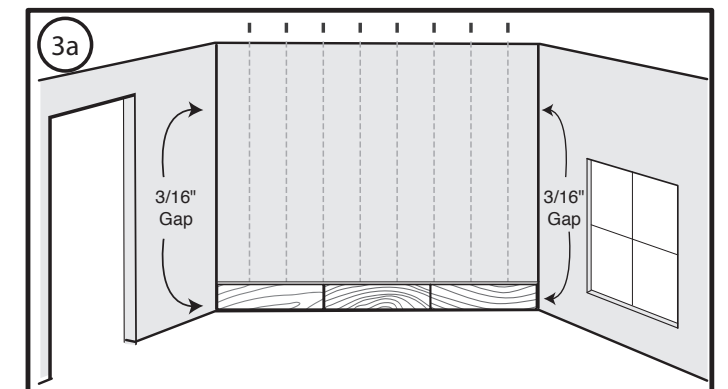
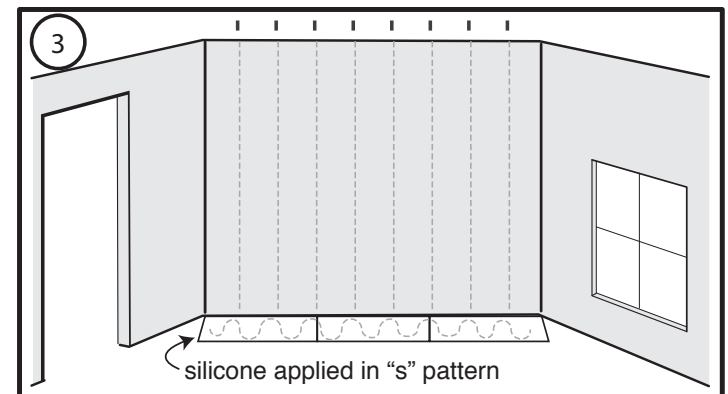
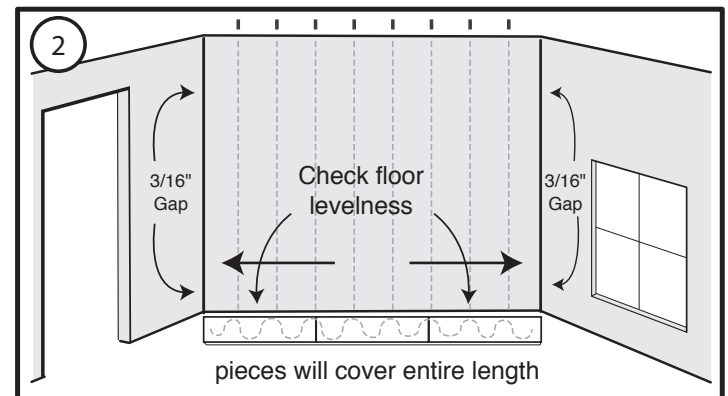
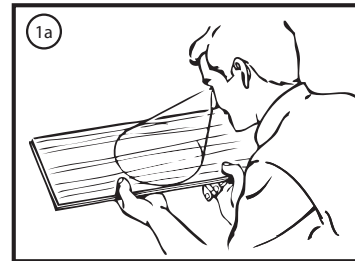
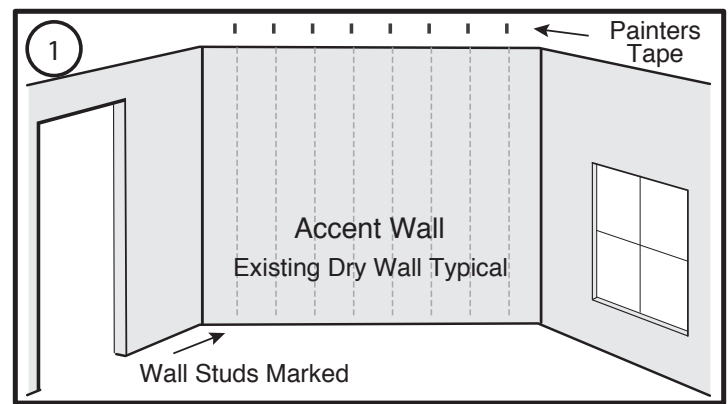

Drive a brad nail into each plank at each wall stud through the shallow area of the extended groove (see inset diagram). Take care that the brad nail heads are not raised, but also don't force them all the way through the groove. This will allow easy connection of the next row of planks. You must also place drywall screws every 16" into the wall studs or the sill plate along the bottom edge of the first row of planks where they will be covered by the wall base. For the best results, predrill the holes for the drywall screws. (Figure 4)

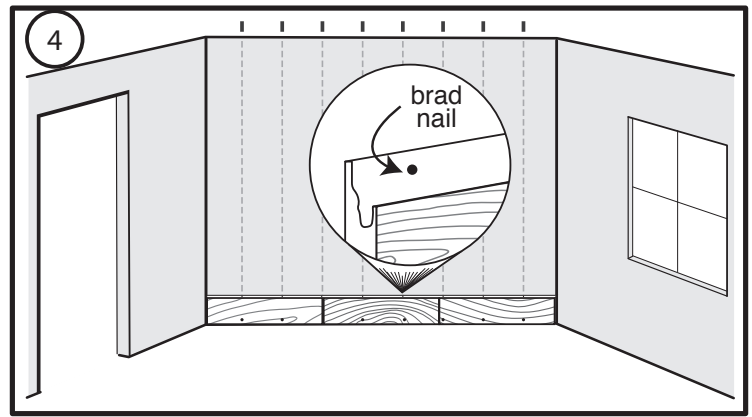

Start the second row from the right side. Cut and glue with silicone adhesive caulk the first plank. Fit plank by angling tongue into groove of row 1 and wiggle into place. Leave a  $\frac{3}{16}$ " gap against the adjoining wall. Use tapping block as needed to tighten the long side joint. Drive a brad nail into each plank through the shallow area of the extended groove at each wall stud. (Figure 5)

**NOTE:** A joint "stagger" of 8 to 12 inches looks most natural. Avoid allowing plank ends to align.

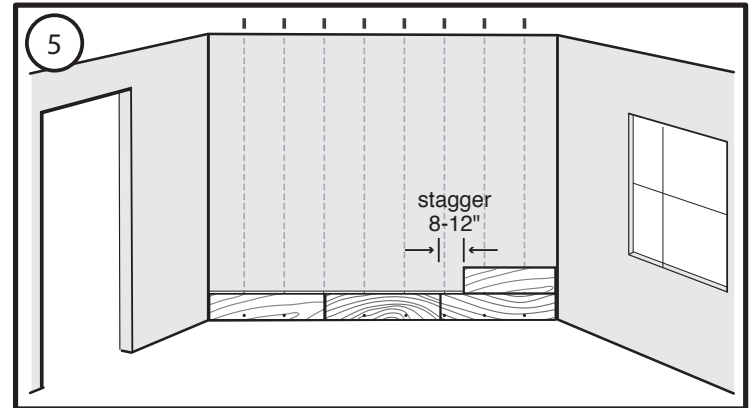

For plank 2 of row 2 (and each plank thereafter in row 2), first apply silicone adhesive caulk in an "S" pattern to the back of the plank. Insert the long side tongue into the long side groove of row 1. While holding plank 2 at approximately a 45 degree angle to the wall, slide plank 2 of row 2 to the right until the short end just touches the short end of plank 1 in row 2. Rotate plank 2 towards the wall to engage both the long side and short side joints. (Figure 6)

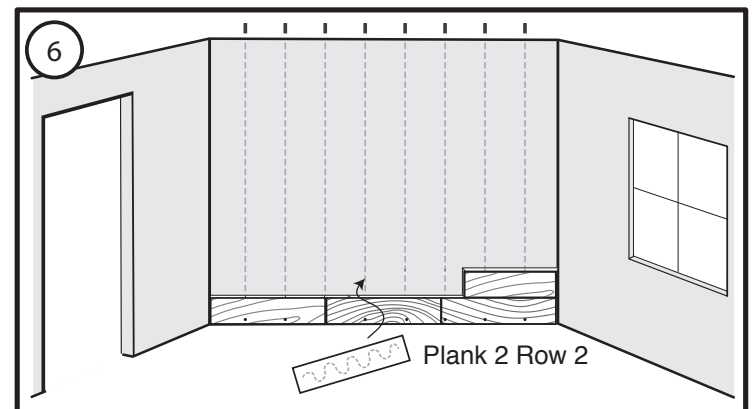

Tighten long side joints as needed with a tapping block or pull bar. Drive a brad nail into each plank through the shallow area of the extended groove at each wall stud. Repeat this process for the remainder of row 2, being sure to cut the last plank to leave a  $\frac{3}{16}$ " gap against the adjoining wall. (Figure 7)

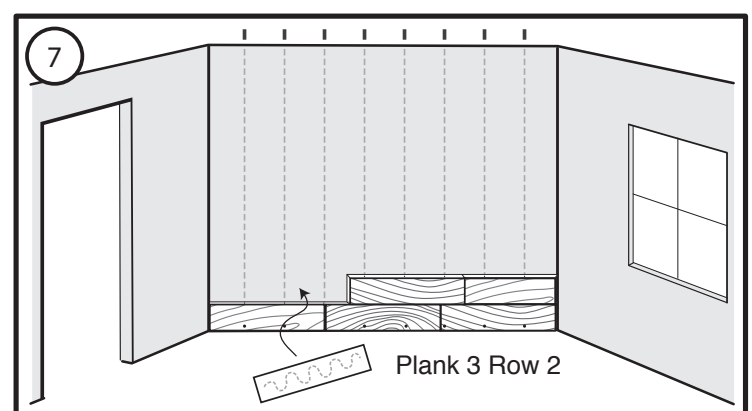

Repeat this process for each plank working your way up to the last row. (Figure 8)

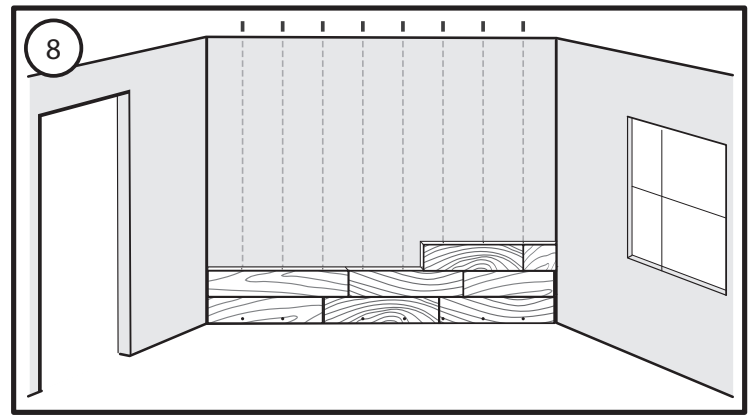

For the last row of the installation, use painters tape to mark the stud location for brad nailing. Cut the planks for the last row to the correct width and complete the installation as you have the earlier rows. (Figure 8A)

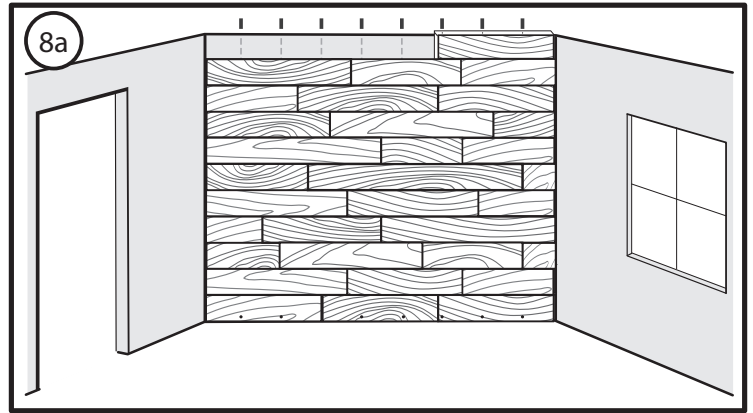

Use quarter round for inside corners and ceiling. Finish with wall base board of your choice. (Figure 9)

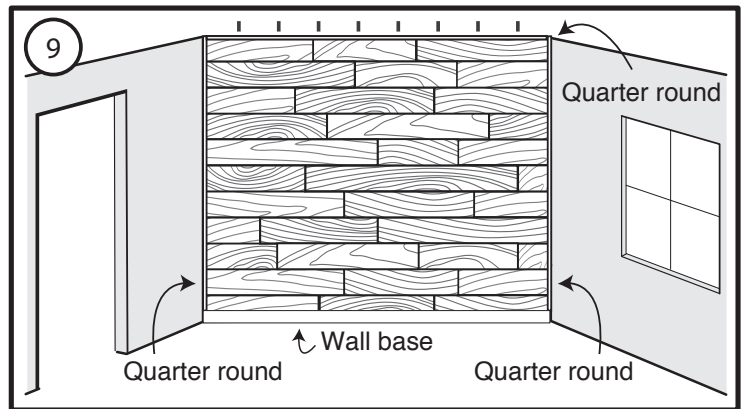

## Care and Cleaning

**Dry wipe** as primary cleaning method. Occasionally damp wipe with water only. **NO wet washing. DO NOT** use detergents, abrasive cleaners, soaps, waxes or polishes. Wipe off spills immediately. **DO NOT allow moisture to remain on the product surface for longer than 30 minutes.**

**DO NOT** attach objects such as pictures, shelves or television mounts directly to the locking engineered hardwood wall. **DO NOT** apply adhesive backed hooks or install screws or nails into the locking engineered hardwood wall for hanging objects. Instead, drill clearance holes through the locking engineered hardwood and mount these objects directly to wall studs with screws or nails. Drill the clearance holes through the locking engineered hardwood at least ¼" larger than the diameter of the fastener that will be used.

**Precautionary Measures:** Power tools should be equipped with a dust collector. If high dust level are encountered use an appropriate NIOSH designated dust mask. Avoid dust contact with skin and eyes. First Aid Measures in case of irritations: In case of irritation flush eyes and skin with water for at least 15 minutes.

### **ATTN: INSTALLERS Caution: Wood Dust**

Sawing, sanding and machining wood products can produce wood dust. Airborne wood dust cause respiratory, skin and eye irritation. The International Agency for Research on Cancer (IARC) has classified wood dust as a nasal carcinogen in humans.

# Limited Warranty For Wall Installations Only

## Pergo Limited Lifetime\* Residential Warranty

Pergo, LLC ("Pergo") provides the following lifetime residential warranty to the original purchaser for as long as he or she owns the product. This warranty applies to the first owner and the first installation of the product and may not be transferred. The "first owner" is the person stated as the buyer on the purchase document(s). This warranty applies only to first quality Pergo brand products purchases made after the edition date of this warranty. The limited warranty does not cover any damage that occurs during shipment or installation.

## Manufacturing Defects

Pergo hereby warrants to the original owner ("Buyer") their Pergo locking engineered hardwood product will be free from manufacturing defects for as long as Buyer owns the product. Hardwood is a natural product and may have naturally occurring variations in grain and color, mineral streaks and knots. The owner/installer of a Pergo hardwood product must use reasonable selectivity and hold out or cut off objectionable naturally occurring blemishes prior to installation.

## Finish Warranty

Under normal use conditions, Pergo hereby warrants to the original owner ("Buyer"), the factory applied finish of their Pergo hardwood product will not wear through or will not lack finish adhesion for as long as the original Buyer owns the product. Diminished gloss is not considered wear through of the finish. In the event the finish wears through or releases from the Pergo hardwood product, Pergo will, at its option, repair or replace the affected planks or area, prorated over the remaining life of the warranty.

## Structure Warranty

Under normal use conditions, Pergo hereby warrants to the original Buyer of the Pergo hardwood product that the plies will not separate for as long as the Buyer owns the home. Pergo will, at its option, repair or replace any defective planks at no cost to the Buyer.

## Jobsite Conditions

Pergo recommends all Pergo hardwood products be acclimated before installation. The purpose of acclimation is to allow the moisture content of the hardwood product to adjust to "normal living conditions" at the site. These are the temperature and humidity conditions that will typically be experienced once the structure is occupied. The room temperature must be within a range of 60-80 degrees Fahrenheit, with a relative humidity between 35% and 55%. These environmental conditions are specified as pre-installation requirements and should be maintained for the life of the product. Environmental conditions consistently outside of these parameters could result in product performance problems that would not be covered under this warranty.

## Pergo's Responsibility:

In the event Pergo determines one or more of the above warranty conditions apply to a claim by the original Buyer, the Buyer's exclusive remedy and Pergo's sole liability on any claim, whether in tort, contract, or breach of warranty, shall be limited to either (1) the repair or replacement of the defective Pergo hardwood product material only for the affected areas only, or (2) the refund of the applicable purchase price. Labor costs for removal and/or installation or repair associated with a warranty claim are not covered. PERGO HEREBY DISCLAIMS ALL OTHER WARRANTIES WHATSOEVER, EXPRESSED OR IMPLIED, INCLUDING ANY WARRANTY OF MERCHANTABILITY OR FITNESS FOR A PARTICULAR PURPOSE. IN NO EVENT SHALL PERGO HAVE ANY OTHER LIABILITY OR ANY MONETARY LIABILITY TO THE BUYER IN EXCESS OF THE PURCHASE PRICE OF THE PERGO HARDWOOD PRODUCT. PERGO EXPRESSLY EXCLUDES AND SHALL NOT BE RESPONSIBLE FOR INCIDENTAL OR CONSEQUENTIAL DAMAGES OF ANY KIND. If Pergo shall elect to repair or replace any defective Pergo hardwood product, then Pergo will supply a new Pergo hardwood product of the same color and grade, if available. If such Pergo hardwood product is not available or discontinued, Pergo reserves the right to supply a Pergo hardwood product of similar value and appearance.

**\*This Limited Lifetime Residential Warranty is pro rata.** A pro rata warranty is one that provides a refund or credit and decreases according to a set formula as the warranty period progresses. The original warranty value is reduced by the amount of time that you own it. When a claim is made, the value of the warranty becomes a percentage of ownership per year based upon the warranty period.

The Limited Lifetime Residential Warranty is prorated over 33 years. Any services that are provided as part of this warranty do not extend the warranty period. This limited residential warranty does not apply to Cabin grade or other downgraded or discontinued Pergo hardwood products and any such product(s) that are sold "as is". Any and all representations, promises, warranties or statements by Pergo or its agents that differs in this manner from the terms of this limited warranty shall be of no force or effect unless in writing and signed by a duly authorized officer of Pergo. If there is a conflict between these general terms and conditions and the terms and conditions of the warranties as specified, the terms and conditions of the warranties specified shall control.

## The Pergo Limited Lifetime\* Residential Warranty is made subject to the following conditions:

- 1) These limited warranties apply to wall installations only. They do not apply to floor installations.
- 2) Other horizontal uses of this product are not covered by these limited warranties. Never install this product on a ceiling or as a countertop.
- 3) These warranties do not apply to any product installed in a commercial application.

## Any of the following shall void and invalidate the above limited warranty.

**Visible Defects**—Boards with visible defects must not be installed. Visible defects are those defects which are apparent on the face of the product. Boards with visible defects must be noted by the installer/buyer and reported before installation so that replacement product can be furnished prior to installation.

**Building Settling or Uneven Walls**—Building settling or uneven walls are considered to be part of the pre-installation inspection process. Do not install Pergo hardwood if these situations exist. This Pergo limited warranty does not cover damage or defects caused by settling or uneven walls.

**Improper Installation**—Pergo hardwood must be installed in strict accordance with Pergo's written installation instructions. Improper installation, done in a way that is contrary to Pergo's written installation instructions, can cause problems with Pergo hardwood products. This Pergo limited warranty does not cover damage or defects caused by improper installation.

**Improper Maintenance or Inadequate Care**—Pergo hardwood requires proper maintenance. Pergo hardwood products must be maintained in accordance with Pergo's written maintenance instructions. This Pergo limited warranty does not cover damage or defects caused by improper maintenance or inadequate care.

**Refinishing**—The factory finish of your Pergo hardwood product may be refinished. However, refinishing the flooring will void the Finish Warranty. Accidents, Abuse or Abnormal Wear—Pergo does not warrant against damage or defects resulting from accidents, abuses or abnormal usage which stain or scratch the finish, diminish gloss or indent the surface of the Pergo hardwood product.

**Problems with Moisture or Dryness**—This Pergo limited warranty does not cover damage or defects caused by wetting, presence of excessive moisture or by conditions which are too dry. Floods, acts of God, plumbing accidents, leaking appliances or pet urine are not covered by this warranty.

**Excessive Lighting**—This Pergo limited warranty does not cover damage or defects, including, but not limited to color changes caused by excessive sunlight or intense lighting. Excessive sunlight or intense lighting can cause color changes in the finished product. Window treatments will usually provide adequate protection against excessive sunlight or intense lighting. Additionally, due to the effects of excessive sunlight or intense lighting, new and/or replacement Pergo hardwood product may not match display samples and/or existing product.

**Difference from Samples**—This Pergo limited warranty does not cover visual differences between color samples and the color of the installed product. Please approve your product's color prior to installation.

**Transferability**—This Pergo limited warranty is applicable to the original owner only and to the Pergo hardwood product used in the original installation. The warranty is non-transferable.