

For each 3x6 panel installed, you will need (6) #8 1½" long stainless steel screws. Corresponding hardware kits including screws and screw covers are available (sold separately in matching colors).

- 1 Measure in  $\frac{5}{8}$ " from the top and side and put a mark on each corner. Next, measure half the distance between each the top and bottom of the panel and put marks. Be sure to have six marks on the panel. (Fig. 1). Using a  $\frac{1}{4}$ " drill bit to allow for expansion and contraction, pre-drill a hole in the center of each mark (Fig. 2).

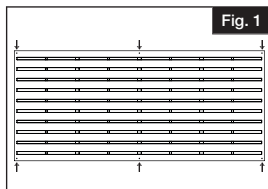

- 2 Place the panel in the desired location, mark the four corners and mid-points on the mounting surface, and pre-drill using a  $\frac{1}{8}$ " bit.

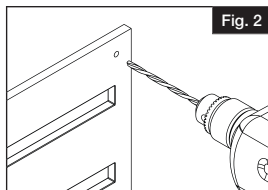

### NOTE:

Be sure to allow an  $\frac{1}{8}$ " between sheets for expansion and contraction.

- 3 Place the screw cover over the screw shank. Line the screw up with the pre-drilled holes and secure the sheeting in place (Fig. 3). DO NOT over-tighten the screw. Snap screw cover in place to hide the fastener (Fig. 4).

