

# **bond** *signature* SERIES

## Canyon Ridge™ Rapid Induction Area Heater™

Item# 66854  
Lowe's# 749294

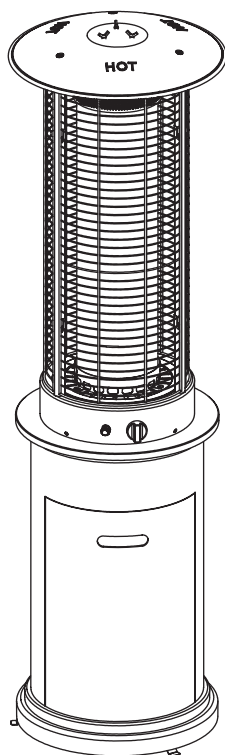

### **! DANGER**

If you smell gas:

1. Shut off gas to the appliance.
2. Extinguish any open flame.
3. If odor continues, keep away from the appliance and immediately call your gas supplier or fire department.

### **! WARNING**

Do not store or use gasoline or other flammable vapors and liquids in the vicinity of this or any other appliance. An LP-cylinder not connected for use shall not be stored in the vicinity of this or any other appliance.

### **! WARNING**

For outdoor use only.

### **! WARNING**

Improper installation, adjustment, alteration, service or maintenance can cause injury or property damage. Read the owner's manual thoroughly before installing or servicing this equipment. If the information in this manual is not followed exactly, a fire or explosion may result causing property damage, personal injury or loss of life.

Save these instructions for future use. If you are assembling this unit for someone else, give this manual to him or her and read and save for the future.



### **! DANGER**



#### **CARBON MONOXIDE HAZARD**

This appliance can produce carbon monoxide which has no odor.

Using it in an enclosed space can kill you.

Never use this appliance in an enclosed space such as a camper, tent, car or home.

## Owner's Manual

## SAFETY INFORMATION

Before you assemble or operate this unit, please carefully read this entire manual. Failure to do so may result in a fire, explosion, injury or death.

### **WARNING**

- The installation of this unit must adhere to local codes or either the National Fuel Gas Code, ANSI Z223. 1/NFPA54, OR CAN/CGA-B149.1, National Gas and Propane Installation Code.
- **THIS UNIT IS INTENDED FOR OUTDOOR USE ONLY!** This product shall be used outdoors, in a ventilated space and shall not be used in any enclosed area.
- This unit is to be used with propane gas only! (sold separately)
- Do not attach a remote gas supply to this unit.
- Only use propane gas for this unit.
- This unit is not intended for natural gas.
- Converting this unit to natural gas is dangerous and not recommended. The conversion of this unit will void the manufacturer warranty.
- If the propane gas tank is leaking gas, you may hear, see, or smell a hiss. Do the following:  
1. Disconnect the propane gas tank. 2. Do not attempt to fix the problem yourself. 3. Contact your gas supplier or fire department for help.
- Never install or remove a propane tank from this unit while it is in use.
- Applying too much propane may result in gas pooling and will not burn. Allow fresh air into the unit so that the remaining gas may escape.
- Do not use a flame to check for gas leaks.
- The max. inlet supply pressure: max. Gas supply 11 in w.c. (2.74kPa)
- Use LP propane tanks with the following dimensions: diameter 12 in, height 18 in - capacity 20 lbs.
- You must use a propane tank that has a collar to protect the gas valve.
- DO NOT fill tank over 80 percent full.
- The tank system must be set up for vapor withdrawal.
- Discontinue use if any part of the propane tank is damaged. Rust and dents may be hazardous and should be inspected by a gas supplier.
- Do not operate unit until all parts are fully assembled.
- Do not paint or color any part of this heating unit.
- Unit may be hot while in use, do not attempt to move it while in use.
- Never leave this heating unit unattended while in use.
- This unit is not intended for cooking.
- Keep any flammable items away.
- Keep a safe distance to avoid burning skin or clothing.
- Do not sit or rest hands or feet on this heating unit.
- Never place hands or fingers on upper portion of this unit while in use.
- Keep all electrical cords and fuel supply hose away from heated surfaces.
- Combustible materials should not be within 24 inches of the top of the unit, or within 24 inches around the entire unit.
- Keep the appliance area clear and free from combustible material, gasoline and other flammable vapors and liquids.
- Never use the unit in spaces which may contain volatile or airborne combustibles.
- If the flame goes out while burning, turn the gas valve off. Wait 5 minutes before repeating the initial lighting procedure. Once you have a flame started, hold down the control knob for 1 minute.
- Do not add water into the unit.
- Do not operate unit if any part has been under water. Call a service technician to replace any

damaged part should this occur.

- Do not disconnect any part while unit is in use.
- Do not store a spare propane tank on or near this unit.
- If the heating unit is indoors, detach the propane tank and leave outdoors.
- Do not operate on a boat or vehicle. This unit must be used on a flat surface and outdoors ONLY.
- Always remove protective cover before operating (if applicable).
- Do not set the protective cover over the unit until it is turned off and completely cooled down.
- Check for leaks after not using the unit for long periods of time.
- **Children should never operate this unit. Children must be supervised while near this unit.**
- Keep gas tank at least 5 ft away from unit when lit. (if external tank)
- The maximum gas supply pressure is 250psi.
- **All installation and repair should be done by a qualified professional. This unit should be inspected annually and cleaned regularly.**
- Inspect all elements of this heating unit before each use. If there is damage, the burner must be replaced.
- Be aware of the hazards of high temperatures and stay away from the unit to avoid any burns or injury.
- The gas supply tank should be constructed and marked with the specifications for the LP gas tanks of the U.S. Department of Transportation or the National Standard of Canada CAN/CSA-B339, LP gas tanks, spheres and tubes for Transportation of Dangerous Goods; and Commission.
- The LP gas tank must have a listed overfilling prevention device and a QCCI or Type I, (CGA810) LP gas tank connection.
- This heating appliance should not be used on plastic or artificial wood desks.
- Inspect the gas hose and all connections to the propane tank prior to each use.
- Always follow lighting instructions carefully.
- Do not use 30 lb. propane tanks for this unit.
- In case of high winds, secure this unit to the ground to prevent the unit falling over.
- **Children and adults should be alerted to the hazards of high surface temperatures and should stay away to avoid burns or clothing ignition.**
- **Young children should be carefully supervised when they are in the area of the appliance.**
- **Clothing or other flammable materials should not be hung from the appliance or placed on or near the appliance.**
- **Any guard or other protective device removed for servicing the appliance shall be replaced prior to operating the appliance.**
- **Installation and repair should be done by a qualified service person. The appliance should be inspected before use and at least annually by a qualified service person. More frequent cleaning may be required as necessary. It is imperative that the control compartment, burners and circulating airways of the appliance are kept clean.**

Only use the regulator and hose assembly provided with this unit. Replacement parts must be supplied directly by Bond Manufacturing Co.

Inspect the burner before use of this unit. If the burner shows any kind of damage, do not operate the appliance. For assistance with repair or replacement of the burner or any other parts, call Bond Manufacturing at 1.866.771.2663.

**NOTE: You must follow all steps to properly assemble this heating item. Make sure the gas valve is turned "OFF" before assembling. Do NOT attempt to assemble without proper tools.**

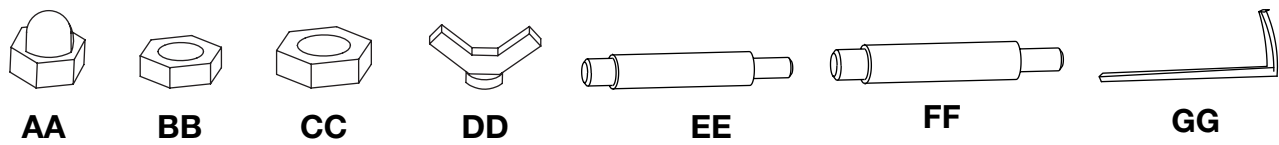

Item	Description	Qty
AA	M6 Cap Nut	3
BB	M6 Nut	4
CC	M8 Nut	3
DD	M5 Wing Nut	3
EE	M6 Studs	3
FF	M8 Studs	3
GG	Anchoring Nut	4

Before beginning assembly of product, make sure all parts are present. Compare parts with package contents list and hardware contents list. If any part appears missing or damaged, don't use this product and call customer service immediately.

Estimated assembly time: 30 minutes.

Tools required for assembly (not included): Phillips Screwdriver, Wrench.

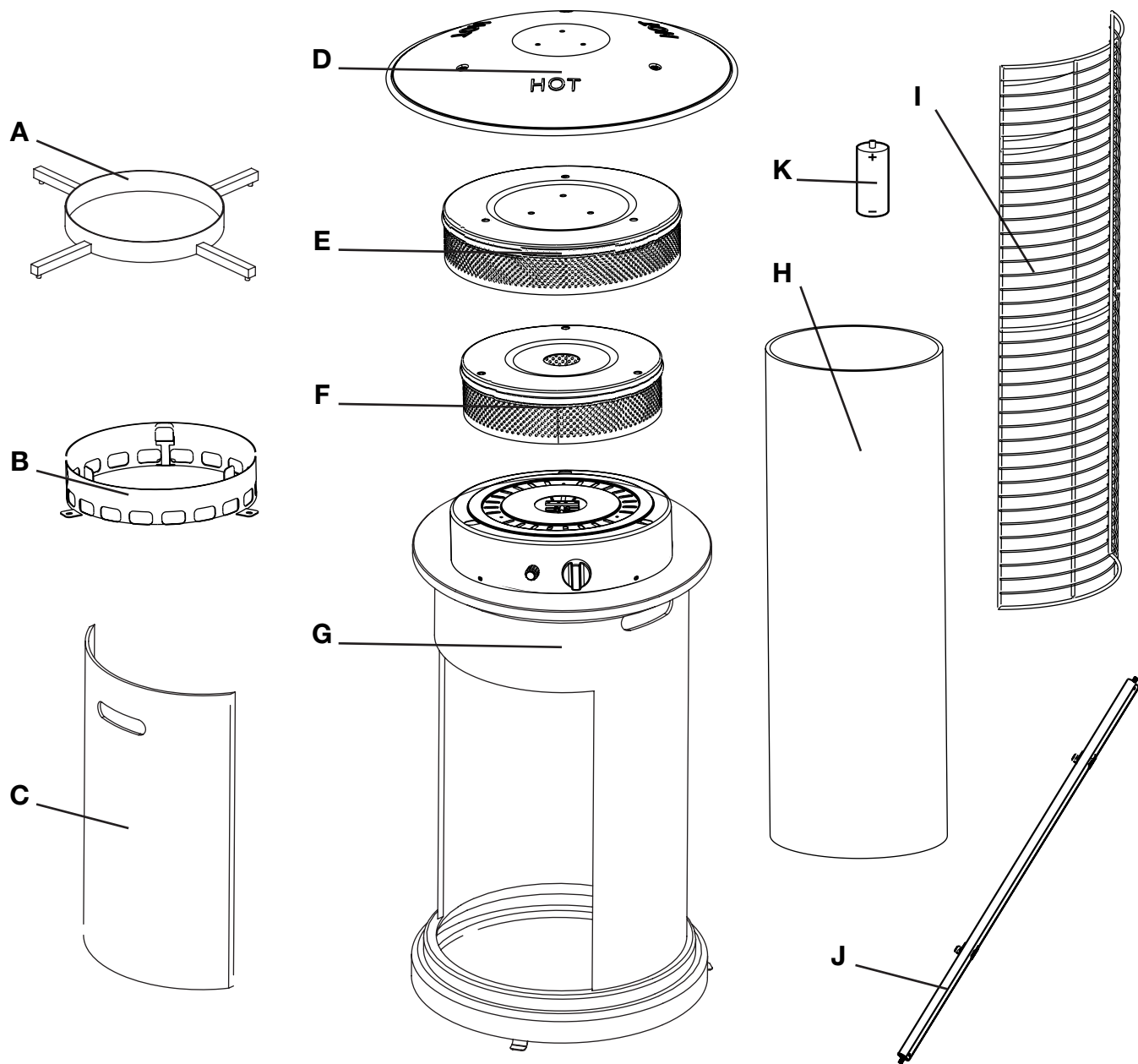

Item	Description	Qty
A	Tank Supporter	1
B	Glass Tube Ring	1
C	Door	1
D	Reflector	1
E	Upper Radiation Screen	1
F	Lower Radiation Screen	1
G	Body	1
H	Glass Tube	1
I	Mesh Guard	3
J	Upper Supporter	3
K	Battery	1

## ASSEMBLY INSTRUCTIONS

**1.** Flip the body (G) upside down on a protected surface. Remove the glass tube (H). Attach the tank supporter (A) to the bottom of the body (G) using 4 M6 nuts (BB). Flip the body (G) over.

**Note:** Make sure the wing nut on the tank supporter (A) faces the door on the body (G).

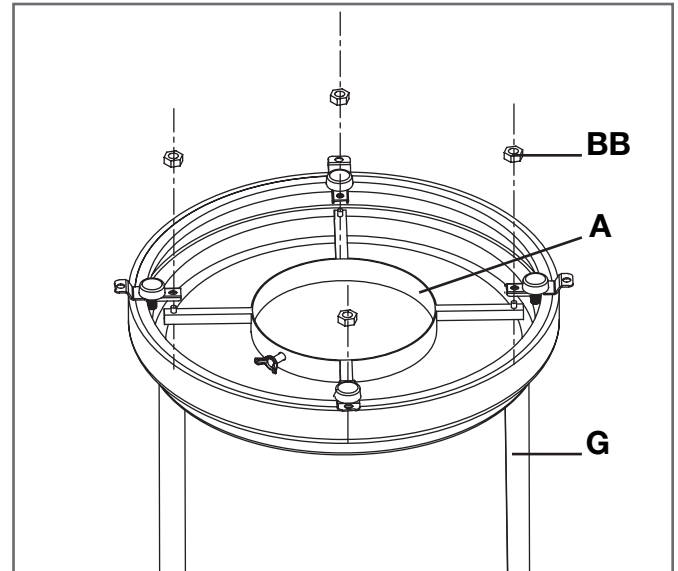

**2.** Slide the 3 upper supporters (J) into the slots in the burner at the top of the body (G). Be sure that they are fully inserted. Tighten the upper supporters (J) with 3 M5 wing nuts (DD).

**Note:** Be sure that the hook on the upper supporter is upwards.

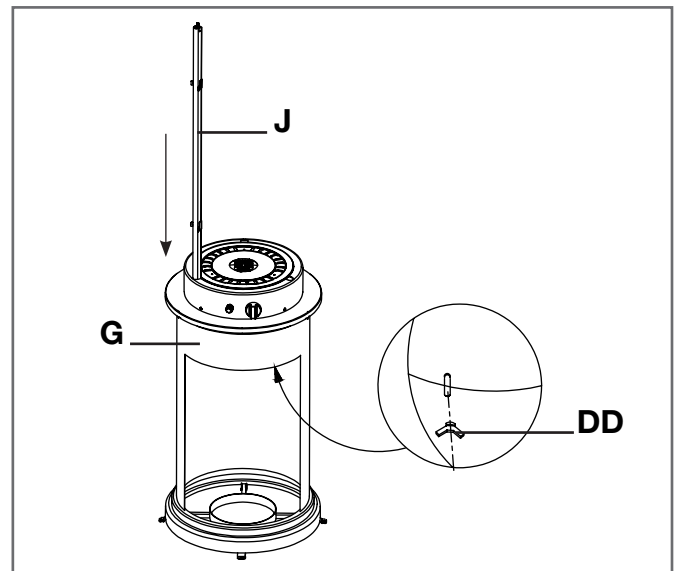

**3.** Remove the 3 preassembled screws from the burner at the top of the body (G). Attach the glass tube ring (B) to the top of the burner using the 3 preassembled screws you just removed.

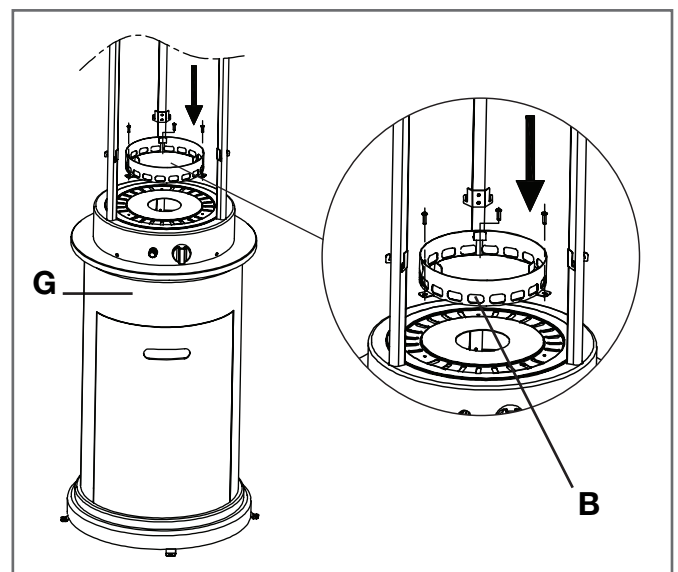

4. Place the glass tube (H) into the top of the glass tube ring (B).

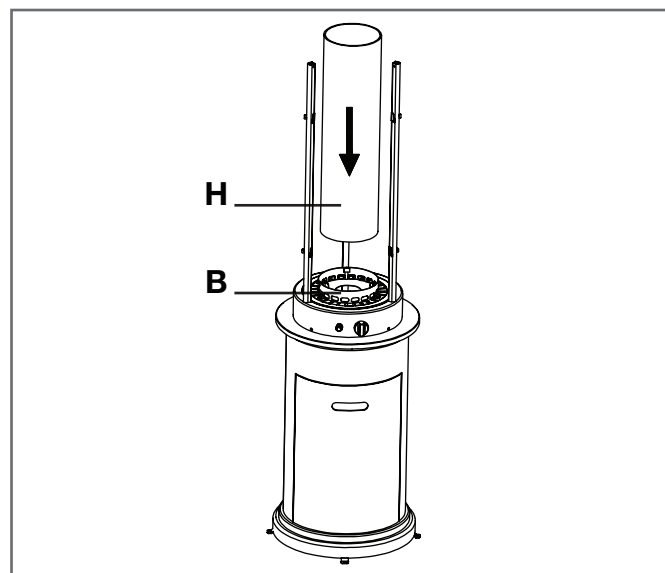

5. Insert 3 M8 studs (FF) inbetween lower radiation screen (F) and upper radiation screen (E). Fasten the studs with 3 M8 nuts (CC). Then insert 3 M6 studs (EE) between the upper radiation screen (E) and the reflector (D). Fasten with 3 M6 cap nuts (AA).

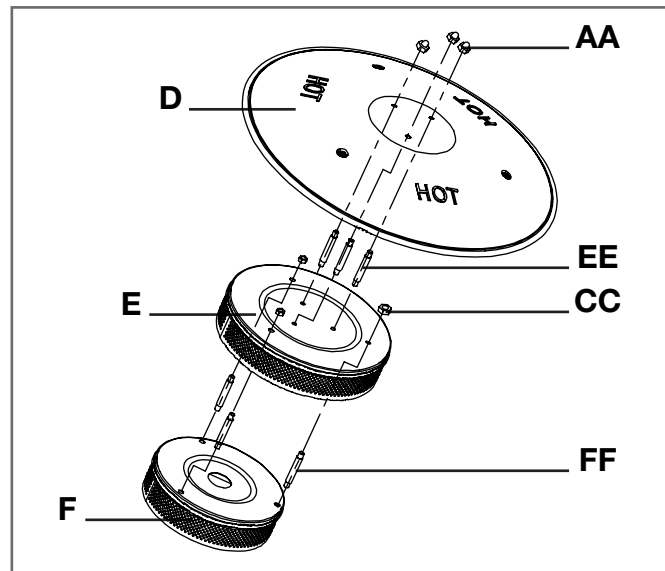

6. Remove 3 M5 screws from the upper supporters (J). Place the reflector assembly made in the previous step onto the upper supporters (J). Tighten together with 3 M5 screws just removed from the upper supporters (J).

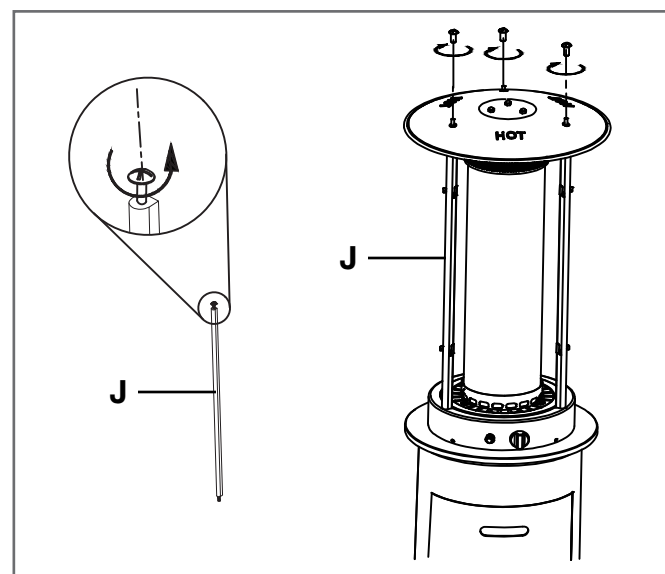



## ASSEMBLY INSTRUCTIONS

**7.** Attach the 3 mesh guards (I) onto the hooks at the top of the upper supporters (J).

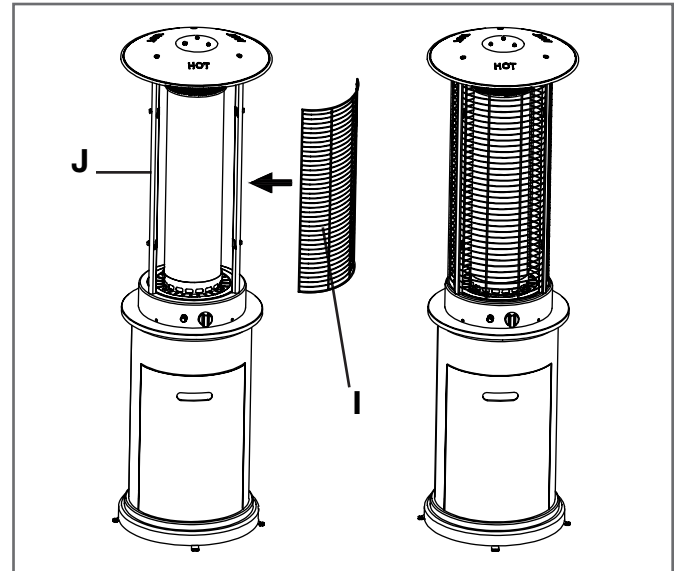

**8.** Remove door (C) from body (G). Place the propane gas tank (not included) into the tank supporter. Tighten the preassembled wing screw clockwise to ensure the propane tank is secure. Replace the door after the tank is connected to the regulator (see below).

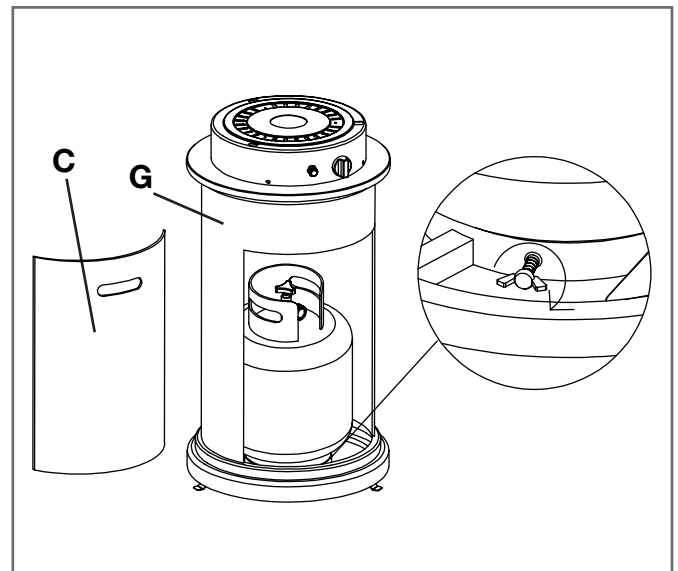

**9.** Turn the cylinder valve on the tank clockwise to close the propane tank. Attach the preassembled regulator to the cylinder valve by turning the regulator coupling nut clockwise. Make sure it is fastened securely and tighten connections by hand only.

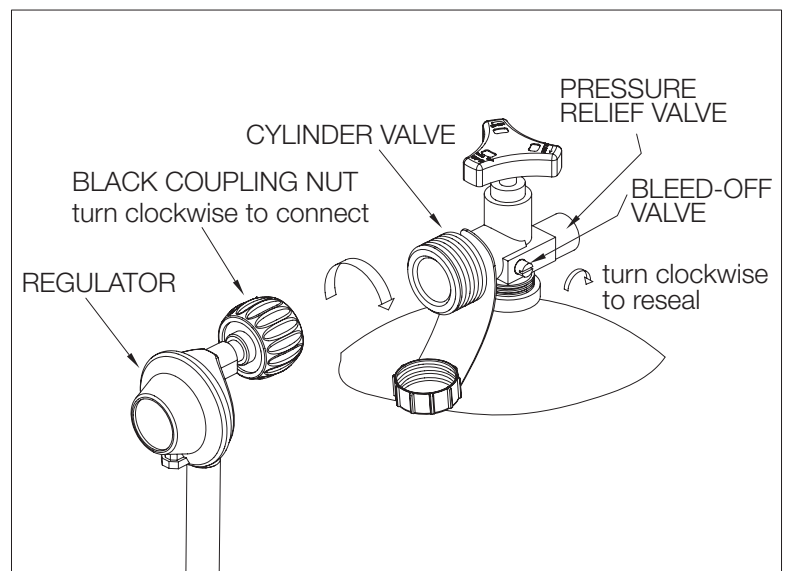



**10.** Use the 4 anchoring nuts (GG) to attach the heater in place to the ground.

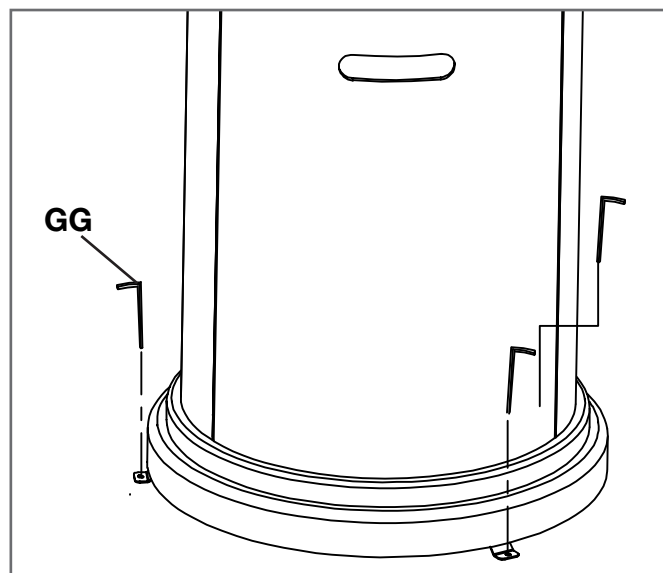

## OPERATION

- The glass tube may break if it is wet while in use; never use the heater while it's raining outside.
- Do not splash any liquid on the heater while it is in use.
- Keep children away from the unit while in use; the glass tube may be extremely hot while in use. Do not touch.
- Ensure that the heater is on a strong and flat surface. The heater may be damaged if the unit tips over.
- Never use the heater if the glass tube shows any cracks.

Before performing a leak test, be sure that no sparks can occur and you are in a spacious outdoor area. Connect the propane gas tank to the regulator and turn the valve on the unit to the “off” position. Brush a soap and water mixture on all connections. Turn the gas supply on; if bubbles occur on any connection there may be a leak. **If you smell gas or a leak is discovered turn the gas valve off, disconnect propane gas tank and do not use the appliance until the leak is repaired.**

## To Light

1. Unscrew the ignition button on the burner to see if the battery (K) has already been placed inside. If the battery (K) is not already within the ignition button on the burner, please place the battery (K) into the ignition button slot.
2. Make sure the ignition control knob is turned to the “off” position. Connect propane gas tank and slowly open the valve on the propane gas tank by turning the knob counterclockwise.
3. Press in and turn the ignition control knob to the “pilot” position; hold down for 1 minute.
4. Push the ignition button, while still holding down control knob down, to generate a spark.
5. Check to see if there is a pilot light through the glass tube (H). If there is, turn the control knob to the “low” position.
6. For maximum flame height and heat output, turn the control knob to the “high” position.

## To Extinguish

1. Push and turn the ignition control knob clockwise to the “off” position.
2. Turn the propane gas tank valve on the gas tank to close the gas supply and disconnect the propane gas tank

**WARNING:** If the lighting instructions are not followed directly a fire or explosion may occur resulting in property damage, personal injury or death.

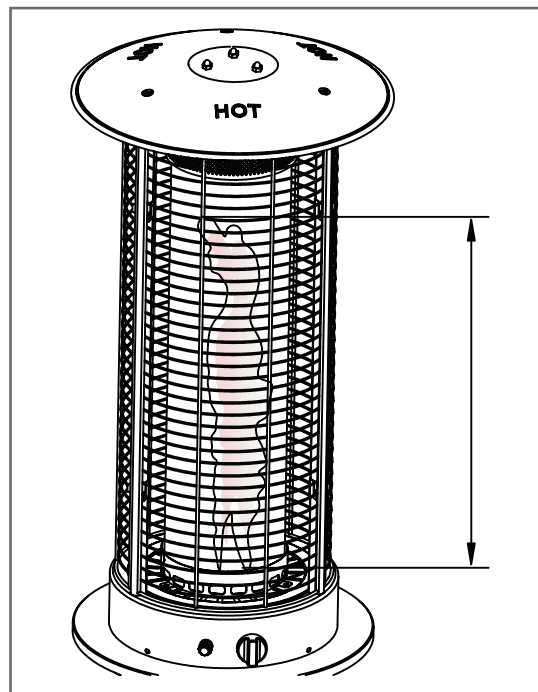
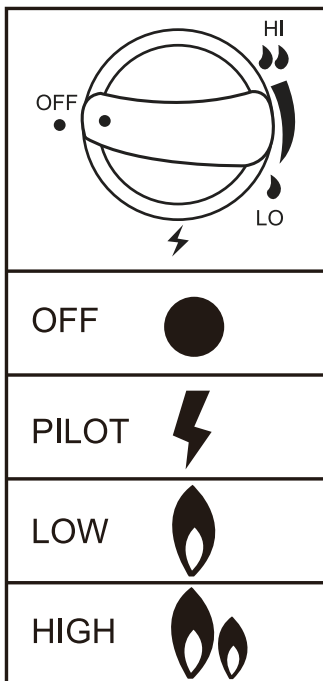

Observe flame height when lit. The flame should be a yellow/blue color between 20 - 28 inches in height.

## MAINTENANCE

- Before performing any maintenance always disconnect propane gas tank.
- Keep the heating item free and clear from combustible materials.
- Visually inspect burner for obstructions and keep tank enclosure free and clear from debris.
- Use a soft brush to get rid of the mild stains, loose dirt and soil after the burner is completely cooled down. Wipe down with a soft cloth.
- Harsh weather conditions may cause stubborn stains, discoloration and possibly rust pitting.
- Permanent damage may occur if powder or solvent comes in contact with painted or plastic components on this heating unit.
- Keep the heating unit stored away from direct sunlight.
- If storing this unit inside, disconnect the propane gas tank from the gas valve.
- Not using manufacturer approved or supplied parts/accessories may result in a defective condition and void the warranty of this heating unit.
- Carbon deposits may pose as a fire hazard; clean the reflector and inside of the glass tube with soap and water if any carbon deposits are present.

## TROUBLESHOOTING

Problem	Cause	Solution
Pilot won't light	Gas valve may be off	Turn the gas valve on
	Gas tank may be empty	Refill the gas tank
	Orifice may be blocked	Clean out the orifice
	Air is within supply system	Pump out air from all lines
	Loose connection	Check all fittings and tighten connections as necessary
Pilot won't stay on	Debris around the pilot	Clean out the debris
	Loose connection	Check all fittings and tighten connections as necessary
	Thermocouple is bad	Call for a replacement part and replace the thermocouple
	Gas leak within the line	Check all connections; call for a replacement part if anything is damaged
	Lack of gas pressure	Gas tank is almost empty
Burner won't light	Gas pressure is low	Gas tank is almost empty
	Orifice may be blocked	Clean out the orifice
	Control knob isn't on	Turn the control knob on
	Thermocouple is bad	Call for a replacement part and replace the thermocouple
	Pilot light assembly is bent or not in the correct location	Place pilot light in the correct location and retry lighting procedure

## WARRANTY

The manufacturer warranty will be voided by, and manufacturer disclaims any responsibility for, the following actions:

- Modification of the unit and/or components including the gas valve assembly.
- Use of any component part not manufactured or approved by Bond Manufacturing.
- Use and installation other than what is listed in this manual.

Please contact the manufacturer for replacement parts.

## CONTACT

If you have any questions or concerns, please contact Bond Manufacturing Company at the below resources:

Toll Free Phone	1-866-771-BOND (2663)   Monday - Friday, 8am - 4:30pm PST
Email	<a href="mailto:customer.service@bondmfg.com">customer.service@bondmfg.com</a>
Online	<a href="http://www.bondmfg.com">www.bondmfg.com</a>

