

Project		Catalog #		Type	
Prepared by		Notes		Date	



HALO

LTB6 Canless Direct Mount

6" LED Canless Direct Mount Module
800 Lumen Series

Baffle Trim

Typical Applications

Residential

Interactive Menu

- Order Information [page 2](#)
- Product Specifications [page 2](#)
- Energy Data [page 3](#)
- Photometric Data [page 3](#)
- Product Warranty

Product Certification



Refer to ENERGY STAR® Certified Products List.
Can be used to comply with California Title 24 High Efficacy requirements.
Certified to California Appliance Efficiency Database under J48.

Product Features



Top Product Features

- Selectable CCT 3000K ,4000K ,5000K only
- Baffle trim
- Canless direct mount – does not require recessed housing or junction box
- Dimmable down to 10%
- Perfect for new construction or remodel work

Dimensional and Mounting Details

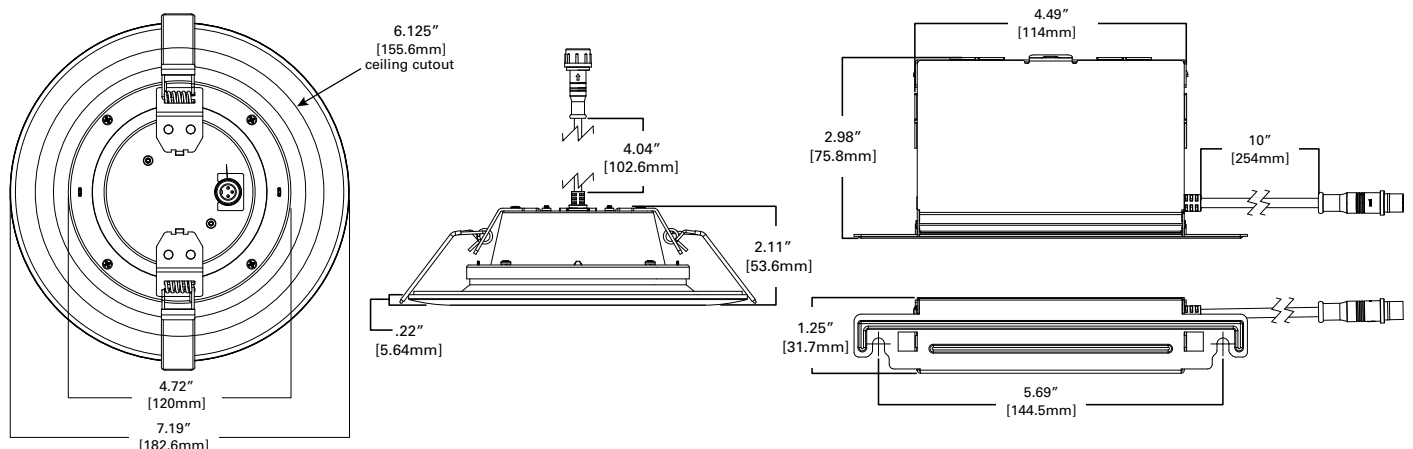

Order Information

SAMPLE ORDER NUMBER: **LTB6089FS351EWHDMR**

Module	Lumens	CRI/CCT	Driver	Finish	Mounting	Packaging
LTB6 = 6-inch baffle LED canless module	08 = 800 lumens (nominal)	9FS35 = 90 CRI min, 3000K, 4000K, 5000K selectable CCT	1E = 120V 60Hz, LE & TE phase cut 10% dimming	WH = Matte White flange	DM = Direct Mount	R = Recyclable 4-color unit carton

Accessories

Accessories
HL6RSMF = 6" round and square mounting frame
MF6RC = 6" round mounting frame with drywall collar
Extension Cable seleCCTable Driver/Jbox
HLB06FSEC = 6 ft. extension cable
HLB12FSEC = 12 ft. extension cable
HLB20FSEC = 20 ft. extension cable

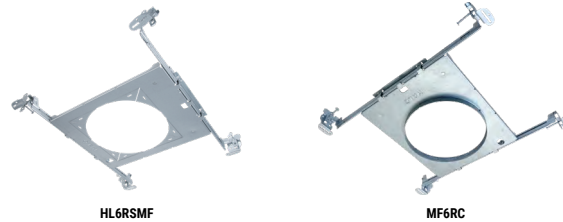

Specification Features

Module

- LED module consists of LED array, optical assembly, driver and self-flanged trim
- Baffle style trim
- Achieving L70 at 35,000 hours in IC and non-IC applications
- Injection molded plastic construction is impact resistant and non-corrosive
- Non-conductive construction meets most local code 'dead front' requirements

Gaskets

- Closed cell gasket achieves restrictive airflow requirements without additional caulking

LED Array

- A plurality of low power LEDs provide a uniform source with high efficiency and long life
- Available in 90 CRI minimum, R9 greater than 50 and color accuracy within 4 SDCM provide color accuracy and uniformity
- Available in 3-color selectable CCT: 3000K, 4000K, 5000K

Optical Assembly

- Optical assembly provides wide distribution useful for general and task lighting
- Diffuse injection molded lens with contoured profile provides uniformity and a familiar lamp like appearance
- Meets ENERGY STAR® color angular uniformity requirements

Junction Box

- Die formed metal driver / junction box with captive hinged junction box cover
- Listed for (6) #12 AWG 90° C splice conductors, 2-in, 2-out plus (2) ground
- (4) ½" conduit pry-outs
- Accepts 14-2, 14-3, 12-2, 12-3 U.S. and 14-2, 14-3, 12-2 Canadian NM cable
- (3) wire nuts for quick and reliable mains voltage connections
- Integral mounting facilitates direct mounting to building structure or mounting frame

Driver

- Integral 120V 60 Hz constant current driver provides high efficiency operation
- Continuous, flicker-free dimming from 100% to 10% with select leading or trailing edge 120V phase cut dimmers – consult dimming guide for more information
- Consult dimmer manufacturer for compatibility and conditions of use

Installation

- Can be installed in 3/8" to 1-1/4" thick ceilings
- Round ceiling cutout
- Heat treated springs hold fixture fitting securely in the ceiling eliminating light leaks
- Can be removed from below the ceiling for service or replacement

Compliance

- UL Certified for US and Canada type IC suitable for direct contact with air permeable insulation
- Not recommended for use in direct contact with spray foam insulation, reference NEMA LSD57-2013
- Wet location listed and IP55 ingress protection rated
- Air-tite per ASTM-E283
- Suitable for use in clothes closets when installed in accordance with the NEC 410.16 spacing requirements
- EMI/RFI emissions per FCC 47CFR Part 15 consumer limits
- Contains no mercury or lead and RoHS compliant
- Photometric testing in accordance with IES LM79-08
- Lumen maintenance projections in accordance with IES LM-80-08 and TM-21-11
- Can be used for State of California Title 24 high efficacy LED compliance under JA8, reference Modernized Appliance Efficiency Database System (MAEDBS) for 2019 JA8 High Efficacy Lighting
- ENERGY STAR® certified, reference "Certified Light Fixtures" database

Warranty

- Five year limited warranty, consult website for details. www.cooperlighting.com/global/warranty

Energy Data

[View IES files](#)

LTB6089FS351EWHDMR	
Lumens	800 Series
Input Voltage	120V
Input Current	74 (mA)
Input Power	8.4 (W)
Efficiency	90.8 (LPW)
Inrush (A)	.07
THD:	≤ 20%
PF:	≥ 0.90
T Ambient	-30° - +40°C
Sound Rating	≤ 22 dba

LTB6-DM 3000K / 4000K / 5000K				
CCT	Watts	lumens	LPW	CRI
3000K	8.6	745	86.6	93
4000K	8.3	820	98.8	94
5000K	8.6	810	94.2	92

LTB6089FS351EWHDMR - 3000K

PRODUCT SPECIFICATIONS	
Lumens	745
Watts	8.6
Lumens Per Watt (Efficacy)	86.6
Color Accuracy (CRI)	93
Light Color (CCT)	3000K
Correlated Color Temperature (CCT)	
<p>The image shows a color temperature scale from 2700K (warm white) to 6500K (bright white). A yellow arrow points to the 3000K mark, which is labeled 'soft white'.</p>	
2700K	3000K
4500K	6500K

Project		Catalog #		Type	
Prepared by		Notes		Date	



HALO

MF4RC | MF6RC

4" & 6" Mounting Frame for Round Canless Downlights
Drywall Collar Included

Typical Applications

Office • Healthcare • Hospitality • Institutional • Mixed-Use/Retail • Residential

Interactive Menu

- Order Information page 2
- Photometric Data page 2
- Connected Systems
- Product Warranty

Top Product Features

- Mounting frames accept "install from below" canless downlights
- Reserve the ceiling location, provide routing guidance for the drywall contractor
- 3/8" drywall collar included to improve hole locating and drywall cutting process
- Use to meet local code requirements where install from below fixtures must be supported directly by building structure

Dimensional and Mounting Details

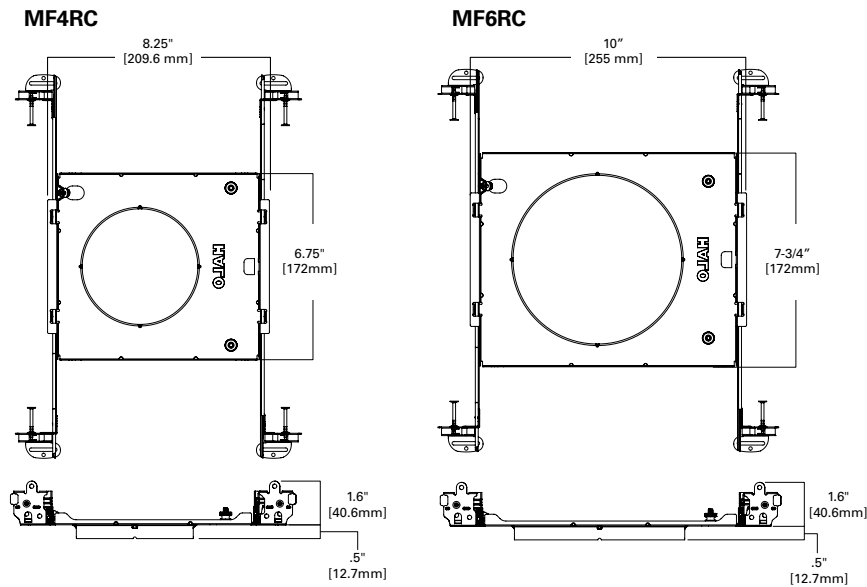

Order Information

Mounting Frame	Compatible Fixture Fittings (Sold Separately)
MF4RC - 4" round mounting frame with drywall collar	HALO - HLA4, HLA4S, HLB4, HLB4S, HLB4SP, HLBPH4, HLBSL4, HLBE4, HLB4*WZ, HLBQL4, HLBC4, RL4-DM, RLQL4-DM, RLS4-DM, RLNL4-DM, RA4-DM, LT4-DM, LTB4-DM, LTQL4-DM, LCR4, ML4DM, SMD4-DM, CEZ4
MF6RC - 6" round mounting frame with drywall collar	HALO - HLB6, HLBPH6, HLBSL6, HLBE6, HLB6*WZ, HLBQL6, HLBC6, RL6-DM, RLQL6-DM, RLS6-DM, RLNL6-DM, RA6-DM, LT6-DM, LTB6-DM, LCR6, SMD6-DM, CEZ6 HALO Commercial - PR6R, HC56R

Product Specifications

Mounting Frame

- Galvanized steel mounting frame with offset aperture and integral bar hanger receivers
- Locking screws provide positive horizontal locking
- Provides tool-less attachment of remote driver / junction box
- 3/8" drywall collar included to improve hole locating and drywall cutting process

Bar Hangers

- GOT NAIL! Gen 3 bar hangers adjust from 8" to 24" wide
- Pass thru feature allows shortening without removal
- Captive nail penetrates standard and engineered lumber
- Mounting flange levels platform with ceiling
- Integral clip attaches directly to tee-bar.

Compliance

- Can be used to meet local code requirements where install from below fixture fittings must be supported directly by building structure

Warranty

- One year limited warranty, consult website for details. www.cooperlighting.com/global/warranty