

# FIREPLACE TV STAND

## FP1

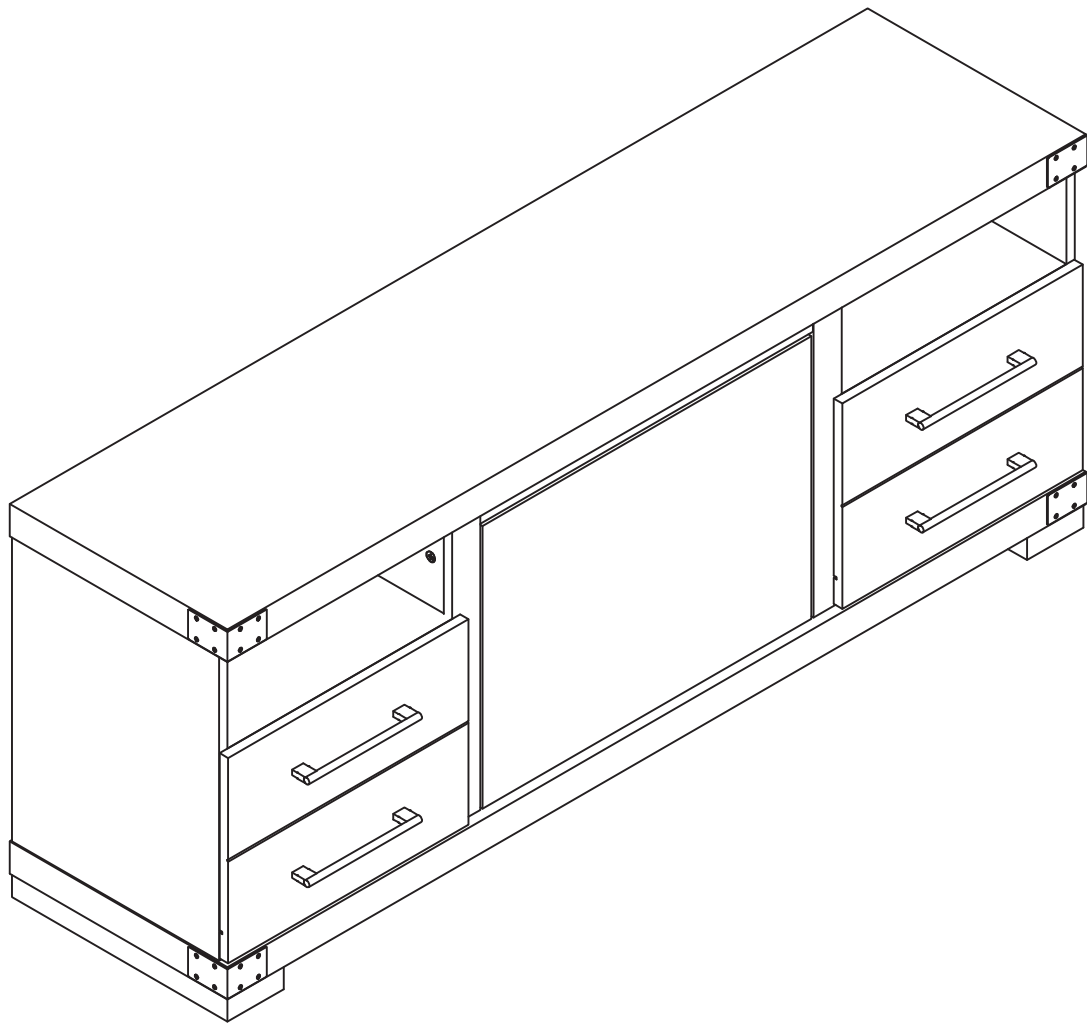

# Table of Contents

# Assembly Tools Required

Part Identification	3
Hardware Identification	4
Assembly Steps	5-24

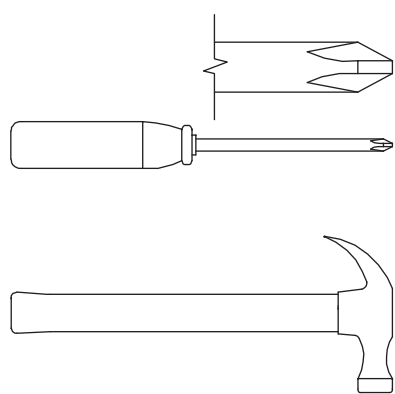

No. 2 Phillips Screwdriver  
Tip Shown Actual Size

Hammer  
Not actual size 😊

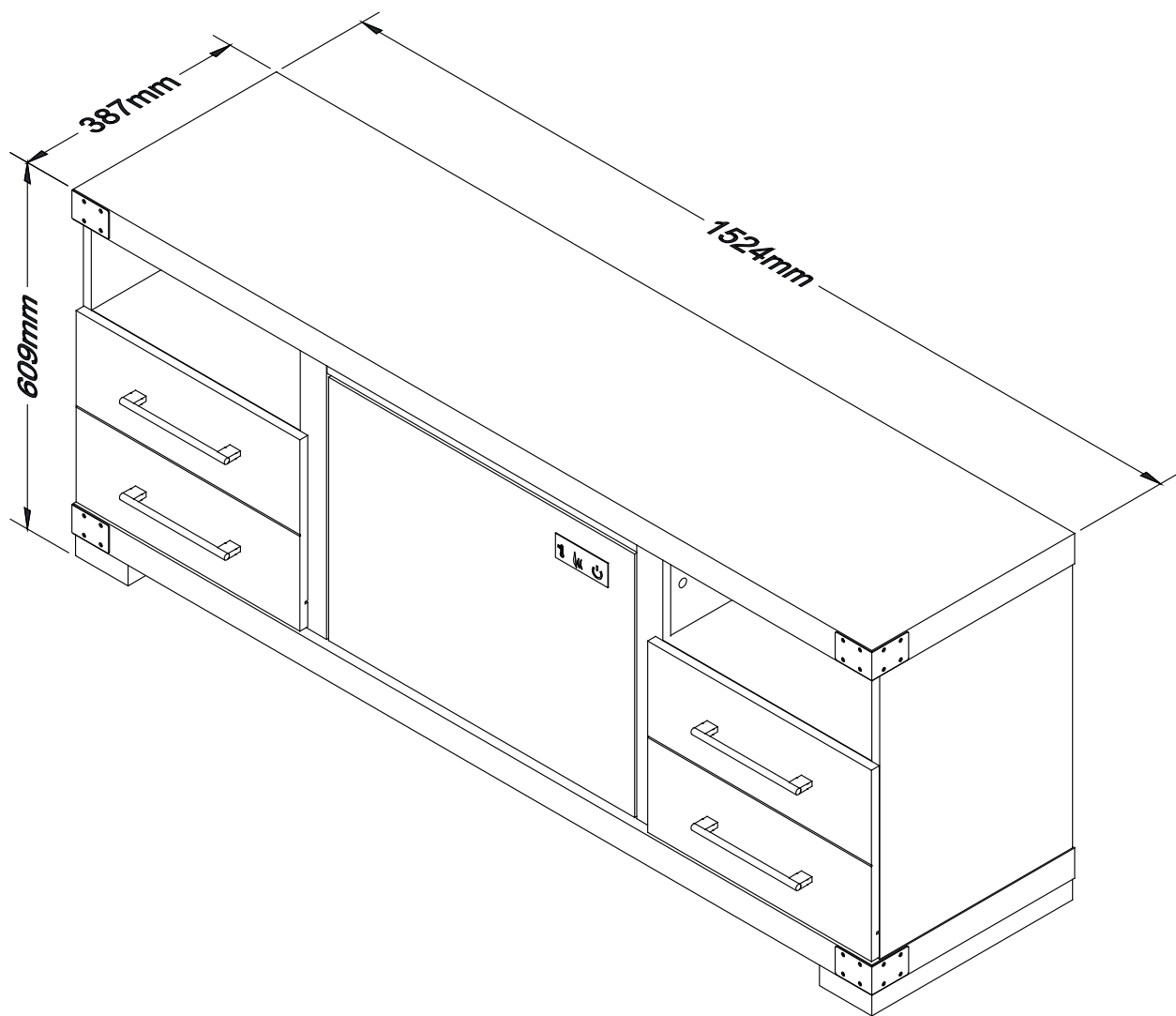

# Part Identification

Now you know  
our ABCs.



- ◆ While not all parts are labeled, some of the parts will have a label or an inked letter on the edge to help distinguish similar parts from each other. Use this part identification to help identify similar parts.

A	TOP (1)
B	BOTTOM (1)
C	LEFT END (1)
D	RIGHT END (1)
E	LEFT UPRIGHT (1)
F	RIGHT UPRIGHT (1)
G	BACK (2)
H	SHELF (2)
J	TOP MOLDING (1)

K	LEFT MOLDING (1)
L	RIGHT MOLDING (1)
N	DRAWER FRONT (2)
O	DRAWER LEFT (2)
P	DRAWER RIGHT (2)
Q	DRAWER BACK (2)
R	DRAWER BOTTOM (2)
S	FOOT (2)
W	FIREPLACE (1)
X	TOP BRACKET (1)
Y	END BRACKET (2)
Z	MIDDLE SHELF (1)

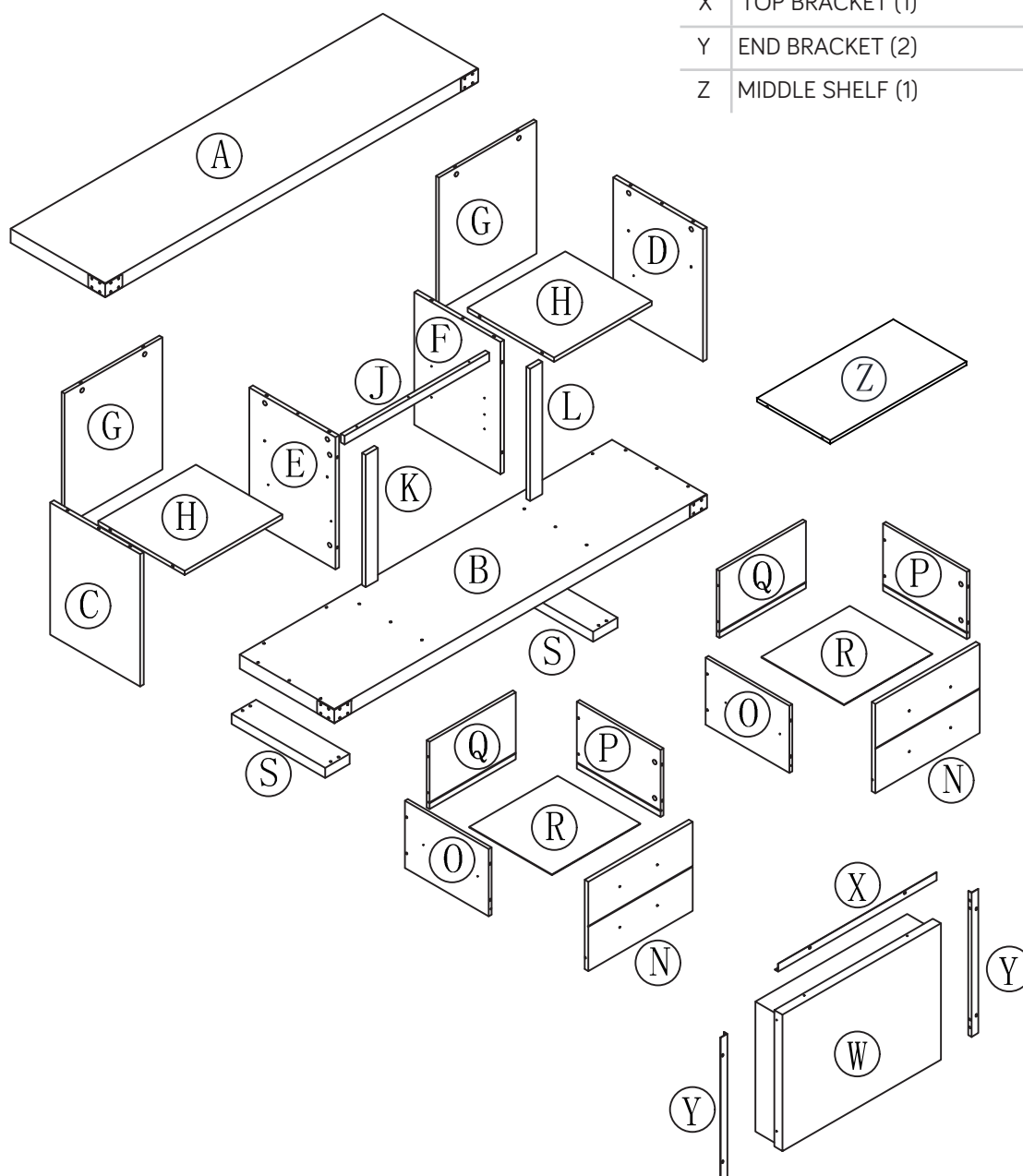

# Hardware Identification

◆ Screws are shown actual size. You may receive extra hardware with your unit.

1 EXTENSION RAIL - 4



2 EXTENSION SLIDE - 4



3 CAM SCREW - 32

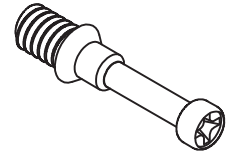

4 HIDDEN CAM - 32



5 PULL - 4

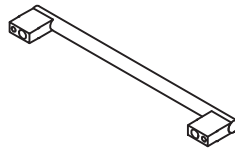

6 WOOD DOWEL - 8

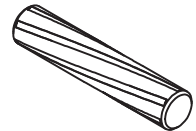

7 APPLIQUE CARD - 6

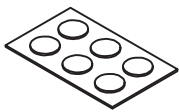

8 2-11/16" PAN HEAD SCREW-12

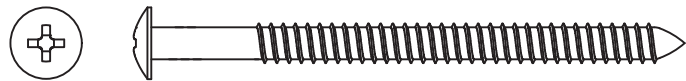

9 2" PAN HEAD SCREW-11

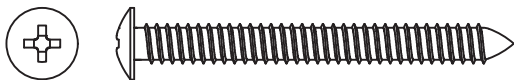

10 1-3/16" PAN HEAD SCREW-8

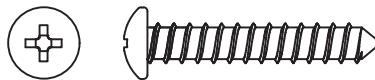

11 3/4" MACHINE SCREW-8

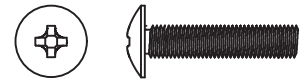

12 1/2" FLAT HEAD SCREW-16



13 METAL PIN-4

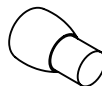

14 WARNING LABEL - 1



(Refer to the last step for proper location and application)

ZZ 3/8" PAN HEAD SCREW-15



# Hardware Usage Guide

## HOW TO USE A HIDDEN CAM & CAM SCREW OR CAM DOWEL

1. NOTE: Various CAM SCREWS or a CAM DOWEL may be used.

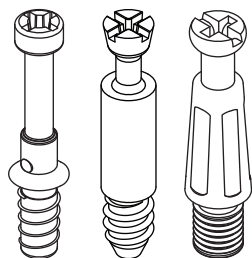

Cam Screws

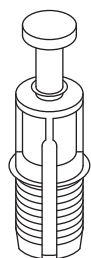

Cam Dowel

Turn the CAM SCREW or gently tap the CAM DOWEL until the shoulder is against the surface of the part.

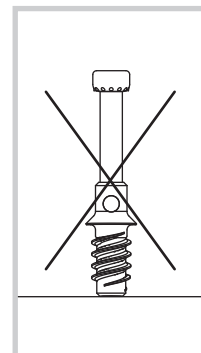
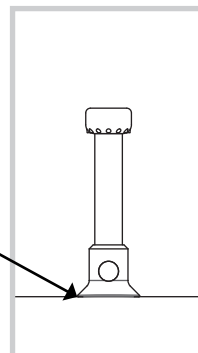

- 2.

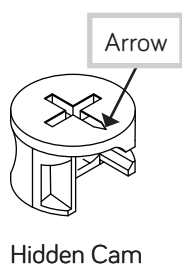

Hidden Cam

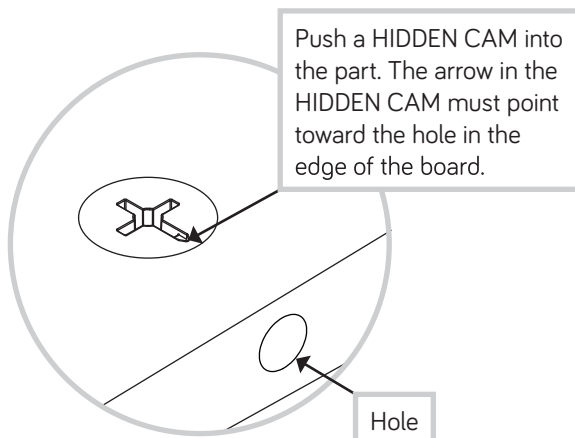

- 3.

Insert the CAM SCREW or CAM DOWEL into the HIDDEN CAM. Tighten the HIDDEN CAM.

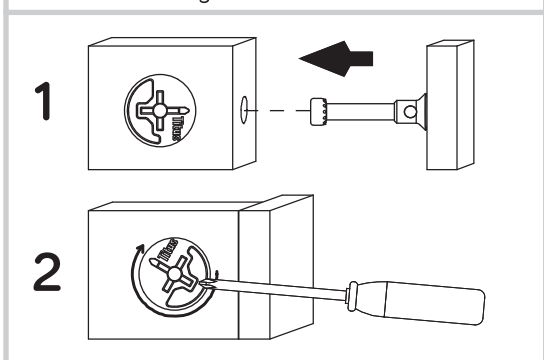

# Step 1

- ◆ Assemble your unit on a carpeted floor or on the empty carton to avoid scratching your unit or the floor.

- ◆ Turn thirty-two CAM SCREWS (3) into the TOP (A), ENDS (C and D), UPRIGHTS (E and F), MOLDINGS (K and L) and DRAWER FRONTS (N).

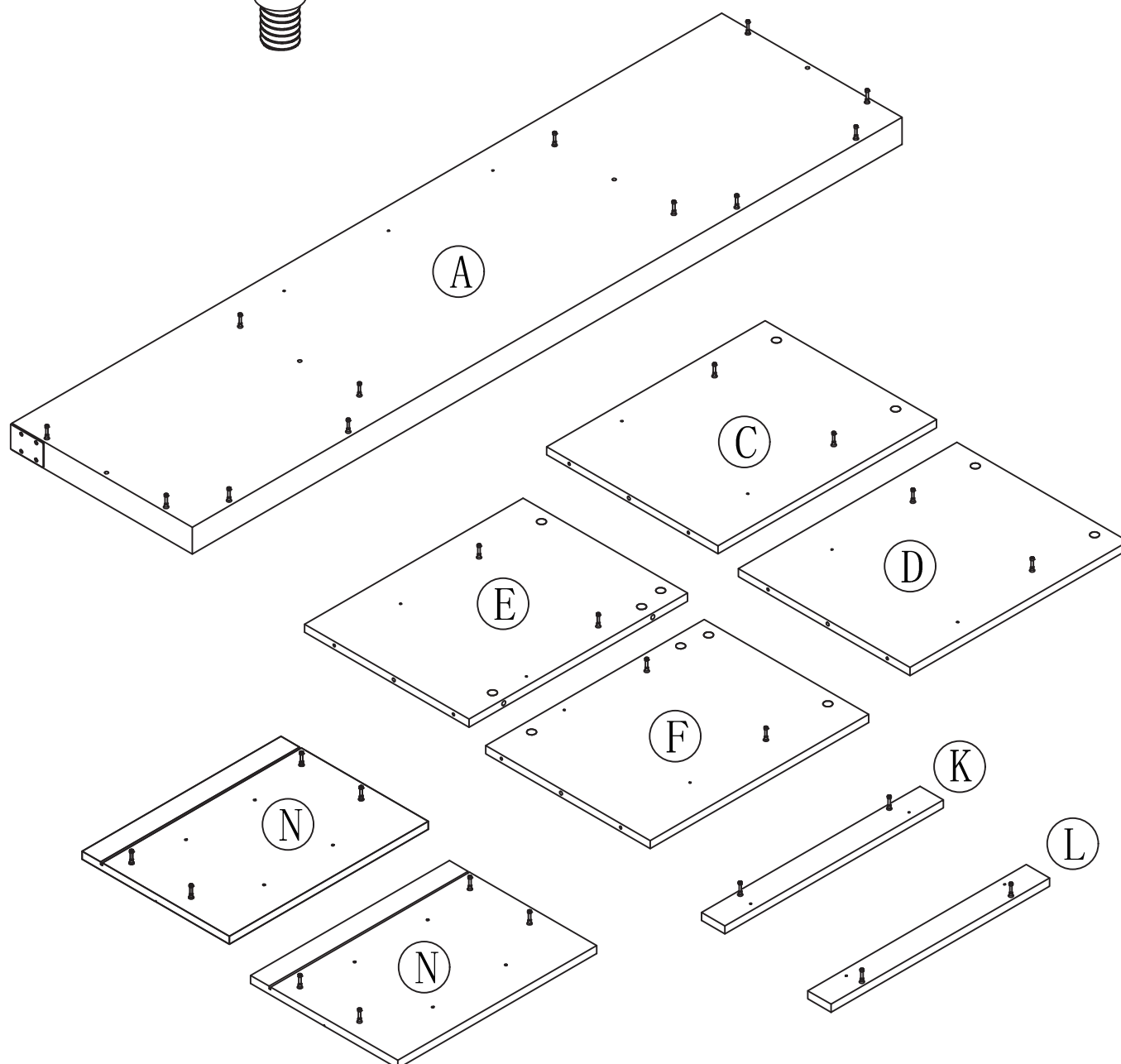
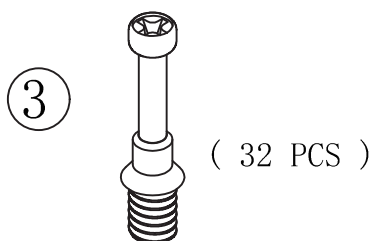
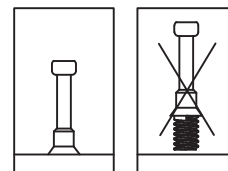

## Step 2

- ◆ Push sixteen HIDDEN CAMS (4) into the ENDS (C and D), UPRIGHTS (E and F), BACKS (G).

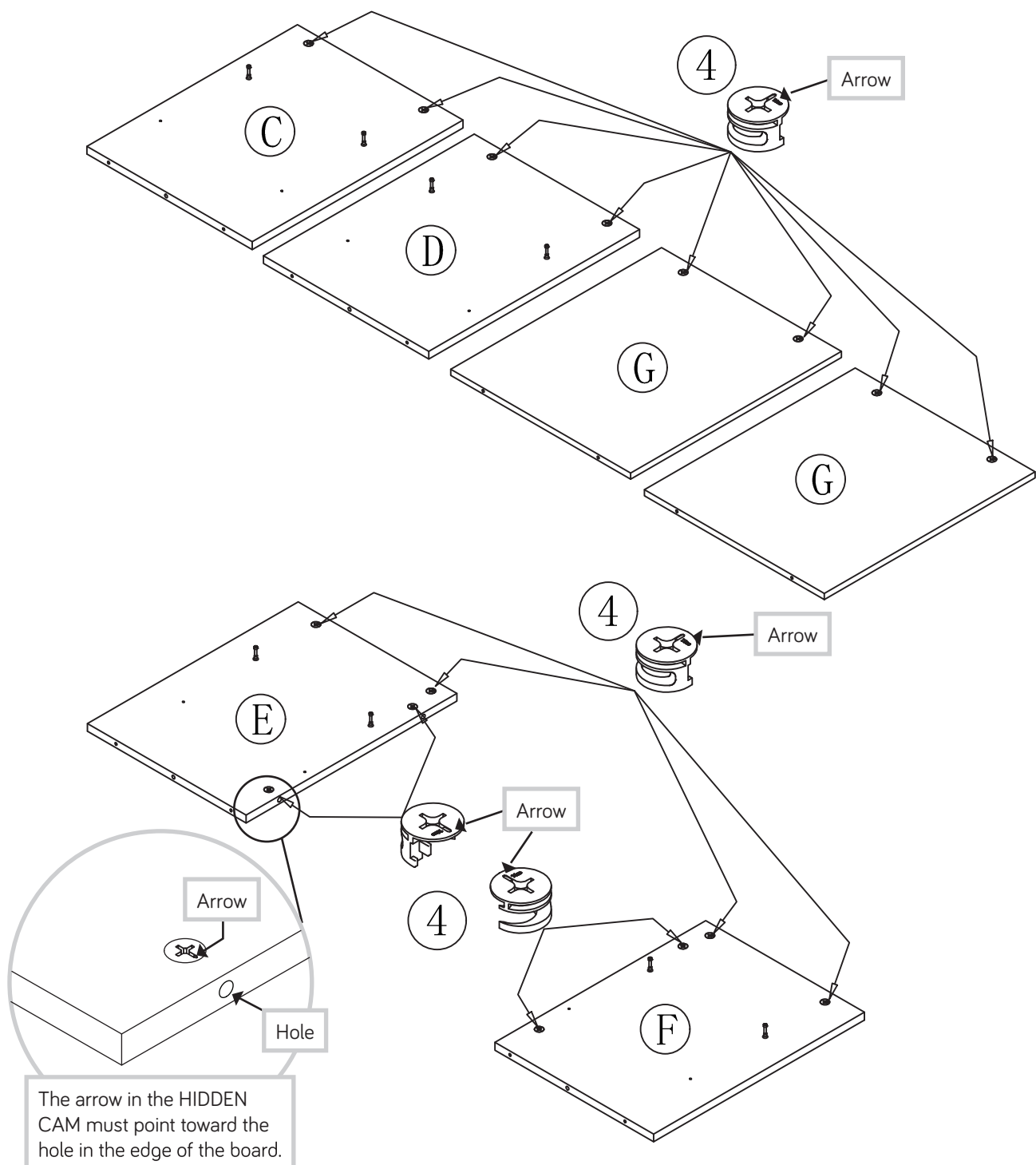

## Step 3

- ◆ Push sixteen HIDDEN CAMS (4) into the DRAWER LEFT (O), DRAWER RIGHT (P) and SHELVES (H).

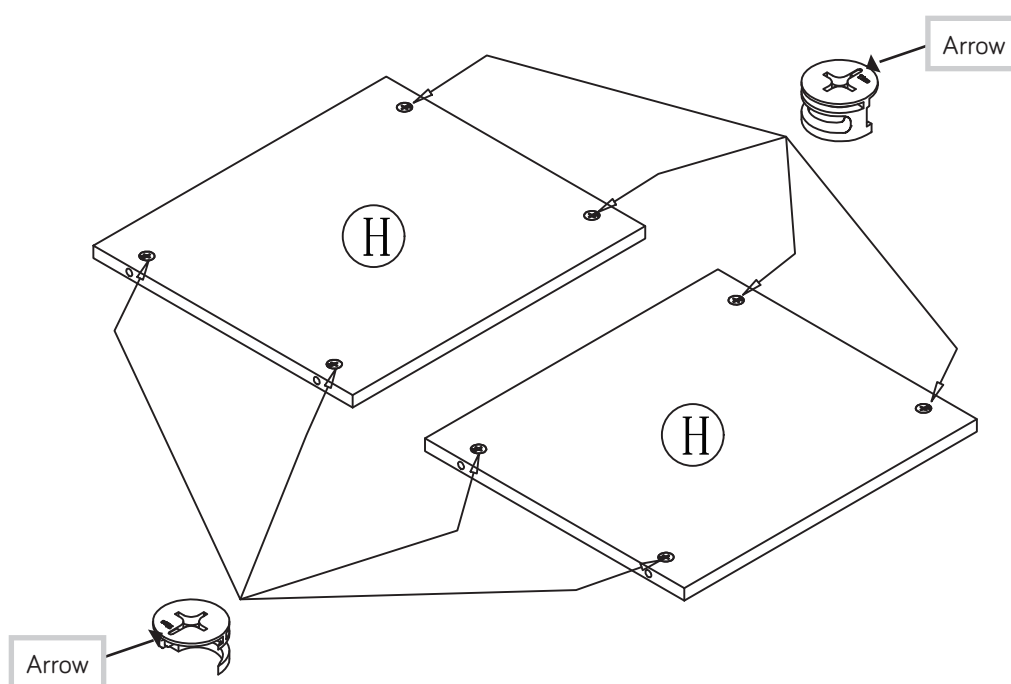
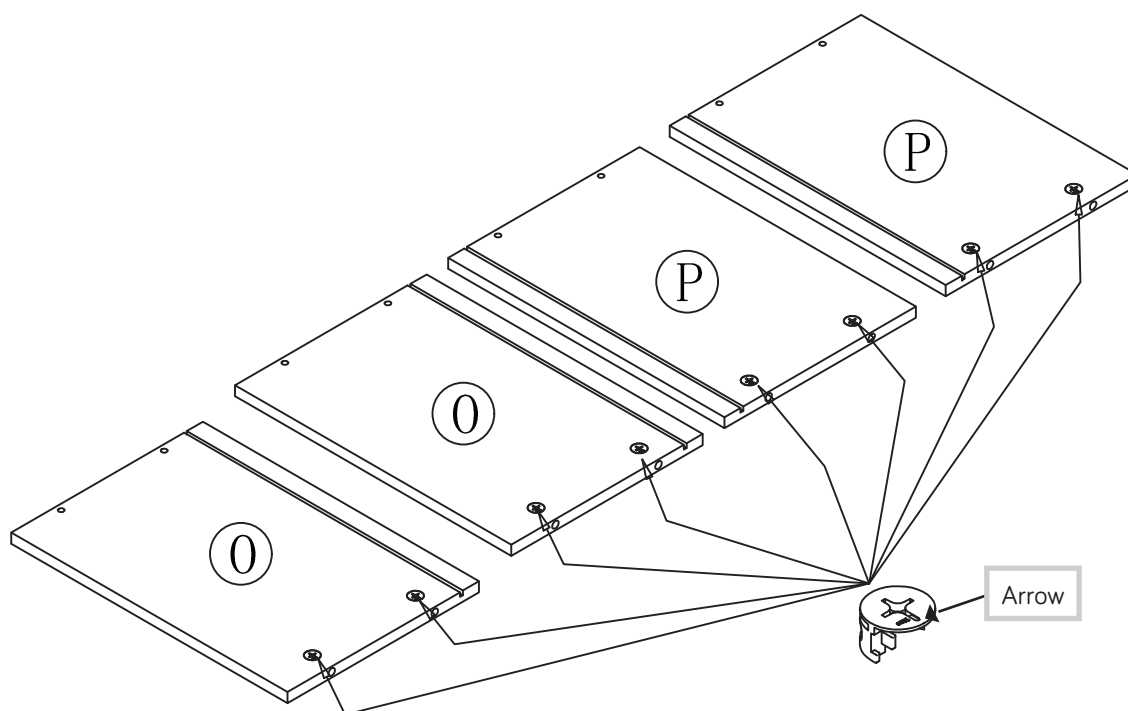



## Step 4

- ◆ Fasten the MOLDINGS (K and L) to the UPRIGHTS (E and F). Tighten four HIDDEN CAMS.

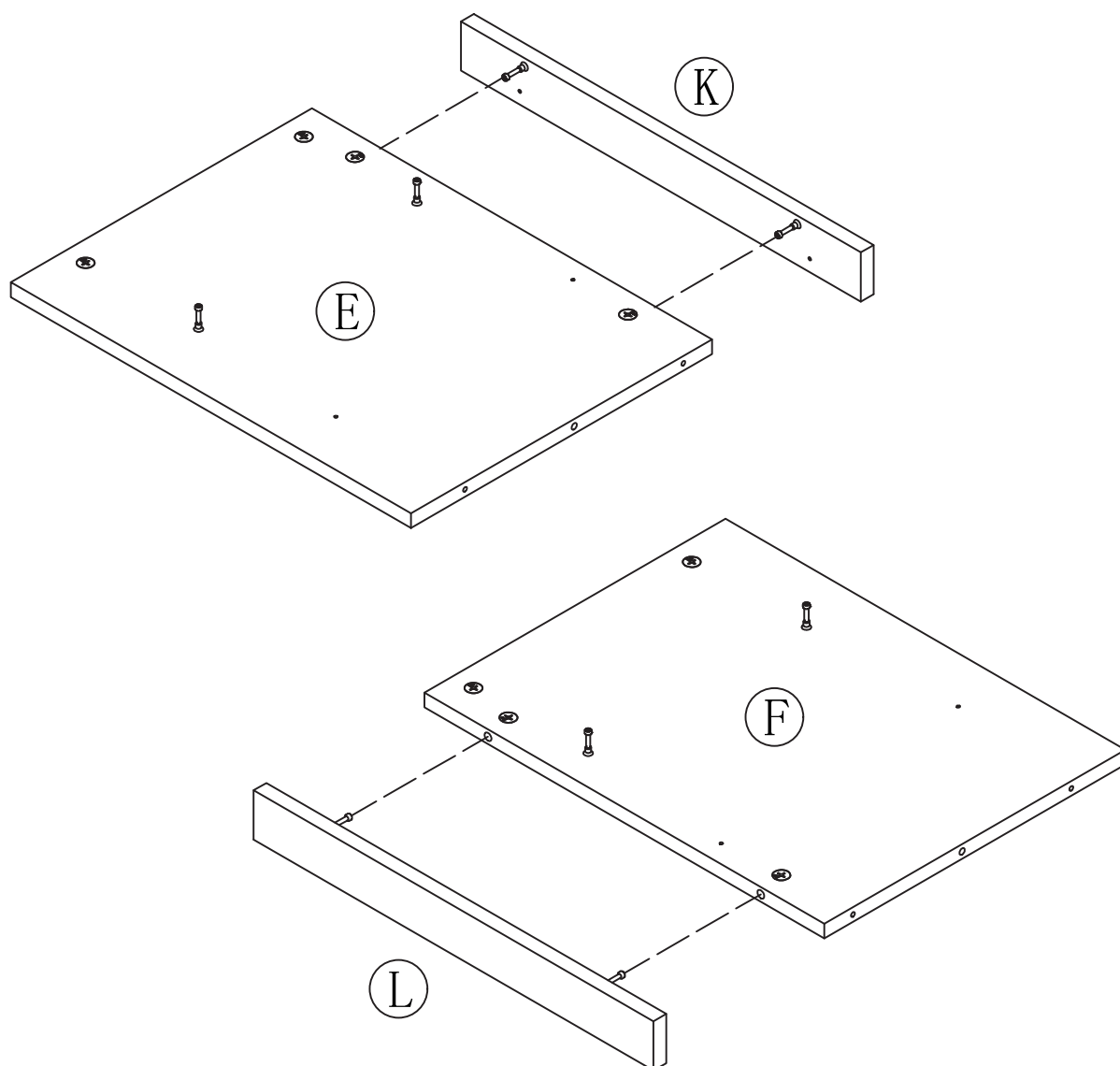
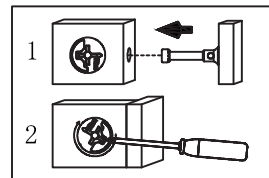
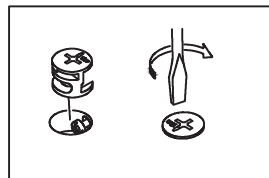
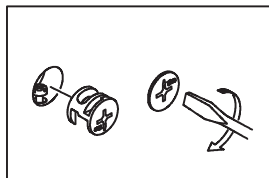

# Step 5

- ◆ Separate the WIDE EXTENSION SLIDES (2) from the WIDE EXTENSION RAILS (1) as shown in the upper diagram below. Be prepared, the parts are greasy.

- ◆ Fasten the WIDE EXTENSION RAILS (1) to the UPRIGHTS (E and F) and ENDS (C and D). Use four 1/2" FLAT HEAD SCREWS (12).

NOTE: For each EXTENSION RAIL, turn a SCREW into the hole shown in the enlarged diagram. Then, slide the inner cartridge of the EXTENSION RAIL in to find the other hole that lines up with the hole in the UPRIGHTS and ENDS.

- ◆ Turn a SCREW into this hole.

- ◆ NOTE: The EXTENSION SLIDES will be used later for the DRAWERS.

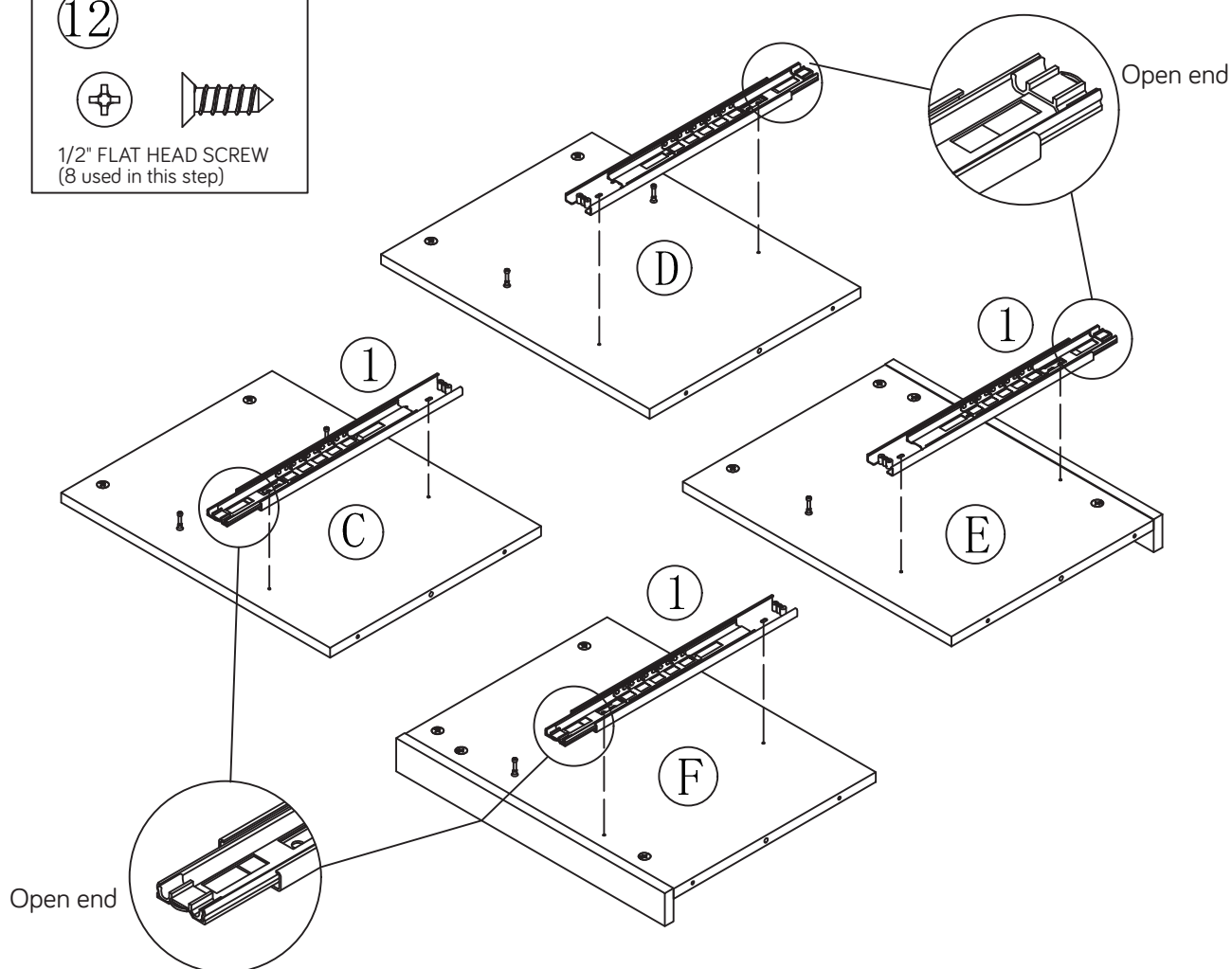
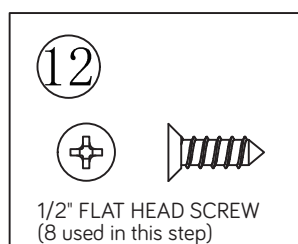
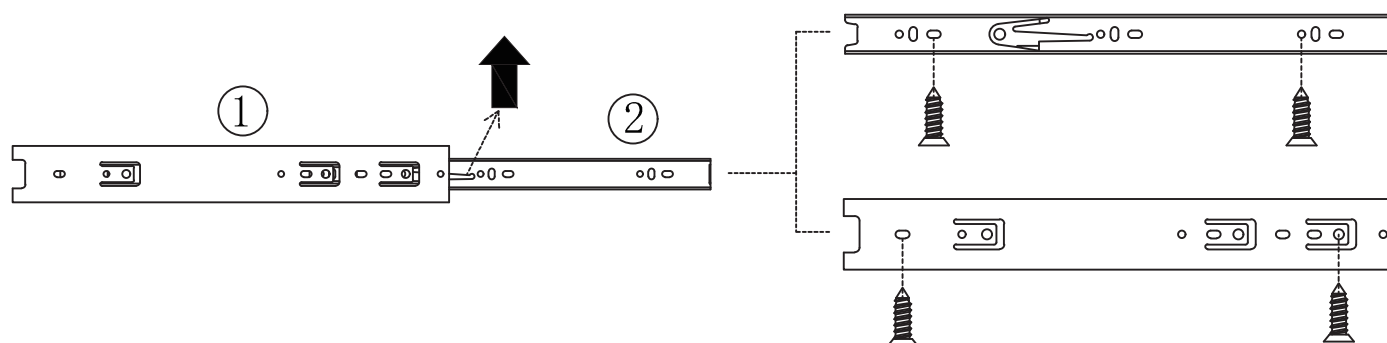

## Step 6

- ◆ Fasten the SHELVES (H) to the UPRIGHTS (E and F) and ENDS (C and D). Tighten eight HIDDEN CAMS.

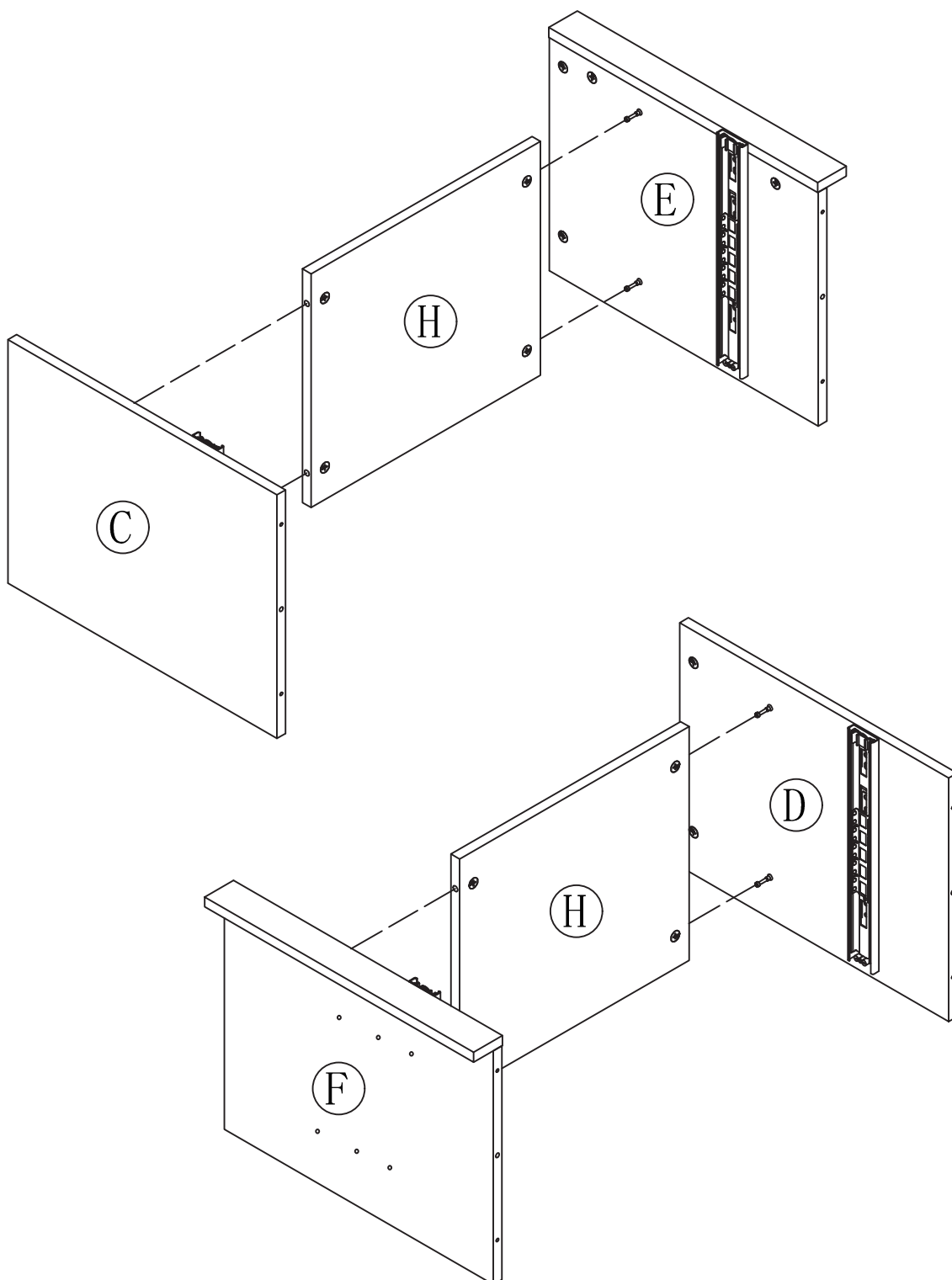
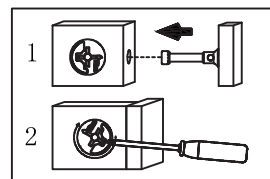
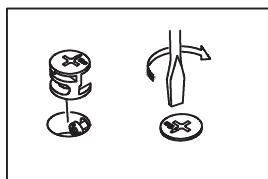
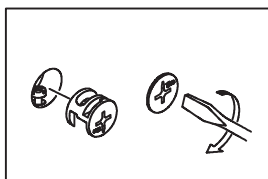

## Step 7

Fasten the TOP MOLDING (J) to the TOP (A).

- ◆ Use three BLACK 2" PAN HEAD SCREWS through the MOLDING and align to the holes in the top before you fasten.

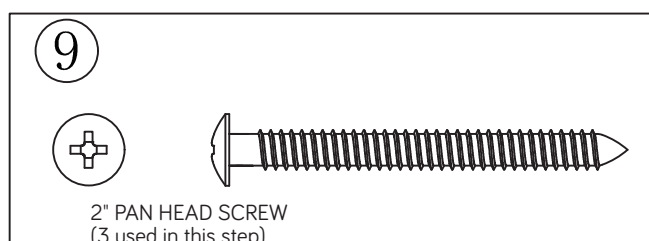
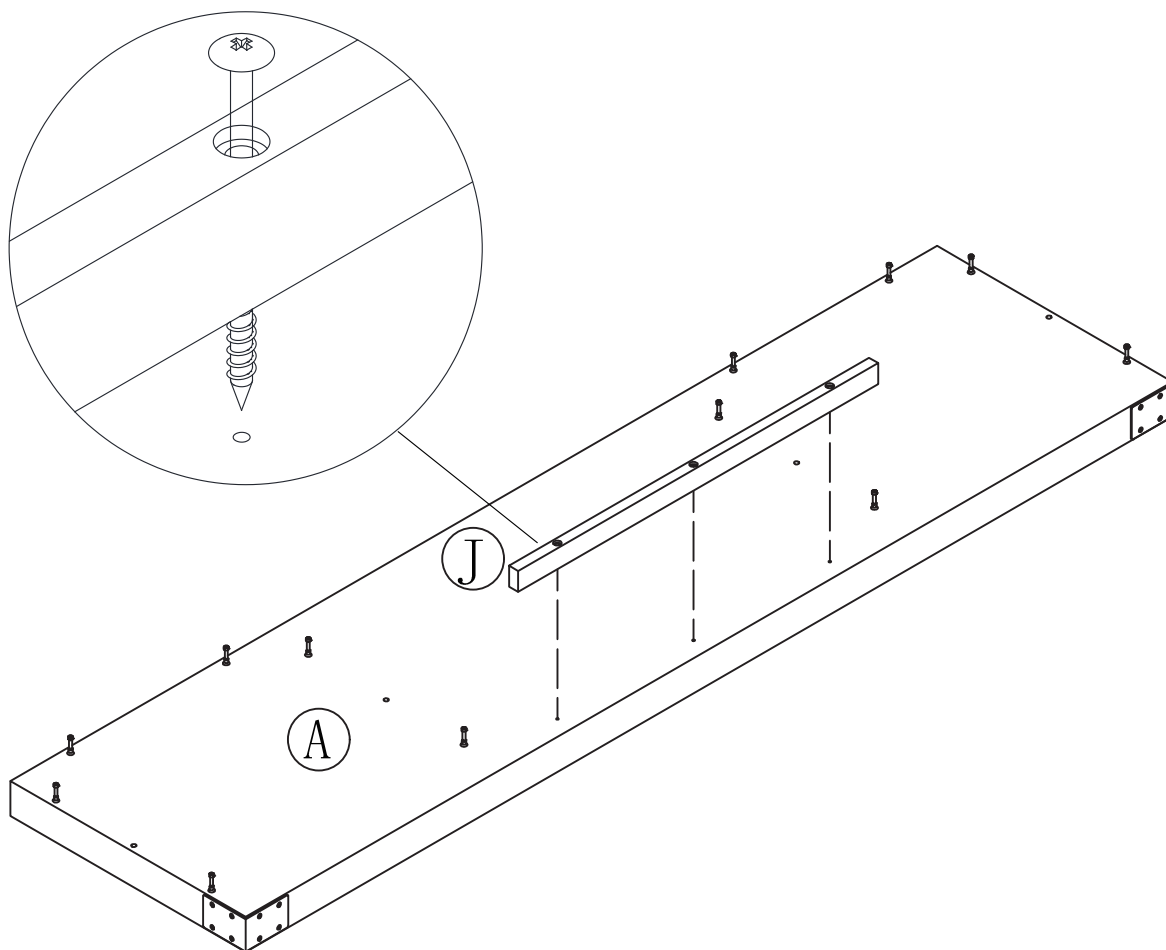

# Step 8

- ◆ Push the WOOD DOWELS (6) into the exact hole shown in the TOP (A).
- ◆ Fasten the ENDS (C and D) and the UPRIGHTS (E and F) to the TOP (A). Tighten eight HIDDEN CAMS.

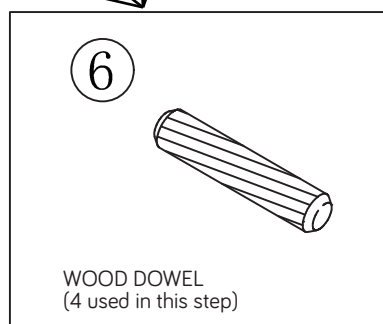
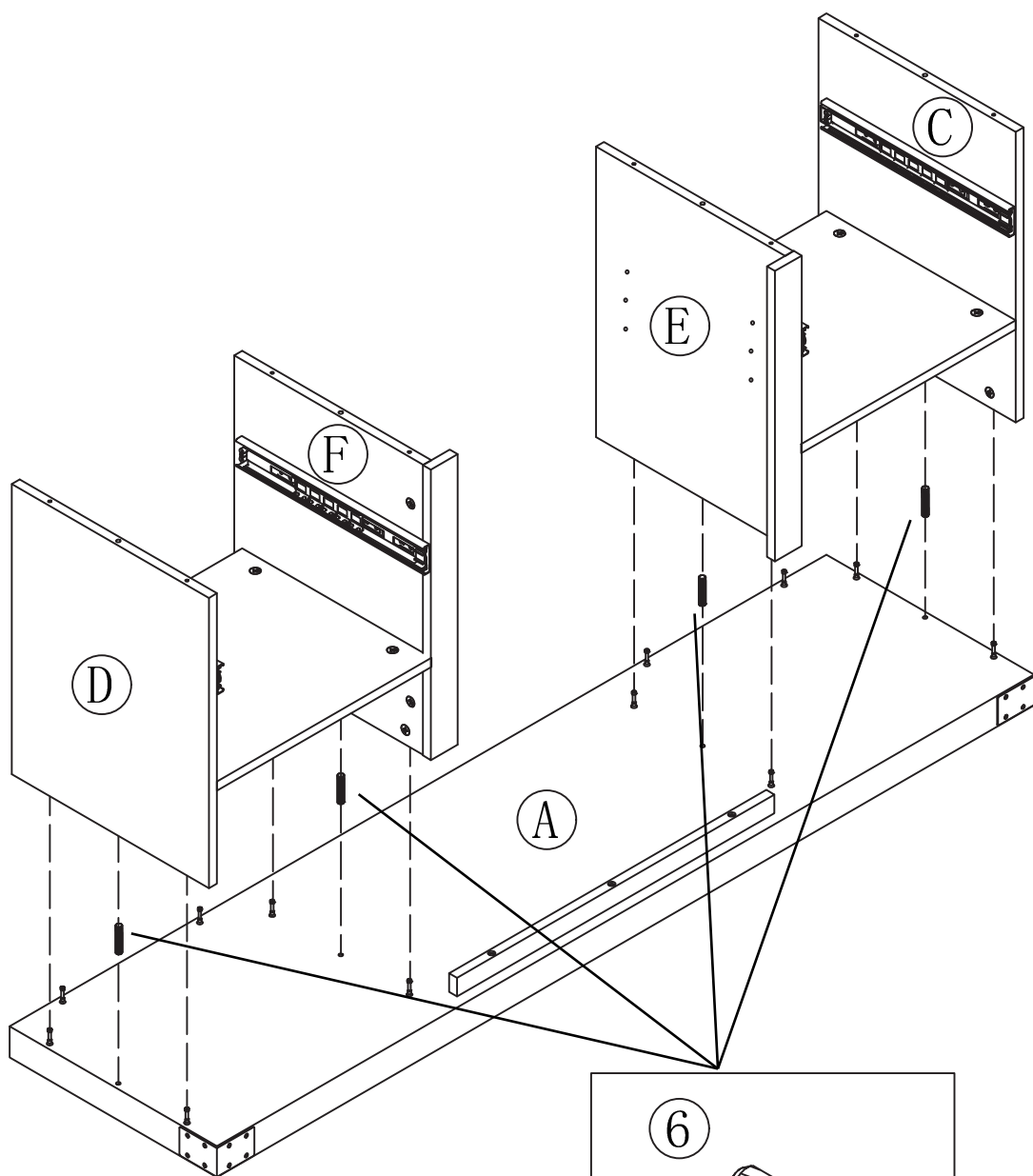
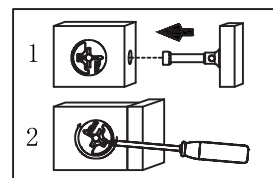
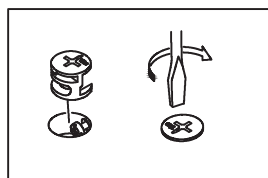
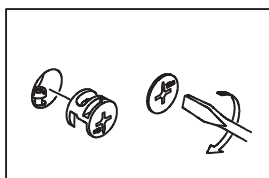

## Step 9

- ◆ Fasten the BACKS (G) to the TOP (A). Tighten four HIDDEN CAMS.

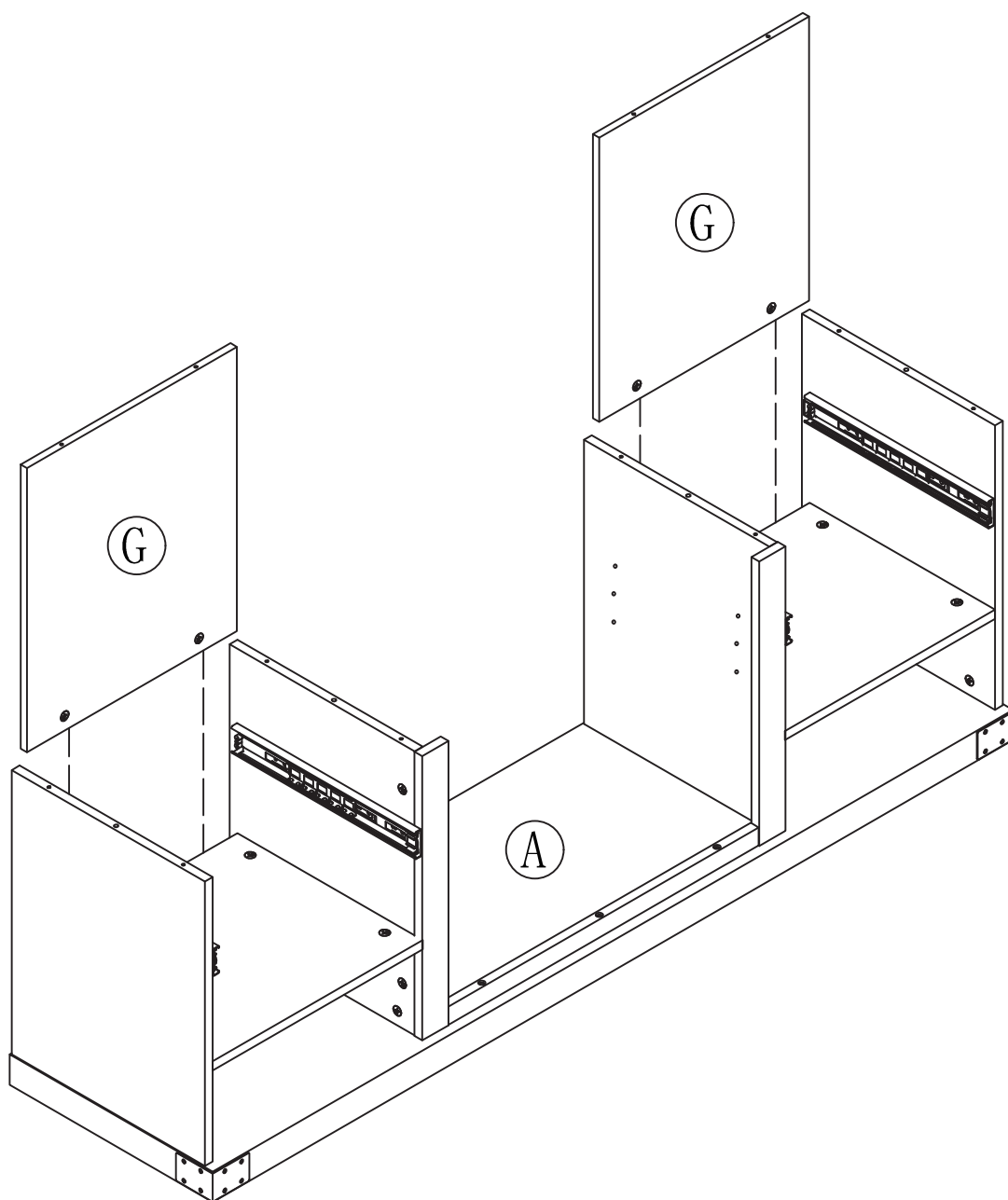
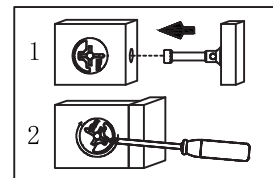
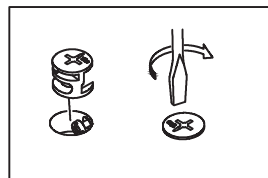
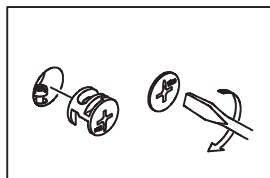

## Step 10

- ◆ Push the WOOD DOWELS (6) into the exact hole shown in the ENDS (C and D) and the UPRIGHTS (E and F).
- ◆ Fasten the BOTTOM (B) to the ENDS (C and D), UPRIGHTS (E and F) and the BACKS (G).
- ◆ Use twelve BLACK 2-11/16" PAN HEAD SCREWS (8).
- ◆ NOTE: You should align each SCREW to the holes before completely tightening any of them.

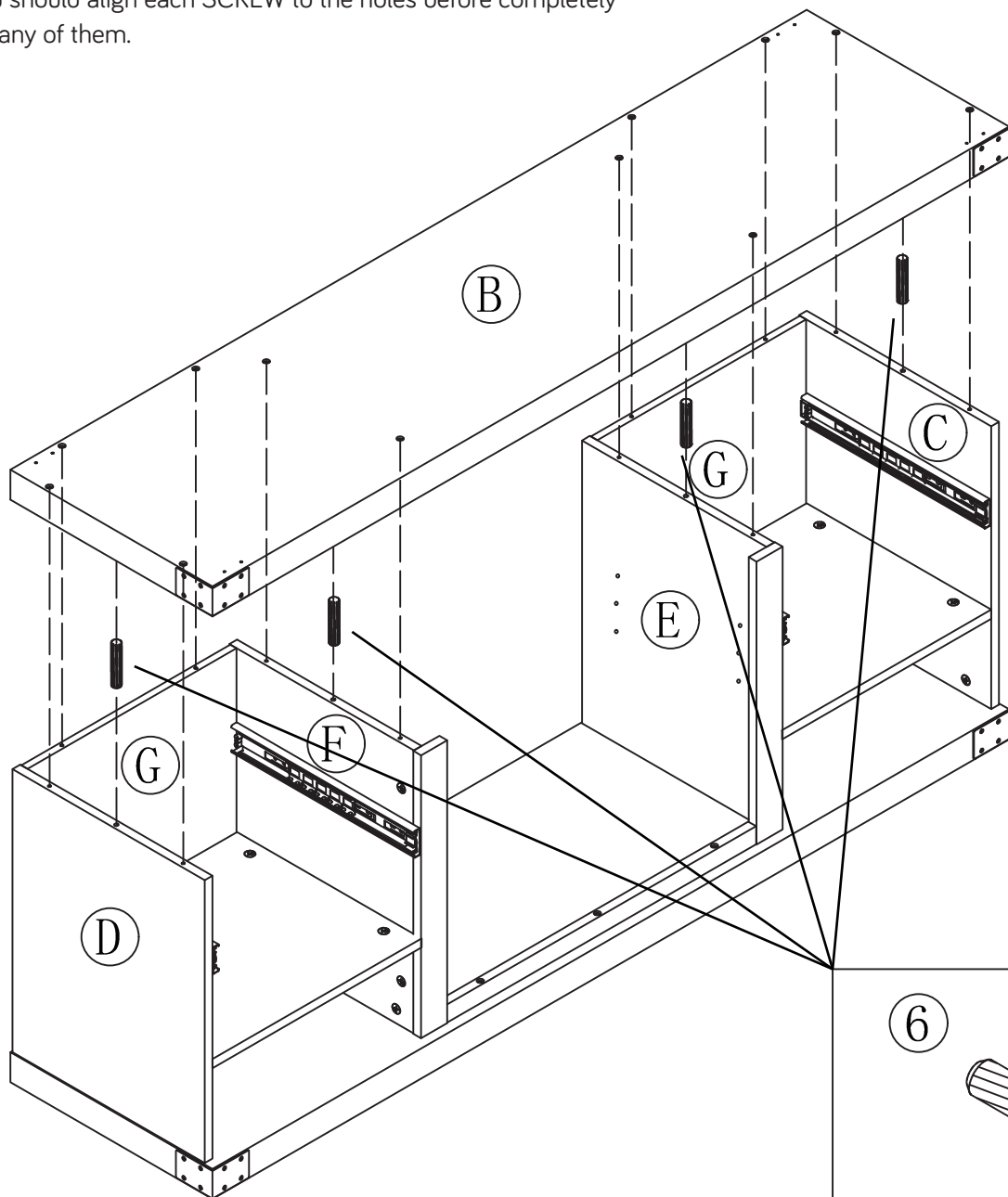

6

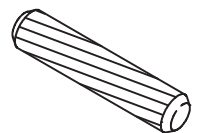

WOOD DOWEL  
(4 used in this step)

8

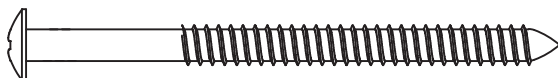

2-11/16" PAN HEAD SCREW  
(12 used in this step)

## Step 11

Fasten the FOOT (S) to the BOTTOMS (B).

- ◆ Use eight BLACK 2" PAN HEAD SCREWS through the FOOT and align to the holes in the bottom before you fasten.

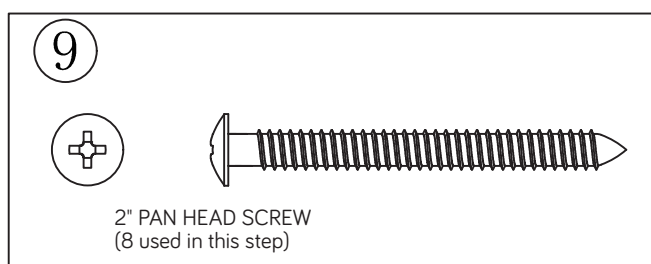
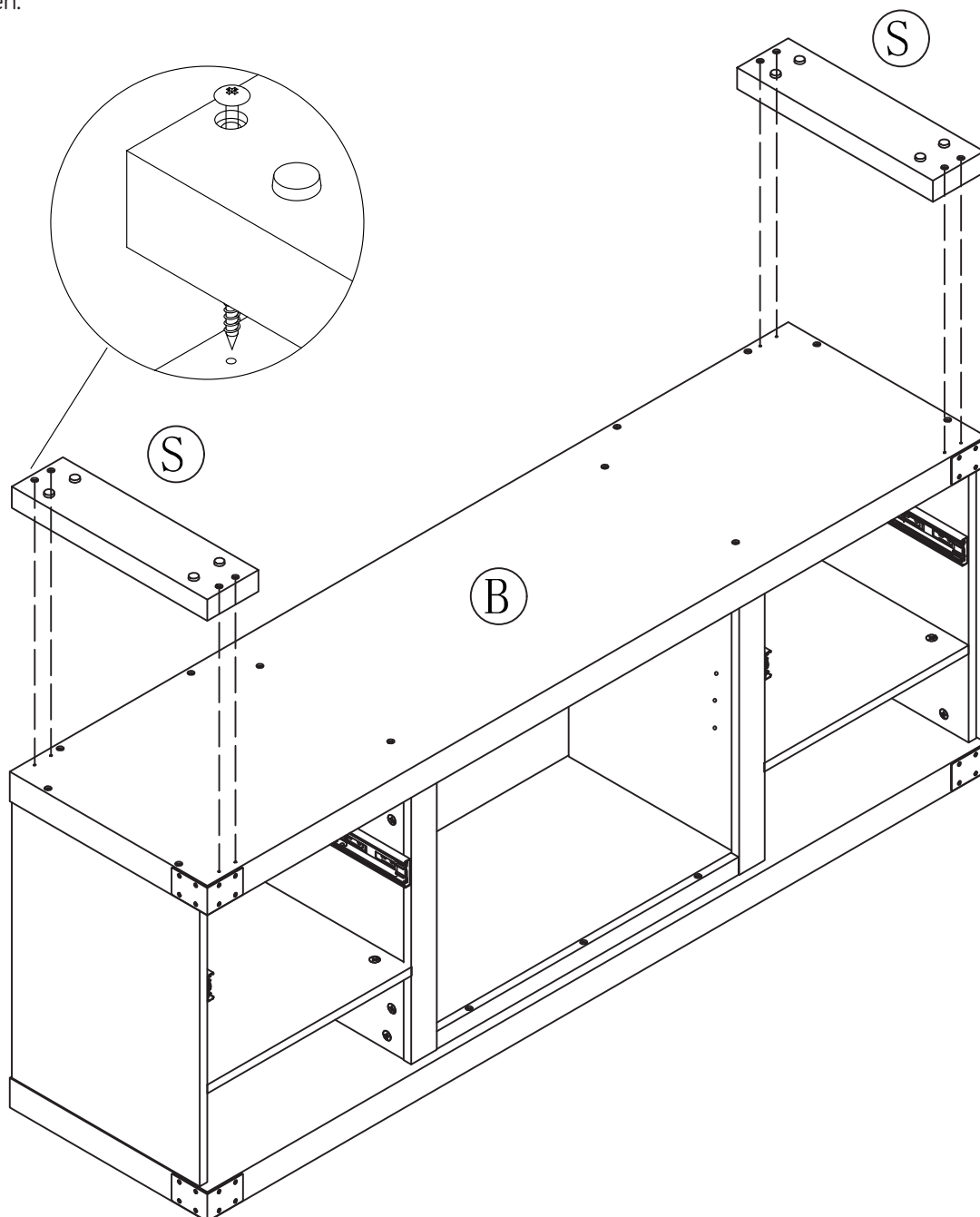



## Step 12

Fasten the DRAWER SIDES (O and P) to the DRAWER BACK (Q). Use four 1-3/16" PAN

- ◆ HEAD SCREWS through the DRAWER SIDES and please align to the holes in the DRAWER BACK before you fasten.
- ◆ Repeat this step for the other drawer.

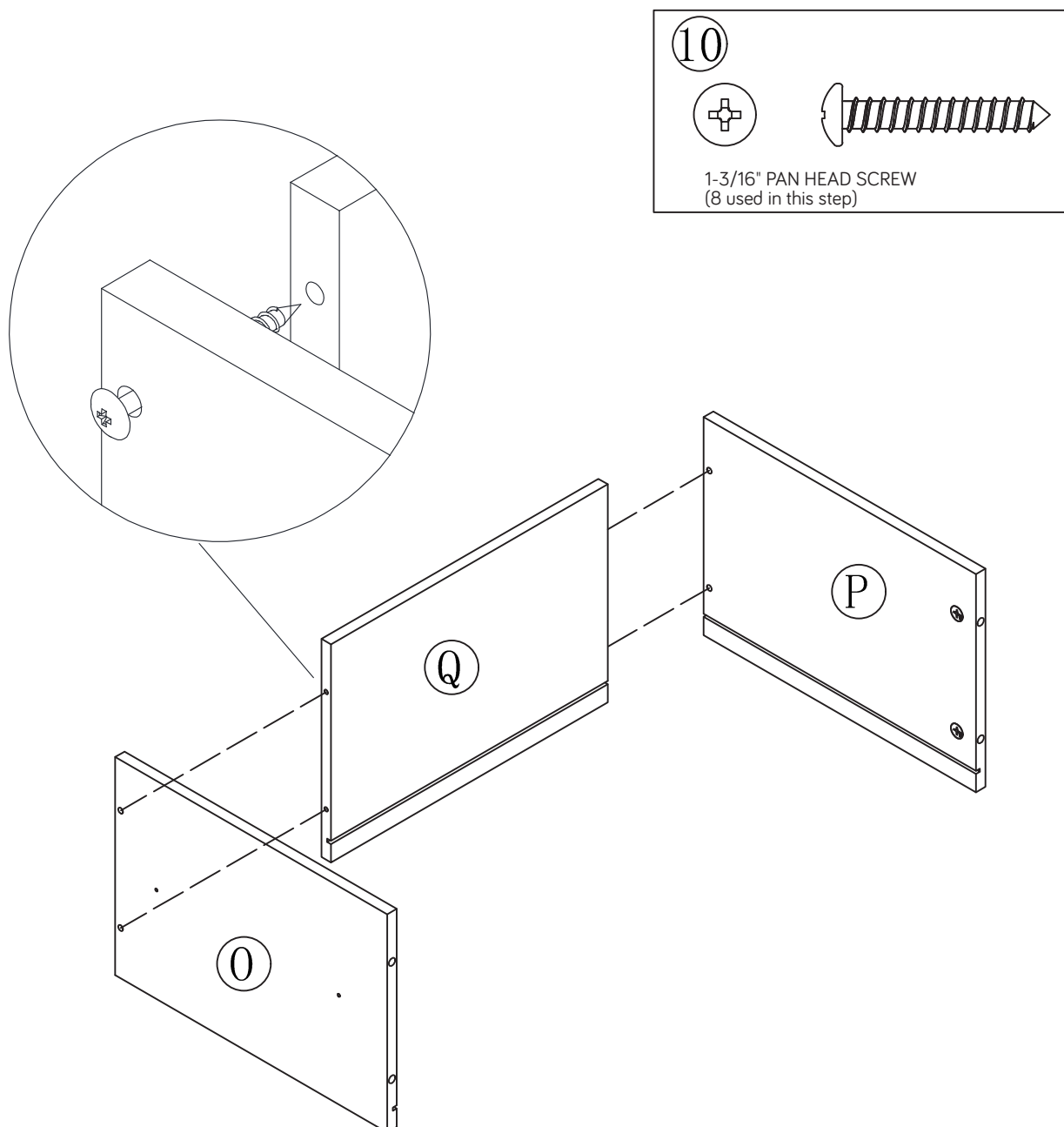

## Step 13

- Slide the DRAWER BOTTOM (R) into the  
◆ grooves in the DRAWER SIDES (O and P) and  
DRAWER BACK (Q).
- ◆ Repeat this step for the other drawer.
- ◆ Peel APPLIQUES from the APPLIQUE CARDS (11) and stick them onto each visible HIDDEN CAM.

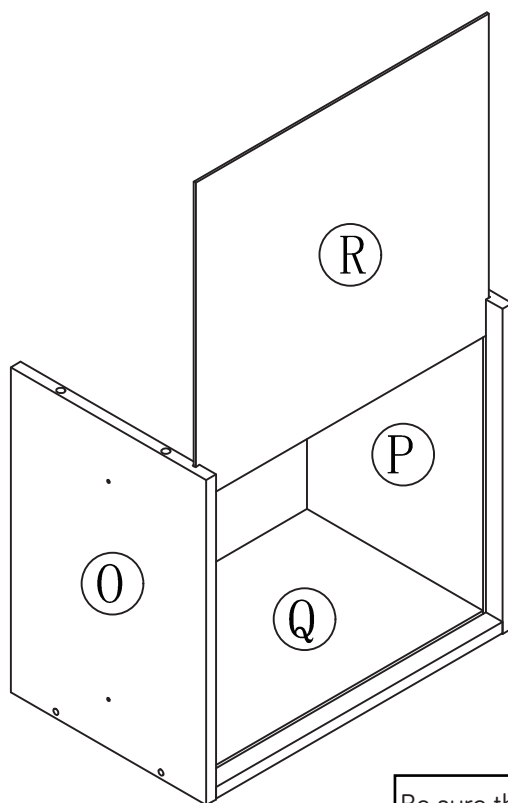

Be sure the DRAWER  
BOTTOM inserts into the  
DRAWER BACK groove.

## Step 14

- ◆ Fasten the DRAWER FRONT (N) to the DRAWER SIDES (O and P). Tighten four HIDDEN CAMS.
- ◆ Fasten the PULLS (5) to the DRAWER FRONT (N). Use four 3/4" MACHINE SCREWS (11).
- ◆ Repeat this step for the other drawer.

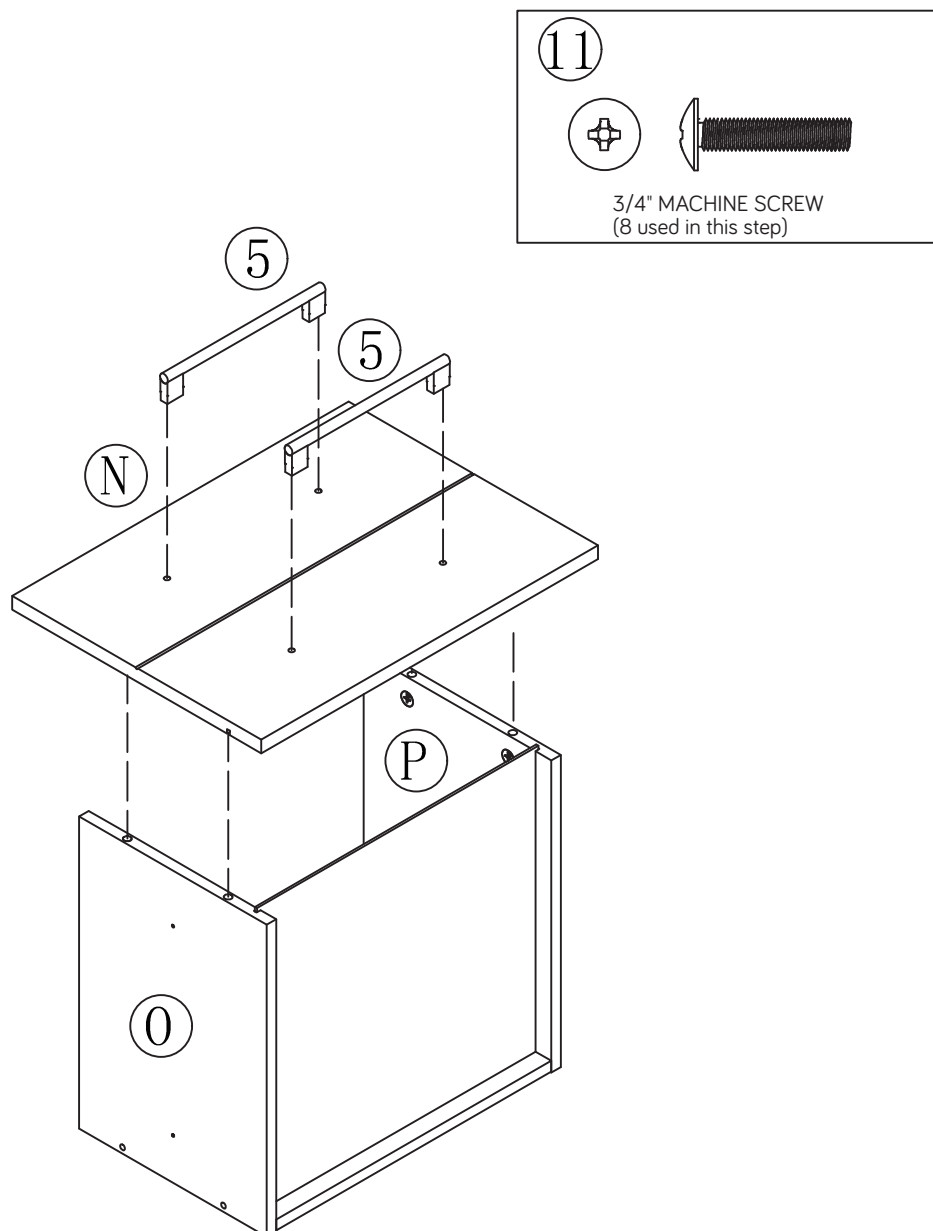

## Step 15

- ◆ Fasten the WIDE EXTENSION SLIDES (2) to the DRAWER SIDES (O and P). Use four 1/2" FLAT HEAD SCREWS (9).
- ◆ Repeat this step for the other drawer.

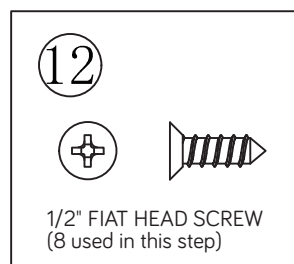
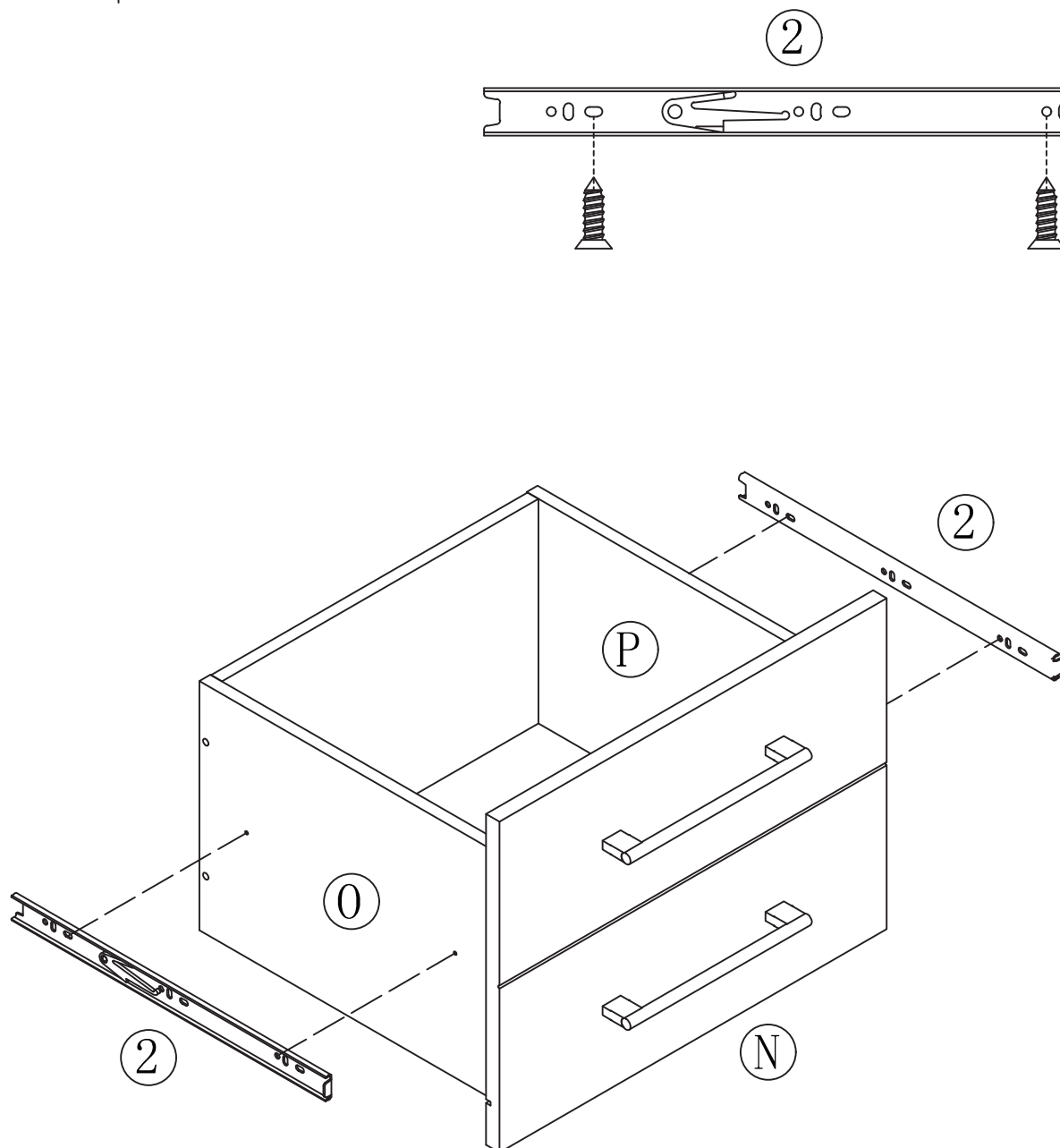

## Step 16

- To insert the FILE DRAWER into your unit, line up the EXTENSION SLIDES on the drawer with the EXTENSION RAILS on the unit and push the drawer into the unit until the drawer is fully inserted.
- ◆ The drawer will push in hard until it is all the way in, then it will slide in and out easier.

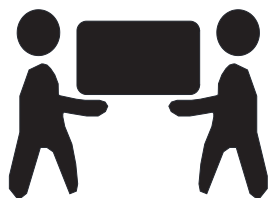
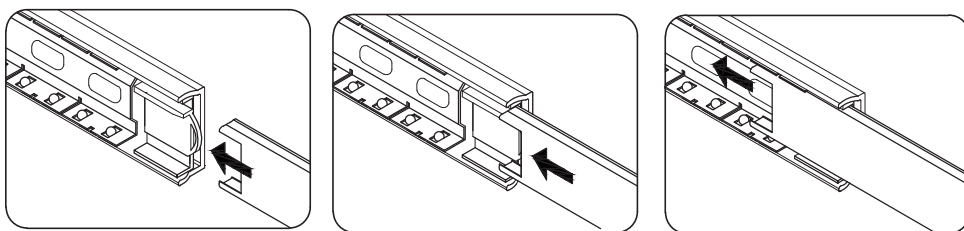

Pro Tip: Lift with your legs. And, you know, your arms.

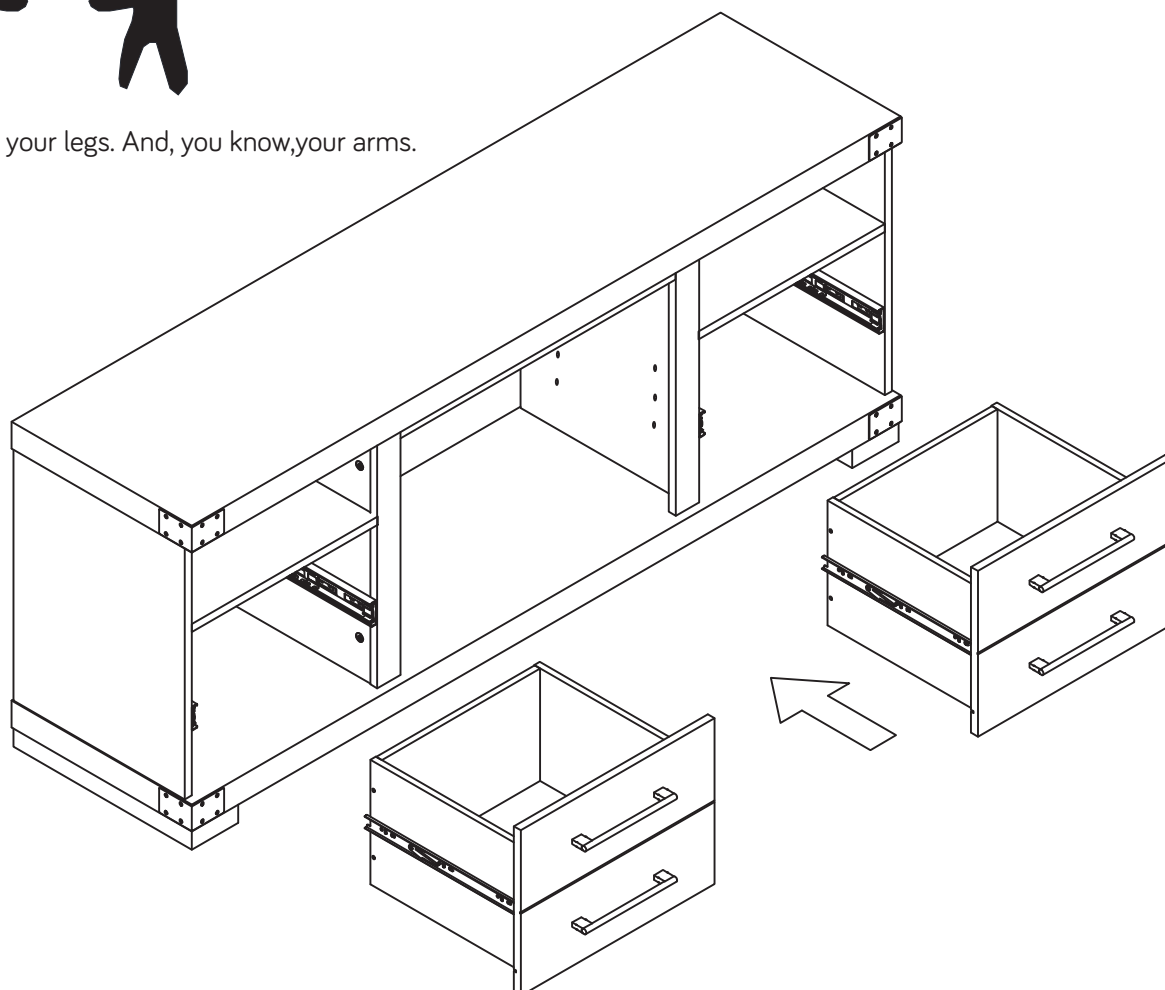

## Step 17

- ◆ Please go to step 18 if you want to put the middle shelf (Z) as show in diagram #1 or go to step 20 if you want to put the insert as show in diagram #2.

Diagram #1

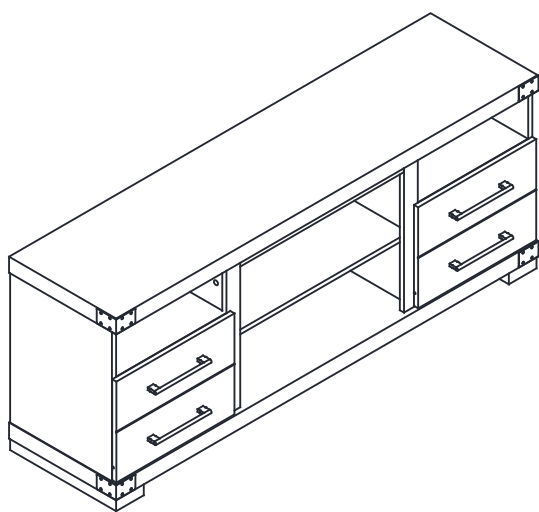
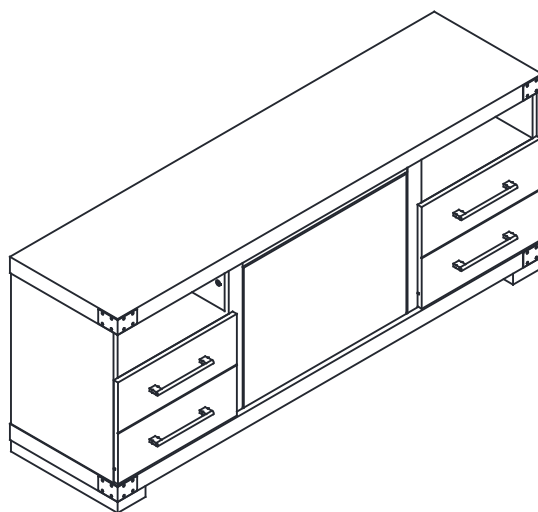
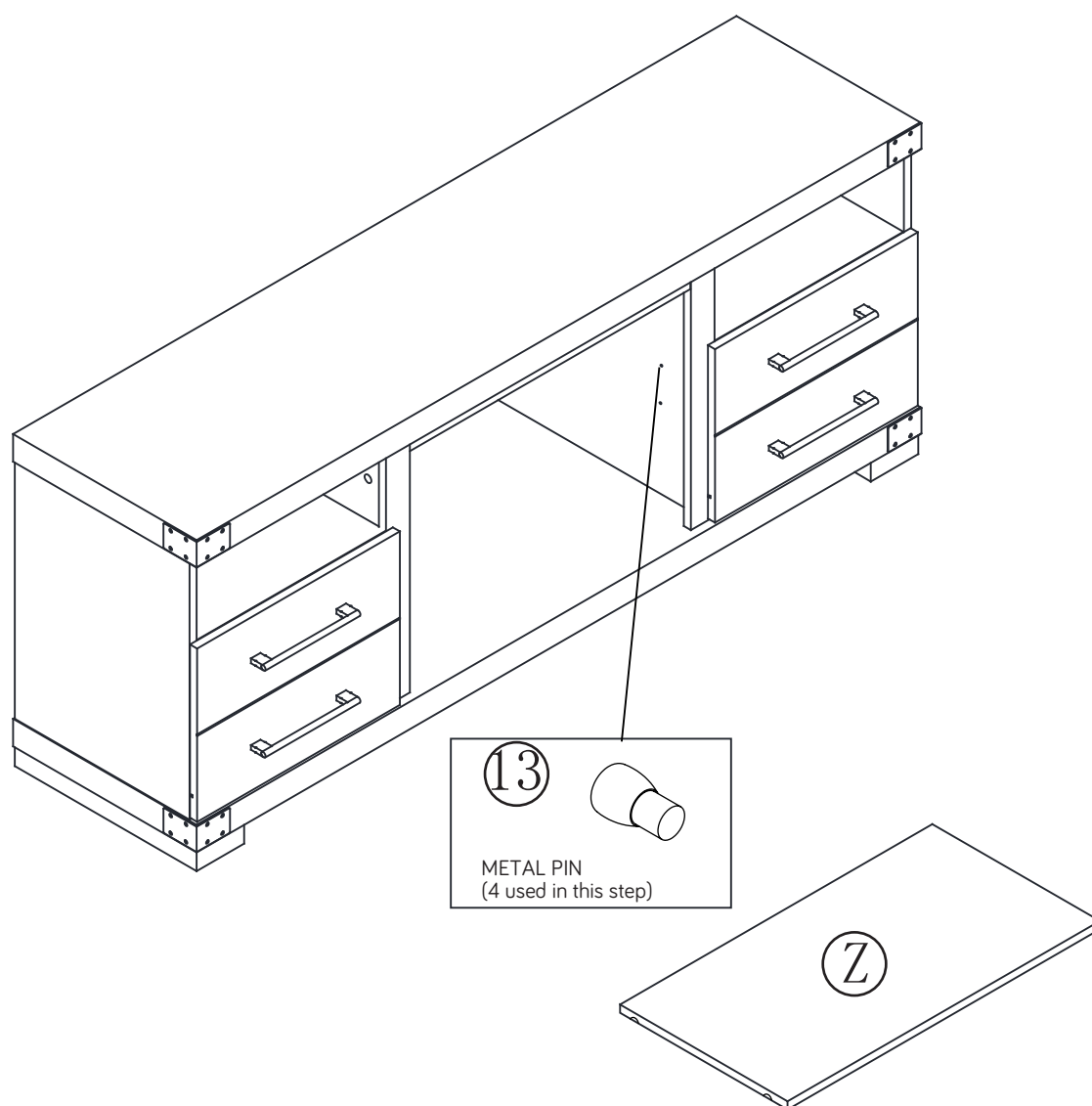

Diagram #2



## Step 18

- ◆ Insert the METAL PINS (13) into the hole locations of your choice in the UPRIGHTS (F and E).
- ◆ Set the ADJUSTABLE SHELF (Z) onto the METAL PINS.



## Step 19

- ◆ Peel APPLIQUES from the APPLIQUE CARDS (7) and stick them onto each visible HIDDEN CAM.
- ◆ This completes assembly. Clean with a damp cloth. Wipe dry.
- ◆ Apply the WARNING LABEL (14) to the TOP (A). You should be able to read the label when the TV is removed from the unit. When the TV is in place, it should hide the label. Peel off the backing and apply the label as shown in the diagram.
- ◆ NOTE: This is a permanent label intended to last for the life of the product. Once applied, do not try to remove it.
- ◆ This completes assembly. Clean with a damp cloth. Wipe dry.

⚠ WARNING	• ADVERTENCIA •	AVERTISSEMENT ⚠
<p>Never use this furniture with a TV that is too large or too heavy. Severe injury or death can occur. The TV and furniture will be unstable and may tip.</p> <p>-The TV <b>must</b> weigh less than <b>70 lbs.</b> -The base of the TV <b>must</b> be able to sit completely on this shelf.</p> <p>Refer to instruction book for complete safety information.</p> <p><i>Note: This is a <u>permanent</u> label. Do not try to remove. Surface will be damaged.</i></p>	<p>Nunca use este mueble con un televisor que es demasiado grande o demasiado pesado. Podría resultar en una lesión grave hasta fatal. El televisor y el mueble estarán inestables y pueden volcarse.</p> <p>-El televisor debe pesar <b>31,75 kg o menos.</b> -La base del televisor <b>debe</b> poder colocarse completamente sobre este estante.</p> <p>Consulte el folleto de instrucciones para información completa sobre la seguridad.</p> <p><i>Nota: Esta etiqueta es <u>permanente</u>. No intente quitarla. Causará daño a la superficie.</i></p>	<p>Ne jamais utiliser ce meuble avec un téléviseur qui soit trop large ou trop lourd. Risque de provoquer des blessures graves, voire mortelles. Le téléviseur et le meuble seront instables et risquent de se renverser.</p> <p>-Le téléviseur doit peser <b>31,75 kg ou moins.</b> -Le socle du téléviseur <b>doit</b> pouvoir être placé complètement sur cette tablette.</p> <p>Consulter le manuel d'instructions pour information complète concernant la sécurité.</p> <p><i>Remarque: Cette étiquette est <u>permanente</u>. Ne pas essayer de la retirer. Causera des dommages à la surface.</i></p>

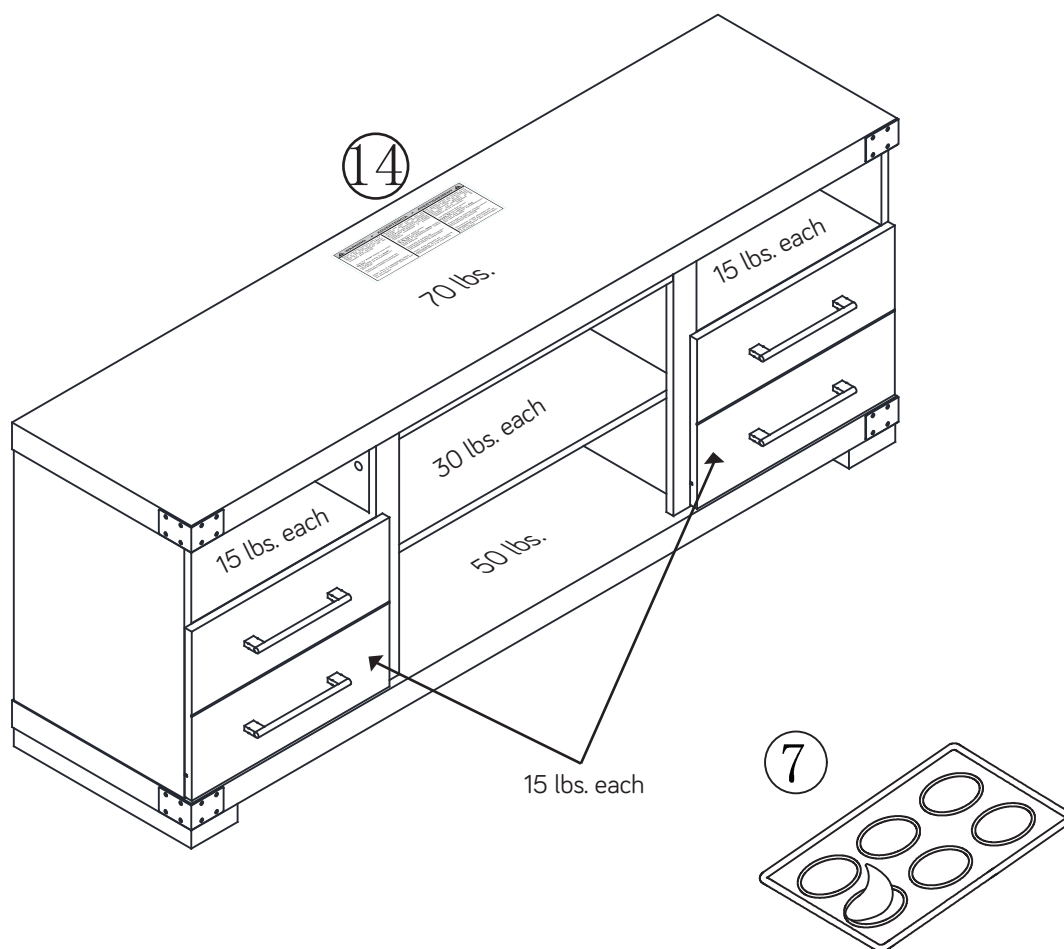



## Step 20

- ◆ Fasten the BRACKETS (X and Y) to the FIREPLACE (W). Use four 3/8" FLAT HEAD SCREWS (9).

### **WARNING**

#### CAUTION!!

Please read all FIREPLACE instructions prior to installing or removing it from your unit.  
Do not plug the FIREPLACE into the power supply until it is installed and your unit is in its final position. Do not move the FIREPLACE while it is plugged into a power supply. Unplug it before moving it.

ZZ

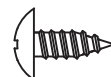

3/8" PAN HEAD SCREW  
(6 used in this step)

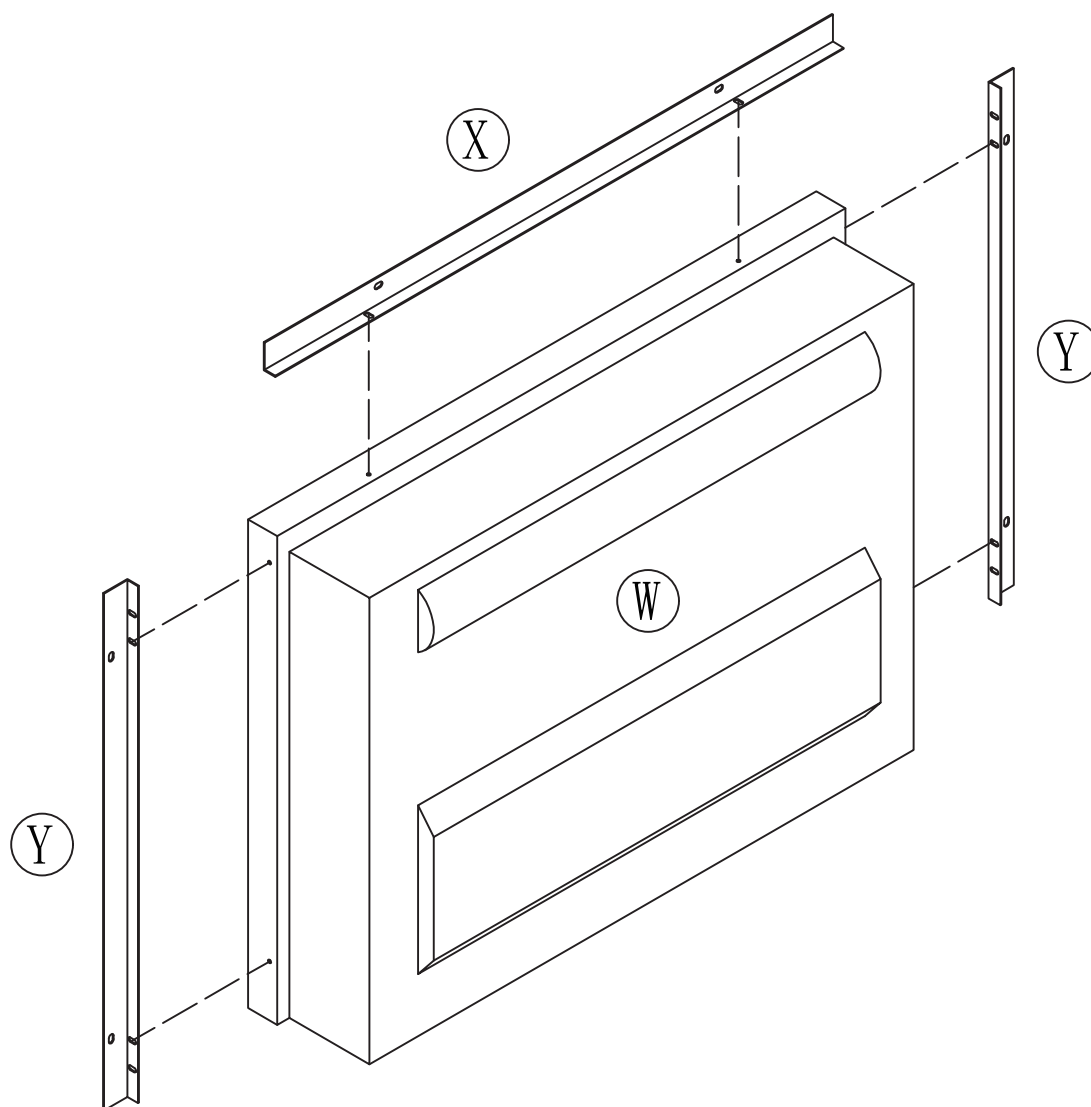

## Step 21

- ◆ Insert the FIREPLACE (W) in through the opening in the back of your unit.
- ◆ Fasten the FIREPLACE (W) to the MOLDINGS (J, K and L).

- Use two BLACK 3/8" PAN HEAD SCREWS (ZZ) through
- ◆ the BRACKETS on the FIREPLACE and into the holes in the MOLDINGS.

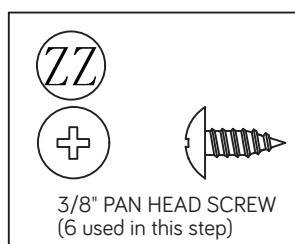
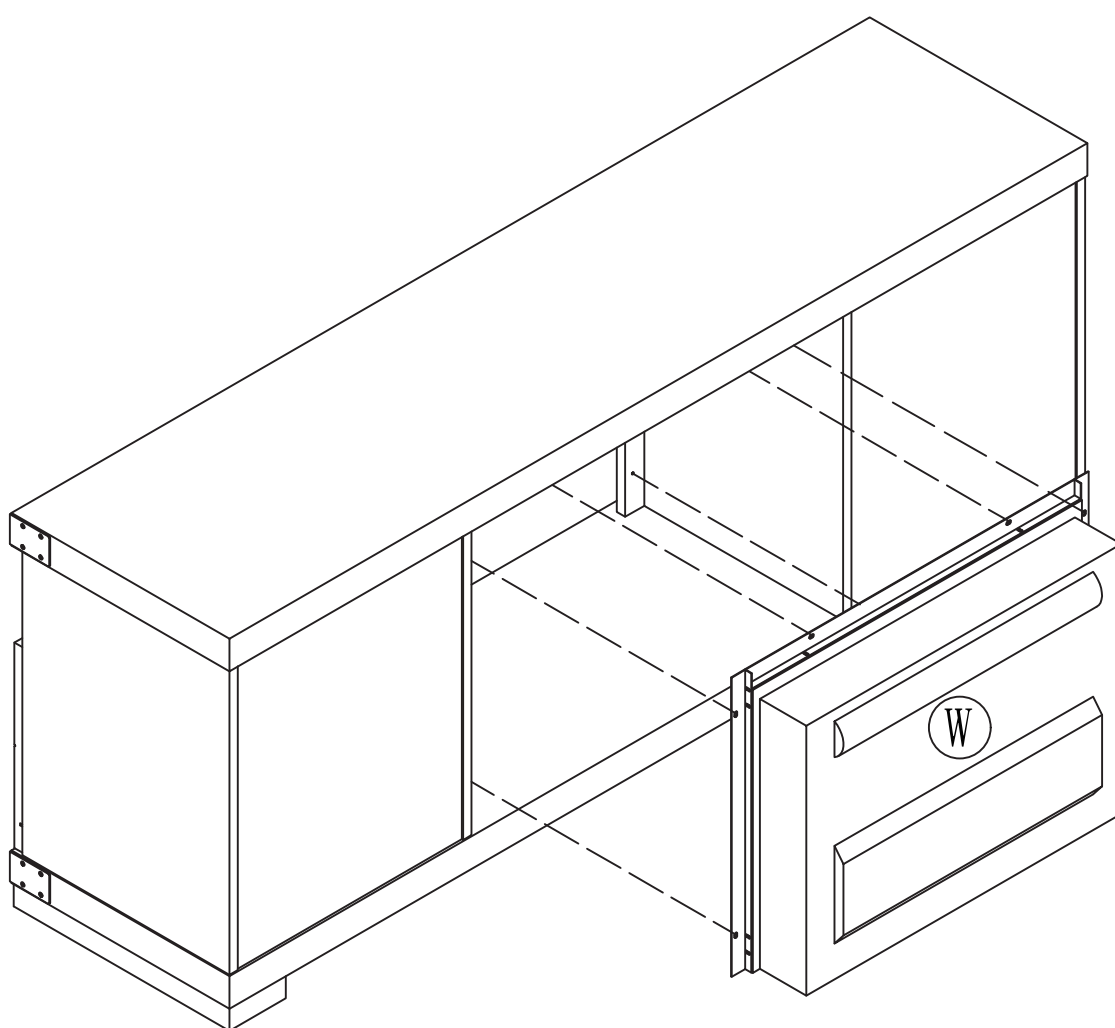

## Step 22

- ◆ Peel APPLIQUES from the APPLIQUE CARDS (7) and stick them onto each visible HIDDEN CAM. This completes assembly. Clean with a damp cloth. Wipe dry.
- ◆ Apply the WARNING LABEL (14) to the TOP (A). You should be able to read the label when the TV is removed from the unit. When the TV is in place, it should hide the label. Peel off the backing and apply the label as shown in the diagram.
- ◆ NOTE: This is a permanent label intended to last for the life of the product. Once applied, do not try to remove it.
- ◆ This completes assembly. Clean with a damp cloth. Wipe dry.

⚠ WARNING	• ADVERTENCIA	• AVERTISSEMENT ⚠
Never use this furniture with a TV that is too large or too heavy. Severe injury or death can occur. The TV and furniture will be unstable and may tip.	Nunca use este mueble con un televisor que es demasiado grande o demasiado pesado. Podría resultar en una lesión grave hasta fatal. El televisor y el mueble estarán inestables y pueden volcarse.	Ne jamais utiliser ce meuble avec un téléviseur qui soit trop large ou trop lourd. Risque de provoquer des blessures graves, voire mortelles. Le téléviseur et le meuble seront instables et risquent de se renverser.
-The TV <b>must</b> weigh less than <b>70 lbs.</b> -The base of the TV <b>must</b> be able to sit completely on this shelf.	-El televisor debe pesar <b>31,75 kg</b> o menos. -La base del televisor <b>debe</b> poder colocarse completamente sobre este estante.	-Le téléviseur doit peser <b>31,75 kg</b> ou moins. -Le socle du téléviseur <b>doit</b> pouvoir être placé complètement sur cette tablette.
Refer to instruction book for complete safety information.	Consulte el folleto de instrucciones para información completa sobre la seguridad.	Consulter le manuel d'instructions pour information complète concernant la sécurité.
<i>Note: This is a <u>permanent</u> label. Do not try to remove. Surface will be damaged.</i>	<i>Nota: Esta etiqueta es <u>permanente</u>. No intente quitarla. Causará daño a la superficie.</i>	<i>Remarque: Cette étiquette est <u>permanente</u>. Ne pas essayer de la retirer. Causer des dommages à la surface.</i>

