

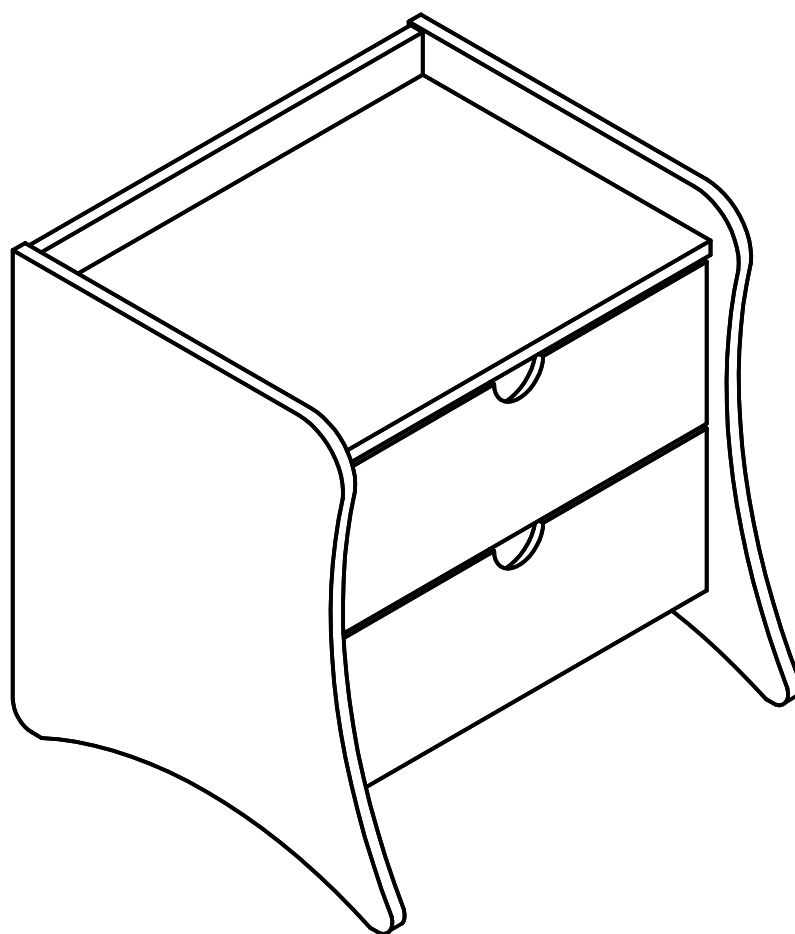

**MANHATTAN
COMFORT**

181GMC

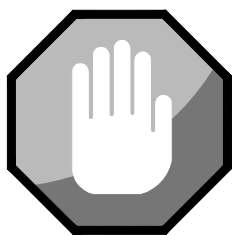



STOP!

Before beginning the assembly process,
ensure all boxes and parts have been delivered.

ATTENTION: BEFORE START ASSEMBLING TAKE A PICTURE OF THE LABELS ON THE PACKAGES, THIS WILL BE REQUIRED IN CASE THE PRODUCT HAS ANY ASSISTANCE DEMAND.

FOR BEST RESULTS:

- Do not throw away packaging materials until assembly is complete.
- Assemble item on a soft surface, such as cardboard or carpet, to protect finish.
- Proper assembly requires one person.

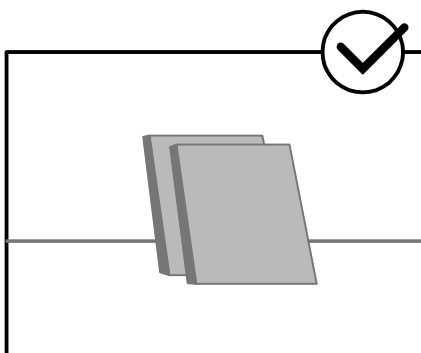
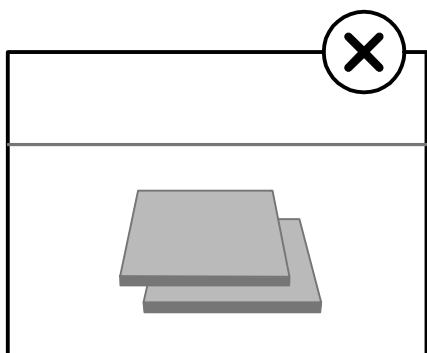
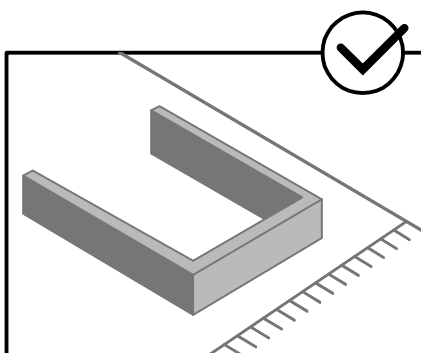
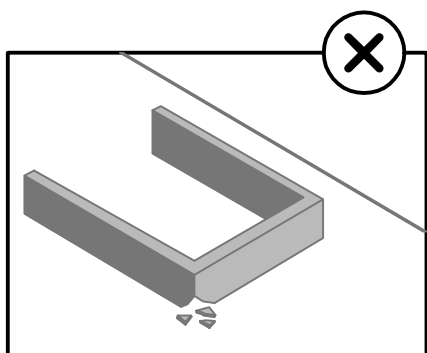

TOOLS REQUIRED

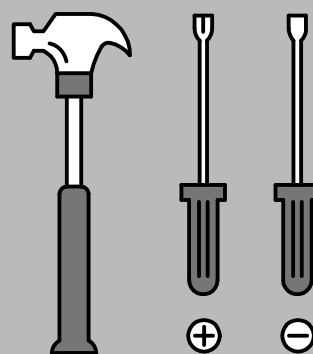

SUPPORT SITE



View our assembly video online
WWW.MANHATTANCOMFORT.COM



Stuck? Question? We are here to help.
tel: **908-888-0818**
e-mail: **help@manhattancomfort.com**



Included in this package:

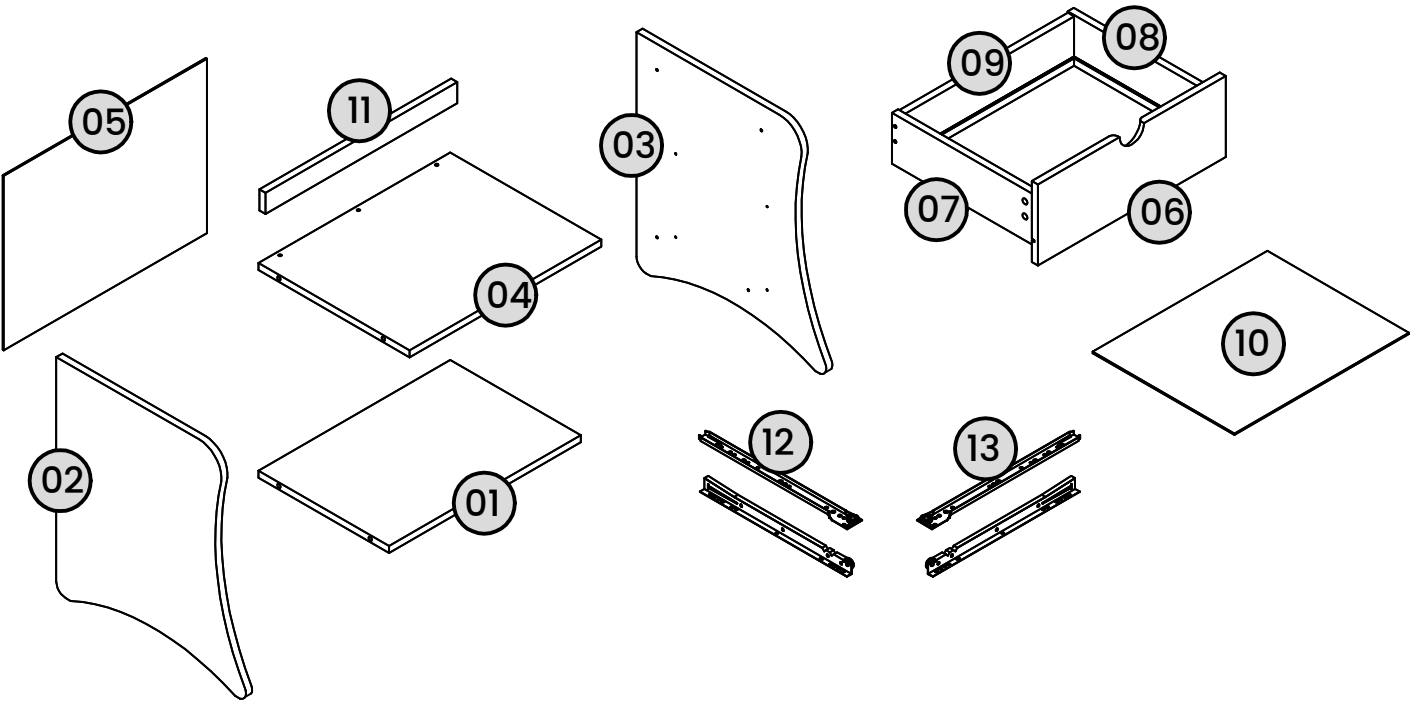

- | | | | |
|-----------------------------------|----|------------------------------------|----|
| 01. Base | 01 | 08. Right side panel of the drawer | 02 |
| 02. Left side panel | 01 | 09. Rear panel of the drawer | 02 |
| 03. Right side panel | 01 | 10. Base of the drawer | 02 |
| 04. Top panel | 01 | 11. Crossbar | 01 |
| 05. Back panel | 01 | 12. Left slides | 02 |
| 06. Front of the drawer | 02 | 13. Right slides | 02 |
| 07. Left side panel of the drawer | 02 | | |

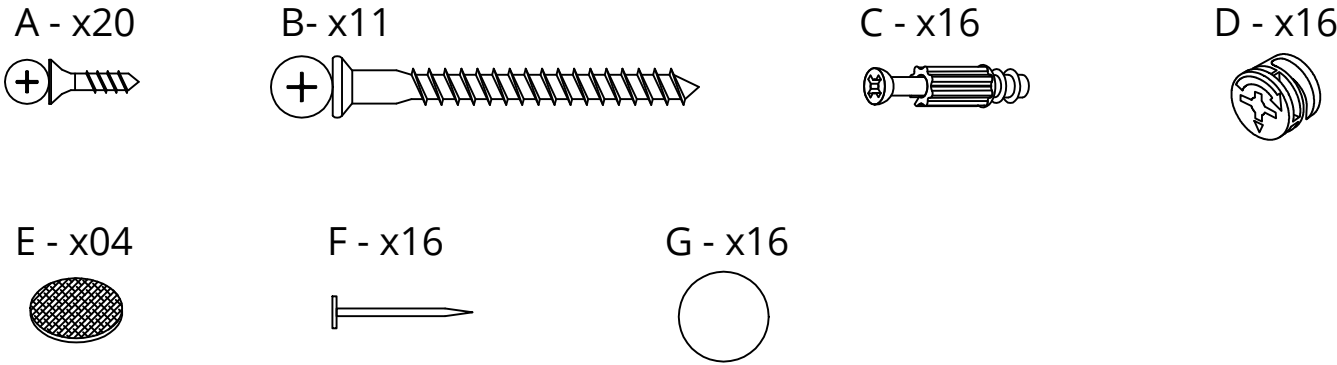

Weight capacity:

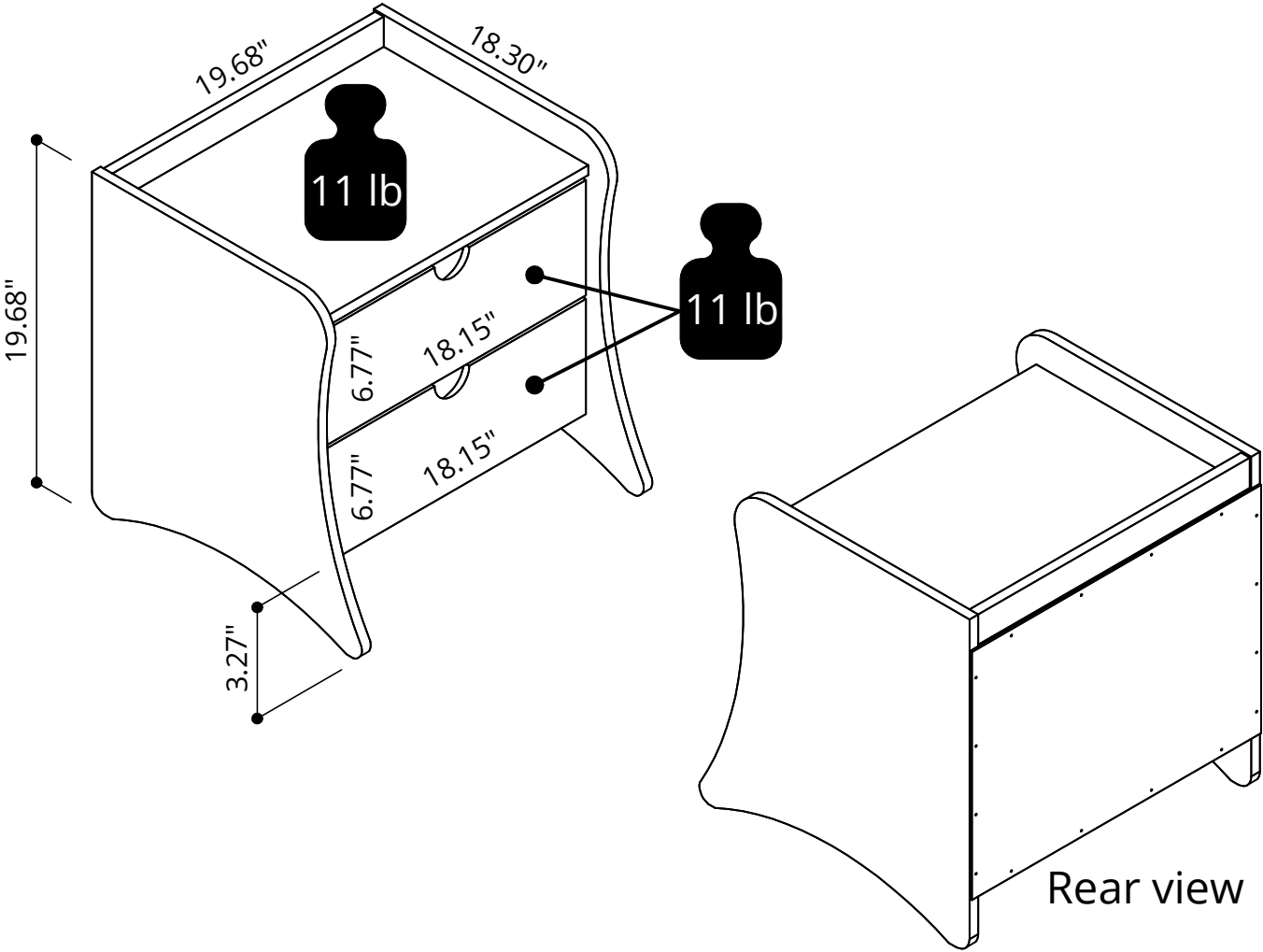

HOW TO IDENTIFY THE SLIDES?

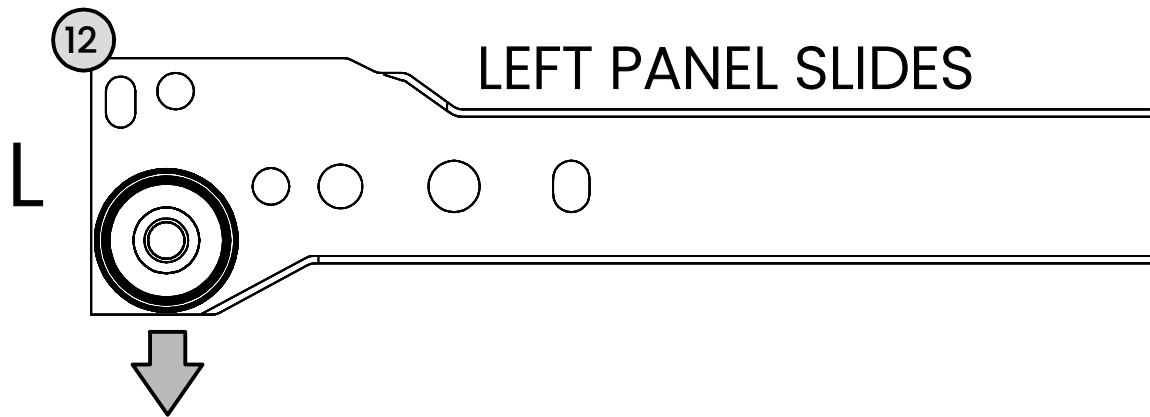

*plastic wheel always pointed to the ground.

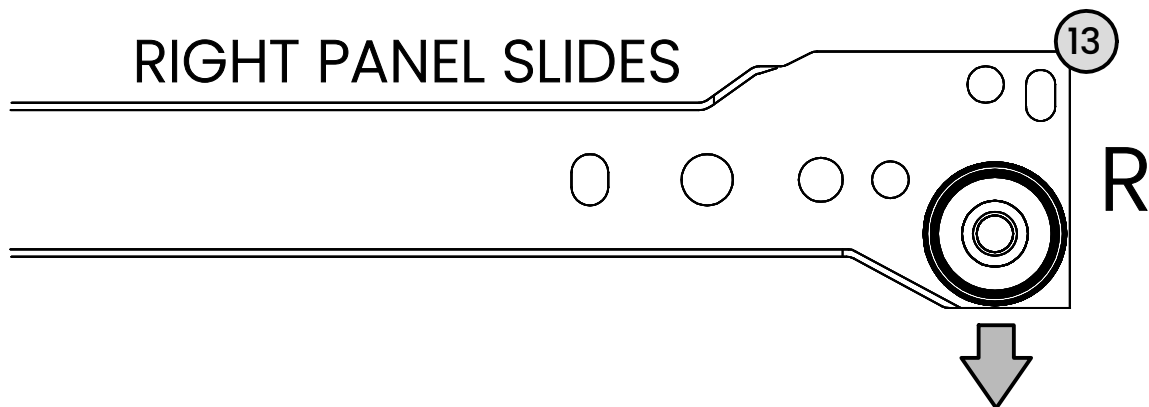

*plastic wheel always pointed to the ground.

WICH HOLES USE TO ATTACH THE SCREWS?

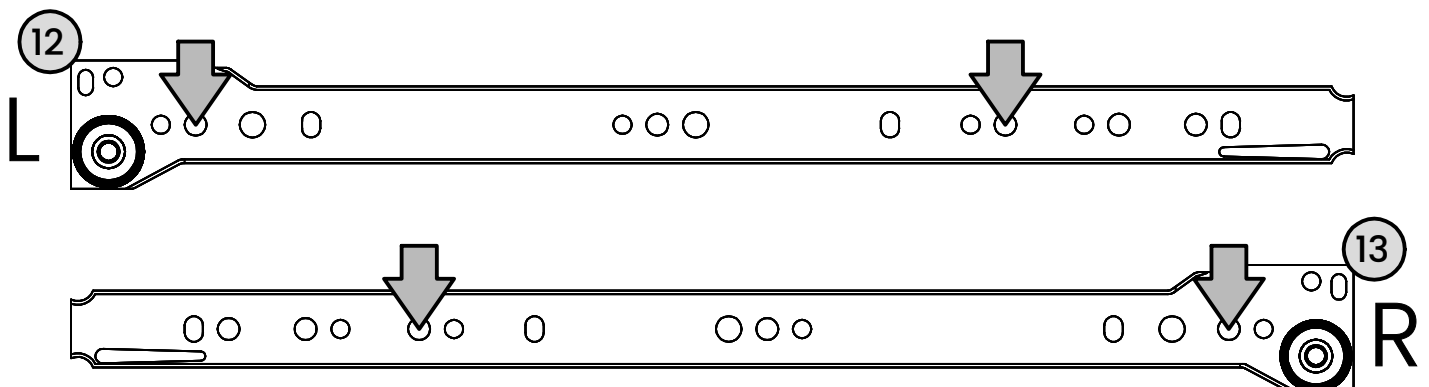

Attention, all the assemblage must be done on the cardboard box or the Styrofoam boards to avoid damage to the parts.

Step 01



A = 16x

Apply the parts 12 onto the part 02 and the part 13 onto the part 03 with the hardware A.



E = 04x

Apply the hardware E onto the parts 02 and 03.

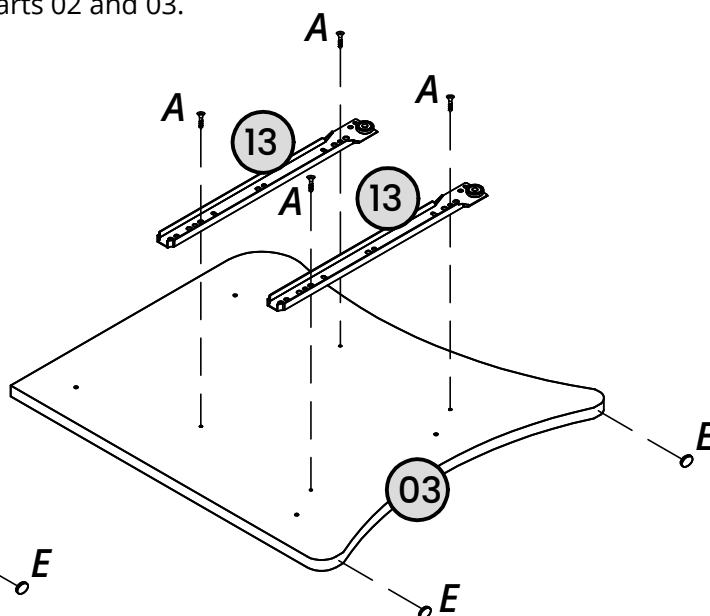
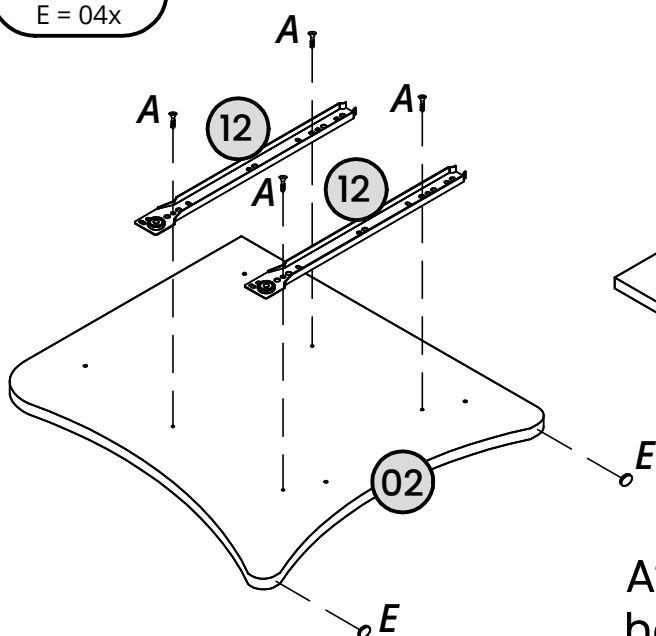

Attention! Before apply the hardware E, clean the parts number 02 and 03, with a dry cloth.

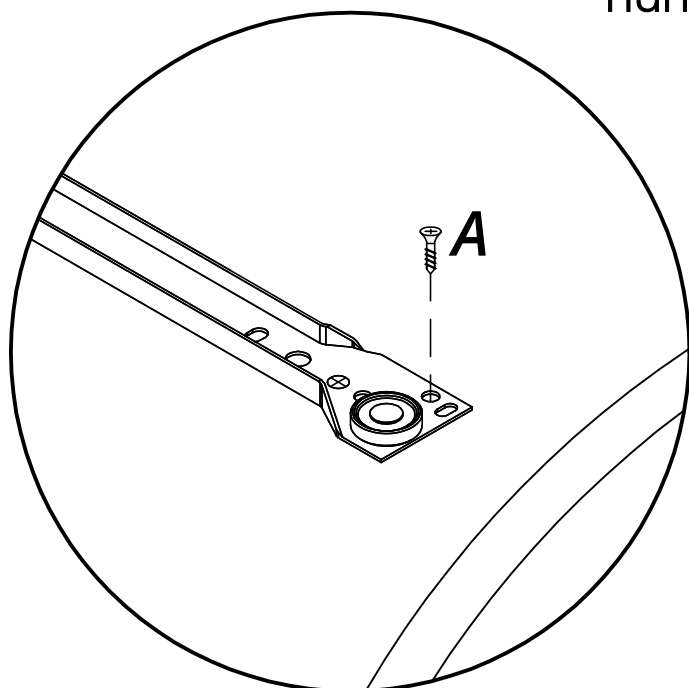

ATTENTION!

It is mandatory to apply an additional screw (A) at the position informed, please observe there is no pre hole in the parts number 02 and 03.

Step 02

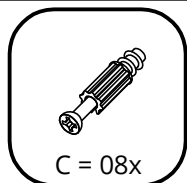

Apply the hardware (C) into the parts 02 and 03.

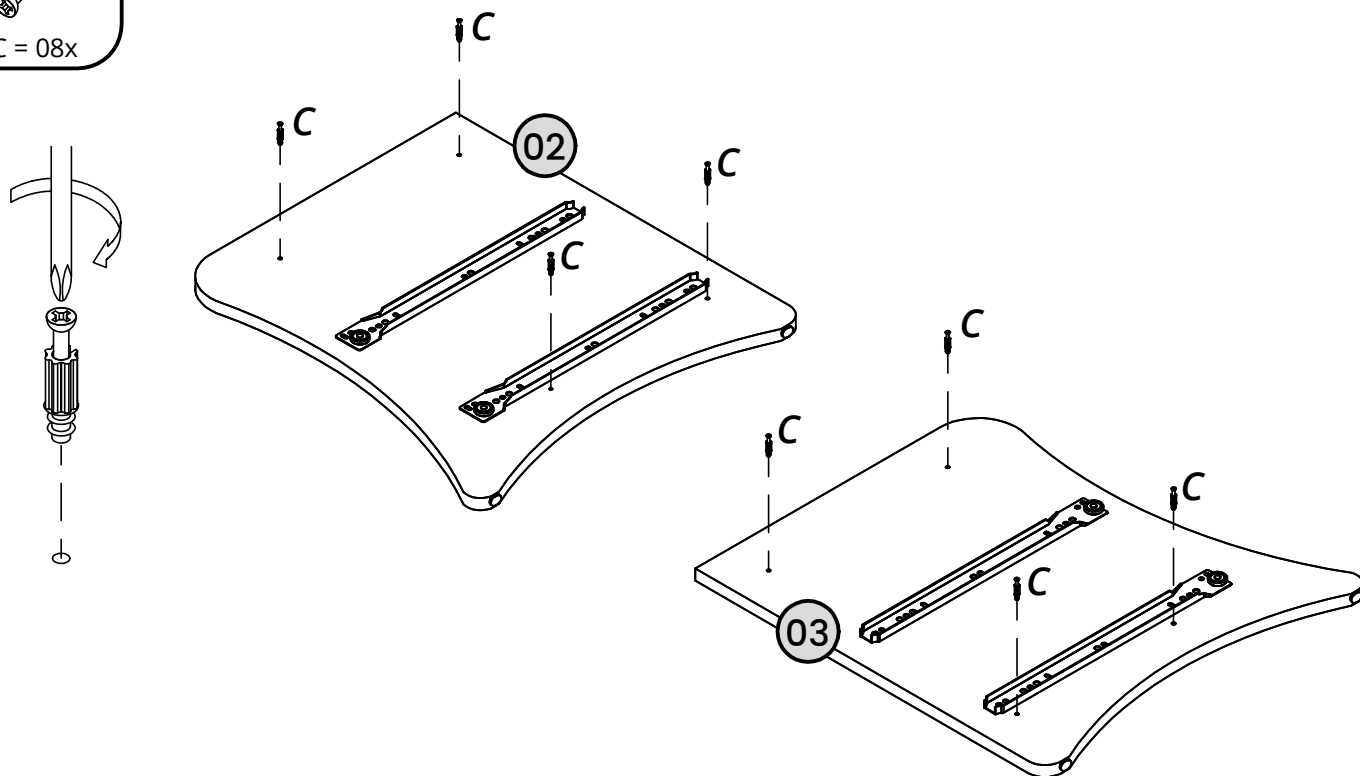

Step 03

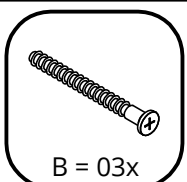

Connect the part 11 onto the part 04 with the hardware (B).

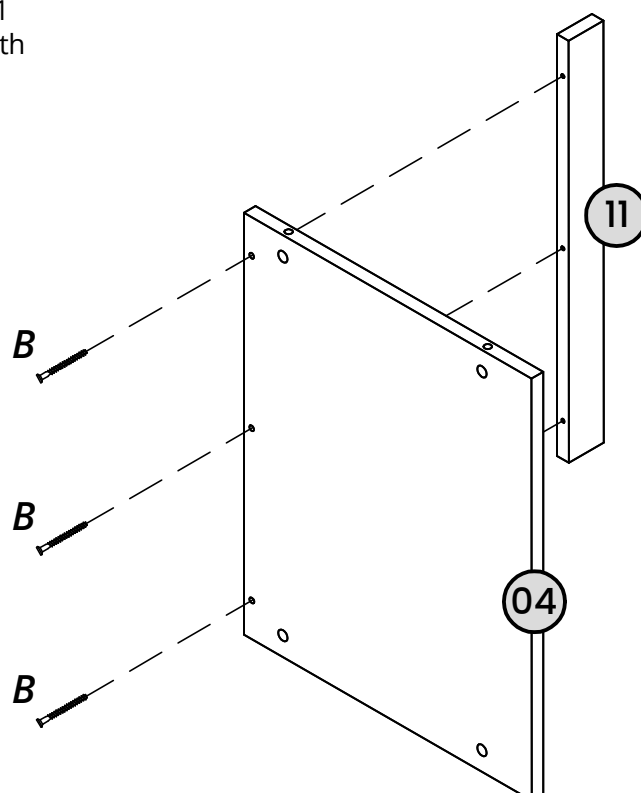

Step 04

Connect the part 04 onto the part 03 with the hardware D.



D = 02x



G = 02x

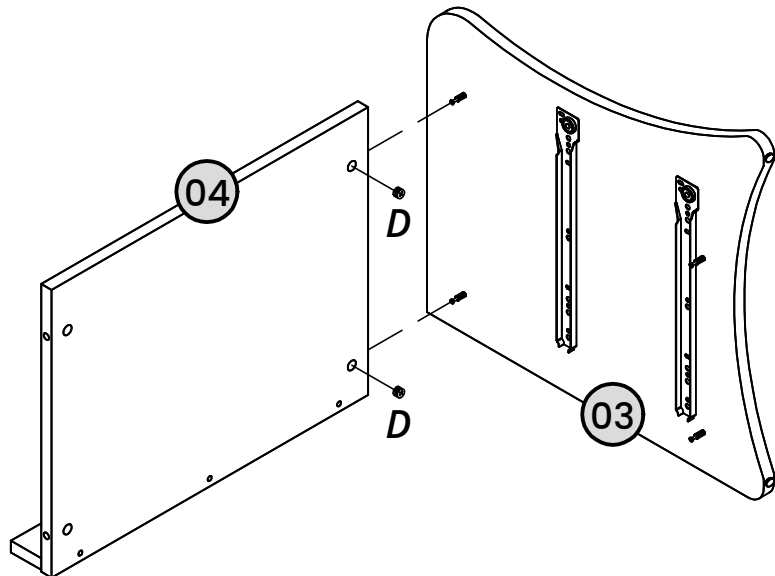
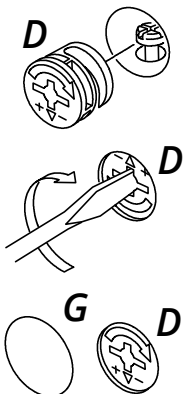

Apply the hardware (G) onto the hardware (D).

Step 05

Connect the part 01 onto the part 03 with the hardware D.



D = 02x



G = 02x

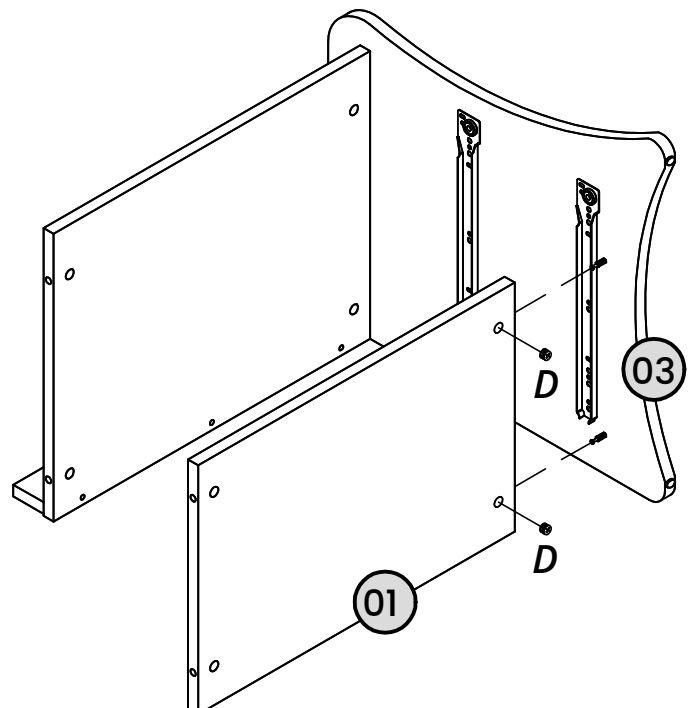
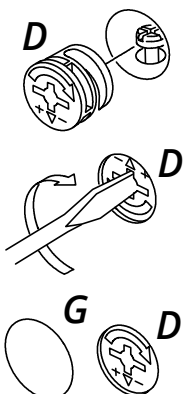

Apply the hardware (G) onto the hardware (D).

Step 06



D = 04x



G = 04x

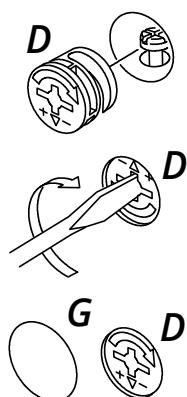

Connect the part 02 onto the parts 01 and 04 with the hardware D.

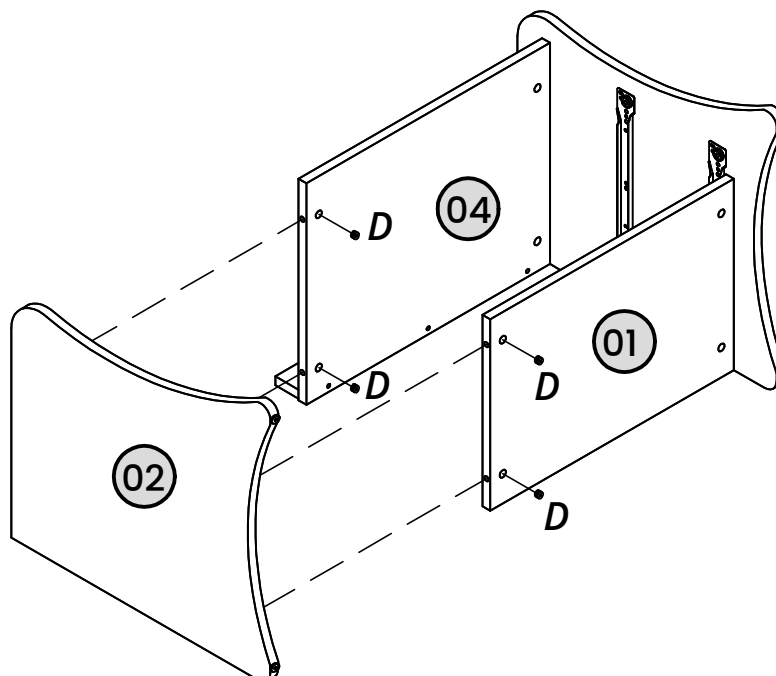

Apply the hardware (G) onto the hardware (D).

Step 07



F = 16x

Connect the part 05 with the hardware F.

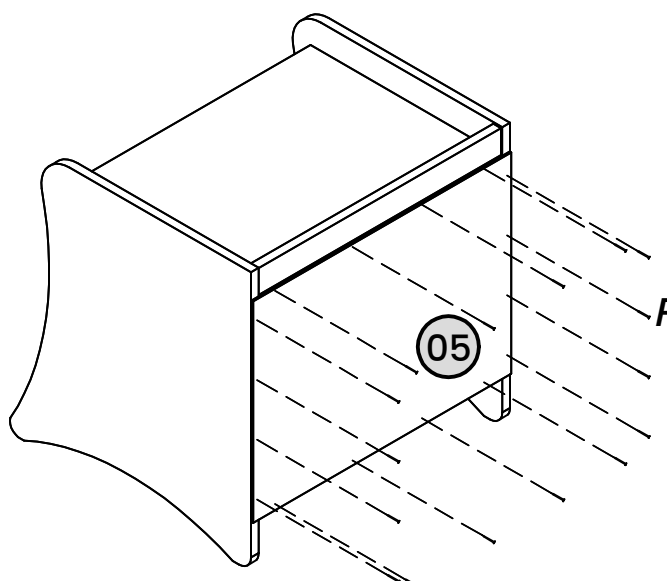

Assembling the drawers

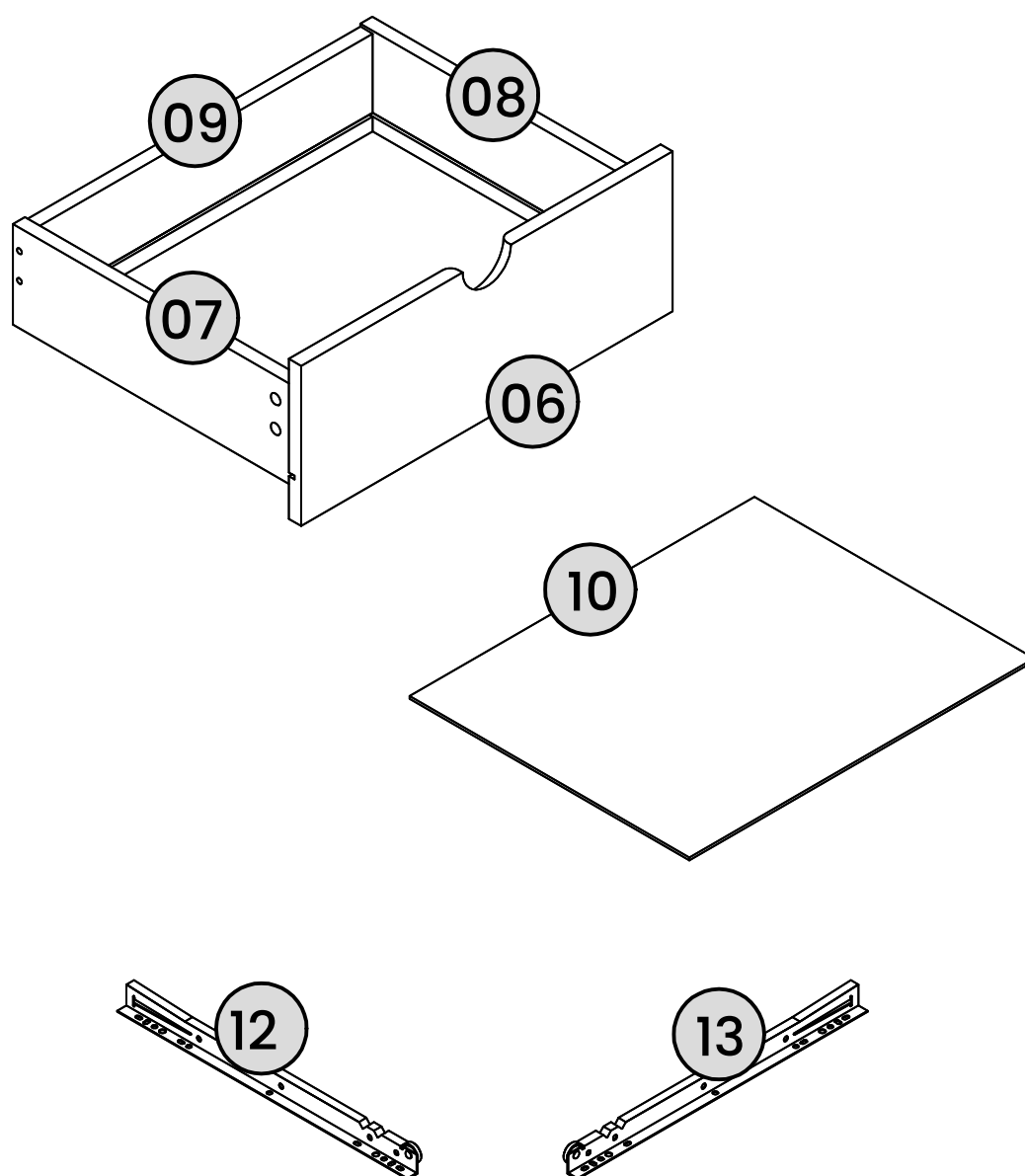

Attention, all the assemblage must be done on the cardboard box or the Styrofoam boards to avoid damage to the parts.

Step 08



Apply the hardware (C) into the part 06.

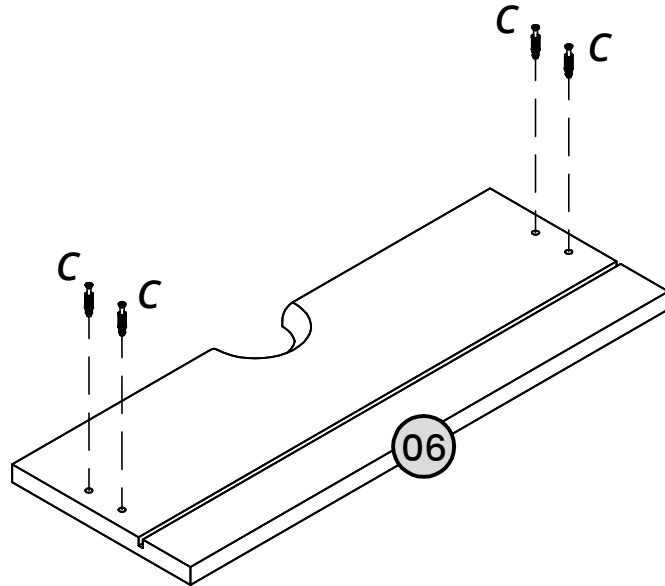
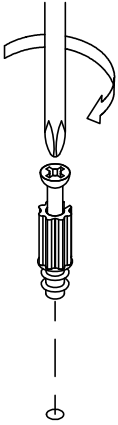

Repeat the same procedure
to assemble the second drawer.

Step 09



Connect the part 07 and 08 onto the part 06 with the hardware D.

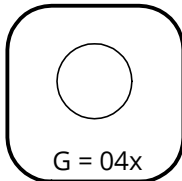

Repeat the same procedure
to assemble the second drawer.

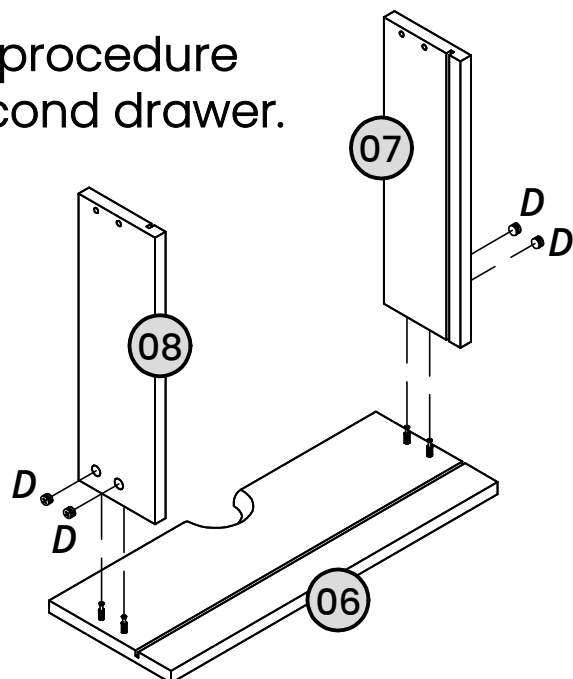
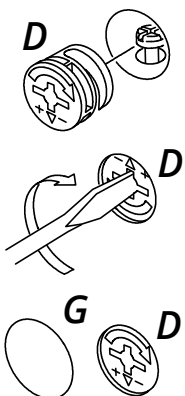

Apply the hardware (G) onto the hardware (D).

Step 10

Apply the part 10 in the groove of the parts 07, 08 until the groove of the part 06.

Repeat the same procedure to assemble the second drawer.

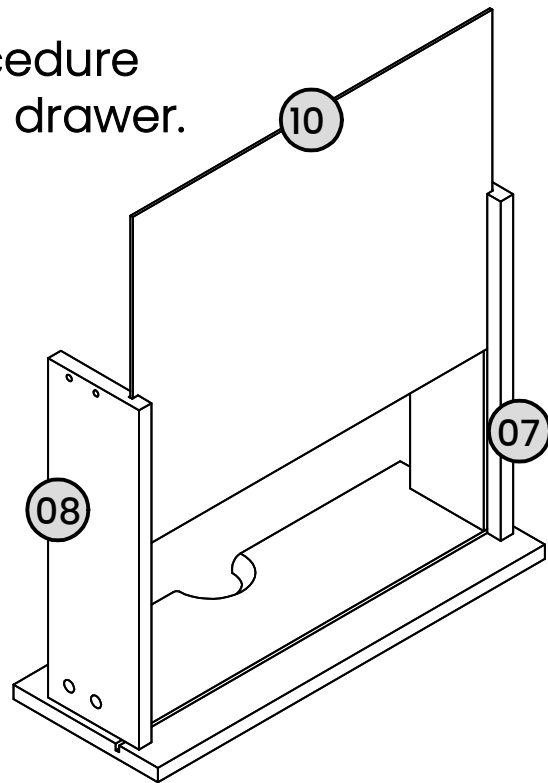
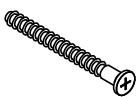
**Step 11**

B = 04x

Connect the part 09 onto the parts 07 and 08 with the hardware (B).

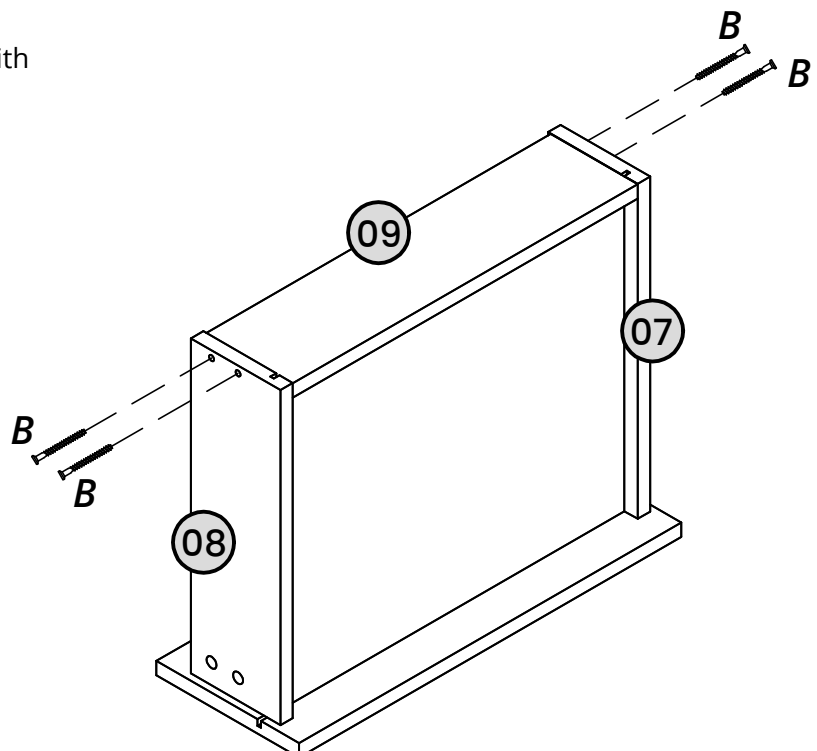

Repeat the same procedure to assemble the second drawer.

Step 12

You must apply the screws
on the holes
indicated by the arrows.

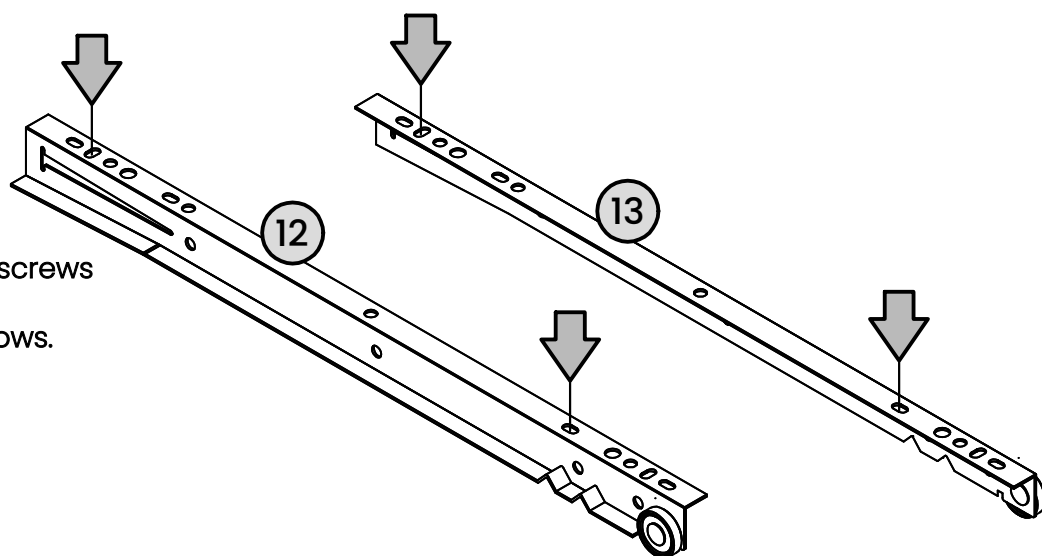

*plastic wheel always pointed
to the rear panel of the drawer
part 09.

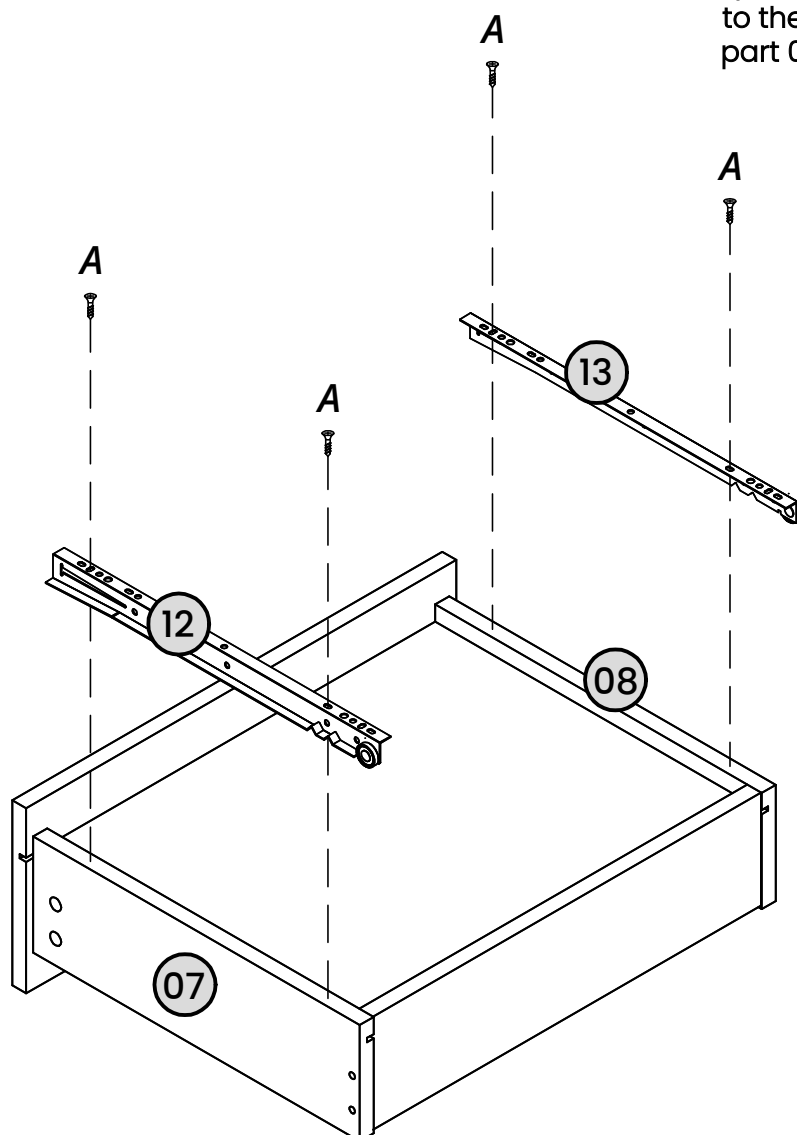
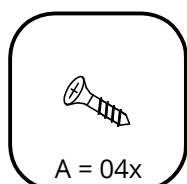

Repeat the same procedure
to assemble the second drawer.

Step 13

Install the drawers fitting them into the slides fixed on the parts 02 and 03.

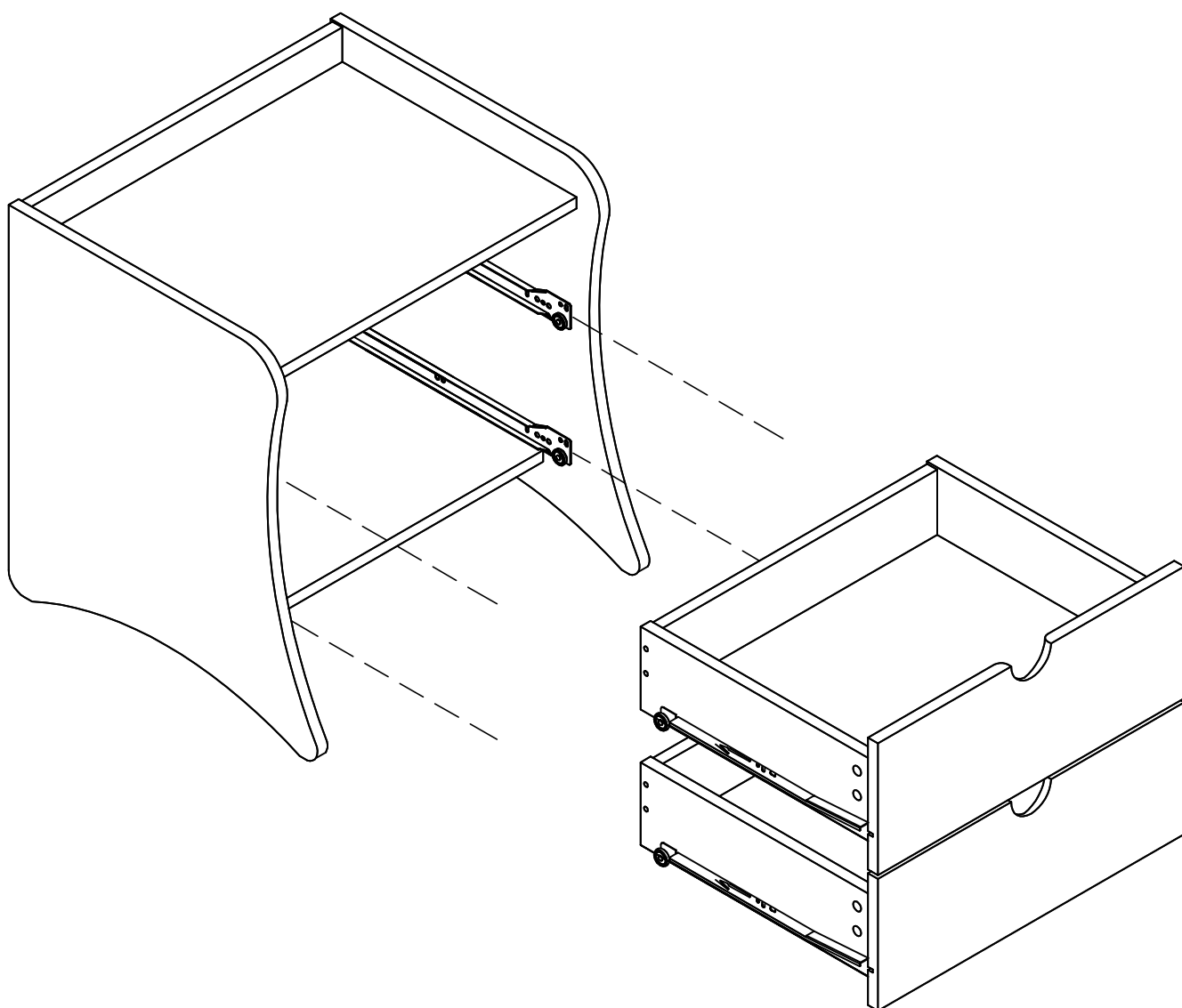



WARRANTY POLICY

All Manhattan Comfort furniture products are warranted, to the original purchaser at the time of purchase and for a period of 30 days thereafter.

Our warranty is limited to new products purchased in factory sealed cartons. This warranty is valid in the United States of America and Canada.

In order to provide you with timely assistance, please thoroughly inspect your furniture for missing or defective parts immediately after opening the carton.

Manhattan Comfort offers a 30-day parts replacement warranty on all items.

Our furniture products are not intended for outdoor use.

THE WARRANTY DOES NOT COVER:

- Defects/damages by improper assembly or disassembly.
- Defects/damages caused by shipping. Claims for damage during transit should be placed immediately to the transportation company.
- Defects/damages caused by inappropriate use of the furniture.



319 Ridge Rd. Dayton, NJ 08810

908-888-0818