

**72 inch Powder Coated Steel  
Roller Cabinet**

**Model:  
DX722117RC**

Extreme Tools, Inc.  
740 Frontenac Road  
Naperville, Illinois 60563  
630.369.9303  
[www.ExtremeTools.net](http://www.ExtremeTools.net)

# Roller Cabinet Parts List

## DX722117RC

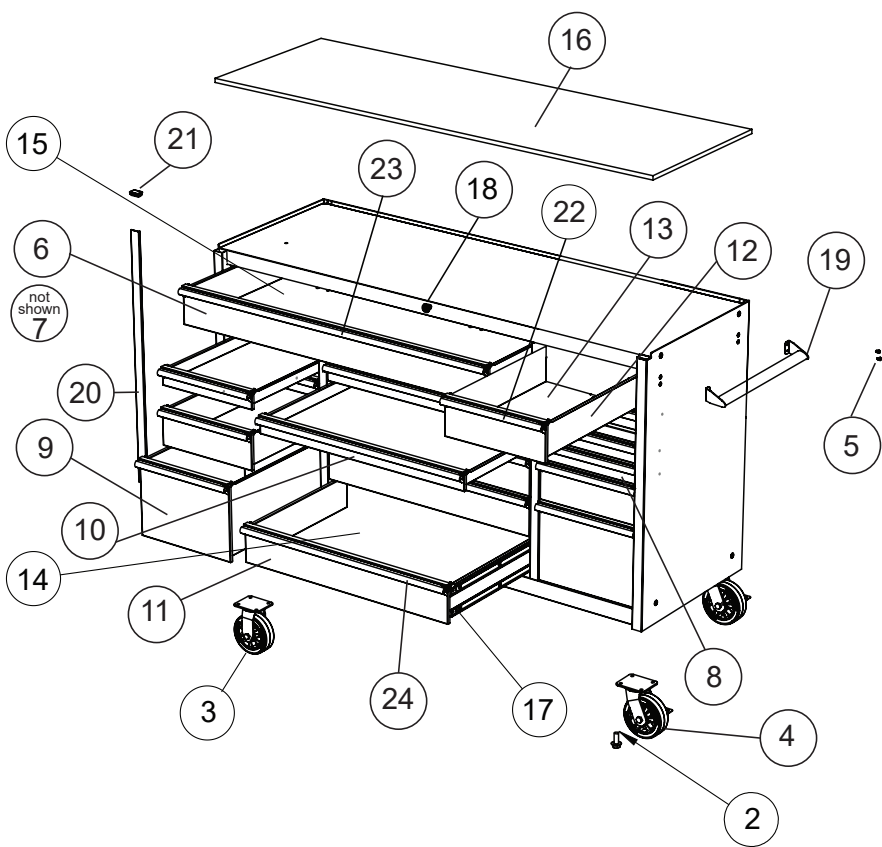

Replacement keys may be ordered using the code that appears on the face of the lock.

To order replacement parts, have the part number, tool box and drawer pull color and quantity ready.

If under warranty, the serial number is **REQUIRED** to get replacement parts.

Not all parts are available under warranty and may be purchased separately.

# Roller Cabinet Parts List

## DX722117RC

Item	Part number	Description	Qty.
2	Z-BTM10X25SHH	M10X25 Serrated Hex Head Bolt	16
3	Z-CA6R(CR)	6X2 Chrome Mag Caster (Rigid)	2
4	Z-CA6R(CRS)	6X2 MAG wheel swivel with brake, NO LOGO	2
5	ZM6SCHX-16 BK	M6X16 Hex Bolts, Black	4
21	Z-ECDX	DX Plastic End Cap	2
6	ZDRD1305C2QWKU	DX722117RC drawer 1A, 100lbs slide, black with blue trim.	1
6	ZDRD1305C2QWKR	DX722117RC drawer 1A, 100lbs slide, black with red trim.	1
6	ZDRD1305C2QWUK	DX722117RC drawer 1A, 100lbs slide, blue with black trim.	1
6	ZDRD1305C2QWGK	DX722117RC drawer 1A, 100lbs slide, green with black trim.	1
6	ZDRD1305C2QWMK	DX722117RC drawer 1A, matte black with black trim.	1
6	ZDRD1305C2QWOK	DX722117RC drawer 1A, 100lbs slide, orange with black trim.	1
7	ZDRD1305C1QWKU	DX722117RC drawer #2A, 100lbs slide, black with blue trim.	1
7	ZDRD1305C1QWKR	DX722117RC drawer #2A, 100lbs slide, black with red trim.	1
7	ZDRD1305C1QWUK	DX722117RC drawer #2A, 100lbs slide, blue with black trim.	1
7	ZDRD1305C1QWGK	DX722117RC drawer #2A, 100lbs slide, green with black trim.	1
7	ZDRD1305C1QWMK	DX722117RC drawer #2A, 100lbs slide, matte black with black trim.	1
7	ZDRD1305C1QWOK	DX722117RC drawer #2A, 100lbs slide, orange with black trim.	1
8	ZDRD398C1QWKU	DX722117RC drawer #3A, 100lbs slide, black with blue trim.	7
8	ZDRD398C1QWKR	DX722117RC drawer #3A, 100lbs slide, black with red trim.	7
8	ZDRD398C1QWUK	DX722117RC drawer #3A, 100lbs slide, blue with black trim.	7
8	ZDRD398C1QWGK	DX722117RC drawer #3A, 100lbs slide, green with black trim.	7
8	ZDRD398C1QWMK	DX722117RC drawer #3A, 100lbs slide, matte black with black trim.	7
8	ZDRD398C1QWOK	DX722117RC drawer #3A, 100lbs slide, orange with black trim.	7
9	ZDRD398C4QWKU	DX722117RC drawer #4A, 100lbs slide, black with blue trim.	2
9	ZDRD398C4QWKR	DX722117RC drawer #4A, 100lbs slide, black with red trim.	2
9	ZDRD398C4QWUK	DX722117RC drawer #4A, 100lbs slide, blue with black trim.	2
9	ZDRD398C4QWGK	DX722117RC drawer #4A, 100lbs slide, green with black trim.	2
9	ZDRD398C4QWMK	DX722117RC drawer #4A, 100lbs slide, matte black with black trim.	2
9	ZDRD398C4QWOK	DX722117RC drawer #4A, 100lbs slide, orange with black trim.	2
10	ZDRD865C1QWKU	DX722117RC drawer #5A, 100lbs slide, black with blue trim.	3
10	ZDRD865C1QWKR	DX722117RC drawer #5A, 100lbs slide, black with red trim.	3
10	ZDRD865C1QWUK	DX722117RC drawer #5A, 100lbs slide, blue with black trim.	3
10	ZDRD865C1QWGK	DX722117RC drawer #5A, 100lbs slide, green with black trim.	3
10	ZDRD865C1QWMK	DX722117RC drawer #5A, 100lbs slide, matte black with black trim.	3
10	ZDRD865C1QWOK	DX722117RC drawer #5A, 100lbs slide, orange with black trim.	3
11	ZDRD865C2QWKU	DX722117RC drawer #6A, 100lbs slide, black with blue trim.	2
11	ZDRD865C2QWKR	DX722117RC drawer #6A, 100lbs slide, black with red trim.	2
11	ZDRD865C2QWUK	DX722117RC drawer #6A, 100lbs slide, blue with black trim.	2
11	ZDRD865C2QWGK	DX722117RC drawer #6A, 100lbs slide, green with black trim.	2
11	ZDRD865C2QWMK	DX722117RC drawer #6A, 100lbs slide, matte black with black trim.	2
11	ZDRD865C2QWOK	DX722117RC drawer #6A, 100lbs slide, orange with black trim.	2

# Roller Cabinet Parts List cont.

## DX722117RC

Item	Part number	Description	Qty.
12	ZDRD398C2QWKU	DX722117RC drawer #7A, 100lbs slide, black with blue trim.	1
12	ZDRD398C2QWKR	DX722117RC drawer #7A, 100lbs slide, black with red trim.	1
12	ZDRD398C2QWUK	DX722117RC drawer #7A, 100lbs slide, blue with black trim.	1
12	ZDRD398C2QWKG	DX722117RC drawer #7A, 100lbs slide, green with black trim.	1
12	ZDRD398C2QWMK	DX722117RC drawer #7A, 100lbs slide, matte black with black trim.	1
12	ZDRD398C2QWOK	DX722117RC drawer #7A, 100lbs slide, orange with black trim.	1
15	ZDL1283X459 PVC	DX722117RC, Drawer liner, Large, 1283x459, PVC, Black	2
14	ZDL845X459 PVC	DX722117RC, Drawer liner, Medium, 845x459, PVC, Black	5
13	ZDL360X459 PVC	DX722117RC, Drawer liner, Small, 360x459, PVC, Black	10
16	ZMDF722125MM	72"x21"x1" Laminated MDF work surface	1
17	ZSLW400F387	DX722117RC drawer slide set, 100 lb, 400/387 mm length	23 sets
17A	Z-DTEX56	Detents for slides (come with slides)	46
18	Z-LK EX01-04	EX01-EX04 Mix lock sets	1
*	Z-LGS	Extreme Tools name plate	1
*	Z-LGL	Extreme Tools Logo	1
20	ZTRDX868X26-BU	DX4125/7217RC FRONT TRIM, 868 MM LG, BLUE	2
20	ZTRDX868X26-RD	DX4125/7217RC FRONT TRIM, 868 MM LG, RED	2
20	ZTRDX868X26-BK	DX4125/7217RC FRONT TRIM, 868 MM LG, BLACK	2
19	ZHDOB30X45ST381-RD	Side handle, Oblong 30x45 with angled L bracket mount, C-C: 381, Red	1
19	ZHDOB30X45ST381-BK	Side handle, Oblong 30x45 with angled L bracket mount, C-C: 381, Black	1
19	ZHDOB30X45ST381-BL	Side handle, Oblong 30x45 with angled L bracket mount, C-C: 381, Blue	1
*	ZM45CSD-D5H4	M4 Shoulder screw for DX drawer pull handle, Dia: 5.0, Height: 4.0	45
*	ZM4NTSR	M4 Serrated nut for DX drawer pull handle/chest lid handle	45
23	ZDPQDX1301-BK	DX722117RC longest drawer pull (1301mm), Quick Release, Black finish.	2
23	ZDPQDX1301-BL	DX722117RC longest drawer pull (1301mm), Quick Release, Blue finish.	2
23	ZDPQDX1301-RD	DX722117RC longest drawer pull (1301mm), Quick Release, Red finish.	2
24	ZDPQDX861-BK	DX722117RC medium length drawer pull (861mm), black.	5
24	ZDPQDX861-BL	DX722117RC medium length drawer pull (861mm), blue.	5
24	ZDPQDX861-RD	DX722117RC medium length drawer pull (861mm), red.	5
22	ZDPQDX395-BK	DX722117RC shortest drawer pull (395mm), Quick Release, Black finish.	4
22	ZDPQDX395-BL	DX722117RC shortest drawer pull (395mm), Quick Release, Blue finish.	
22	ZDPQDX395-RD	DX722117RC shortest drawer pull (395mm), Quick Release, Red finish.	
option	Z-DLDX722117RC-Kit	DX722117RC Drawer liner kits, PVC, Black, LG x 2; MED x 5; SM x 10	1 set
*	not shown		

# ASSEMBLY

## Handle Installation

NOTE: Assemble the handle first to make it easier to move the tool cabinet.

Position the handle over the holes in the cabinet and attach with the provided (4) M6 socket head screws. Tighten securely.

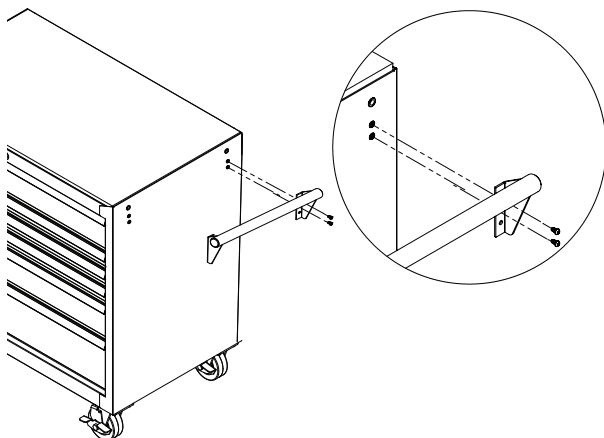

## OPERATING PROCEDURE

### Drawer Removal

Pull drawer out so that it is almost fully extended.

Push up on the black lever on one drawer slide and at the same time push down on the lever on the other side.

With the levers in these positions, pull the drawer out until it releases from the drawer slides.

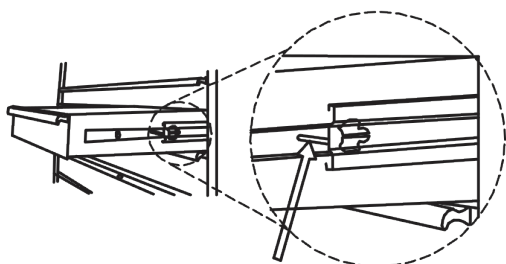

### Drawer Replacement

Extend the drawer slides.

Careful align the brackets on the sides of the drawers with the slots of the cabinet slides. Insert the brackets on the side of each drawer into the slots of the cabinet slides.

Once properly inserted, completely close the drawer to set the slides into their properly functioning positions.

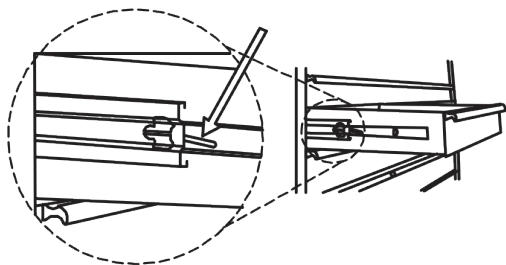

## **MAINTENANCE**

Lubricate the casters once a year with high quality ball bearing grease.

Lubricate the slides twice a year with high quality, petroleum-based lubricant. This may be required more often if operating the tool box in colder climates.

Use mild detergent and water to clean drawer fronts, drawer trim and other surfaces.

Grease and oil can be removed with standard, non-abrasive, non-flammable cleaning products.

Auto wax will help preserve the unit's high gloss finish. Follow directions as provided.

# SAFETY



## WARNING

Do not attempt to lift the cabinet by its side handle using chains, ropes or lifting device. Side handle may fail resulting in personal injury or damage to the product!

Use a forklift or similar lifting device with forks placed under the bottom of the tool box to move if tool box cannot be moved by two people.

Close the drawers and lock the tool box before moving this product! If drawers are not locked they could open and make the product unstable and tip which may cause personal injury or damage to the product.

Do NOT stand on this product or lean on the drawer or work top.

Wear safety glasses when removing or repositioning the slides. The tool box could slip resulting in personal injury.

Do NOT mount this product on a truck bed or other moving object. This may cause personal injury or product damage. Mounting this product on any surface will void the warranty.

Do NOT tow with power equipment. The product could tip which may cause personal injury or product damage.

Do NOT alter this product in any manner or attach electrical equipment. This may cause personal injury or product damage and will void the warranty.

If using the combination top chest and roller cabinet, the top chest MUST be secured to the roller cabinet by following the directions provided. Not securing the top chest to the roller cabinet may cause the product to become unstable which may cause personal injury or damage to the product.



## CAUTION - IMPORTANT PRODUCT INFORMATION

### **DRAWERS MUST BE CLOSED AND TOOL BOX LOCKED USING KEYS BEFORE MOVING!**

The maximum weight for each drawer should not exceed 100 lbs. (45 kg) for single slides and 200 lbs. (90 kg) for drawers with double slides.

Maximum overall weight should not exceed 2,700 lbs. (1,224 kg.)

Use caution when closing the chest lid. Remove hands from the area before closing to prevent personal injury.

Do NOT pull this product. Push the product to prevent personal injury.

ENGAGE THE BRAKES when not moving this product. Locked casters prevent the product from rolling. Rolling may result in personal injury or damage to the product.

This product may become unstable and tip if more than one drawer is open at a time. To prevent personal injury or damage to product, OPEN ONLY ONE DRAWER AT A TIME.

Lock product before moving. Properly secure if moving with a forklift or other device.

Keep the product on a level surface. The product could become unstable and tip if stored or moved on an uneven surface which may result in personal injury or product damage.

Remove the work surface from the roller cabinet before installing top chest.