



**RELIABILT™**

RELIABILT and logo design are trademarks  
or registered trademarks of LF, LLC. All  
rights reserved.

ITEM/MODEL # 5997906/5997909/5993543/5993544

## Railing Level Panel & Level Panel Post

Español p. 12

ATTACH YOUR RECEIPT HERE

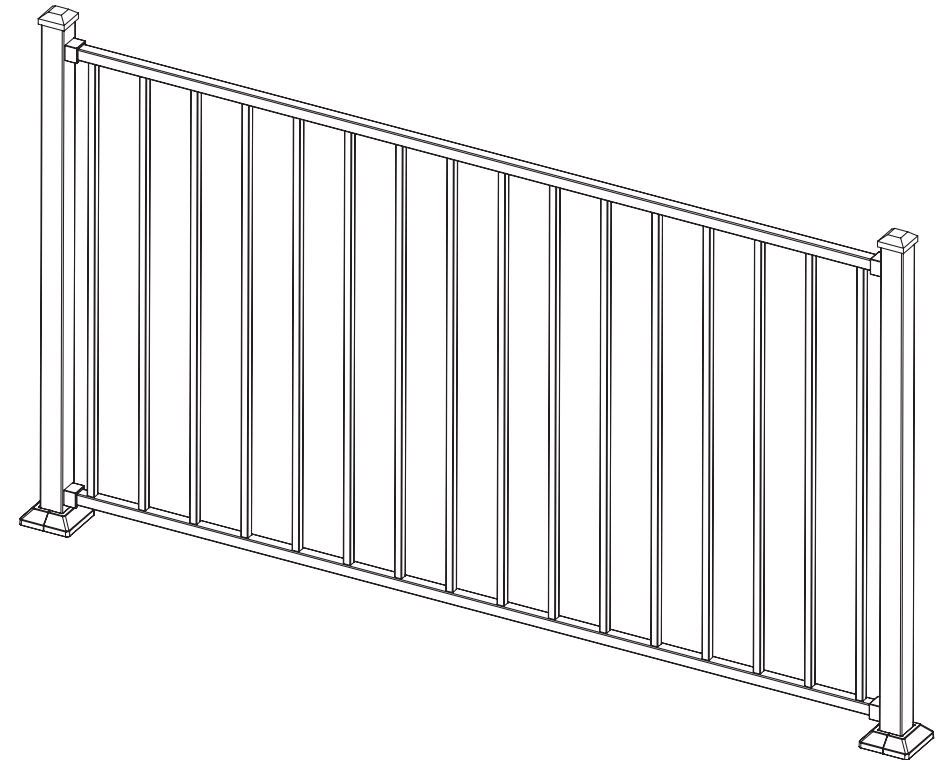

Serial Number \_\_\_\_\_

Purchase Date \_\_\_\_\_

Thank you for purchasing this RELIABILT product.  
Questions, problems or missing parts?  
Before returning, contact us on:  
**866-386-7941, 8 a.m. - 8 p.m., EST, Monday - Sunday or [ascs@lowes.com](mailto:ascs@lowes.com).**

XXXXXX

TABLE OF CONTENTS

Package Contents..... 3

Hardware Contents..... 4

Safety Information..... 5

Preparation..... 5

Assembly or Installation Instructions..... 6

Care and Maintenance .....10

Warranty.....11

PRODUCT SPECIFICATIONS

SPECIFICATIONS
Components below to complete assembly shown are sold separately:
<ul style="list-style-type: none"><li>• Post(s): Each post includes 1 post, 1 post base cover, 4 post brackets and caps, 12 self-drilling screws and 2 post wedge shims. Recommended RELIABILT item # 5993549, 5993551</li><li>• 3/8in. [10 mm] fasteners appropriate for post mounting surface material type and thickness.</li></ul>

PACKAGE CONTENTS

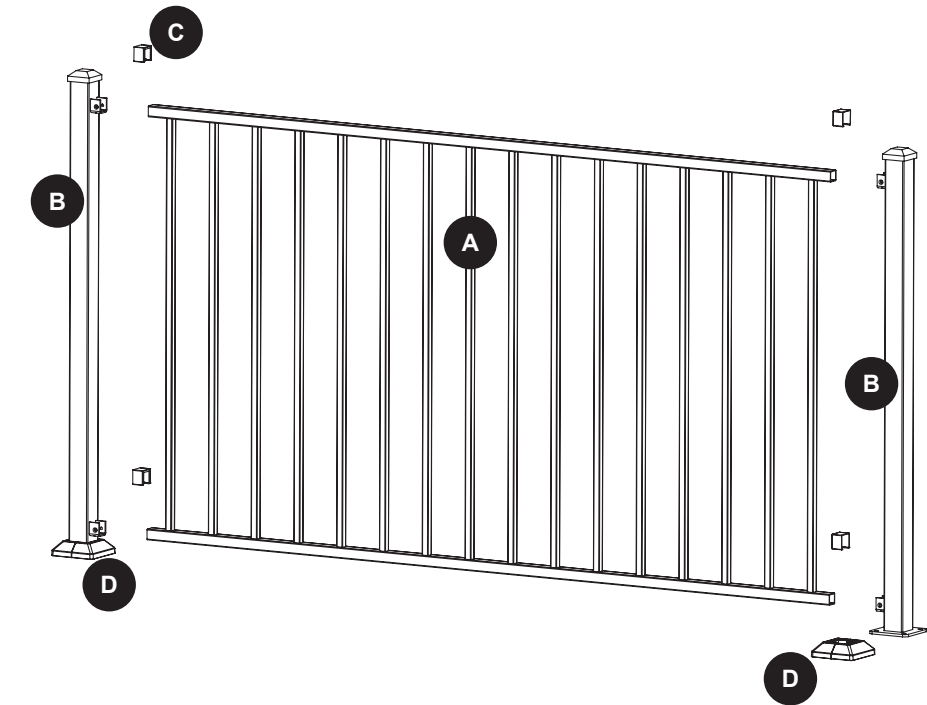

PART	DESCRIPTION	QUANTITY
A	Level Rail Panel	1
B	Post Assemblies	2
C	Bracket Caps	8
D	Post Base Covers	2
E	Brackets	4

**HARDWARE CONTENTS** (shown actual size)

AA

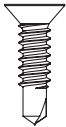

8-18 X .62  
PHILLIPS  
FLAT HEAD  
SELF-DRILLING  
SCREW

QTY: 12 PER  
POST  
(24 TOTAL)

BB

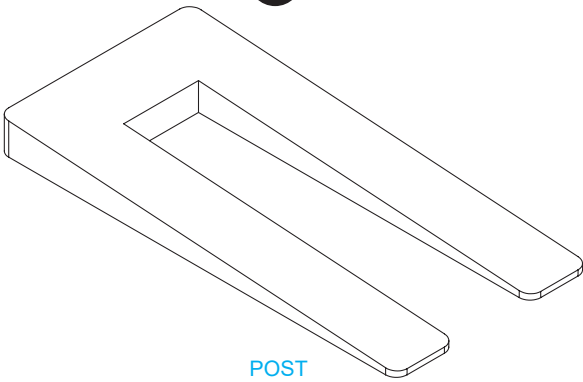

POST  
WEDGE  
SHIM

QTY: 2 PER  
POST  
(4 TOTAL)

**SAFETY INFORMATION**

Please read and understand this entire manual before attempting to assemble, operate or install the product.

Check your local building codes.

Shims can be easily trimmed using a utility knife for a precise fit.

**WARNING**

To avoid metal filings rusting on or within the deck, do not cut rails, posts, panels and other steel parts on the deck surface.

**PREPARATION**

Before beginning assembly of product, make sure all parts are present. Compare parts with package contents list and hardware contents list. If any part is missing or damaged, do not attempt to assemble the product.

**Estimated Assembly Time: 20 minutes**

Tools Required for Assembly (not included): drill, 3/8in. [10 mm] and 5/32in. [4 mm] drill bits, philips driver bit, tape measure, wrenches, speed square, center punch, level, metal cutting saw, touch up paint.

ASSEMBLY INSTRUCTIONS

1. Place the posts (sold separately): Refer to your deck railing plan to determine the locations for the railing posts.

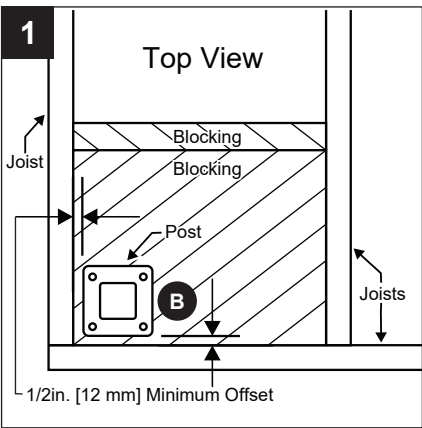

2. Blocking: Make sure there's enough support underneath the deck to securely mount the posts. If not, you may need to install additional blocking (support beams) before proceeding.

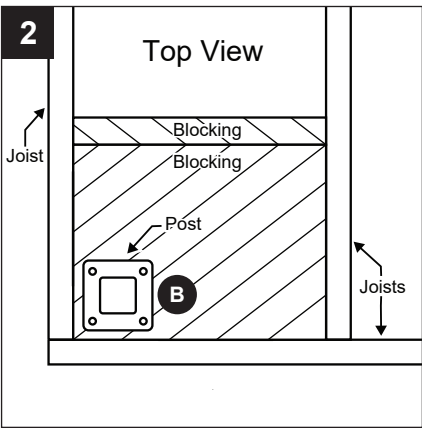

3. Plumb and shim the posts:  
A. Position each post in its designated spot.  
B. Use a level to ensure the post is plumb in all directions.  
C. Insert post wedge shims between post and deck as needed to achieve level position.

Hardware Used

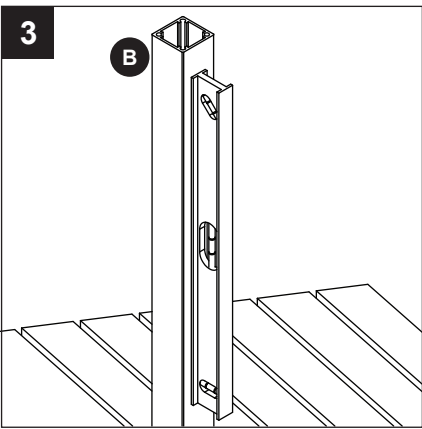
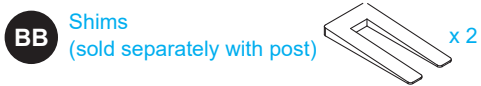

ASSEMBLY INSTRUCTIONS

4. Secure the posts:  
A. Once the post is plumb and shimmed (if needed), secure the post to the deck surface.  
B. The post base is designed to accept a 3/8in. [10 mm] fastener. Use the appropriate fastener for your substrate.  
Tips: Use a helper to hold the post in place while you plumb and secure it. Shims (if needed) can be easily trimmed using a utility knife or for a precise fit. Check local building codes.

Hardware Used

3/8in. [10 mm] fasteners x 4 Per Post  
appropriate for post mounting surface  
material and thickness. (sold separately from posts)

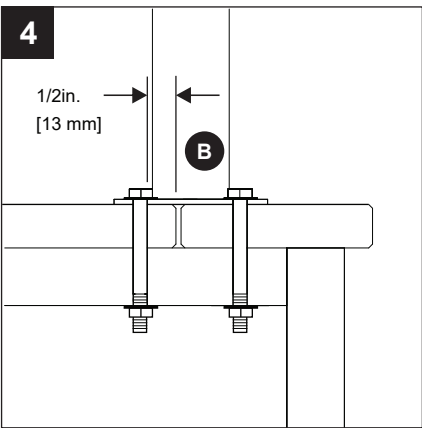

5. Measure and mark the panel:  
A. Measure the distance between the two top brackets and two bottom brackets.  
B. Transfer this measurement to the rail panel, centering so that there is equal space at each end.

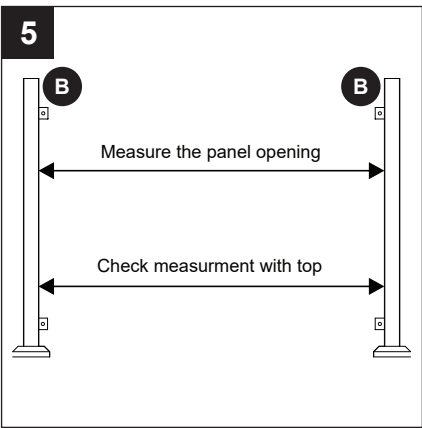

6. Cut the panel: Use a metal saw to cut the panel at the marked locations.  
Important: Do not cut the panel directly on the deck surface to avoid metal filings rusting on the deck.

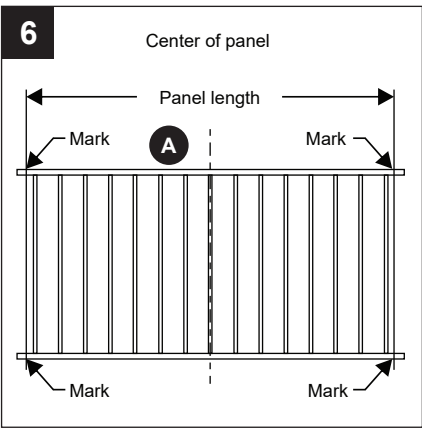

## ASSEMBLY INSTRUCTIONS

### 7. Apply touch-up paint:

- A. Apply two coats of RELIABILT touch-up paint (Item # 5997915), a zinc based touch-up paint, to the freshly cut edges to prevent rust.
- B. Allow it to dry prior to installation.

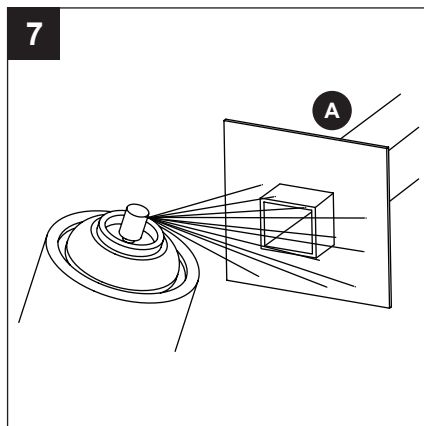

### 8. Set Panel: Carefully position the pre-cut panel between the posts, ensuring even spacing at each end.

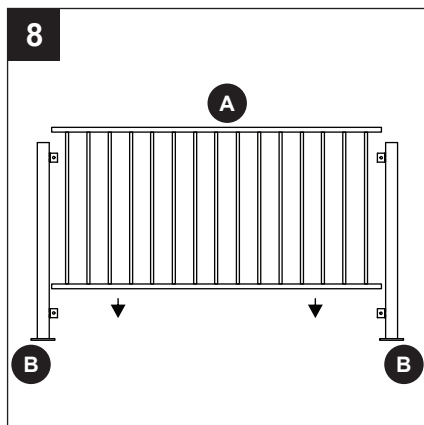

### 9. Attach panel and brackets:

- A. Use a 5/32in. [4 mm] metal drill bit to pre-drill screw holes through the panel, aligning them with the pre-drilled holes in the brackets on each post.
- B. Secure the panel using the supplied self-tapping screws (2 per bracket) through the pre-drilled holes.

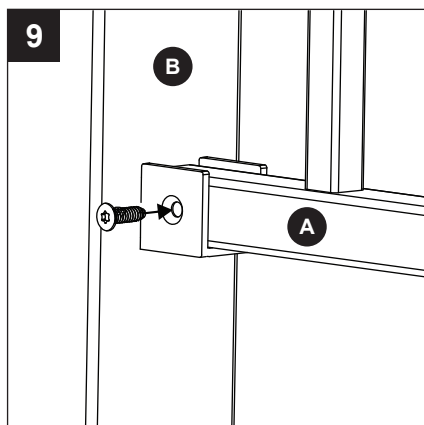

### Hardware Used

AA Self-tapping Screws  x 8

## ASSEMBLY INSTRUCTIONS

### 10. Snap on bracket caps & post base covers:

- A. Slide the bracket cap over the rail next to the bracket.
- B. Push the cap towards the post until it snaps securely into place, concealing the screws.

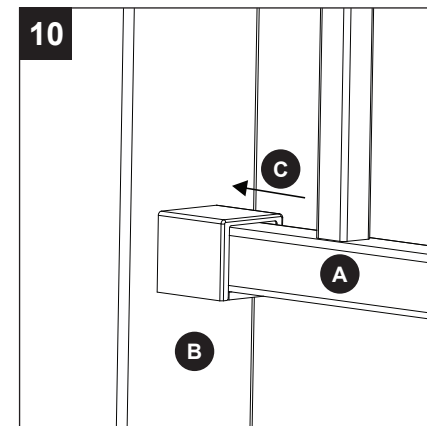

### 11. Place one piece of the post base cover against the post.

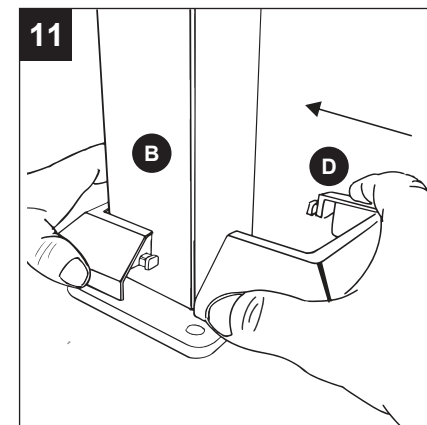

### 12. Bring in the second post base piece and rotate it to lock the two pieces together. This will conceal the post flange for a finished look.

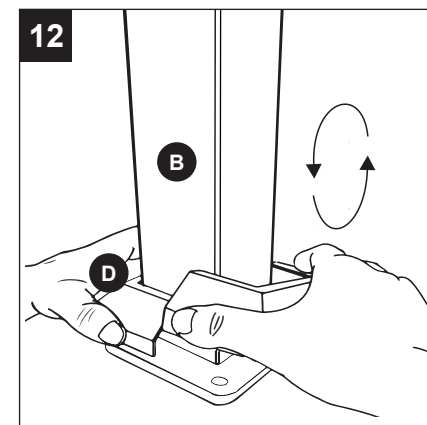

## CARE AND MAINTENANCE

---

Care and maintenance of RELIABILT steel railing products powder-coated products and surfaces:

- Immediately after installation of your RELIABILT steel railing, clean powder-coated products and surfaces with a solution of warm water and non-abrasive, pH neutral detergent solution. Surfaces should be thoroughly rinsed after cleaning to remove all residues. All surfaces should be cleaned using a soft cloth or sponge.
- Ensure construction materials such as concrete, plaster, and paint splashes are removed immediately before they have a chance to dry. Failure to remove these materials may cause damage to the powder-coated surfaces.
- The frequency of cleaning depends in part on the standard of appearance and also the requirements to remove deposits that may cause damage to the powder coat after prolonged exposure. The manufacturer recommends cleaning in three to four month intervals all products and powder-coated surfaces. In areas where higher traffic, increase atmospheric substances, or other effects may occur, the time period between cleanings should be increased to monthly intervals.
- **WARNING:** Do not use strong solvents such as thinners, or solutions containing chlorinated hydrocarbons, esters, or ketones. Abrasive cleaners or cutting compounds should not be used.

## WARRANTY

---

Limited 15 year warranty.

**NOTE:** Start Latin American Spanish section from here.