

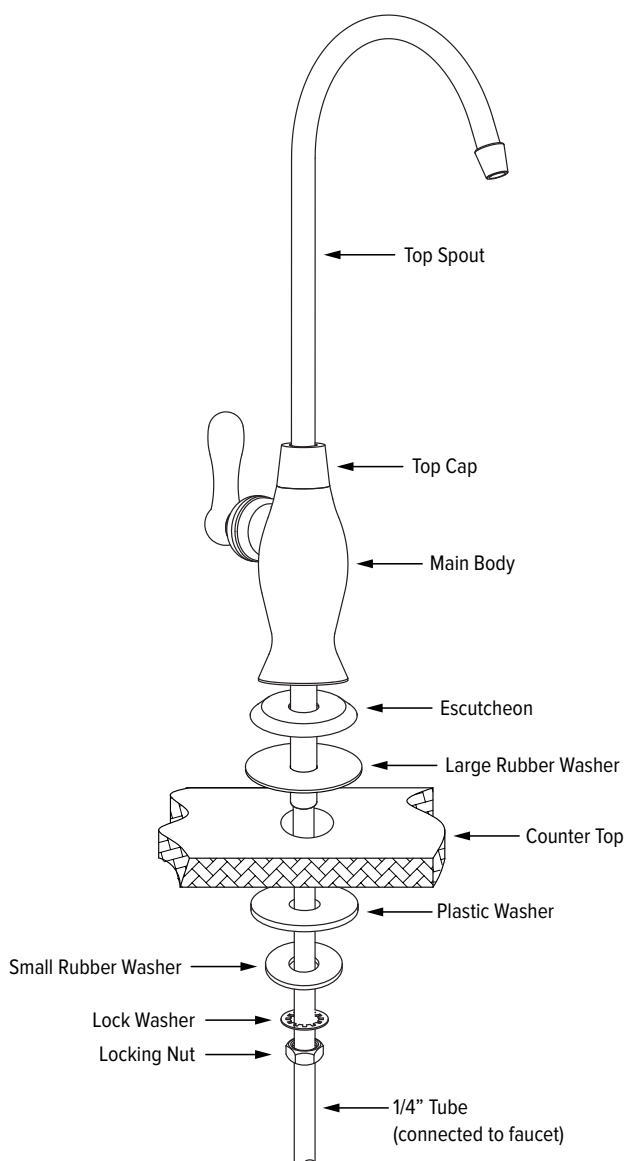

BF200/BF400 Filtered Water Faucet Installation

Installing the Faucet

1. Unpack the faucet and insert the Top Spout into the Main Body by pushing down until fully inserted, then screw the Top Cap clockwise until secured in place.
2. Cut zip tie on the blue water connection tubing and unroll to straighten tubing. Be careful not to cut the tube when removing the zip tie.
3. Install the Escutcheon (faucet base), curved lip side down, by inserting the blue tubing through the Escutcheon and the Large Rubber Washer and push both all the way up until adjacent to the Main Body.
4. Install the faucet on top of the countertop or sink and feed the blue tubing through the hole to the cabinet below. Slide the large Plastic Washer and Small Rubber Washer as shown to the left up through the blue tubing until snug against the bottom of the countertop or sink hole.
5. Install the Lock Washer and the Locking Nut the same way and tighten until the Plastic Washer and Small Rubber Washer are holding the faucet assembly firmly in place. The faucet is now installed!





BF100/BF300 Filtered Water Faucet Installation & Battery Replacement

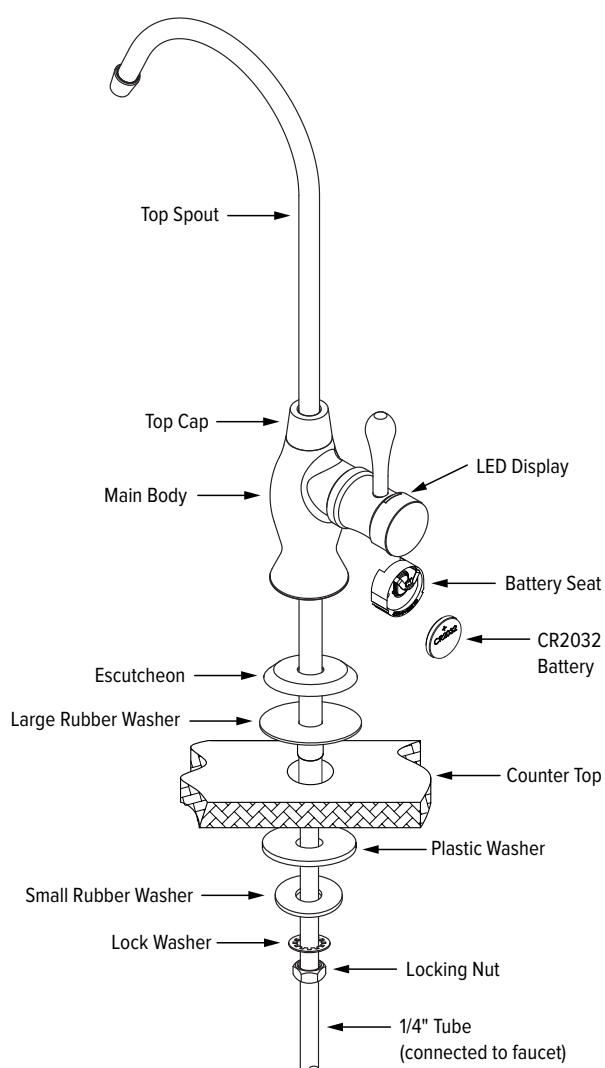

For California Residents

CR2032 batteries contain Perchlorate Material - special handling may apply.
Visit <http://www.dtsc.ca.gov/hazardouswaste/perchlorate> for more information.

Installing the Faucet

1. Unpack the faucet and insert the Top Spout into the Main Body by pushing down until fully inserted, then screw the Top Cap clockwise until secured in place.
2. Cut zip tie on the blue water connection tubing and unroll to straighten tubing. Be careful not to cut the tube when removing the zip tie.
3. Install the Escutcheon (faucet base), curved lip side down, by inserting the blue tubing through the Escutcheon and the Large Rubber Washer and push both all the way up until adjacent to the Main Body.
4. Install the faucet on top of the countertop or sink and feed the blue tubing through the hole to the cabinet below. Slide the large Plastic Washer and Small Rubber Washer as shown to the left up through the blue tubing until snug against the bottom of the countertop or sink hole.
5. Install the Lock Washer and the Locking Nut the same way and tighten until the Plastic Washer and Small Rubber Washer are holding the faucet assembly firmly in place. The faucet is now installed!
6. Pull the plastic tab out from the Battery Seat to activate the LED Indicator. The LED light will blink red once, blue once, and then will be ready to go.

Replacing the Battery (with each filter change)

Replace the battery in the faucet LED indicator to reset the filter change reminder. Use the new CR2032 battery included with your replacement filter set.

1. Under the Faucet Handle, locate the black rubber Battery Seat. Grasp it from the sides and pull down.
2. Remove the old battery by gently lifting the silver metal tab and sliding the battery out of the Battery Seat. Wait 30 seconds before inserting the new battery.
3. Insert the new CR2032 battery by sliding the battery under the silver tab, making sure that the "+" sign and CR2032 are facing towards you.
4. Push the Battery Seat back up into the Faucet Handle.

